



xunison Hub D50 Home WiFi 6 Mesh System User Guide

[Home](#) » [xunison](#) » xunison Hub D50 Home WiFi 6 Mesh System User Guide 

Contents

- 1 xunison Hub D50 Home WiFi 6 Mesh System
- 2 Hub D50 Home Quick Start Guide
- 3 Product Introduction
- 4 Product Installation
- 5 LED Indicators
- 6 Ports and Interfaces
- 7 Safety Guidelines
- 8 RF Parameters
- 9 Declaration of Conformity
- 10 Documents / Resources
 - 10.1 References
- 11 Related Posts



xunison Hub D50 Home WiFi 6 Mesh System

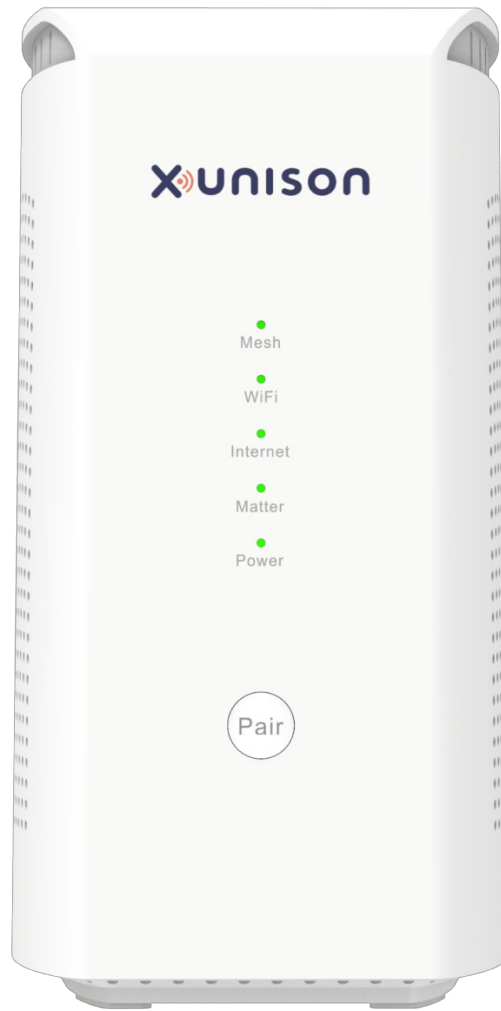

Hub D50 Home Quick Start Guide

Product Introduction

The Xunison D50 Home is a high-performance Wi-Fi 6 Mesh system that can provide speeds of up to 5400 Mbps, ensuring the ultimate user experience. It also integrates matter technology, which allows smart devices from different companies to communicate, simplifying control and creating an integrated smart home. The device supports Wi-Fi 6 and is compatible with various Wi-Fi standards, including older ones, for reliable connections with a range of devices.

Product Installation

Before installing the device, ensure that the cables are connected properly. Connect the Ethernet cable (labeled 1) from the home internet to the WAN port on the router. Then, connect the power cable (labeled 2) to the device and press the power button (labeled 3) to turn on the device.

Product Configuration

To configure the device, follow these steps:

1. Connect your mobile device to the Xunison Hub D50 Home network by entering the Wi-Fi details printed on the device sticker.
2. To install the Xunison app, you can either scan the QR code on the welcome card or download the Xunison app from Google Play store or App store.
3. After installing the app, log in with your registered account to access the features of the Xunison Hub D50 Home.

LED Indicators

The device has LED indicators for Wi-Fi, Internet, Matter, and Power status. The LED colors and symbols indicate the status of each feature.

Ports and Interfaces

The device has 3GE x LAN Ethernet ports to connect PCs, Laptops, etc. It also has a USB 2.0 port to charge devices such as smart phones and power banks. The Ethernet cable connects from Xunison 1GE x WAN Hub D50 Home router to ISP source. The device has a DC jack for power supply (12V 2A). It also has a POWER button to turn on/off the device, a PAIR button to set up the Mesh mode, and a RESET button to factory reset the device to default settings.

Safety Guidelines

Use only original and certified cables. Avoid exposing the device to water during storage, transportation, and operation. Keep the device away from heat sources and ensure adequate ventilation. Do not use any corrosive cleaner/oil to clean the device. Keep the device out of reach of children. Check the cable connections after installing the device. Place the Xunison Hub D50 Home in an appropriate location for seamless internet connectivity. Restart the device in case of any internet connectivity problems. Change your Wi-Fi passwords regularly.

Product Introduction

The Xunison D50 Home provides a high-performance Wi-Fi 6 Mesh system that can deliver speeds of up to 5400 Mbps, which ensures the ultimate user experience. The system also integrates matter technology, further enhancing its capabilities.

Wi-Fi 6 (ax)

This device supports Wi-Fi 6 and is compatible with various Wi-Fi standards, including older ones, for reliable connections with a range of devices.

Mesh

Mesh technology boosts Wi-Fi coverage, eliminates dead zones, and ensures reliable connection. It also offers easy setup with rapid one-button pairing.

Matter Technology

Technology that allows smart devices from different companies to communicate, simplifying control and creating an integrated smart home.

Product Installation

Ensure the cables are connected.

1. Connect the Ethernet cable (labeled “1”) from the home internet to the WAN port on the router.

Note: Disconnect the cable (1) to use the device in satellite mode.

2. Connect the power cable (labeled “2”) to the device.
3. Press the power button (labeled “3”) to turn on the device.

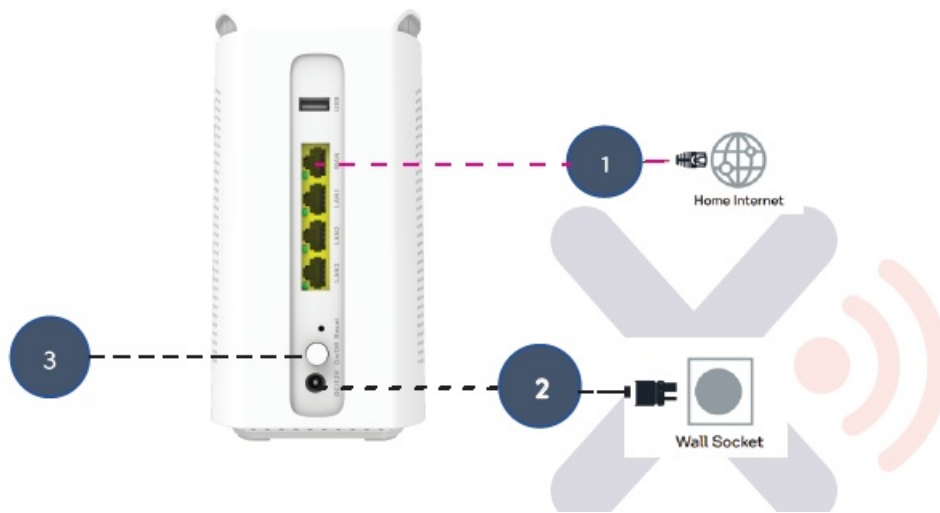

Product Configuration

- **Step 1:** Connect your mobile device to the Xunison Hub D50 Home network by entering the Wi-Fi details printed on the device sticker.
- **Step 2:** To install the Xunison app, you can either scan the QR code on the welcome card.
OR
- **Step 3:** Alternatively, you can also download the Xunison app from Google Play store or App store.

After installing the app, log in with your registered account to access the features of the Xunison Hub D50 Home.

LED Indicators

	LEDs	Color		Symbol	Status		
	Wi-Fi	Solid Green		Wi-Fi	Wi-Fi ON		
		OFF			Wi-Fi OFF		
	Internet	Solid Green		Internet	Internet Connected		
		OFF			No Internet Connection		
	Matter	Solid Green		Matter	MatterON		
		Blinking	Green		Adding the Matter device		

		OFF			MatterOFF		
		Solid Green			Powered ON		
	Power	OFF		Power	Powered OFF		
Mesh	Gateway	Solid Green		Mesh	Mesh Network Connected/Regular		
		Blinking	Green		Gateway Pairing		
	Satellite	Quick Oran	Blinking ge	Mesh	Satellite Pairing		
		Solid Green			Pairing successful		
		Blinkin	g Red		Mesh Failed		

Ports and Interfaces

	Ports	Description
	3GE x LAN	To connect PCs, Laptops, etc. via Ethernet cables.
	USB 2.0	To charge devices such as smart phone, power bank etc.
	1GE x WAN	Connect Ethernet cable from Xunison Hub D50 Home router to ISP source.
	DC jack	For power supply(12V 2A).

Button	Description
POWER	Turn the device On/Off
PAIR	Long press the PAIR button for 5-10 seconds to setup the Mesh mode.
RESET	Press the “RESET” button for 10 seconds to factory reset the device to default settings.

Safety Guidelines

General tips:

Use only original and certified cables.

Avoid exposing the device to water during storage, transportation, and operation.

Keep the device away from heat sources and ensure adequate ventilation.

Do not use any corrosive cleaner/oil to clean the device.

Keep the device out of reach of children.

Installation tips:

Check the cable connections after installing the device.

Place the Xunison Hub D50 Home in an appropriate location for seamless internet connectivity.

Restart the device in case of any internet connectivity problems.

Change your Wi-Fi passwords regularly.

Caution:

Do not disassemble the device in case of malfunction or damage. Instead, change the connections and contact technical support for assistance.

RF Parameters

For additional information

For answers to your support questions and to access the latest downloads and product services, please visit xunison.com/support. If you experience any issues with our product features or functionality, you can also submit a ticket for assistance.

Disposal Note

Note that electronic devices should not be disposed of in household waste, and at the end of its service life, the product should be disposed of in accordance with the applicable regulatory guidelines. By doing so, you fulfill your statutory obligations and contribute to the protection of the environment.

This means that the device is only permitted to operate on Wireless Access Systems, such as radio local area networks, within the frequency band of 5150-5350 MHz for indoor use only, and only within the countries of the European Union listed:

BE/BG/CZ/DK/DE/EE/IE/EL/ES/FR/HR/IT/CY/LV/LT/LU/HU/MT/NL/AT/PL/PT/RO/SI/SK/FI/SE/TR/NO/CH/IS/LI/UK(NI). The device is not permitted to operate outdoors within this frequency band or in other countries outside of the EU without the appropriate regulatory approvals.

Declaration of Conformity

Hereby, Xunison Ltd. declares that the radio equipment type D50 Home is in compliance with Directive 2014/53/EU. The full text of the EU declaration of conformity is available at the following internet address: xunison.com/support

Compliance

Any Changes or modifications not expressly approved by the party responsible for compliance could void the user’s authority to operate the equipment. This device complies with part 15 of the FCC rules. Operation is subject to the following two conditions:

- 1. This device may not cause harmful interference, and
- 2. This device must accept any interference received, including interference that may cause undesired operation.

This equipment complies with FCC radiation exposure limits set forth for an uncontrolled environment. This equipment should be installed and operated with minimum distance 20cm between the radiator and your body.

Bracken Business Park, Bracken Rd, Sandyford Business Park, Sandyford, Dublin, Ireland www.xunison.com

Documents / Resources

	xunison Hub D50 Home WiFi 6 Mesh System [pdf] User Guide D50-Home, Hub D50, Hub D50 Home WiFi 6 Mesh System, WiFi 6 Mesh System, Mesh System
---	---

References

- [🔗 Home - Xunison](#)
- [🔗 Support - Xunison](#)