

Contents [[hide](#)]

- [1 xumo RD48D Stream Box](#)
- [2 Product Information](#)
- [3 Button Description](#)
- [4 In the box](#)
- [5 FCC Statement](#)
- [6 FAQ](#)
- [7 Documents / Resources](#)
 - [7.1 References](#)



xumo RD48D Stream Box



Product Information

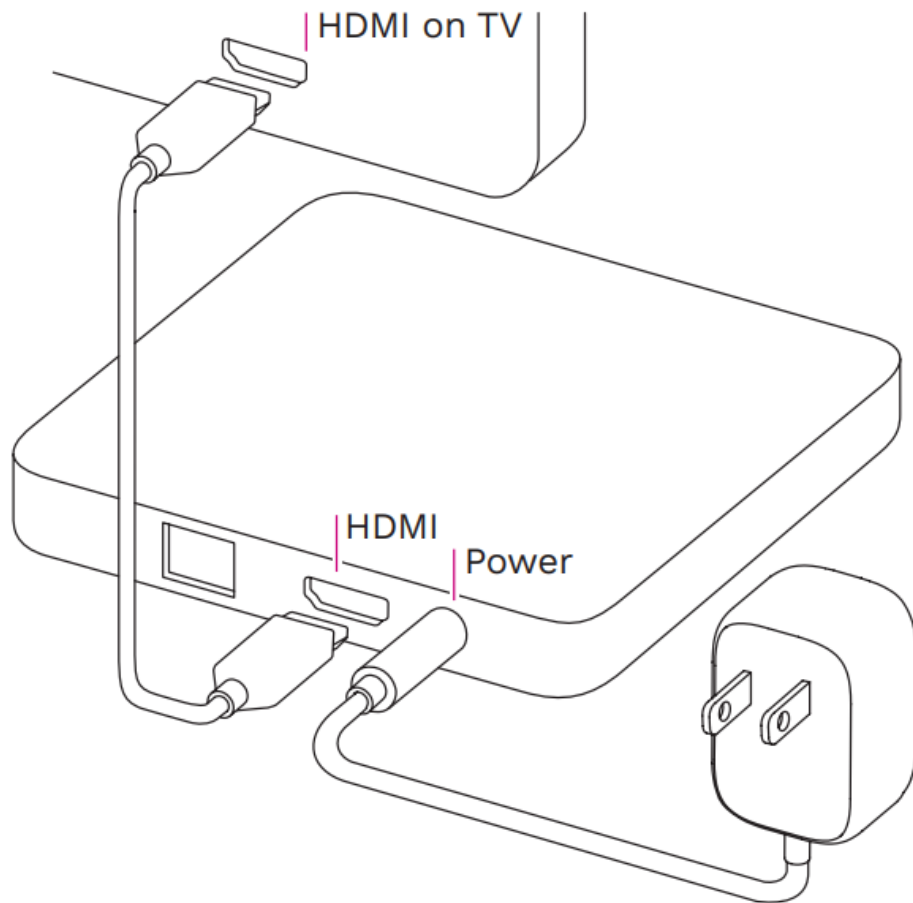

1. Connect the HDMI cable between your TV and Xumo Stream Box. Turn your TV on and select the HDMI input for the Xumo Stream Box
Be sure you have wifi with internet connection.
2. Connect the power adapter to the device and plug into a power outlet.
3. Remove the battery tab and point your remote directly toward the front of the device.
Follow onscreen instructions.
For the best results, be within 10 feet of the device.

Button Description

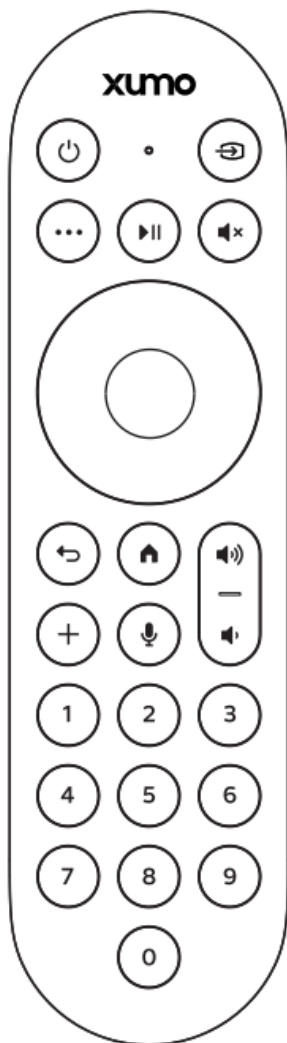

Button Name
Power / Standby
Input Select
Setup
Play/Pause
Mute
Up
Left
Select/OK
Right
Down
Back/Last
Home
Volume Up
Plus
Voice
Volume Down
1
2
3
4
5
6
7
8
9
0

Inserting, removing, and replacing remote control batteries.

CAUTION: Risk of explosion if batteries are replaced by an incorrect type. Only use AAA alkaline batteries.

1. Slide off bottom cover

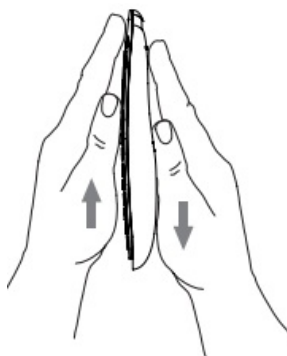

2. Insert batteries as shown, ensuring correct orientation.

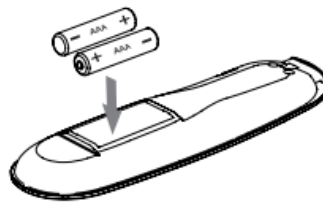

3. Replace bottom cover

In the box

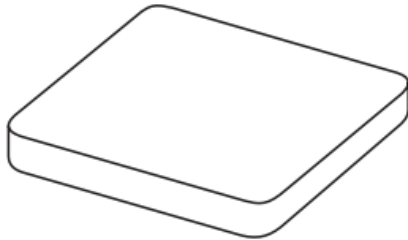

Xumo Stream Box

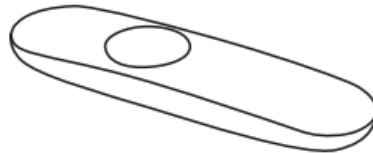

Voice Remote

2 AAA batteries installed

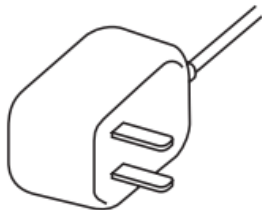

Power adapter

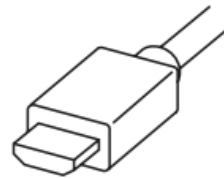

HDMI cable

Need help? xfinity.com/chat

Learn more about FCC information at xfinity.com/fcc-compliance-notice

Explore accessibility at xfinity.com/support/accessibility

FCC Statement

FCC Compliance Statement

This equipment has been tested and found to comply with the limits for a Class B digital device, pursuant to part 15 of the FCC rules. These limits are designed to provide reasonable protection against harmful interference in a residential installation. This equipment generates, uses, and can radiate radio frequency energy and, if not used in

accordance with the instructions, may cause harmful interference to radio communications. There is no guarantee that interference will not occur in a particular installation. If this equipment does cause harmful interference to radio or television reception, the user is encouraged to try to correct the interference by one or more of the following measures:

- Reorient or relocate the receiving antenna.
- Increase or decrease the separation between the equipment and receiver.
- Connect the equipment to an outlet on a circuit different from that to which the receiver is connected.
- Consult the place of purchase or an experienced remote control/TV technician for help.
- It is strongly recommended that the TV be plugged into a separate wall outlet.

The user is cautioned that changes and modifications made to this equipment without the approval of the manufacturer could void the user's authority to operate this equipment. This device complies with part 15 of the FCC rules. Operation is subject to the following two conditions:

1. This device may not cause harmful interference, and
2. this device must accept any interference received, including interference that may cause undesired operation.

FAQ

- **Q: How do I ensure the best performance of the Xumo Stream Box?**
 - A: Make sure to be within 10 feet of the device for optimal results and have a stable Wi-Fi connection.
- **Q: What type of batteries should I use for the remote control?**
 - A: Only use AAA alkaline batteries to prevent any risk of explosion.
- **Q: Where can I find more information about FCC compliance?**
 - A: Visit xfinity.com/fcc-compliance-notice for more details on FCC compliance.

Documents / Resources

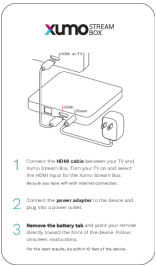

[xumo RD48D Stream Box \[pdf\]](#) Instruction Manual

RD48D, TX4RD48D, RD48D Stream Box, RD48D, Stream Box, Box

References

- [User Manual](#)

box, RD48D, RD48D Stream Box, Stream Box, TX4RD48D,

Xumo Xumo

Leave a comment

Your email address will not be published. Required fields are marked *

Comment *

Name

Email

Website

☐ Save my name, email, and website in this browser for the next time I comment.

Post Comment

Search:

e.g. whirlpool wrf535swhz

Search

[Manuals+](#) | [Upload](#) | [Deep Search](#) | [Privacy Policy](#) | [@manuals.plus](#) | [YouTube](#)

This website is an independent publication and is neither affiliated with nor endorsed by any of the trademark owners. The "Bluetooth®" word mark and logos are registered trademarks owned by Bluetooth SIG, Inc. The "Wi-Fi®" word mark and logos are registered trademarks owned by the Wi-Fi Alliance. Any use of these marks on this website does not imply any affiliation with or endorsement.