



XTREAM Connecting to your Wireless Network Installation Guide

[Home](#) » [XTREAM](#) » XTREAM Connecting to your Wireless Network Installation Guide 

XTREAM Connecting to your Wireless Network



Contents

- [1 Installation and Activation Instructions](#)
- [2 iOS \(iPhone/iPad\)](#)
- [3 Android](#)
- [4 Mac OS X](#)
- [5 Windows 8](#)
- [6 Windows 10](#)
- [7 Documents / Resources](#)
- [8 Related Posts](#)

Installation and Activation Instructions

Step 1

You must configure your wireless network using the instructions found in the enclosed Installation and **Activation Guide** before connecting your devices.

Step 2

Follow the instructions below to turn on the wireless feature on your computers and/or devices

COMPUTER // LAPTOP



Confirm the wireless feature is set to ON. Often this is accomplished through your computer's settings. Some computers and laptops are equipped with a key or switch to activate the wireless feature. If using a keyboard, hold down the Function Key (FN) and press the key with the wireless icon.

TABLET // SMARTPHONE



Tap the settings icon, then tap Wi-Fi from the list and verify the toggle is set to ON.

Step 3

Proceed to the instructions that match your operating system to finish your wireless connection set-up.



iOS (iPhone/iPad)

1. Tap the **Settings** icon on the Home screen.



2. Tap **Wi-Fi** from the list



3. Tap the name of your new wireless network from the list.

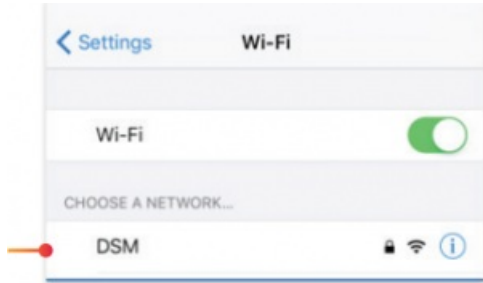

4. Enter the password you created for the network. Tap **Join**.



5. Within a few moments your device should connect to your new modem and you will be online.



Android

1. Tap the **Settings** icon on the Home screen.



2. Tap **Wi-Fi** from the list.

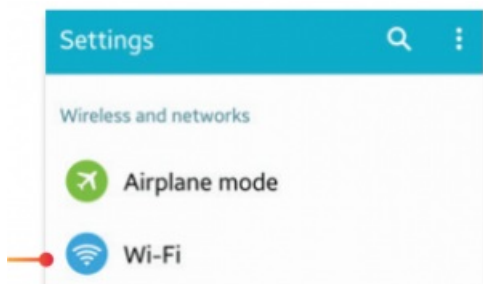

3. Tap the name of your new wireless network from the list.



4. Enter the password you created for the network. Tap **Connect**.

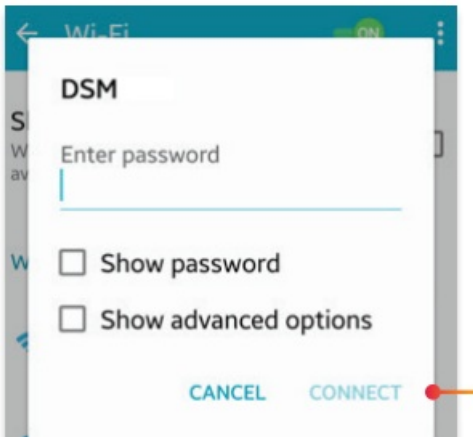

5. Within a few moments your device should connect to your new modem and you will be online.



Mac OS X

1. Click on the **Wireless Icon** in the Finder menu bar. Typically, it is displayed in the upper right-hand corner of the screen.



2. When the drop-down menu appears, a list of available networks should appear. Find the name of your new wireless network in the list and click on it to select.

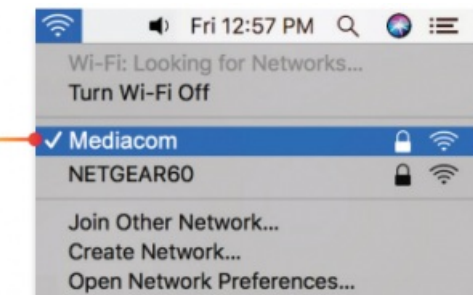

3. Enter the password you created when you set up your new modem. Click **Join**.



4. Within a few moments your computer should connect to your new modem and you will be online.



Windows 8

1. Place your cursor in the lower right-hand corner of the screen. This will make the charms bar appear.
2. Click on the **Settings charm** to open Settings.



3. Click the **Network** icon.

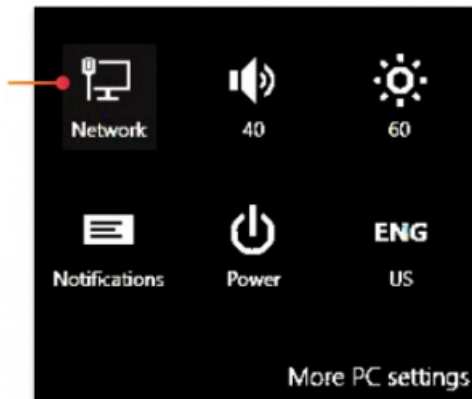

4. Find the name of your new wireless network in the list, and click to highlight it. Click **Connect**.

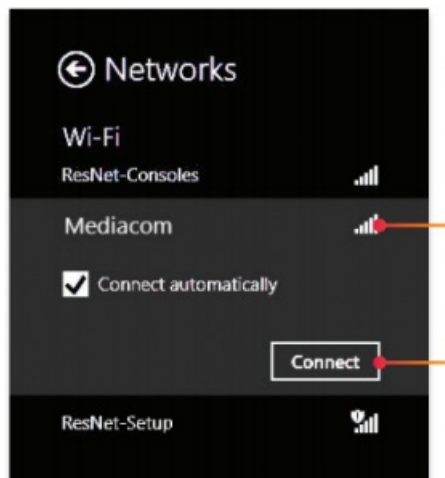

5. Enter the password you used to set up your new modem. Click **OK**.
6. Within a few moments, your computer should connect to your new modem and you will be online.



Windows 10

1. Click on the Wireless icon in the taskbar.
2. Click the **Network Settings** tile



3. Find the name of your new wireless network in the list, and click to highlight it. Click **Connect**.

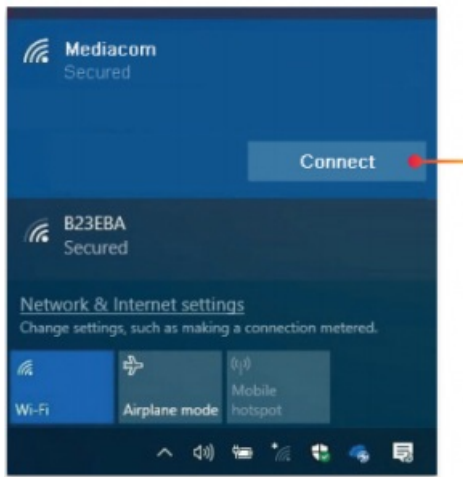

4. Enter the password you used to set up your new modem. Click **Next**.

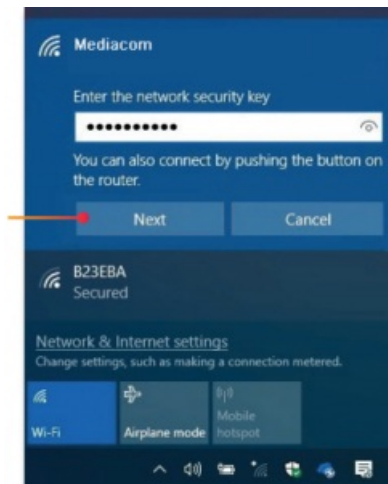

5. Within a few moments, your computer should connect to your new modem and you will be online.



Total Care Customer Support

Customer Support Website
support.mediacomcable.com
[@mediacomsupport](https://www.youtube.com/mediacomcable)
[youtube.com/mediacomcable](https://www.youtube.com/mediacomcable)
 1-855-633-4226

Total Care text support- text 66554

Total Care Text Support- Text 66554 To enroll in Total Care Text Messaging, text MEDIACOM to 66554 from your mobile device. Molli will ask you a few questions and sign you up. Once you're enrolled, make sure to add 66554 as a contact and text her any time you have a question.



MediacomConnect MobileCare App

Available now for your iPhone, iPad and Android device at the Google Play® or iTunes App Store®.

Documents / Resources



[XTREAM Connecting to your Wireless Network](#) [pdf] Installation Guide
Connecting to your Wireless Network