



XTOOL KS-1 Smart Key Emulator for All Keys Lost User Manual

[Home](#) » [XTOOL](#) » XTOOL KS-1 Smart Key Emulator for All Keys Lost User Manual 



USER MANUAL OF KS-1 TOYOTA SMART KEY SIMULATOR



SHENZHEN XTOOLTECH CO., LTD



STEP BY STEP
PROCESS

Contents

- 1 Smart Key Emulator for All Keys Lost
- 2 Documents / Resources
 - 2.1 References
- 3 Related Posts

Smart Key Emulator for All Keys Lost



www.xtooltech.com



SHENZHEN XTOOLTECH CO., LTD

1. Select: Immobilization- TOYOTA- All smart keys lost



2. Select "Read immobilizer data" to read vehicle immobilizer data

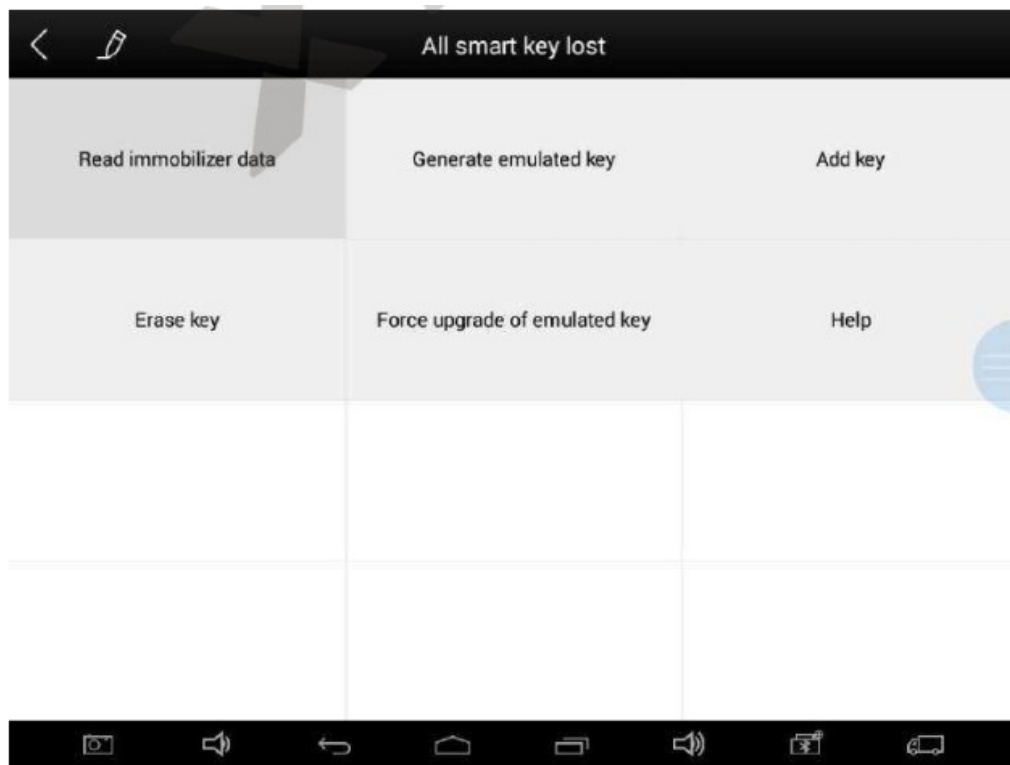

3. According to the prompt, please press the car's START button to read the data.

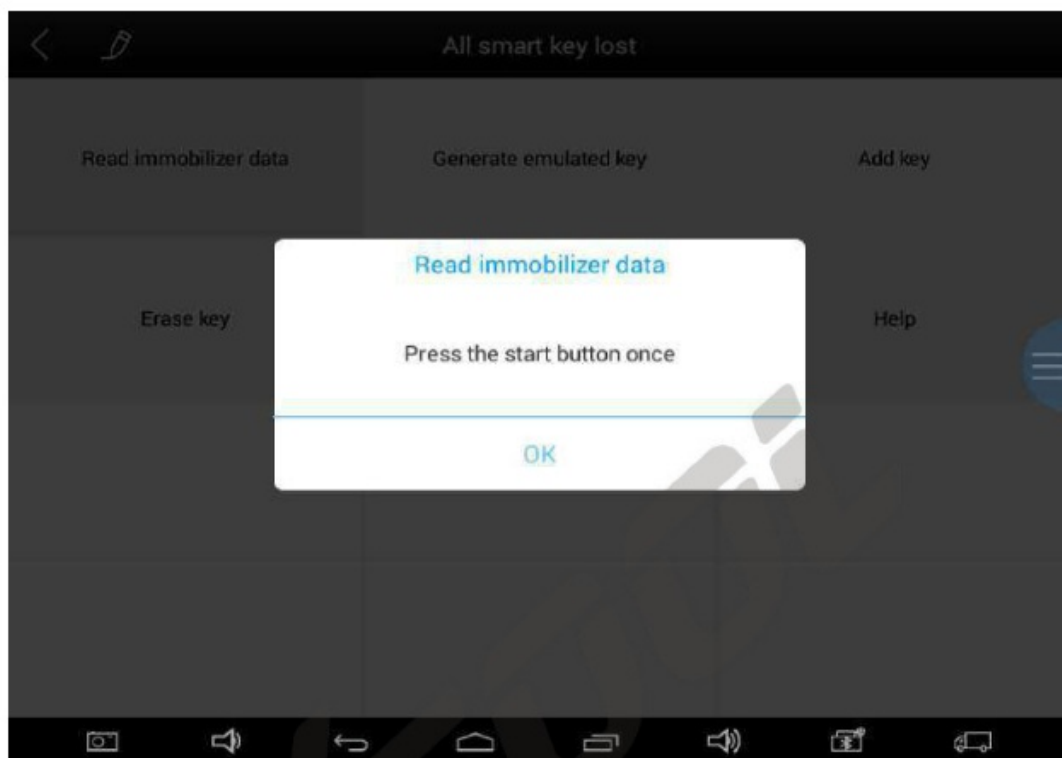

It will show the completion ratio of the read data as below:

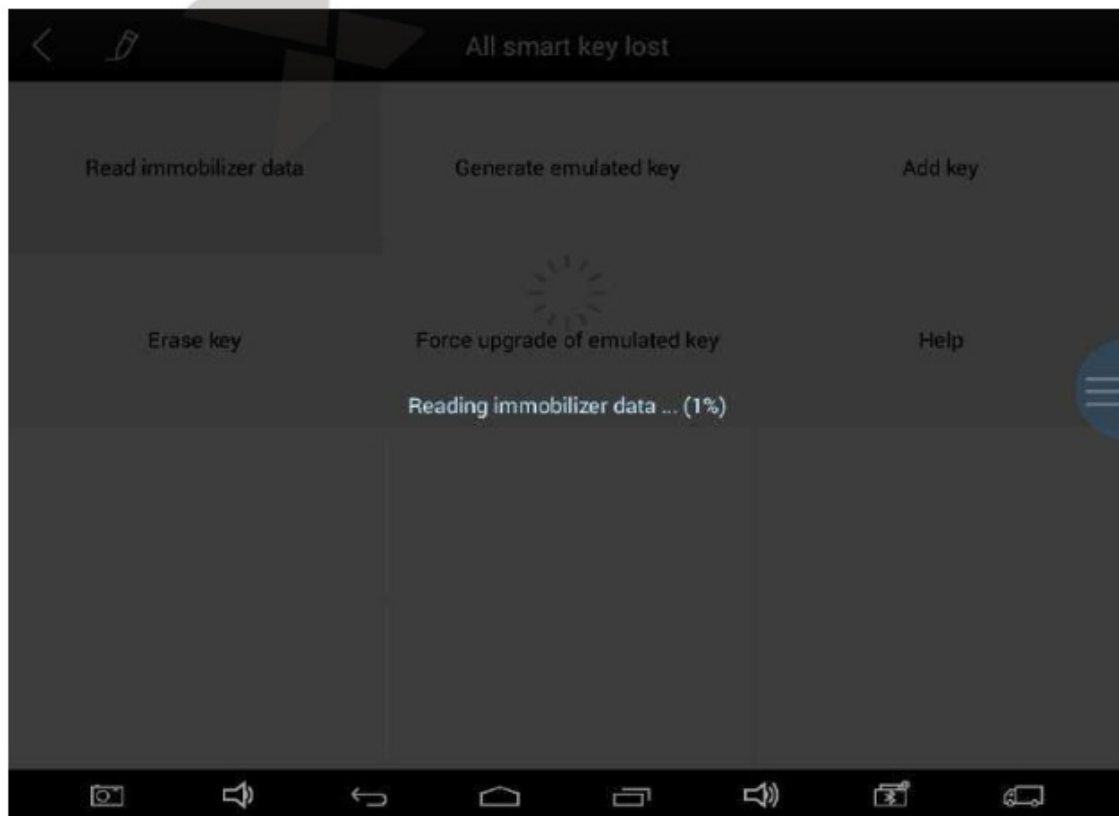

4. After reading the data, please save the data and name the saved file



After saving, the saved information will be shown as below:

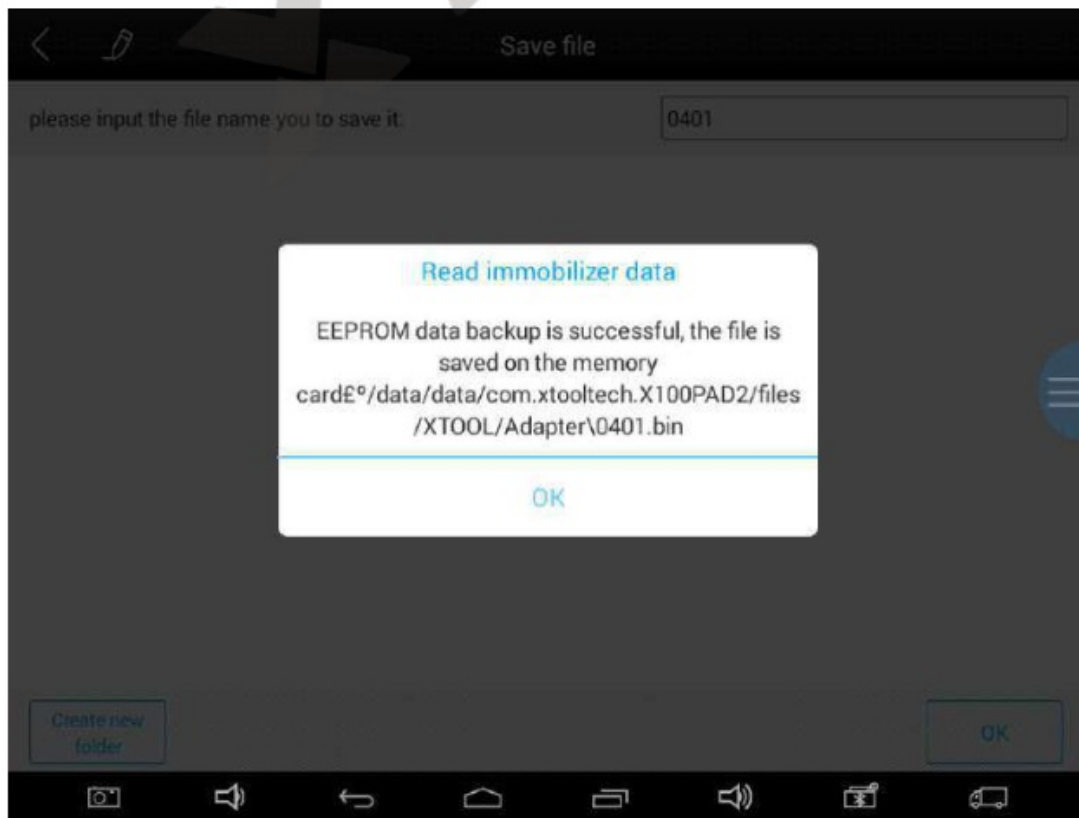

5. When general ingKS-1Toyotasimulator key, please connect KC100 orKC501first(Please noticed the device ust be connected to the network). Click the “Generate emulated key” button.

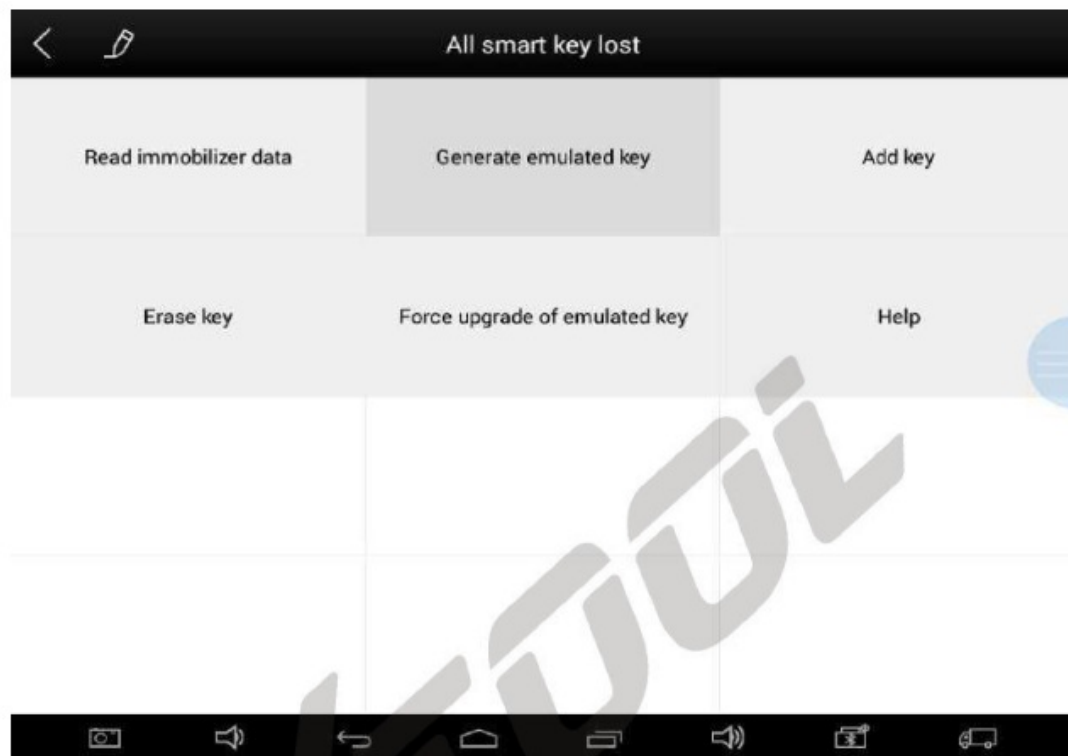

6. And then click the OK button to select the file saved in the previous step.

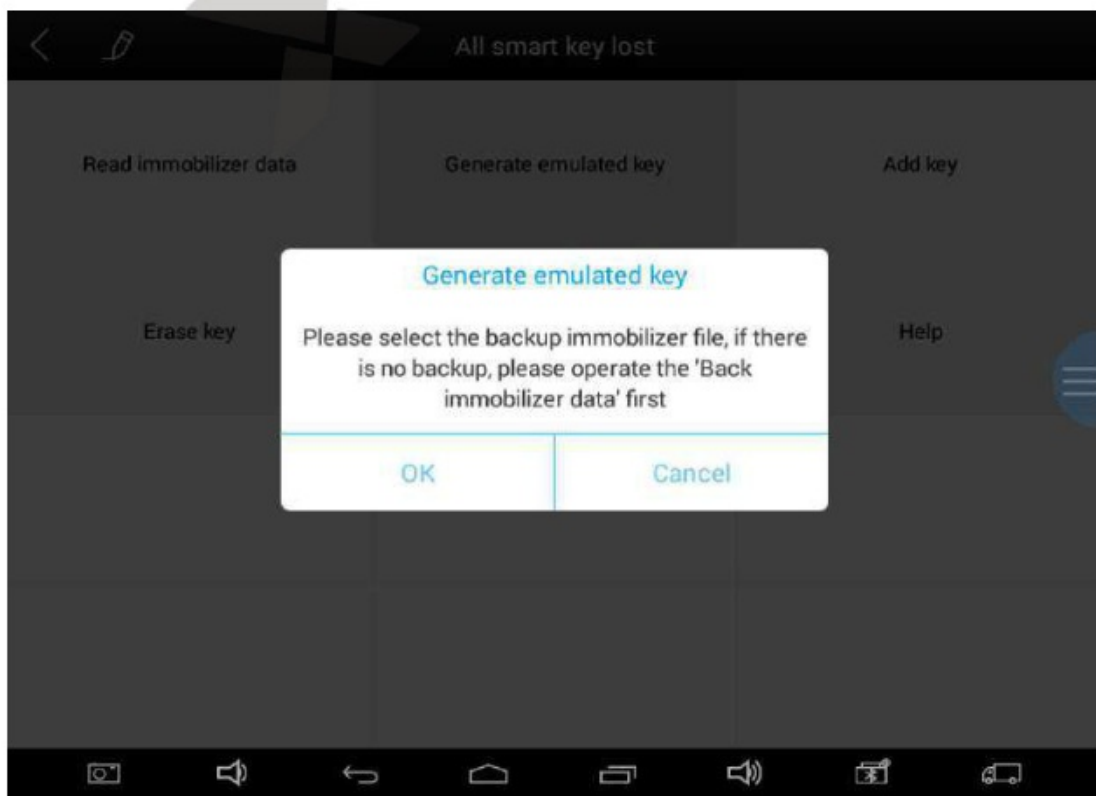

7. After the document selection is completed, the screen will display the current key type, please click Yes or No button to confirm whether it is correct.

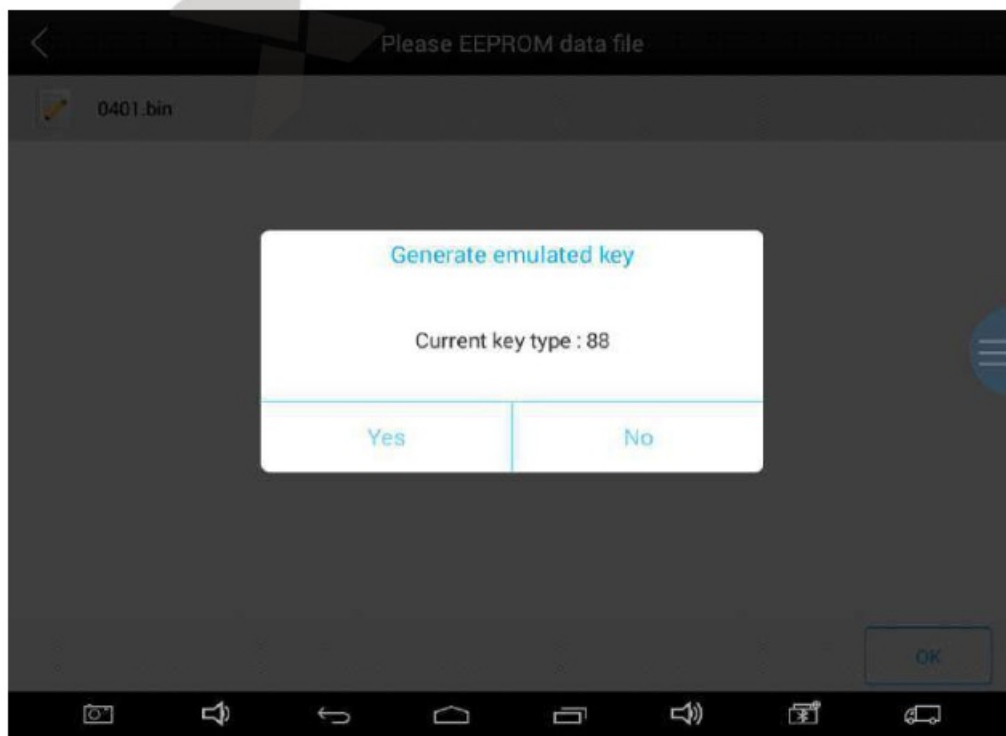

8. After confirmation, the system will upload data to the Xtool server for data verification and calculation.

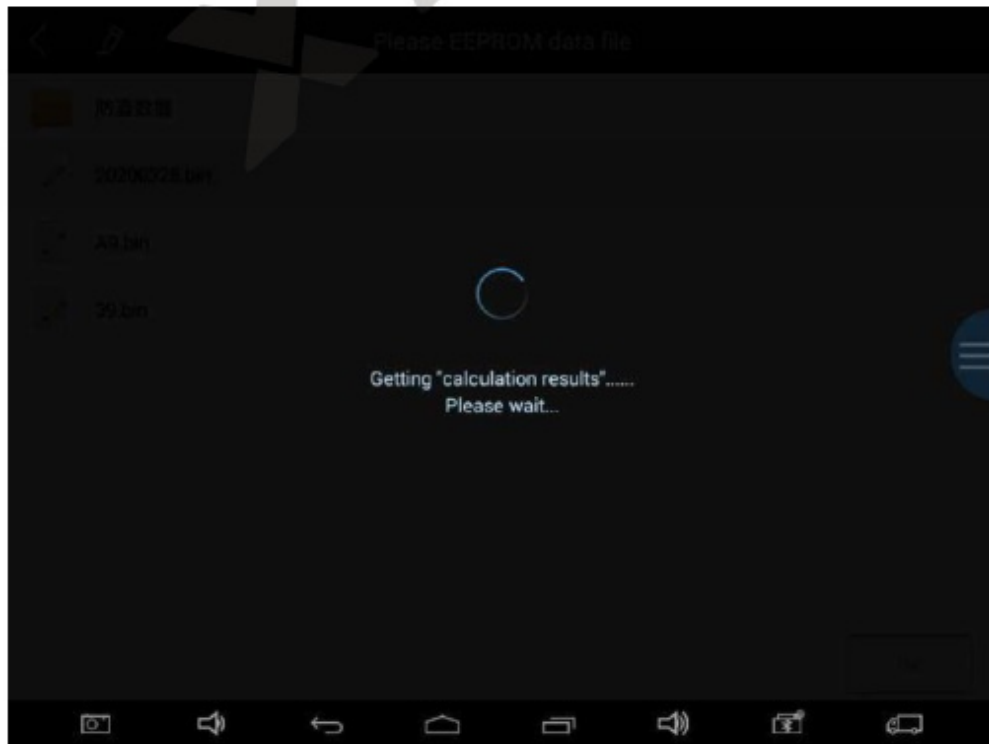
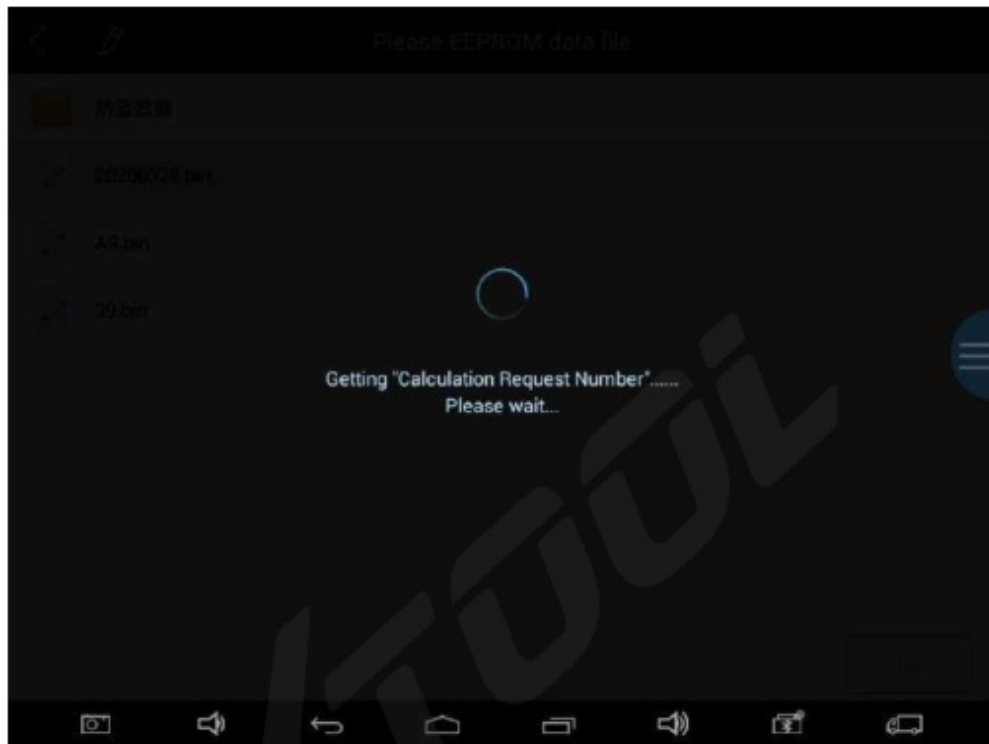

9. After verification, it will activate KC100 or KC501.

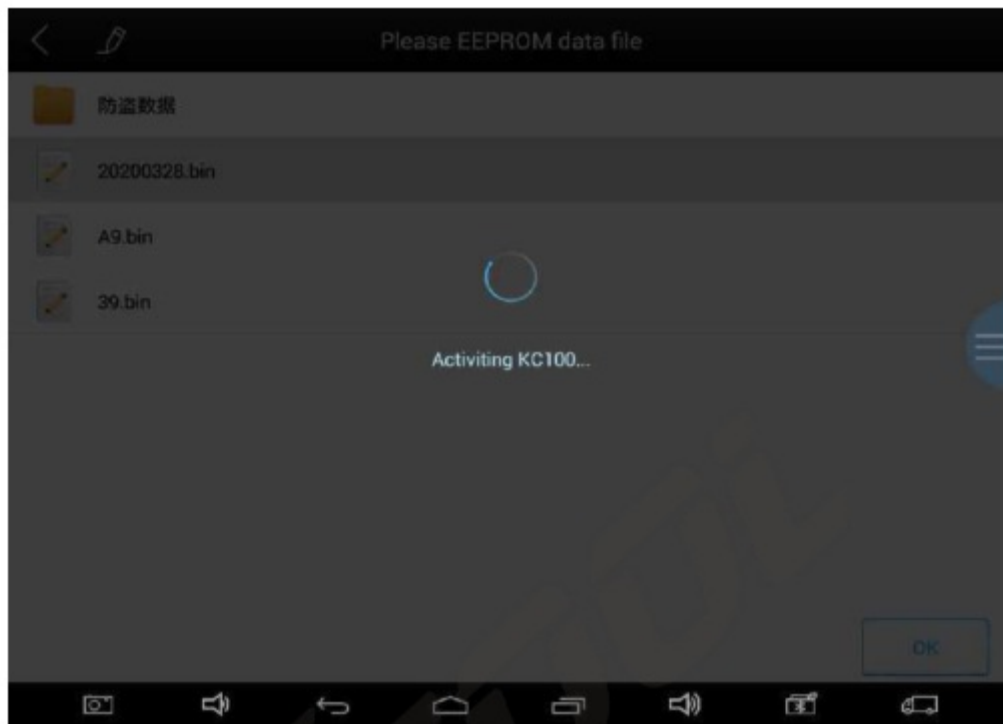

10. Please put the KS-1 simulator card into the KC100's or KC501's slot and follow the instructions to complete the next operation.

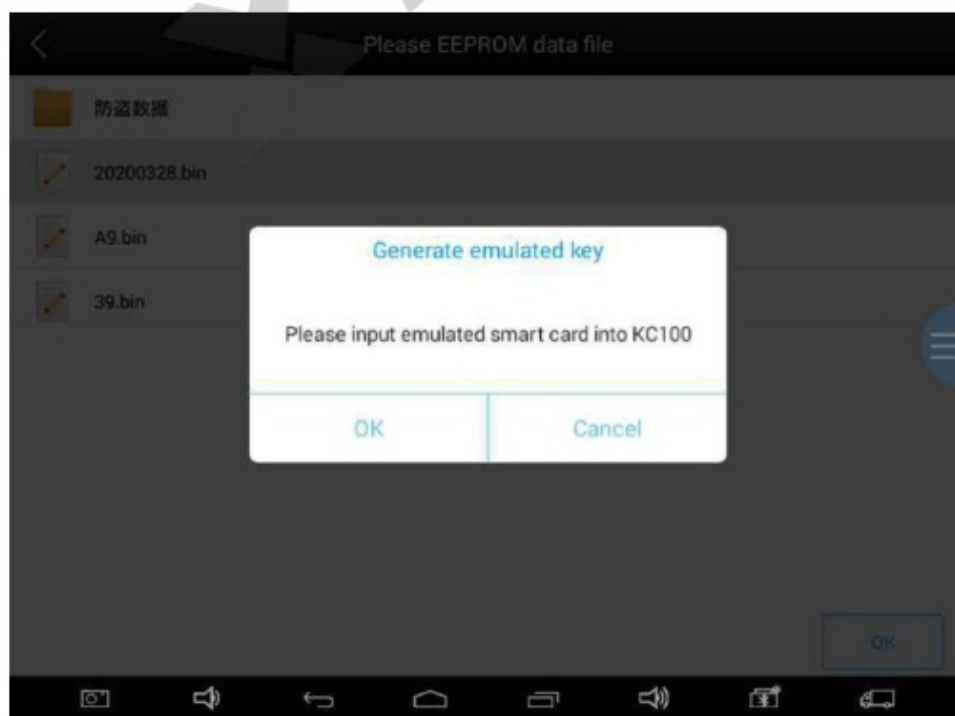

11. Please click Yes to the next step. (This operation will make the device bound with KS-1 Toyota simulator card)

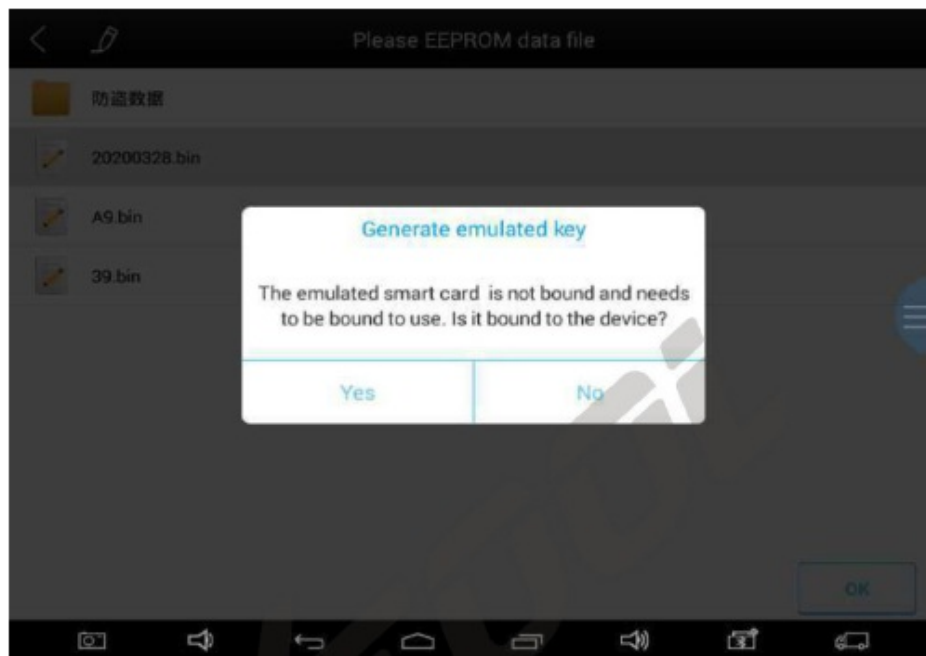

12. Binding succeed.

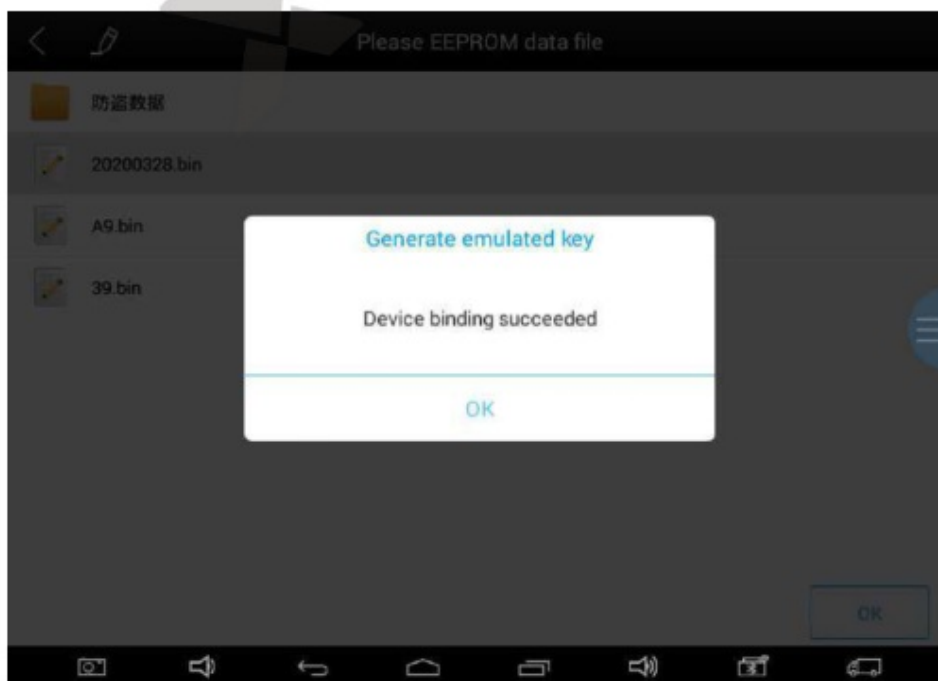

13. After the binding is successful, the simulator key is generated.



14. Generated successfully.

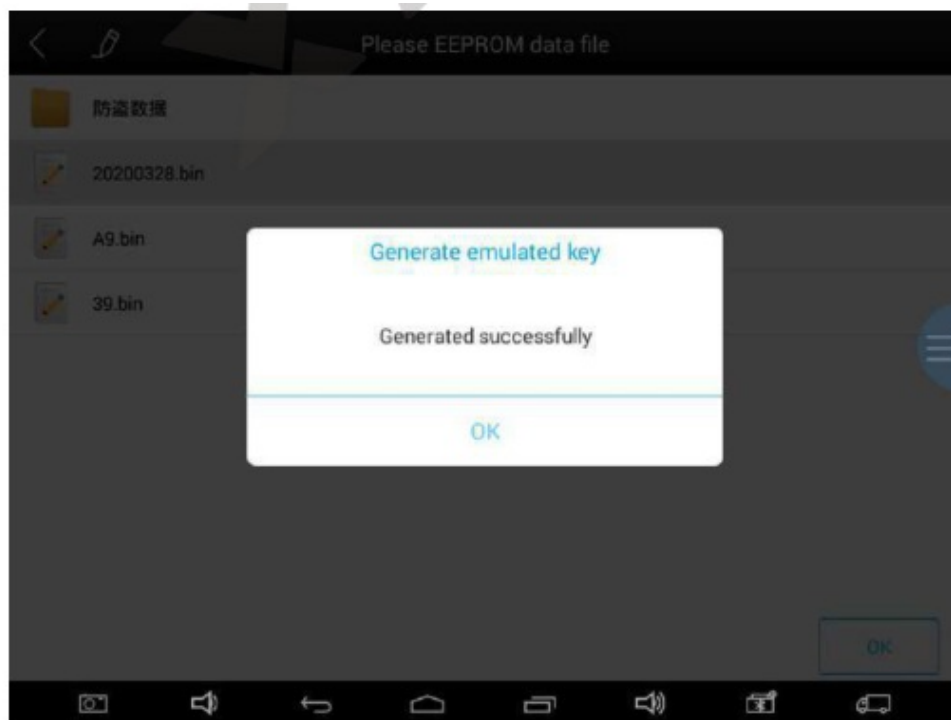

15. After generating the simulation key successfully, select “Add key” to do add keys.

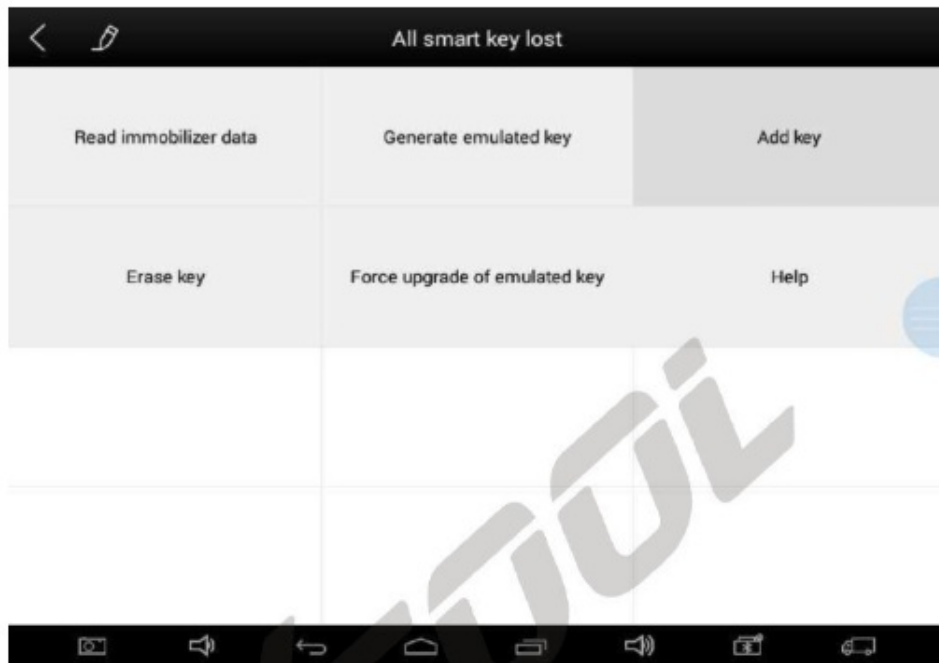

16. Please follow prompts for relevant operations.

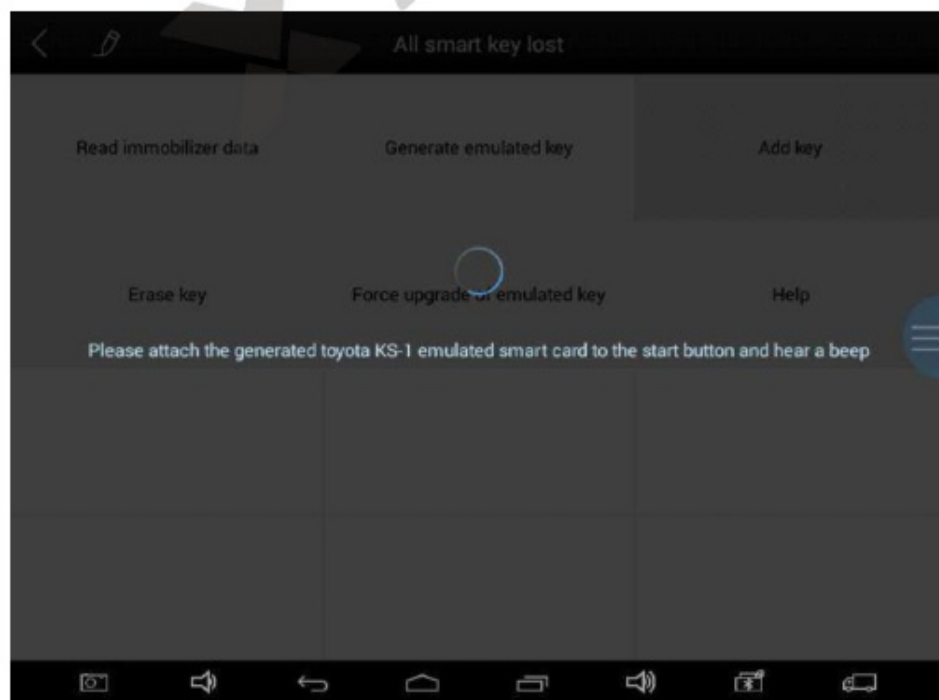

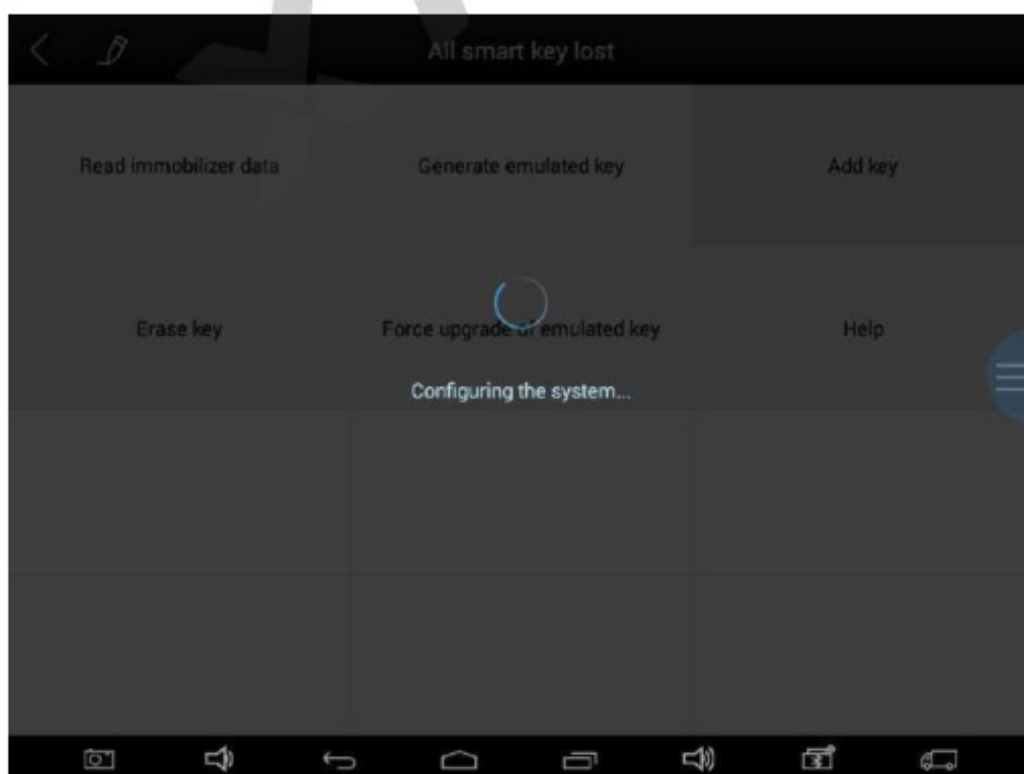
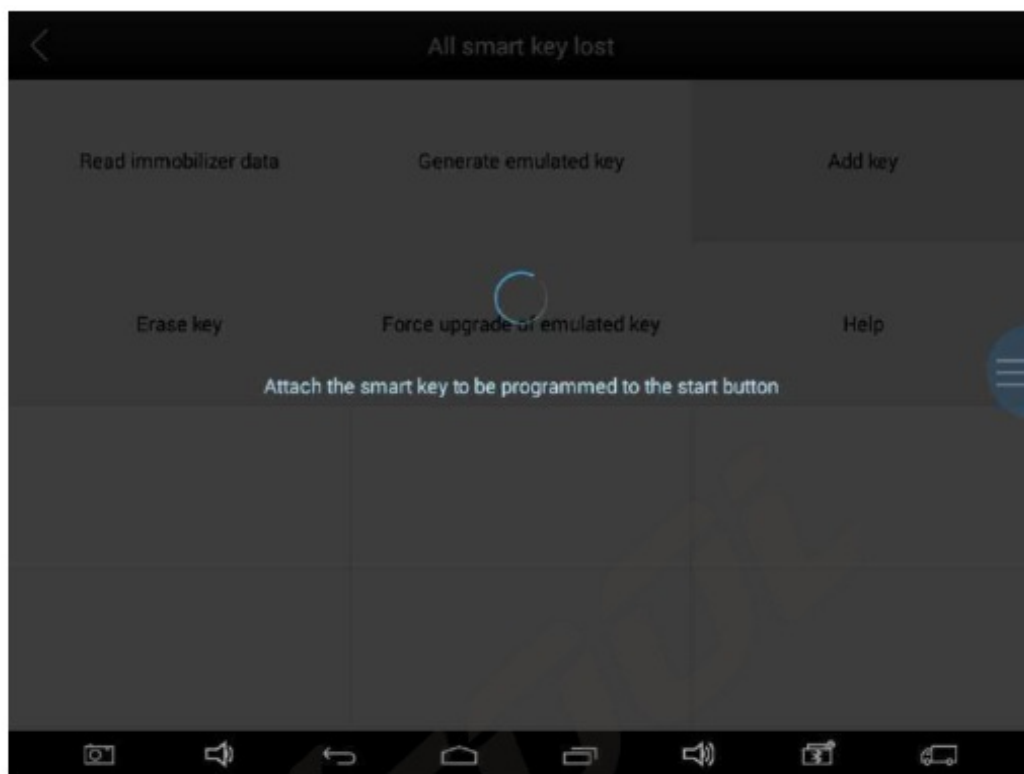

17. The device will prompt Programming success.

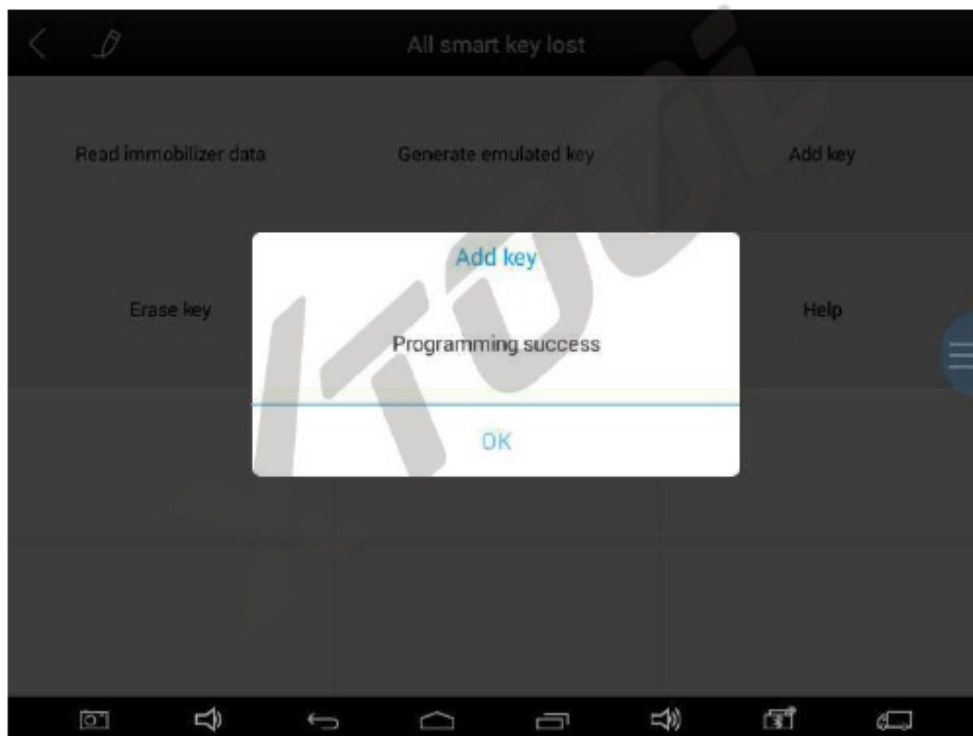

XTOOL



USER MANUAL OF
KS-1 TOYOTA SMART KEY
SIMULATOR
STEP BY STEP
PROCESS



SHENZHEN XTOOLTECH CO.LTD



www.xtooltech.com

Documents / Resources



[XTOOL KS-1 Smart Key Emulator for All Keys Lost](#) [pdf] User Manual
KS-1, Smart Key Emulator for All Keys Lost, Smart Key Emulator, Key Emulator, KS-1, Emulator

References

-  [XTOOL KS-1 Smart Key Emulator for All Keys Lost](#)