



# XtendLan XL-FLS1315 Optical Laser Source User Guide

[Home](#) » [XtendLan](#) » XtendLan XL-FLS1315 Optical Laser Source User Guide 

## Contents

- [1 XtendLan XL-FLS1315 Optical Laser Source User Guide](#)
- [2 WARNING](#)
- [3 NOTE](#)
- [4 Precautions for Use](#)
- [5 Avoiding condensation problems](#)
- [6 Storage](#)
- [7 Check the accessories Standard Edition](#)
- [8 Description](#)
- [9 Installing the battery](#)
- [10 On/Off and Permanent On](#)
- [11 Select Wavelength](#)
- [12 Wavelength identification](#)
- [13 Power Indicator](#)
- [14 Charge](#)
- [15 Detail parameters](#)
- [16 Read More About This Manual & Download PDF:](#)
- [17 Documents / Resources](#)
- [18 Related Posts](#)

## XtendLan XL-FLS1315 Optical Laser Source User Guide



### WARNING

<p>VISIBLE LASER RADIATION AVOID EYE OR SKIN EXPOSURE TO DIRECT OR SCATTERED RADIATION</p> <p>SEMICONDUCTOR LASER Wavelength:635-650nm</p>	<p>INVISIBLE LASER RADIATION AVOID EYE OR SKIN EXPOSURE TO DIRECT OR SCATTERED RADIATION</p> <p>SEMICONDUCTOR LASER Wavelength:800-1700nm CLASS II LASER PRODUCT</p>
--	--

You are cautioned that changes or modifications not expressly approved in this document could void your authority to operate this equipment.

To reduce the risk of fire or electric shock, do not expose this apparatus to rain or moisture.

To avoid electrical shock, do not open the cabinet. Refer servicing to qualified personnel only.

### NOTE

As the laser is harmful to the eyes, do not attempt to disassemble the cabinet.

### Precautions for Use

Use batteries

At the same time, can not use different style or different capacitance batteries. And only charge the rechargeable batteries.

### Avoiding condensation problems

As much as possible, avoid sudden temperature changes. Do not attempt to use the drive immediately after moving it from a cold to a warm location, to raising the room temperature suddenly, as condensation may form within the drive. If the temperature changes suddenly while using the drive, stop using it and take out batteries for at least an hour.

## Storage

When long time no use, must take out the batteries to avoid destroying the device!

## Check the accessories Standard Edition

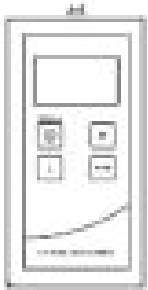

Host

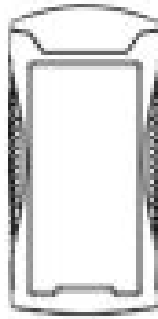

Rubber Jacket



Soft Bag

## Description

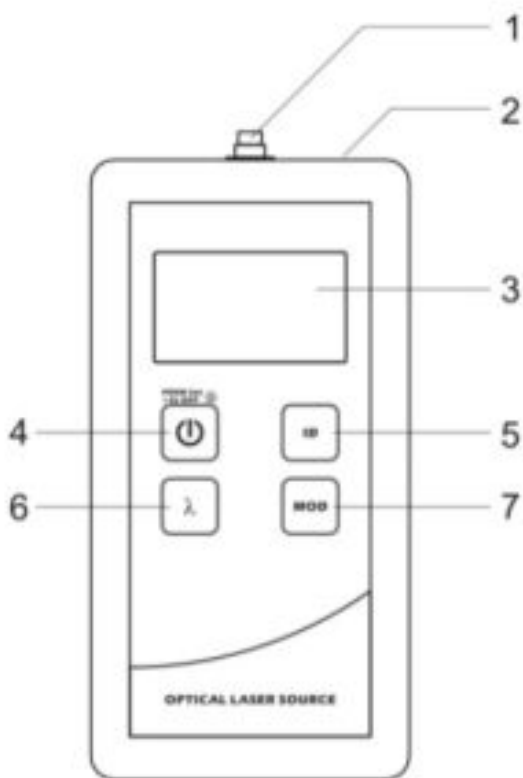

1. Laser Source Connector
2. AC/DC Socket
3. LCD
4. Power Button
5. Wavelength ID
6. Output wavelength switch button
7. Load modulation

## Installing the battery

1. Pull the battery cover



2. Installing the battery



3. Push the battery cover

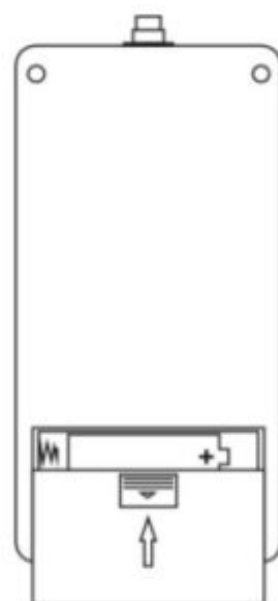

4. Complete



## On/Off and Permanent On

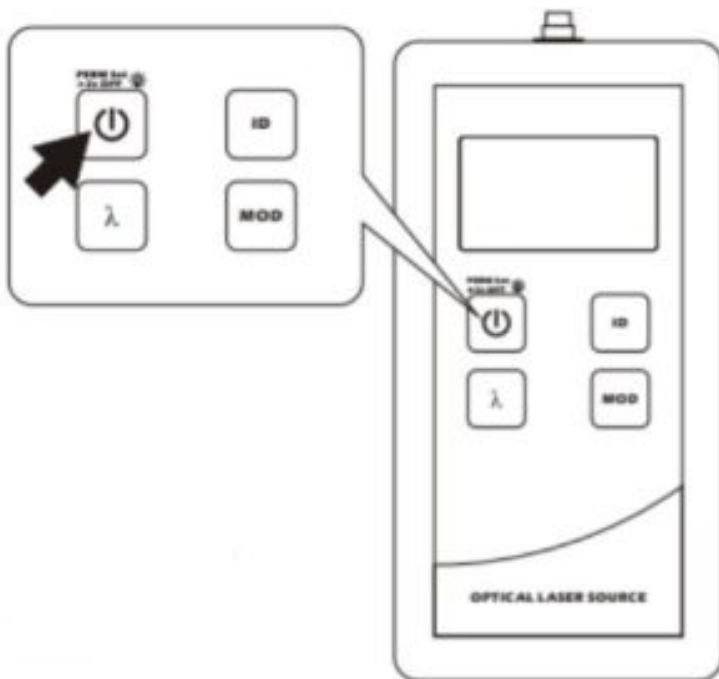

Press  button to turn on the meter .

Press button again for two seconds or more to turn off the meter.

This meter has power-saving function, if ten minutes without any operation, the device will automatically shut down.





If you need to disable this function, only need to press the  button for 2 seconds when you turn on the meter till it displays 'PERM'.

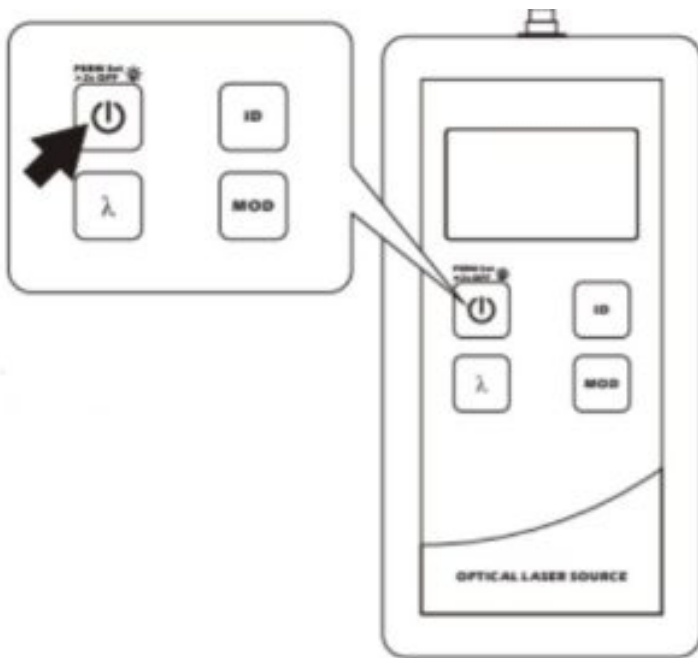

When the meter is power on , short press the  button, you can control the backlight function on or off. The backlight function is used when you want to use the meter at night or darker occasions.

## Select Wavelength



After pressing  button, you can select the required out put wavelengths. Details refer to the parameters table. The power meter or other measuring equipment should select correspond wavelength of laser source. After pressing button, you can load a modulation current output laser. This instrument has three modulation for selection: 270Hz, 1 kHz, 2 kHz.

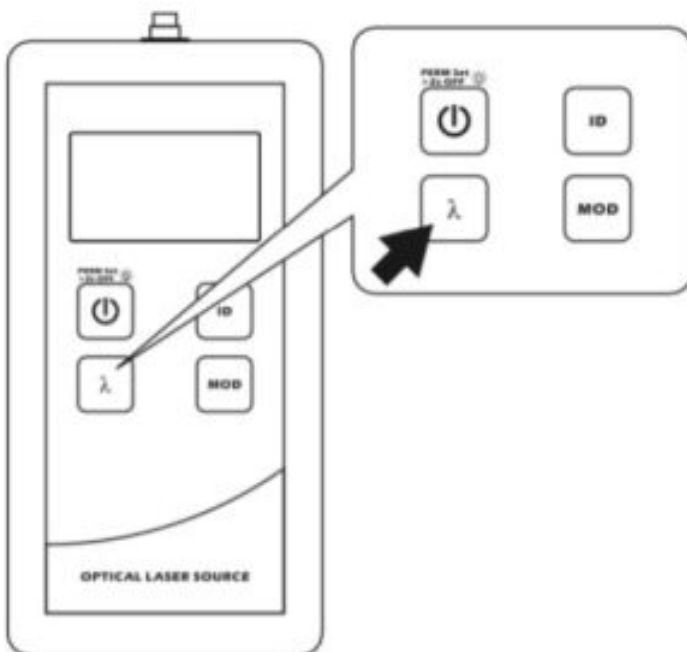

## Wavelength identification

Press Button  the laser source will output with wavelength ID and LCD will display 'Id'. and if works with the paired power meter with WAVE ID function. the optical power meter will change to the same wavelength automatically.

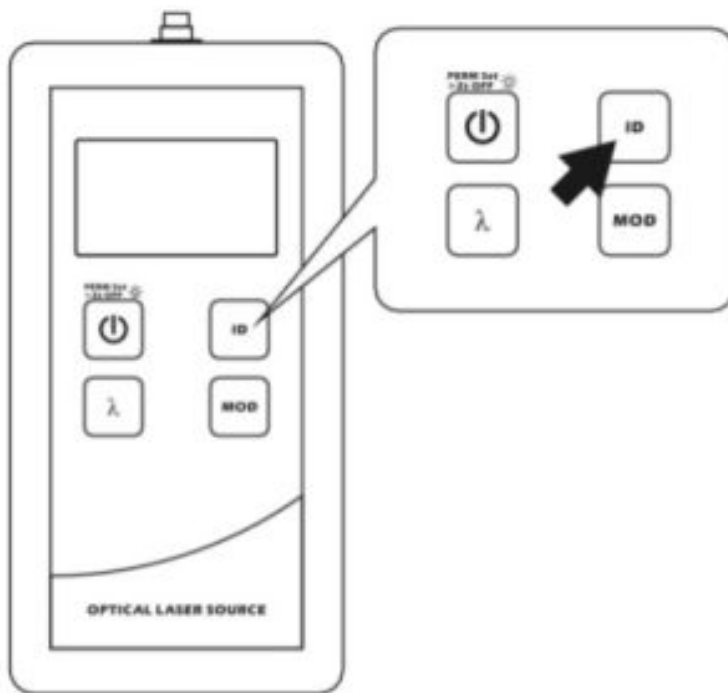

## Power Indicator

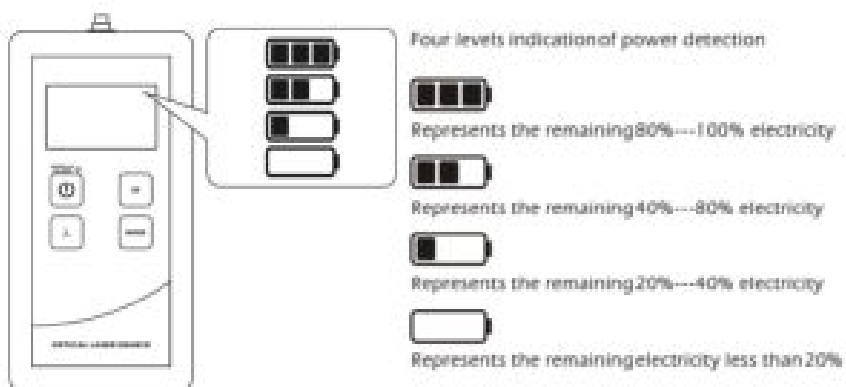

## Charge

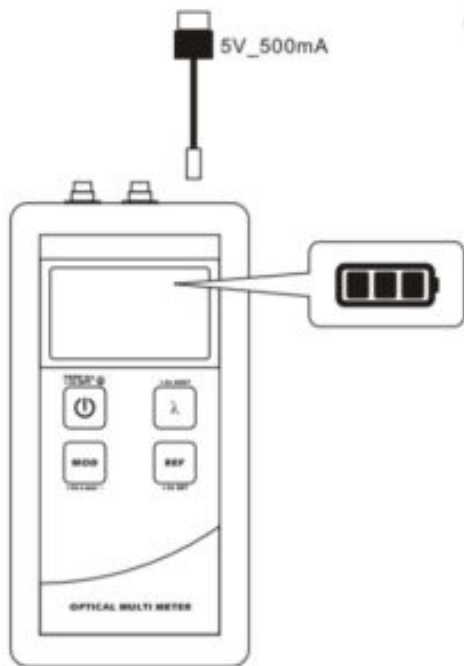

The instrument has a charging function. When use rechargeable batteries and a low battery indication shows on the instrument, you should promptly shut down it and recharge. Long time under voltage will shorten the lifetime of the rechargeable battery.

Connect the AC adapter to the device correctly, it can charge automatically. Besides, computer USB port can also be used for charging. The battery remaining indicator keeps flashing during charging. It will stop when the charging is finished. The battery has finished the fast recharge and can be used directly. If you do not stop recharging at this time, the instrument will continue the trickle charge state, using small current to supply natural discharge. But this process is not more than 48 hours.

The instrument can still be used while charging. But do not plug in the AC adapter when it isn't rechargeable battery inside, or it will cause a high temperature and combustion, even explosion.

## Detail parameters



<b>Output length }nm]</b>	1310 / 1550
<b>Output power</b>	> -6dBm
<b>Laser type</b>	Fabry-Perot Laser Diode
<b>Optical adapter</b>	FC/PC
<b>Modulation wave</b>	270Hz / 1kHz / 2kHz
<b>Auto off</b>	Yes
<b>Battery type</b>	2x AA
<b>Battery lifetime</b>	> 40 hours
<b>Waterproof</b>	Can prevent small splash
<b>Size (h, w, d)mm</b>	140 x 62 32
<b>Weight</b>	174g

***Read More About This Manual & Download PDF:***

## **Documents / Resources**

 <p><b>XtendLan<sup>®</sup></b> <b>XL-FLS1315</b> <small>1550nm Fabry-Perot Laser Source</small></p>	<p><a href="#">XtendLan XL-FLS1315 Optical Laser Source</a> [pdf] User Guide</p> <p>XL-FLS1315, Optical Laser Source</p>
---	--