



XRocker Mesh-Tek Gaming TV Unit Installation Guide

[Home](#) » [XRocker](#) » XRocker Mesh-Tek Gaming TV Unit Installation Guide 

XRocker®

MESH-TEK
BY XRocker
GAMING TV UNIT
BLACK/RED
Installation Guide

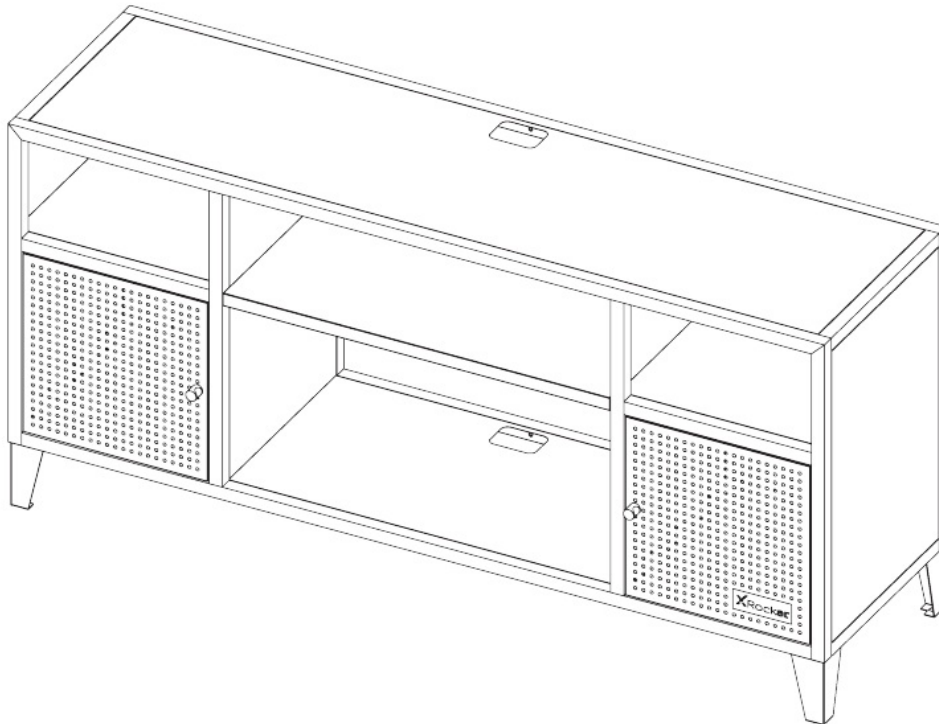

Contents

- [1 Mesh-Tek Gaming TV Unit](#)
- [2 A Guide to Wall Mounting & Fixings](#)
- [3 TYPES OF WALLS](#)
- [4 Care & Maintenance](#)
- [5 Documents / Resources](#)
- [6 Related Posts](#)

Mesh-Tek Gaming TV Unit



WARNING PLEASE READ BEFORE CONTINUING

ALL HOME FITTINGS ARE PERFORMED AT THE USERS OWN RISK.
PLEASE CONSULT PROFESSIONAL ASSISTANCE IF NEEDED.

WARNING! Serious or fatal crushing injuries can occur from furniture tip over. To prevent tip over this furniture must be used with the wall attachment device(s) provided. Screw(s) and plug(s) for the wall are not included. Do not climb or allow others to climb on the furniture once assembled. Use screw(s) and plug(s) suitable for your walls. If you are uncertain, seek professional advice. Read and follow each step of the instruction carefully. Please ensure components of the furniture are handled with care. Do not bend any parts. Improper handling may result in an unstable construction.

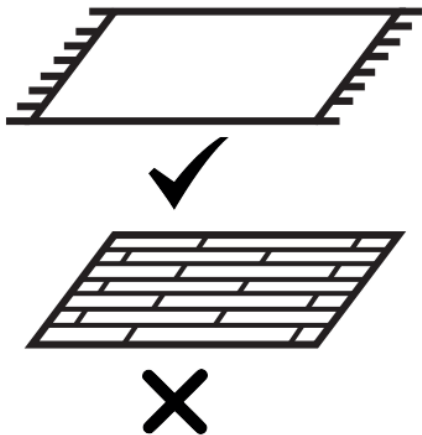

PLACE FURNITURE ON SOFT
SURFACE DURING ASSEMBLY

NEED HELP?



CONTACT

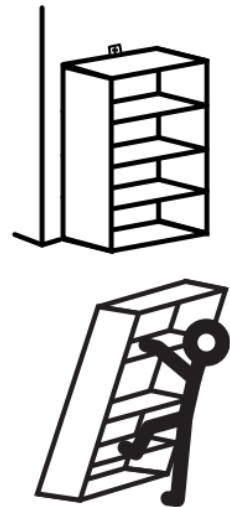

DO NOT CLIMB ON FURNITURE

www.xrockerkuk.com/page.support

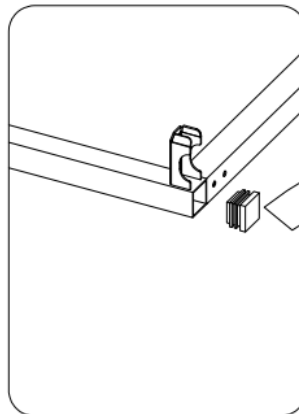
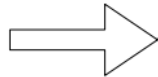
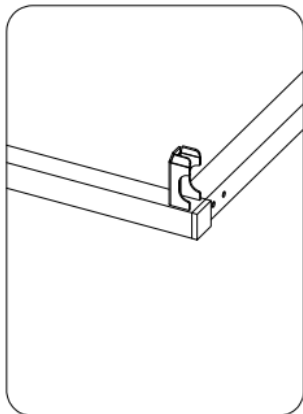
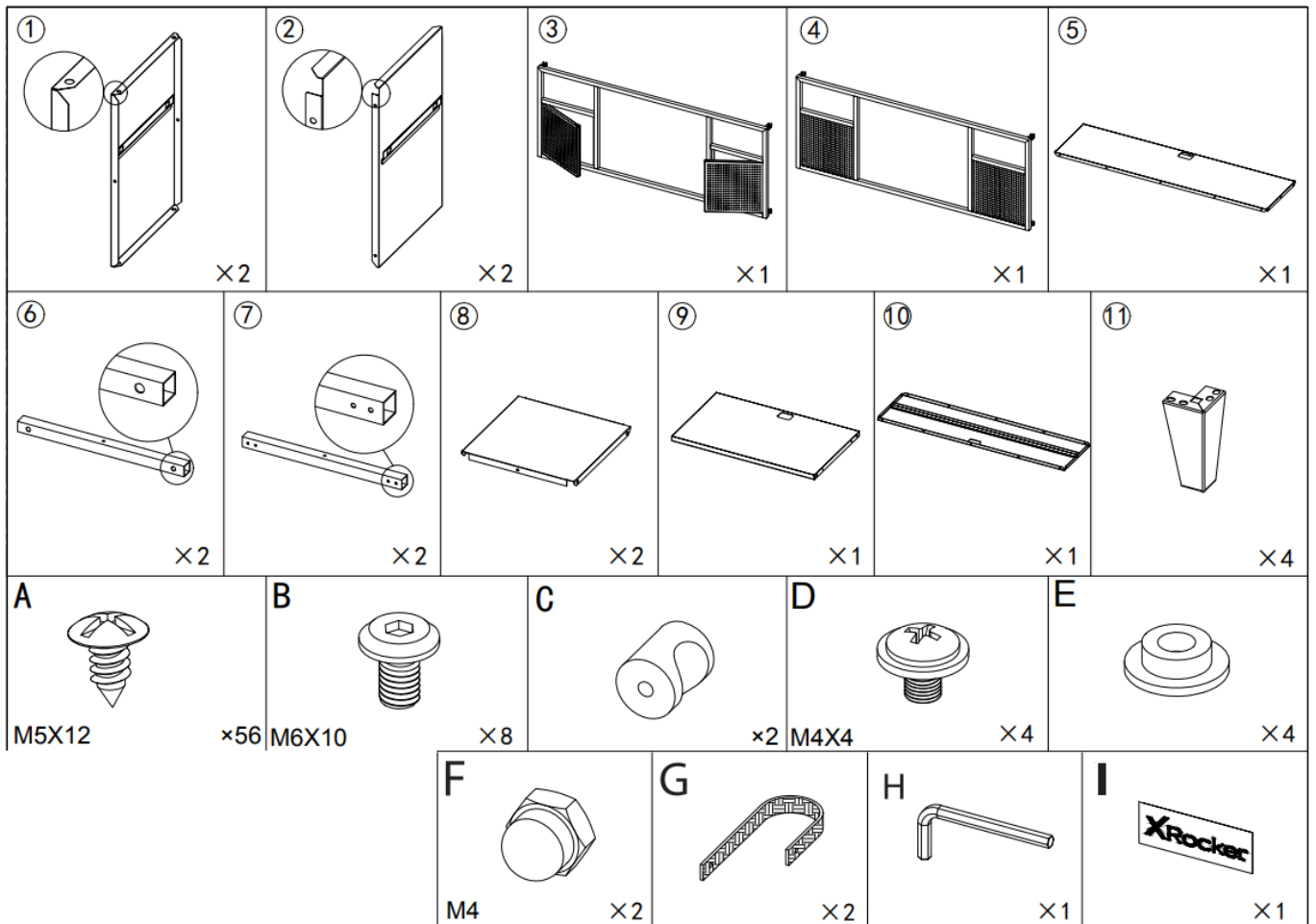

Retain plastic caps for future use or product transportation

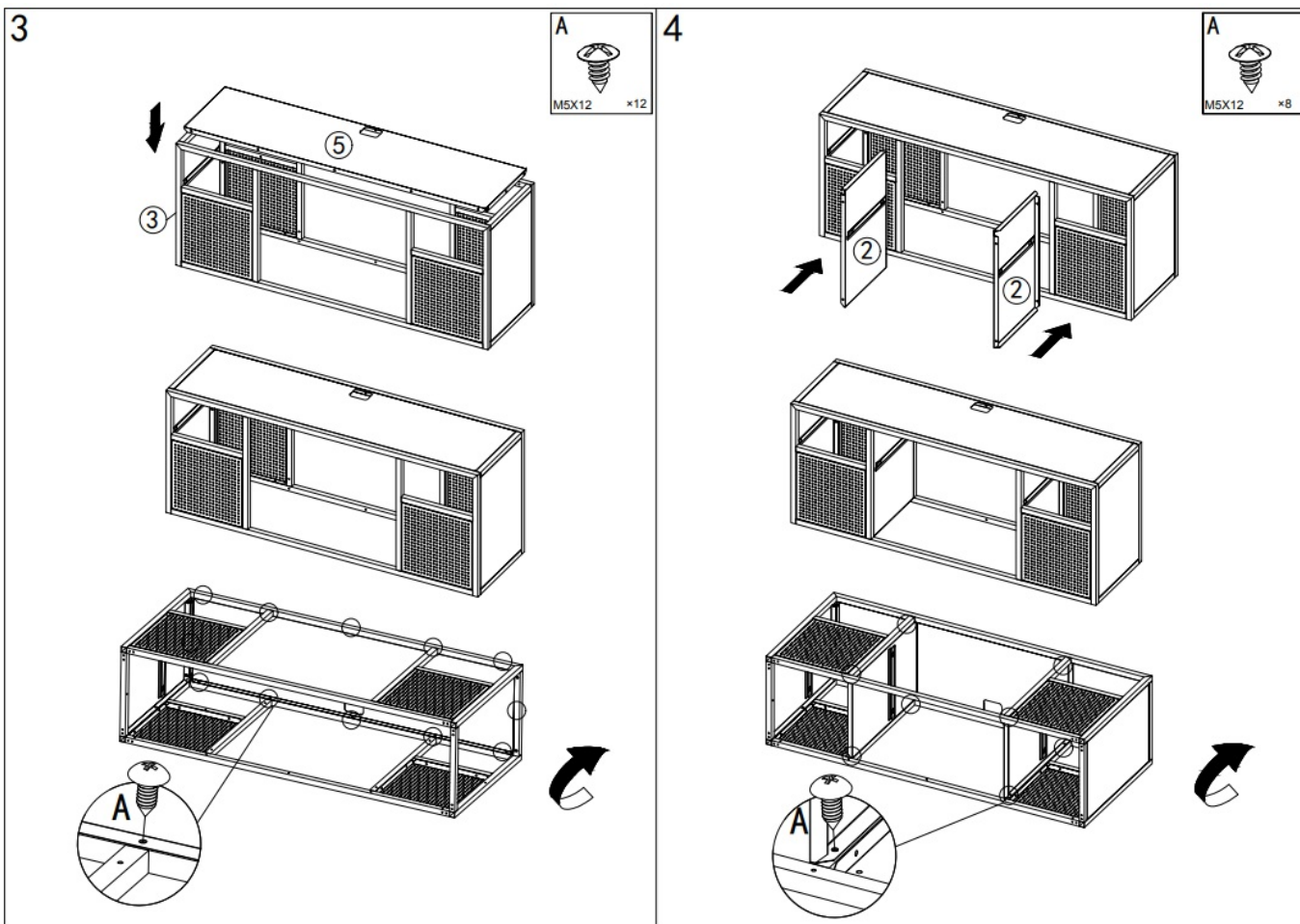
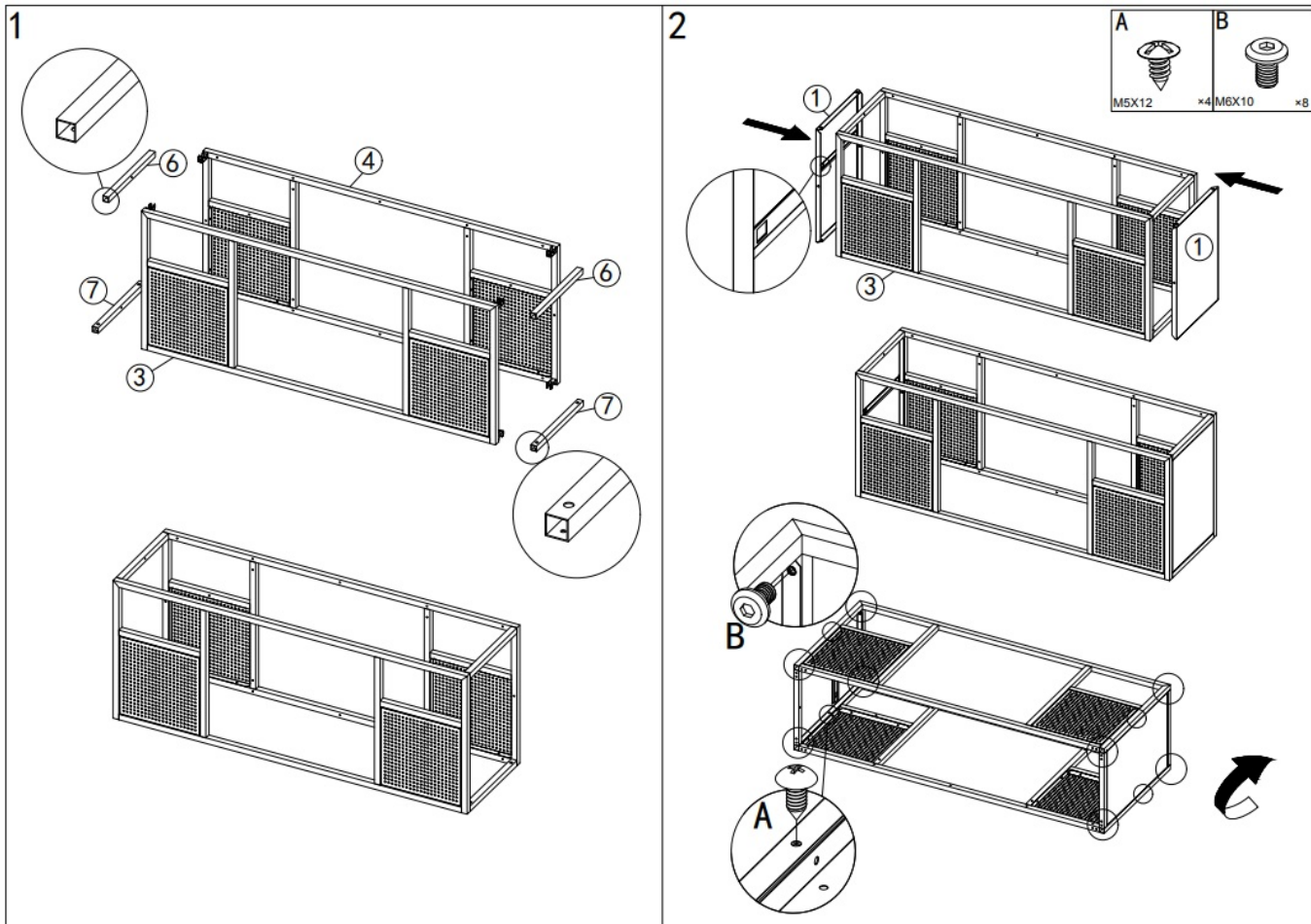

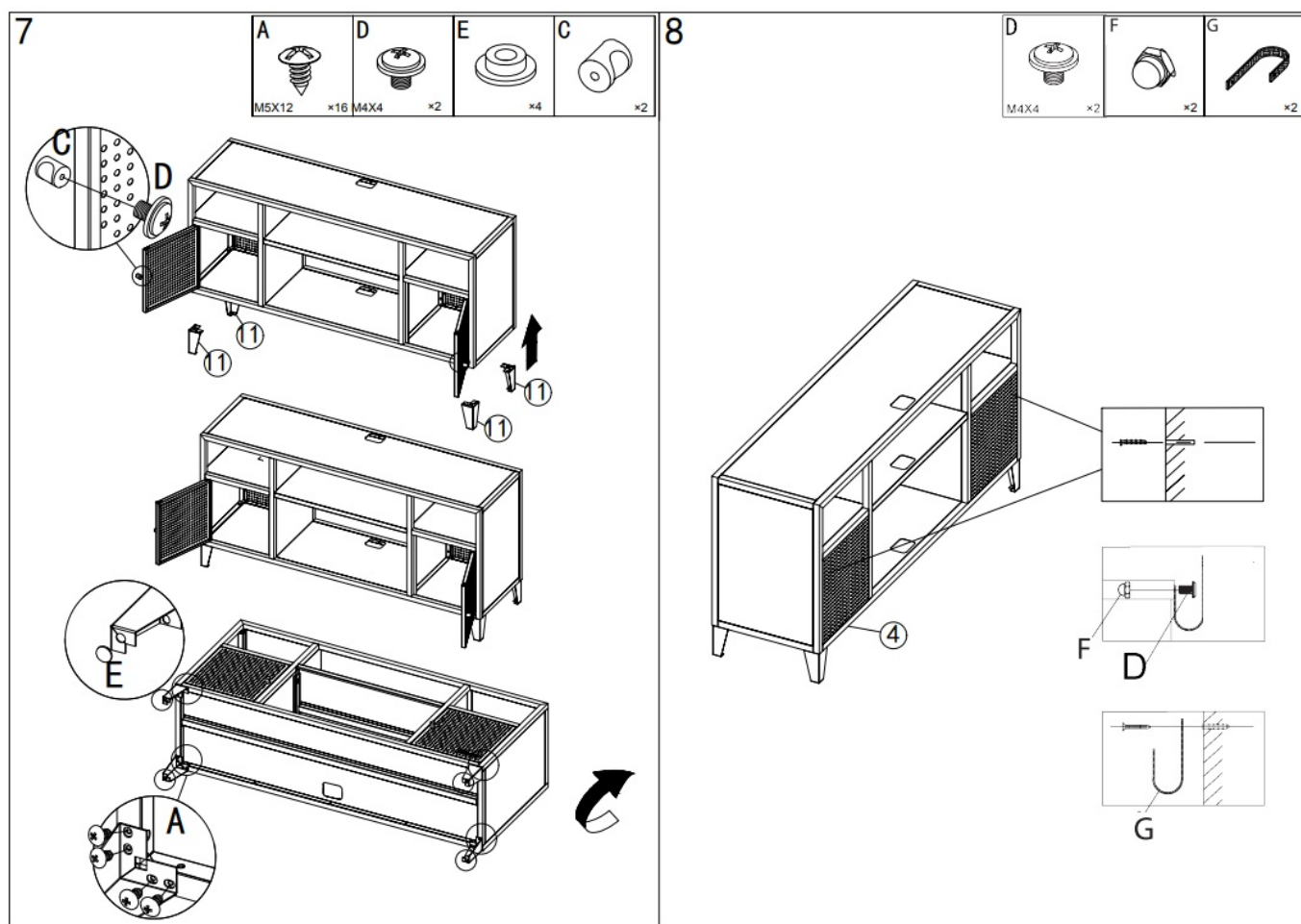
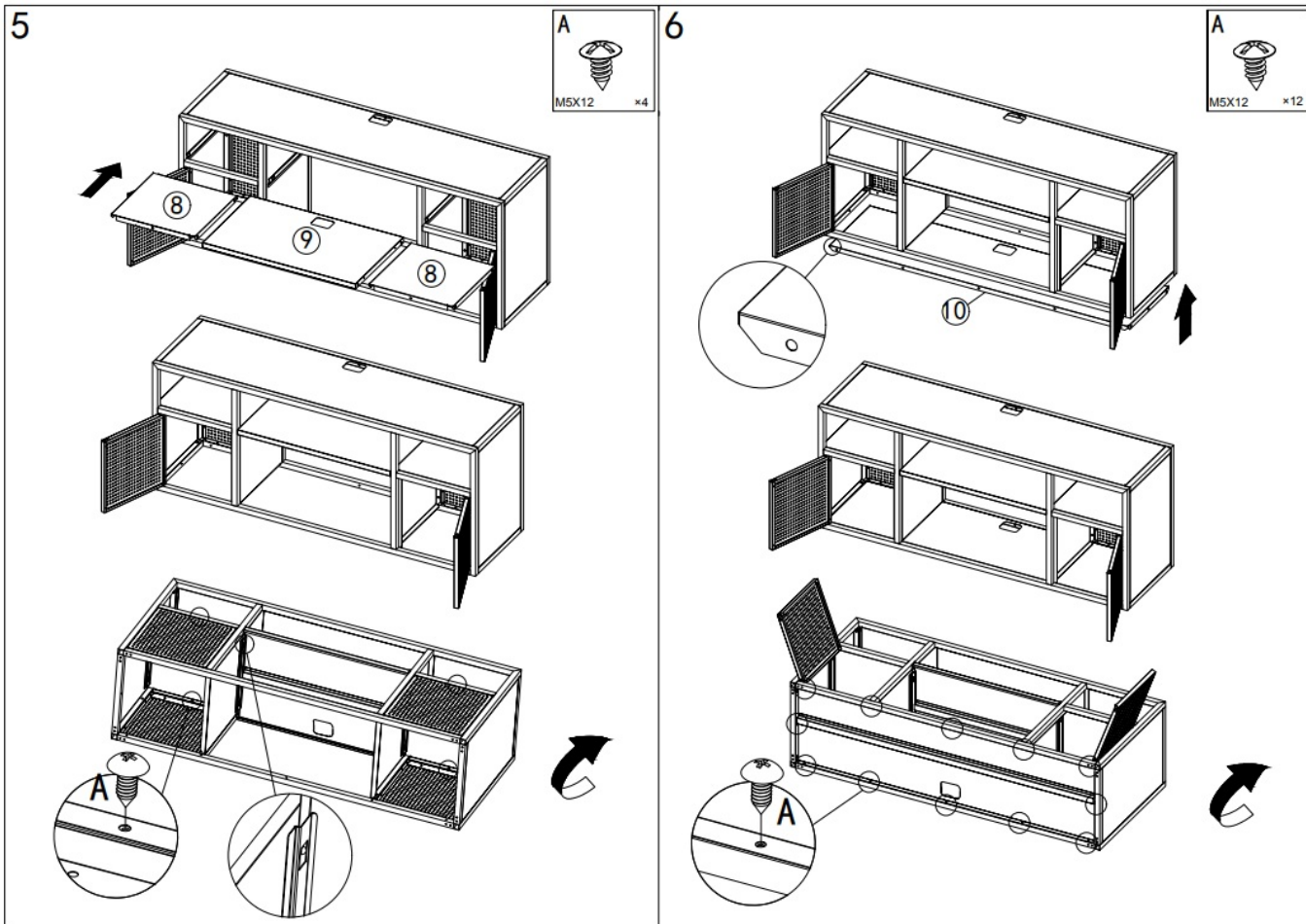

9

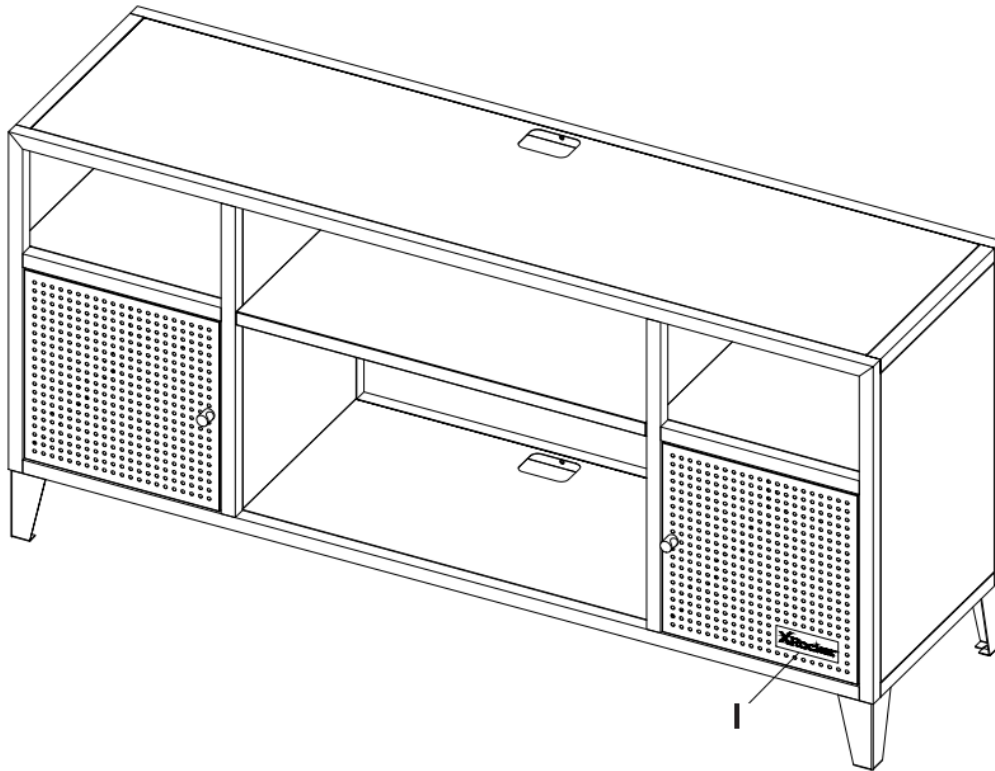

A Guide to Wall Mounting & Fixings

If plastic wall plugs are supplied



These are only suitable for use in masonry walls

If you are in any doubt about The correct wall plugs for Your wall, seek professional assistance.



Important: When drilling into walls always Check that there are no hidden wires or pipes.

Make sure that the screws and wall plugs being used are suitable for supporting your unit.

Consult a professional assistance if you are unsure.

ALL HOME FITTINGS ARE PERFORMEDM AT THE USERS OWN RISK. PLEASE CONSULT PROFESSIONAL ASSISTANCE IF NEEDED.

TYPES OF WALLS

No.1 “General Purpose” wall plug

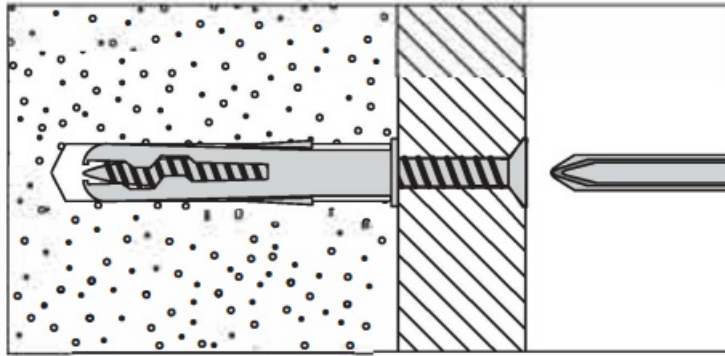

Generally aerated blocks should not be used to support heavy loads, use a specialist fitting in this case. For light loads, general purpose wall plugs can be used.

No.2 “Plasterboard” wall plug

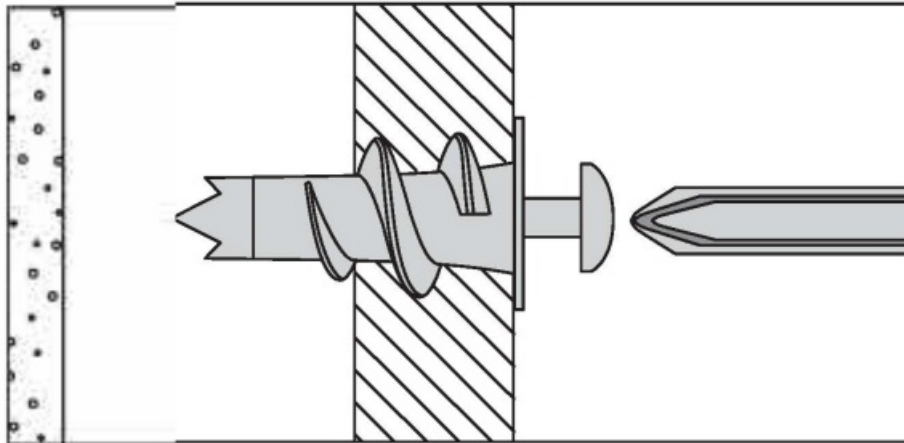

For use when attaching light loads on to plasterboard partitions.

No.3 “Cavity Fixing” wall plug

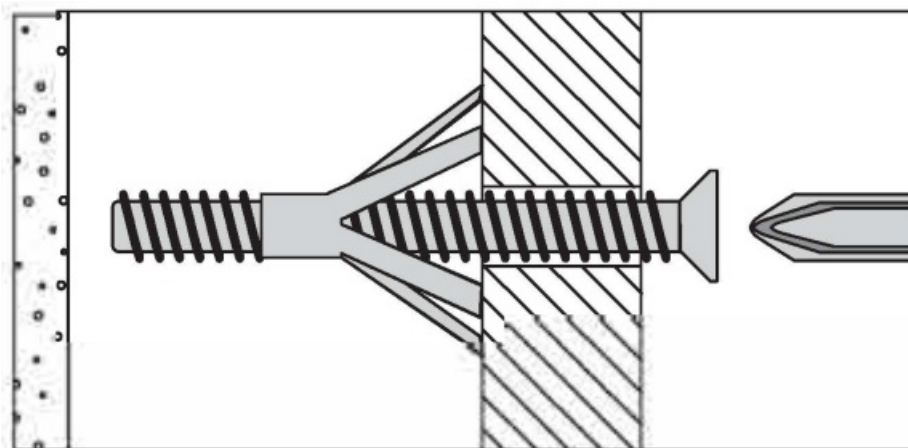

For use with plasterboard partitions or hollow wooden doors.

No.4 “Cavity Fixing-Heavy Duty” wall plug

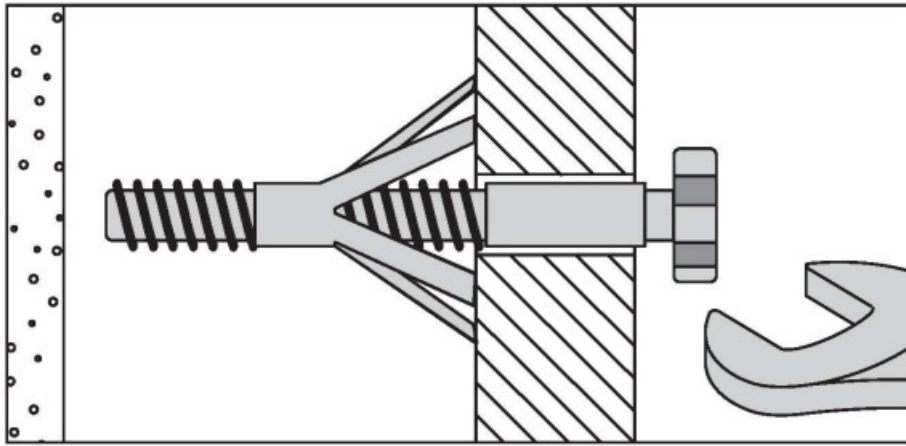

For use when fitting or supporting heavy loads such as shelving, wall cabinets and coat racks.

No.5 “Hammer Fixing” wall plug

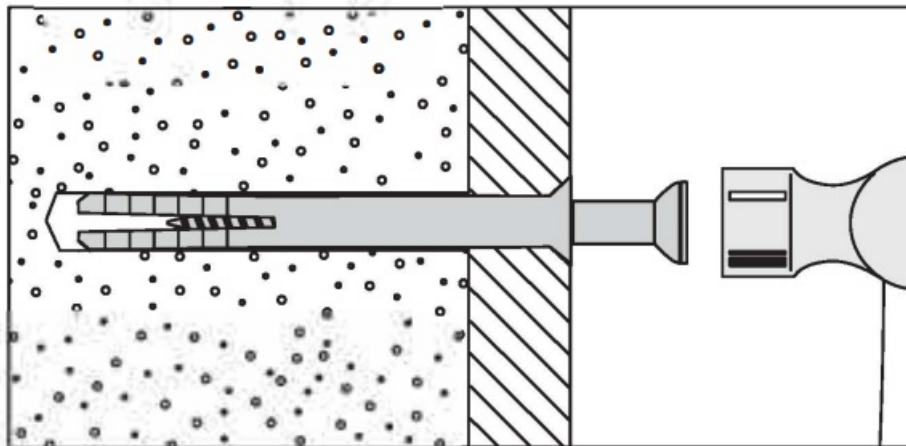

For use with walls stuck with plasterboard. The hammer fixing allows it to be fixed to the wall rather than the plasterboard. Always check the fixing is secure to the retaining wall.

No.6 “Shield Anchor” wall plug Heavy loads

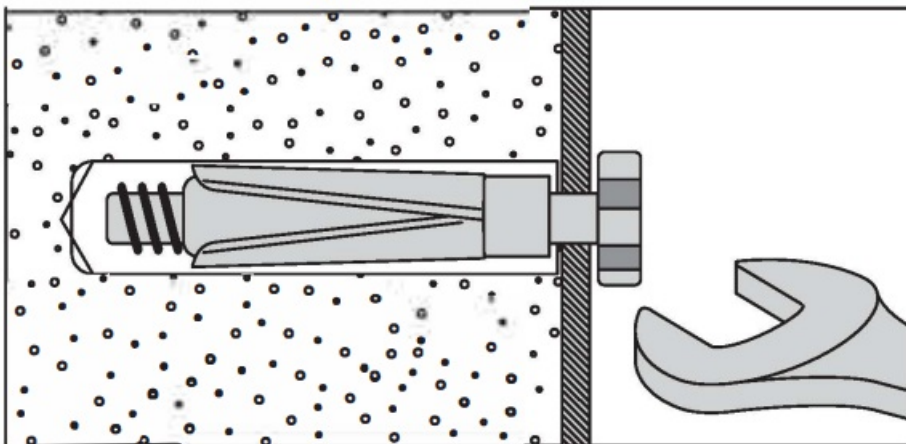

For use with heavier loads such as TV & HiFi speakers and satellite dishes etc.

Care & Maintenance

Please check the location of the furniture to ensure safety before fitting to the wall.
Please check fittings periodically to ensure that they remain securely fastened to the wall.

Need Help? Please visit the following webpage!

www.xrockeruk.com/pages/support

IMPORTANT: You must keep your original retail receipt as proof of purchase.

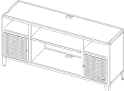
<div><div><p>GAMING TV UNIT BLACK/RED</p></div><div></div><div><p><small>Read Model? Please visit the following website: www.xrockergaming.com/support SUPPORT: You must keep your original model number in print at all times.</small></p></div></div>	<p>X-Rocker Mesh-Tek Gaming TV Unit [pdf] Installation Guide</p> <p>Mesh-Tek Gaming TV Unit, Mesh-Tek, Mesh-Tek Gaming Unit, Gaming TV Unit, Gaming Unit, T V Unit</p>
---	--