



[Home](#) » [Xmagpot](#) » **Xmagpot T3 Wireless 2 In 1 Adapter Instruction Manual** 

Contents [[hide](#)]

- [1 Xmagpot T3 Wireless 2 In 1 Adapter](#)
- [2 What's in the box?](#)
- [3 Product Diagram](#)
- [4 Basic Operation](#)
- [5 Specifications](#)
- [6 PRECAUTIONS](#)
- [7 FCC Statement](#)
- [8 ACTIVATE WARRANTY](#)
- [9 Documents / Resources](#)
 - [9.1 References](#)



Xmagpot T3 Wireless 2 In 1 Adapter



What's in the box?



Package Contents :

- A Wireless 2-in-1 Adapter x 1
- B Type-c Charging Cable x 1
- C 3.5mm Female to 2 RCA Male Cable x 1
- D User Guide x 1

- E 3.5mm Audio Plug x 1
- F Airplane headphone Adapter

Product Diagram

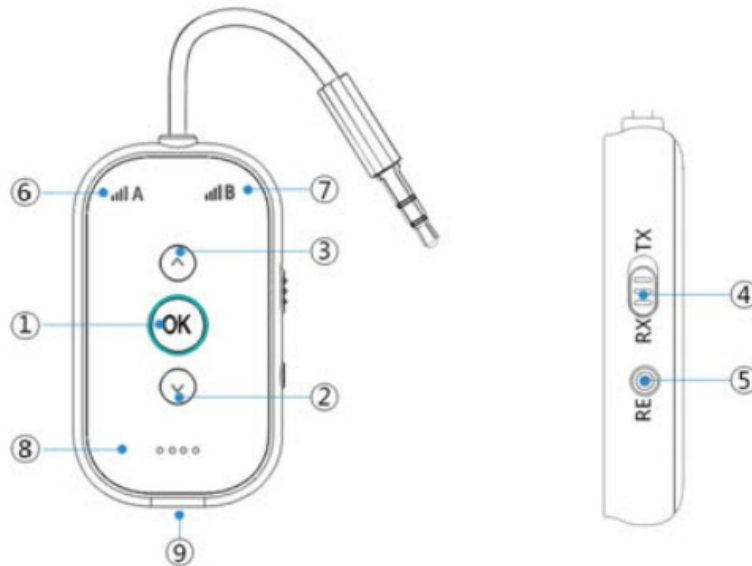

1. MFB(Multi-functional Button)
2. Volume-/ Previous Track
3. Volume+/Next Track
4. Mode Switch Button
5. Reset Button
6. LED Indicator A
7. LED Indicator B
8. Power LED Indicator
9. Charging Port

Basic Operation

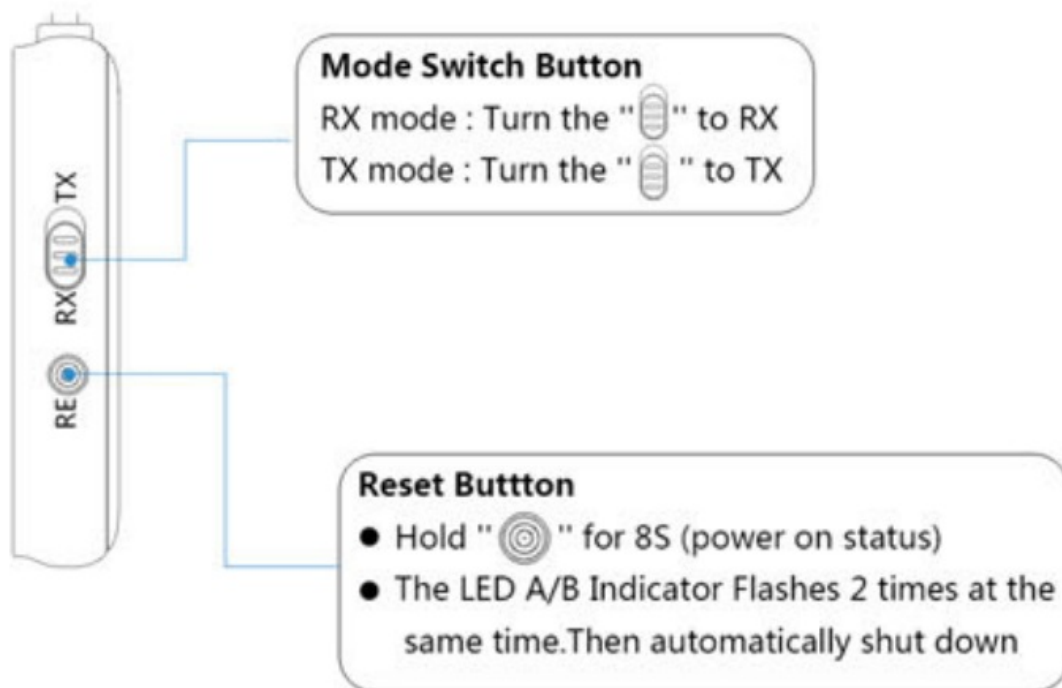
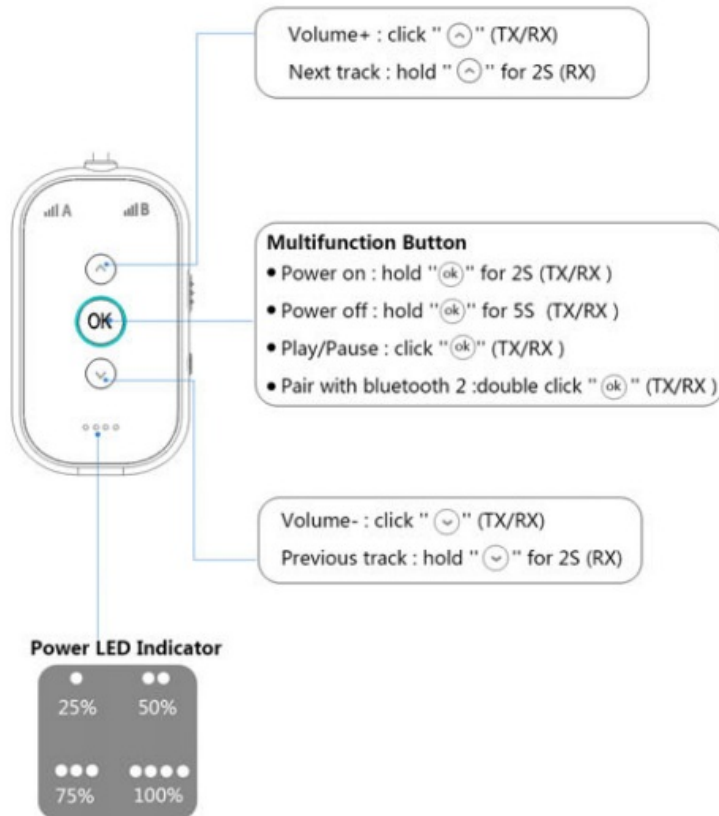

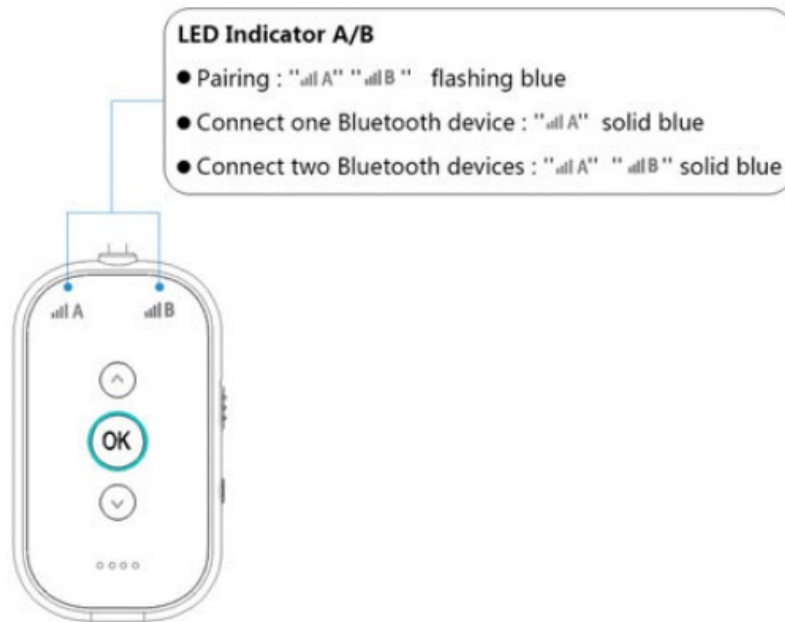

How to pair with two in RX mode

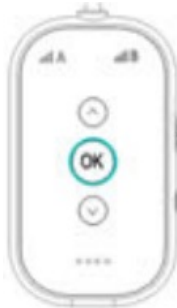

1. Power on

- Hold 'OK' for 2S
- " A " " B " flashing blue

2. Connect device

- Turn on your Bluetooth device. (phone, tablet , etc .)
- Search Bluetooth devices • T3 • Tap on • T' to connect .
- " A " will be solid blue .

3.

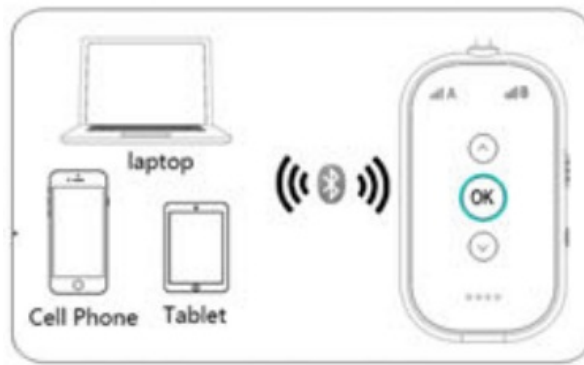

Connect the second device

- Double click 
- "A" "B" " flashing blue
- Turn on your bluetooth device . (phone , tablet etc .)
- Search Bluetooth devices • TY .
- Tap on • T' to connect .
- "B" " will also be solid blue .

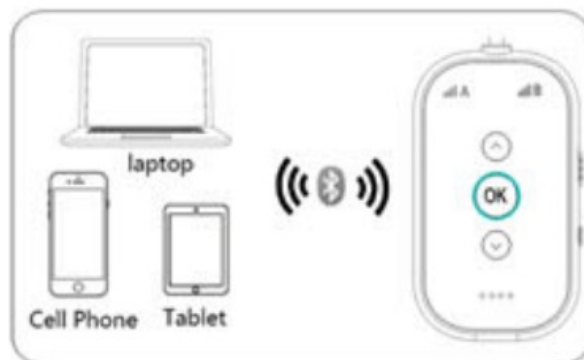

NOTES :

- After 3 minutes,if not any Bluetooth devices to connect, the adapter will shut down
- If the adapter has already connected to two Bluetooth devices, double-click the  button, it will not enter pairing mode anymore.

How to pair with one-to-two in TX mode

1. Power on

- Hold "  for 2S
- "A" "B" " .dIB" flashing blue

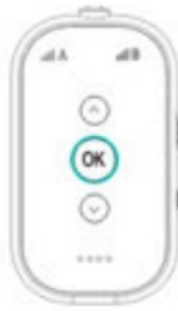

2. Connect audio

- Turn on your bluetooth device . (BT
- Speaker, BT Headset,etc.)
- Automatically search and connect .
- " A " will be solid blue .(connected)



3. Connect the second device

- Double click " ok "
- " A " " B " dIB" flashing blue
- Turn on your bluetooth device. (BT Speaker, BT Headset,etc.)
- Automatically search and connect .
- " B " will also be solid blue .

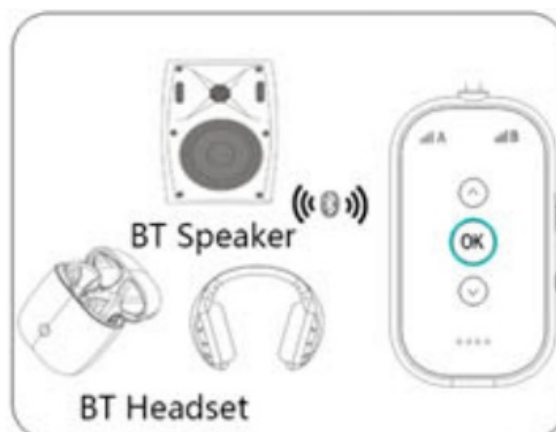

NOTES :

- Ake sure there are no other Bluetooth devices within 10 meters of the adapter.

Specifications

Bluetooth Version	V5.4
Bluetooth Profile	A2DP/AVRCP
Audio Codec	SBC/aptX
Range	33ft/10m
Charging Power	DC 5V
Battery Capacity	250mAh
Working Time	Approx.18hours
Charging Time	2 hours
Dimension(L*W*H)	62*36*12mm
Weight	50g

Charging

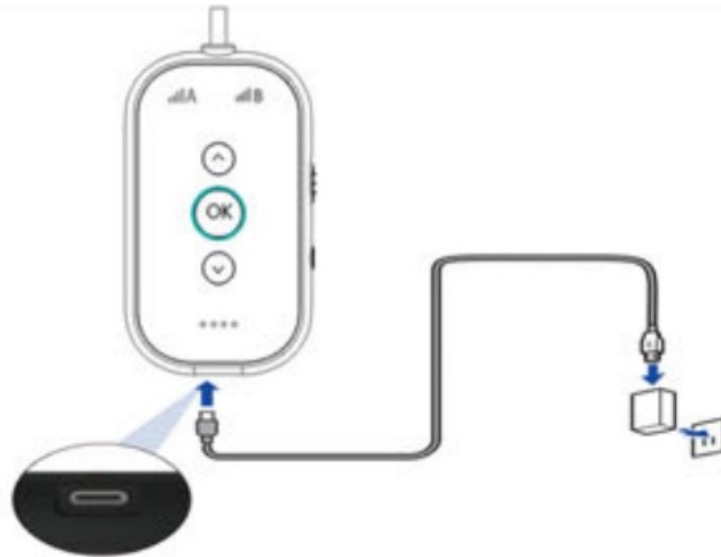

1. Use a USB Type C cable in the package and connect the adapter to any active Type C port, Please DO NOT use the fast charging port. NO MORE THAN 5V.
2. The LED indicator will be flashing white when charging.

How to connect to TV in TX mode

3.5mm audio cable Types 1



Types 2 RCA Cable

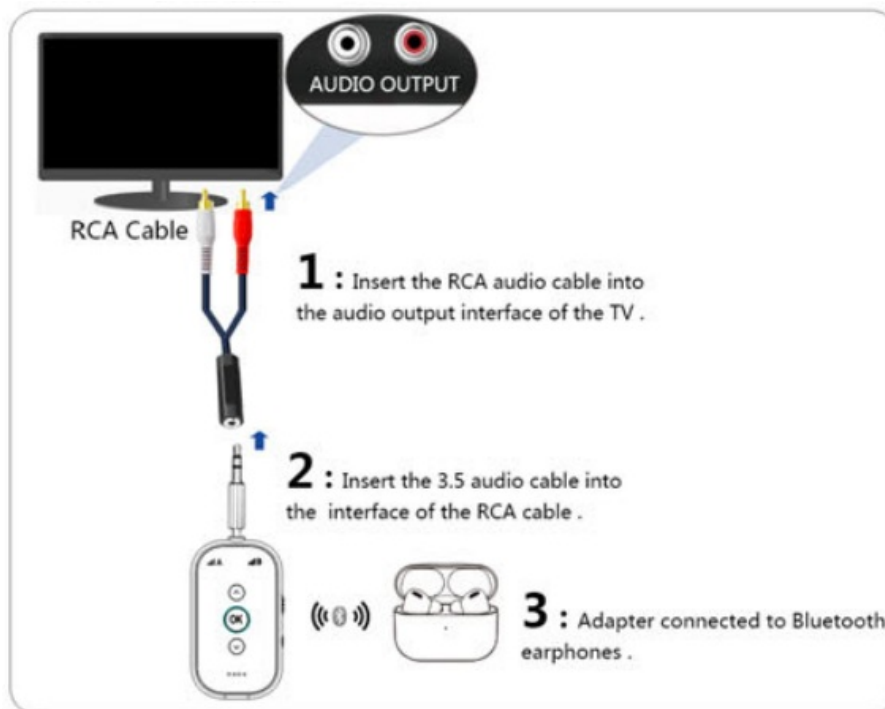

PRECAUTIONS

1. When power is low or the adapter is not used for a long time, it should be charged before use to prevent the product from working abnormally or receiving battery damage.
2. Bluetooth signals will be blocked and absorbed by surrounding objects. For the best sound quality, try to use the adapter in a direct line-of-sight with your connected device.
3. The adapter has a built-in lithium battery, please charge frequently when using it .

4. Please keep the adapter away from water or other liquids to avoid damage.
5. If you have any problems, please feel free to contact us at service@iswitech.com and we will be happy to help you.

Need any help?

If there is any issue with your order, please contact below email to ask for warranty, and you don't have to return the defective one to amazon.

- **Email:** info@icomtofit.com
- **Facebook:** @lcomtofit- Europe
- **PS:** We provide warranty even though the return window was closed.

FCC Statement

This device complies with Part 15 of the FCC rules. Operation is subject to the following two conditions: 1) this device may not cause harmful interference, and 2) this device must accept any interference received, including interference that may cause undesired operation.

Note: This equipment has been tested and found to comply with the limits for a Class B digital device, pursuant to part 15 of the FCC Rules. These limits are designed to provide reasonable protection against harmful interference in a residential installation.

This equipment generates uses and can radiate radio frequency energy and, if not installed and used in accordance with the instructions, may cause harmful interference to radio communications. However, there is no guarantee that interference will not occur in particular installation. If this equipment does cause harmful interference to radio or television reception, which can be determined by turning the equipment off and on, the user is encouraged to try to correct the interference by one or more of the following measures:

- Reorient or relocate the receiving antenna.
- Increase the separation between the equipment and receiver.
- Connect the equipment into an outlet on a circuit different from that to which the receiver is connected.

- Consult the dealer or an experienced radio/TV technician for help.

Changes or modifications not expressly approved by the party responsible for compliance could void the user's authority to operate the equipment.

FCC Radiation Exposure Statement

This device complies with FCC RF radiation exposure limits set forth for an uncontrolled environment. The device can be used in portable exposure condition without restriction.

ACTIVATE WARRANTY

Xmagpot

www.iswiitech.com



1. Lifetime Extended Warranty
2. Technical support if you have any usage problems

Email : info@iswiitech.com



MADE IN CHINA

Documents / Resources

	<p>Xmagpot T3 Wireless 2 In 1 Adapter [pdf] Instruction Manual</p> <p>T3, T3 Wireless 2 In 1 Adapter, Wireless 2 In 1 Adapter, 2 In 1 Adapter, Adapter</p>
---	--

References

- [User Manual](#)

🔍 2-in-1 Adapter, Adapter, T3, T3 Wireless 2 In 1 Adapter, Wireless 2-In-1 Adapter,

📁 Xmagpot Xmagpot

Leave a comment

Your email address will not be published. Required fields are marked *

Comment *

Name

Email

Website

☐ Save my name, email, and website in this browser for the next time I comment.

Post Comment

Search:

e.g. whirlpool wrf535swhz

Search

Manuals+ | Upload | Deep Search | Privacy Policy | @manuals.plus | YouTube

This website is an independent publication and is neither affiliated with nor endorsed by any of the trademark owners. The "Bluetooth®" word mark and logos

are registered trademarks owned by Bluetooth SIG, Inc. The "Wi-Fi®" word mark and logos are registered trademarks owned by the Wi-Fi Alliance. Any use of these marks on this website does not imply any affiliation with or endorsement.