



XILENCE M704PRO Computer Case Installation Guide

[Home](#) » [Xilence](#) » XILENCE M704PRO Computer Case Installation Guide 

Contents

- [1 XILENCE M704PRO Computer Case](#)
- [2 Components List](#)
- [3 Installation](#)
 - [3.1 Intel LGA1200/115X](#)
 - [3.2 Intel LGA1700](#)
 - [3.3 Intel LGA2066/2011](#)
 - [3.4 AMD AM4](#)
- [4 FAN MOUNTING & CONNECTION](#)
 - [4.1 ARGB Version And RGB Connection](#)
- [5 ARGB Version And Motherboard Sync](#)
- [6 Contact Information](#)
- [7 Documents / Resources](#)



XILENCE M704PRO Computer Case



Components List

1. Heatsink ×1
2. Fan ×1
3. Intel Bracket ×2
4. AMD Bracket ×2
5. LGA1700/1200 Backplate
6. Fan Clip ×4
7. LGA1700 Standoff ×4
8. LGA1200/115X/AM4 Standoff ×4
9. LGA20xx Standoff ×4
10. Tightening Nut ×4
11. AMD Screw ×4
12. Thermal Grease ×1

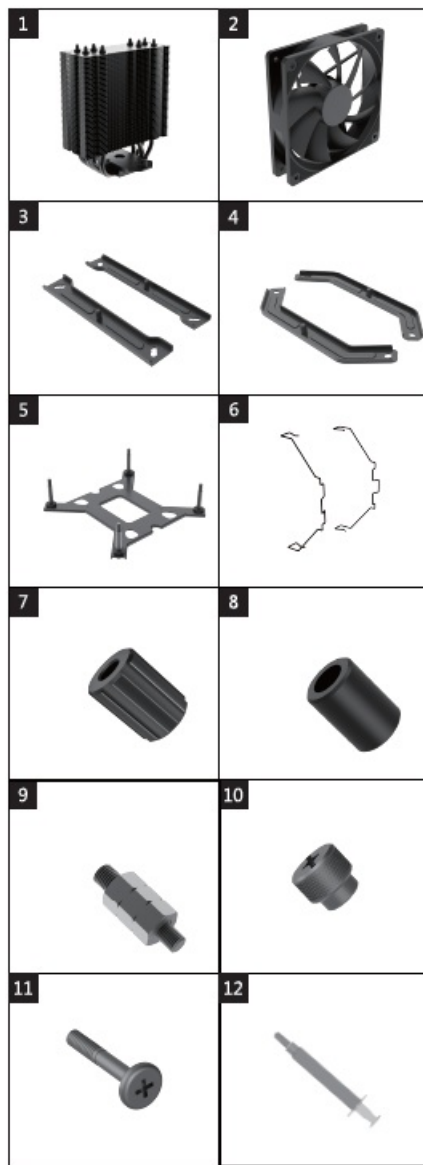

Installation

Intel Bracket Illustration

- The Intel brackets are designed with 3 different sizes of mounting holes for LGA2066/2011, LGA1700 and LGA1200/115X.
- Please select correct mounting holes according to your CPU socket.

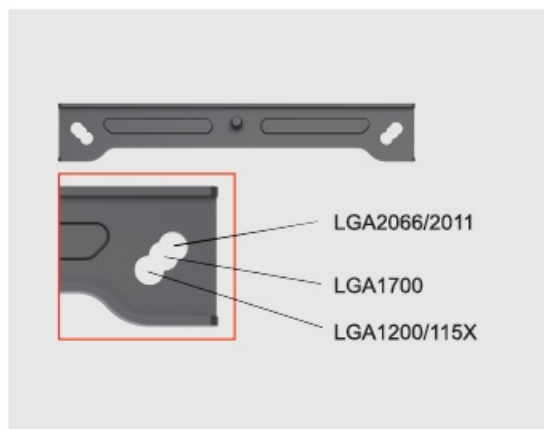

Intel Backplate Illustration

- The Intel backplate is designed for LGA 1700 and LGA1200/115X sockets.
- Push the screws to the outside for LGA1700. Push the screws to the inside for LGA1200/115X.

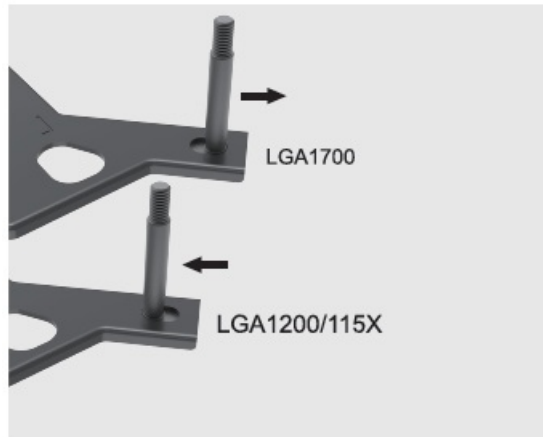

Intel LGA1200/115X

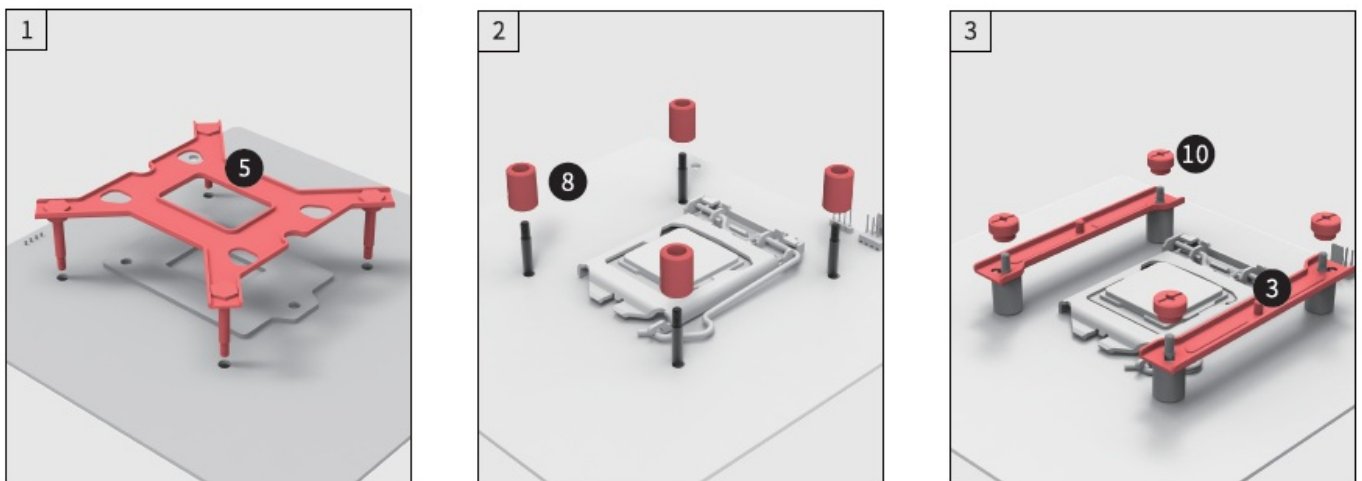

- Push the screws on the backplate to the inside and then put the backplate through the back of the motherboard; push the standoffs into the protruding screws and then secure the brackets with the tightening nuts.

Intel LGA1700

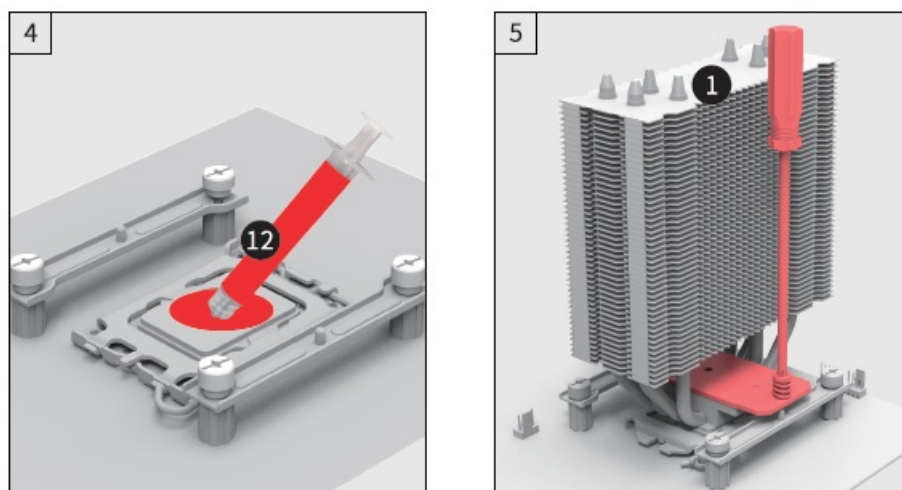

- Apply a thin layer of thermal grease onto the CPU surface, and then secure heatsink.

Intel LGA1700

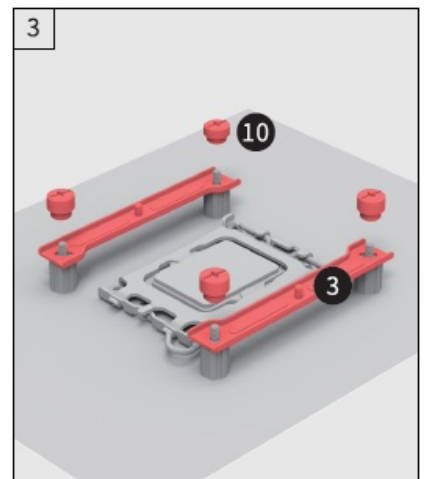
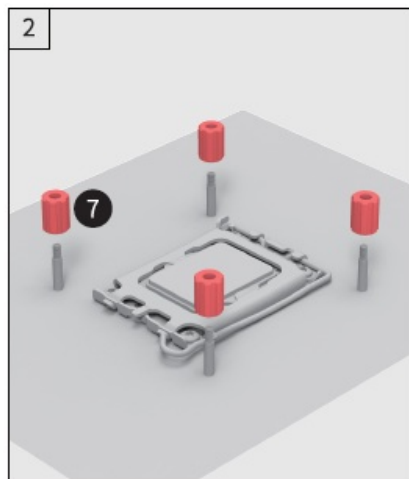
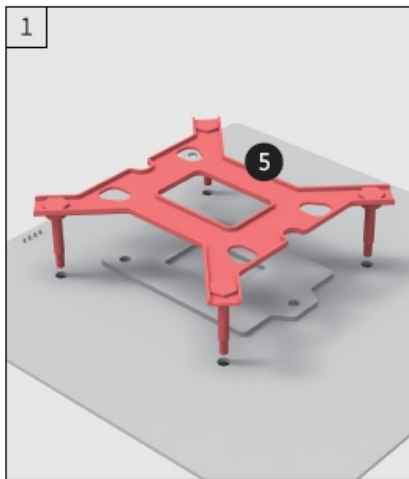

Push the screws on the backplate to the outside and then put the backplate through the back of the motherboard; push the standoffs into the protruding screws and then secure the brackets with the tightening nuts.

Intel LGA1200/115X

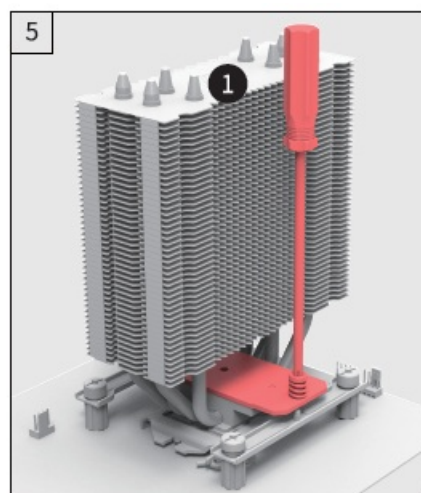
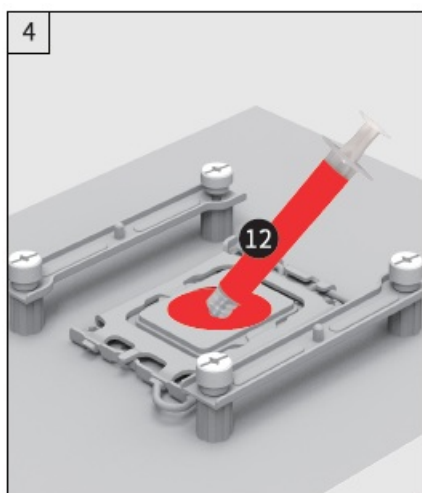

Apply a thin layer of thermal grease onto the CPU surface, and then secure heatsink.

Intel LGA2066/2011

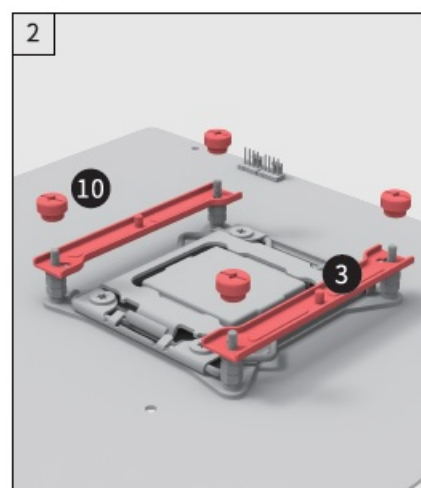
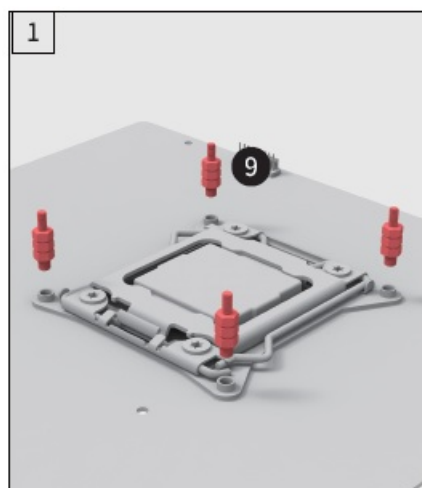

- Thread in the LGA20XX standoffs; put on the brackets and fasten by tightening nuts.

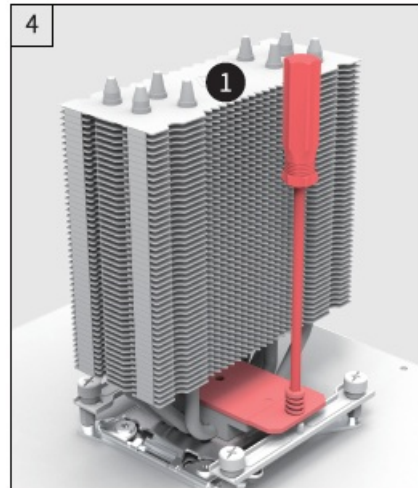
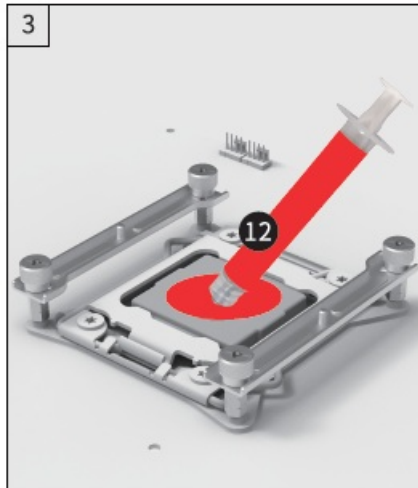

- Apply a thin layer of thermal grease onto the CPU surface, and then secure heatsink.

AMD AM4

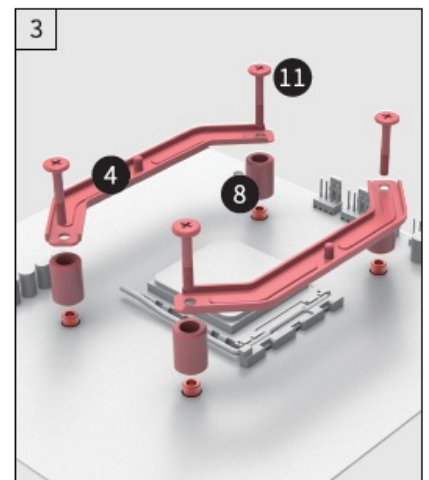
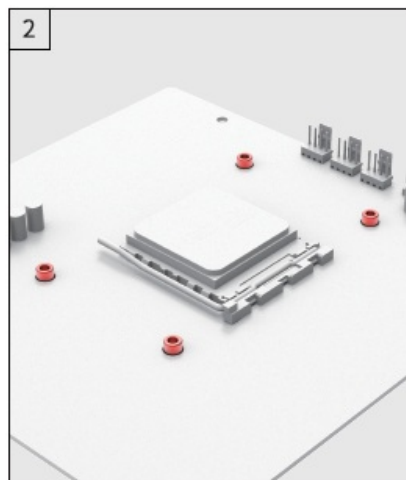
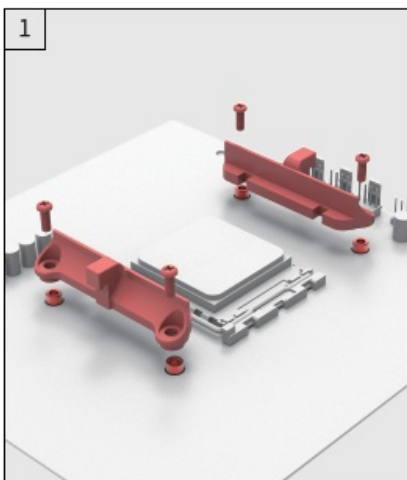

- Remove the original AMD plastic retention frame, but keep the backplate; put the standoff on and then secure the AMD bracket with screws.

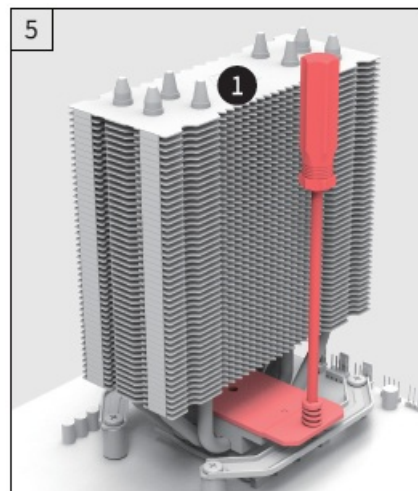
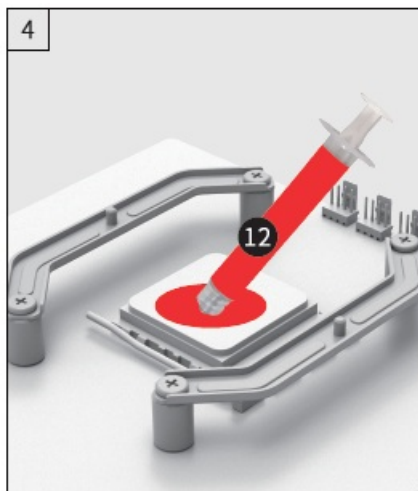

- Apply a thin layer of thermal grease onto the CPU surface, and then secure heatsink.

FAN MOUNTING & CONNECTION

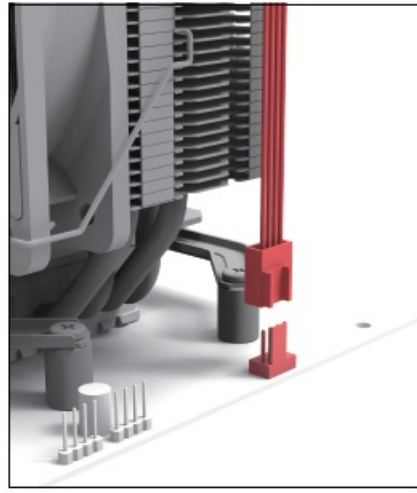
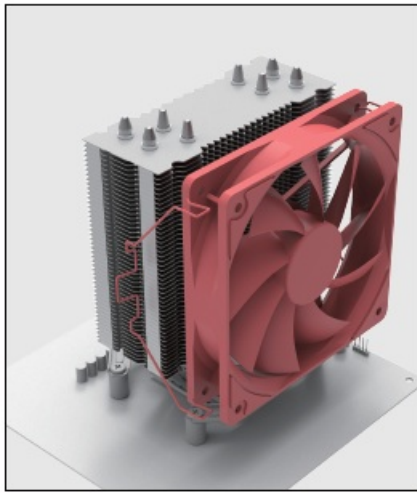

- Secure the fan to the heatsink with fan clips.
- Connect the fan header to “CPU_FAN” header on the motherboard.

ARGB Version And RGB Connection

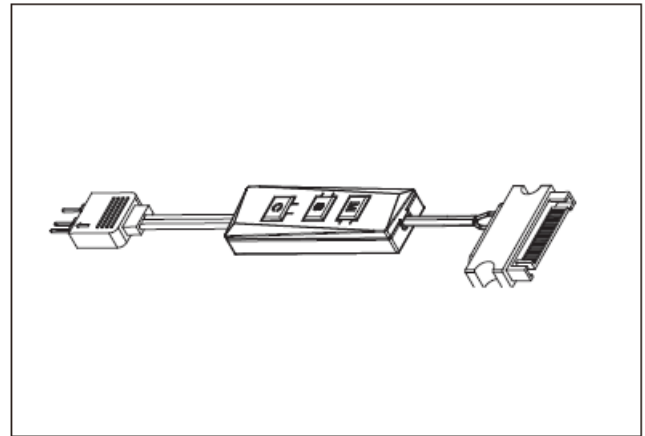
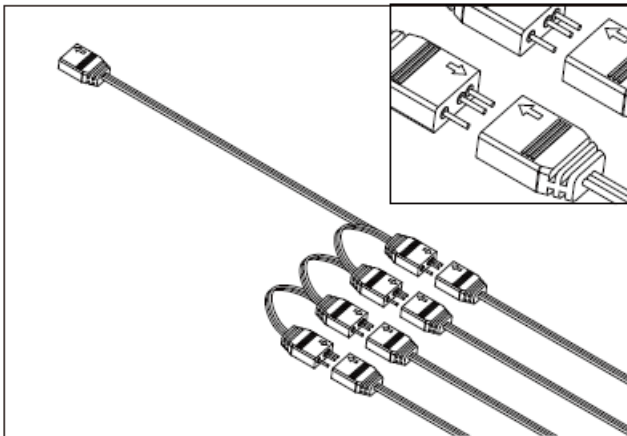

- Connect the fans' GB header to the RGB splitter wire.
- Please make sure the pin with Arrow connects to the one with Arrow too.
- Set RGB Lighting with Controller. Switch the lighting modes with 'M' button.
- Change the speed of the color changing with 'S' button. Switch the color modes with 'C' button.

ARGB Version And Motherboard Sync

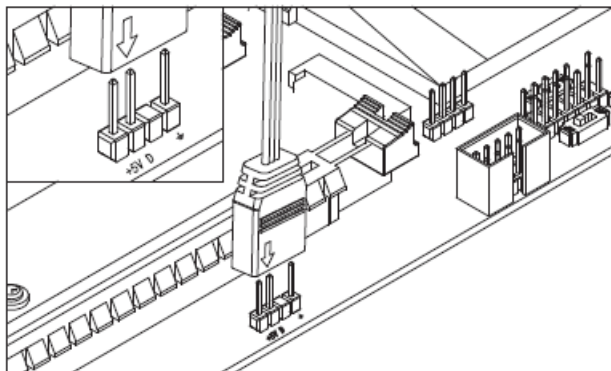

 ASUS: ADD_HEADER

 MSI: JRAINBOW

 GIGABYTE: D_LED

 ASROCK: ADDR_LED

- (For motherboard ARGB control): plug fan ARGB 3pin cable to 5V ARGB header on the motherboard.

- Then download correct software from motherboard official website and use the software to control the ARGB lighting.

Contact Information

XILENCE GmbH

- Lavesstraße 4 31137 Hildesheim Germany
- www.xilence.net
- info@xilence.de.

Documents / Resources

	<p>XILENCE M704PRO Computer Case [pdf] Installation Guide M704PRO Computer Case, M704PRO, Computer Case, Case</p>
---	---