



XIIW B0B71LL8H7 Pyrography Station Temperature Adjustable Instruction Manual

[Home](#) » [XIIW](#) » XIIW B0B71LL8H7 Pyrography Station Temperature Adjustable Instruction Manual 

Contents

- 1 XIIW B0B71LL8H7 Pyrography Station Temperature Adjustable
- 2 APPLICATIONS
- 3 PART LIST
- 4 OPERATION
- 5 THE USE OF PYROGRAPHY WIRE NIBS
- 6 MAINTENANCE AND PRECAUTIONS
- 7 Documents / Resources
 - 7.1 References



XIIW B0B71LL8H7 Pyrography Station Temperature Adjustable



- Temperature range: 250°C~500°C / 482°F~932°F
- Main unit dimensions: L115*W70*H84mm ±5mm
- Operating ambient temperature: 0°C~40°C / 32°F~104°F

Thank you for purchasing this product. Please read the manual carefully before parting and keep this manual for future reference.

Statement: The company reserves the right to improve & upgrade products, product specifications and design are subject to change without notice.

Made in China

This product should not be thrown in the garbage. In accordance with the European directive 2012/19/EU, electronic equipment at the end of their life must be collected & returned to an authorized recycling facility.

APPLICATIONS

This station is suitable for pyrography works on wood, gourds, leather, wheat stalks, tree barks, bamboos, furniture, and more.

PART LIST

1. Dial (Temperature Adjustment)
2. Cord (Pyrography Pen)
3. Pyrography Pen
4. Operating Indicator Light
5. Stand (Pyrography Pen)
6. Pyrography Wire Nib

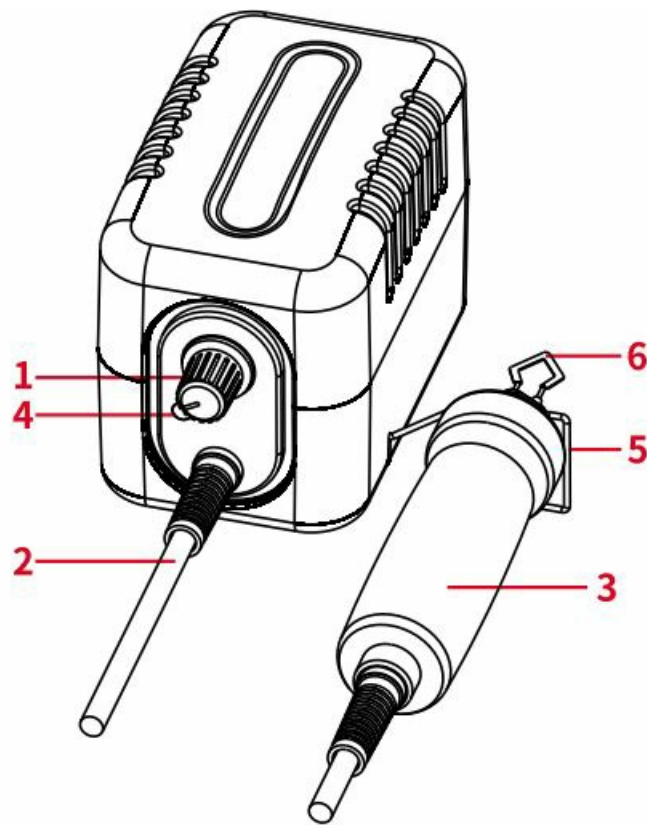

OPERATION

1. Tip Installation

Align the two pins with the corresponding holes on the pyrography pen. Insert and press the pyrography nib into the pyrography pen.

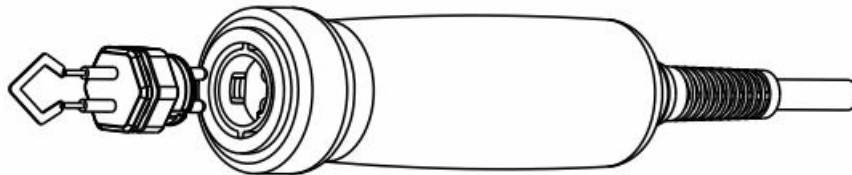

2. Tip Removal

Clamp the pyrography tip and pull it out.



CAUTION: The replacement of the tip **MUST** be carried out when the tip is cooled. Ensure the

3. Based on your preference, install the pen stand on either the left or on the right side of the main unit. Then, place the pyrography pen in the stand.

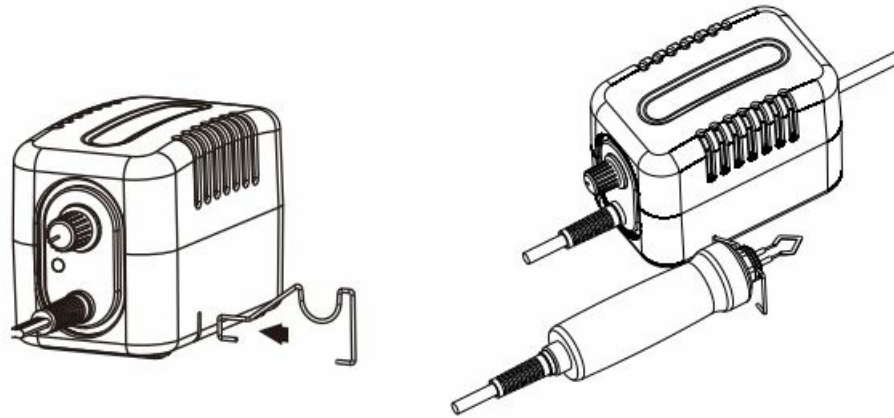

4. Turn ON the power switch, and the pyrography nib will begin heating, and the operating indicator light will turn ON. Set the desired temperature and begin your work once the temperature reaches the set temperature.
5. Once done using, place the pen back to the pen stand, then turn OFF the power switch.

If the station is not in use for an extended period, disconnect the power plug.

Note: rotate the pyrography pen handle while picking up the pyrography pen; make sure the pyrography pen handle is appropriately placed onto the U-shaped pyrography pen stand when placing the pyrography pen.

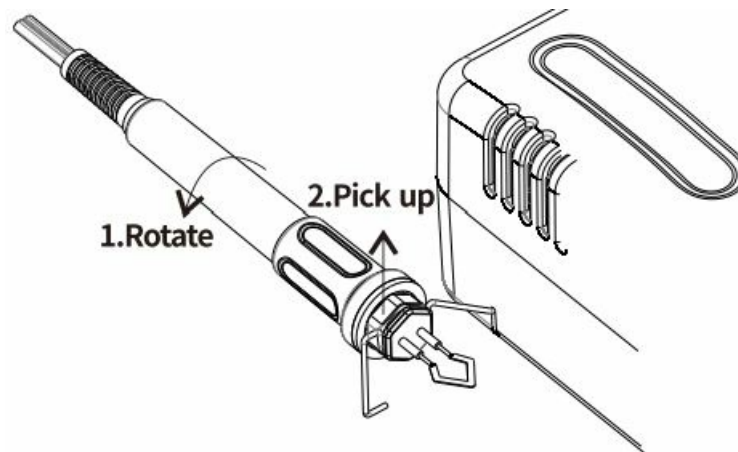

THE USE OF PYROGRAPHY WIRE NIBS



Pointed Nib – For texts, detailing, low-temperature depth-of-field shading.



Curved Nib – For shading, fine-outlining, and general drawing.



Skewed Spear Nib – For feathers, fine-lines, shading, low-temperature depth-of-field shading.



Diamond Flat Shader – For shading, outlining and cutting & carving.



Diamond Point Nib – For detailing and outlining.



Round Wire Nib – For outlining, and feathering.



Long Round Point Wire Nib – For outlining, feathering, and shading.



Long flat shader – For outlining, feathering, and precision low-temperature shading.



Long Sharp Flat Nib – For outlining, burning fine hair, and fine shading.



Long Flat Shader XL – For outlining, burning hair, shading, and cutting.

MAINTENANCE AND PRECAUTIONS

After use, clean the residue and oxide off the pyrography pen tip when the tip is cooled. Keep the pyrography pen clean.

Documents / Resources

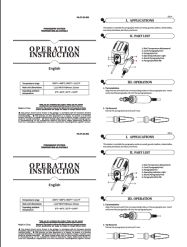
	<p>XIIW B0B71LL8H7 Pyrography Station Temperature Adjustable [pdf] Instruction Manual B0B71LL8H7 Pyrography Station Temperature Adjustable, B0B71LL8H7, Pyrography Station Temperature Adjustable, Station Temperature Adjustable, Temperature Adjustable, Adjustable</p>
---	---

References

- [User Manual](#)