



**Contents** [ [hide](#) ]

- [1 Xiaoqiangiot TC226 WiFi Camera](#)
- [2 Product Usage Instructions](#)
- [3 INTRODUCTION](#)
- [4 Register and log in to the APP](#)
- [5 Add a camera](#)
- [6 Warranty card](#)
- [7 FCC WARNING](#)
- [8 Frequently Asked Questions](#)
- [9 Documents / Resources](#)
  - [9.1 References](#)

# Xiaoqiangiot

## Xiaoqiangiot TC226 WiFi Camera



## Product Specifications

- **Antenna Type:** Supplied Antenna
- **Compliance:** FCC's RF Exposure Guidelines
- **Minimum Distance:** 20cm between the radiator and the body

## Product Usage Instructions

### Installation

1. Consult the dealer or a radio/TV technician for assistance with connecting the receiver.
2. Ensure compliance with the FCC's RF Exposure guidelines by maintaining a minimum distance of 20cm between the radiator and your body.
3. Use only the supplied antenna for optimal performance and safety.

### Operation

1. Power on the device using the designated power button.
2. Tune to the desired frequency range for operation.
3. Adjust volume and settings as needed for your listening experience.
4. Follow the user manual instructions for additional features and functionalities.

## INTRODUCTION

- Dear users, thank you for using the company's products.
- Please read the operation manual carefully before using the company's products, and save this manual for subsequent production examinations

## Register and log in to the APP

- Open the APP (as shown in Figure 1)
- Click to register (as shown in Figure 2)
- Follow the prompts to fill in the registration information(as shown in Figure 3) to complete the registration and log in to the APP (as shown in Figure 4)

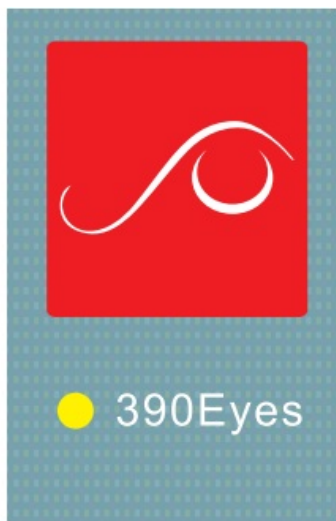

figure 1



figure 2



figure3

## Add a camera

### Method 1: Scan the code to add

- Click the "+" sign at the top right of the home page (as shown in Figure 4)
- Click the scan button in the upper right corner (as shown in Figure 5)
- Scan the "PID QR code" on the camera (as shown in Figure 6)
- Follow—up steps to be added, please ask the production test APP to prompt



figure 4

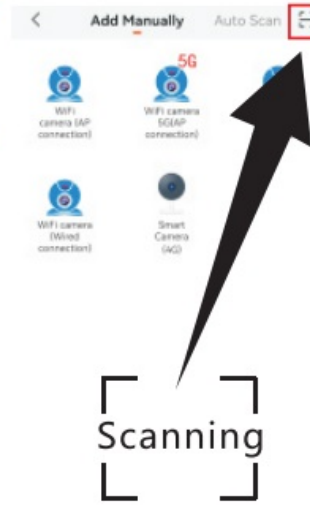

figure 5

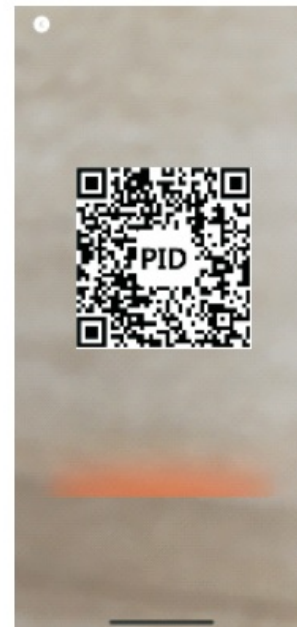

figure 6

## Method 2: WiFi Camera (AP connection)

- Click the “+” sign at the top right of the home page (as shown in Figure 7)
- Click on WiFi Camera (AP connection) (as shown in Figure 8)
- After entering the correct W’Fi password, click “Next” (as shown in Figure 9)

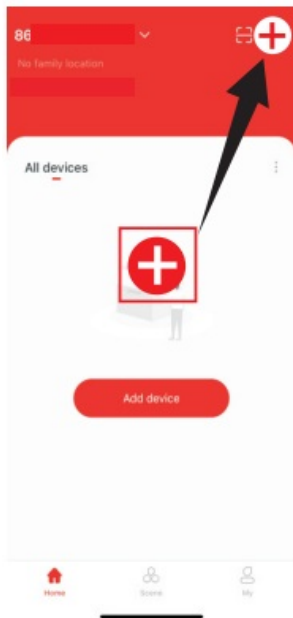

figure 7

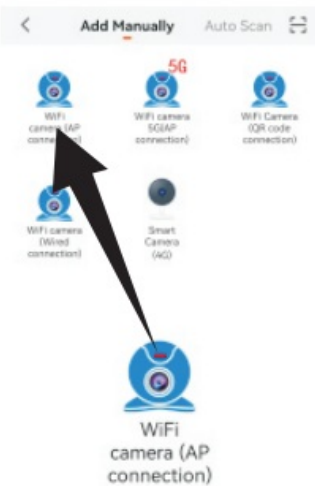

figure 8



figure 9

- Power on the camera, wait about 30s and click ‘Next’ (as shown in Figure 10)
- After heard wait for connecting,” Click next, if not, please reset the camera until you hear the prompt. (Figure 11)

- Click “Go to Connect (as shown in Figure 12)



figure10



figure11

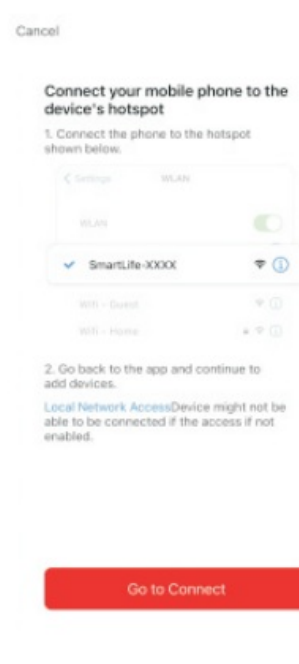

figure12

- Connect the mobile phone WiFi named “Smartl\_ife” and return to the APP (as shown in Figure 13)
- The device is being added (as shown in Figure 14)
- After jumping out of the successful addition page, click the “Done button on the upper right to complete the addition (as shown in Figure 15)

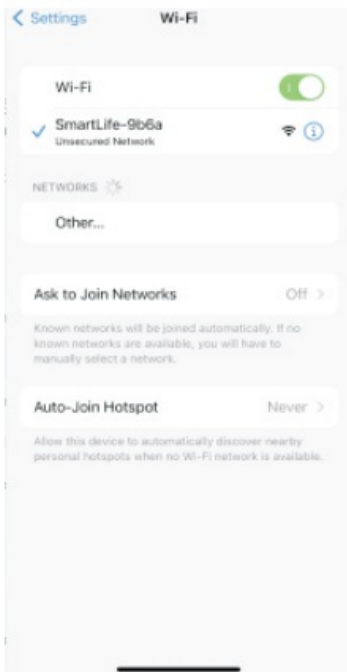

figure13



figure14

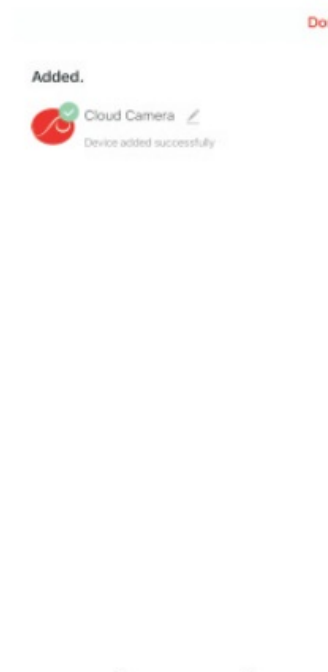

figure15

**Method 3: Wired addition (this method requires the camera to have a network port)**

- Click the “+” sign at the top right of the home page (as shown in Figure 16)
- Click WiFi camera (wired connection) (as shown in Figure 17)
- Power on the camera, wait about 30s and click “Next” (as shown in Figure 18)



figure16

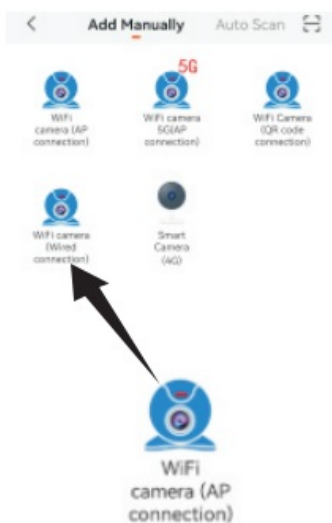

figure17



figure18

- Confirm that the above steps are completed and click “Next (as shown in Figure 19)
- After heard wait for connecting,” Click next, if not, please reset the camera until you hear the prompt (as shown in Figure 20)
- Device searching (as shown in Figure 21)

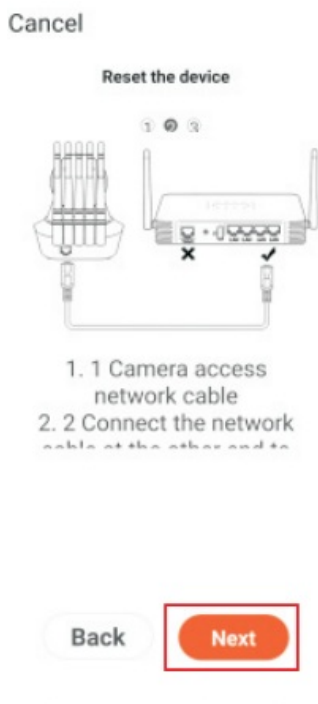

figure19



figure20

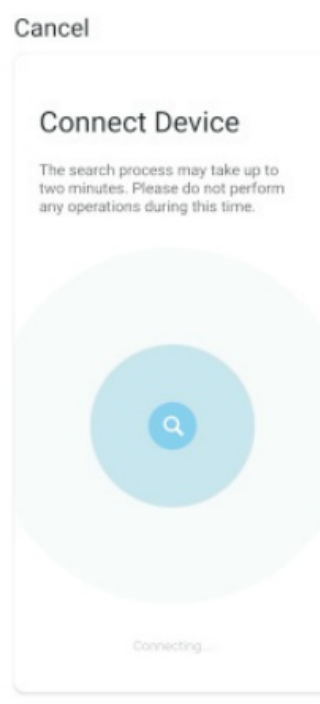

figure21

- After finding the camera, click the “+” sign on the right to add it (as shown in Figure 22)

22)

- The device is being added (as shown in Figure 23)
- After jumping out of the successful addition page, click the “Finish” button on the upper right to complete the addition (as shown in Figure 24)

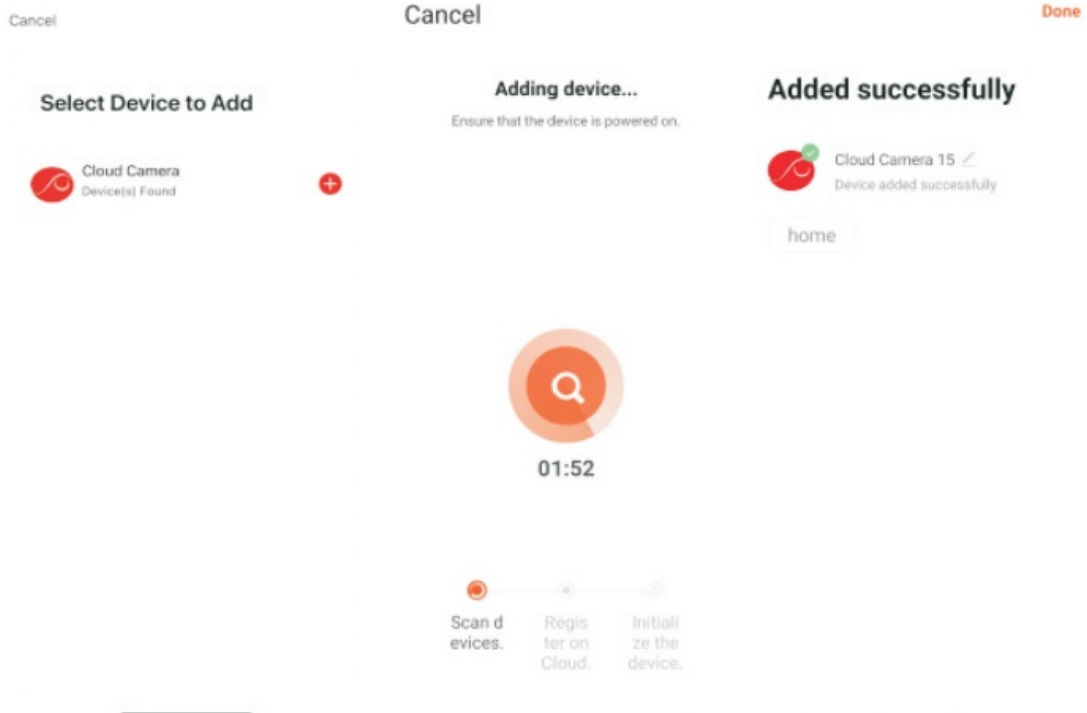

figure22

figure23

figure24

## Warranty card

- **Your name:** \_\_\_\_\_
- **Shopping time:** \_\_\_\_\_
- **Contact details** \_\_\_\_\_
- **Cause of issue:** \_\_\_\_\_

## FCC WARNING

This device complies with part 15 of the FCC Rules. Operation is subject to the following two conditions:

1. This device may not cause harmful interference,
2. This device must accept any interference received, including interference that may cause undesired operation.

Any changes or modifications not expressly approved by the party responsible for

compliance could void the user's authority to operate the equipment.

**NOTE:** This equipment has been tested and found to comply with the limits for a Class B digital device, under Part 15 of the FCC Rules. These limits are designed to provide reasonable protection against harmful interference in a residential installation. This equipment generates, uses and can radiate radio frequency energy and, if not installed and used according to the instructions, may cause harmful interference to radio communications. However, there is no guarantee that interference will not occur in a particular installation. If this equipment does cause harmful interference to radio or television reception, which can be determined by turning the equipment off and on, the user is encouraged to try to correct the interference by one or more of the following measures:

- Reorient or relocate the receiving antenna.
- Increase the separation between the equipment and receiver.
- Connect the equipment to an outlet on a circuit different from that to which the receiver is connected.
- Consult the dealer or an experienced radio/TV technician for help.

To maintain compliance with FCC's RF Exposure guidelines, this equipment should be installed and operated with a minimum distance between 20cm the radiator your body: Use only the supplied antenna.

## **Frequently Asked Questions**

Can I use a different antenna with the product?

It is recommended to use only the supplied antenna to ensure proper operation and compliance with safety guidelines.

How do I ensure compliance with the FCC's RF Exposure guidelines?

Maintain a minimum distance of 20cm between the radiator and your body while operating the equipment.



Can two mobile phones be connected to one camera at the same time?

The camera can only be added by one account, and multiple mobile phones can be viewed by sharing the device or logging in to the same account through multiple mobile phones

Can I connect to the camera without WiFi?

No, the camera needs to be connected to a WiFi network to use.

Check the playback prompt SD card not detected?

Check if the memory card is correctly inserted into the camera.

How to change the network connection?

Long-press the camera reset button until the reset is successful, then restart and connect.

The camera prompts to be offline?

Check whether the WiFi network is normal, and check whether the power supply is working properly

## Documents / Resources

	<p><a href="#">xiaoqiangiot TC226 WiFi Camera [pdf]</a> User Manual 2BO5T-TC226, 2BO5TTC226, tc226, TC226 WiFi Camera, TC226, WiFi Camera, Camera</p>
---	---

## References

- [User Manual](#)

📌 2BO5T-TC226, 2BO5TTC226, camera, tc226, TC226 WiFi Camera, WiFi Camera,

📁 xiaoqiangiot xiaoqiangiot

---

## Leave a comment

Your email address will not be published. Required fields are marked \*

Comment \*

Name

Email

Website

Save my name, email, and website in this browser for the next time I comment.

**Post Comment**

**Search:**

e.g. whirlpool wrf535swhz

**Search**

[Manuals+](#) | [Upload](#) | [Deep Search](#) | [Privacy Policy](#) | [@manuals.plus](#) | [YouTube](#)

This website is an independent publication and is neither affiliated with nor endorsed by any of the trademark owners. The "Bluetooth®" word mark and logos are registered trademarks owned by Bluetooth SIG, Inc. The "Wi-Fi®" word mark and logos are registered trademarks owned by the Wi-Fi Alliance. Any use of these marks on this website does not imply any affiliation with or endorsement.