



**MDZ-38-DB Portable
Speaker 30W**



xiaomi MDZ-38-DB Portable Speaker 30W Instructions

[Home](#) » [Xiaomi](#) » xiaomi MDZ-38-DB Portable Speaker 30W Instructions 

Contents

- 1 xiaomi MDZ-38-DB Portable Speaker 30W
- 2 Product Specifications
- 3 Product Usage Instructions
- 4 WHAT IN THE BOX
- 5 Bluetooth connection
- 6 Stereo pair
- 7 Multi-speaker pair
- 8 Calls
- 9 Instructions
- 10 Important Safety Information
- 11 Basic Specifications
- 12 WARRANTY NOTICE
- 13 FCC
- 14 Frequently Asked Questions
- 15 Documents / Resources
 - 15.1 References
- 16 Related Posts



xiaomi MDZ-38-DB Portable Speaker 30W



Product Specifications

- **Weight:** 68g
- **Color:** Pantone Cool Gray 11C
- **Size:** 1:1 mm
- **Bluetooth Version:** 5.0
- **Battery Life:** Up to 80%
- **Brand:** Xiaomi
- **Model:** Sound Outdoor
- **Special Feature:** Stereo pair, Multi-speaker pair
- **Maximum Multi-Speaker Pair:** Up to 100 Xiaomi Sound Outdoor speakers

Product Usage Instructions

Power On/Off

Long press the power button for 2 seconds to turn on the speaker and begin Bluetooth pairing. To turn off the speaker, press the power button for 2 seconds. Voice prompts will indicate the status.

Bluetooth Connection

To pair with a Bluetooth device, ensure the speaker is in pairing mode. Activate Bluetooth on your mobile phone, select “Xiaomi Sound Outdoor” from the list, and click to pair. A prompt will confirm the successful pairing. To

disconnect, short press the button for 2 seconds.

Stereo Pairing

Short press the button on each of the two speakers to pair them automatically as left and right channels. To disconnect, short-press the button on either speaker.

Multi-Speaker Pairing

Long press the button for 3 seconds on each speaker to pair all speakers automatically. All speakers will play the same content. To disconnect, long press the button for 3 seconds on each speaker. This function supports up to 100 Xiaomi Sound Outdoor pairs simultaneously.

Calls

If a call comes in while connected to a smartphone, the speaker will pause the music and play a ringtone. Short press the button to answer, and short press again to end the call. Long press for 2 seconds to reject the call. Long press for more than 1 second to switch between mobile and speaker.

Other Features

Long press both the “+” and “-” buttons for 2 seconds to clear the pairing list and restore default volume settings.

Indicator Light

1. **Indicator light blinking:** Bluetooth pairing mode or charging
2. Indicator light on Paired with a device or fully charged
3. **Indicator light fast blinking:** Two speakers searching for each other for TWS
4. **Indicator light slowly blinking:** Two speakers paired but not connected to a device

WHAT IN THE BOX

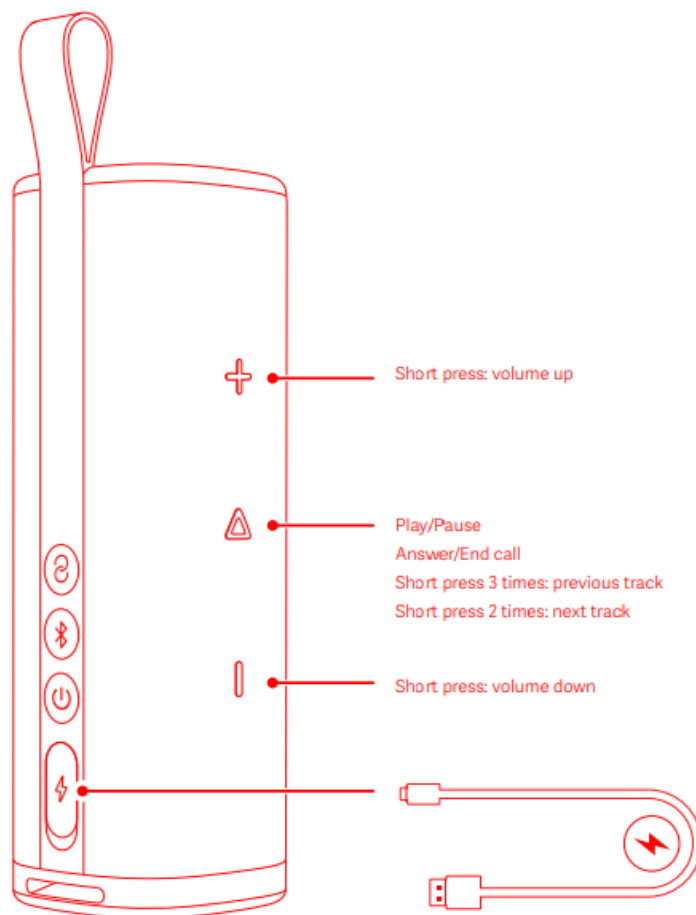

Bluetooth connection

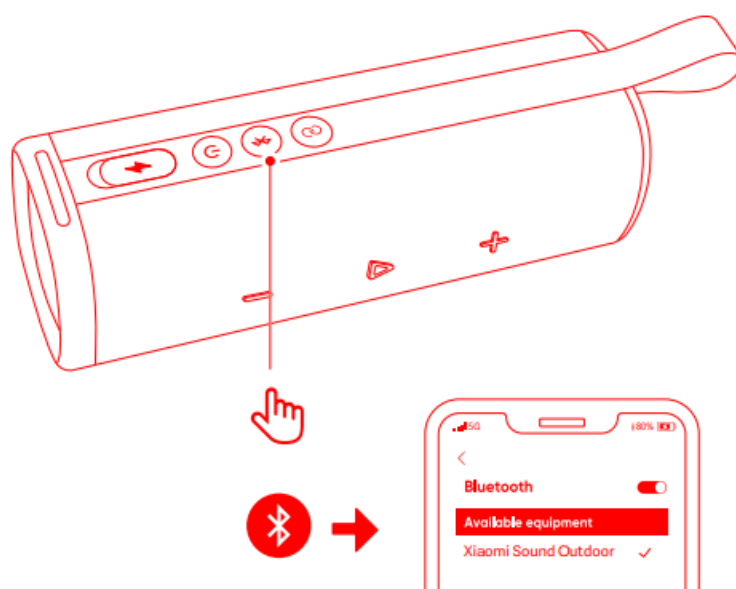

Stereo pair

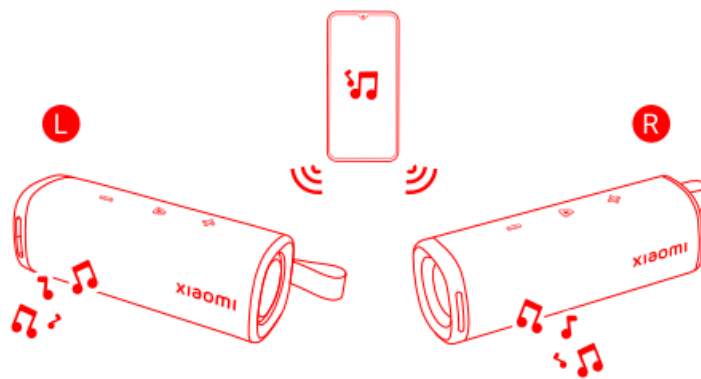

Multi-speaker pair

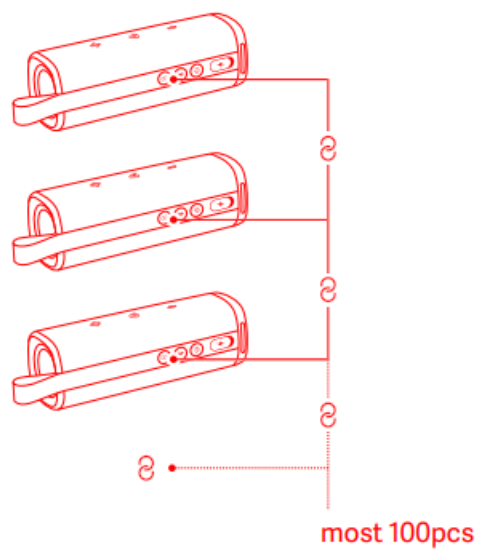

Calls

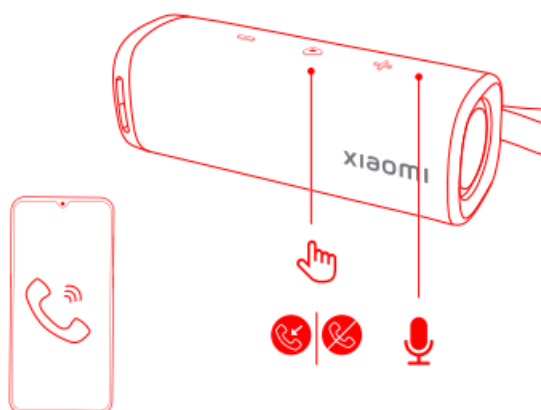

Important Safety Information

Refer to the user manual for detailed safety instructions and precautions.

Instructions

Power on/off

Long press the power button





for 2 seconds to turn on the speaker and begin Bluetooth pairing, or to turn the speaker off. This process includes voice prompts.

Bluetooth connection

When the speaker is in the Bluetooth pairing mode, turn on your mobile phone's Bluetooth functions, then select "Xiaomi Sound Outdoor" from the Bluetooth pairing list and click to pair. You will hear a prompt when pairing is successful. To disconnect the speaker, short press  button 2s and the speaker will switch to Bluetooth pairing mode.

Stereo pair

Short press  button each two speakers, and the two nearby speakers will pair automatically and operate as left and right channels respectively.





To disconnect, short press  button on either of the speaker.

Multi-speaker



pair Long press  button 3s on each speaker, and all speakers will pair automatically*. All speakers will play the same content.

To disconnect, long press button 3s on each speaker. *Multi-speaker pair function can support at most 100pcs Xiaomi Sound Outdoor pair at the same time.

Calls

If a call comes in when the speaker is connected to a smartphone, the speaker will automatically pause the music and play a ringtone. When this happens, short press  button to answer; short press  button again to end the call. Long press  button for 2 seconds to reject the call. long press "  " more than 1s to switch between mobile and speaker.

Other Features

Long press the  and  button 2s to clear the pairing list and restore the default volume.

Indicator Light

1. **Indicator light blinking:** The speaker is in the Bluetooth pairing mode. The speaker is charging.
2. **Indicator light on:** The speaker is paired with a device, such as a smartphone. The speaker finish charging
3. **Indicator light fast blinking:** Two speakers are searching for each other for TWS.
4. **Indicator light slowly blinking:** Two speakers pair successfully but are not connected to a smartphone or other devices.

Important Safety Information

Read all safety information below before using your device:

- Use of unauthorized cables, power adapters, or batteries can cause fire, explosion, or pose other risks.
- Use only authorized accessories which are compatible with your device.
- This device's operating temperature range is 0°C to 40°C. Using this device in an environment outside of this

temperature range may damage the device.

- If your device is provided with a built-in battery, to avoid damaging the battery or the device, do not attempt to replace the battery yourself.
- Charge this device only with the included or authorized cable and power adapter. Using other adapters may cause fire, electric shock, and damage the device and the adapter.
- After charging is complete, disconnect the adapter from both the device and the power outlet. Do not charge the device for more than 12 hours.
- The battery must be recycled or disposed of separately from household waste. Mishandling the battery may cause fire or explosion. Dispose of or recycle the device, its battery, and accessories according to your local regulations.
- Do not disassemble, hit, crush, or burn the battery. If the battery appears deformed or damaged, stop using it immediately.
- Do not short circuit the battery, as this may cause overheating, burns, or other injury.
- Do not place the battery in a high-temperature environment.
- Overheating may cause explosion.
- Do not disassemble, hit, or crush the battery, as this may cause the battery to leak, overheat, or explode.
- Do not burn the battery, as this may cause fire or explosion.
- If the battery appears deformed or damaged, stop using it immediately.
- User shall not remove or alter the battery. Removal or repair of the battery shall only be done by an authorized repair center of the manufacturer.
- Keep your device dry.
- Do not try to repair the device yourself. If any part of the device does not work properly, contact Xiaomi customer support or bring your device to an authorized repair center.
- Connect other devices according to their instruction manuals. Do not connect incompatible devices to this device.
- For AC/DC adapters, the socket-outlet shall be installed near the equipment and shall be easily accessible.

CAUTION

- RISK OF EXPLOSION IF BATTERY IS REPLACED BY AN INCORRECT TYPE.
- DISPOSE OF USED BATTERIES ACCORDING TO INSTRUCTIONS.

Basic Specifications

- **Product model no.:** MDZ-38-DB
- **Supports:** A2DP V1.4, AVRCP V1.6.2, HFP V1.8
- **Rated output power:** 1×20W , 1×10W
- **Battery:** Lithium-ion, 7.2V, 2600mAh
- **Play duration:** approx. 12 hours (at 50% volume)
- **Bluetooth transmitter power:** <10dBm
- **Bluetooth transmitter modulation:** GFSK, $\pi/4$ -DQPSK, 8-DPSK
- **Speaker unit:** 2 speaker
- **Bluetooth version:** 5.4
- **Signal-to-noise ratio:** ≥80dB

- **Battery charging:** 5V 3A, 2.5hours
- **Frequency range:** 60Hz to 20KHz

WARRANTY NOTICE

THIS LEGAL WARRANTY NOTICE INFORMS YOU ABOUT YOUR RIGHTS UNDER THE LEGAL WARRANTY. FOR A FULL UNDERSTANDING OF YOUR RIGHTS YOU ARE INVITED TO CONSULT THE LAWS OF YOUR COUNTRY, PROVINCE OR STATE.

The duration and conditions related to the legal warranties are provided by respective local laws. For more information about the consumer warranty benefits, please refer to Xiaomi's official website

<https://www.mi.com/global/support/warranty>. If you have purchased the Product directly from Xiaomi. In all other cases, please consult your seller. There is no guarantee that the operation of the Product will be uninterrupted or error-free. Damages arising from non-compliance with the instructions related to the use of the Product are excluded. If a hardware defect is found within the Warranty period, the Product will be either (1) repaired, (2) replaced, or (3) refunded, depending on your rights under local laws. Normal wear and tear, force majeure, abuse or damage caused by the user's negligence or fault are not warranted. The contact person for the after-sales service may be any person in Xiaomi's authorized service network, Xiaomi's authorized distributors or the final vendor who sold the Products to you. The present warranty does not apply in Hong Kong and Taiwan. Products that were not duly imported and/or were not duly manufactured by Xiaomi and/or were not duly acquired from Xiaomi or Xiaomi's official seller are not covered by the present warranties. As per applicable law you may benefit from warranties from the non-official retailer who sold the Product. Therefore, Xiaomi invites you to contact the retailer from whom you purchased the Product.

Notes

RoHS compliance – European Union Xiaomi products sold in the European Union, meet the requirements of Directive 2011/65/EU and its subsequent amendments directive (EU) 2015/863 on the restriction of the use of certain hazardous substances in electrical and electronic equipment

Simplified EU Declaration of Conformity

Hereby, Beijing Xiaomi Electronics Co.,Ltd declares that the radio equipment type Xiaomi Sound Outdoor is in compliance with Directive 2014/53/EU. The full text of the EU declaration of conformity is available at the following internet address: <http://www.mi.com/global/service/support/declaration.html>

FCC

RF Frequency and Power

This device offers the following frequency bands in EU areas only and maximum radio-frequency power Bluetooth: 20 dBm For the purpose of recycling to facilitate effective utilization of resources, please return this product to a nearby authorized Collection Centre, registered Dismantler or Recycler when disposing of this product. What the Wheelie Bin symbol means: The symbol says don't dispose your e-waste into the municipal waste collection bins. That's because these wastes are hazardous in nature and need to be recycled in a special way.

NOTE: This equipment has been tested and found to comply with the limits for a Class B digital device, pursuant to part 15 of the FCC Rules. These limits are designed to provide reasonable protection against harmful interference in a residential installation. This equipment generates, uses and can radiate radio frequency energy and, if not installed and used in accordance with the instructions, may cause harmful interference to radio communications. However, there is no guarantee that interference will not occur in a particular installation. If this equipment does cause harmful interference to radio or television reception, which can be determined by turning the equipment off and on, the user is encouraged to try to correct the interference by one or more of the following measures:

- Reorient or relocate the receiving antenna.
- Increase the separation between the equipment and receiver.
- Connect the equipment into an outlet on a circuit different from that to which the receiver is connected.

- Consult the dealer or an experienced radio/TV technician for help

Changes or modifications not expressly approved by the party responsible for compliance could void the user's authority to operate the equipment. This device complies with Part 15 of the FCC Rules. Operation is subject to the following two conditions: (1) this device may not cause harmful interference, and (2) this device must accept any interference received, including interference that may cause undesired operation. This device contains licence-exempt transmitter(s)/receiver(s) that comply with Innovation, Science and Economic Development Canada's licence-exempt RSS(s).

Operation is subject to the following two conditions:

1. This device may not cause interference.
2. This device must accept any interference, including interference that may cause undesired operation of the device.

Frequently Asked Questions

- **Q: How do I reset the speaker?**
 - A: Long press both the "+" and "-" buttons for 2 seconds to clear the pairing list and restore default settings.
- **Q: How many Xiaomi Sound Outdoor speakers can be paired simultaneously?**
 - A: The multi-speaker pair function supports up to 100 Xiaomi Sound Outdoor pairs at the same time.
- **Q: How do I know if two speakers are successfully paired in stereo mode?**
 - A: The indicator light will slowly blink when two speakers are paired successfully but not connected to any device.

Documents / Resources

	xiaomi MDZ-38-DB Portable Speaker 30W [pdf] Instructions MDZ38DB, 2AIMR-MDZ38DB, MDZ-38-DB Portable Speaker 30W, MDZ-38-DB, Portable Speaker 30W, Speaker 30W
---	--

References

-  [Xiaomi UK | Mobile Phone | Xiaomi Official Website](#)
-  [smartphone.de](#)
-  [Xiaomi Global Home](#)
-  [Xiaomi Japan](#) | [Xiaomi](#) | [Xiaomi](#)
- [User Manual](#)

[Manuals+](#), [Privacy Policy](#)

This website is an independent publication and is neither affiliated with nor endorsed by any of the trademark owners. The "Bluetooth®" word mark and logos are registered trademarks owned by Bluetooth SIG, Inc. The "Wi-Fi®" word mark and logos are registered trademarks owned by the Wi-Fi Alliance. Any use of these marks on this website does not imply any affiliation with or endorsement.