



xiamen TinyLock Smart Fingerprint Password NFC Bluetooth Zigbee Lock User Manual

[Home](#) » [Xiamen](#) » xiamen TinyLock Smart Fingerprint Password NFC Bluetooth Zigbee Lock User Manual 

xiamen TinyLock Smart Fingerprint Password NFC Bluetooth Zigbee Lock User Manual



Contents

- 1 ACCESSORY
- 2 DOOR OPENING
- 3 SHIFT THE LEFT AND RIGHT
- 4 ADJUST THE MARTISE DIRECTION
- 5 CAUTION BEFORE INSTALLTION
- 6 INSTALLATION
- 7 Check points after installation
- 8 ACCESS DOOR LOCK FUNCTION MANAGEMENT
- 9 APP CONFIGURATION
- 10 Documents / Resources
- 11 Related Posts

ACCESSORY

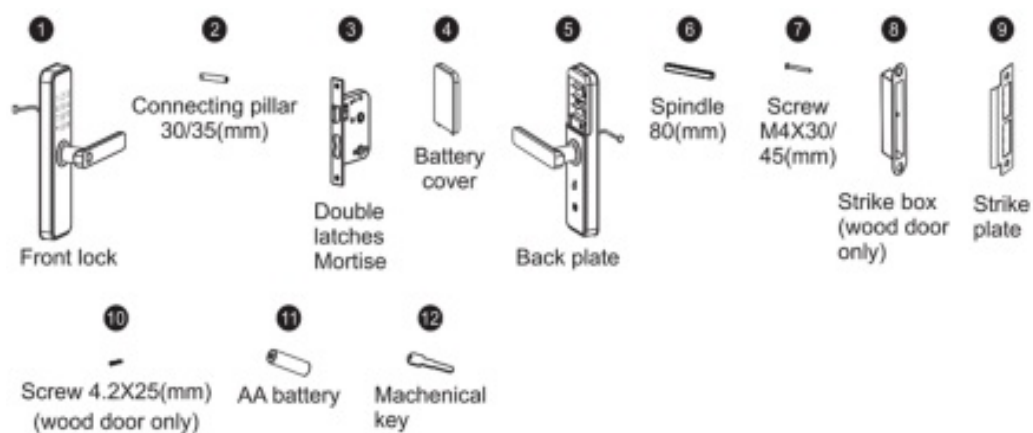

DOOR OPENING

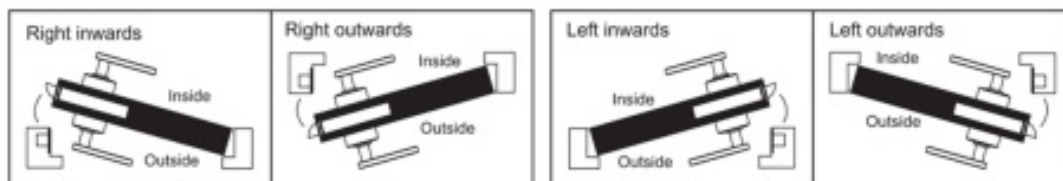

SHIFT THE LEFT AND RIGHT

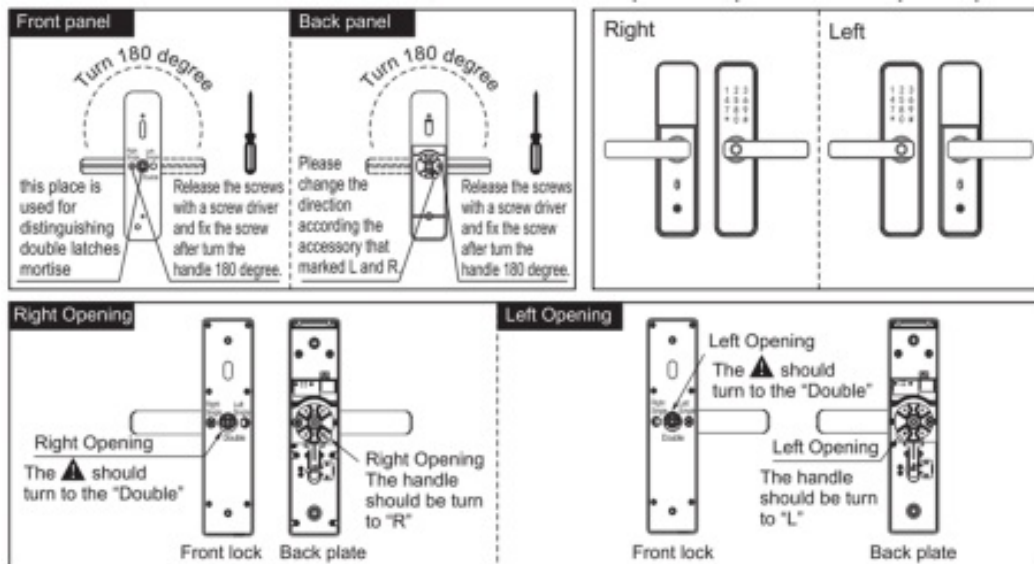

ADJUST THE MARTISE DIRECTION



CAUTION BEFORE INSTALLTION



INSTALLATION

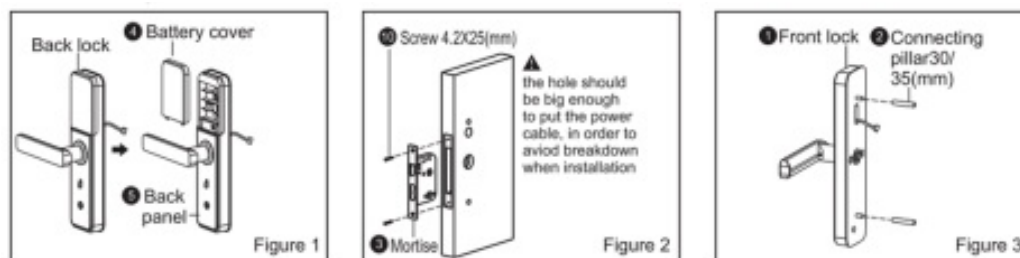

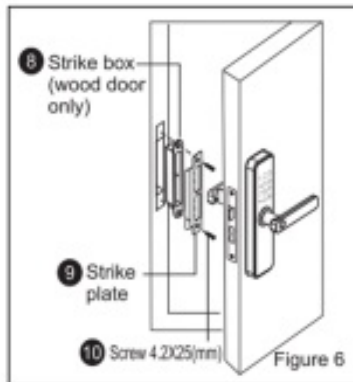
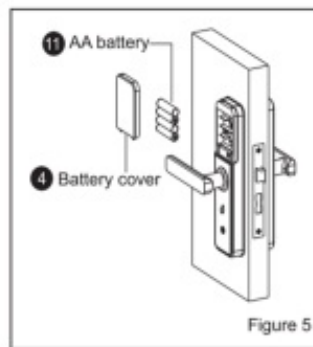
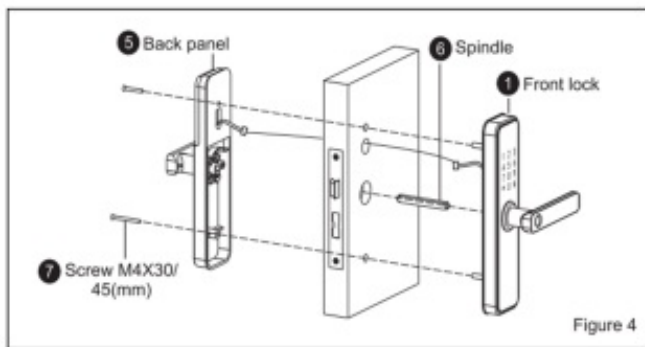

Check points after installation

1. The face plate a bandontal shah the door.
2. The latch boll Dead bad and Seamy Ben must laorks smoothy and “ug*"
3. The Front lona is verbcac and Stable

INITIAL INFORMATION

- Key clear key/back key.
- Keylal: confirmation key or menu function key.
- To open the door with a password, have to touch the keypad or fingerprint head to activate the button light (fingerprint headlight is a breathing effect), and then press the (a) key to confirm after entering the password.
- To open the door with cards,there is no need to activate the button light, just swipe the card directly.
- To open the door with fingerprints,there is no need to activate the button light.Enter fingerprint directly.
- If the verification is successful, the lock is unlocked by voice broadcast, the green light is on, and it flashes every 1 second. It will be automatically locked after a few seconds.
- If the verification fails, the button light flashes 3 times, the fingerprint head lights up in red, and the voice prompts the operation to fail.

ORIGINAL STATE

- The factory administrator initial password is “123456”, under the initial state any fingerprint, IC card or password can open the lock. (for safety, the default password must be changed after normal use!)
- Any fingerprint, IC card or password which are not input can't open the lock after inputting the administrator information.
- After entering the administrator menu:

1. Add unlocking information
2. Delete unlocking information
3. Change management code
4. Volume setting
5. Language setting

ACCESS DOOR LOCK FUNCTION MANAGEMENT

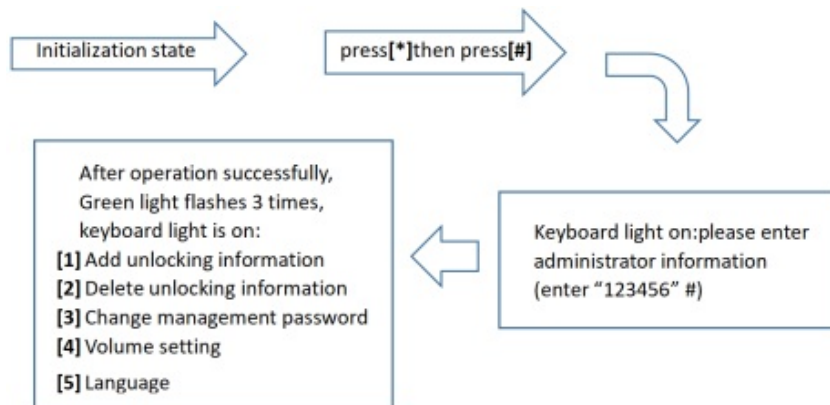

ADD USERS INFORMATION

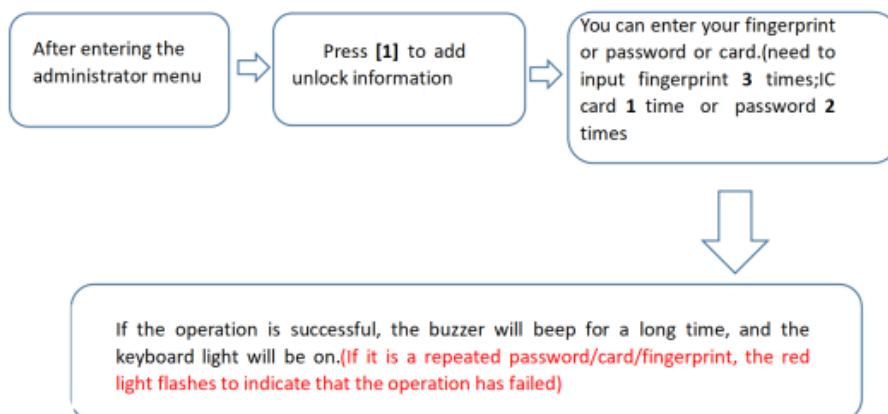

3.2- DELETE USERS

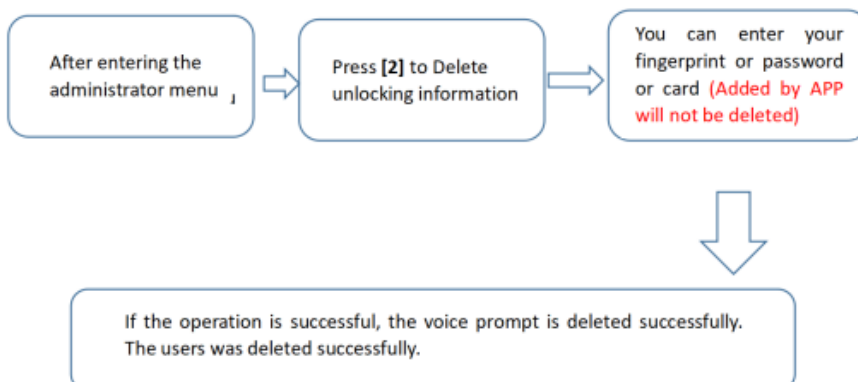

CHANGE MANAGEMENT INFORMATION

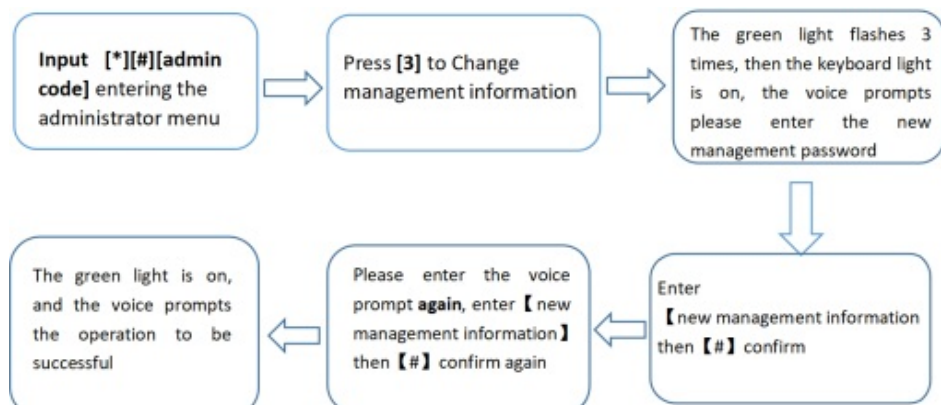

VOICE SETTING

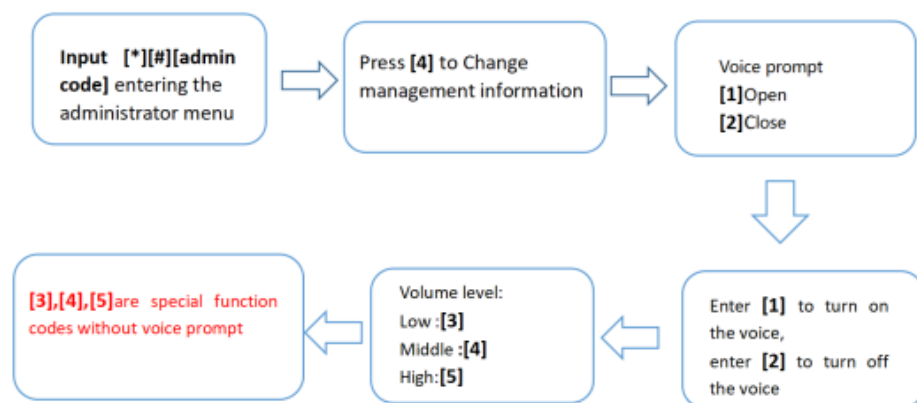

- The volume will not be muted in the administrator menu mode. The volume is set to high by default. It will be executed after exiting the administrator after the voice setting is completed.
- If the voice is turned off, the flashing keyboard light will be used as a reminder when you press the number keys.
- Press [•] [tt] Even if the voice is turned off, there will be voice prompts to enter the menu

LANGUAGE SELECTION

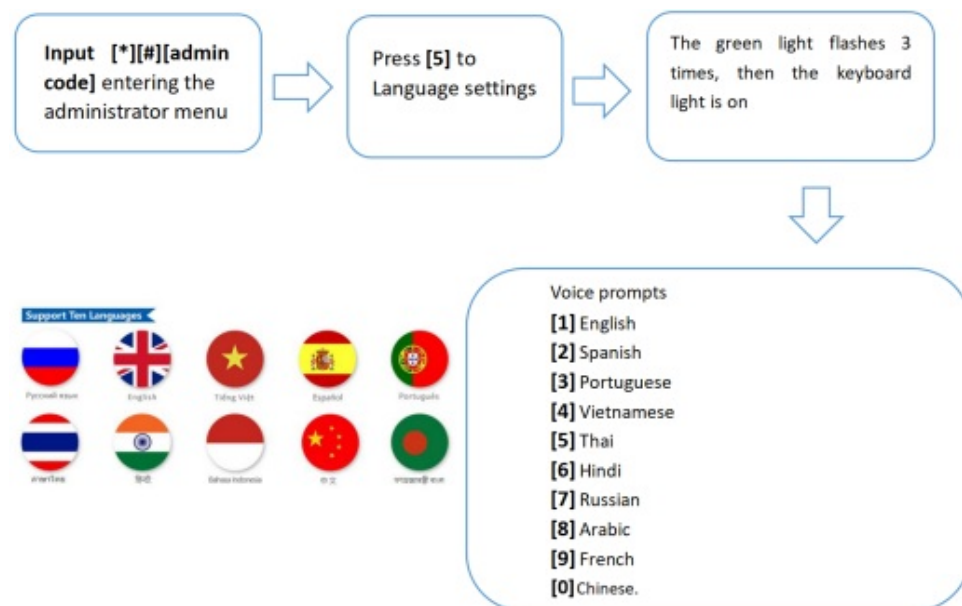

- Toggle the button on the back of the lock to turn on the safe mode. In this state, the door lock can only be opened by the management password. This mode prohibits the user from unlocking the lock by password/fingerprint/card, and disables all Bluetooth functions. (Some models do not support this function)



APP CONFIGURATION

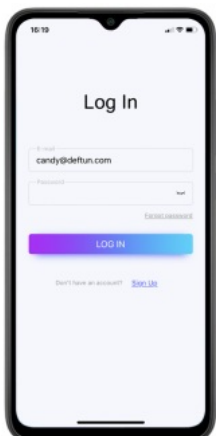

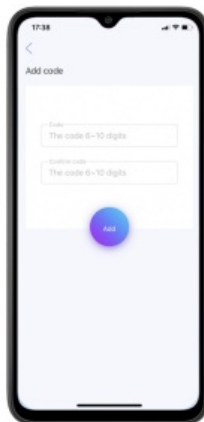
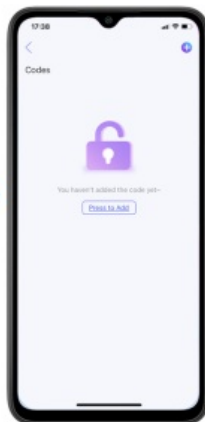
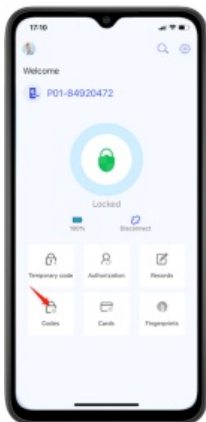
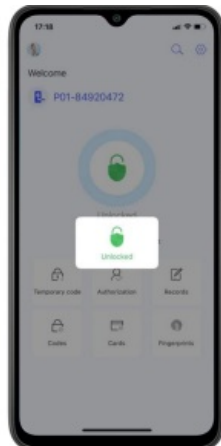
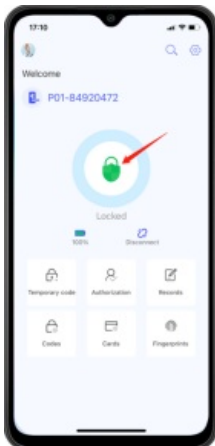
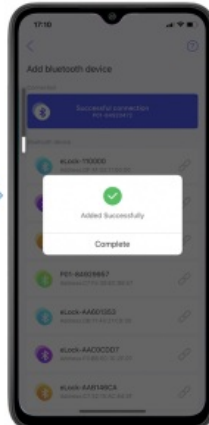
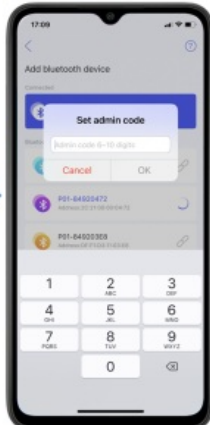
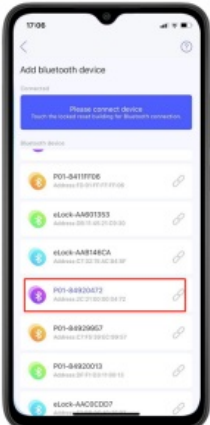
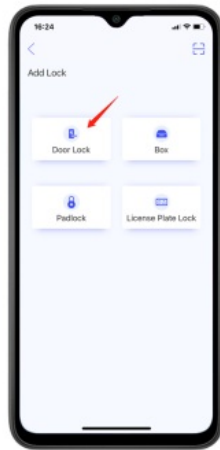
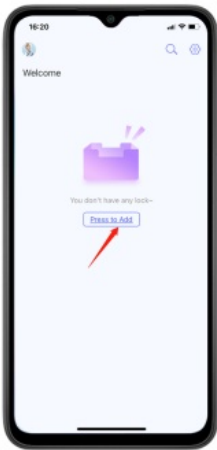

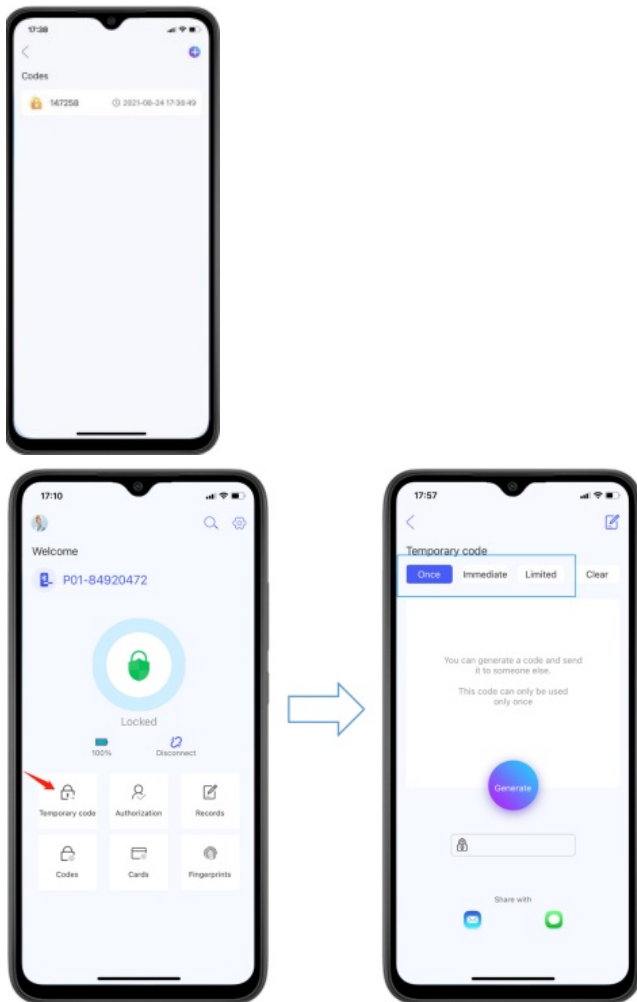

Record

You can see all the unlocking records in the “records”home page .
Some notes:

1. Phenomenon: The voice prompts that the battery is low, and the green light and keyboard light flash alternately and quickly 6 times at the same time. Reason: The battery is low. Solution: Replace the battery as soon as possible.
2. Phenomenon: The voice prompts that the system is locked, the fingerprint head lights up in red, the green light flashes 3 times, then the light goes out, and the device enters the dormant standby state. Reason: Entering incorrectly for 10 consecutive times, the device is locked. Processing method: wait for 60s.
3. Suggestion: The mechanical key is used for emergency door opening and should be kept outdoors for backup, such as in a car. It is not recommended to keep all the keys indoors.

FCC Warning:

This equipment has been tested and found to comply with the limits for a Class B digital device. pursuant to part 15 of the FCC Rules. These Emissions are designed to provide reasonable protection against harmful interference in a residential installation. This equipment generates, uses and can radiate radio frequency energy and, if not installed and used in accordance with the instructions, may cause harmful interference to radio communications. However, there is no guarantee that interference will not occur in a particular installation. If this equipment does cause harmful interference to radio or television reception, which can be determined by turning the equipment off and on, the user is encouraged to try to correct the interference by one or more of the following measures: Reorient or relocate the receiving antenna.

- Increase the separation between the equipment and receiver.
- Connect the equipment into an outlet on a circuit different from that to which the receiver is connected.
- Consult the dealer or an experienced radio/TV technician for help. Caution: Any changes or modifications to this device not explicitly approved by manufacturer could void your authority to operate this equipment. This device complies with part 15 of the FCC Rules. Operation is subject to the following two conditions: (1) This device may not cause harmful interference. and (2) this device must accept any interference received, including interference that may cause undesired operation. This equipment complies with FCC radiation exposure limits set forth for an uncontrolled environment. This equipment should be installed and operated with minimum distance 0cm between the radiator and your body.

Documents / Resources

	<p>xiamen TinyLock Smart Fingerprint Password NFC Bluetooth Zigbee Lock [pdf] User Manual</p> <p>2BAI9-NB6601, 2BAI9NB6601, nb6601, NB6601 Smart Fingerprint Password NFC Bluetooth Zigbee Lock, Smart Fingerprint Password NFC Bluetooth Zigbee Lock, Fingerprint Password NFC Bluetooth Zigbee Lock, Password NFC Bluetooth Zigbee Lock, Bluetooth Zigbee Lock, Zigbee Lock</p>
---	---