



# Xhorse KEY TOOL MAX PRO Multi-Language Remote Programmer User Manual

[Home](#) » [Xhorse](#) » Xhorse KEY TOOL MAX PRO Multi-Language Remote Programmer User Manual 

## Contents

- [1 Xhorse KEY TOOL MAX PRO Multi-Language Remote Programmer](#)
- [2 Overview](#)
- [3 Main Functions](#)
- [4 Performance](#)
- [5 Appearance](#)
- [6 Packing List](#)
- [7 Setting](#)
- [8 Maintenance](#)
- [9 Warranty And After-Sale Instructions](#)
- [10 Documents / Resources](#)
- [11 Related Posts](#)



**Xhorse KEY TOOL MAX PRO Multi-Language Remote Programmer**



## Overview

KEY TOOL MAX PRO is a professional smart device with multi-function, Bluetooth and WIFI communication interface are integrated inside, which is convenient for connecting and controlling Xhorse Key Cutting Machine. Supports various OBD functions such as Vehicle diagnosis, Immo programming, Throttle program, TPMS, and the Maintenance light reset.

## Main Functions

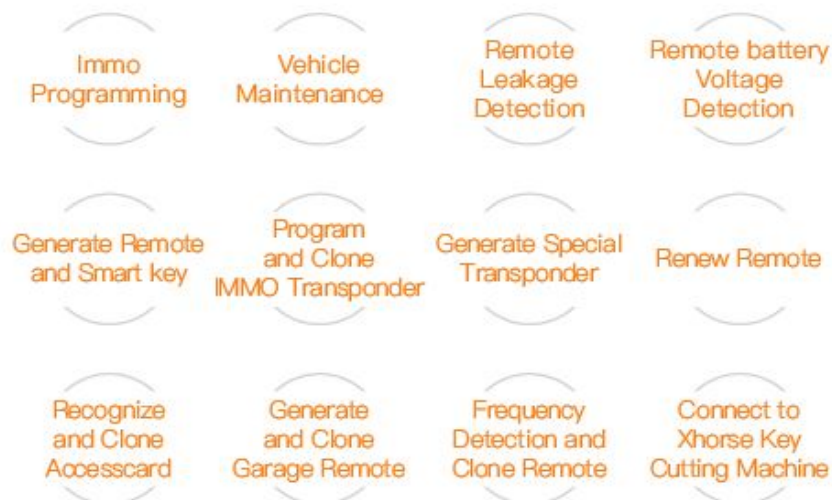

Performance

			
Battery capacity 3375mAh	Battery life >6Hours	Stand time >5Days	Recharging current 1.5A
			
Brightness >400nits	Screen resolution 1280*720P	Camera resolution 800W	WiFi & Bluetooth 802.11a/b/g/n/ac & 4.2 BLE

Appearance

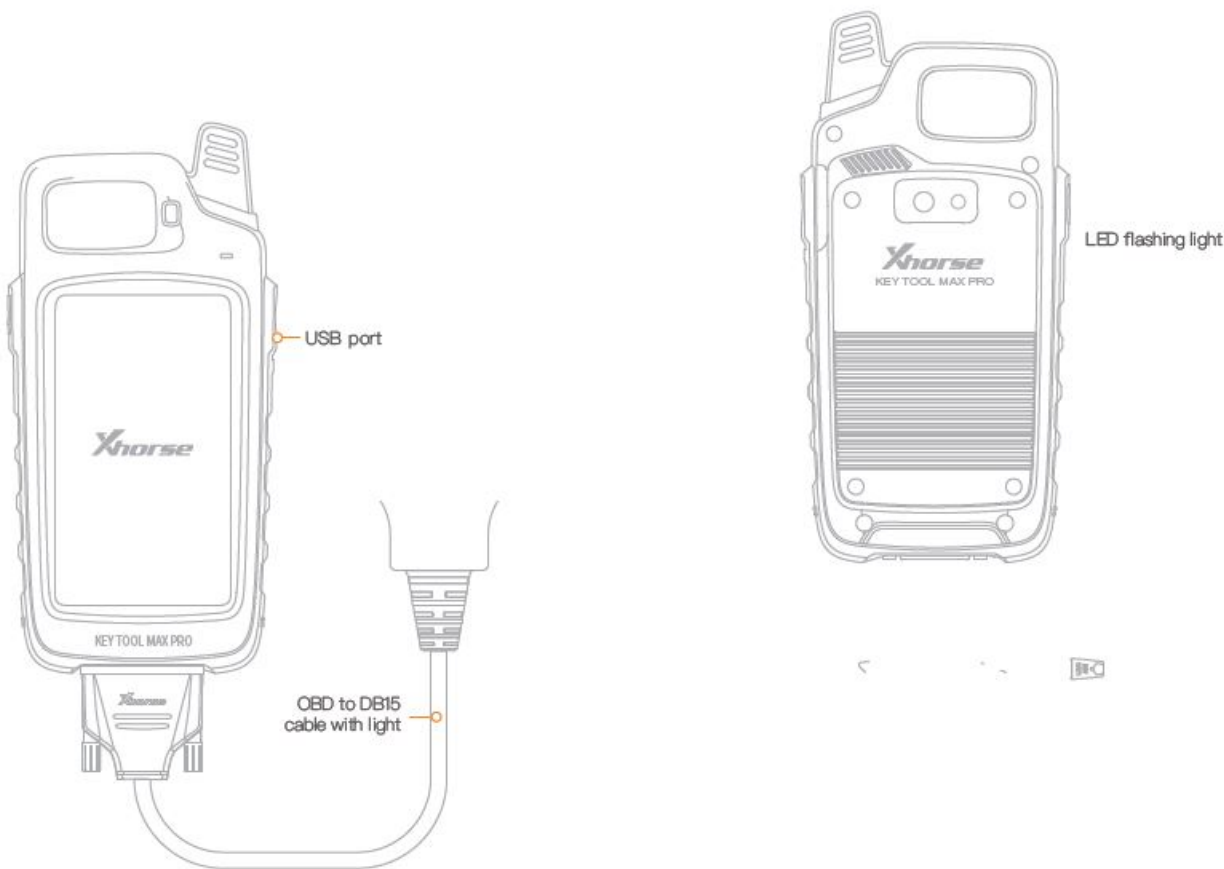

## Packing List

Item	Quantity
KEY TOOL MAX PRO device	1
OBD to DB15 cable with light	1
Remote programming cable	1
Leakage detection cable	1
USB cable	1
User Manual	1

## Setting

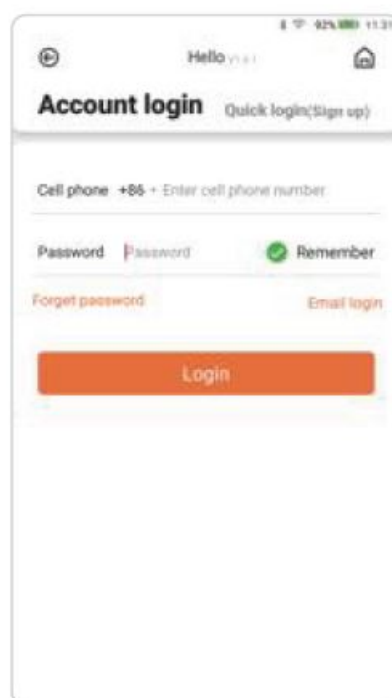

### First Time to use

For the first time turning on the KEY TOOL MAX PRO, you need to select language, region (System default setting is China Standard Time Zone), connect to WIFI, login with a registered account, if you don't have an account, please register as the picture on the left.

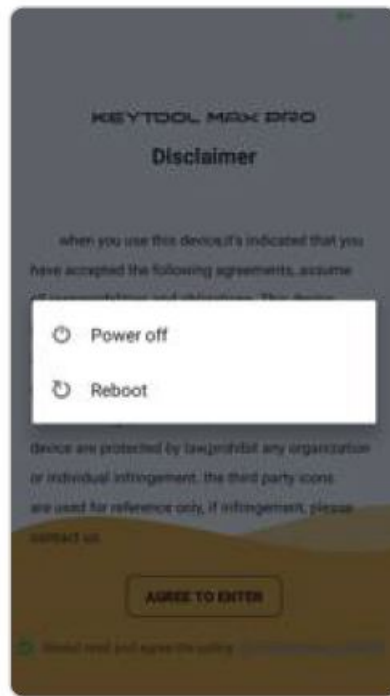

### Power Off

Before entering the system, Press and hold the On/off button for a while, 'power off and 'restart will be shown on the Screen, click on 'power off, device will shut down.



### Power Off

Before entering the system, Press and hold the On/off button for a while, 'power off and 'restart will be shown on the Screen, click on 'power off, device will shut down.



### After entering the system

Press and hold the On/off button for a while, the interface displays the following icons, click to shut down Option, the device will shut down.

### Indicator status

(D When the device is turned on or charging, the POW indicator light is on. When the device is working, the CON indicator is on.

### Device reset

Press the On/Off button for 12 seconds, the device will restart automatically. Press the On/Off button about 1-2 seconds, the screen displays shutdown and restart options, select the corresponding option to shut down or restart the device.

### Maintenance

Do not hit it violently. shake or throw it. Do not wash main body and other parts with water or other liquid directly, and do not clean KEY TOOL MAX PRO with wet cloth. Do not place KEY TOOL MAX on high temperature, high humidity or dusty places. Do not take KEY TOOL MAX PRO apart or retrofit it in private both otherwise mainboard will be damaged or battery will on fire and etc.

Please keep screen, camera and other key parts well and prevent sharp objects to do damage to them. The leakage detection and voltage detection functions are limited to the leakage detection and voltage detection or the remote, please do not use it for the detection of other products. All functions should be used strictly in accordance with the scope of use of the device, as exceeding the scope will damage the device.

### Warranty And After-Sale Instructions

KEY TOOL MAX PRO has one year warranty, and it is based on the date on the transaction voucher, if do not have transaction Voucher or lost it, the factory date recorded by the manufacturer will prevail. situations on the below can not get free repairment

- Damage caused by not following the use instructions.
- Damage caused by repairing or retrofitting in private.
- Damage caused by fall, crash or inappropriate voltage.
- Damage caused by inevitable force.
- Damage caused by using in harsh environment or on the vehicle and ship for a long time; Get main body dirty

and won't be able to use.

- Please get in contact with the dealer or scan the QR code behind the instruction, and download Xhorse official APP to get after-sale and technical support.
- Xhorse reserves all rights to this manual. Without permission, it is forbidden for any individual or organization to use any form of reproduction and dissemination of any part of this manual. Due to product improvements, the contents of this manual may be changed without notice.

## Documents / Resources

	<a href="#">Xhorse KEY TOOL MAX PRO Multi-Language Remote Programmer</a> [pdf] User Manual KEY TOOL MAX PRO, Multi-Language Remote Programmer, Language Remote Programmer, Remote Programmer, KEY TOOL MAX PRO, Programmer
---	--