



Xesi DD95 Curve Shape Handrail Installation Guide

[Home](#) » [Xesi](#) » Xesi DD95 Curve Shape Handrail Installation Guide 

Contents

1 DD95 Curve Shape Handrail

2 DD95 Curve Shape Handrail

3 LIMITED WARRANTY

4 Documents / Resources

4.1 References

DD95 Curve Shape Handrail



60 mins



CURVE SHAPE HANDRAIL
SKU: DD95, LMN1

DD95 Curve Shape Handrail

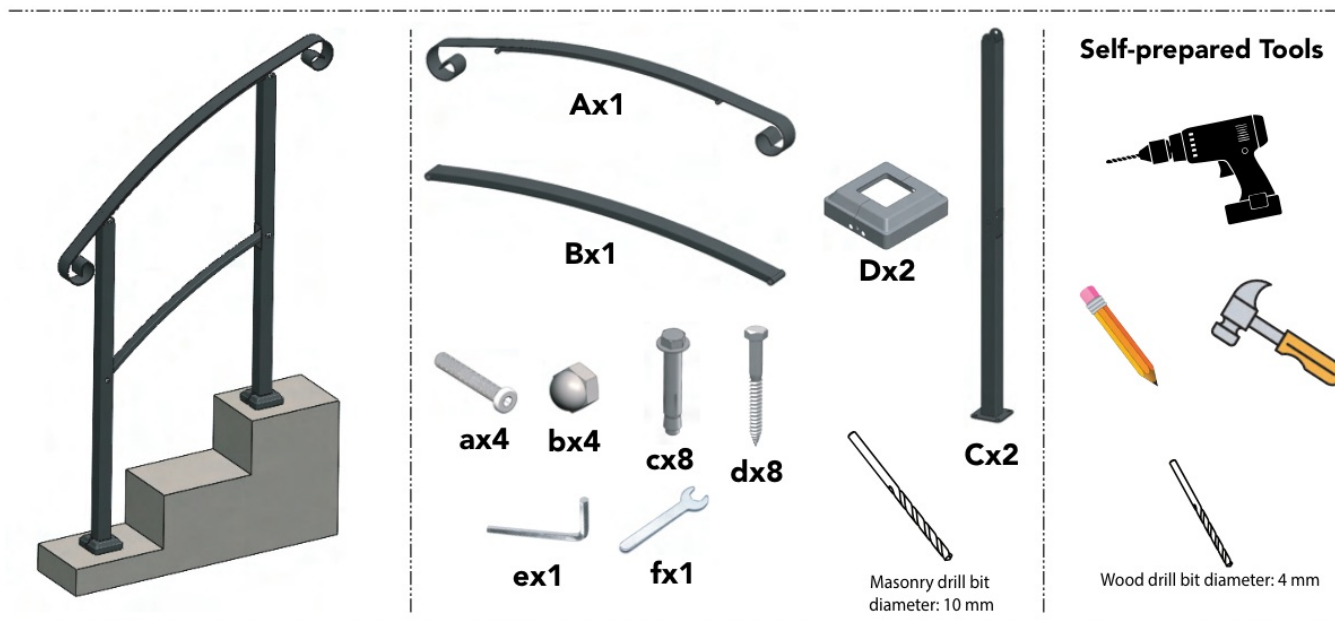

NOTE:

THE SCREWS MUST BE LOOSELY TIGHTENED DURING ASSEMBLY PROCESS AND MADE THEM TIGHTER AFTER STEP 4

1

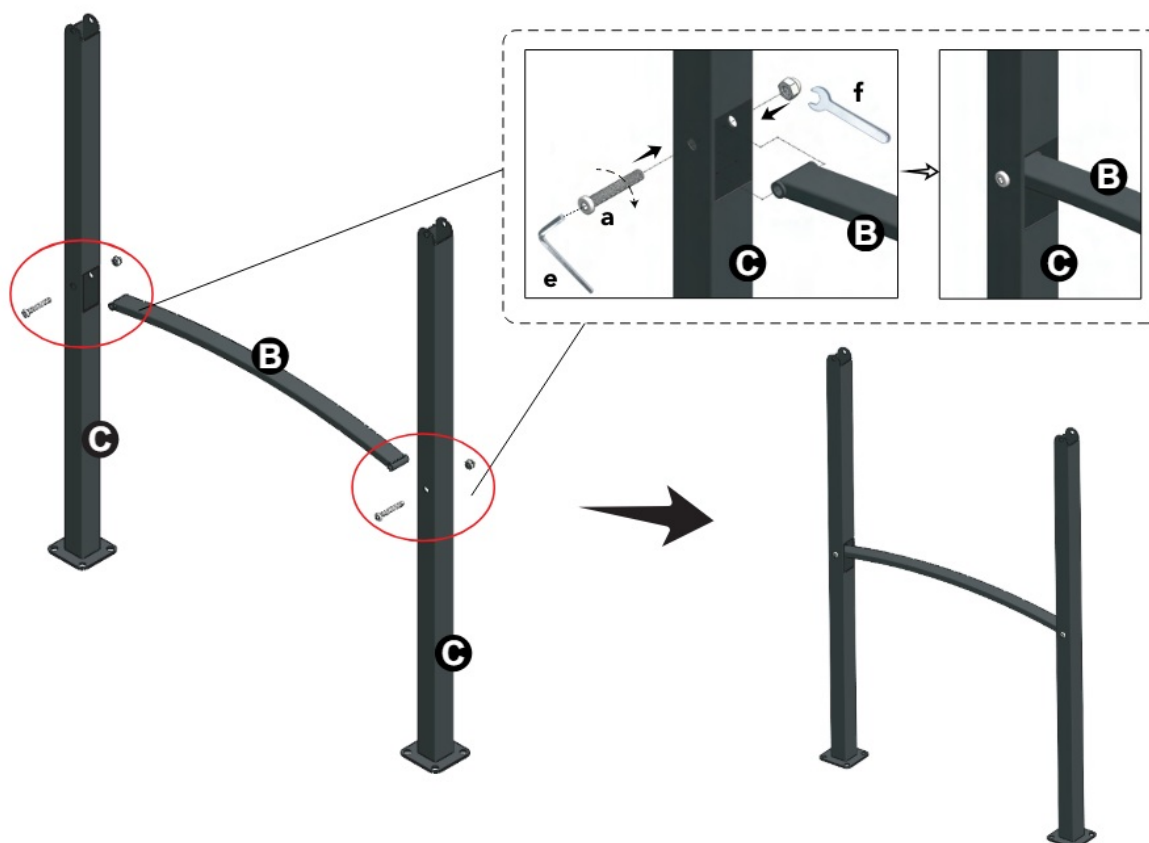

2

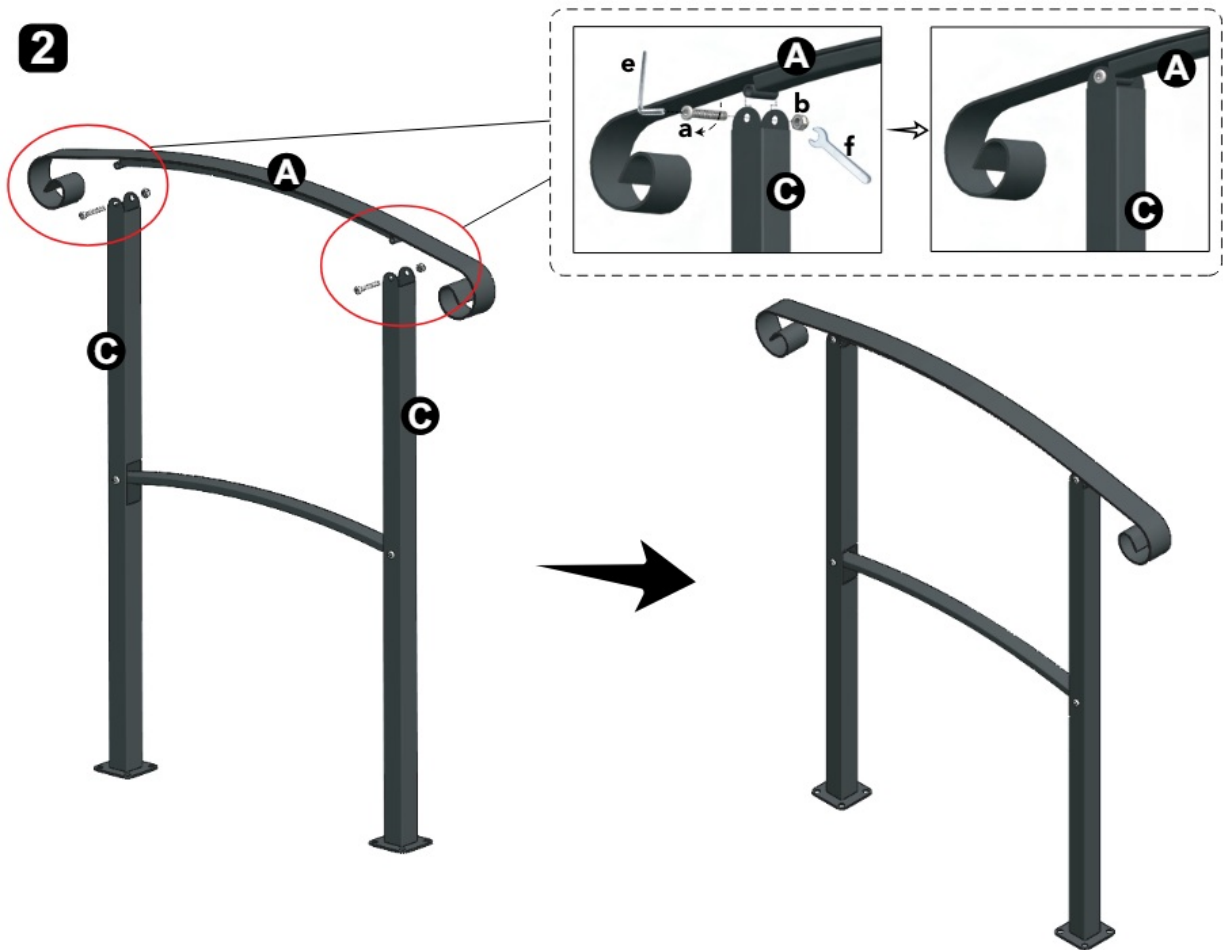

3

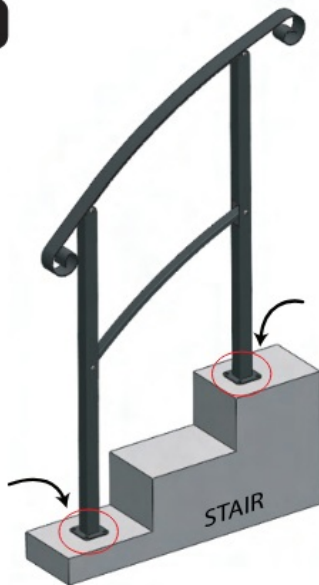

● Position Handrail on your stair, and then mark for holes drilling

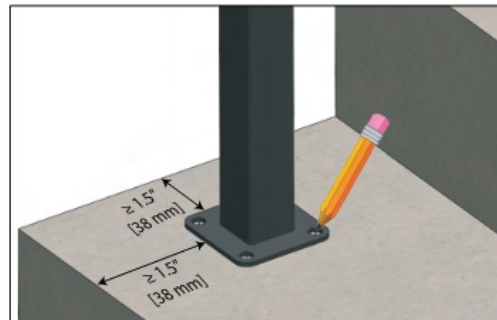

● Locate at least 1 inch away from the stair edges

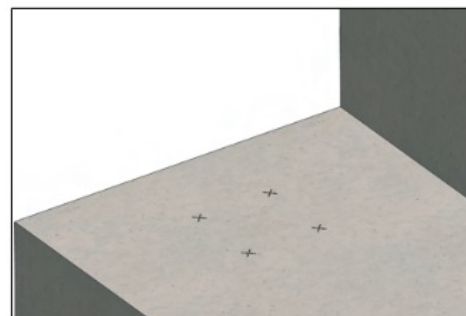

4.1 (For concrete)

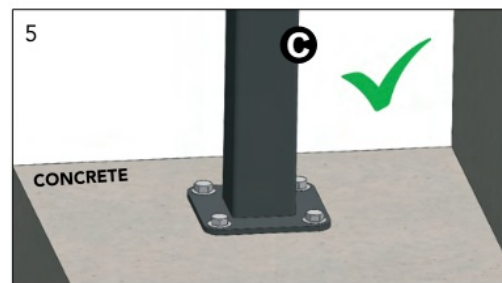
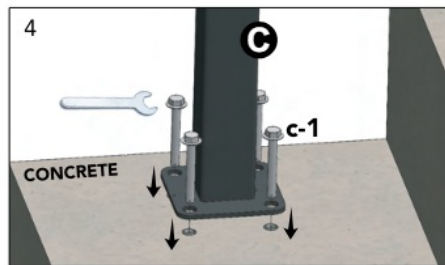
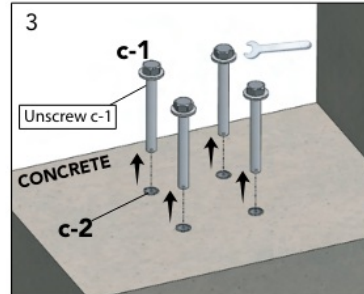
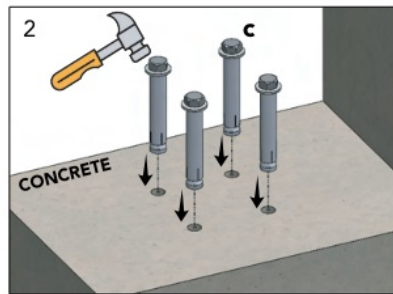
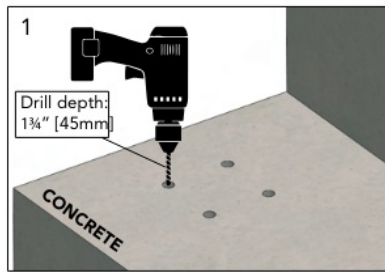

The hole that's too big or the concrete that's not up to standard grade can cause the anchor wiggle or possibility of coming out, then lead to low sturdiness of the handrail

4.2 (For wood)

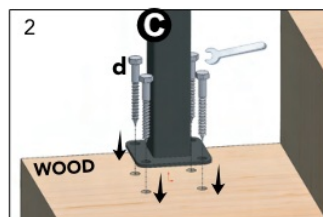
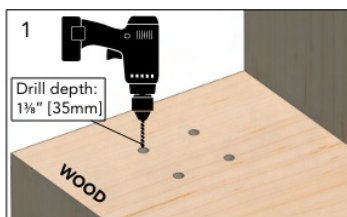
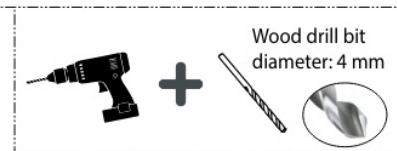

5

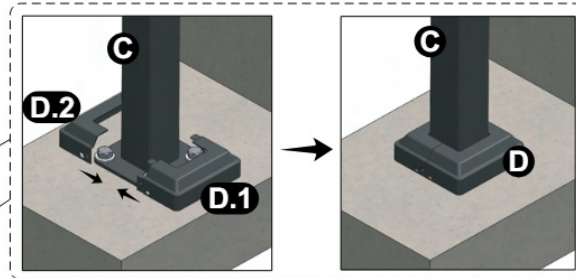
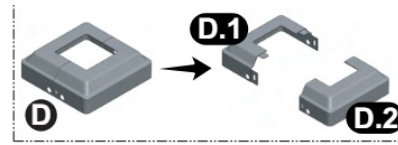
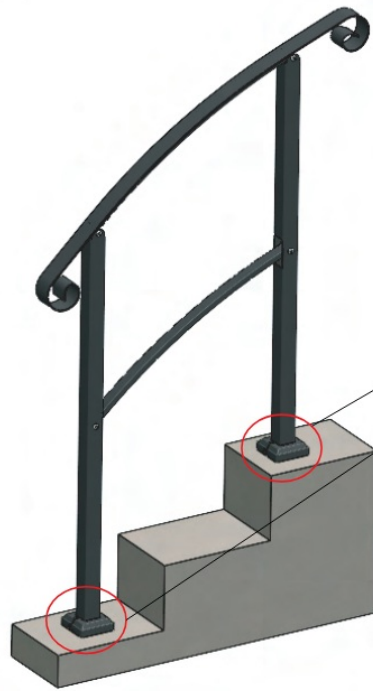

EXERCISE

For exercise and instruction, please refer to your instructor and professional trainer or Youtube.

RETURN

In case of any defect or concern, within 30 days contact us for free replacement and support solution by Yes4all LLC Care Team.

Email: contact@yes4all.com

WARNING

Risk of suffocation! Keep any packaging materials away from children and pets – these materials are a potential source of danger, e.g suffocation.

- The images related to the exercises are for product introduction, not for training instructions.
- Read these instructions carefully and retain them for future use. If this product is passed to a third party, then these instruction must be included.
- Consult a physician before starting any training session. Stop exercising if you feel faint or short of breath.
- Wear comfortable clothing and non-slip sneakers for training.
- Do not overexert during exercise.
- Use the product on a stable, level surface with protective covering.
- Inspect the product prior to each use. Do not use the product with worn or damaged parts.
- Store the product in a location out of reach of children and pets.

LIMITED WARRANTY

Under no circumstances shall Yes4All, or its affiliates, owners, officers, directors, employees, agents, suppliers, or trainers be liable to you or its third party for injuries or any other damages of any nature arising out of or in connection with of the use or improper use or inability to use this product or any other legal theory and whether or not advised of the possibility of such damages.

You or a third party understand and acknowledge that there is a risk of injury and danger associated with using this product in accordance with the images related to the exercises in the manual. Yes4All or its affiliates, owners, officers, directors, employees, agents, suppliers, or trainers shall not be held liable under any circumstance for any injuries, incidental or consequential losses, claims, or damages that might incur as a result of your or the third party's using this product in accordance with the images related to the exercises in the manual.

This is a comprehensive limitation of liability that applies to all losses and damages of any kind (whether direct, indirect, general, special, consequential, incidental, exemplary, or otherwise), whether the claim is in contract, tort, or strict liability, even if an authorized representative of Yes4All has been advised of or should have known of the possibility of such damages.

Documents / Resources

	<p>Yesi DD95 Curve Shape Handrail [pdf] Installation Guide DD95, LMN1, DD95 Curve Shape Handrail, Curve Shape Handrail, Shape Handrail, Handrail</p>
---	--

References

- [User Manual](#)

[Manuals+](#), [Privacy Policy](#)

This website is an independent publication and is neither affiliated with nor endorsed by any of the trademark owners. The "Bluetooth®" word mark and logos are registered trademarks owned by Bluetooth SIG, Inc. The "Wi-Fi®" word mark and logos are registered trademarks owned by the Wi-Fi Alliance. Any use of these marks on this website does not imply any affiliation with or endorsement.