



xerox C9000 High Capacity Feeder Feed Roller Kit Instruction Manual

[Home](#) » [Xerox](#) » xerox C9000 High Capacity Feeder Feed Roller Kit Instruction Manual 

xerox C9000 High Capacity Feeder Feed Roller Kit Instruction Manual



High Capacity Feeder Feed Roller Kit

Contents

- [1 Installation](#)
- [2 Documents / Resources](#)
 - [2.1 References](#)
- [3 Related Posts](#)

Installation

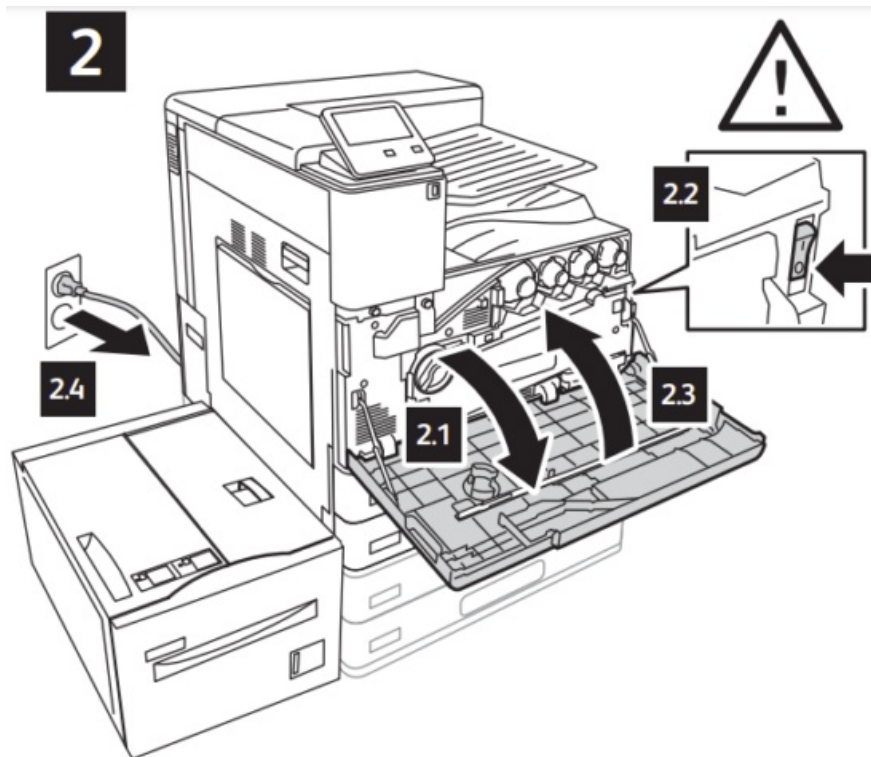
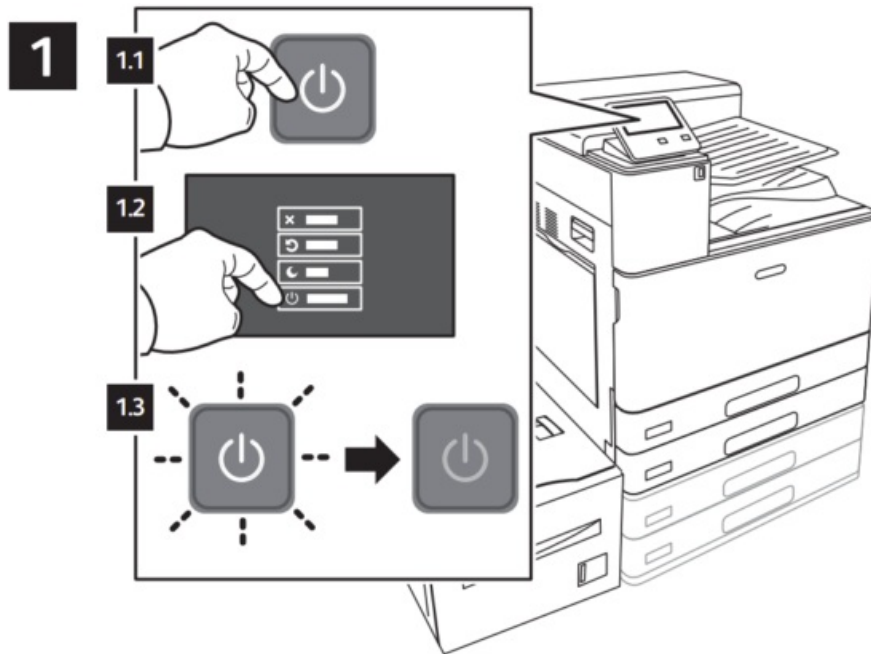

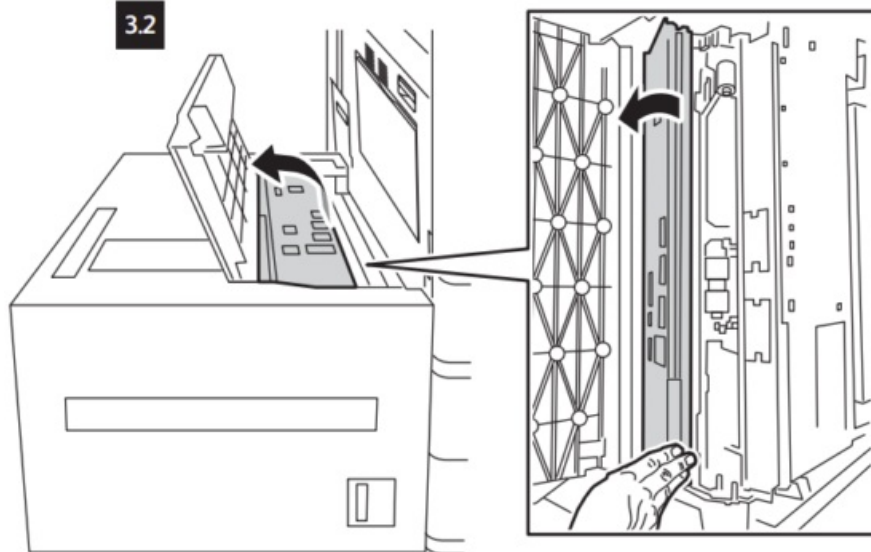
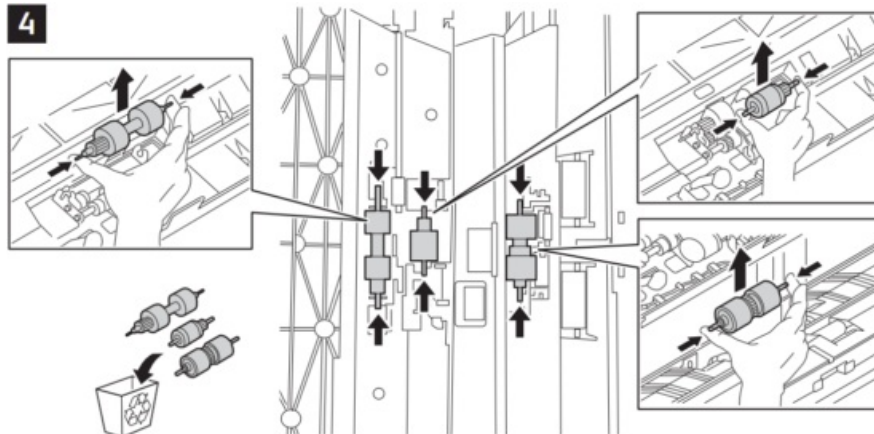
3**3.1****3.2****4**

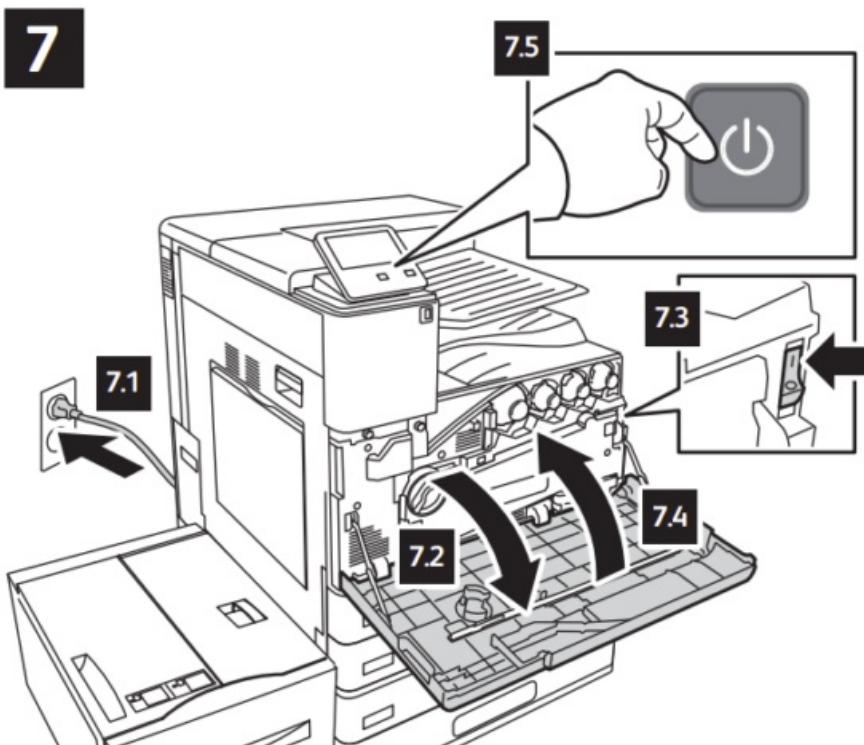
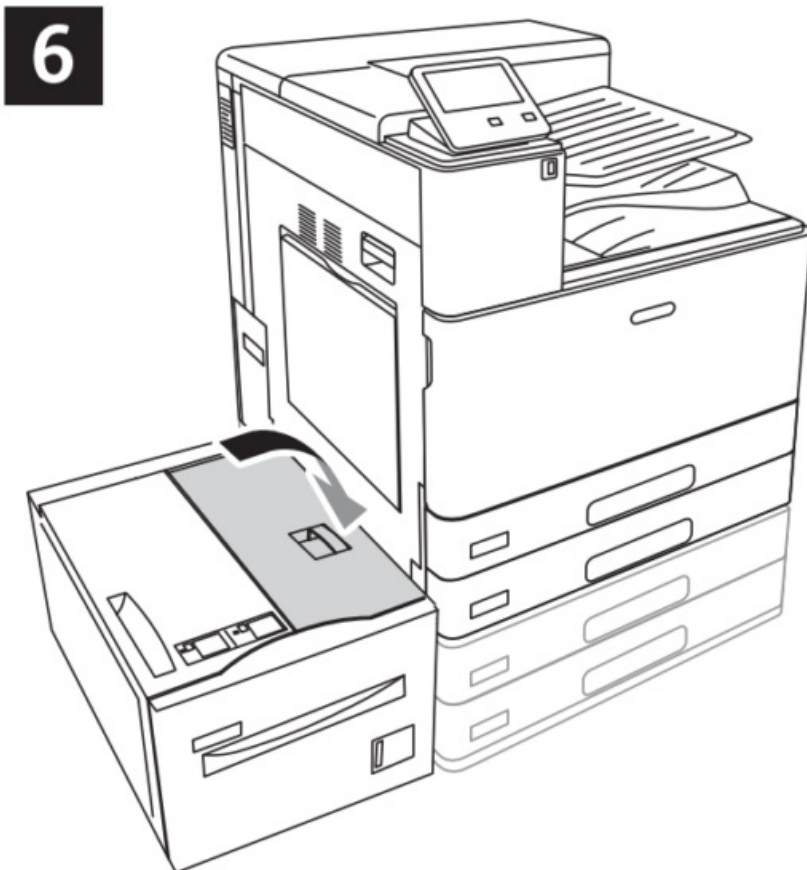
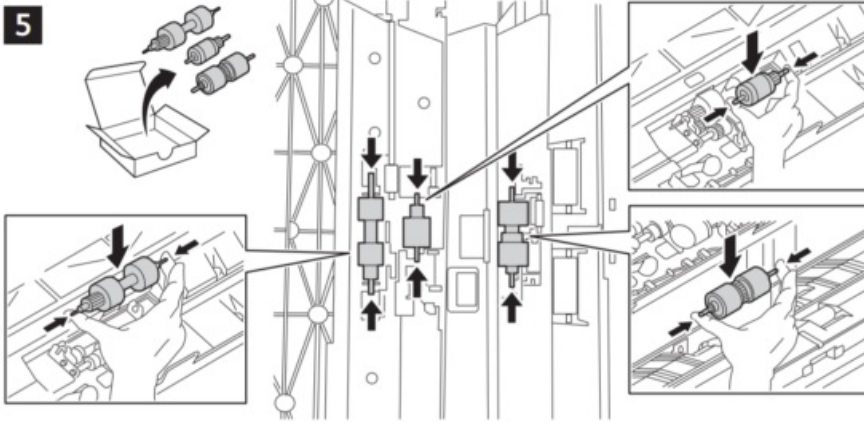

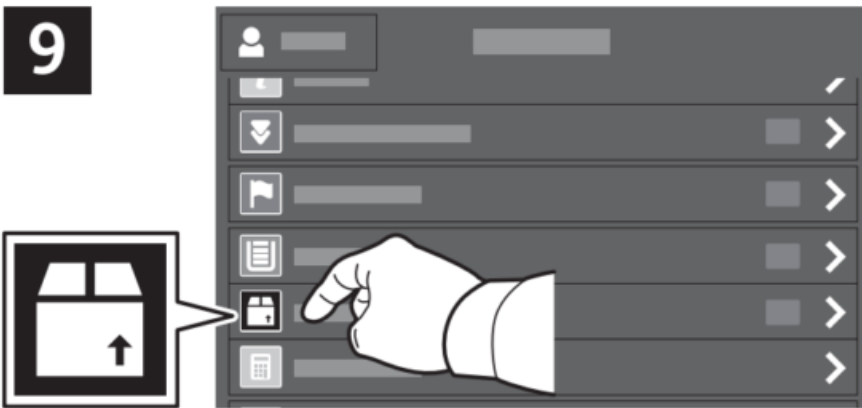
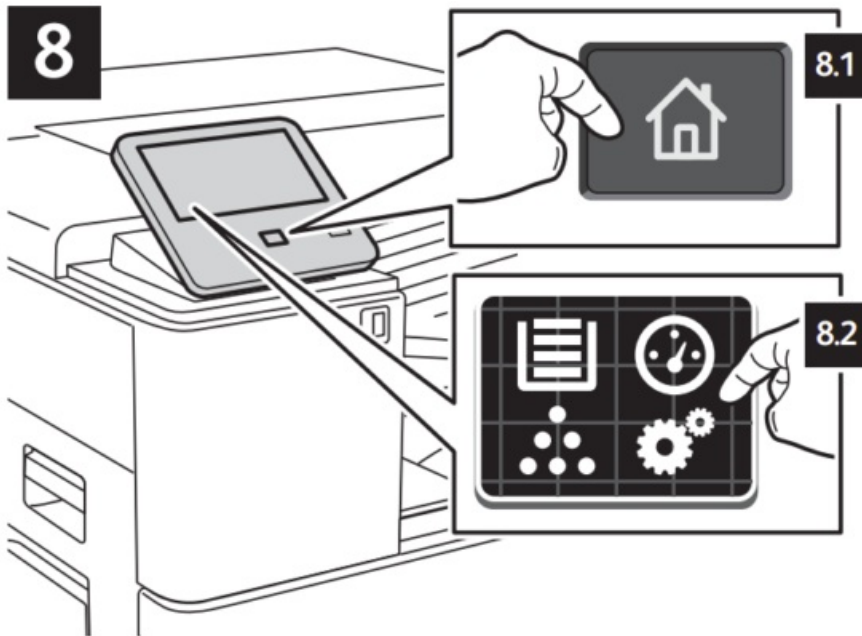

To reset the counter, touch **Tray 6 Feed Roller**.

10

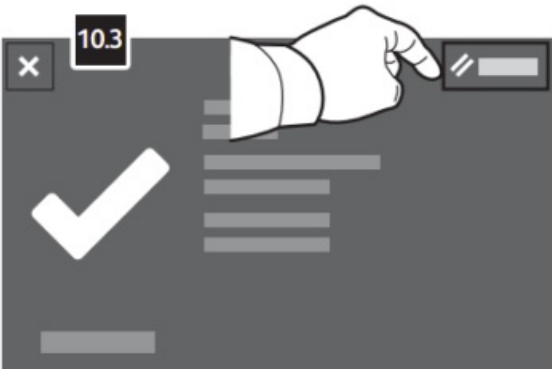
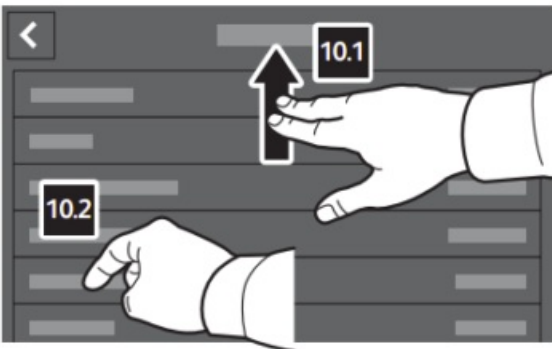

10.4

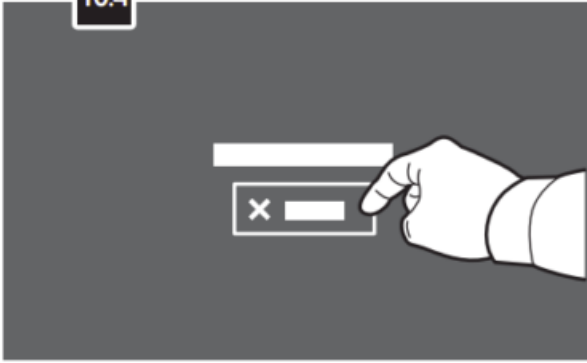

10.5



© 2017 Xerox Corporation. All rights reserved.

Xerox®, and Xerox and Design® are trademarks of Xerox Corporation in the United States and/or other countries.
BR21746



Documents / Resources

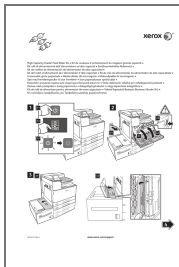

[xerox C9000 High Capacity Feeder Feed Roller Kit](#) [pdf] Instruction Manual
C9000, C9000-DTM, C9000 High Capacity Feeder Feed Roller Kit, C9000, High Capacity Feeder Feed Roller Kit, Capacity Feeder Feed Roller Kit, Feeder Feed Roller Kit, Feed Roller Kit, Roller Kit

References

- [User Manual](#)

[Manuals+](#), [Privacy Policy](#)

This website is an independent publication and is neither affiliated with nor endorsed by any of the trademark owners. The "Bluetooth®" word mark and logos are registered trademarks owned by Bluetooth SIG, Inc. The "Wi-Fi®" word mark and logos are registered trademarks owned by the Wi-Fi Alliance. Any use of these marks on this website does not imply any affiliation with or endorsement.