



## xerox C410 Color Printer Instructions

[Home](#) » [Xerox](#) » xerox C410 Color Printer Instructions 

### xerox C410 Color Printer Instructions



#### Contents

- [1 DAIMENTION INSTRUCTION](#)
- [2 Documents / Resources](#)
  - [2.1 References](#)
- [3 Related Posts](#)

## DAIMENTION INSTRUCTION

Xerox® C310

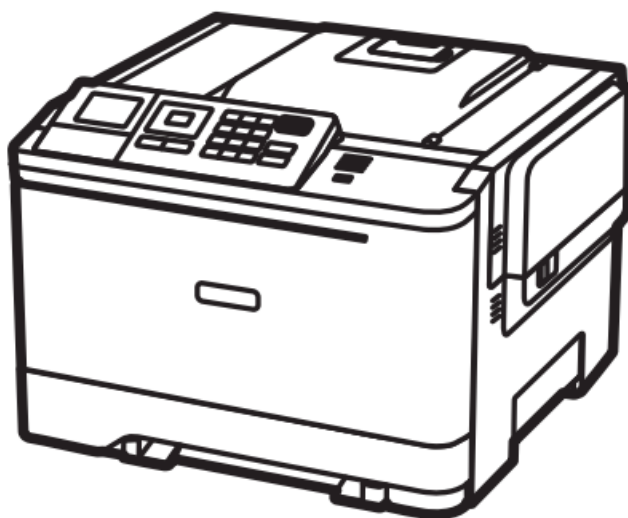

Xerox C315



Xerox C410

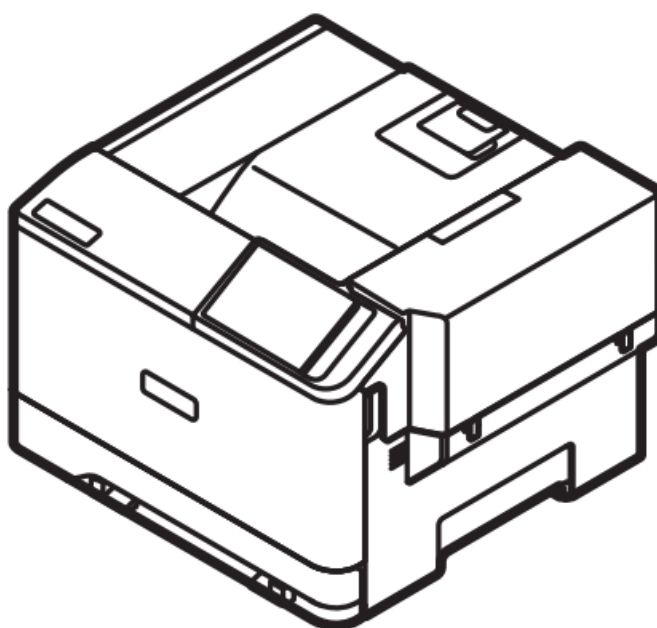

Xerox® VersaLink C415

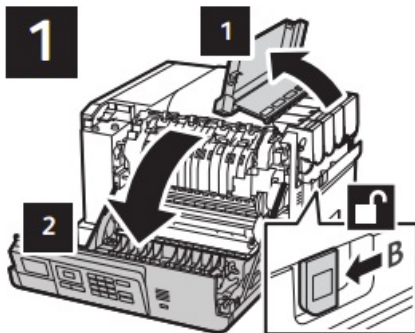
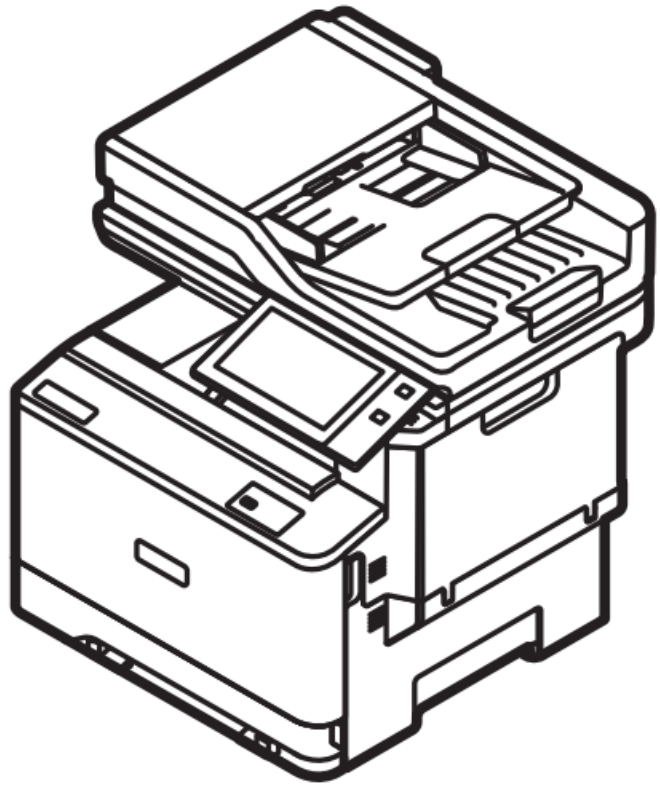

Xerox® 310

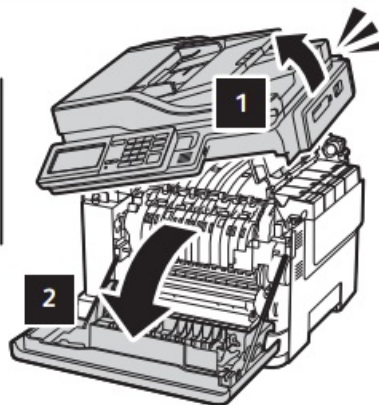

Xerox® C315

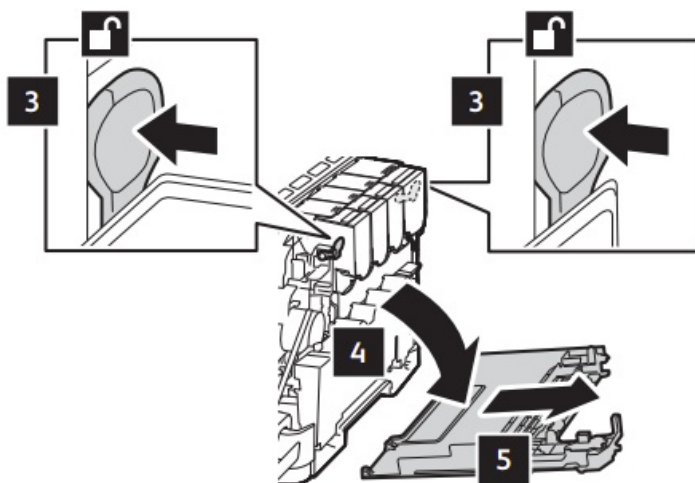

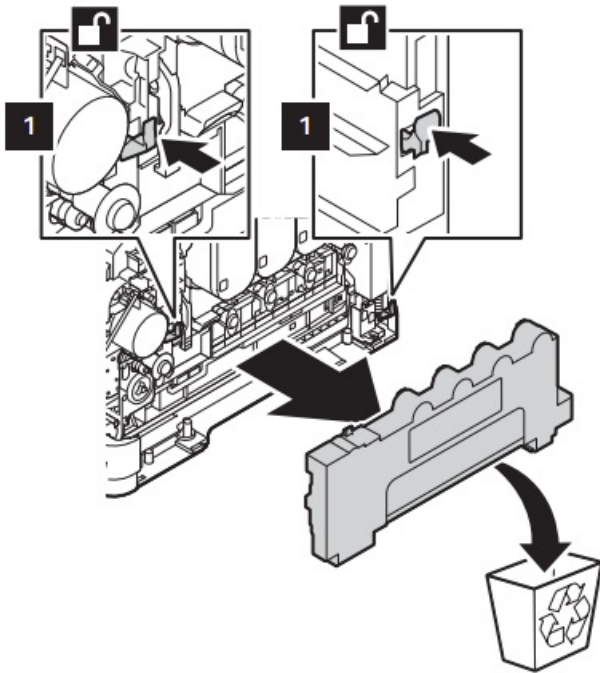
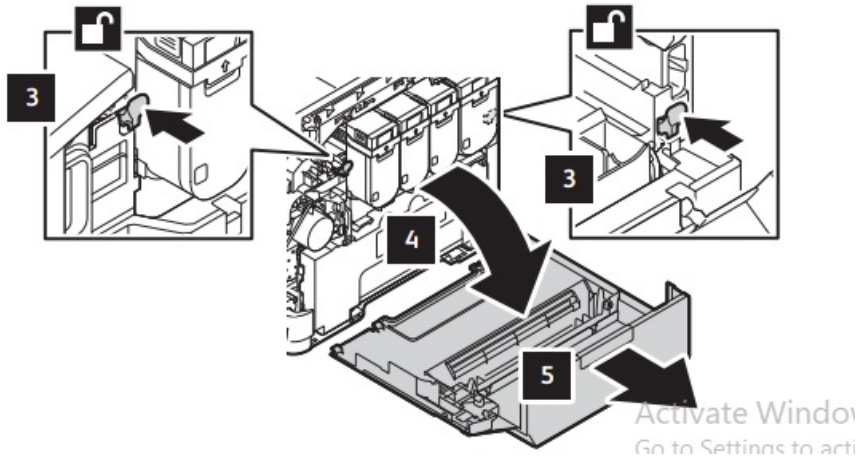
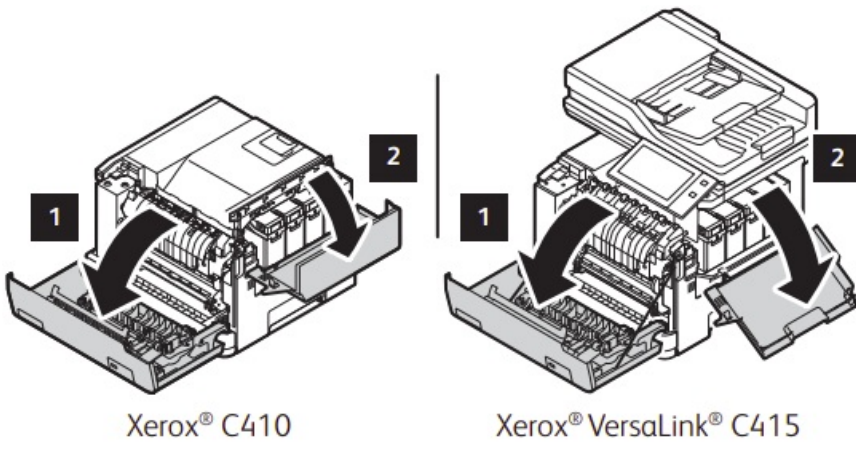

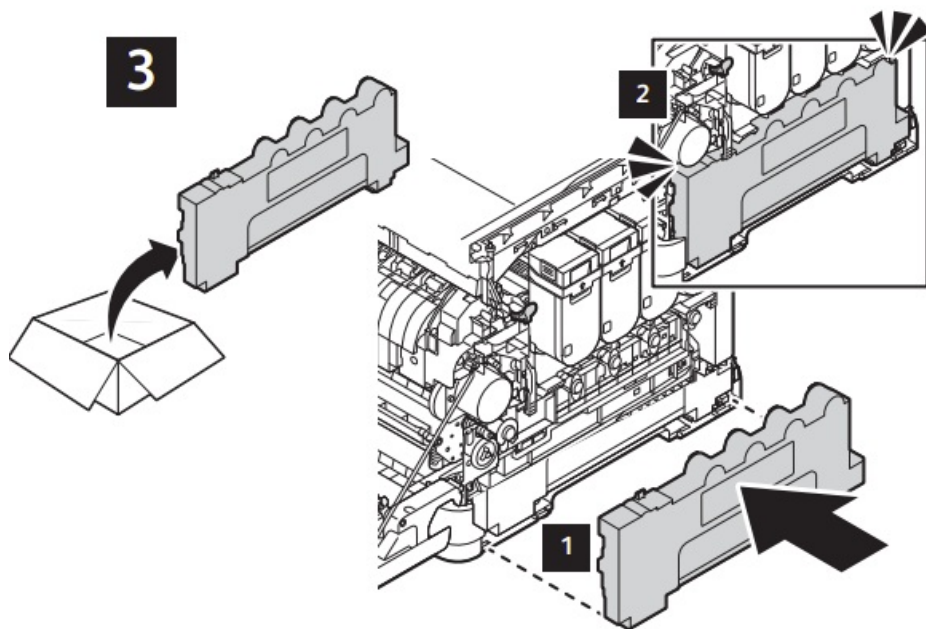

3.

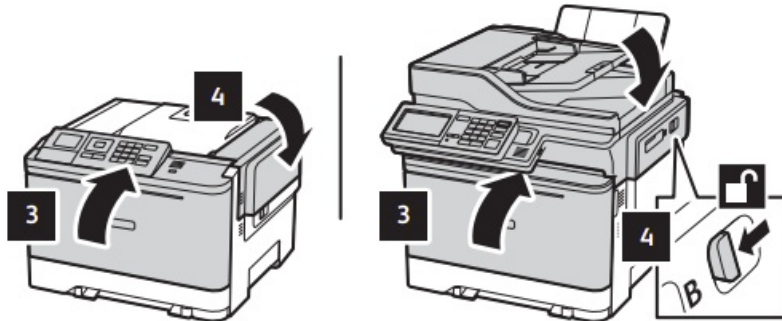
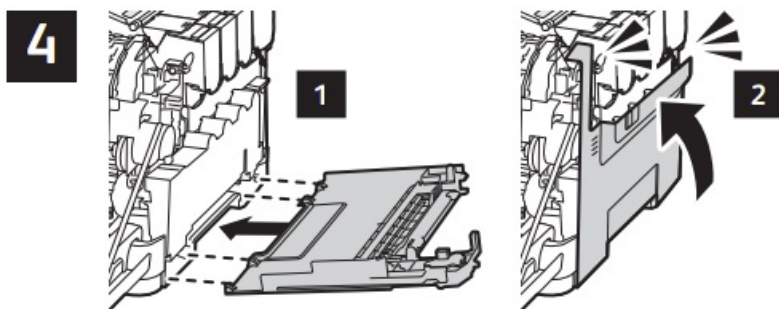

4.

Xerox® 310

Xerox® C315



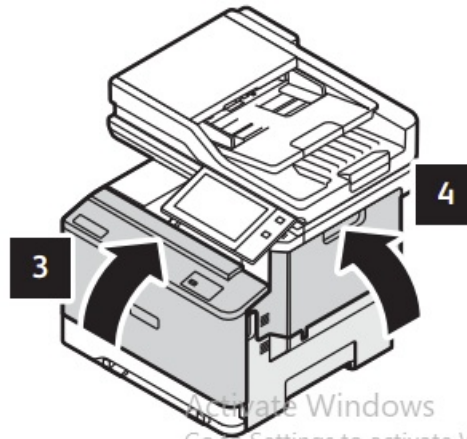
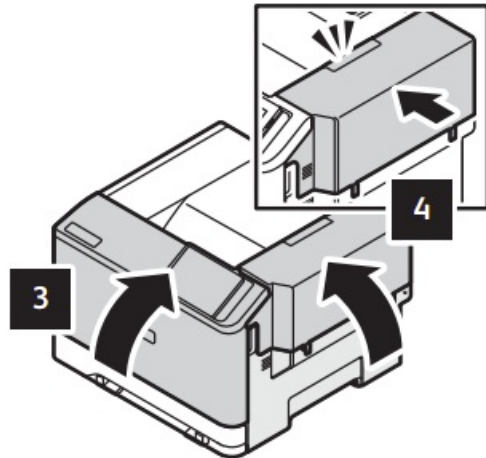
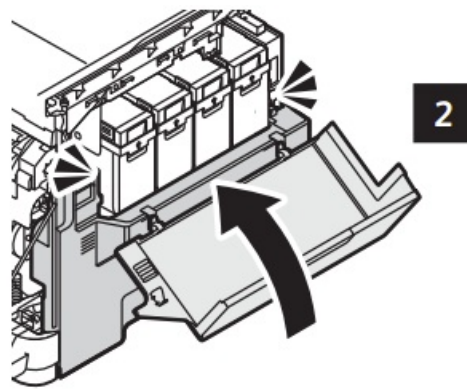
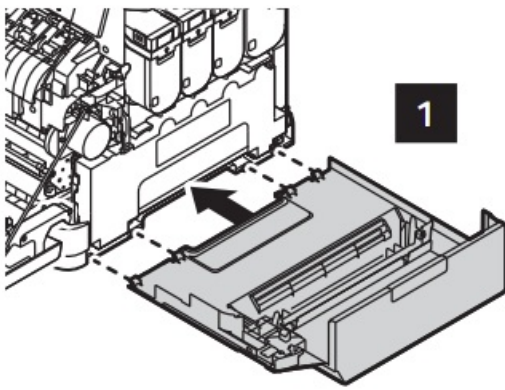

Xerox® C410

Xerox® VersaLink® C415

5.

607E42850 Rev C

© 2023 Xerox Corporation. All Rights Reserved.

Xerox® and VersaLink® are trademarks of Xerox Corporation  
in the United States and/or other countries.

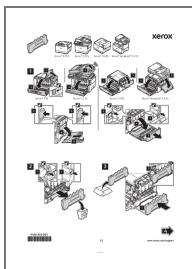

xerox™

## Documents / Resources



[xerox C410 Color Printer](#) [pdf] Instructions  
C410 Color Printer, C410, Color Printer, Printer

## References

-  [Product Support and Drivers – Xerox](#)
-  [Manual-Hub.com - Free PDF manuals!](#)
- [User Manual](#)

[Manuals+.](#) [Privacy Policy](#)

This website is an independent publication and is neither affiliated with nor endorsed by any of the trademark owners. The "Bluetooth®" word mark and logos are registered trademarks owned by Bluetooth SIG, Inc. The "Wi-Fi®" word mark and logos are registered trademarks owned by the Wi-Fi Alliance. Any use of these marks on this website does not imply any affiliation with or endorsement.