



XDRUM DD-530 E-Drum Set with Mesh Heads Instruction Manual

[Home](#) » [XDRUM](#) » XDRUM DD-530 E-Drum Set with Mesh Heads Instruction Manual 



User manual

Contents

- 1 DD-530 E-Drum Set with Mesh Heads
- 2 INFORMATION FOR YOUR SAFETY!
- 3 Panel Description
- 4 Setup
- 5 Connections
- 6 Performing
- 7 Editing and Saving a Drum Kit
- 8 Playing Along with Songs
- 9 Recording Your Performance
- 10 Practicing with Patterns
- 11 Creating Your Own Drum Kit
- 12 Making the Settings for Pads
- 13 Setting the Metronome
- 14 Playing Back Songs
- 15 Recording a Song
- 16 Practicing in Learning Mode
- 17 Making the Settings for MIDI
- 18 Prompt Messages
- 19 Troubleshooting
- 20 Specifications
- 21 Drum Kit List
- 22 Drum Instrument List
- 23 GM Drum Kit List
- 24 Song List
- 25 Pattern List
- 26 Parameter List
- 27 MIDI Implementation Chart
- 28 Documents / Resources
 - 28.1 References

DD-530 E-Drum Set with Mesh Heads

XDrum Drum Stool

Assembly instruction

You can find the Assembly instruction for your drum throne online under the following link:

XDrum Semi

https://www.kirstein.de/docs/manuals/XDrum-Drum%20Stool%20SemiAssembly%20Instruction_EN.pdf



XDrum DHS-1

https://www.kirstein.de/docs/manuals/XDrum-Schlagzeughocker%20DHS-1Assembly%20Instruction_EN.pdf



In order to protect the environment, we do not send these manuals in printed form. Should you nevertheless wish to do so, you can easily print out the instructions using the links or QR code provided or contact us directly and we will send them to you in printed form by post.

Musikhaus Kirstein GmbH
www.kirstein.de
Bernbeurener Straße 11
Phone: 08861 909494-0
86956 Schongau – Germany
info@kirstein.de

INFORMATION FOR YOUR SAFETY!

THE FCC REGULATION WARNING (for USA)

This equipment has been tested and found to comply with the limits for a Class B digital device, pursuant to Part 15 of the FCC Rules.

These limits are designed to provide reasonable protection against harmful interference in a residential installation. This equipment generates, uses, and can radiate radio frequency energy and, if not installed and used in accordance with the instructions, may cause harmful interference to radio communications. However, there is no guarantee that interference will not occur in a particular installation.

If this equipment does cause harmful interference to radio or television reception, which can be determined by turning the equipment off and on, the user is encouraged to try to correct the interference by one or more of the following measures:

- Reorient or relocate the receiving antenna.
- Increase the separation between the equipment and receiver.
- Connect the equipment into an outlet on a circuit different from that to which the receiver is connected.
- Consult the dealer or an experienced radio/TV technician for help.

Unauthorized changes or modification to this system can void the user's authority to operate this equipment.

CAUTION

The normal function of the product may be disturbed by Strong Electro Magnetic Interference. If so, simply reset the product to resume normal operation by following the owner's manual. In case the function could not resume, please use the product in other location.

PRECAUTIONS

PLEASE READ CAREFULLY BEFORE PROCEEDING

Please keep this manual in a safe place for future reference.

Power Supply

Please connect the designated AC adaptor to an AC outlet of the correct voltage.

Do not connect it to an AC outlet of voltage other than that for which your instrument is intended.

Unplug the AC power adaptor when not using the instrument, or during electrical storms.

Connections

Before connecting the instrument to other devices, turn off the power to all units. This will help prevent malfunction and / or damage to other devices.

Location

Do not expose the instrument to the following conditions to avoid deformation, discoloration, or more serious damage:

- Direct sunlight
- Extreme temperature or humidity
- Excessive dusty or dirty location
- Strong vibrations or shocks
- Close to magnetic fields

Interference with other electrical devices

Radios and televisions placed nearby may experience reception interference. Operate this unit at a suitable distance from radios and televisions.

Cleaning

Clean only with a soft, dry cloth.

Do not use paint thinners, solvents, cleaning fluids, or chemical-impregnated wiping cloths.

Handling

Do not apply excessive force to the switches or controls.

Do not let paper, metallic, or other objects into the instrument. If this happens, unplug the AC adaptor from the wall outlet. Then have the instrument inspected by qualified service personnel.

Disconnect all cables before moving the instrument.

Panel Description

Front Panel

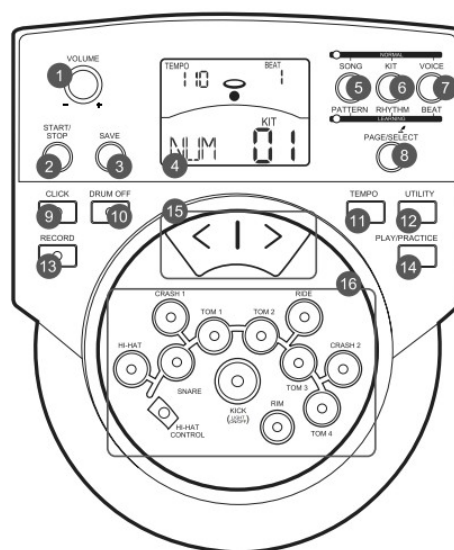

1. VOLUME Knob

Adjust the volume of phone and line output.

2. START/STOP Button

Start or stop playing.

3. **SAVE Button**

This button is used to save the current kit settings in a user kit and save the trigger settings under the Utility menu pages.

4. **LCD Display**

Please refer to the LCD Display section.

5. **SONG/PATTERN Button**

Enter the Song menu in NORMAL mode or enter the Pattern Practice menu in LEARNING mode.

6. **KIT/RHYTHM Button**

Enter the Kit menu in NORMAL mode or enter the Rhythm Practice menu in LEARNING mode.

7. **VOICE/BEAT Button**

Enter the Voice menu in NORMAL mode or enter the Beat Practice menu in LEARNING mode.

8. **PAGE/SELECT Button**

Scroll through the menu pages. Press and hold it for 1 second to switch modes between NORMAL and LEARNING.

9. **CLICK Button**

Turn the metronome on or off and enter the Click menu in NORMAL mode.

10. **DRUM OFF Button**

Mute the drum part of the pattern.

11. **TEMPO Button**

Adjust the current tempo.

12. **UTILITY Button**

Enter the Utility menu in NORMAL mode.

13. **RECORD Button**

Enter the Record menu in NORMAL mode.

14. **PLAY/PRACTICE Button**

Play back your recording in NORMAL mode.

Start practicing following sample practice patterns in LEARNING mode.

Press and hold it for 1 second to play back your practice in LEARNING mode.

15. **<Button and > Button**

Press the [>] button increases and press [<] button decreases the current parameter.

16. **Pad Select Buttons**

These buttons play the pad voices of the current kit. In Voice menu and Utility menu, they select the pad to be edited.

Rear Panel & Side Panel

17. **AUX IN Jack(1/8")**

This stereo input jack is for an external sound source, such as an MP3 or CD player.

18. **LINE OUTPUT Jacks(1/4")**

Stereo output connection to an audio system or drum amplifier.

19. **CRASH 2 Jack(1/4")**

Input connection for Crash 2 (dual-zone).

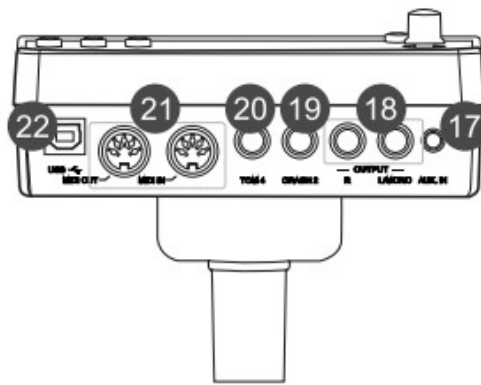

20. TOM 4 Jack(1/4")

Input connection for Tom 4 (dual-zone).

21. MIDI Connectors (IN, OUT)

These ports allow communication with other products equipped with a MIDI interface.

22. USB Connector

This port is used to connect to a computer (MIDI In/Out via USB).

23. PAD Connectors

Input connections for Kick, Snare, Tom, Cymbal pads and Hi-Hat control pedal.

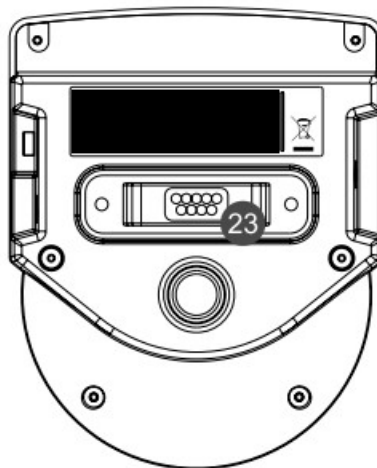

24. PHONES Jack(1/8")

This stereo jack is used to connect headphones to the unit.

25. POWER Switch

This switch turns the power on and off.

26. DC IN Jack

Connect the included DC 9V power adaptor.

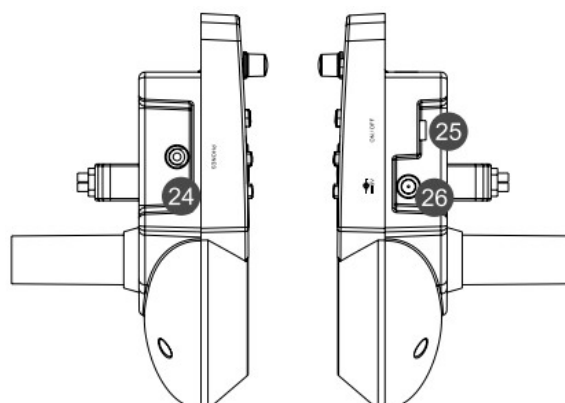

1. Tempo/Measure
2. Hitting Indicator
3. Beat Count
4. Indicators for Learning
5. Indicators for Menus (Such as UTILITY, REC, etc.)
6. Current Mode and Parameter Display

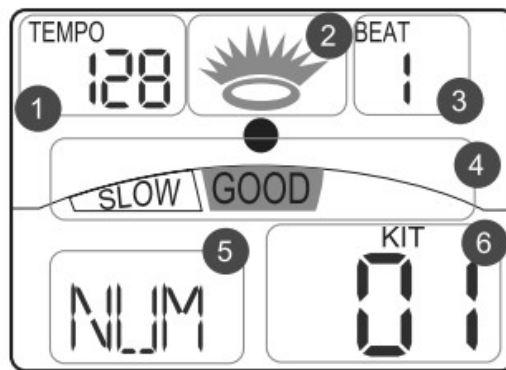

Setup

Caution!

To prevent electric shock and damage to the device, make sure the power is switched OFF on the drum and all related device before making any connection.

Connecting Pads and Pedals

Standard: KICK, SNARE, TOM1-3, CRASH1, RIDE, HIHAT, HIHAT CONTROL PEDAL

Extended: CRASH2, TOM4

Using the provided cables, connect with kick, snare, tom1~tom3, ride, crash, hi-hat, hi-hat control triggers. Snare, tom, ride, crash are stereo input, support double triggering (increase edge triggering); kick, hi-hat are mono input, which can't response edge triggering. Hi-hat control pedal is stereo input.

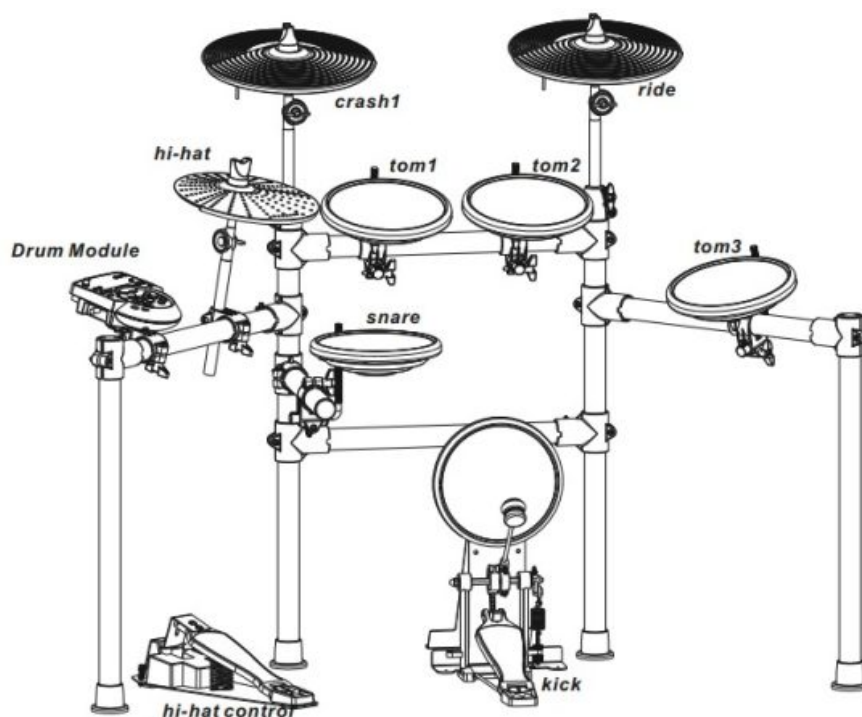

Note:

For details on assembling the drum stand, attaching the digital drum and connecting pads, refer to the Installation manual.

Connections

Connecting an Audio Equipment

When using an amplifier, connect the Output L/MONO and R jacks on the rear panel to the input of the amplifier.

Note:

For mono playback, use the L/MONO jack.

For stereo playback, connect both L/MONO and R jacks.

The line output volume is controlled by the VOLUME knob.

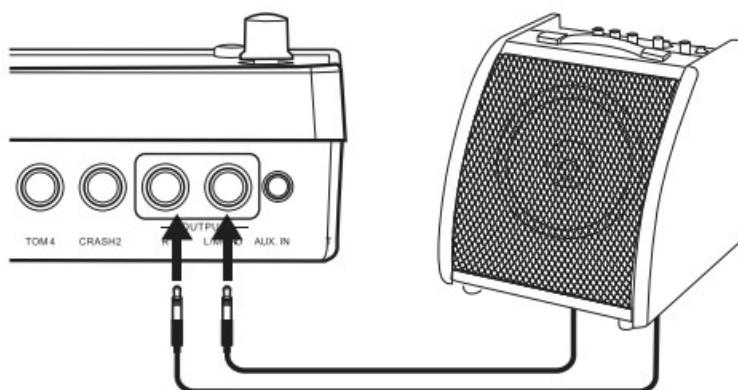

Connecting a set of Headphones

An optional set of stereo headphones can be connected to the PHONES jack located on the side of the drum module.

The headphones output volume is controlled VOLUME knob, too.

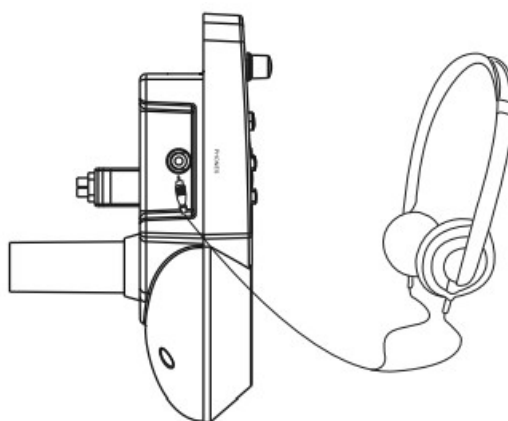

Connecting an MP3/CD Player

Connect the audio output of an MP3/CD player or other audio source to the stereo AUX IN jack on the rear panel. The input signal is mixed with the drum signal, allowing you to play along.

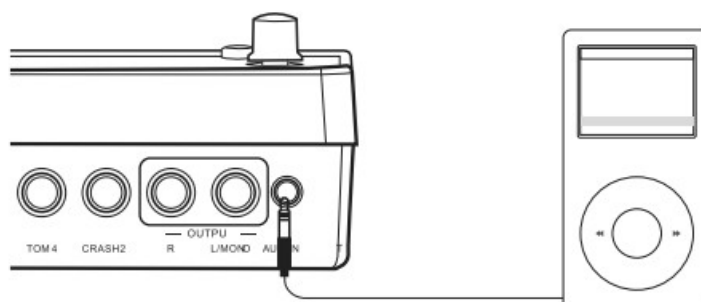

Connecting a Computer

■ Via the USB Connector

This receives and transmits MIDI messages.

■ Via the MIDI Connectors

MIDI IN Connector

This receives MIDI messages transmitted from an external MIDI device or a computer.

MIDI OUT Connector

Pad performance data is transmitted from this connector to connected computer or MIDI device.

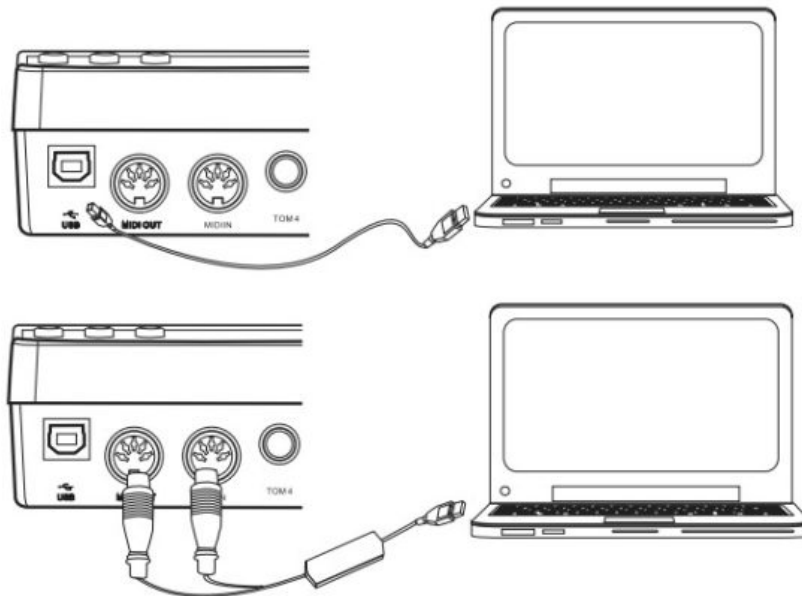

Connecting a Midi Keyboard

If you're using an external MIDI keyboard or pads to control the digital drum, make connections as shown. Here, it is used as a sound module.

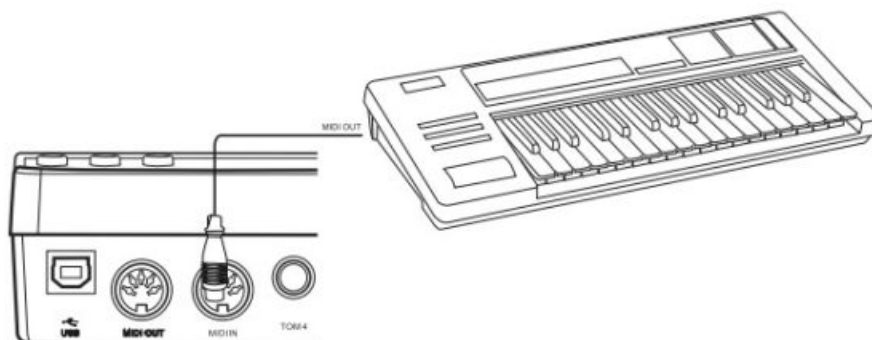

Power Supply & Switch

Make sure the power is switched OFF. Connect the power adaptor to the DC IN jack on the side panel. After confirming that all connections have been completed, rotate the volume knob to the left (minimum volume level) before switching the power on. Set the power switch to the "ON" position. The KIT indicator on LCD will light up and the display will show kit number 01.

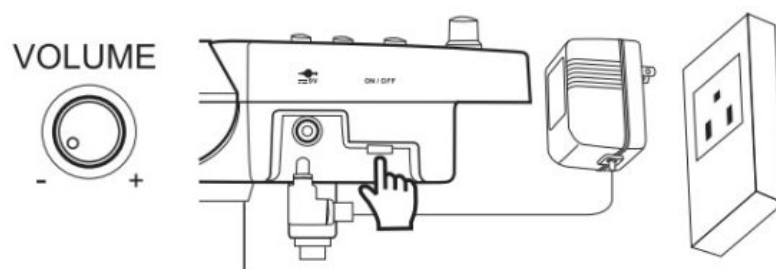

Note:

Make sure the power is switched OFF when connecting the drum module with external devices.

Performing

Selecting a Drum Kit

After powering up, the digital drum will be in KIT menu (KIT indicator ON). The display should look like this:

1. Use the [<] and [>] buttons to select the active kit.

There are 45 kits in the digital drum:

- 29 preset kits (Kits 01-29)
- 16 user kits (Kits 30-45), the parameter display area will display as “U30~U45”, with an additional letter “U”.

2. Pressing the Pad Select buttons allows you to preview the current kit (fixed velocity).
3. Hit the pads to play the current kit.

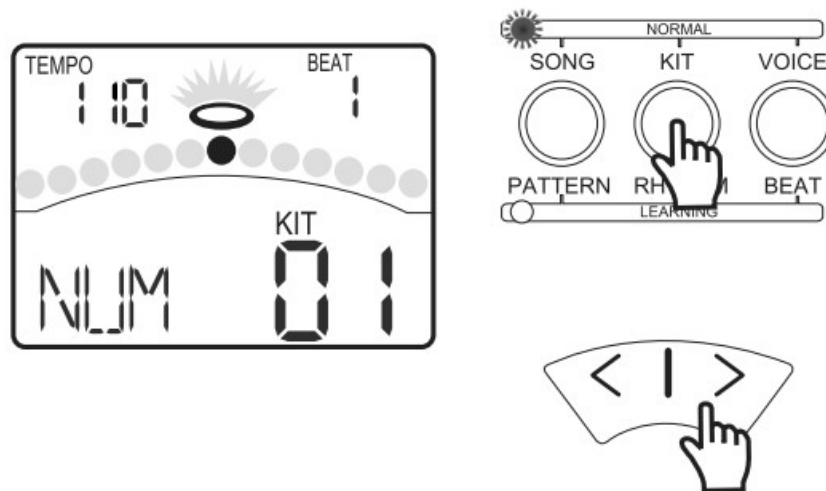

Playing the Pads

Similar to an acoustic drum kit, the digital drum responds differently to various playing techniques and dynamics. All the pads are velocity sensitive. And some voices change timbre depending on the striking force.

Drum Pad Head or Rim shot

The digital drum pad detects head and rim shots (rim shots trigger the rim voice).

Cymbal Bow shot and Rim shot

The digital drum cymbals detect bow shot and rim shots (rim shots trigger the rim voice).

Both Ride and Crash cymbals have cymbal choke. But hi-hat don't have the cymbal choke

Choking the crash/ride edge with the hand immediately after hitting the crash/ride mutes the crash/ride sound.

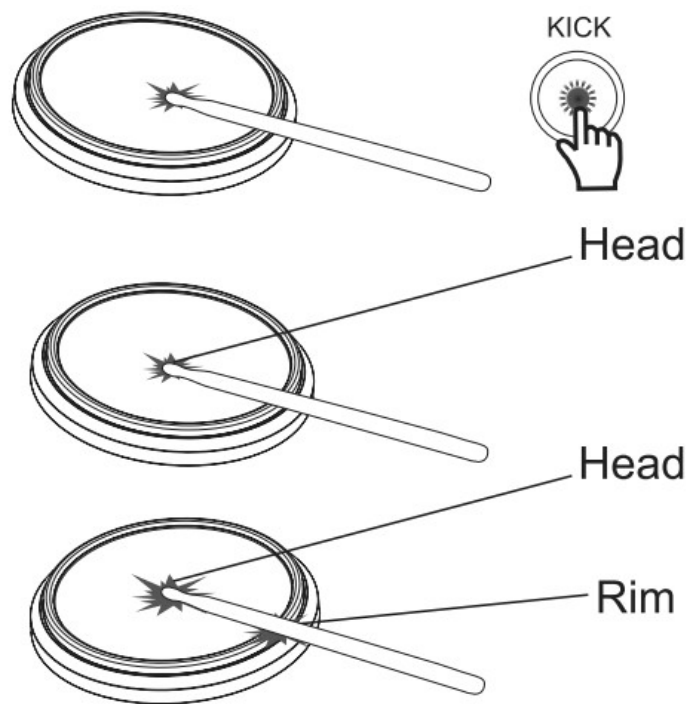

Hi-Hat

The Hi-Hat sound varies depending on the position of the HiHat pedal:

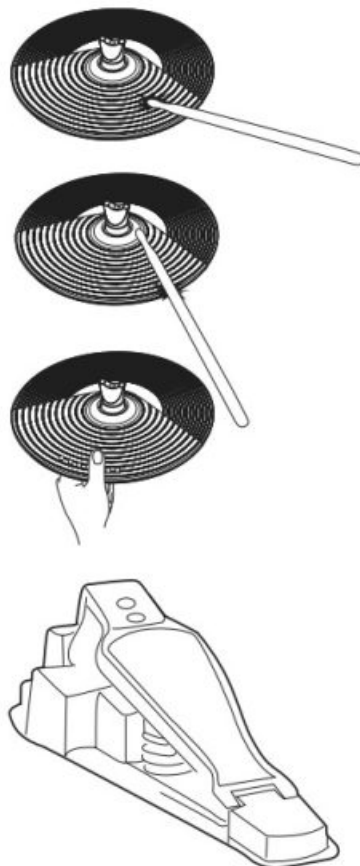

Open Hi-Hat: Strike the Hi-Hat pad without pressing the pedal.

Half-Open Hi-Hat: Strike the Hi-Hat pad with the pedal pressed halfway down.

Closed Hi-Hat: Strike the Hi-Hat pad with the pedal pressed completely down.

Pedal Close: Press the pedal completely down without striking the pad.

Splash: Press the pedal completely down and release it immediately

Adjusting the Sensitivity of a Pad

You may wish to adjust the sensitivity of the pads according to your playing style and desired dynamic range.

1. Press the [UTILITY] button

The UTILITY indicator appears.

2. Strike a pad or press a pad select button to select the one whose sensitivity is to be adjusted. The PAD indicator shows the current selected pad.
3. Press the [<] or [>] button to adjust the sensitivity.
4. Press the [SAVE] button to save the current setting. For details on pad adjustments, refer to Advanced Use.

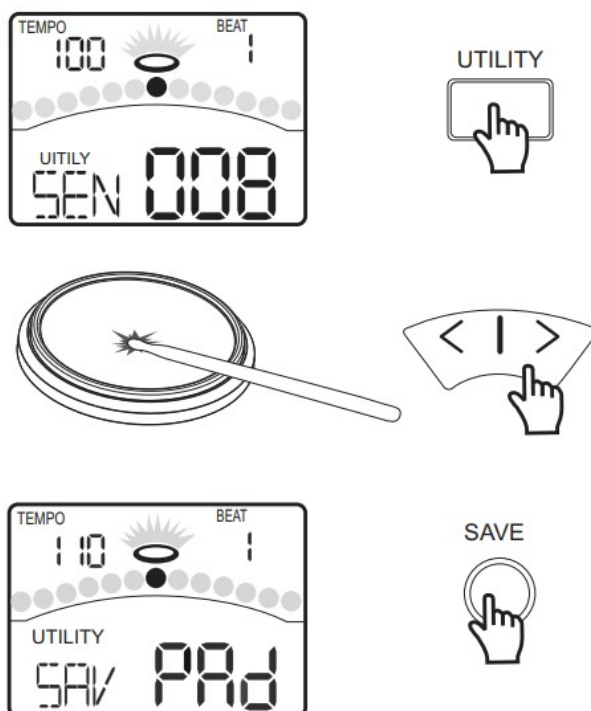

Using the Metronome/Click Feature

You can switch the click sound on and off by pressing [CLICK] button. When the click plays at the current Time Signature and Tempo (displayed in the top left corner of the LCD), the beat indicators will swing accordingly. You can set the time signature and interval, adjust the click volume and select the click sound in the CLICK menu.



1. Press the [CLICK] button.

Start the metronome with click sound.

2. Press the [PAGE] button to select the click menu pages and press the [<] or [>] button to adjust the parameters.
3. Press the [CLICK] button again.

Stop the metronome and exit the click menu.

Adjusting the Tempo

You can adjust the tempo of the Metronome, the current song, and the current learning pattern. The current tempo always displays in the top left corner of the LCD.

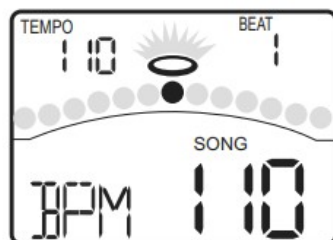

1. Press the [TEMPO] button.
2. Press the [<] or [>] button.

Adjust the current tempo.

3. Press both [<] and [>] buttons at the same time, reset the current tempo to its default value.

Note:

If there's no operation, it will return to the previous menu page automatically after 3 seconds.

Editing and Saving a Drum Kit

In KIT menu, you can modify the parameters as you like and save to the selected user kit.

Adjusting the Volume of a Drum Kit

1. Press the [KIT] or [PAGE] button. Select the Kit Volume page.
2. Press the [<] and [>] button. Adjust the kit volume.

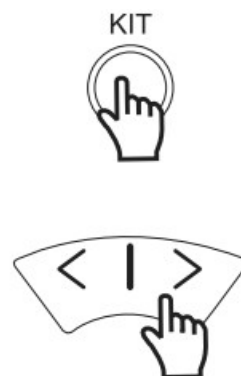
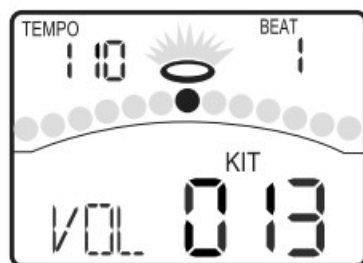

Switching Reverb On/Off and Setting EQ

1. Press the [KIT] or [PAGE] button.
Select the Global Reverb page and EQ pages.
2. Press the [<] or [>] button.
Switch Reverb ON or OFF.
Set the gain of three-band EQ (high, middle, low)

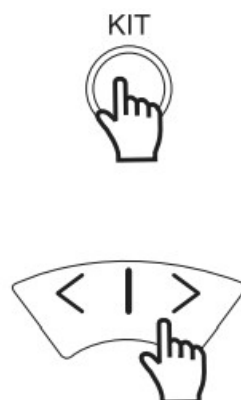

Selecting the Drum Instrument of the Pad

1. Press the [VOICE] button.

Select the Pad Voice page.

2. Press the [<] or [>] button.

Select the drum instrument of the selected pad.

Please refer to Drum Instrument List.

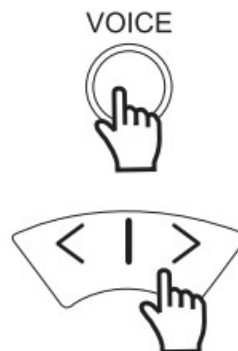
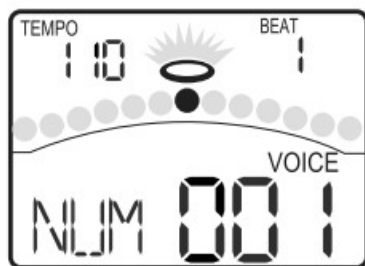

Adjusting the Volume, Pan and Pitch of the Pad

1. Press the [VOICE] or [PAGE] button.

Select the Pad Volume, Pad Pan, and Pad Pitch pages.

2. Press the [<] or [>] button.

Adjust the corresponding parameter.

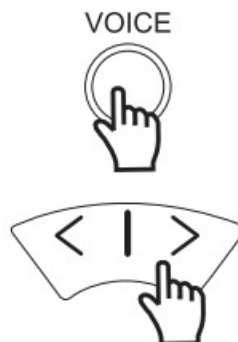

Setting the Pads to Play Songs

1. Press the [VOICE] or [PAGE] button.

Select the Pad Song and Song Number pages.

2. Press the [<] or [>] button.

Switch the Pad Song function ON or OFF. Select the Song that begins playing when the following pad is struck.



Saving the Edited Kit

1. Press the [SAVE] button.
The number of user kit will be flashed.
2. Press the [<] or [>] button.
Select a user kit to save your settings. (No. 30-45)
3. Press the [SAVE] button again.
Save the setting to the selected user kit.

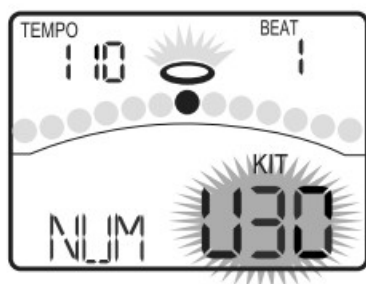

HINT

If the edited kit isn't saved before selecting another kit, powering down the digital drum, the changes will be lost.

Playing Along with Songs

Selecting and Playing Back a Song

1. Press the [SONG] button.
Switch to the SONG menu.
2. Press the [<] or [>] button.
Select the active song. The digital drum has many kinds of songs. Please refer to Song list.
3. Press the [START/STOP] button.
Start or stop playing back this selected song. When playing back this song, the PAD indicator will display which pads are being played by drum track.

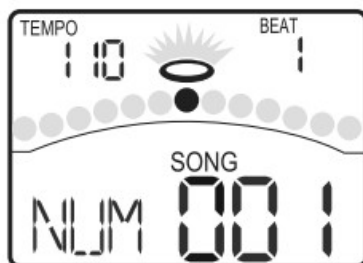

Adjusting the Volume of the Accompaniment and Drum

In SONG menu, you can adjust the volume of drum or accompaniment track.

1. Press the [SONG] or [PAGE] button.
Select the ACC Volume or Drum Volume page.
2. Press the [<] or [>] button.
Adjust the corresponding volume.

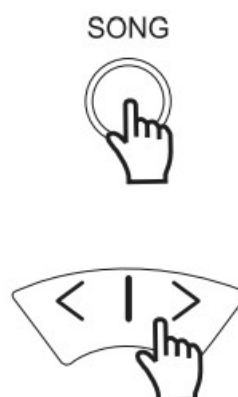

Muting the Drums in Songs

If you want to mute the drum track of the song, please press the [DRUM OFF] button. The [DRUM OFF] LED will turn on.



Using the Pads to Play Songs

This function is available only with electric drum. When you struck the pads that have been set Pad Song function, they will start the performance of the songs. If you don't know how to set this function, please return to previous page and review the part “**Setting the Pads to Play Songs**”.

For Example

Kick: You can play the bass-line (Tap group, refer to Song List) note by note with you kick drum.

Crash: The chords (Hit group, refer to Song List) progress when you strike the pad.

HINT

The sounds in the Tap song are played back one by one when you pressing the [START/STOP] button or hitting the “pad song” pad.

Recording Your Performance

In RECORD menu, you can record pad performances and the song as accompaniment.

Recording Your Performance Quickly

1. Press the [RECORD] button.

The [RECORD] LED will flash. The Metronome will be turned on automatically.

The display will show:

2. Press the [START/STOP] button or strike the pad.

Recording will start.

The [RECORD] LED will turn on.

3. Press the [START/STOP] button again, or press the [RECORD] button.

Stop recording, the [RECORD] LED will turn off.

Your performance has been recorded.

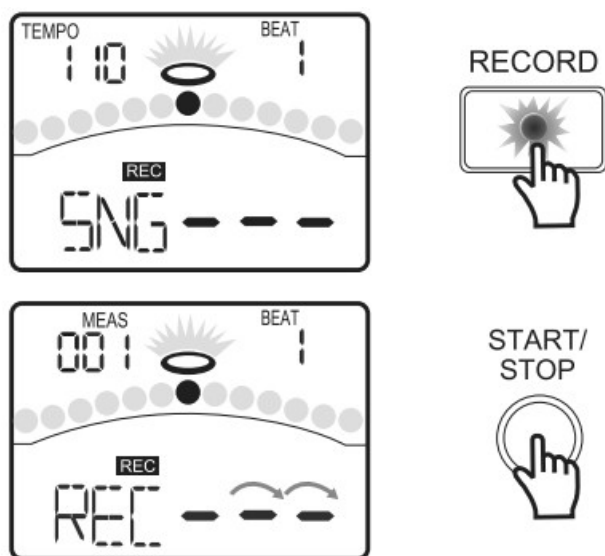

Playing Back Your Recorded Performance

1. Press the [PLAY] button.

Play back your recording.

The display will show:

2. Press the [PLAY] button again.

Stop playing back your performance.

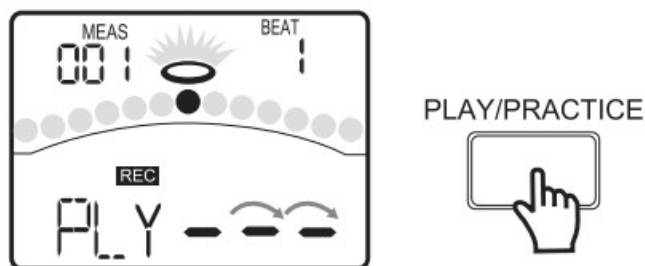

If you are not satisfied with your recording, please press the [RECORD] button to restart the recording progress.

Making the Settings for Recording

You can make the settings for recording on Record Standby.

1. Press the [PAGE] button.
Select the Record Setting pages.
2. Press the [<] or [>] button.
Adjust the parameters about recording.
For details on record setting, refer to Advanced Use.

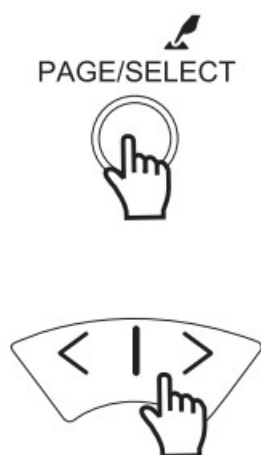

Practicing with Patterns

There are three types of patterns in LEARNING mode.

Beat: Snare Practice

Rhythm: Drums Practice

Pattern: Drums Practice with accompaniment

Selecting a Pattern and Practicing with it

When you are in NORMAL mode, please press and hold the [PAGE/SELECT] button for 1 second. The LED of LEARNING mode will turn on. The display will show:

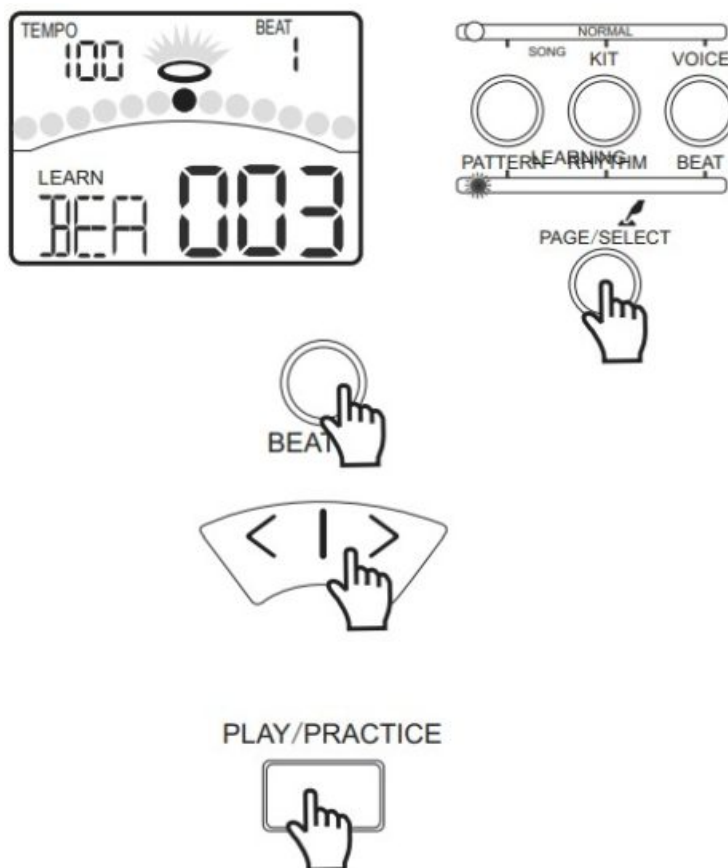

1. Press the [BEAT] button.
Select the Beat Choosing page.
2. Press the [<] or [>] button.
Select the beat which you want to practice.
3. Press the [PRACTICE] button.
Start or stop playing the pattern with your practice. The PAD indicators will display which pads are being played by drum track.

If you want to select the Rhythm or Pattern, please follow the steps described above. Drum Lessons Score can be downloaded from internet(consult your dealer). We recommend you to follow it.

Scoring Your Practice

If you want to check your progress, please press the [START/STOP] button. The display will show:
A measure count-in will be inserted before playing back the pattern so that you can practice in good time. Your practice will be recorded automatically. When finished playing back the pattern, the digital drum will score your practice automatically.

The display will show the score.

If you are unsatisfied with your score, please press the [START/STOP] button and restart examination.

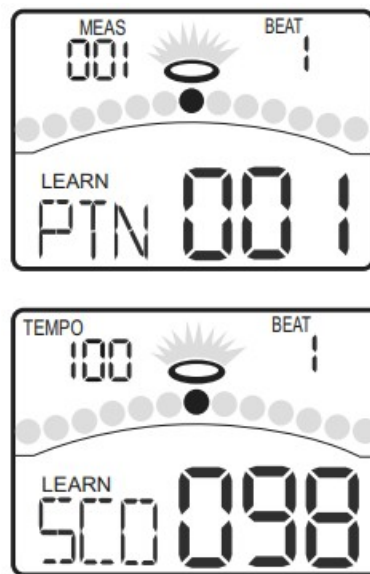

START/
STOP



Playing Back Your Recorded Practice

1. Press and hold the [PLAY/PRACTICE] button for 2 seconds.

The display will show:

You will listen to your recorded practice.

2. Press the [PLAY/PRACTICE] button again.

Stop playing back the recorded practice.

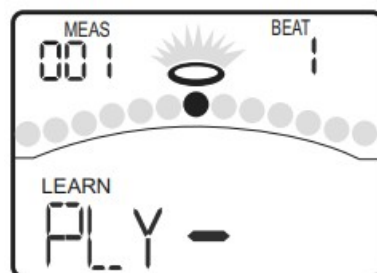

PLAY/PRACTICE



Creating Your Own Drum Kit

About the Drum Kits

In KIT menu, you can select drum kits to play from the pads, and you can edit voices and their associated parameters, such as Pitch, Reverb Level, Volume, Pan, MIDI Note, etc.

There are 45 kits in the digital drum:

- 29 preset kits (Kits 01-29)
- 16 user kits (Kits U30-U45)

In addition, there are 11 General MIDI preset kits for MIDI/USB applications, and for MIDI file playback. Please refer to GM Drum Kit List. Each drum kit contains settings for up to 19 voices, assigned to the 10 pad inputs and 1 pedal controller:

Pad Settings		
Kick	Head1	
Snare	Head2	Rim2
Tom1	Head3	Rim3
Tom2	Head4	Rim4
Tom3	Head5	Rim5
Tom4	Head6	Rim6
Crash1	Head7	Ri m7
Crash2	Head8	Ri m8
Ride	Head9	Ri m9
Hihat	Head 10	
Pedal		

Selecting a Drum Kit

If the digital drum is not yet in KIT menu, press the [KIT] button to enter it. The KIT indicator will light up, and the LCD will display the current kit number.

Press the [<] or [>] buttons to select a kit. When holding down [>], values increase rapidly. When holding down [<], values decrease rapidly.

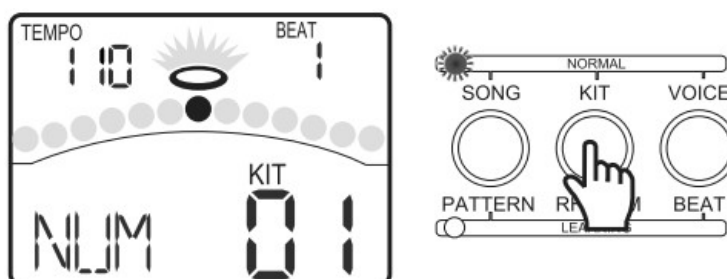

Overall Drum Kit Setting

In KIT menu, you can set the overall kit parameters.

1. Press the [PAGE] or [KIT] button, select Kit volume page. The parameter adjusts the overall kit volume(0-32).
2. Press the [PAGE] or [KIT] button, select Reverb Switch page. The parameter toggles the global reverb Switch ON/OFF.
3. Press the [PAGE] or [KIT] button, select EQ gain page. These parameters adjust the three bands of Master EQ (-12dB-12dB).

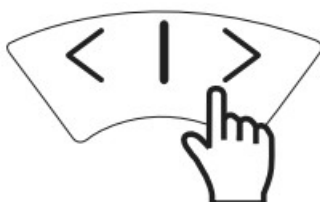

Overall Kit Settings	
Kit	Volume
Global	Reverb on/off
	EQ High gain
	EQ Middle gain
	EQ Low gain

Selecting the Pad to Edit

The current pad to be edited can be selected either by pressing its Pad Select button, or by striking the pad itself. The PAD indicator will light up to show which pad is currently selected. If the rim of a pad is selected, both the PAD indicator and the RIM indicator will turn on.

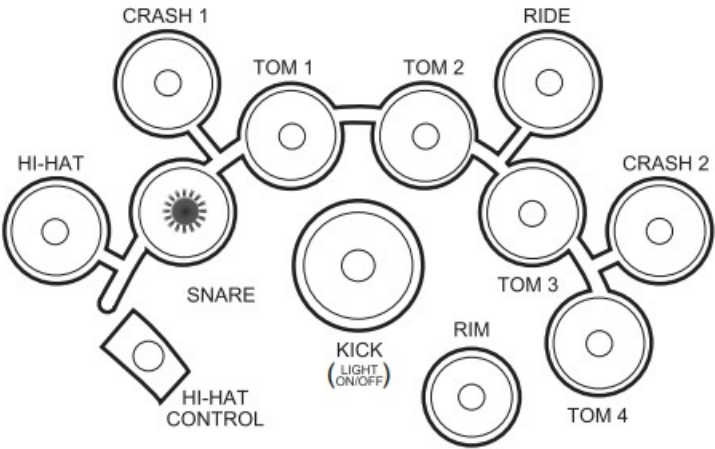

About the Drum Instruments

The digital drum features 400 different drum instruments which are categorized into 9 separate groups, such as Acoustic Kick, Electric Kick, Acoustic Snare, Electric Snare, Percussion. You can individually adjust the volume, pan, pitch, reverb settings for instruments set to the pad.

Selecting Instruments

If the digital drum is not yet in VOICE menu, press the [VOICE] button to enter it. The VOICE indicator will light up, and the LCD will display the current voice number.

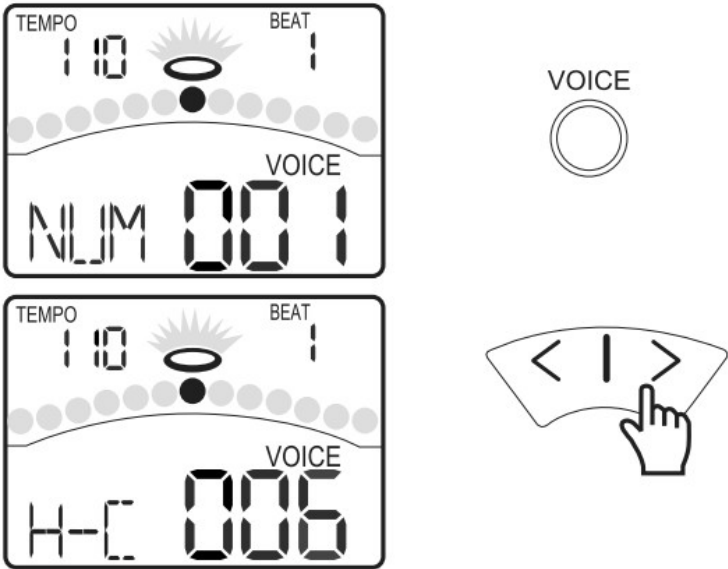

1. Press the [<] or [>] buttons to change a pad's Individual voice (001-400).
2. If the selected pad is Hi-Hat, an additional option is available: Hi-Hat Combination (001-007).

Drum Instrument Settings

1. Press the [PAGE] or [VOICE] button, select Pad Volume page. The parameter adjusts the volume of the pad.
2. Press the [PAGE] or [VOICE] button, select Pad Pan page. The parameter adjusts the pan of the pad.
3. Press the [PAGE] or [VOICE] button, select Pad Pitch page. The parameter adjusts the pitch of the pad.
4. Press the [PAGE] or [VOICE] button, select Pad Reverb page. The parameter adjusts the reverb level of the pad.

Drum Instrument Settings	
Voice Setting	Volume(0-32)
	Pan(-8-8)
	Pitch(-8-8)
	Reverb(0-16)
Settings for Other Functions	
MIDI	MIDI Note(0-127)
Others	Pad Song Switch(ON/OFF)
	Song Number(1-80)

Settings for Other Functions

1. Press the [PAGE] or [VOICE] button, select Pad MIDI Note page. The parameter sets MIDI Note Number for each pad.
2. Press the [PAGE] or [VOICE] button, select Pad Song pages. The parameters sets pad song function ON and choose the song numbers.
Press the [<] or [>] buttons to adjust the parameters.

HINT

While editing Voice Number, Pitch, Pan, Volume, and Reverb, you can also preview the result of the current settings by pressing the Pad Select button to play the edited voice.

Saving to a User Drum Kit

After change any kit parameter, please press the [SAVE] button to save the current settings to the user kit (No. 30-45). The number of user kit will be flashed. Press the [SAVE] button to save to user kit and return to Kit Select page.

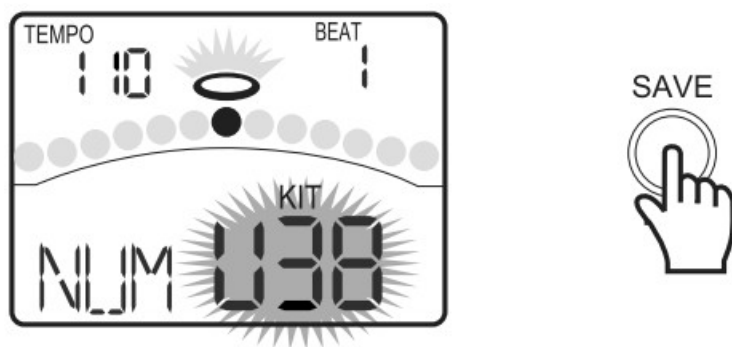

Making the Settings for Pads

About Settings of Pads

If the digital drum is not yet in UTILITY menu, press the [UTILITY] button to enter it.

The UTILITY indicator will light up. You can use the [<] or [>] buttons to adjust parameters (as shown to the right) for each pad as well as the rim sensitivity of the pad and the splash sensitivity of the Hi-Hat control pedal.

The current pad to be edited can be selected either by pressing its Pad Select button, or by striking the pad itself. The PAD indicator will light up to show which pad is currently selected. If the rim of a pad is selected, both the PAD indicator and the RIM indicator will turn on.

Sensitivity: Adjust the sensitivity of the pad to regulate the pad response. Higher settings result in higher sensitivity, so that the pad will produce a loud volume even when struck softly. You can also adjust the sensitivity of the splash in SPLASH SENSITIVITY.

Threshold: This setting allows a trigger signal to be received only when the pad is struck harder than a specified force. This can be used to prevent a pad from sounding in response to extraneous vibrations from another pad.

Crosstalk: When two pads are mounted on the same stand, the vibration produced by hitting one pad may trigger the sound from another pad unintentionally (This is called crosstalk). You can avoid this problem by adjusting Crosstalk Cancel on the pad that is sounding inadvertently. If the value is set too high, then when two pads are played simultaneously, the one that is struck less forcefully will not sound. So be careful and set this parameter to the minimum value required to prevent such crosstalk. With a setting of 0 , crosstalk prevention does not function.

Curve: This setting allows you to control the relation between the velocity (striking force) and changes in volume (the dynamic curve). Adjust this curve until the response feels as natural as possible.

Pad Settings	
Pad	Sensitivity(1-16)
	Threshold(0-16)
	Crosstalk(1-16)
	Curve(1-6)
Special	Rim Sensitivity(1-16)
	Splash Sensitivity(1-9)

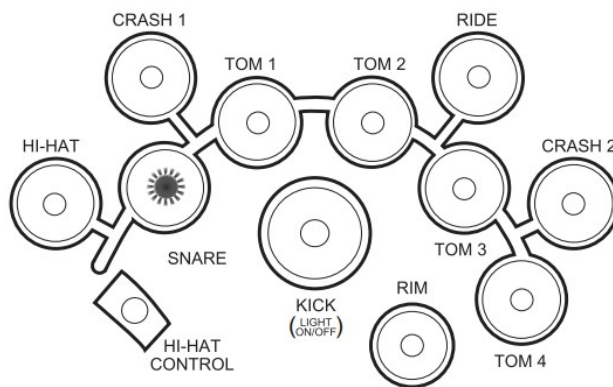

Adjusting the Pad Sensitivity

Press the [PAGE] or [UTILITY] button, select Pad Sensitivity page. The display will show:

Changes how a pad responds to your playing. At higher sensitivities, the pad will generate a louder signal, even when you play softly. At lower sensitivities, the pad will generate a quieter signal, even if you play strongly. Adjust according to your playing style and desired dynamic range.

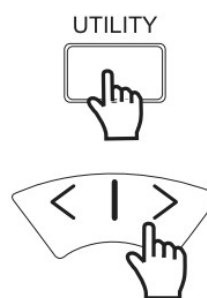
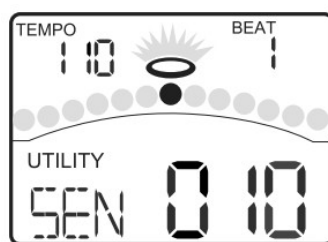

Setting the Pad Threshold

Press the [PAGE] or [UTILITY] button, select Pad Threshold page. The display will show:

Changes how forcefully you must strike the pad to generate a trigger signal. Setting a high threshold requires hitting the pad very hard to get a sound. This can help cut out transient responses, such as vibrations from the kit or accidental pad taps that you don't intend to generate sounds. Setting a low threshold means even light touches will produce sound. Adjust according to environment and playing style.

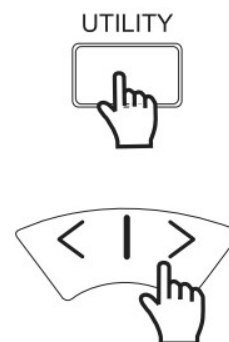
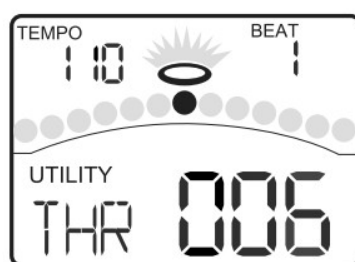

Eliminating Crosstalk between Pads

Press the [PAGE] or [UTILITY] button, select Pad Crosstalk page. The display will show:

When two pads are mounted close to each other, hitting one pad may trigger the sound from another pad unintentionally. This effect can be eliminated by setting this parameter to a higher value on the pad is triggered unintentionally.

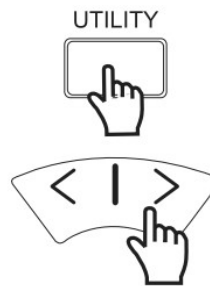
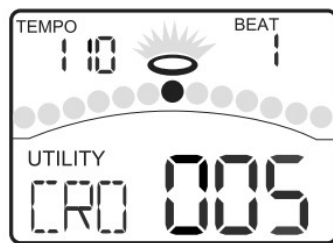

HINT

If the value is set too high, then when two pads are played simultaneously, the one that is struck less forcefully will not sound. So be careful and set this parameter to the minimum value required to prevent such crosstalk.

Selecting the Pad Curve

Press the [PAGE] or [UTILITY] button, select Pad Curve page.

The display will show:

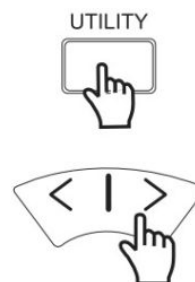
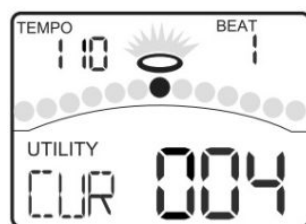

Making the Settings for Pads

Curve refers to how the trigger signal's dynamic response relates to your pad hit.

Curve 1: The standard setting, this produces the most natural correspondence between playing dynamics and volume change.

Curve 2, 3: Compared to Curve1, strong dynamics produce a greater change.

Curve 4, 5: Compared to Curve1, a soft playing produces a greater change.

Curve 6: Very little dynamic response, making it easy to maintain strong volume levels. If using drum triggers, these settings help maintain stable levels.

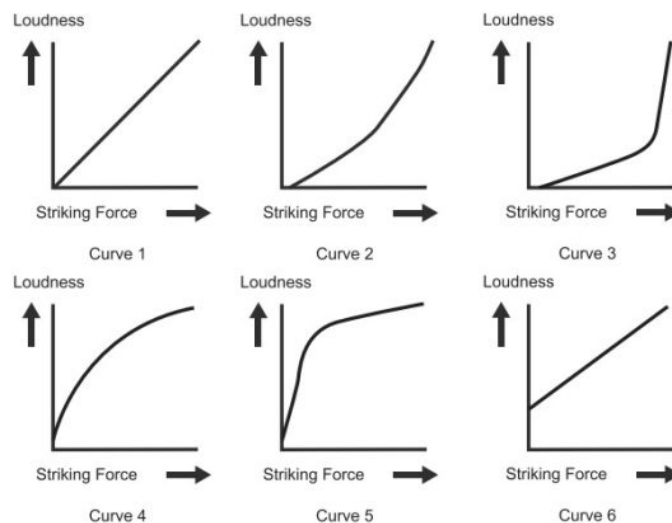

Setting Rim Sensitivity on Pads

You can only set rim sensitivity on Snare, Tom1, Tom2, Tom3, Tom4. If you select the other pads, this page will not appear.

Press the [PAGE] or [UTILITY] button, select Pad Rim Sensitivity page. The display will show:

Same as the basic sensitivity feature, except that it relates specifically to playing the rim.

Note:

This parameter can be adjusted only on SNARE, TOM1, TOM2, TOM3, TOM4. If you select the other pads on this page, a horizontal line “—” appears, and you can’t make the setting.

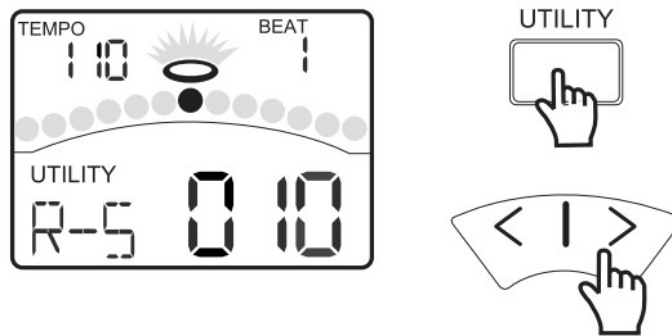

Adjusting the Hi-Hat Pedal Splash Sensitivity

Press the [PAGE] or [UTILITY] button, select Pedal Splash Sensitivity page. The display will show:
This Setting control the sensitivity of the foot splash.

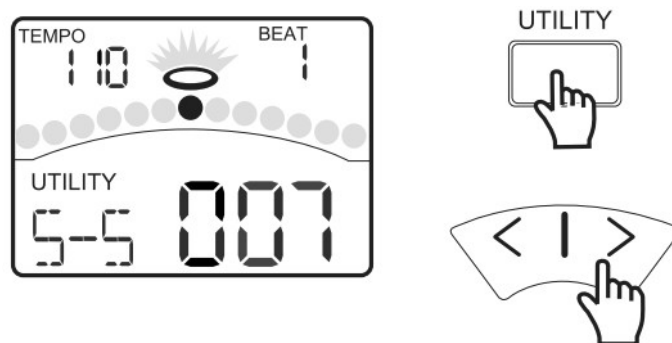

Saving Settings of Pads

After adjusting the trigger settings (sensitivity, Threshold, crosstalk, curve, rim sensitivity, splash sensitivity), you can save them into memory. In UTILITY menu, press the [SAVE] button to store all pad settings.

Note:

1. If you turn off the power without saving, you will lose the trigger setting changes you have just made.
2. These parameters affect all kits.

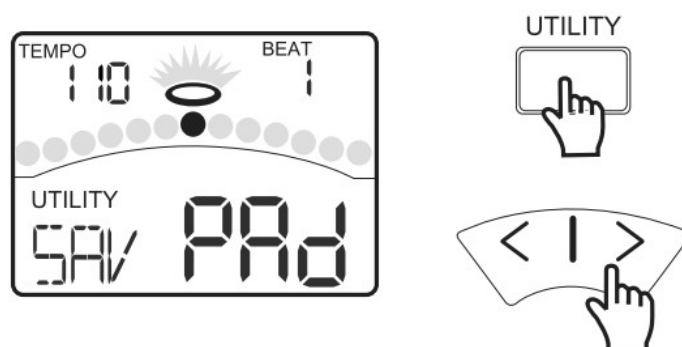

Setting the Metronome

About Click

The digital drum is equipped with a built-in metronome, which can be used by itself as a rhythm guide for practice, or in conjunction with the song playback or record functions. If the digital drum is not yet in CLICK menu, press the

[CLICK] button to enter it. In CLICK menu, you can use the [<] or [>] button to adjust the parameters(as shown to the right).

Click Settings	
Time signature	0-9/2, 0-9/4, 0-9/8, 0-9/16
Interval	1-2, 3-8, 1-4, 1-8, 1-12, 1-16
Volume	0-32
Voice	1-5

Switching the Click On/Off

- 1. Press the [CLICK] button to start the metronome. The CLICK LED will blink accordingly. The metronome will play at the current Time signature and tempo (displayed in the left right corner of the LCD)
- 2. Press the [CLICK] button again to stop the metronome. The CLICK indicator will turn off.

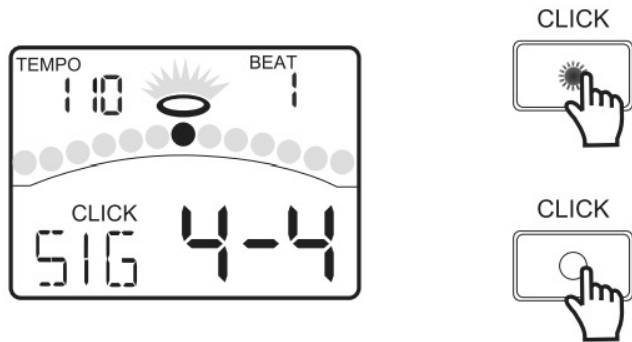

Adjusting the Click Tempo

Press the [TEMPO] button, and use the [<] or [>] buttons to adjust the current click tempo. The current tempo always displays in the top left corner of the LCD.

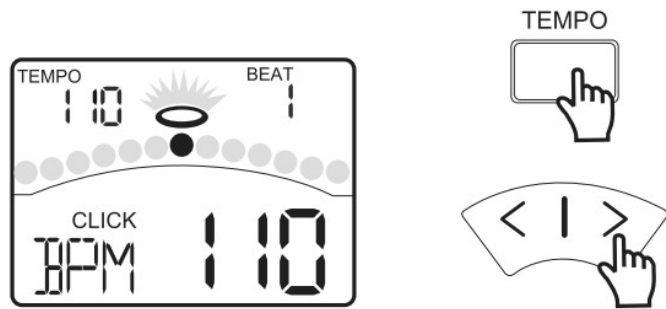

Setting the Time Signature

Press the [PAGE] button, select Click Time signature page. The display will show: When the parameter is set to “0”, such as 0-2,0-4,0-8,0-16, no accent is added to the first beat.

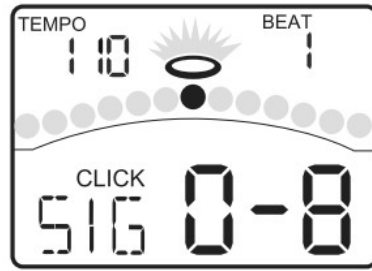

Setting the Interval

Press the [PAGE] button, select Click Interval page. The display will show:
This parameter sets how the sound plays.

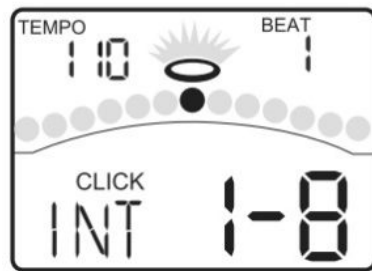

Adjusting the Click Volume

Press the [PAGE] button, select Click Volume page. The display will show:
This parameter adjust the volume of the click sound.

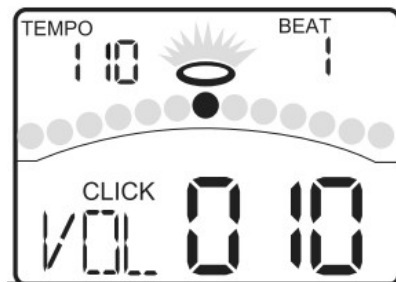

Selecting the Click Sound

Press the [PAGE] button, select Click Voice page. The display will show:
This parameter choose the sound for the click.



Playing Back Songs

About Songs

There are 80 preset songs in the digital drum:

- 50 Looped Patterns
- 10 Looped Percussion Patterns
- 5 Hit Songs
- 15 Tap Songs

Please refer to Song List. In SONG menu, you can select the song number and adjust the volume of the song's accompaniment and drum part.

Song Settings	
No.	Number(1-80)
Mix	Accomp(0-32)
	Drum(0-32)

HINT

The sounds in the tap song are played back one by one in sequence each time [START] is pressed or hitting the pad which is functioned as "pad song".

Selecting a Song

If the digital drum is not yet in SONG menu, press the [SONG] button to enter it. The SONG indicator will light up, and the LCD will display the current song number.

Press the [<] or [>] button to select a song. When holding down [>], the song number increase rapidly. When holding down [<], it decrease rapidly.

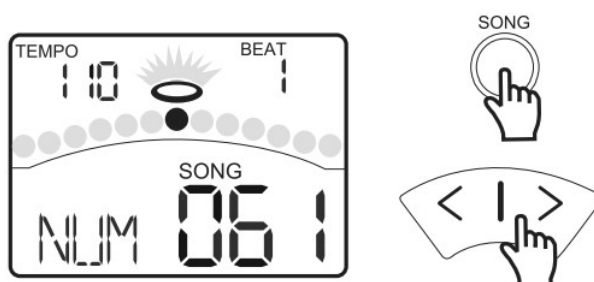

HINT

If the song number is switched while playing, the new song won't start until the end of the current bar.

Playing Back a Song

Press the [START/STOP] button to start song playback. The LCD will display the current playing beat. Press the [START/STOP] button again, stop the song during playback.

During song playback in SONG menu, the PAD indicators will show which pads of the drum track is triggering. This function can be disabled or enabled by pressing the [KICK] button while in SONG menu.

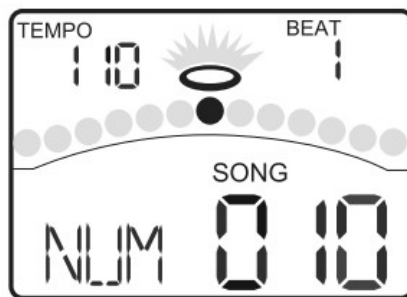

Adjusting the Accompaniment Volume

Press the [PAGE] or [SONG] button, select Song Accompaniment volume page. The display will show: Use the [<] or [>] to adjust it. It will be restore to default value on the next power on.

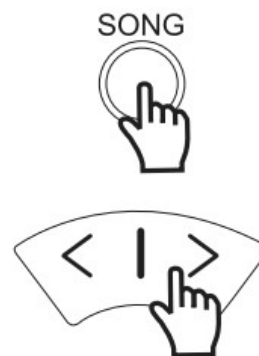

Adjusting the Drum Volume

Press the [PAGE] or [SONG] button, select Song Drum volume page. The display will show: Use the [<] or [>] to adjust it. It will be restore to default value on the next power on.

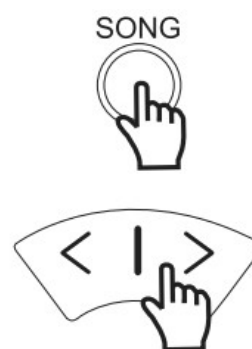
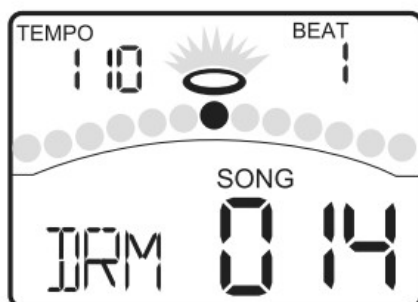

Muting the Drums in Songs

Press the [DRUM OFF] button to enable and disenable the drum mute function. When DRUM OFF is enabled, the LED will turn on.



Recording a Song

About Recording

In NORMAL mode, the digital drum allows you to quickly record your performance as you play the pads. There are two ways to start recording a new song:

- Press the [START/STOP] button
- Hit any pad

On Recording Standby, you can use the [<] or [>] button to adjust the parameters(as shown to the right).

Record Settings	
Song Number	—/1-60
Kit	1-45
Tempo	30-280
Signature	1-9/2, 1-9/4, 1-9/8, 1-9/16
Interval	1-2, 3-8, 1-4, 1-8, 1-12, 1-16
Drum Off	—/ON/OFF
Pre Count	ON/OFF

Recording Pad Performances

1. Press the [RECORD] button, enter recording standby. The [RECORD] LED will flash.
2. Press the [START/STOP] button or strike the pad. Recording will start. The RECORD LED will turn on. After Count-in, the display will show: Now you will record your performance.
3. Press the [START/STOP] button again, or press the [RECORD] button. Stop recording, the [RECORD] LED will turn off.

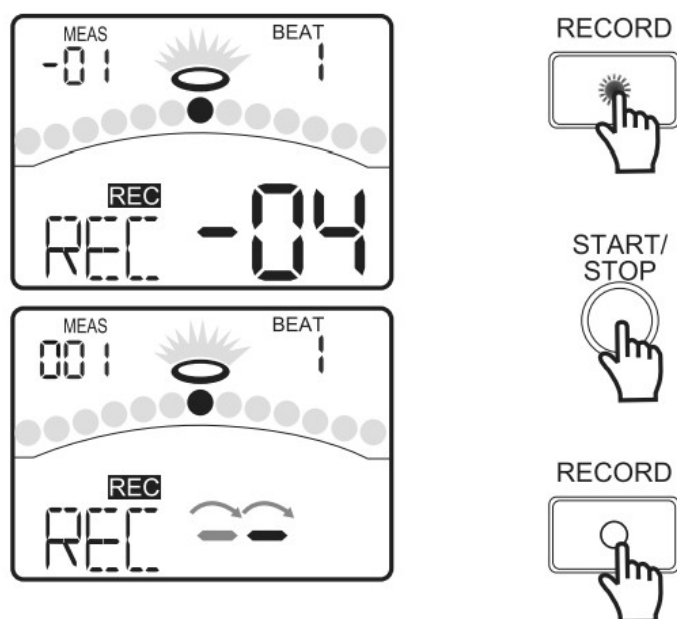

Recording Performances Accompanied with a Song

If you want to record your performance accompanied with a song, first set the parameters (Song Number and Drum off) before start to record. The display will be as shown to the right: For details on setting, refer to Recording Standby. Recording operations are as mentioned above.

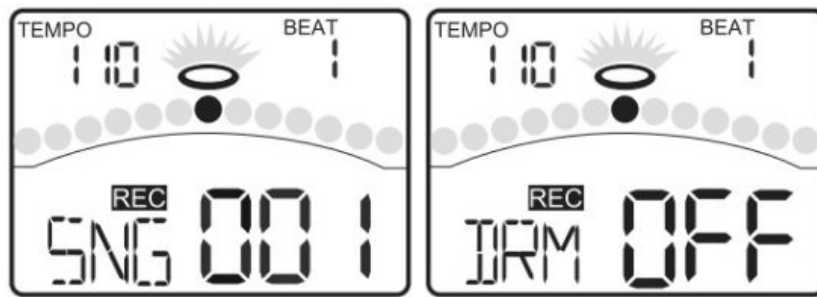

Playing Back Your Recorded Performance

Press the [PLAY] button. Play back your recording. The display will show:
Press the [PLAY] button again. Stop playing back your performance.

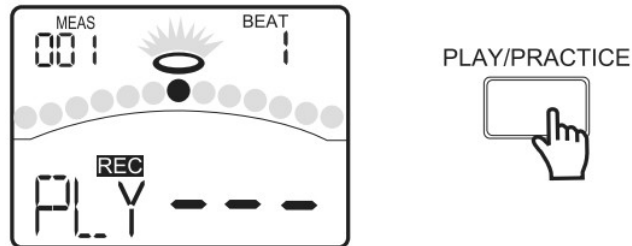

Recording Standby

Use the [PAGE] button to scroll through the various record parameters and the [<] or [>] button to adjust the value.

Page1: Setting the song accompanied or not

Page2: Selecting the drum kit that you want to record.

Page3: Setting the recording tempo

Page4: Setting the time signature

Page5: Setting the interval

Page6: Setting the drums in songs muted or not

Page7: Setting a measure count-in inserted or not before recording.



Practicing in Learning Mode

About Learning Mode

The LEARNING mode is a unique set of exercises specifically designed to help build speed, accuracy and stamina,

as well as develop better drum skills.

There are 42 practices in the digital drum:

- 20 Beats (Only Snare)
- 12 Rhythms (Only Drum, from Level1-Level6)

■ 10 Patterns (from Level1-Level5)

You can select appropriate patterns to practice depending on your present skills.

There are 3 states in Learning mode:

Follow me: Practice with the selected pattern

Score: Record and score your practice

Playback: Play back your recorded practice

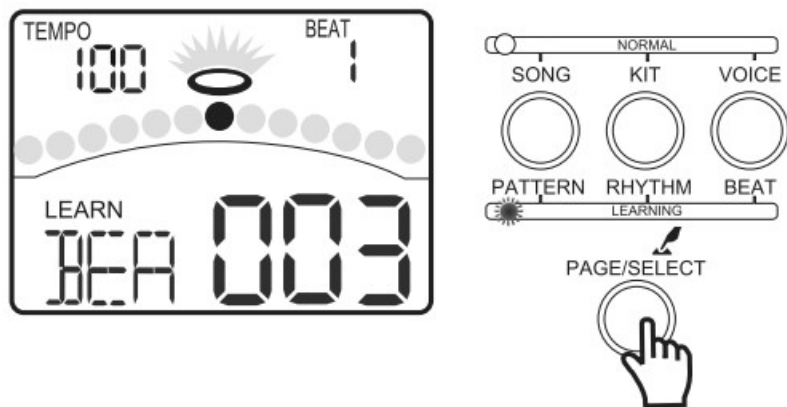

If the digital drum is not yet in LEARNING mode, press and hold the [PAGE/SELECT] button for 1 second. The LED of LEARNING mode will turn on. The display will show:

In this Learning Mode, after you press the [PRACTICE] or [START/STOP] to start practicing, your hitting accuracy will always be indicated in the middle of the display according to the current pattern.

DRAGGING:	<p>The display shows 'TEMPO 100' and 'BEAT 1'. The sunburst icon is dimmed. The 'SLOW' label is shown in a box below the dot row. The 'LEARNING' LED is on. The score is '003'.</p>
PERFECT:	<p>The display shows 'TEMPO 100' and 'BEAT 1'. The sunburst icon is bright. The 'GOOD' label is shown in a box below the dot row. The 'LEARNING' LED is on. The score is '003'.</p>
RUSHING:	<p>The display shows 'TEMPO 100' and 'BEAT 1'. The sunburst icon is dimmed. The 'FAST' label is shown in a box below the dot row. The 'LEARNING' LED is on. The score is '003'.</p>

Practicing with Beats

If the digital drum is not yet in BEAT menu, press the [BEAT] button to enter it. You can adjust the parameters (as shown to the right).

1. Press the [<] or [>] button to select the beat.
2. Press the [PRACTICE] button to listen to the beat and follow it. Press it again to stop the beat.
3. Press the [BEAT] or [PAGE] button to select the Beat Drum volume page. Press the [<] or [>] button to adjust the drum volume of the beat.

Beat	
Number	1-20
Drum Volume	0-32

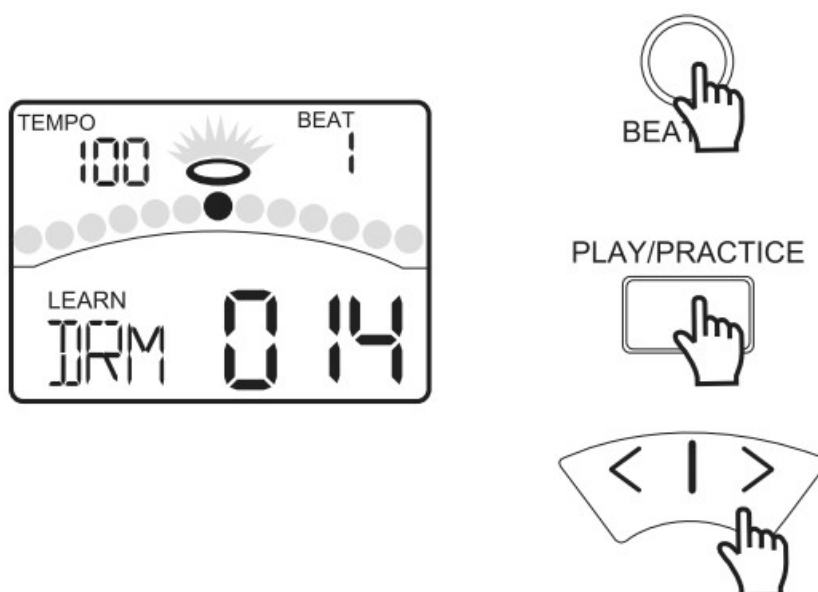

Practicing with Rhythms

If the digital drum is not yet in RHYTHM menu, press the [RHYTHM] button to enter it. You can adjust the parameters (as shown to the right).

1. Press the [<] or [>] button to select the rhythm.
2. Press the [PRACTICE] button to listen to the rhythm and follow it. Press it again to stop the rhythm.
3. Press the [RHYTHM] or [PAGE] button to select the Rhythm Level page. Press the [<] or [>] button to select the level of the rhythm.
4. Press the [RHYTHM] or [PAGE] button to select the Rhythm Drum Volume page. Press the [<] or [>] button to adjust the drum volume of the rhythm.

Rhythm	
Number	1-12
Level	1-6
Drum Volume	0-32

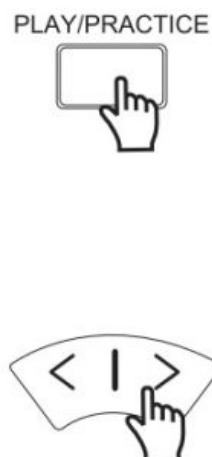
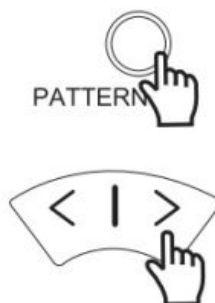
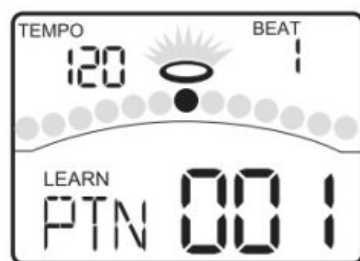

Practicing with Patterns

If the digital drum is not yet in Pattern menu, press the [PATTERN] button to enter it. You can adjust the parameters (as shown to the right).

1. Press the [<] or [>] button to select the pattern.
2. Press the [PRACTICE] button to listen to the pattern and follow it. Press it again to stop the pattern.
3. Press the [PATTERN] or [PAGE] button to select the Pattern Level page. Press the [<] or [>] button to select the level of the pattern.
4. Press the [PATTERN] or [PAGE] button to select the Pattern Accompany Volume page. Press the [<] or [>] button to adjust the accompaniment volume of the pattern.
5. Press the [PATTERN] or [PAGE] button to select the Pattern Drum Volume page. Press the [<] or [>] button to adjust the drum volume of the pattern.

Pattern	
Number	1-10
Level	1-5
Accompany Volume	0-32
Drum Volume	0-32

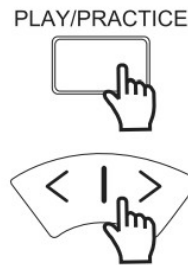
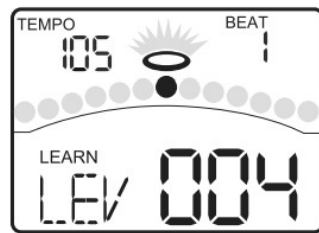
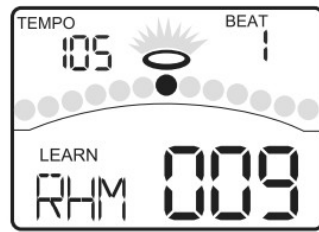

Recording and Scoring Your Practice

1. Press the [START/STOP] button, you can enter the score state. A measure count-in will be inserted before playing back the pattern so that you can practice in good time. When playing back the pattern, your performance will be recorded automatically. When finished playback, the digital drum will score your practice automatically.

The display will show the score for 3 seconds.

2. Press the [START/STOP] button again to stop playing back the pattern and recording your practice during the playback

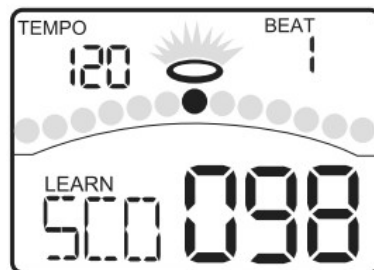
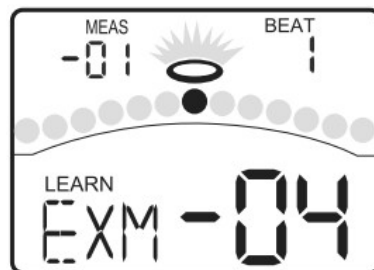

Playing Back Your Recorded Practice

1. Press and hold the [PLAY/PRACTICE] button for 2 seconds, you can enter the playback state. The display will show: You will listen to your recorded practice.
2. Press the [PLAY/PRACTICE] button again. Stop playing back the recorded practice.

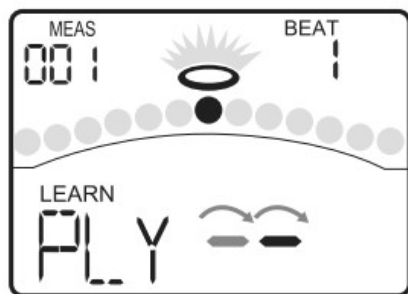

PLAY/PRACTICE



Making the Settings for MIDI

About MIDI

MIDI (Musical Instrument Digital Interface) is a standard that allows performance data and other information to be exchanged among electronic musical instruments and computers. With a MIDI cable connecting MIDI connectors equipped device, you can play multiple instruments with a single keyboard, have multiple instruments perform in ensemble, program the settings to change kits automatically to match the performance as the song progress, and more.

MIDI Connection

MIDI IN: This terminal receives MIDI data from an external MIDI device.

MIDI OUT: This terminal transmits data from the digital drum to other MIDI devices.

USB Connection

The USB connector allows you to connect the digital drum directly to your computer. It can be connected without installing a driver in Windows XP/Vista/Win7 or MAC OSX environments. The digital drum will be recognized as a "USB Audio device" to receive and transmit MIDI messages through a single USB cable. The USB port is used only for MIDI messages (MIDI via USB)

Note:

When the USB port is connected to a computer, all MIDI messages will be received and transmitted via USB.

Making the MIDI Settings

If the digital drum is not yet in UTILITY menu, press The [UTILITY] button to enter it. Press the [PAGE] or [UTILITY] button, select Local mode pages. The display will show:
Press the [<] or [>] button, set local mode to ON or OFF.

Local Mode

Local OFF: The pads and internal sequencer are disconnected from the digital drum's internal sound generator. Striking the pads does not cause sound to be produced by the internal sound generator.

Local ON: The pads and internal sequencer are connected to the digital drum's internal sound generator. Sounds are produced by the internal sound generator when the pads are struck.

GM Mode

Press the [PAGE] or [UTILITY] button, select GM mode pages.

The display will show:

Press the [<] or [>] button, set GM mode to ON or OFF.

Refer to Using the Digital Drum as a Sound Module.

Sync Mode

Press the [START/STOP] button to start or stop songs playback, the digital drum will transmit the MIDI system real-time Message: FA or FC.

MIDI Settings	
Local on/off	ON/OFF
GM on/off	ON/OFF

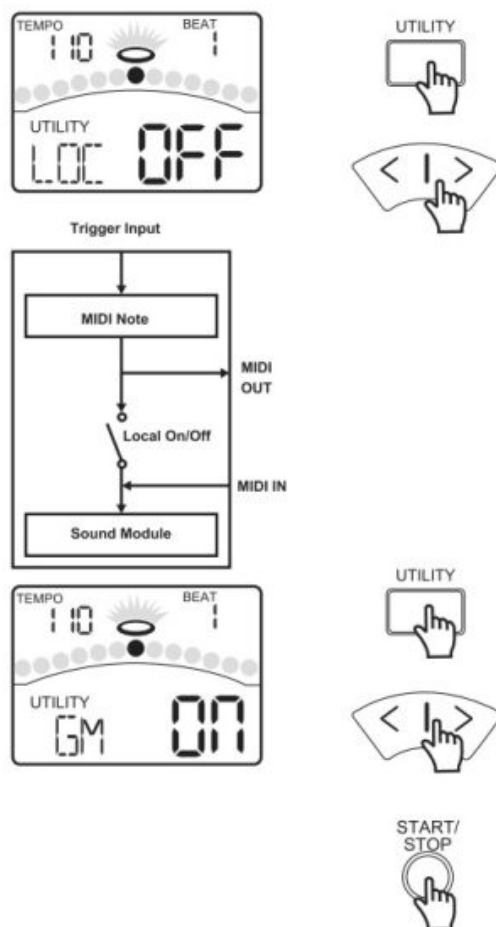

Connecting with an External Sound Device

The digital drum transmission channel for the drum kit is fixed to Channel 10. It will output MIDI data generated by the triggers when hitting the pads or stepping on the Hi-Hat control pedal (Note ON/OFF, and Foot messages). Song playback data and metronome notes are not transmitted.

Recording Your Performance to an External Sequencer

1. Connect the MIDI OUT of the digital drum to the MIDI IN of your sequencer, and the MIDI OUT of your sequencer to the MIDI IN of the digital drum. If you are using a software sequencer on a computer, you can simply connect the USB port of the digital drum to a USB port of your computer using a single USB A-B cable.
2. Setup the active track of your sequencer on Channel 10. Activate RECORD on your sequencer.
3. Play the pads of your digital drum.
4. Stop recording. Locate your sequencer to the start of your recording.
5. Playback the recorded sequencer.

Setting MIDI Note Number to be Transmitted/Received by Each Pad

Each drum kit can have it's own set of MIDI note to be transmitted/received by each pad, useful for advanced purpose. Normally, you'll never need to change them, but if you want to change, please follow these steps:

1. Press the [VOICE] button in NORMAL mode, enter the VOICE menu.

2. Press the [PAGE] or [VOICE] button, select Pad MIDI Note page.
3. Press the [<] or [>] button, change the MIDI Note Number for each pad. Hit the pad you wish to set or press the related Pad Select button.
4. Press the [SAVE] button twice to save to user kit.

Trigger	MIDI Note	Trigger	MIDI Note
Kick	36	Tom2	45
Snare	38	Tom2 R	47
Snare R	40	Tom3	43
Tom1	48	Tom3 R	58
Tom1 R	50	Tom4	41

Trigger	MIDI Note	Trigger	MIDI Note	Trigger	MIDI Note
Tom4 R	39	Crash1 R	55	Hi-Hat HO	23
Ride	51	Crash2	57	Hi-Hat C	42
Ride R	53	Crash2 R	52	Hi-Hat P	44
Crash1	49	Hi-Hat O	46	Splash	21

Using the Digital Drum as a Sound Module

Connecting an external keyboard or sequencer to the MIDI Input allows you to use the digital drum as a multi-part, polyphonic sound module to play various instrument parts in addition to your drums (for instance, Piano on Channel 1, Bass on Channel 2, Strings on Channel 3, etc). The voices on each MIDI channel are selected using MIDI Program Change messages (refer to GM Backing Instrument List).





The MIDI system in the digital drum has 16 reception channels numbered from 1-16. Each of the channels is responsible for a voice. When the instrument receives MIDI information from an external device, the active channel is determined by the control message. Channel 10 is reserved for Drums. The digital drum has two options for Channel 10: GM ON or OFF, as selected in MIDI UTILITY menu.

- When GM Mode is ON, Channel 10 will play the GM percussion kits.
- When GM Mode is OFF, Channel 10 will play the digital drum internal kits.

Note:

For more information on received MIDI messages, refer to MIDI implementation chart.

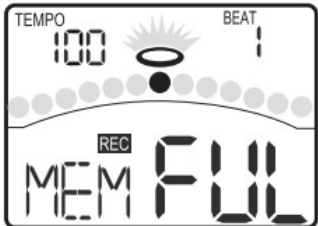
Prompt Messages

Display	Meaning	Action
	Resetting the digital drum is failed.	Please call the distributor, maybe it need repair.
	There isn't data in the digital drum's memory.	Please record your performance, and then play it.
	There is full of data in the digital drum's memory. You can not record any data.	If you want to record another song, please restart recording and replace it.
	You didn't record your practice in the Learning mode.	Please press the [START/STOP] button to score your practice, and then play back your practice.

Troubleshooting

	Possible Cause and Solution
No Sound	1) Rotate the [VOLUME] knob to be sure that the volume isn't down. 2) To be sure that Local Mode should be set to ON?
No Sound from Pads	1) To be sure that the pad is connected correctly. 2) To be sure not set the volume of the pad to 0.
No Click Sound	1) To be sure not set the volume of the click to 0.
Sound is Distorted	1) Turn down the volume.

Specifications

Maximum Polyphony

64

Drum kits

45 (29 Preset Kits + 16 User Kits)

General MIDI Kits

11 GM Kits

Drum Instruments

400 (Drums, Percussion, SFX)

7 Hi-Hat Combos

Effect

Reverb,3 Band Equalizer

Sequencer Normal

Song 80

Learning

Beat 20, Rhythm 12, Pattern 10

Resolution

120 ticks per quarter note

Recording Method

Real-time

Maximum Note Storage

approx.1600 Notes

Tempo

30~280

Display

Backlit Segment LCD

Connectors

9 Trigger Input Jack, Phone Jack(1/8", stereo), Aux In Jack(1/8", stereo),

2 External Trigger Input Jack(1/4", Tom4, Crash2), Output(1/4", L/Mono, R), USB, MIDI IN, MIDI OUT

Control Buttons

Power on/off switch, Volume, Start/Stop, Save, Song, Kit, Voice, Page/Select, INC/DEC, Click, Drum off, Record,

Tempo, Utility, Play/Practice

Pad Select Buttons

12 Pad Select Buttons

Power Supply

DC 9V

Dimensions

147.1(W) × 183.3(H)× 111.7(D)mm

Weight

0.5 kg

Drum Kit List

NO.	PRESET KIT	NO.	PRESET KIT
1	Acoustic	25	Tabla
2	Standard 1	26	Latin
3	Standard 2	27	808
4	Funk 1	28	Teckno 2
5	Funk 2	29	DJ
6	Fusion	30	Acoustic
7	Camco	31	Standard 1
8	Brush	32	Standard 2
9	Room	33	Funk 1
10	Rock	34	Funk 2
11	Pop Rock	35	Fusion
12	Jazz	36	Camco
13	Jazz Brush	37	Brush
14	Timpani	38	Room
15	Songo	39	Rock
16	1971's	40	Pop Rock
17	Disco	41	Jazz
18	TR606	42	Jazz Brush
19	909	43	Timpani
20	HipHop 1	44	Songo
21	HipHop 2	45	1971's
22	Electronic 1		
23	Electronic 2		
24	Teckno 1		

Drum Instrument List

No.	Name	54	Classic Snare 1	110	Electronic Snare 4
Acoustic Kick		55	Classic Snare Rim 1	111	Electronic Snare 5
1	Standard Kick 1	56	Classic Snare 2	112	Electronic Snare 6
2	Standard Kick 2	57	Classic Snare Rim 2	113	Electronic Snare 7
3	Classic Kick 1	58	Acoustic Snare	114	Electronic Snare 8
4	Classic Kick 2	59	Acoustic Snare Rim	Acoustic Tom	

5	Rock Kick 1	60	Rock Snare 1	115	Classic Tom 1
6	Rock Kick 2	61	Rock Snare Rim 1	116	Classic Tom 2
7	Rock Kick 3	62	Rock Snare 2	117	Classic Tom 3
8	Room Kick 1	63	Rock Snare 3	118	Classic Tom 4
9	Room Kick 2	64	Room Snare 1	119	Classic Tom 5
10	Jazz Kick 1	65	Room Snare 2	120	Classic Tom 6
11	Jazz Kick 2	66	Room Snare 3	121	Standard Tom 1
12	Big Band Kick 1	67	Steel Snare	122	Standard Tom 2
13	Big Band Kick 2	68	Steel Snare Rim	123	Standard Tom 3
14	Camco Kick 1	69	Jazz Snare 1	124	Standard Tom 4
15	Camco Kick 2	70	Jazz Snare Rim 1	125	Standard Tom 5
16	Funk Kick 1	71	Jazz Snare 2	126	Standard Tom 6
17	Funk Kick 2	72	Jazz Snare Rim 2	127	Camco Tom 1
18	Funk Kick 3	73	Jazz Latin Snare	128	Camco Tom 2
19	HipHop Kick 1	74	Big Band Snare	129	Camco Tom 3
20	HipHop Kick 2	75	Camco Snare	130	Camco Tom 4
21	HipHop Kick 3	76	Camco Snare Rim	131	Camco Tom 5
22	HipHop Kick 4	77	Brush Snare 1	132	Camco Tom 6
23	1969 Kick	78	Brush Snare 2	133	Rock Tom 1
24	1971 Kick	79	Brush Snare Rim	134	Rock Tom 2
25	1976 Kick	80	Funk Snare	135	Rock Tom 3
26	Power Kick	81	Funk Stick	136	Rock Tom 4
27	R&B Kick	82	Funk Band Snare	137	Rock Tom 5
28	Voice Kick	83	Funk Band Snare Rim	138	Rock Tom 6
29	Acoustic Kick	84	Funk Band Snare Stick	139	Room Tom 1
Electronic Kick		85	Fusion Snare	140	Room Tom 2
30	Orchestra Kick	86	Fusion Snare Stick	141	Room Tom 3
31	House Kick 1	87	Snare Stick	142	Room Tom 4
32	House Kick 2	88	Power Snare	143	Room Tom 5
33	House Kick 3	89	HipHop Snare 1	144	Room Tom 6
34	House Kick 4	90	HipHop Snare 2	145	Funk Tom 1
35	Step Kick	91	1969 Snare	146	Funk Tom 2

36	Teckno Kick	92	1969 Snare Rim	147	Funk Tom 3
37	Drum & Bass Kick	93	1971 Snare	148	Funk Tom 4
38	Junkyard Kick	94	1971 Snare Rim	149	Funk Tom 5
39	Noise Kick	95	1976 Snare	150	Funk Tom 6
40	Industry Kick	96	1976 Snare Rim	151	Fusion Tom 1
41	Lowfi Kick	Electronic Snare		152	Fusion Tom 2
42	Disco Kick	97	House Snare 1	153	Fusion Tom 3
43	808 Kick	98	House Snare 2	154	Fusion Tom 4
44	909 Kick	99	House Snare 3	155	Fusion Tom 5
45	Electronic Kick 1	100	Teckno Snare 1	156	Fusion Tom 6
46	Electronic Kick 2	101	Teckno Snare 2	157	1969 Tom 1
47	Electronic Kick 3	102	808 Snare	158	1969 Tom 2
48	Electronic Kick 4	103	909 Snare	159	1969 Tom 3
49	Electronic Kick 5	104	Drum & Bass Snare 1	160	1969 Tom 4
50	Electronic Kick 6	105	Drum & Bass Snare 2	161	1971 Tom 1
51	Electronic Kick 7	106	TR606 Snare	162	1971 Tom 2
Acoustic Snare		107	Electronic Snare 1	163	1971 Tom 3
52	Standard Snare	108	Electronic Snare 2	164	1971 Tom 4
53	Standard Snare Rim	109	Electronic Snare 3	165	1976 Tom 1
166	1976 Tom 2	222	Standard 22" Ride Rim	333	Cowbell 11
167	1976 Tom 3	223	Brush Ride	334	Tabla 1
168	1976 Tom 4	224	Brush Ride Rim	335	Tabla 2
169	HipHop Tom 1	225	Rock Ride	336	Tabla 3
170	HipHop Tom 2	226	Clean Pop Ride	337	Tabla 4
171	HipHop Tom 3	227	Flat Ride	338	Tabla 5
172	HipHop Tom 4	228	60's Ride	339	Tabla 6
173	HipHop Tom 5	229	808 Ride	340	Da Gu 1
174	HipHop Tom 6	Crash		341	Da Gu 2
175	Jazz Tom 1	230	Classic Crash 1	342	Zhu Ban
176	Jazz Tom 2	231	Classic Crash Rim 1	343	Nan Bang
177	Jazz Tom 3	232	Classic Crash 2	344	Da Mu Yu

178	Jazz Tom 4	233	Classic Crash Rim 2	345	Mu Yu 1
179	Jazz Tom 5	234	Standard Crash 1	346	Mu Yu 2
180	Jazz Tom 6	235	Standard Crash Rim 1	347	Mu Yu 3
181	Brush Tom 1	236	Standard Crash 2	348	Mu Yu 4
182	Brush Tom 2	237	Standard Crash 3	349	Pai Gu 1
183	Brush Tom 3	238	Rock Crash 1	350	Pai Gu 2
184	Brush Tom 4	239	Rock Crash 2	351	Pai Gu 3
185	Brush Tom 5	240	Splash	352	Mang Luo 1
186	Brush Tom 6	241	Brush Crash	353	Mang Luo 2
187	Tom Rim 1	242	China	354	Mang Luo 3
188	Tom Rim 2	243	Orchestra Crash	355	Da Luo 1
189	Tom Rim 3	244	HipHop Crash	356	Da Luo 2
190	Tom Rim 4	245	808 Crash	357	Da Po 1
191	Timpani 1	246	606 Crash	358	Da Po 2
192	Timpani 2	247	Electronic Crash	359	Xiao Po
193	Timpani 3	Hi-hat		360	Xiao Luo
194	Timpani 4	248	Standard Hi-hat Open	361	Ten Luo
195	TR606 Tom 1	249	Pop Hi-hat Open	362	Peng Lin
196	TR606 Tom 2	250	Rock Hi-hat Open	363	Gou Luo
197	TR606 Tom 3	251	Jazz Hi-hat Open	364	DJ 1
198	TR606 Tom 4	252	Electronic Hi-hat Open	365	DJ 2
199	TR606 Tom 5	253	808 Hi-hat Open	366	DJ 3
200	TR606 Tom 6	254	House Hi-hat Open	367	DJ 4
201	808 Tom 1	255	Standard Half Open	368	DJ 5
202	808 Tom 2	256	Pop Half Open	369	DJ 6
203	808 Tom 3	257	Rock Half Open	370	DJ 7
204	808 Tom 4	258	Jazz Half Open	371	DJ 8
205	808 Tom 5	259	Standard Hi-hat Close	372	DJ 9
206	808 Tom 6	260	Pop Hi-hat Close	373	DJ 10
207	Electronic Tom 1	261	Rock Hi-hat Close	374	One
208	Electronic Tom 2	262	Jazz Hi-hat Close	375	Two

209	Electronic Tom 3	263	Electronic Hi-hat Close	376	Three
210	Electronic Tom 4	264	808 Hi-hat Close	377	Four
211	Electronic Tom 5	265	House Hi-hat Close	378	Five
212	Electronic Tom 6	266	Standard Hi-hat Pedal	379	Six
213	909 Tom 1	267	Pop Hi-hat Pedal	380	Seven
214	909 Tom 2	268	Rock Hi-hat Pedal	381	Eight
215	909 Tom 3	269	Jazz Hi-hat Pedal	382	Nine
216	909 Tom 4	270	Electronic Hi-hat Pedal	383	Metronome Bell
Ride		271	808 Hi-hat Pedal	384	Metronome Click
217	Classic Ride	272	House Hi-hat Pedal	385	Clave Click 1
218	Classic Ride Rim	273	Standard Hi-hat Splash	386	Clave Click 2
219	Acoustic Ride	274	Rock Hi-hat Splash	387	Stick Click 1
220	Acoustic Ride Rim	Percussion		388	Stick Click 2
221	Standard 22" Ride	275	Metronome Bell	389	Cow Click 1
390	Cow Click 2	395	FX 3	HI-HAT COMBINATIONS	
391	Fm Click 1	396	FX 4	1	Standard
392	Fm Click 2	397	FX 5	2	Pop
FX		398	FX 6	3	Rock
393	FX 1	399	FX 7	4	Jazz
394	FX 2	400	FX 8	5	Electronic
				6	808
				7	House

GM Drum Kit List

Note No.	Standard 1 (bank 0)	Standard 2 (bank 4)	Room (bank 8)	Rock (bank 16)
27 D#1	High Q	<-	<-	<-
28 E1	Slap	<-	<-	<-
29 F1	Scratch Push	<-	<-	<-
30 F#1	Scratch Pull	<-	<-	<-
31 G1	Sticks	<-	<-	<-

32 G#1	Square Click	<-	<-	<-
33 A1	Metronome Click	<-	<-	<-
34 A#1	Metronome Bell	<-	<-	<-
35 B1	Acoustic Bass Drum	<-	Room Bass Drum 1	Rock Bass Drum 1
36 C2	Standard 1 Bass Drum	Standard 2 Bass Drum	Room Bass Drum 2	Rock Bass Drum 2
37 C#2	Side Stick	<-	<-	<-
38 D2	Standard 1 Snare	Standard 2 Snare	Room Snare	Rock Snare
39 D#2	Hand Clap	<-	<-	<-
40 E2	Standard 1 Snare Rim	Standard 2 Snare Rim	Room Snare Rim	Rock Snare Rim
41 F2	Standard 1 Tom 6	Standard 2 Tom 6	Room Tom 6	Rock Tom 6
42 F#2	Standard 1 Hi-hat Close	Standard 2 Hi-hat Close	Room Hi-hat Close	Rock Hi-hat Close
43 G2	Standard 1 Tom 5	Standard 2 Tom 5	Room Tom 5	Rock Tom 5
44 G#2	Standard 1 Hi-hat Pedal	Standard 2 Hi-hat Pedal	Room Hi-hat Pedal	Rock Hi-hat Pedal
45 A2	Standard 1 Tom 4	Standard 2 Tom 4	Room Tom 4	Rock Tom 4
46 A#2	Standard 1 Hi-hat Open	Standard 2 Hi-hat Open	Room Hi-hat Open	Rock Hi-hat Open
47 B2	Standard 1 Tom 3	Standard 2 Tom 3	Room Tom 3	Rock Tom 3
48 C3	Standard 1 Tom 2	Standard 2 Tom 2	Room Tom 2	Rock Tom 2
49 C#3	Standard 1 Crash 1	Standard 2 Crash 1	Room Crash 1	Rock Crash 1
50 D3	Standard 1 Tom 1	Standard 2 Tom 1	Room Tom 1	Rock Tom 1
51 D#3	Standard 1 Ride	Standard 2 Ride	Room Ride	Rock Ride
52 E3	Chinese Cymbal 1	<-	<-	<-
53 F3	Ride Bell	<-	Room Ride Bell	Rock Ride Bell
54 F#3	Tambourine	<-	<-	<-
55 G3	Splash Cymbal	<-	Room Splash Cymbal	Rock Splash Cymbal
56 G#3	Standard 1 Cowbell	Standard 2 Cowbell	Room Cowbell	Rock Cowbell
57 A3	Standard 1 Crash 2	Standard 2 Crash 2	Room Crash 2	Rock Crash 2
58 A#3	Vibra-slap	<-	<-	<-
59 B3	Ride Cymbal	<-	<-	<-
60 C4	Hi Bongo	<-	<-	<-
61 C#4	Low Bongo	<-	<-	<-
62 D4	Mute Hi Conga	<-	<-	<-

63 D#4	Open Hi Conga	<-	<-	<-
64 E4	Low Conga	<-	<-	<-
65 F4	High Timbale	<-	<-	<-
66 F#4	Low Timbale	<-	<-	<-
67 G4	High Agogo	<-	<-	<-
68 G#4	Low Agogo	<-	<-	<-
69 A4	Cabasa	<-	<-	<-
70 A#4	Maracas	<-	<-	<-
71 B4	Short Whistle	<-	<-	<-
72 C5	Long Whistle	<-	<-	<-
73 C#5	Short Guiro	<-	<-	<-
74 D5	Long Guiro	<-	<-	<-
75 D#5	Claves	<-	<-	<-
76 E5	Hi Wood Block	<-	<-	<-
77 F5	Low Wood Block	<-	<-	<-
78 F#5	Mute Cuica	<-	<-	<-
79 G5	Open Cuica	<-	<-	<-
80 G#5	Mute Triangle	<-	<-	<-
81 A5	Open Triangle	<-	<-	<-
82 A#5	Shaker	<-	<-	<-
83 B5	Jingle Bell	<-	<-	<-
84 C6	Bell Tree	<-	<-	<-
85 C#6	Castanets	<-	<-	<-
86 D6	Mute Surdo	<-	<-	<-
87 D#6	Open Surdo	<-	<-	<-

Note No .	Funk (bank 17)	Electronic (bank 24)	808 (bank 25)	House (bank 28)
27 D#1	<-	<-	<-	<-
28 E1	<-	<-	<-	<-
29 F1	<-	<-	<-	<-
30 F#1	<-	<-	<-	<-
31 G1	<-	<-	<-	<-
32 G#1	<-	<-	<-	<-

33 A1	<-	<-	<-	<-
34 A#1	<-	<-	<-	<-
35 B1	Funk Bass Drum 1	Electronic Bass Drum 1	808 Bass Drum 1	House Bass Drum 1
36 C2	Funk Bass Drum 2	Electronic Bass Drum 2	808 Bass Drum 2	House Bass Drum 2
37 C#2	<-	<-	<-	<-
38 D2	Funk Snare	Electronic Snare	808 Snare	House Snare
39 D#2	<-	<-	<-	House Hand Clap
40 E2	Funk Snare Rim	Electronic Snare Rim	808 Snare Rim	House Snare Rim
41 F2	Funk Tom 6	Electronic Tom 6	808 Tom 6	House Tom 6
42 F#2	Funk Hi-hat Close	Electronic Hi-hat Close	808 Hi-hat Close	House Hi-hat Close
43 G2	Funk Tom 5	Electronic Tom 5	808 Tom 5	House Tom 5
44 G#2	Funk Hi-hat Pedal	Electronic Hi-hat Pedal	808 Hi-hat Pedal	House Hi-hat Pedal
45 A2	Funk Tom 4	Electronic Tom 4	808 Tom 4	House Tom 4
46 A#2	Funk Hi-hat Open	Electronic Hi-hat Open	808 Hi-hat Open	House Hi-hat Open
47 B2	Funk Tom 3	Electronic Tom 3	808 Tom 3	House Tom 3
48 C3	Funk Tom 2	Electronic Tom 2	808 Tom 2	House Tom 2
49 C#3	Funk Crash 1	<-	808 Crash 1	<-
50 D3	Funk Tom 1	Electronic Tom 1	808 Tom 1	House Tom 1
51 D#3	Funk Ride	<-	<-	<-
52 E3	<-	<-	<-	<-
53 F3	<-	<-	<-	<-
54 F#3	<-	<-	<-	<-
55 G3	<-	<-	<-	<-
56 G#3	<-	<-	<-	<-
57 A3	Funk Crash 2	<-	808 Crash 2	<-
58 A#3	<-	<-	<-	<-
59 B3	<-	<-	<-	<-
60 C4	<-	<-	<-	<-
61 C#4	<-	<-	<-	<-
62 D4	<-	<-	808 Mute Hi Conga	<-
63 D#4	<-	<-	808 Open Hi Conga	<-
64 E4	<-	<-	808 Low Conga	<-
65 F4	<-	<-	<-	<-

66 F#4	<-	<-	<-	<-
67 G4	<-	<-	<-	<-
68 G#4	<-	<-	<-	<-
69 A4	<-	<-	<-	<-
70 A#4	<-	<-	808 Maracas	<-
71 B4	<-	<-	<-	<-
72 C5	<-	<-	<-	<-
73 C#5	<-	<-	<-	<-
74 D5	<-	<-	<-	<-
75 D#5	<-	<-	808 Claves	<-
76 E5	<-	<-	<-	<-
77 F5	<-	<-	<-	<-
78 F#5	<-	<-	<-	<-
79 G5	<-	<-	<-	<-
80 G#5	<-	<-	<-	<-
81 A5	<-	<-	<-	<-
82 A#5	<-	<-	<-	<-
83 B5	<-	<-	<-	<-
84 C6	<-	<-	<-	<-
85 C#6	<-	<-	<-	<-
86 D6	<-	<-	<-	<-
87 D#6	<-	<-	<-	<-

Note No.	Jazz (bank 32)	Brush (bank 40)	Orchestra (bank 48)
27 D#1	<-	<-	Concert Hi-hat Close
28 E1	<-	<-	Concert Hi-hat Pedal
29 F1	<-	<-	Concert Hi-hat Open
30 F#1	<-	<-	Concert Ride
31 G1	<-	<-	<-
32 G#1	<-	<-	<-
33 A1	<-	<-	<-
34 A#1	<-	<-	<-
35 B1	Jazz Bass Drum 1	Brush Bass Drum 1	Concert Bass Drum 1

36 C2	Jazz Bass Drum 2	Brush Bass Drum 2	Concert Bass Drum 2
37 C#2	<-	<-	<-
38 D2	Jazz Snare	Brush Snare	Concert Snare 1
39 D#2	<-	<-	Castanets
40 E2	Jazz Snare Rim	Brush Snare Rim	Concert Snare 2
41 F2	Jazz Tom 6	Brush Tom 6	Timpani F
42 F#2	Jazz Hi-hat Close	<-	Timpani F#
43 G2	Jazz Tom 5	Brush Tom 5	Timpani G
44 G#2	Jazz Hi-hat Pedal	<-	Timpani G#
45 A2	Jazz Tom 4	Brush Tom 4	Timpani A
46 A#2	Jazz Hi-hat Open	<-	Timpani A#
47 B2	Jazz Tom 3	Brush Tom 3	Timpani B
48 C3	Jazz Tom 2	Brush Tom 2	Timpani C
49 C#3	<-	Brush Crash 1	Timpani C#
50 D3	Jazz Tom 1	Brush Tom 1	Timpani D
51 D#3	Jazz Ride	Brush Ride	Timpani D#
52 E3	<-	<-	Timpani E
53 F3	<-	<-	Timpani F
54 F#3	<-	<-	<-
55 G3	<-	<-	<-
56 G#3	<-	<-	<-
57 A3	Chinese Cymbal 2	Brush Crash 2	Concert Crash 1
58 A#3	<-	<-	<-
59 B3	<-	<-	Concert Crash 2
60 C4	<-	<-	<-
61 C#4	<-	<-	<-
62 D4	<-	<-	<-
63 D#4	<-	<-	<-
64 E4	<-	<-	<-
65 F4	<-	<-	<-
66 F#4	<-	<-	<-
67 G4	<-	<-	<-
68 G#4	<-	<-	<-

69 A4	<-	<-	<-
70 A#4	<-	<-	<-
71 B4	<-	<-	<-
72 C5	<-	<-	<-
73 C#5	<-	<-	<-
74 D5	<-	<-	<-
75 D#5	<-	<-	<-
76 E5	<-	<-	<-
77 F5	<-	<-	<-
78 F#5	<-	<-	<-
79 G5	<-	<-	<-
80 G#5	<-	<-	<-
81 A5	<-	<-	<-
82 A#5	<-	<-	<-
83 B5	<-	<-	<-
84 C6	<-	<-	<-
85 C#6	<-	<-	<-
86 D6	<-	<-	<-
87 D#6	<-	<-	<-

PIANO		43	Celloi	86	Lead6 (voice)
1	Acoustic Grand Piano	44	Contrabass	87	Lead7 (fifths)
2	Bright Acoustic Piano	45	Tremoio Strings	88	Lead8 (bass & Lead)
3	Electric Grand Piano	46	Pizzicato Strings	PAD	
4	Honky-Tonk Piano	47	Orchestral Harp	89	Pad1 (newage)
5	E.Piano 1	48	Timpan	90	Pad2 (warm)
6	E.Piano 2	STRINGS ENSEMBLE		91	Pad3 (Polysynth)
7	Harpsichord	49	Strings Ensemble 1	92	Pad4 (choir)
8	Clavi	50	Strings Ensemble 2	93	Pad5 (bowed)
MALLET		51	Synth Strings 1	94	Pad6 (metallic)

9	Celesta	52	Synth Strings 2	95	Pad7 (halo)
10	Glockenspiel	53	Choir Aahs	96	Pad8 (sweep)
11	Music Box	54	Voice Oohs	EFFECTS	
12	Vibraphone	55	Synth Voice	97	FX1 (rain)
13	Marimba	56	Orchestra Hit	98	FX2 (soundtrack)
14	Xylophone	BRASS		99	FX3 (crystal)
15	Tubular Bells	57	Trumpet	100	FX4 (atmosphere)
16	Dulcimer	58	Trombone	101	FX5 (brightness)
ORGAN		59	Tuba	102	FX6 (goblins)
17	Drawbar Organ	60	Muted Trumpet	103	FX7 (echoes)
18	Percussive Organ	61	French Horn	104	FX8 (sci-fi)
19	Rock Organ	62	Brass Section	ETHNIC	
20	Church Organ	63	Synth Brass 1	105	Sitar
21	Reed Organ	64	Synth Brass 2	106	Banjo
22	Accordion	REED		107	Shamisen
23	Harmonica	65	Soprano Sax	108	Koto
24	Tango Accordion	66	Alto Sax	109	Kalimba
GUITAR		67	Tenor Sax	110	Bagpipe
25	Nylon Guitar	68	Baritone Sax	111	Fiddle
26	Steel Guitar	69	Oboe	112	Shanai
27	Jazz Guitar	70	English Horn	PERCUSSIVE	
28	Clean Guitar	71	Bassoon	113	Tinkle Bell
29	Muted Guitar	72	Clarinet	114	Agogo
30	Overdriven Guitar	PIPE		115	Steel Drums
31	Distortion Guitar	73	Piccolo	116	Wood Block
32	Guitar Harmonics	74	Flute	117	Taiko Drum
BASS		75	Recorder	118	Melodic Tom
33	Acoustic Bass	76	Pan Flute	119	Synth Drum
34	Finger Bass	77	Blown Bottle	120	Reverse Cymbal
35	Pick Bass	78	Shakuhachi	SOUND EFFECTS	
36	Fretless Bass	79	Whistle	121	Guitar Fret Noise
37	Slap Bass 1	80	Ocarina	122	Breath Noise

38	Slap Bass 2	LEAD		123	Seashore
39	Synth Bass 1	81	Lead1 (square)	124	Bird Tweet
40	Synth Bass 2	82	Lead2 (sawtooth)	125	Telephone Ring
STRINGS		83	Lead3 (calliophe)	126	Helicopter
41	Violin	84	Lead4 (chiff)	127	Applause
42	Viola	85	Lead5 (charang)	128	Gunshot

Song List

No.	Name	Type	No.	Name	Type
1	Drum Intro	Loop	41	Mambo	Loop
2	Drum Main A	Loop	42	Latin Rock 1	Loop
3	Drum Main B	Loop	43	Latin Pop 2	Loop
4	Electronic&Funk	Loop	44	Guitar Bossa	Loop
5	Modern Pop	Loop	45	Country Blues	Loop
6	Fusion 1	Loop	46	Rock	Loop
7	HipHop	Loop	47	Reggae 1	Loop
8	Latin Jazz 1	Loop	48	60's Rock	Loop
9	Funk 1	Loop	49	Blues	Loop
10	Big Band 1	Loop	50	World 1	Loop
11	Funk 2	Loop	51	World 2	Loop
12	Pop Funk 1	Loop	52	Latin	Loop
13	Fusion 2	Loop	53	Bossa	Loop
14	Funk 3	Loop	54	Samba 2	Loop
15	Fusion 3	Loop	55	3/4 Pop	Loop
16	Funk 4	Loop	56	Pop	Loop
17	Fusion 4	Loop	57	Jazz 2	Loop
18	Pop Funk 2	Loop	58	Reggae 2	Loop
19	R&B	Loop	59	Reggae 3	Loop
20	Drum & Bass 1	Loop	60	Latin Rock 2	Loop
21	Break Beat	Loop	61	Chorused Piano Tap 1	Hit
22	Dance	Loop	62	Fifths Tap	Hit

23	Drum & Bass 2	Loop	63	Brightness Tap 1	Hit
24	Latin Dance 1	Loop	64	Atmosphere	Hit
25	Latin Dance 2	Loop	65	Chorused Piano Tap 2	Hit
26	Swing 1	Loop	66	Bass Tap 1	Tap
27	Latin Jazz 2	Loop	67	Synth string Tap	Tap
28	Big Band 2	Loop	68	Brightness Tap 2	Tap
29	3/4 Jazz	Loop	69	Bass Tap 2	Tap
30	Jazz 1	Loop	70	Pad Tap 1	Tap
31	Latin Jazz 3	Loop	71	Vibraphone	Tap
32	Swing 2	Loop	72	Bass Tap 3	Tap
33	6/8 Ballad	Loop	73	Rain Tap	Tap
34	Pop Ballad	Loop	74	Pizzcato Strings	Tap
35	Pop Bossa	Loop	75	Bass Tap 4	Tap
36	16Beat Pop	Loop	76	Crystal	Tap
37	Pop Shuffle	Loop	77	Xylophone	Tap
38	Ballad	Loop	78	Bass Tap 5	Tap
39	Samba 1	Loop	79	Pad Tap 2	Tap
40	Latin Pop 1	Loop	80	Glockenspiel Tap	Tap

Pattern List

Number	Name	Beat	Tempo	Measure
1	Beat 1	4/4	100	4
2	Beat 2	4/4	100	4
3	Beat 3	4/4	100	4
4	Beat 4	4/4	100	4
5	Beat 5	4/4	100	4
6	Beat 6	4/4	100	4
7	Beat 7	4/4	100	4
8	Beat 8	4/4	100	4
9	Beat 9	4/4	100	4
10	Beat 10	4/4	100	4
11	Beat 11	4/4	100	4
12	Beat 12	4/4	100	4

13	Beat 13	4/4	100	4
14	Beat 14	4/4	100	4
15	Beat 15	4/4	100	4
16	Beat 16	4/4	100	4
17	Beat 17	4/4	100	4
18	Beat 18	4/4	100	4
19	Beat 19	4/4	100	4
20	Beat 20	4/4	100	4
1	Funk 1	4/4	110	4
2	Funk 2	4/4	90	4
3	HipHop 1	4/4	90	4
4	HipHop 2	4/4	113	4
5	Jazz 1	4/4	157	4
6	Jazz 2	4/4	187	4
7	Latin 1	4/4	190	4
8	Latin 2	4/4	200	4
9	Pop Rock 1	4/4	105	4
10	Pop Rock 2	4/4	97	4
11	Rock	4/4	100	4
12	6/8 Pop Rock	6/8	125	4
1	Funk	4/4	120	4
2	HipHop	4/4	110	4
3	Latin Jazz	4/4	130	8
4	6/8 Ballad	6/8	96	4
5	Bossanova	4/4	82	8
6	R&B	4/4	86	4
7	3/4 Jazz	3/4	120	10
8	Reggae	4/4	78	4
9	Rock	4/4	100	4
10	Fusion	4/4	103	4

Parameter List

NORMAL MODE

KIT		
Parameter	Abbreviation	Value
Kit Number	NUM	1-45
Kit Volume	VOL	0-32
Reverb	REV	ON / OFF
EQ High	EQH	-12 — +12
EQ Middle	EQM	-12 — +12
EQ Low	EQL	-12 — +12
SONG		
Parameter	Abbreviation	Value
Song Number	NUM	1-80
Accomp Volume of Song	ACC	0-32
Drum Volume of Song	DRM	0-32
UTILITY		
Parameter	Abbreviation	Value
Pad Sensitivity	SEN	1-16
Pad Threshold	THR	0-16
Crosstalk	CRO	1-16
Curve	CUR	1-6
Rim Sensitivity	R-S	1-16
Splash Sensitivity	S-S	1-9
Local on/off	LOC	ON/OFF
GM on/off	GM	ON/OFF
TEMPO		
Parameter	Abbreviation	Value
TEMPO	BPM	30-280

VOICE		
Parameter	Abbreviation	Value
Voice Number	NUM/H-C	1-400/1-7
Voice Volume	VOL	0-32
Voice Pan	PAN	-8 — +8
Voice Pitch	PIT	-8 — +8
Voice Reverb	REV	0-16
MIDI Note	MID	0-127
Pad Song Switch	P-5	ON / OFF
Pad Song Number	P-N	1-80

CLICK		
Parameter	Abbreviation	Value
Signature	SIG	0-9/2, 0-9/4, 0-9/8, 0-9/16
Interval	INT	1-2, 3-8, 1-4, 1-8, 1-12, 1-16
Click Volume	VOL	0-32
Click Voice	VOC	1-5
RECORD		
Parameter	Abbreviation	Value
Song Number	SNG	—/1-60
Kit	KIT	1-45
Tempo	BPM	30-280
Signature	SIG	1-9/2, 1-9/4, 1-9/8, 1-9/16
Interval	INT	1-2, 3-8, 1-4, 1-8, 1-12, 1-16
Drum Off	DRM	—ION/OFF
Pre Count	PRC	ON/OFF

LEARNNIG MODE

BEAT		
Parameter	Abbreviation	Value
Beat Type	BEA	1–20
Drum Volume	DRM	0-32
RHYTHM		
Parameter	Abbreviation	Value
Rhythm Type	RFIM	1–12
Level	LEV	1–6
Drum Volume	VOL	0-32
PATTERN		
Parameter	Abbreviation	Value
Pattern Type	PTN	1–10
Level	LEV	1–5
Accompany Volume	ACC	0-32
Drum Volume	DRM	0-32

MIDI Implementation Chart

Function	Transmitted	Recognized	Remarks
Basic Default Channel Changed	10ch x	1-16 x	
Default Mode Messages Altered	x x *****	x x *****	
Note Number : True Voice	0-127 *****	0 —127 0-127	
Velocity Note On Note Off	0 99H,V=1-127 x (99H,V=0)	0 0	
after Key's Touch Ch's	x x	0 (drum kit part onl y) x	
Pitch Bend	x	x	



Control 0	x	0	Bank Select
Change 1	x	0	Modulation
5	x	0	Portamento Time
6	x	0	Data Entry
7	x	0	Volume
10	x	0	Pan
11	x	0	Expression
64	x	0	Sustain Pedal
65	x	0	Portamento On/Off
66	x	0	Sostenuto Pedal
67	x	0	Soft Pedal
80	x	0	Reverb Program
81	x	0	Chorus Program
91	x	0	Reverb Level
93	x	0	Chorus Level
120	x	0	All Sound Off
121	x	0	Reset All Controllers All
123	x	0	Notes Off
Program	x	0	
Change : True Number	xxxxxxx	0-127	
System Exclusive	x	0	
System : Song Position	x	x	
Common : Song Select	x	x	
: Tune	x	x	
System : Clock	0	x	
Real Time : Commands	0	x	Start And Stop Only
Aux : Local On/off	x	x	
: All Notes Off Messages : Active Sensing	x	x	
: Reset	x	0	
		x	



Documents / Resources

	XDRUM DD-530 E-Drum Set with Mesh Heads [pdf] Instruction Manual DD-530, DHS-1, DD-530 E-Drum Set with Mesh Heads, DD-530, E-Drum Set with Mesh Heads, Mesh Heads, Heads
---	---

References

-  [Musikhaus Kirstein - E Pianos, E Drums, Akkordeons & More](#)
-  [Musikhaus Kirstein - E Pianos, E Drums, Akkordeons & More](#)

- [User Manual](#)

[Manuals+](#), [Privacy Policy](#)

This website is an independent publication and is neither affiliated with nor endorsed by any of the trademark owners. The "Bluetooth®" word mark and logos are registered trademarks owned by Bluetooth SIG, Inc. The "Wi-Fi®" word mark and logos are registered trademarks owned by the Wi-Fi Alliance. Any use of these marks on this website does not imply any affiliation with or endorsement.