



# WZUICOV B0CBSHN3JY Bluetooth Game Controller User Guide

[Home](#) » [WZUICOV](#) » WZUICOV B0CBSHN3JY Bluetooth Game Controller User Guide 

WZUICOV B0CBSHN3JY Bluetooth Game Controller



## Contents

- 1 [Applicable to the following controller models](#)
- 2 [About firmware version](#)
- 3 [For iPhone / iPad / Mac / Apple TV \(Bluetooth \)](#)
- 4 [For iPad or Mac/MacBook \(USB -C wired](#)
- 5 [For Android Phone / Tablet / TV / TV Box \(Bluetooth\)](#)
- 6 [Wired connection to Android, just plug it in directly](#)
- 7 [For Android Phone / Tablet / TV / TV Box \(USB 2.4G Wireless\)](#)
- 8 [For Switch \(Bluetooth and wired\)](#)
- 9 [For Windows \(Bluetooth, 2,4G Wireless, Wired\)](#)
- 10 [For Tesla](#)
- 11 [For PS3 and PS4](#)
- 12 [About P4 & P5 connection](#)
- 13 [For V3 mapping mode](#)
- 14 [Documents / Resources](#)
  - 14.1 [References](#)
- 15 [Related Posts](#)

## Applicable to the following controller models

1. Red & Blue Game Controller



## 2. Red & Blue (Star) Game Controller



The following two blue working modes are universally connected to multiple devices and games

### [R1 + Home] Enable Xbox controller mode

- Press and hold R1, then press the 'Home'
- Open the Bluetooth list to connect



After the connection is successful,  
LED 1, 2, 3 are always on.

### Recommended for:

- Gamers accustomed to Xbox controllers
- Android Phone /Tablet / TV /TV Box /Chromebook
- Windows PC /Laptop /Surface
- Tesla Model

### [B + Home] Enable DualShock 4 Wireless Controller mode

- Press and hold B, then press the 'Home'
- Open the Bluetooth list to connect



After the connection is successful, LED 4 are always on.

### Recommended for:

- Gamers accustomed to PS controllers
- iPad /iPad / Apple TV /Mac /MacBook
- PS Remote Play

The above are recommendations from test technicians.

However, these two Bluetooth modes are generally compatible with Android or iOS. You can choose freely if the game you want to play is also compatible with the controller type.

- The controller also supports wired and 2.4G wireless receivers
- The following list will introduce recommended connection methods

### About firmware version

- The current firmware version is Ver 1.42



- Whether it is iOS or Android, it is recommended to install the app ShootingPlus V3 or ShootingPlus
- If you have usage problems and give feedback, even better suggestions can be provided



- When an update is released, the controller is connected to the mobile phone and the firmware can be updated using the APP.
- [A+ Home Enable Bluetooth for V3 Bluetooth Name: LJC-269

### **For iPhone / iPad / Mac / Apple TV (Bluetooth )**

#### **[B+ Home] Connect iPhone or iPad**

- Press and hold B, then press the Home button
- At this time LED 4 flash



After the connection is successful,

LED 4 are always on.

### Open Bluetooth list

Settings → Bluetooth (on)

**Bluetooth name:** DualShock 4 **Wireless**Controller

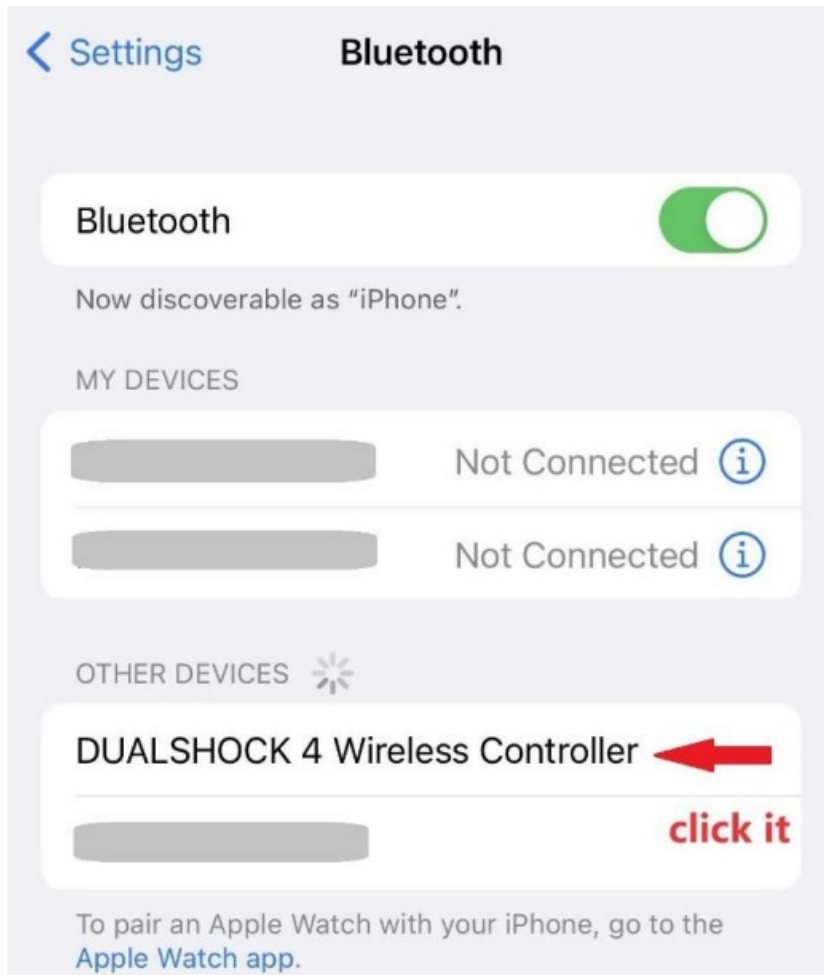

- Compatible with popular games COD Mobile, Fortnite, Apex Mobile, Genshin Impact, Minecraft, Sky, etc.
  - Compatible with MFi and Arcade games
- (it is recommended to confirm in advance whether the game is compatible with controllers)**

### [B+ Home] Connect to Mac/MacBook



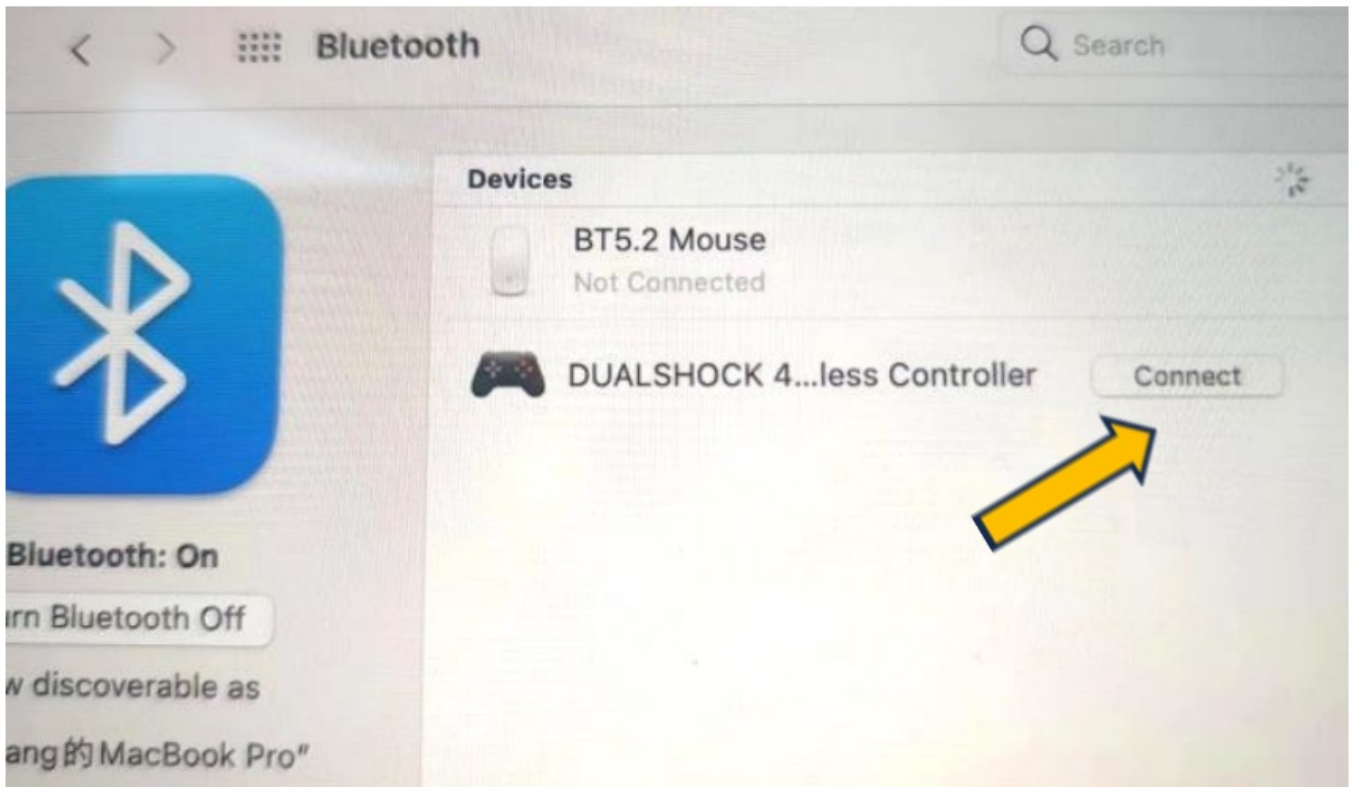

[B+ Home] Connect to Apple TV



- While using this mode, press the Home button to activate the menu and hibernate the Apple TV, and the controller will automatically turn off. When you need to wake up, press the Home button directly on the controller, which will wake up the Apple TV and automatically connect to the game controller.
- If you are connected to the same iPhone and the Bluetooth connection is successful, long press Home for 3 seconds to turn off the controller.
- The next time you connect again, just press the Home button to turn on the game controller and it will automatically reconnect.
- If you have used a game controller to connect to different devices during the above process, you need to forget

the original Bluetooth name and press [B+ Home] again to connect.

### **For iPad or Mac/MacBook (USB -C wired)**

Only suitable for iPad or Mac/MacBook with USB port (including USB Type-C port)

**Package includes a USB A to C adapter**



**One USB C to A wired**



**Connect to iPad (Type-C)**

USB adapter plugged into iPad

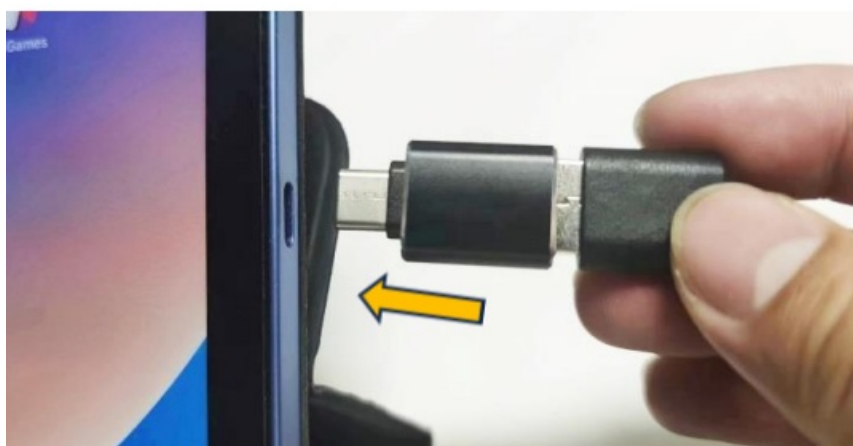





After the connection is successful, LED1 is always on

### Connect to Mac (Type-C)

The controller catches B, then plugs in the wired



After the connection is successful, LED1 is always on



- iPad is different from Android Tablet, wired compatibility includes COD Mobile, Genshin Impact, etc.
- Wired use is faster than Bluetooth and has 0 latency

### **For Android Phone / Tablet / TV / TV Box (Bluetooth)**

#### **[R1 + Home] Enable Xbox controller mode**

- Press and hold R1, then press the Home button
- At this time LED 1,2,3 flash



After the connection is successful,  
LED1, 2, 3 is always on

#### **Open Android Bluetooth list**

**Bluetooth name:** Xbox Wireless Controller

# Bluetooth

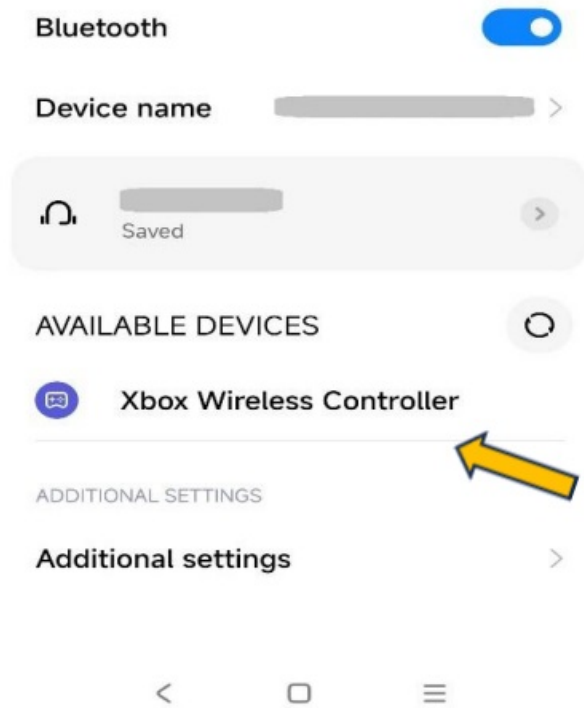

- Supports Xbox game pass ultimate, GeForce Now, Steam Link, etc.
- Supports mainstream games including COD Mobile, BB Racing 2, Roblox, Minecraft, Among US, Dead Cells, GBA emulator, TMNT: Shredder's Revenge, Streets of Rage 4, Castle vania: Symphony of the Night.
- It is recommended to first read the app store game's introduction to compatible controllers.

## Wired connection to Android, just plug it in directly

### For Phone



## For Tablet



- **Note:** The Android ver of COD Mobile currently only supports Bluetooth controller connection and does not support wired connections.

## For Android Phone / Tablet / TV / TV Box (USB 2.4G Wireless)

The product package includes a USB A to C adapter



A 2.4G wireless receiver



Connect Android Phone

1. Plug the USB receiver into the USB adapter Then plug in Phone/Tablet/TV/TV Box

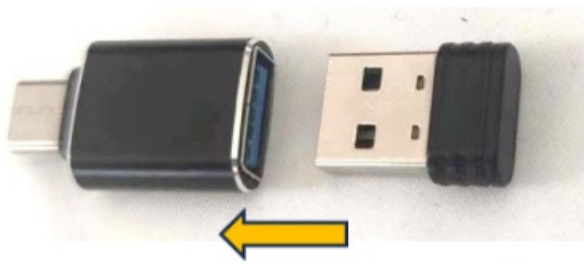

2. push Android Phone



#### **Connect Android Tablet or TV Box**

3. Or push Android Tablet



4. Or Push Android TV /TV Box



**After plugging in the USB receiver,  
[L1 + Home] enables the controller and automatically connects**





- The 2.4G receiver is currently not compatible with the Android version of COD Mobile
- Also suitable for Tesla, PC Windows
- Currently not available for Switch, Xbox, iPad, Mac, iPhone15

### For Switch (Bluetooth and wired)

#### [R2 + Home] Enable Bluetooth



### Main interface – Controllers – Change Grip/Order

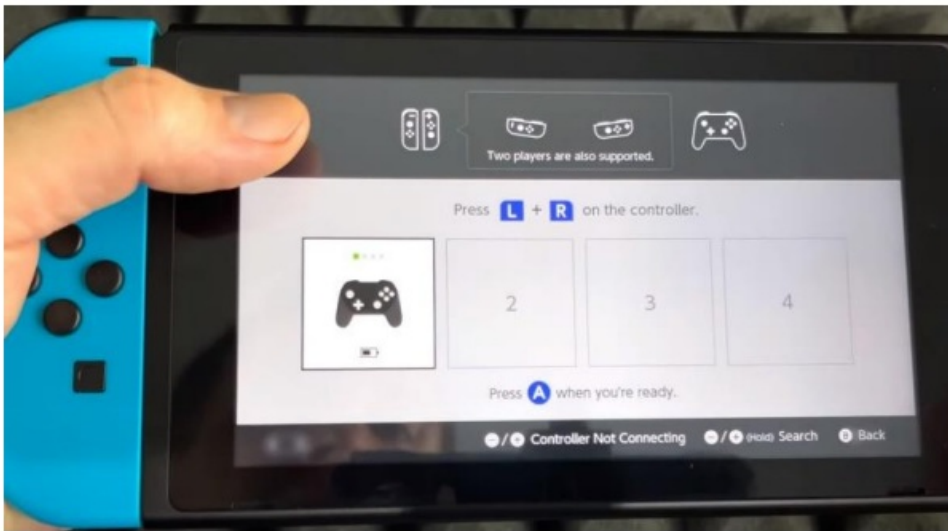

### How to wake up:

1. After using the controller to hibernate Switch, press Home for more than 3 seconds to turn off the controller
2. The next time you want to use it, just press the Home button of the game controller to enable the controller and wake up the Switch at the same time.
3. **Note:** The device that the controller presses the Home button to reconnect or wake up will only be the last successfully connected device.

### Switch port plugs into USB A-C adapter and wired

### Hold down R2 on the controller and connect the Switch via wire

- Wired does not support Switch wake-up
- Wired does not require battery power
- the 'CLEAR' key will act as the FN function key

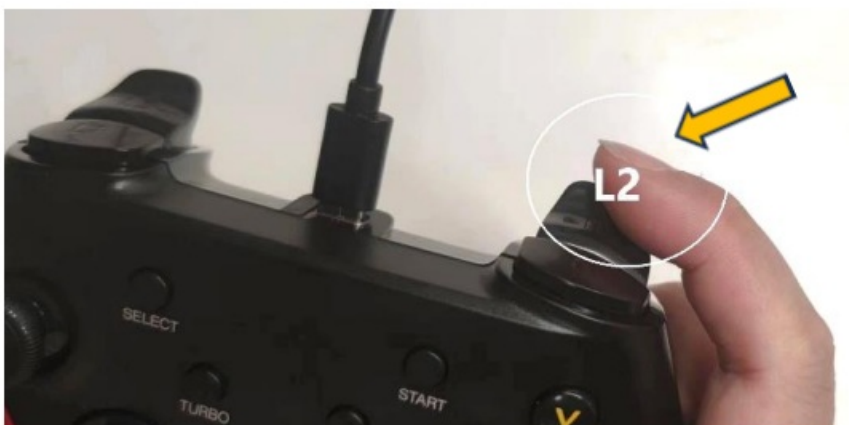

### For Windows (Bluetooth, 2,4G Wireless, Wired)

[R1 + Home] Enable Xbox controller Bluetooth



**Bluetooth name: Xbox Wireless Controller**

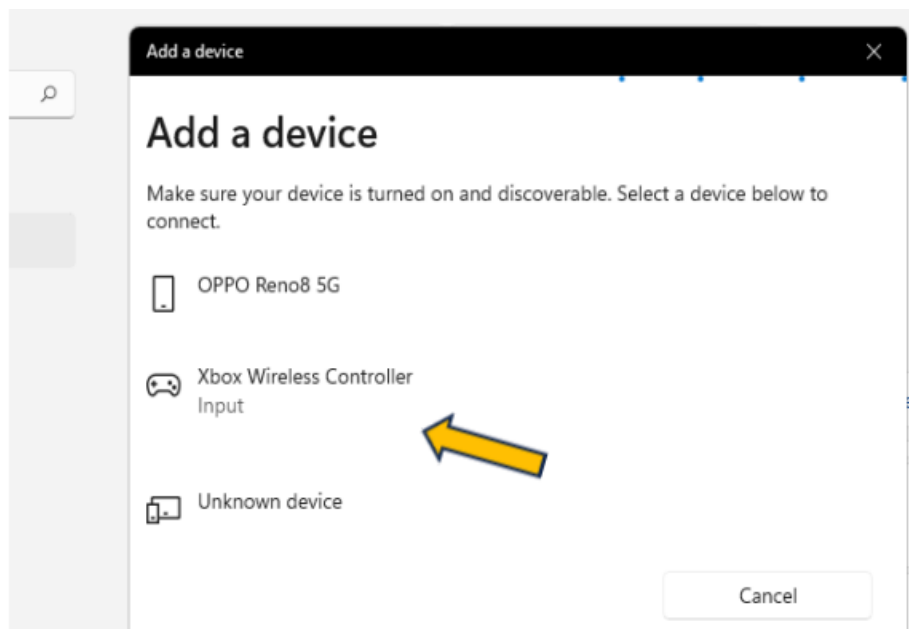

**[L1 + Home] Enable USB 2.4G wireless**



Plug in the 2.4G receiver and Windows will automatically recognize it.



Plug directly into wired



No need to do anything extra

## For Tesla

Supports three connection methods: Bluetooth, 2.4G and wired

### [R1 + Home] Enable Xbox controller Bluetooth



Click it

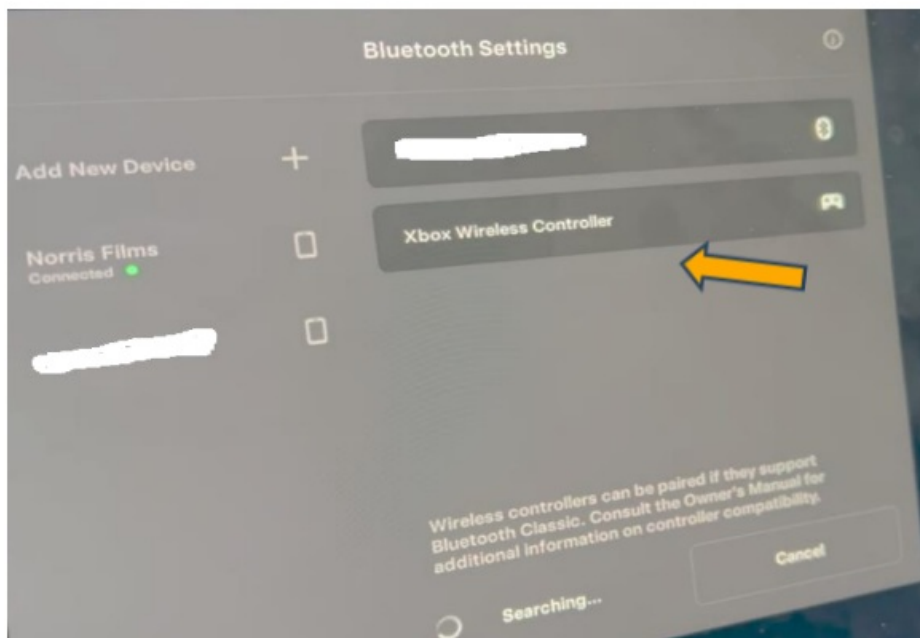

1. Plug in the 2.4G receiver & USB A to C adapter





2. [L1 + Home] Enable USB 2.4G wireless



Plug directly into the cable, connect and play

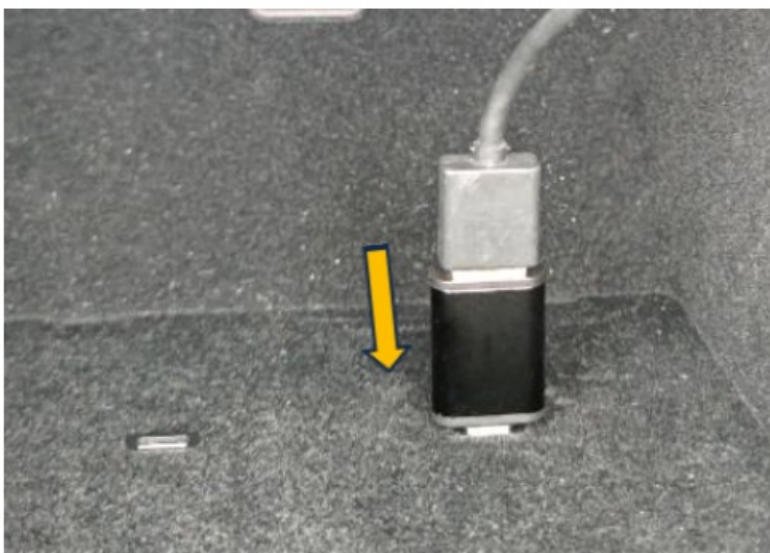

USB wired with adapter cable can be plugged in No need to do anything extra



## For PS3 and PS4

### P3 Wired

Hold down the R1 key USB connection host

### P3 Wireless

Wired connection succeeded. Unplug the cable directly and automatically switch to wireless mode

### Wired is successful:

LED1 is always on

### Wireless is successful:

Unplug the data cable, then LED4 is always on.

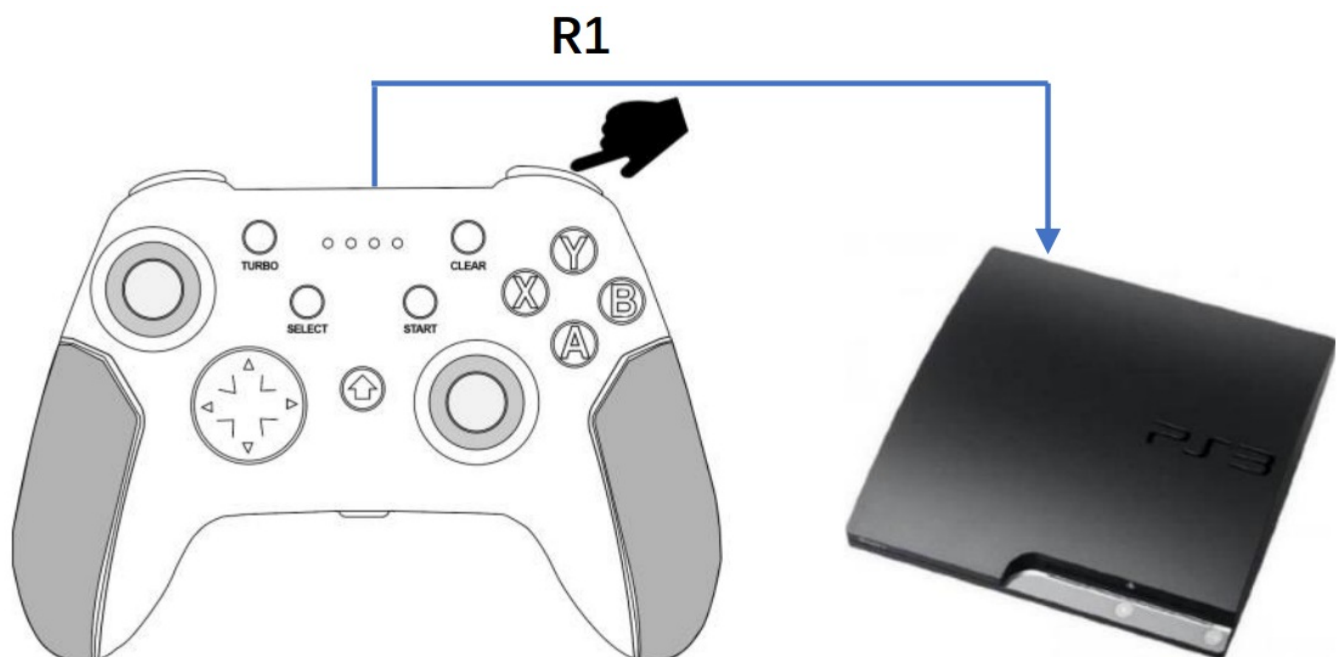

## Wired and Wireless connection of P4 & P5

### > P4&5 Wired

- 1>Hold down the B key
- 2>USB connection host.
- 3>Then, just press the 'HOME' (>1 seconds) again to identify

#### **P4 5 ireless**

Wired connection succeeded Unplug the cable directly and automatically switch to wireless mode

#### **\* Wired is successful:**

LED1 is always on

#### **\* Wireless is successful:**

LED1 is always on Unplug the data cable, then LED4 is always on.



#### **About P4 & P5 connection**

- No for P5 games, only for P4 games
- This is not a pro P4 game controller, no touchpad and headphone jack
- How to screenshot and share The 'Select' button on the controller is the share/capture button.

#### **For V3 mapping mode**

This mode is only available for some Android Phone & Tablet non-controller games, such as Arena of Valor, Wild Rift, Stumble Guys, World of Tanks, Mario Kart etc.

#### **Can be found via Google Play**

1. [A+Home] Enable Bluetooth mode connection
2. Open the APP and turn on the floating function  
Requires permissions to be enabled on Android phone or tablet
3. Open the game
4. Set mapping to click location
  - Customize virtual keys and remote sensing positions
  - Some games already have presets
5. Save and return, use the controller

**Bluetooth name: LJC-269**

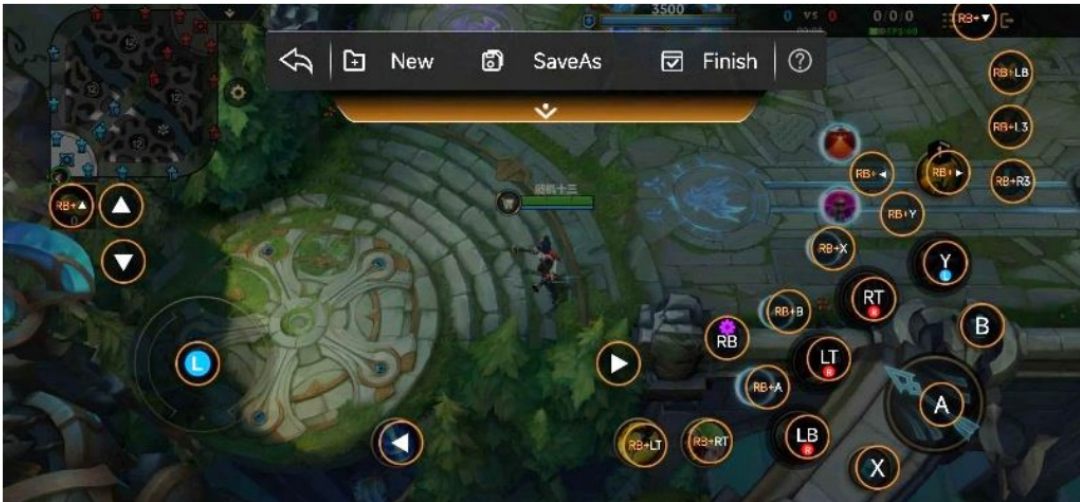

6. > [A+Home] Enable Bluetooth connection Bluetooth name: LJC-269

This is another version, but the operation is the same as above

**Note:**

Available for PUBG Mobile

But the settings will be more complicated

Therefore, it is generally recommended for some simple games.

Unless you are already very skilled





This is another third-party mapping tool

The advantage is that it only requires Bluetooth Xbox or PS4 controller connection

Play Android games with Gamepad/Controller, Mouse & Keyboard!

Map peripherals to touchscreen. No root or activator required





Documents / Resources

	<p><a href="#">WZUICOV B0CBSHN3JY Bluetooth Game Controller</a> [pdf] User Guide B0CBSHN3JY Bluetooth Game Controller, B0CBSHN3JY, Bluetooth Game Controller, Game Controller, Controller</p>
---	---

References

- [User Manual](#)

[Manuals+](#), [Privacy Policy](#)

This website is an independent publication and is neither affiliated with nor endorsed by any of the trademark owners. The "Bluetooth®" word mark and logos are registered trademarks owned by Bluetooth SIG, Inc. The "Wi-Fi®" word mark and logos are registered trademarks owned by the Wi-Fi Alliance. Any use of these marks on this website does not imply any affiliation with or endorsement.