



# WZATCO W2 Pro LED Projector User Manual

[Home](#) » [WZATCO](#) » WZATCO W2 Pro LED Projector User Manual 

## Contents

- [1 WZATCO W2 Pro LED Projector](#)
- [2 Important Safeguards](#)
- [3 Accessories List](#)
- [4 Projector Overview](#)
- [5 Specifications](#)
- [6 Multimedia Supported Formats](#)
- [7 Remote Control](#)
- [8 Switching Machine Operation](#)
- [9 Focus / Keystone Correction](#)
- [10 Image Focusing](#)
- [11 Standard Setting](#)
- [12 Use of the Projector](#)
- [13 Use of the Projector](#)
- [14 Troubleshooting](#)
- [15 Documents / Resources](#)
- [16 Related Posts](#)



**WZATCO W2 Pro LED Projector**



**Note:** As the product system is updated from time to time, the specific operation content is based on the actual situation.

## Important Safeguards

1. Please read the manual carefully before operating projector. To ensure stable power supply, please use standard power cord.
2. Please use the power supply and cable indicated on the rating label. The projector should be kept away from cloths, sofas and anything that may block the ventilation scoop. Please keep the unit away from flammable and explosive materials.
3. Please do not disassemble the unit by yourself as this will invalidate the warranty service. To protect your eyes, do not stare directly at the lens when the projector is on. The projector must be kept away from water and any other liquids.
4. To prevent electric shock, please keep the projector out of the rain and away from moisture. It is recommended to switch off the projector after it has run for 6 hours non-stop. Please use the original foam and other cushioning materials when transporting the projector.
5. If the projector does not work, please contact [support@wzatco.com](mailto:support@wzatco.com) or wzatco customer care number 709 209 0011.
6. The projector filters need to be cleaned after every 1 month of usage to prevent air choke or heating issues due to poor ventilation.

7. The projector should be given few minutes power off break after every 3 – 4 hours of usage for longevity.

## Accessories List

- **AV Signal Cable** x1
- **Remote Control** x1
- **Power Cable** x1
- **User Manual** x1
- **Lens Cap** x1

## Projector Overview

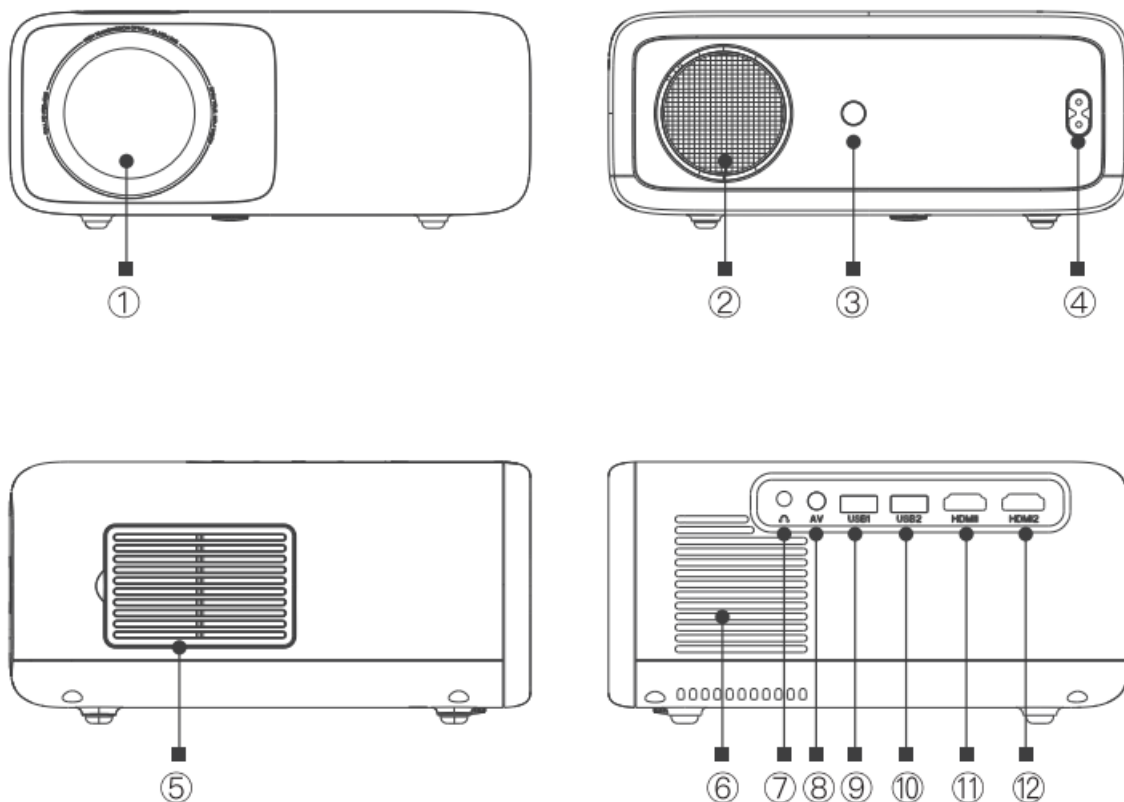

1. Lens
2. Speaker
3. IR for Remote Control
4. Power Socket
5. Dust-Proof Net
6. Air Outlet
7. Headphone Jack
8. AV Port
9. USB1 Port
10. USB2 Port
11. HDMI1 Port
12. HDMI2 Port

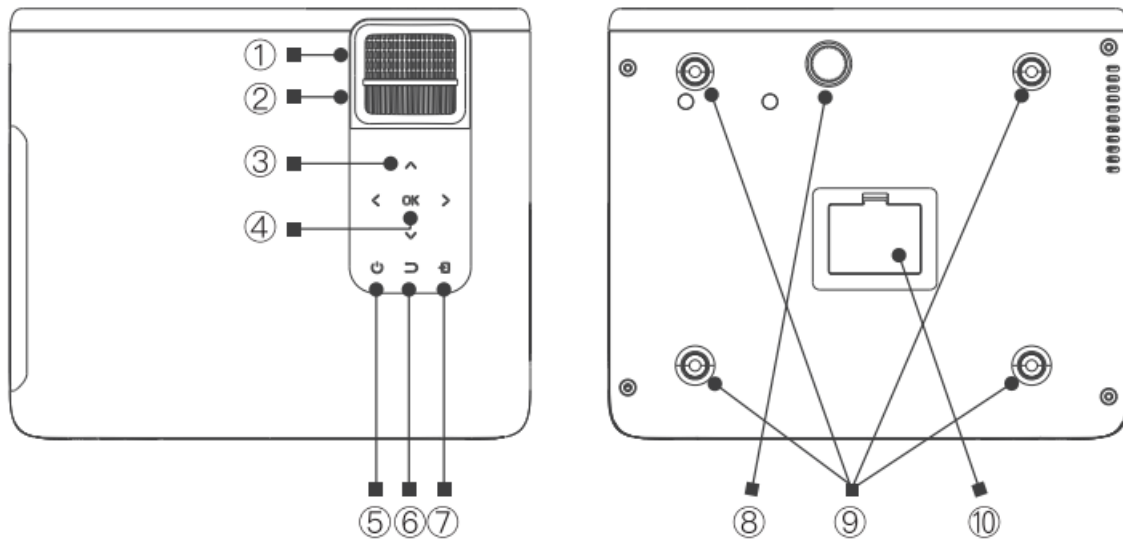

- 13. Focusing
- 14. Keystone Correction
- 15. Arrow Keys
- 16. OK Key
- 17. Power Key
- 18. Return Key
- 19. Source Key
- 20. Height Adjustment Machine Feet
- 21. Hanger Fixing Screw Holes
- 22. **Points:** Remove the machine foot pads before hoisting)
- 23. Bottom Label (Tear off the bottom sticker, you can remove the bottom dust cover to clean up the dust)

## Specifications

Model	Multimedia Projector
Lamp	LED
Image System	LCD
Language	English, total 15 languages
Resolution	1920x1080P

Input Voltage	100-240V~
Weight	1.2 KG
Working Temp	0-35°C
Input Port	HDMI / USB / AV
Output Port	Headphone
Aspect Ratio	16:9 / 4:3
Size	232x192x91mm
Operation Mode	Manual / Remote Control

## Multimedia Supported Formats

Image Format	JPG /JPEG/ GIF / BMP / PNG
Audio Format	MP3/ AAC /OGG/ WAV / FLAC / WMA / MP2 / M4A
Video Format	MP4 / MKV / WMV / FLV / TRP / VOB / 3GP / TP / TS / MPG/DAT
File Format	TXT

## Remote Control

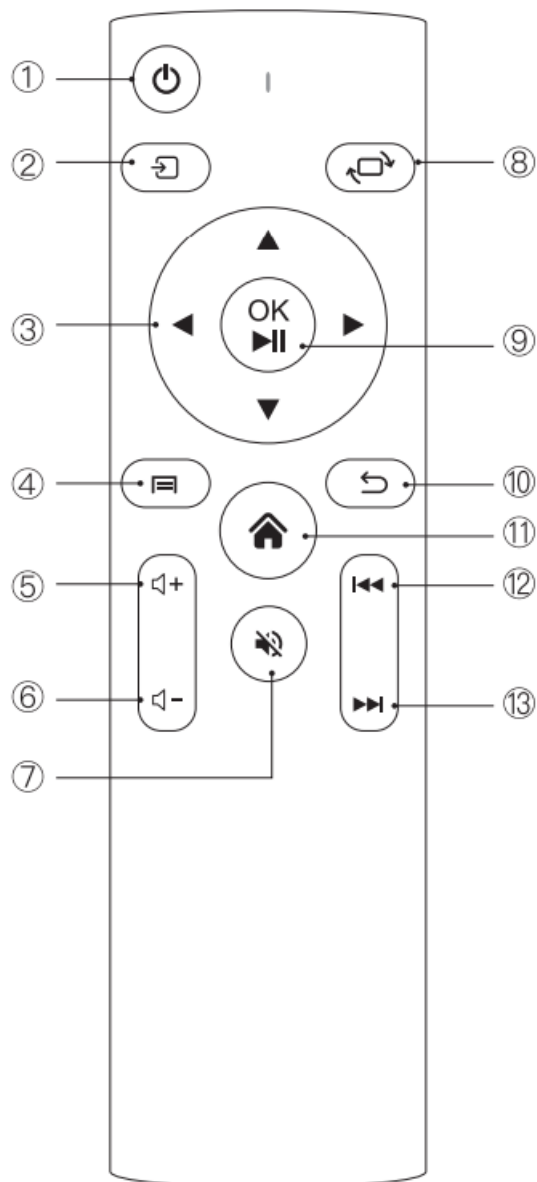

1. Power Key
2. Source Key
3. Arrow Keys
4. Menu Key
5. Volume+
6. Volume-
7. Mute
8. Screen Flip
9. Confirm Key/(Pause/Play Key)
10. Return Key
11. Home Key
12. Previous
13. Next

## Switching Machine Operation

### Power On:

- **Step 1:** Press the power button on the body or the power button on the remote control, and the indicator light will turn blue and steady.
- **Step 2:** After 2 seconds, the projector starts to start, the image appears on the screen, and the unit enters the normal working state.
- **Step 3:** If the projector is newly installed, the image may be blurred or have trapezoidal distortion when it is turned on for the first time. Please refer to the “Focus/Keystone Correction” section for calibration.
- **Step 4:** After the image is adjusted clearly, it can be viewed normally.

#### Power Off:

- **Step 1:** In the working state, press the power button of the body or the power button on the remote control to switch the projector to the standby state.
- **Step 2:** After the projector enters into the standby state, the machine is in the process of automatic heat dissipation, and the indicator light will change from blue to red.

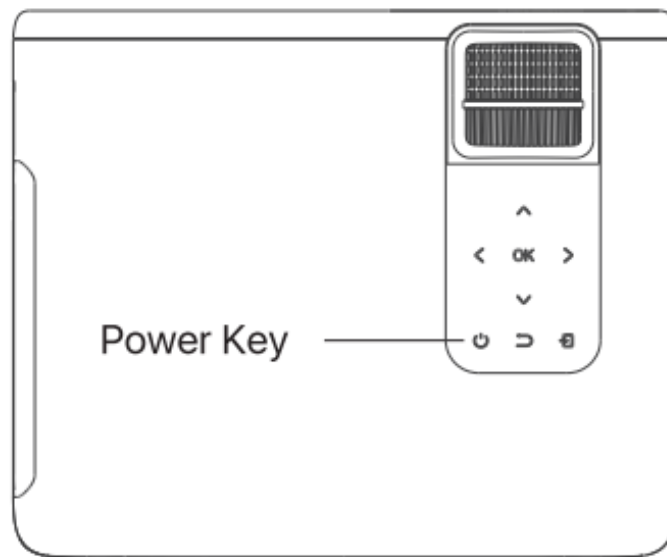

- Please connect the power cord to the projector before connecting the power cord to an electrical outlet.

#### Focus / Keystone Correction

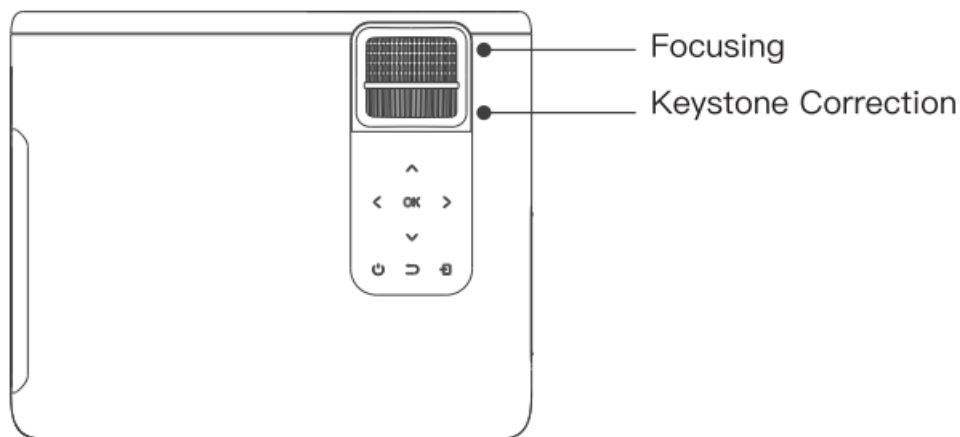

#### Image Focusing

Place the projector lens perpendicularly to the projection screen or curtain wall, and adjust the focus dial until the



image is clear, that means the image focusing is finished.

During the focusing process, you can play the programs or pick up the product menu images to match the focusing adjustment.

### Keystone Correction

Please turn the trapezoidal adjustment dial until the image is displayed normally.

**Note:** The projector has only mechanical trapezoidal correction in the vertical direction and there is no horizontal correction. Make sure the projector is level with the projected image.

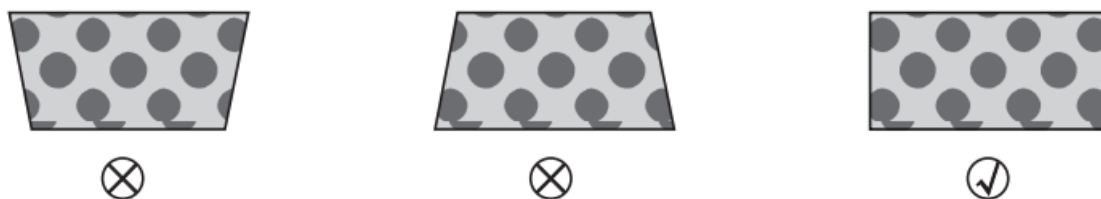

### Standard Setting

Refer to the data in the table below to place the projector away from the projection screen according to the preset graphic size. When installing, place the projector on a solid, stable countertop. The airframe should be well-ventilated. Do not cover or block the vents. There should be no obstructions within 30cm of the vents.

Aspect Ratio	16:9
Picture Size (inch)	Projection Distance (m)
50	1.54
70	2.15
100	3.08
120	3.69

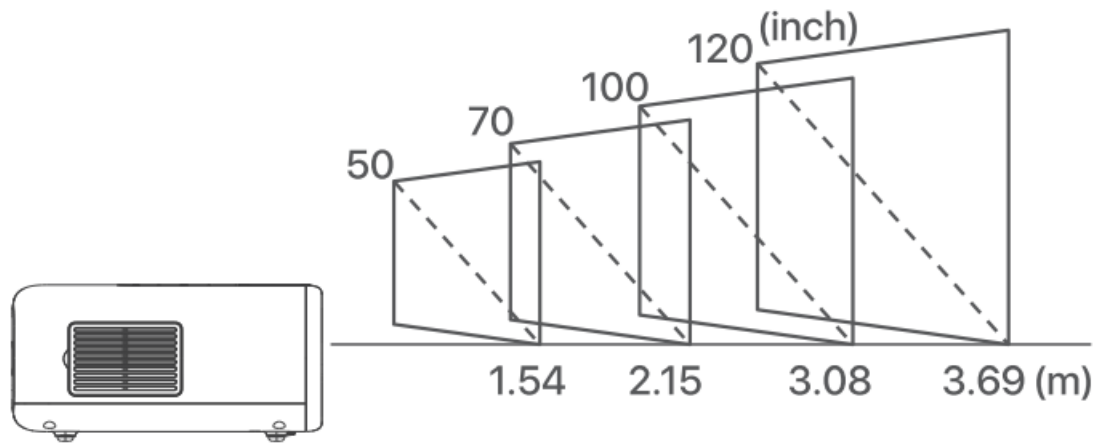

**Note:** The above data is for reference only, please refer to the physical measurement.

## Use of the Projector

### How to Select the Signal Source

- **Step 1:** Turn on the projector and this main interface will appear.
- **Step 2:** In the signal source option, select the signal source you need and confirm the connection.

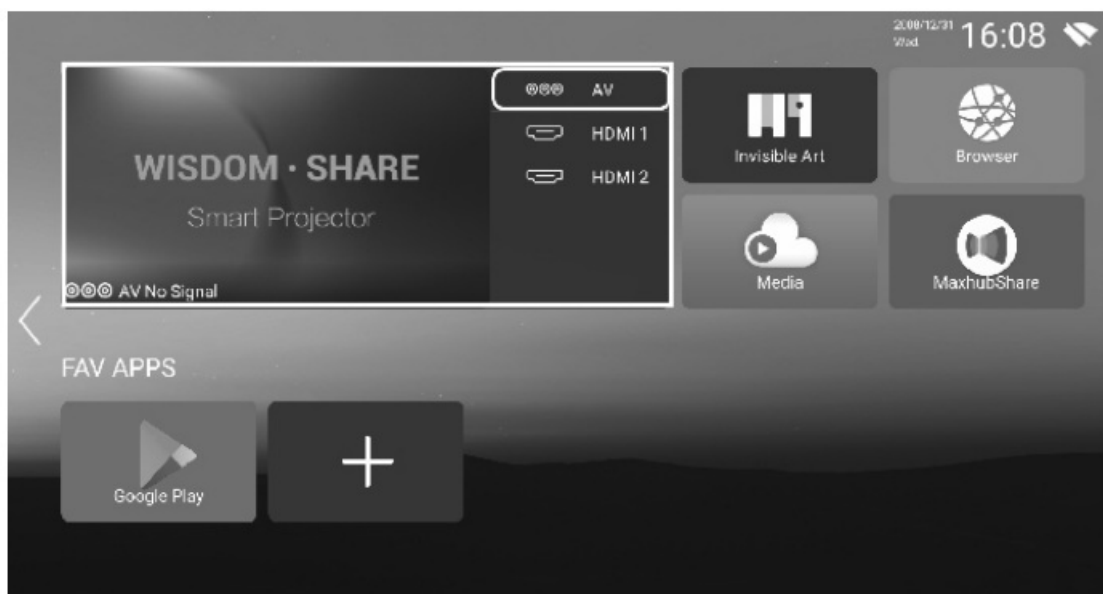

### How to Read Files on U Disk

- **Step 1:** Insert your USB flash drive, and select “Media” on the home screen.
- **Step 2:** After entering the interface, then select your U disk, find the file you want to view in the classification to play



## Use of the Projector

### • How to Download App

- **Step 1:** Select Google Play at the bottom of the main interface.
- **Step 2:** After entering the interface, download the APP you need. Apps can be added via the “+” next to Google Play.

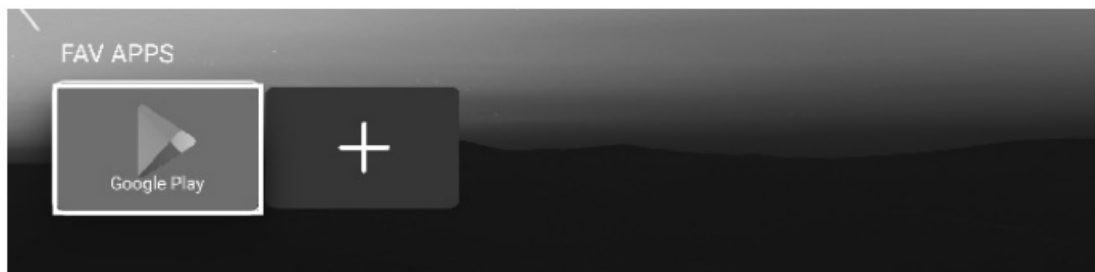

### • How to Connect to WiFi

- **Step 1:** Select “Network” —> “Wireless” on the left side of the main interface.
- **Step 2:** Search for WiFi, select the WiFi that needs to be connected, enter the password on the front through the virtual button, and confirm.

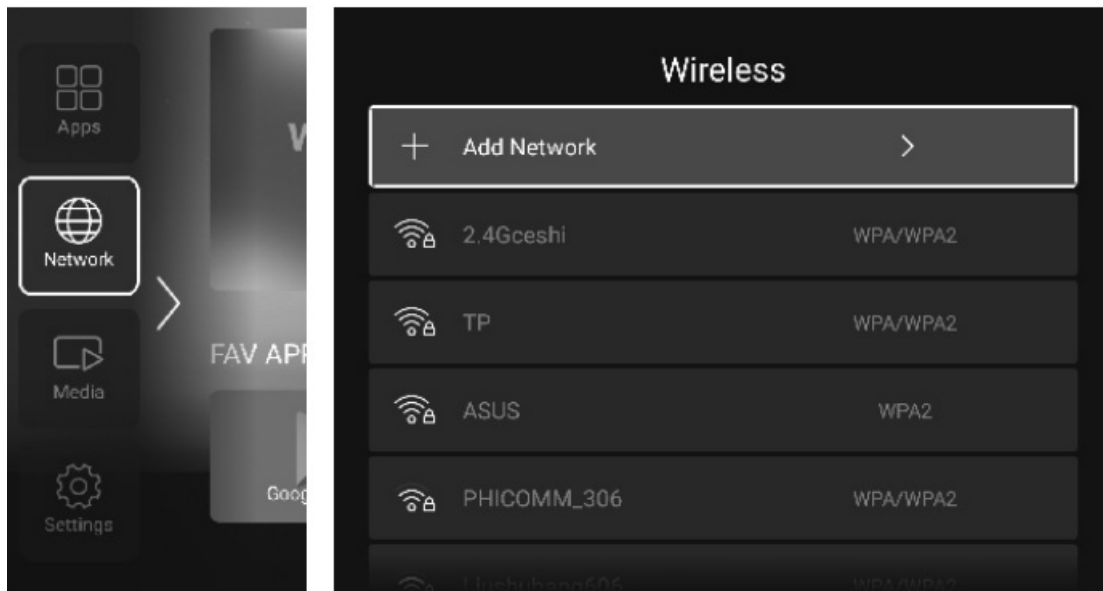

### • Use of the Projector

#### • How to Use MaxhubShare

- **Step 1:** Select “MaxhubShare” in the main interface.
- **Step 2:** After entering the interface, use your mobile phone to scan the QR code on the right side of the interface to download the “MaxhubShare” APP.



- **Miracast:**
- **Step 1:** On your Android phone/tablet, open the settings menu.
- **Step 2:** Access your display settings or screen mirroring.
- **Step 3:** Select your Miracast receiver: IV- .... (1V name on the projector interface)

### Miracast Steps:

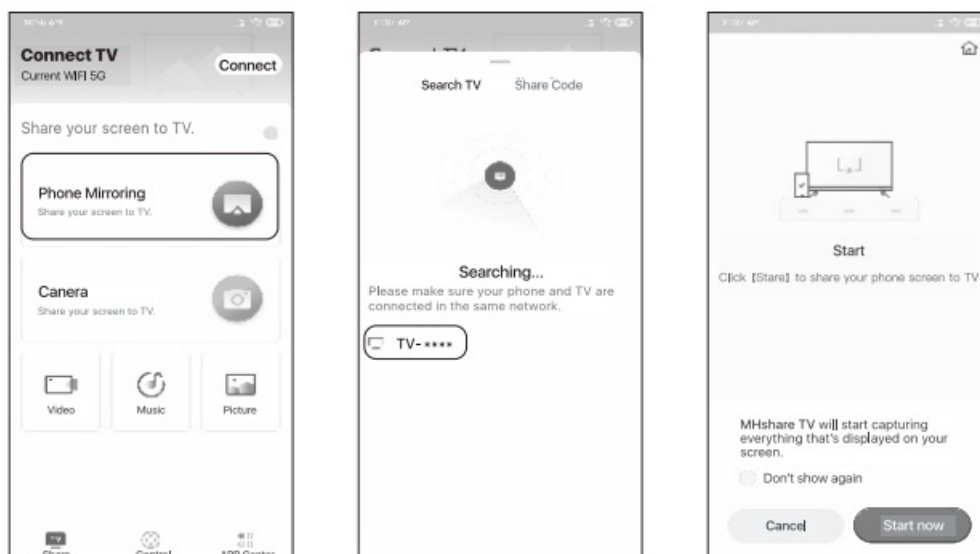

### iOSCast:

- **Step 1:** On your iOS device, open Control Center and tap Screen Mirroring.
- **Step 2:** Looking for devices that can be mirrored.
- **Step 3:** Select '1V- \*\*\*\*\*' (1V name on the projector interface) from the list to connect. iOS Cast Steps:

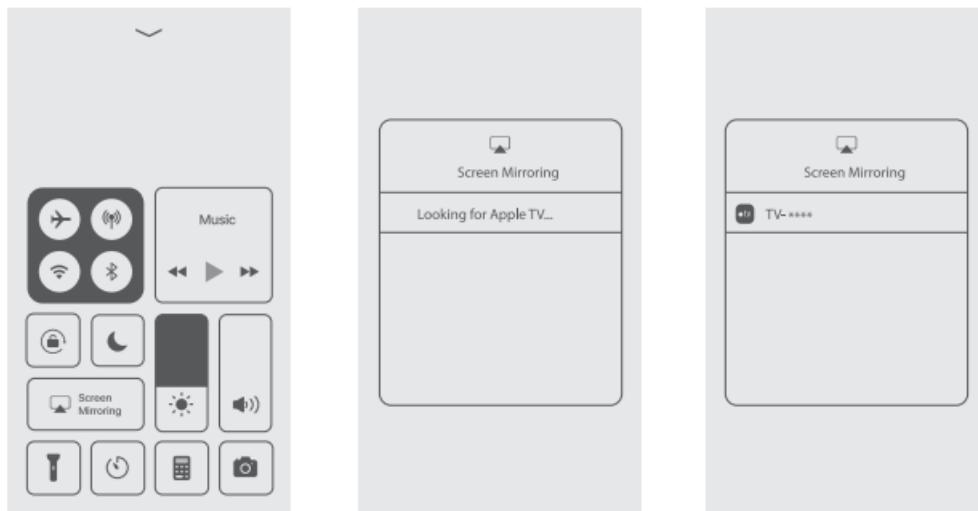

- TV name is randomly generated, this picture is for reference only.

### How to Connect Bluetooth Audio Device

- **Step 1:** Select “Settings” on the left side of the main interface, after entering the interface, find “Bluetooth”.
- **Step 2:** Turn on Bluetooth, search for the device, and connect the device you need.

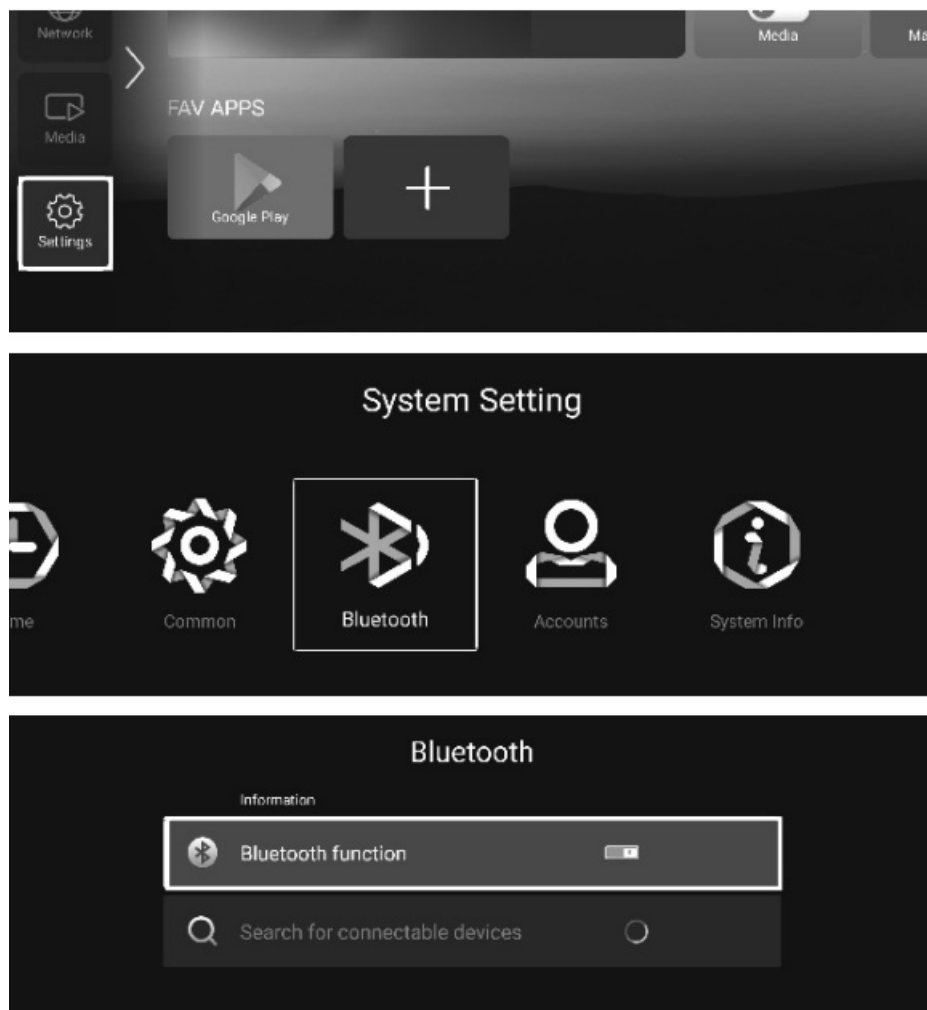

### Projection Settings

- **Step 1:** Select the setting icon on the left side of the main interface, press the “OK” button on the remote control to enter the setting interface, and select “Projection Settings”.
- **Step 2:** After entering the interface, select the mode you want in the projection settings.

## Four-Sided Trapezoid

- **Step 1:** Advanced keystone correction: Select “Sides” mode.
- **Step 2:** Enter “Four-sided trapezoid”, and adjust according to the screen prompts.

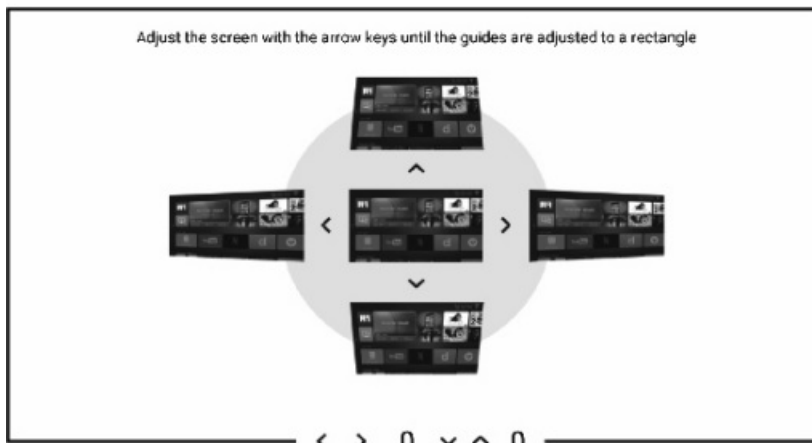
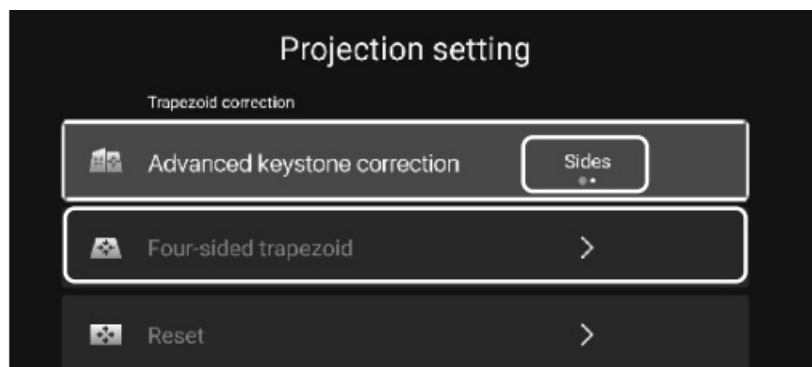

- **Square Trapezoid**
- **Step 1:** Advanced keystone correction: Select “Corners” mode.
- **Step 2:** Enter “Square trapezoid”, and adjust according to the screen prompts.

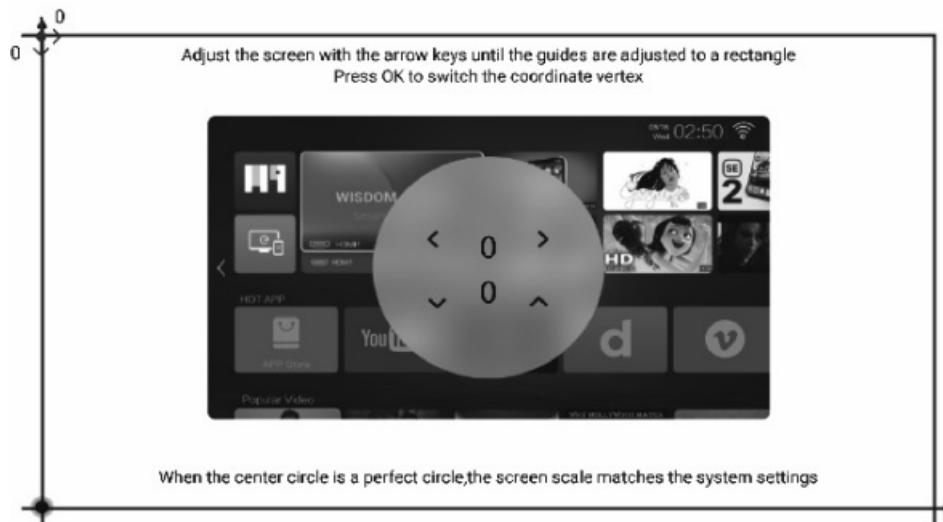
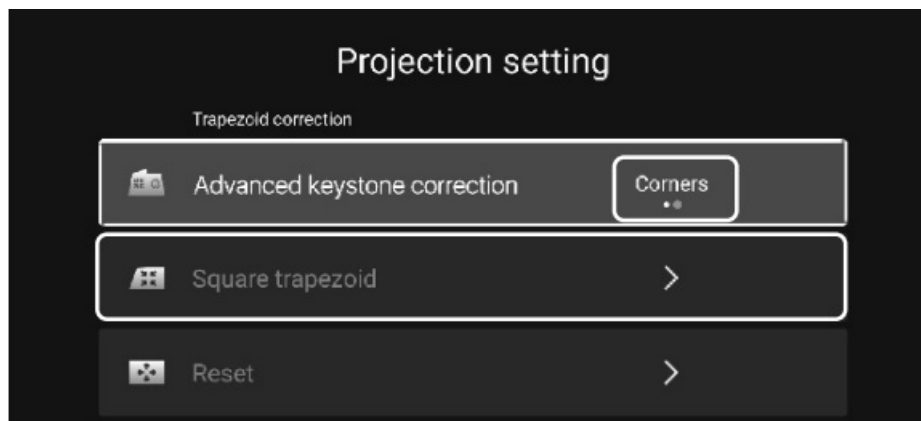

## Projection Method

- Front/Ceiling Front/Rear/CeilingRear (four modes) Can be selected according to the actual situation.

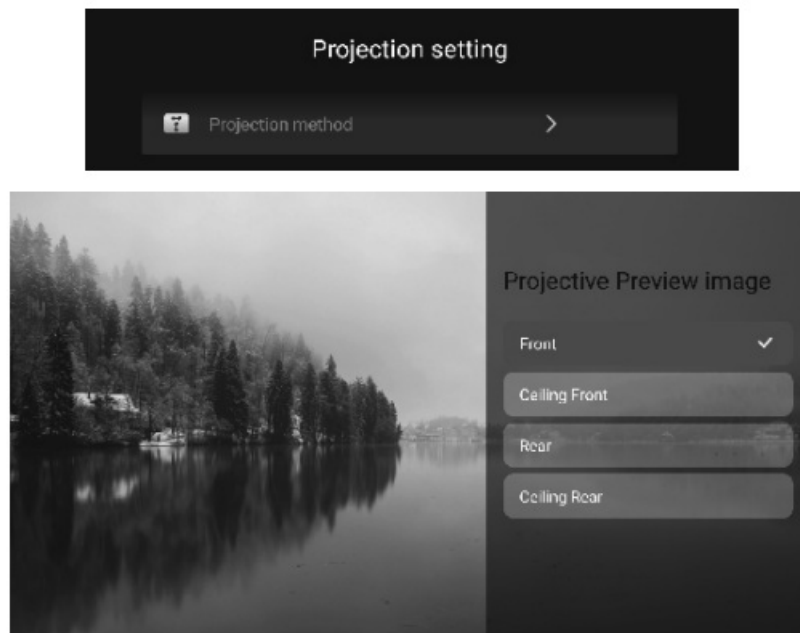

## • Custom Zoom

After opening, select the corresponding zoom mode to adjust the screen size.

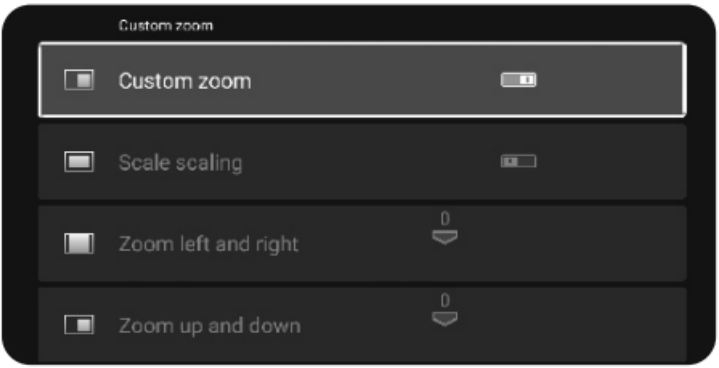

Troubleshooting

Problem	Possible Causes	
1. The indicator light does not work when the power switch is turned on.	©	The Power cable is not connected properly
	©	The power switch is faulty
2. The projector does not work when using the remote control.	© The power switch is turned	
	© The remote control has no batteries or the batteries are low	
	© The remote control is not being aimed at the IR receiver	



	© The IR receiver is under strong lights.	
3. No image.	© The input source may not be correct.	
	©	No input signal.
	© The input cable is not connected.	
	© If under PC mode, the PC output frequency is not 50-60Hz. Make sure that the PC output is connected to the projector	
	© If using a laptop, check if the output signal is HDMI1 or HDMI2	
4. Auto-off.	© The projector ventilation is blocked.	
	© The voltage is not stable.	

© The projector has overheated- check that the fan is not broken.

The terms **HDMI** and **HDMI High-Definitioo** Multimedia Interface, and the HDMI Logo are trademarks or registered trademarks of HDMI Licensing Administrator, Inc. l'l the United States and other countries.

Documents / Resources



WZATCO  
LED Projector

WZATCO W2 Pro LED Projector [pdf] User Manual  
W2 Pro LED Projector, W2 Pro, W2 Pro Projector, LED Projector, Projector