

wuipet WP10 AI Bird Feeder User Guide

[Home](#) » [WUIPET](#) » wuipet WP10 AI Bird Feeder User Guide 

wuipet WP10 AI Bird Feeder

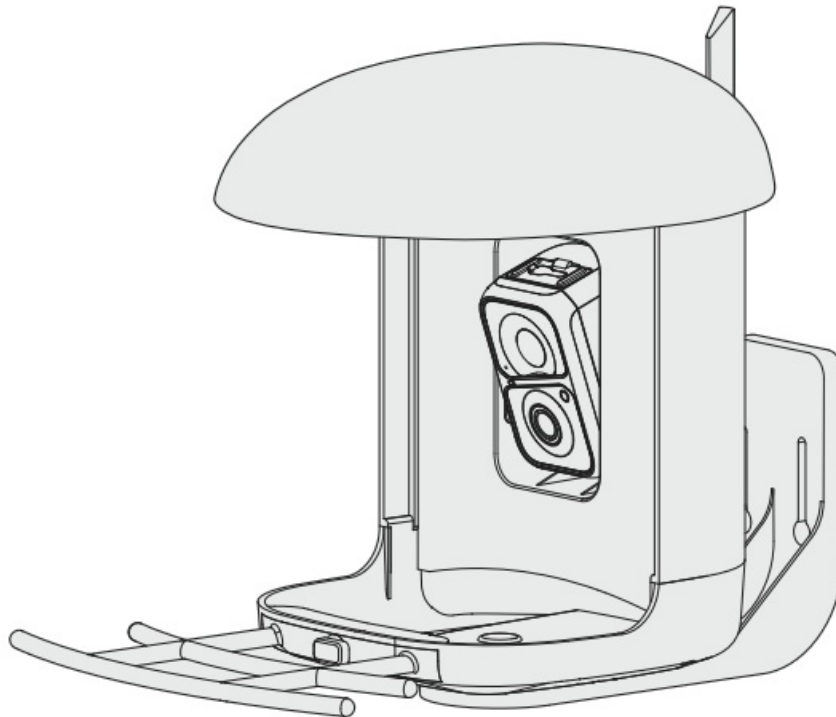

Contents

- 1 Warning
- 2 What's In the Box
- 3 Camera Structure
- 4 Assemble Bird Feeder
- 5 Battery Charging
- 6 How To Turn On & Off The Camera
- 7 Read Before Installation
- 8 Set Up With Vichohome APp
- 9 Pair the Camera to your Phone App
- 10 About Cloud Storage and Bird Fans Plan
- 11 Share the camera with others
- 12 AI Identification
- 13 How to Connect charging cable and waterproof rubber stopper
- 14 Frequently Asked Questions
- 15 Installation
- 16 Tree Installation
- 17 Pole Installation – Hose clip
- 18 Cleaning Bird Feeder
- 19 How to install the solar panel
- 20 How to Add Bird Seed
- 21 Status Light
- 22 AI Bird Recognition
- 23 Documents / Resources
 - 23.1 References
- 24 Related Posts

Warning

NOTE: This equipment has been tested and found to comply with the limits for a Class B digital device, pursuant to part 15 of the FCC Rules. These limits are designed to provide reasonable protection against harmful interference in a residential installation. This equipment generates uses and can radiate radio frequency energy and, if not installed and used in accordance with the instructions, may cause harmful interference to radio communications. However, there is no guarantee that interference will not occur in a particular installation. If this equipment does cause harmful interference to radio or television reception, which can be determined by turning the equipment off and on, the user is encouraged to try to correct the interference by one or more of the following measures:

- Reorient or relocate the receiving antenna.
- Increase the separation between the equipment and receiver.
- Connect the equipment into an outlet on a circuit different from that to which the receiver is connected.
- Consult the dealer or an experienced radio/TV technician for help.

The antennas used for this transmitter must be installed to provide a separation distance of at least 20 cm from all persons and must not be co-located for operating in conjunction with any other antenna or transmitter.

FCC (USA) 15.9 prohibition against eavesdropping except for the operation of law enforcement officers conducted under lawful authority, no person shall use, either directly or indirectly, a device operated pursuant to the provision of this part for the purpose of overhearing or recording the private conversations of other unless such use is authorized by all of the parties engaging in the conversation.

Changes or modifications not expressly approved by the party responsible for compliance could void the user's authority to operate the equipment.

FCCID: 2AY58-V5DZWNQ

IC Caution:

This device contains licence-exempt transmitter(s)/receiver(s) that comply with Innovation, Science and Economic Development Canada's licence-exempt RSS(s). Operation is subject to the following two conditions:

This device may not cause interference.

This device must accept any interference, including interference that may cause undesired operation of the device.

Video Installation Guide



You can also the QR Code Watch the installation video

What's In the Box

- Root



- Perch Screw

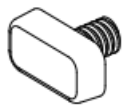

- Bird Feeder

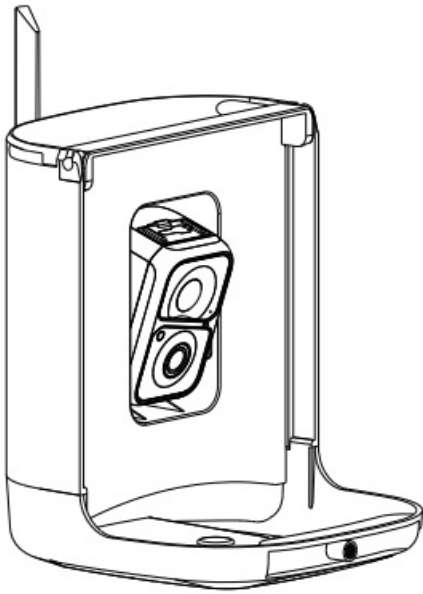

- Perch

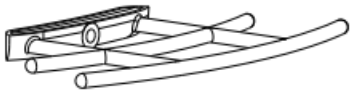

- Drilling Template

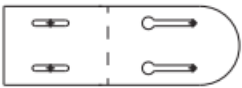

- Mounting Bracket

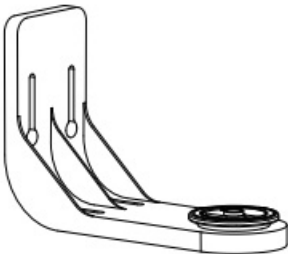

- Black Strap

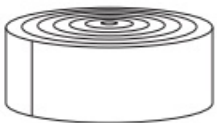

- Anchors

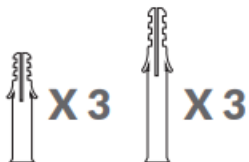

- Mounting Screws



- Hose Clip



- Ejector Pin



- Type C power Cable



- Solar Panel

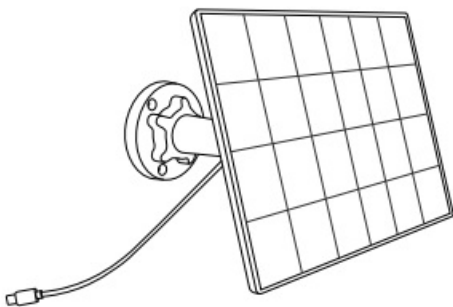

- Quick Guide

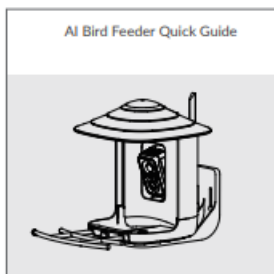

Camera Structure

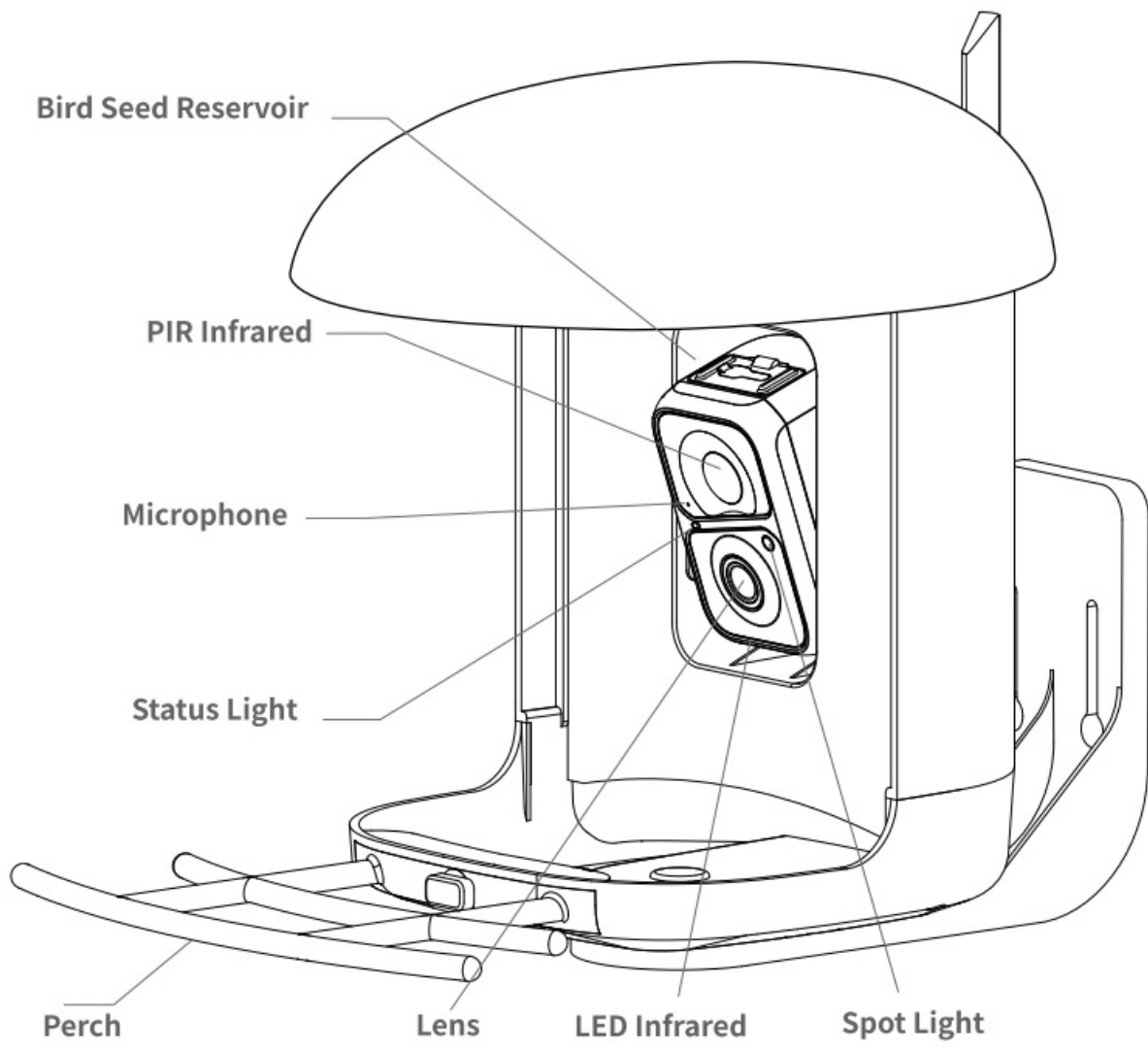

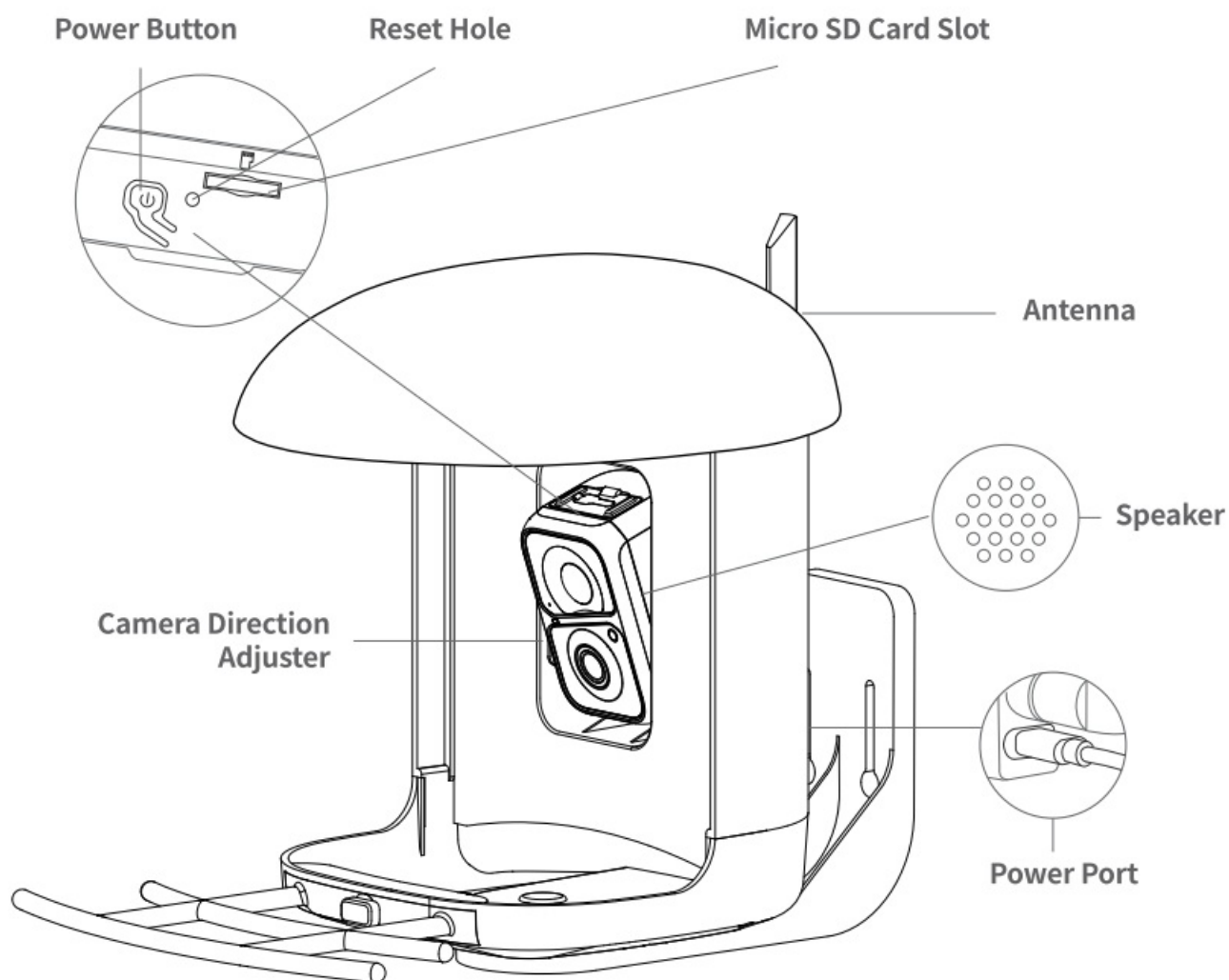

Assemble Bird Feeder

Assemble the roof

Step 1: Face up the side of the roof with the buckles. Align the small pillar on both the left and the right side with the buckles of the white bird seed container.

Step 2: Push down to insert.

Step 3: Then rotate back to install the buckle behind the white bird seed container.

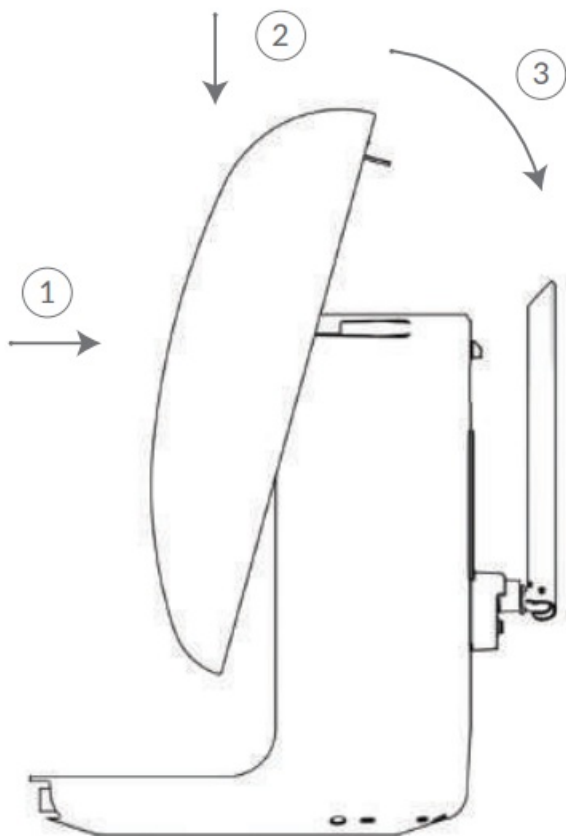

Assemble Perch

Use the provided perch screw to install the perch.

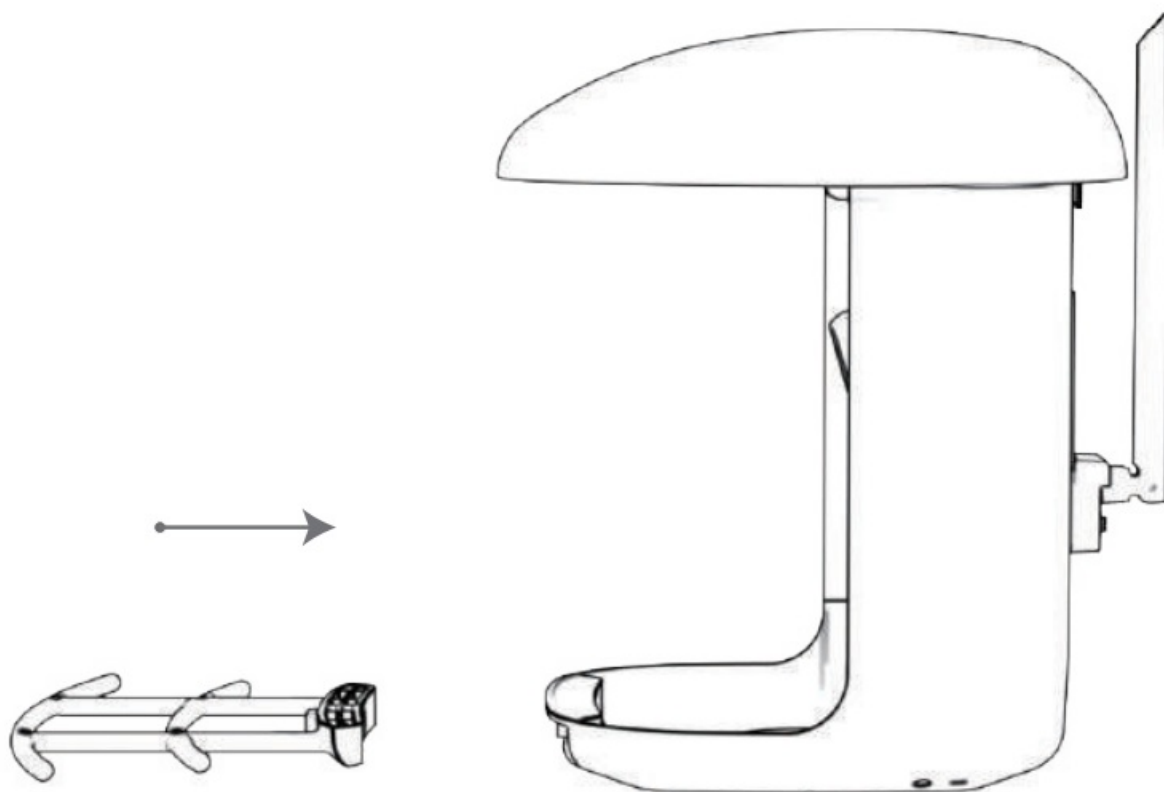

Battery Charging

The batteries inside the camera are not fully charged according to the transportation safety regulations. Please

fully charge the camera before using it. Please charge the batteries with provided Type C Port Cable (DC5V / 1.5A adapter not included).

The status light will be in solid yellow when charging, and will turn to solid green when it is fully charged. It takes about 14 hours to fully charge your camera.

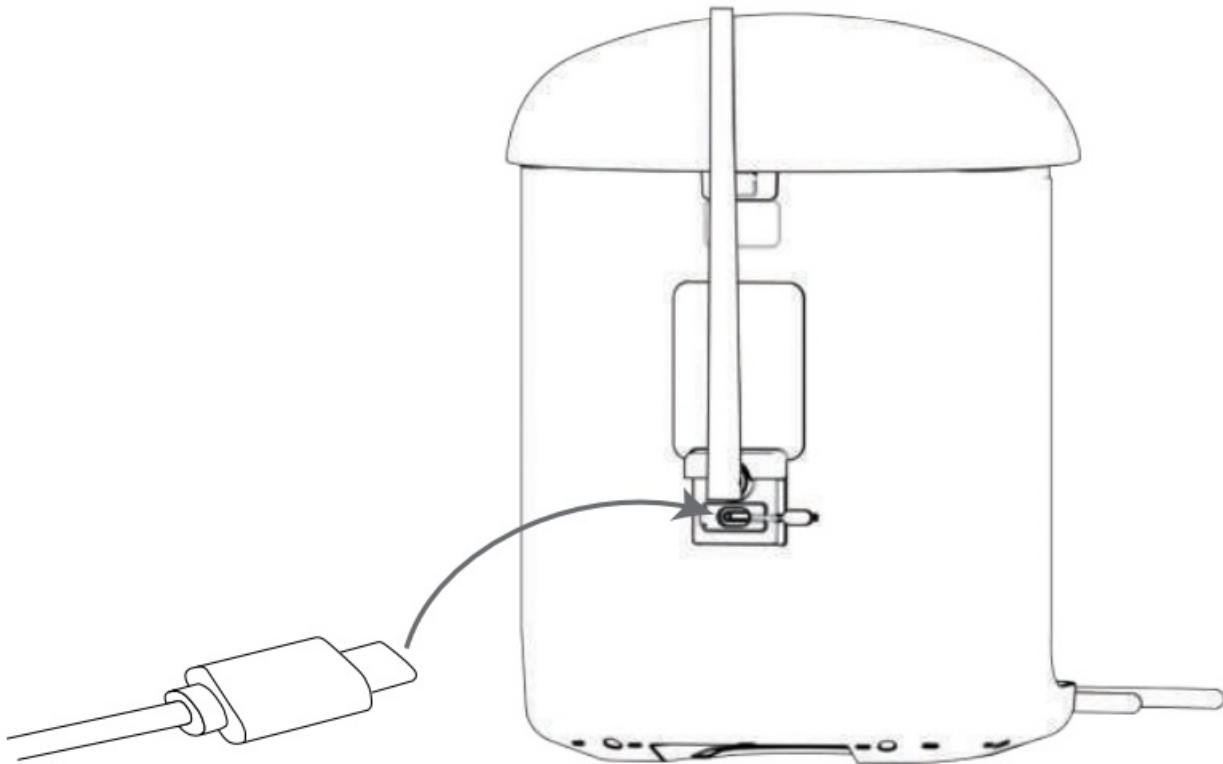

How To Turn On & Off The Camera

To turn on the camera:

Long press the power button for 3s to turn on the camera. Then the Status Light in the front of the camera will be solid blue. Double click the power button to enter WiFi mode after the prompt tone.

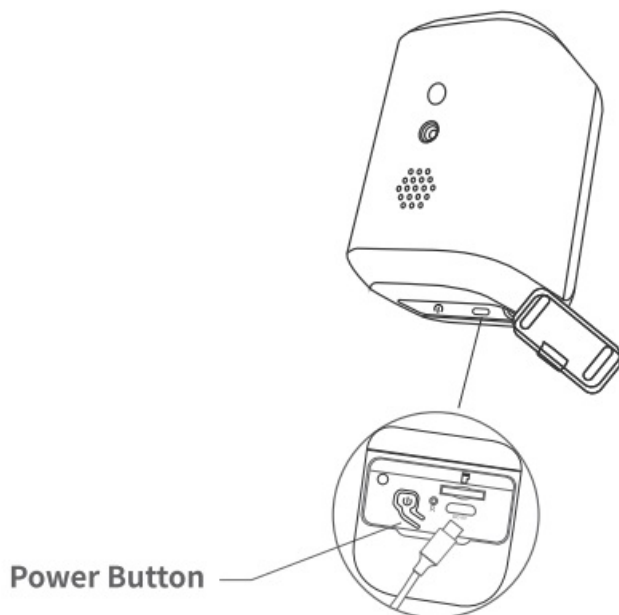

To turn off the camera:

Long press the power button for 3s turn off the camera . the the status Light in the front of the camera will be off.

Read Before Installation

1. Keep the Bird Feeder and all accessories out of reach of children and pets.
2. Make sure the camera has been fully charged (DC5V / 1.5A).
3. Working temperature: -10°C to 50°C (14°F to 122°F) Working relative humidity: 0-95%
4. Please do not expose the camera lens to direct sunlight.
5. The camera has an IP65 waterproof rating, which supports working properly under rain or snow. But it can not be soaked in water.

Note:

1. Bird Feeder Cam only works with 2.4GHz Wi-Fi.
2. Strong lights may interfere with the device's ability to scan the QR code.
3. Avoid placing the device behind furniture or near microwave products. Try to keep it within range of your Wi-Fi signal.

Bird Cam comes with a built-in card slot that supports up to 128GB Micro SD card.

Step 1: Rotate the camera down to the bottom.

Step 2: Open the top silicone plug. Insert the Micro SD card. Make sure to plug it in the right direction.

Step 3: Finally, Cover the silicone plug.

Set Up With Vichohome APp

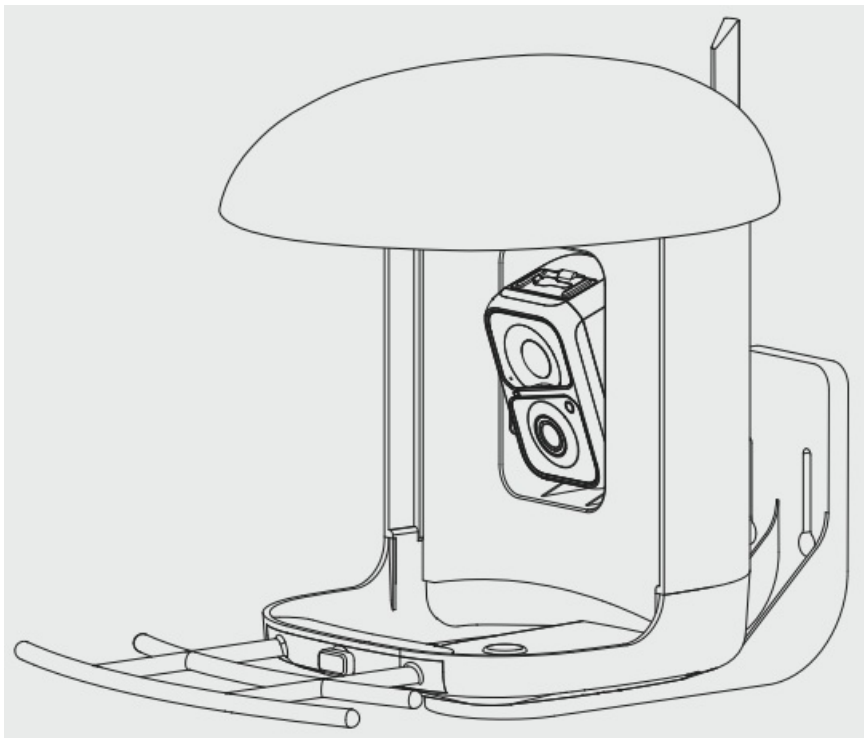



Download Vicohome App from App Store or Google Play. You can also Download the App by Scanning the QR Code above with the QR Code Scanner in you smartphone

Pair the Camera to your Phone App

Note

Before Installing your bird feeder and camera, Please Set up your camera first

Set up the camera

Step1:

Go to your App Store or Google Play on your smartphone, search for “Vicohome”(Or just scan the QR code below to download the app:



Then please sign up for a new account, please check the screenshot below for your reference:

1. Tap “Sign up for a new account”
2. Input your user name, your country “the United State”, and your E-mail address.
And then check on the “Agreement and Privacy policy”. Let’s go to “Next Step”.

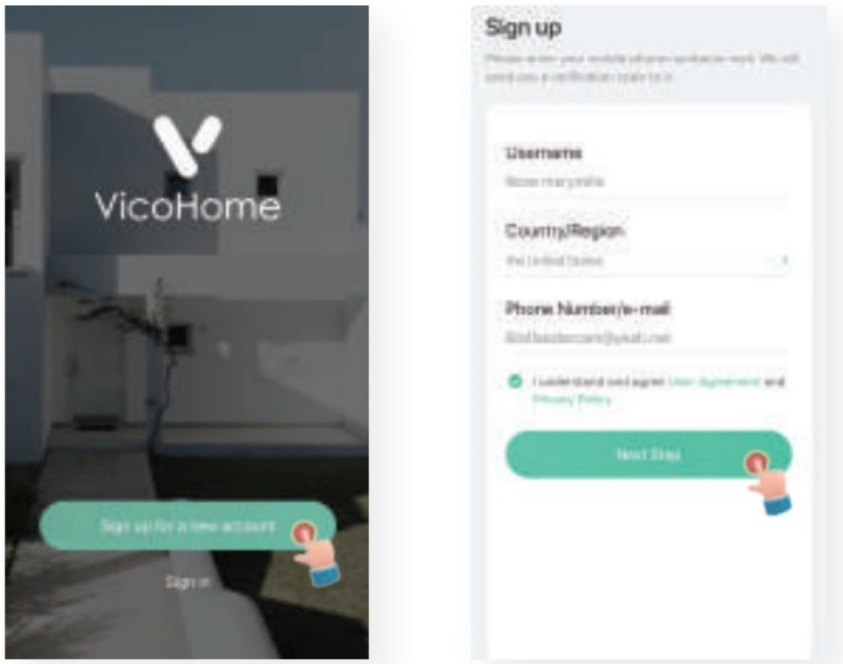

3. you will receive the Verification Code from you E-mail, put it in and then go to “Nest **Step**”
4. Set password for your account, and then go to “Done”.
5. Congratulations You have already registered successfully. Let’s tap the “+ icon to add the camera now!

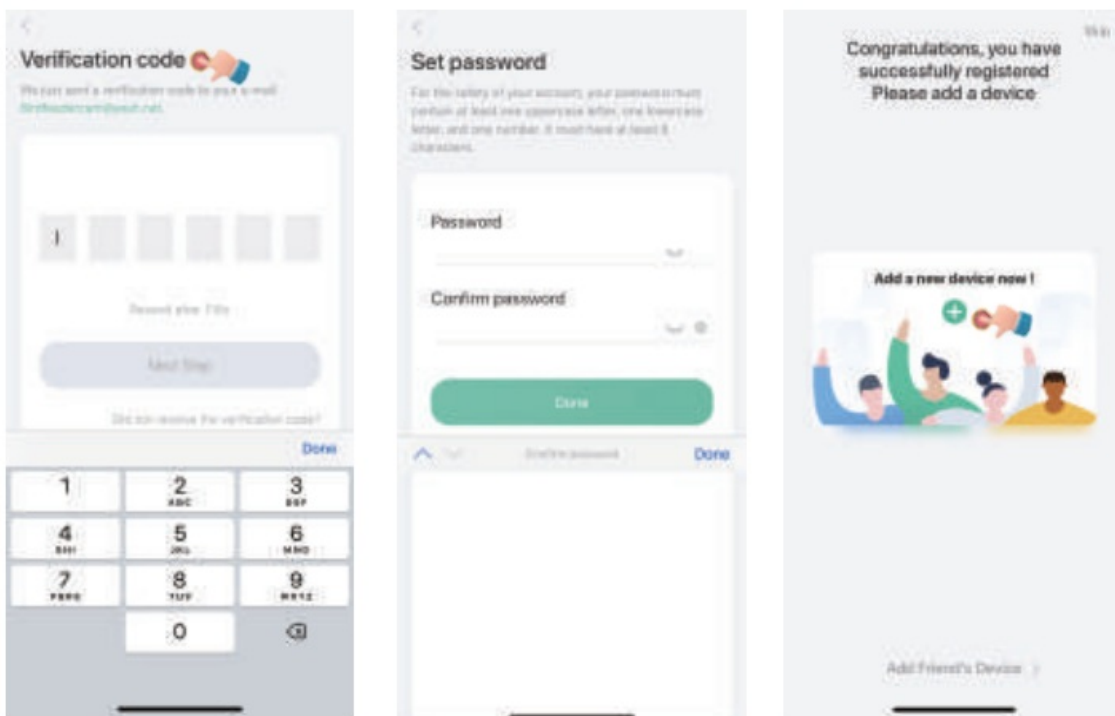

Step2:

you will hear the pairing sound from the camera, which means that the camera is ready for connection.

1. If you hear the sound from the camera, please go to “Next Step”.
2. The device is found, please tap the device at this page. Turn on the device.



3. Connect WIFI to the camera, select your network and input your WIFI password.
4. Tap "Join", please.

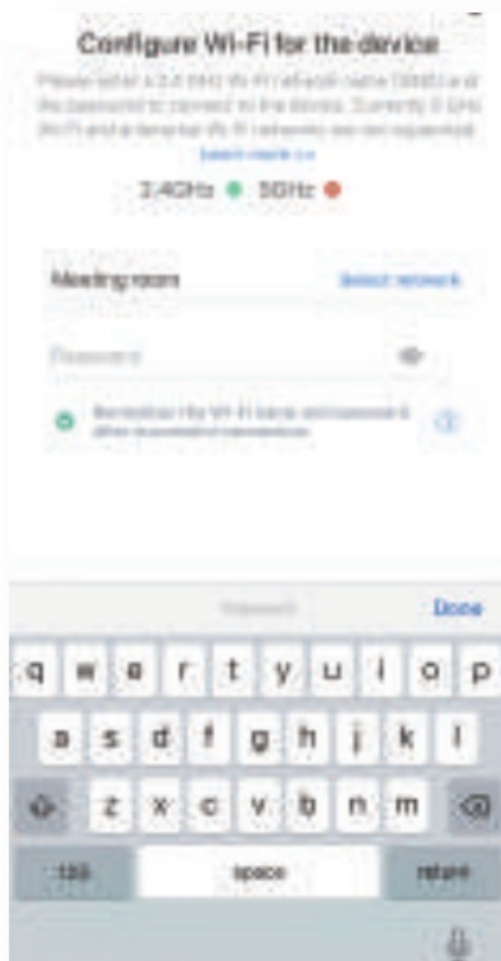

5. Wait for a second, you will see this page and the camera would say "WIFI connected". You're almost done.
6. Set a name for the device and go to "Next Step".

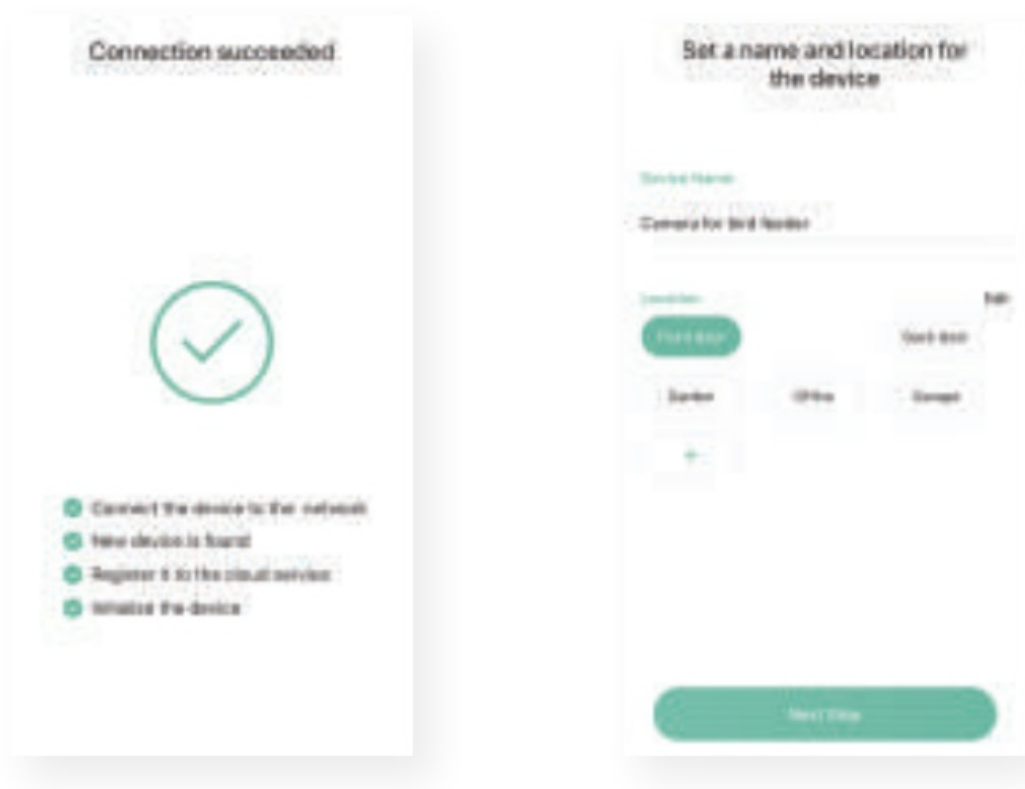

7. Check your WIFI signal strength, tap "Done".
8. Here we go! tap the "play" icon, you will see the camera image.

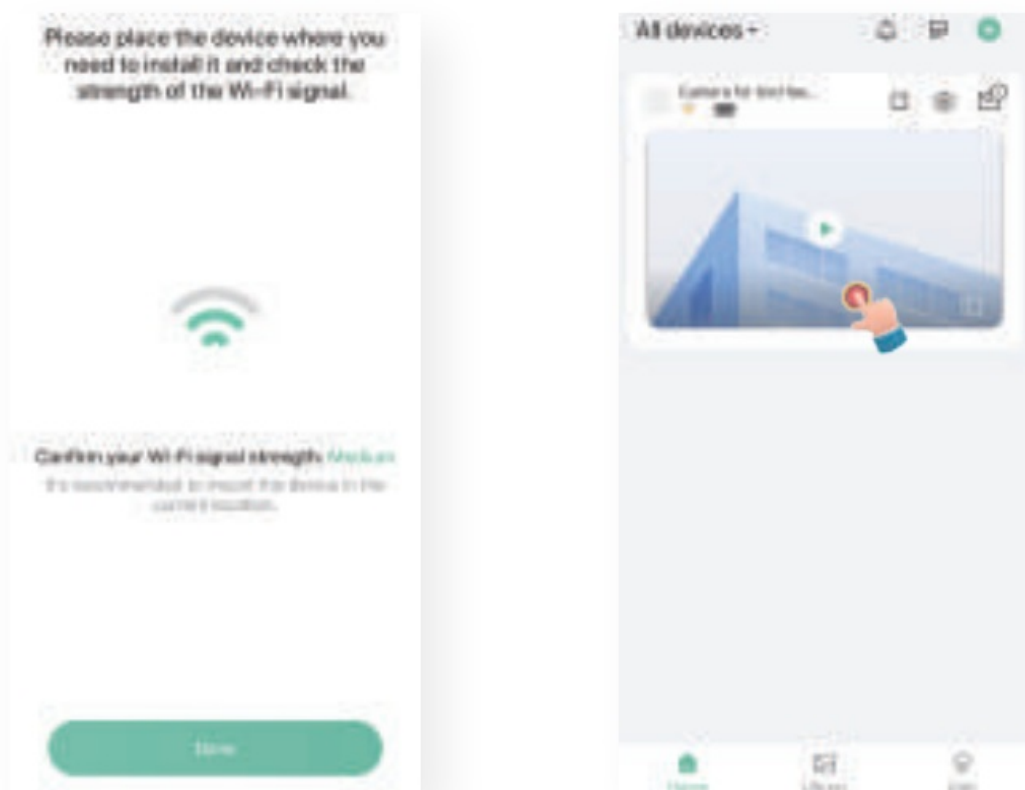

About Cloud Storage and Bird Fans Plan

How to get 30 days of free cloud storage For new register we have 30 days free cloud storage

1. Please go to Vicohome app, then tap try it free.

2. Please go to “Bird Fans Plan” get it free.
3. After one month this service needs to be subscribed.

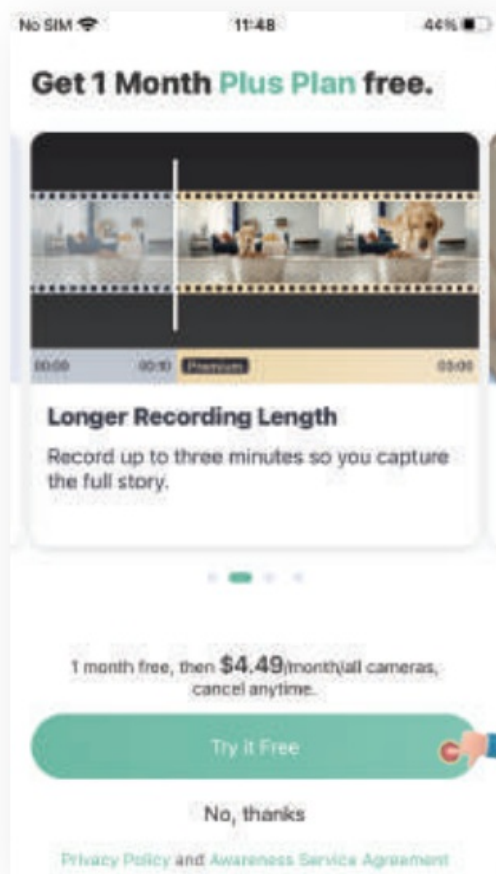

Share the camera with others

Step1: The invitee needs to download the Vicohome APP on her/his smartphone.

Step2: After installing and registering a new account to login, just go to the app homepage, tap on the “+ sign in the upper right corner, and then select “Add friend’s device”. Then please scan the QR code of device admin.

How to find the device admin QR code?

See the screenshot below. Just go to the administrator’s Vicohome app. Go to the settings icon Share Device Sharing then you will see the QR code. (QR code valid within half an hour)

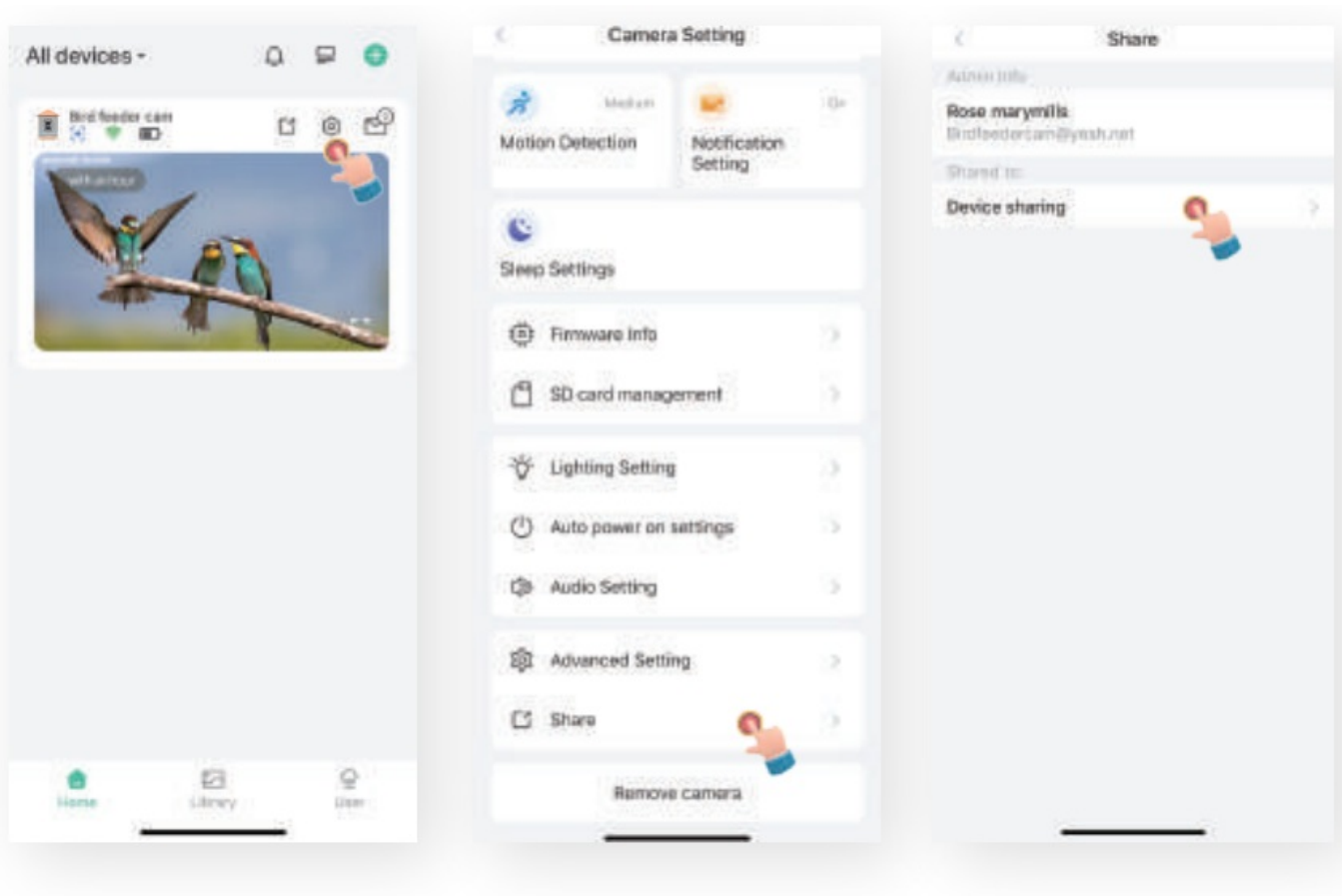

AI Identification

AI Identification

A bird came to the bird feeder and triggered camera recording and AI Identification.

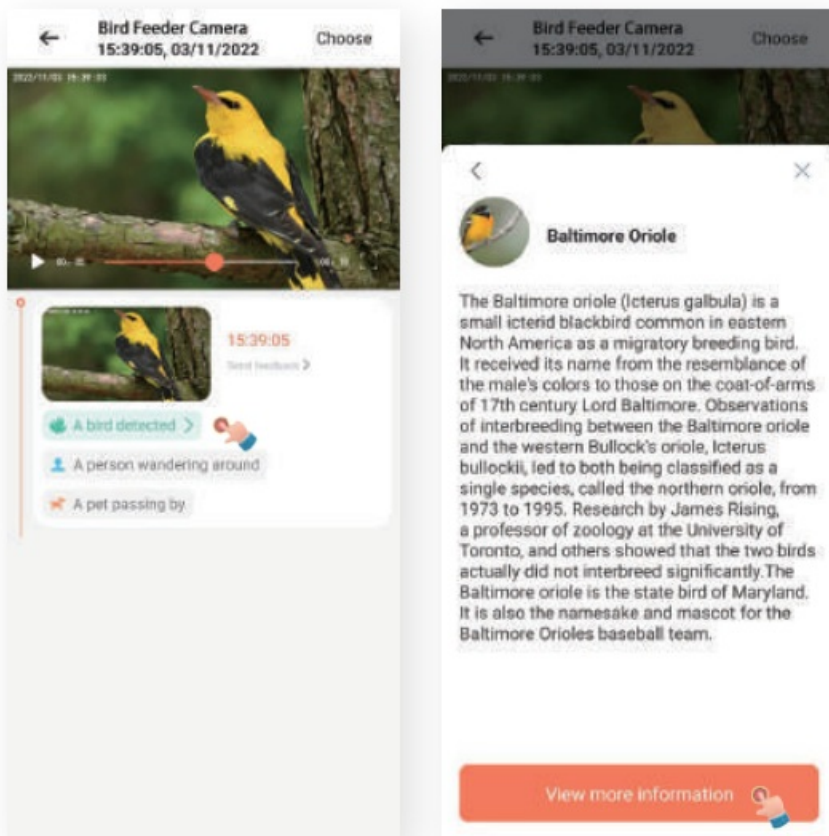

How to Connect charging cable and waterproof rubber stopper

When you connect the camera to the panel. Please confirm that the charging cable plug is in good contact with camera.

1. Prepare the solar panel with charging cable, take the rubber stopper out.

1



2. Thread the charging cable through the rubber plug.

2



3. Insert the charging cable firm the rubber stopper.

3



4. Please DON'T insert the charging cable directly with the rubber on the plug.

Incorrect Connection



Frequently Asked Questions

Q1: Why doesn't the Wi-Fi name appear when I connect to Wi-Fi?

A1: You need to turn on the "location permission" for the app in the system settings and change it to "allow when using".

Q2: Will the camera show red lights when night vision is activated?

A2: The built-in infrared lamp beads make the camera only show some dim red lights when night vision is activated, but the image quality is still clear under no light environment.

Q3: What are the requirements for Wi-Fi?

A3: Please use a 2.4GHz wireless network. The device does not support the 5GHz wireless network. Meanwhile, please set the Wi-Fi authentication method to WPA2-PSK or other lower level of the security method. A password is required.

Q4: How far should the camera be placed from the router?

A4: After testing, the Wi-Fi connection distance can normally reach up to 100 meters in the open area. However, the actual situation depends on the strength of Wi-Fi and its surrounding environment.

Q5: What is the maximum length of recording time?

A5: You can choose the recording time in the app. The camera records for a fixed time or "auto" mode, when depending on whether there is a person. The maximum length of a video is 3 minutes.

Q6: What should I do when the device is malfunctioning?

A6: Long press the power button to restart the camera.

Installation

Check the following things before you drill holes on your wall: Bird Feeder Cam has been successfully added to your Vicohome App and is able to stream video.

Wall Installation:

1. **Step 1:** Use the provided drilling template to mark the position of holes on your wall. Use a drill bit (5/16", 8mm) to drill two holes.

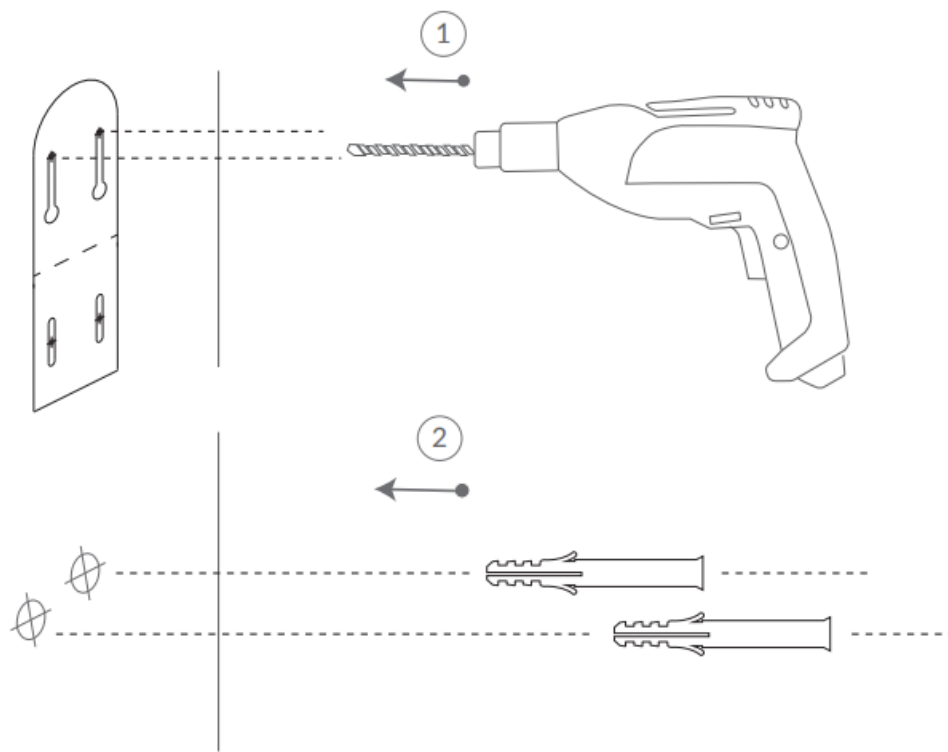

2. **Step 2:** Linstall the Mounting Bracket on your wall with the screws provided.

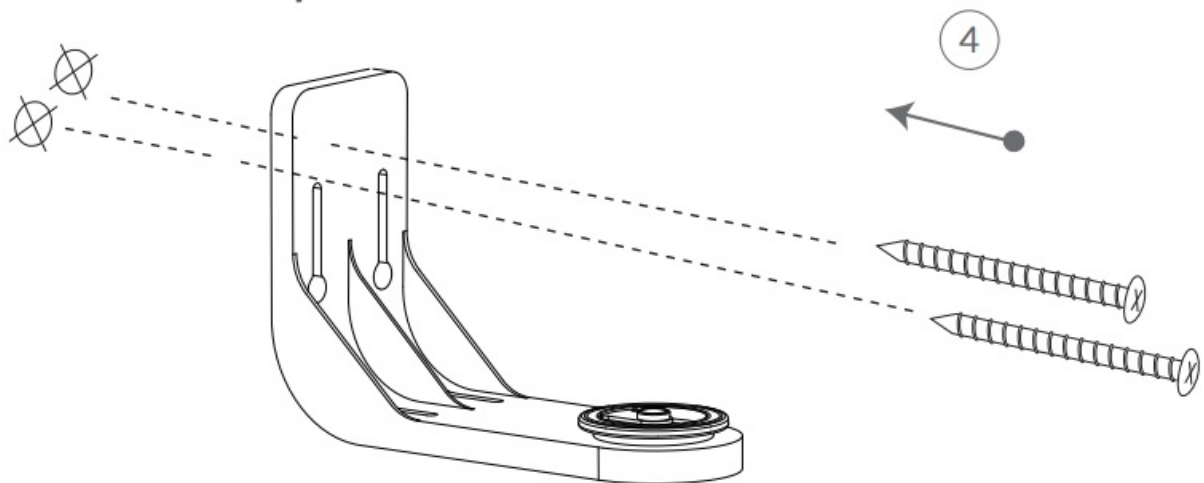

3. **Step3:** Slide the Bird Feeder into the mounting bracket.

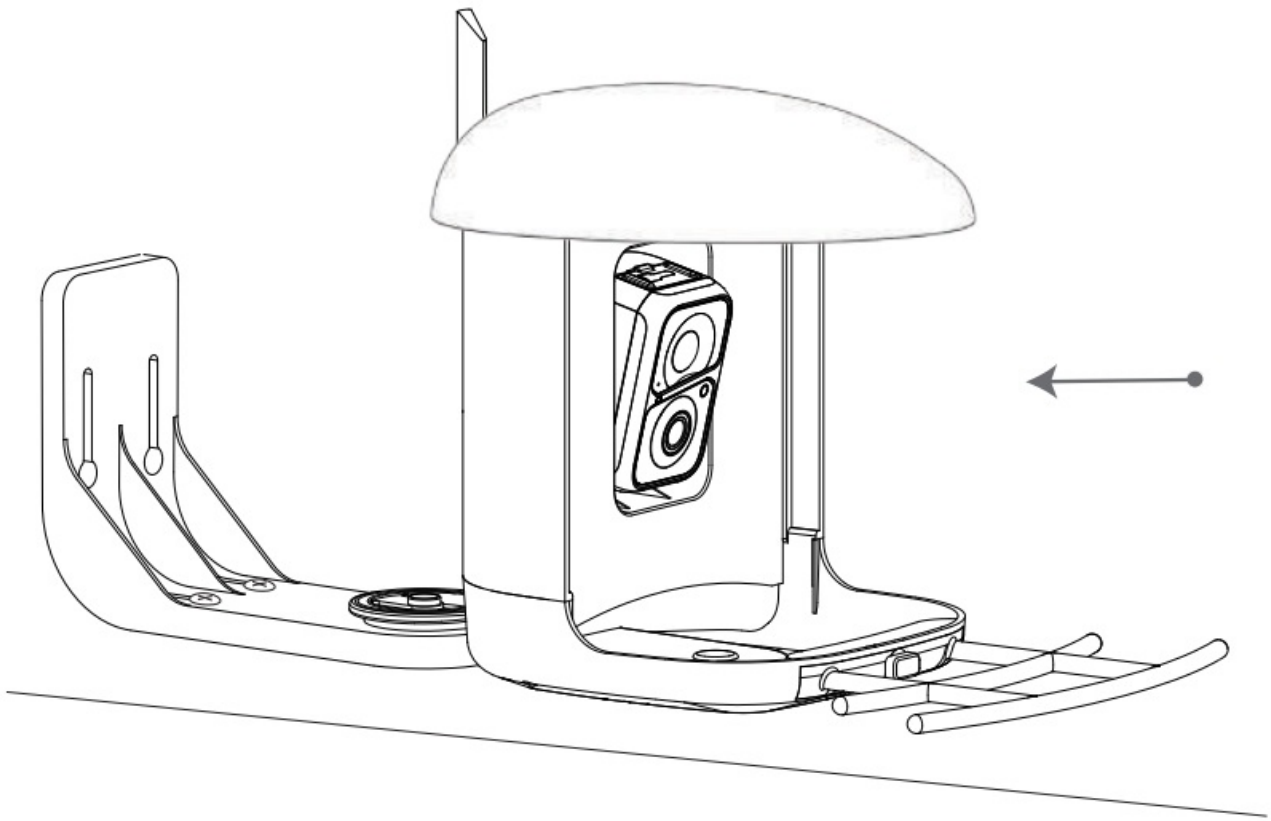

Stand Installation:

1. **Step 1:** The Bird Feeder can be placed steadily on a flat surface, but for stability, we recommend that the backplane is installed and fixed on a flat surface. Use the provided drilling template to mark the position of holes on a flat surface. Use a drill bit (5/16", 8mm) to drill two holes.

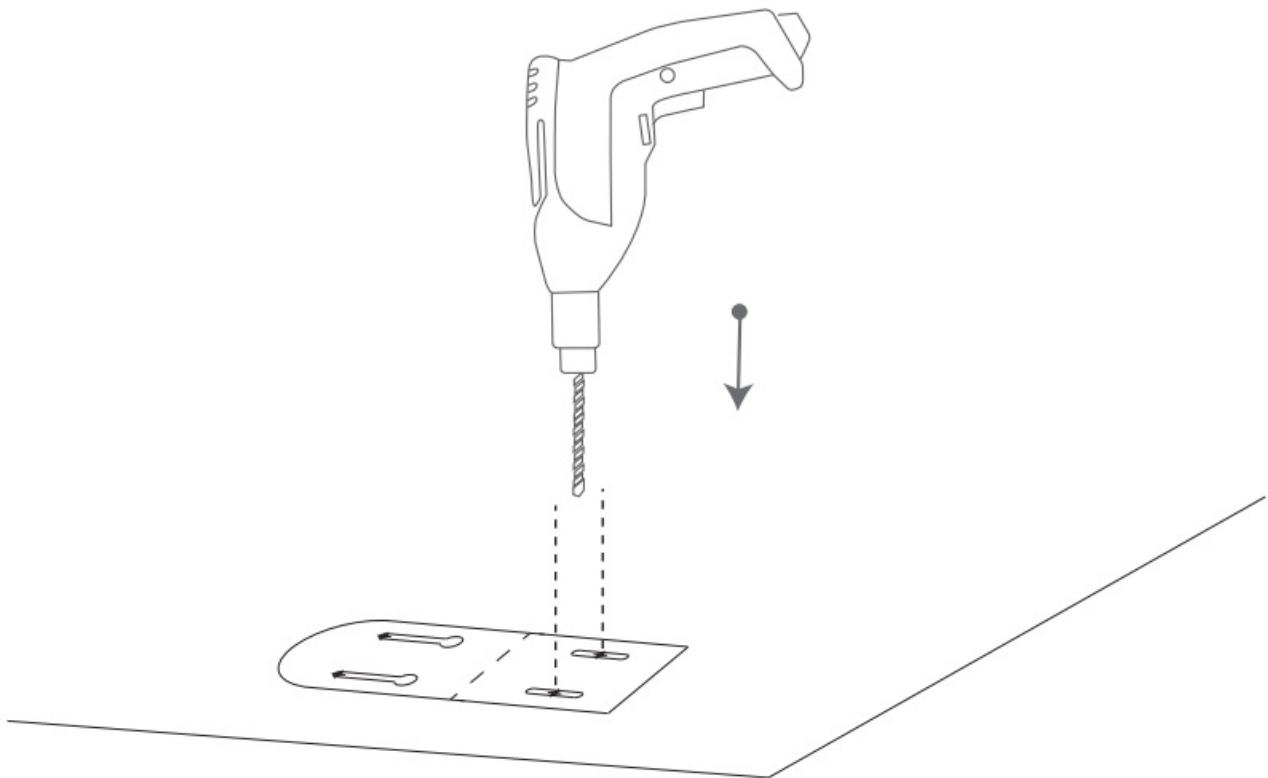

2. **Step 2:** Install the anchors to fix the screws. (Install on wood skip this step.)

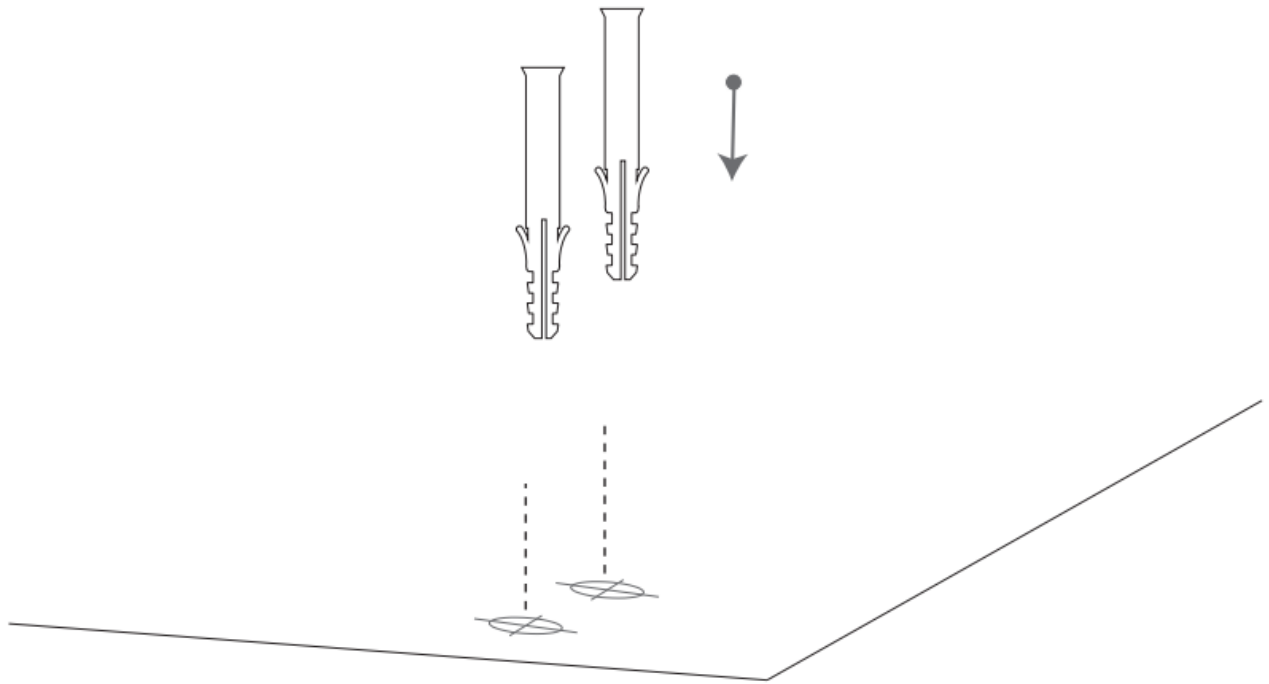

3. **Step3:** Install the Mounting Bracket on a flat surface with the screws provided.

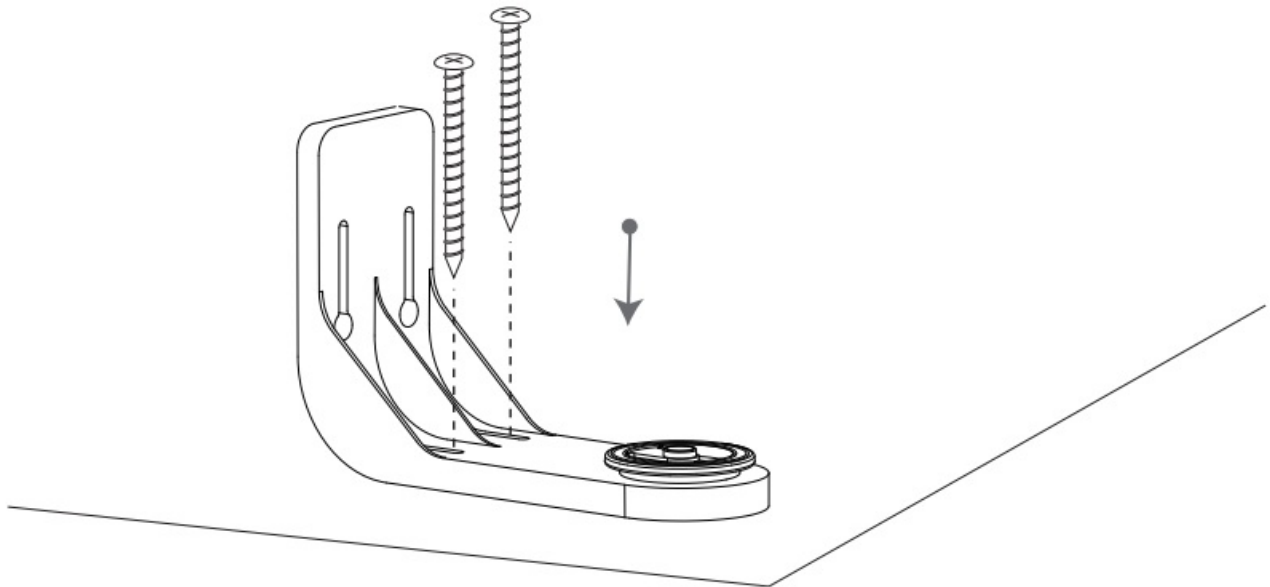

4. **Step4:** Slide the Bird Feeder into the mounting bracket.

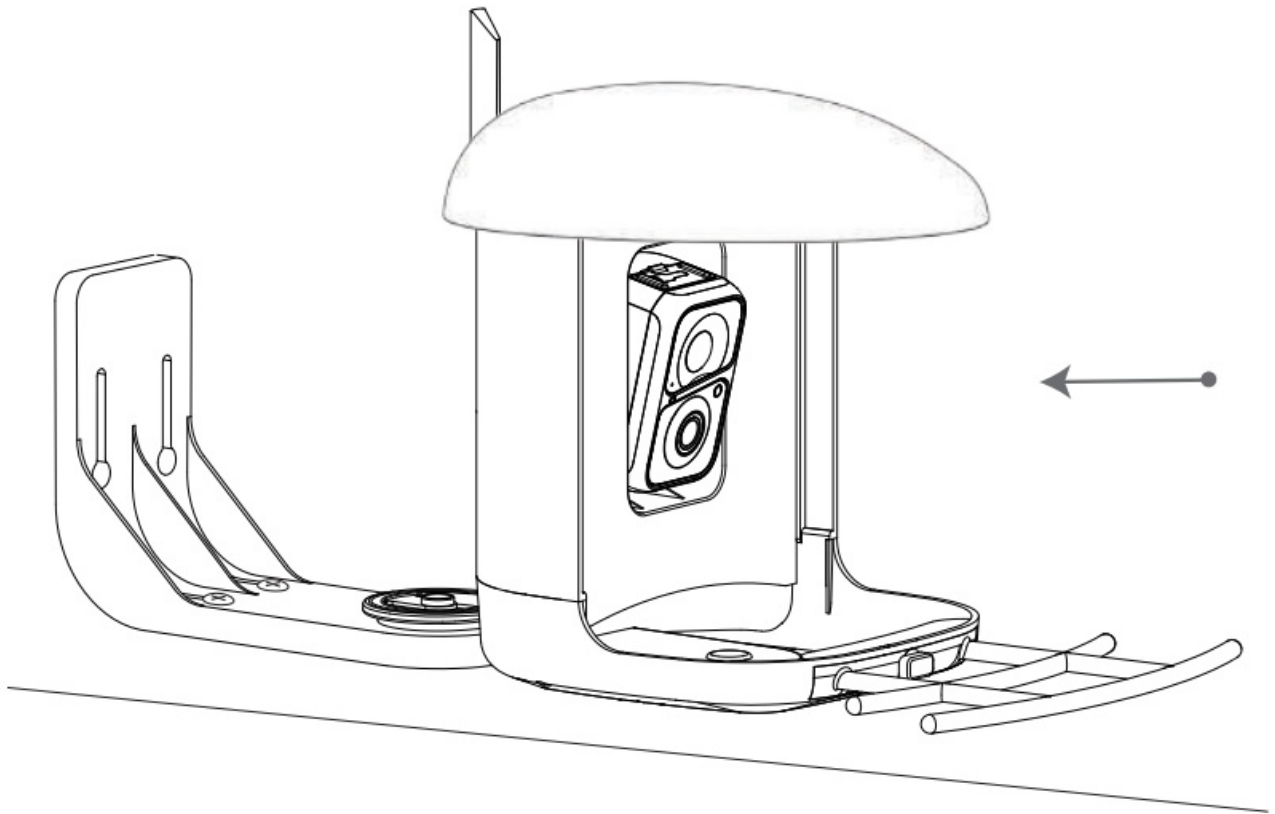

Tree Installation

strap installation

1. **Step 1:** Wrap the Mounting Bracket around the tree with the Black Strap.

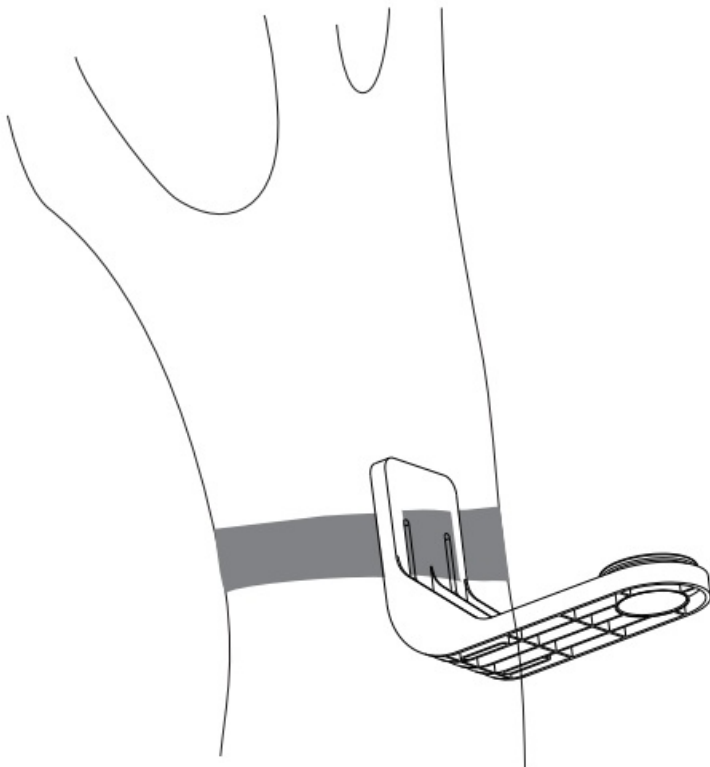

2. **Step 2:** Slide the Bird Feeder into the mounting bracket.

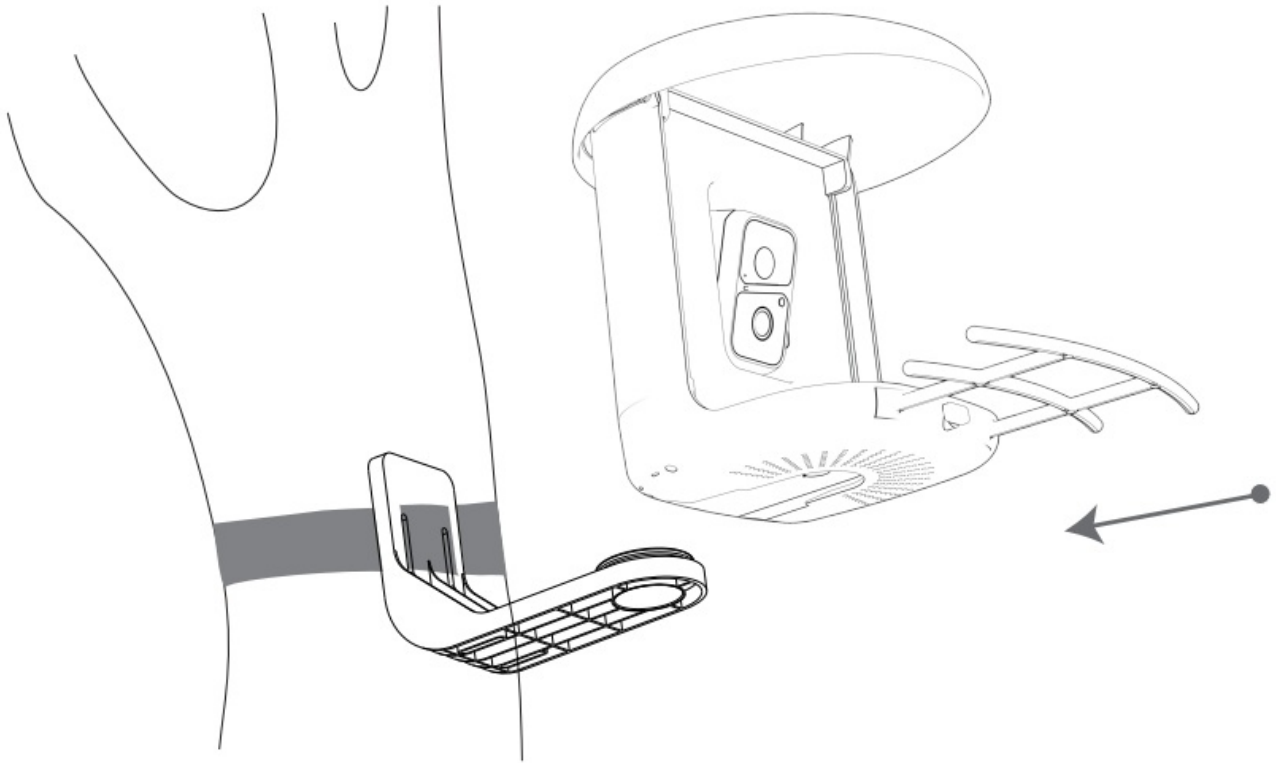

Pole Installation – Hose clip

nail installation

1. **Step1** Attach the Bird Feeder to the pole with the Hose Clip turning the handle clockwise.

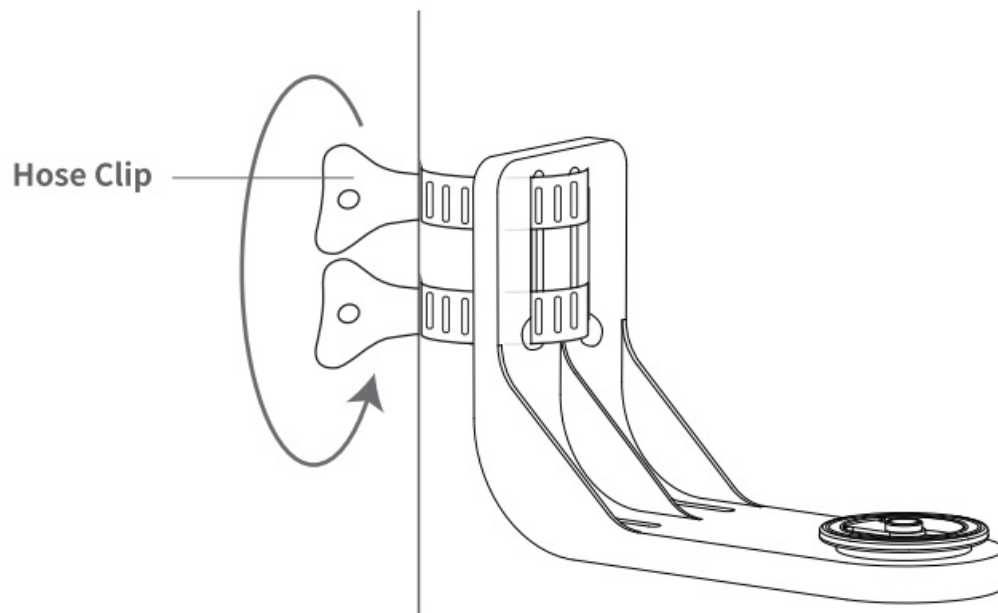

2. **Step2:** Slide the Bird Feeder into the bracket through the slide rail.

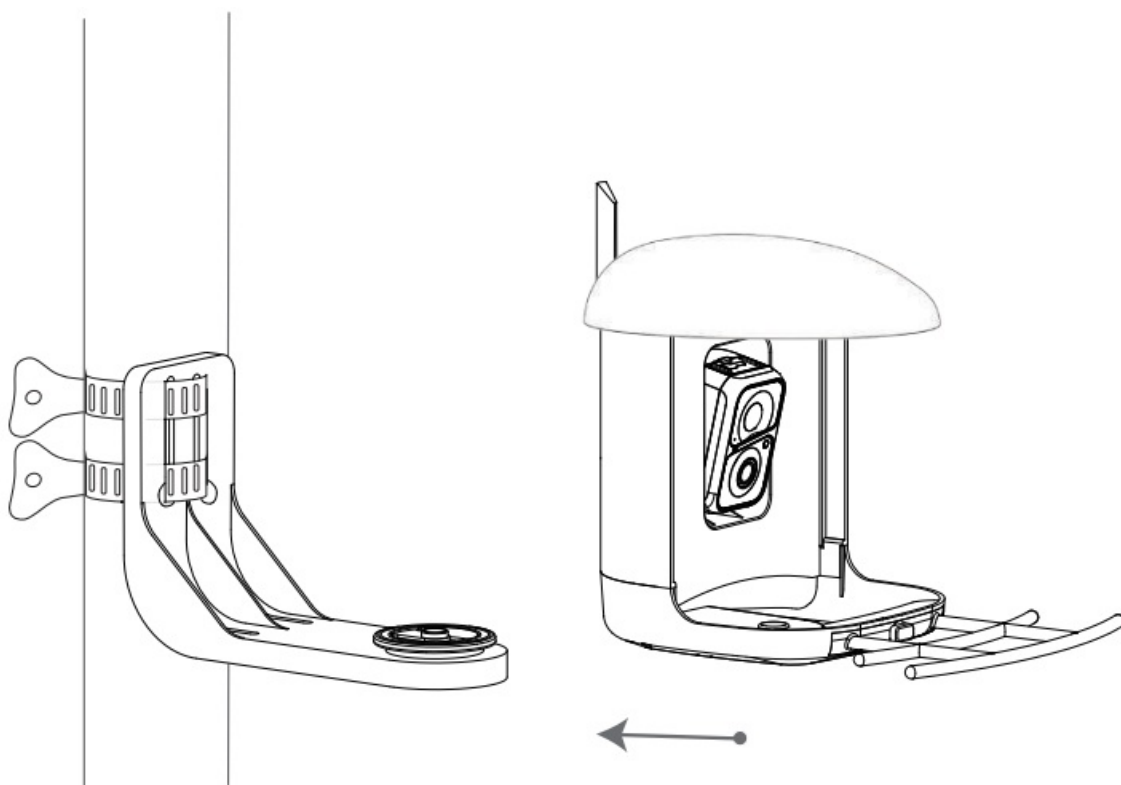

3. **Step 3:** The bird Feeder is installed and ready for bird watching.

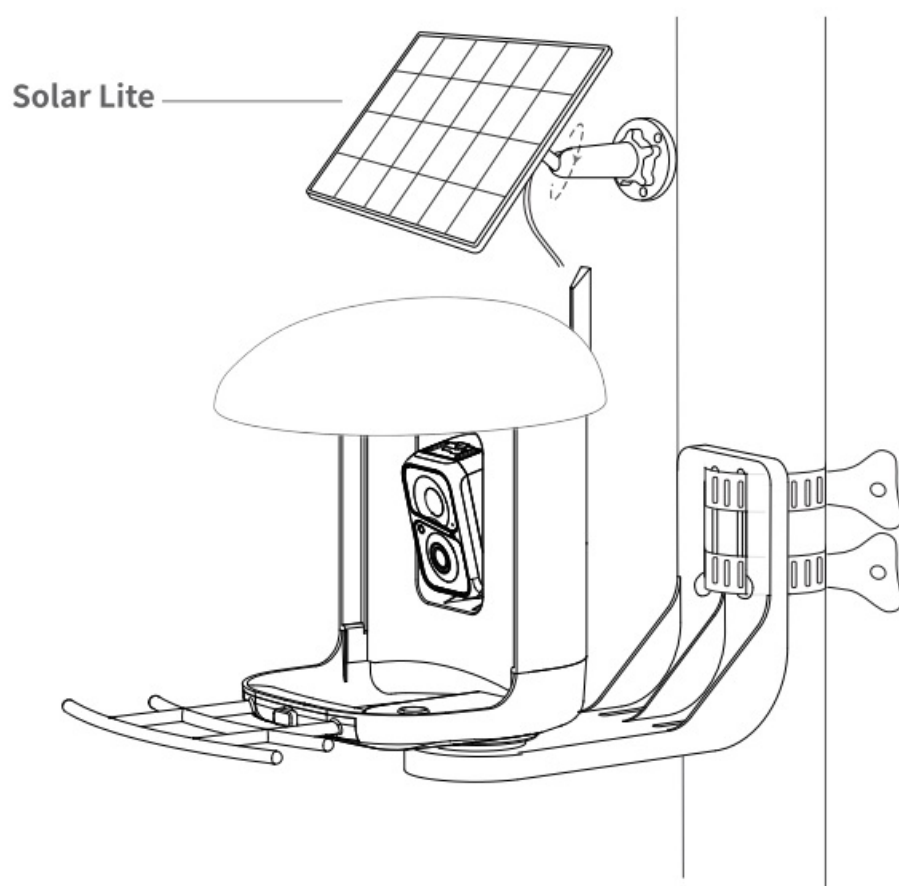

4. **Step 4:** Slide the Bird Feeder into the mounting bracket.

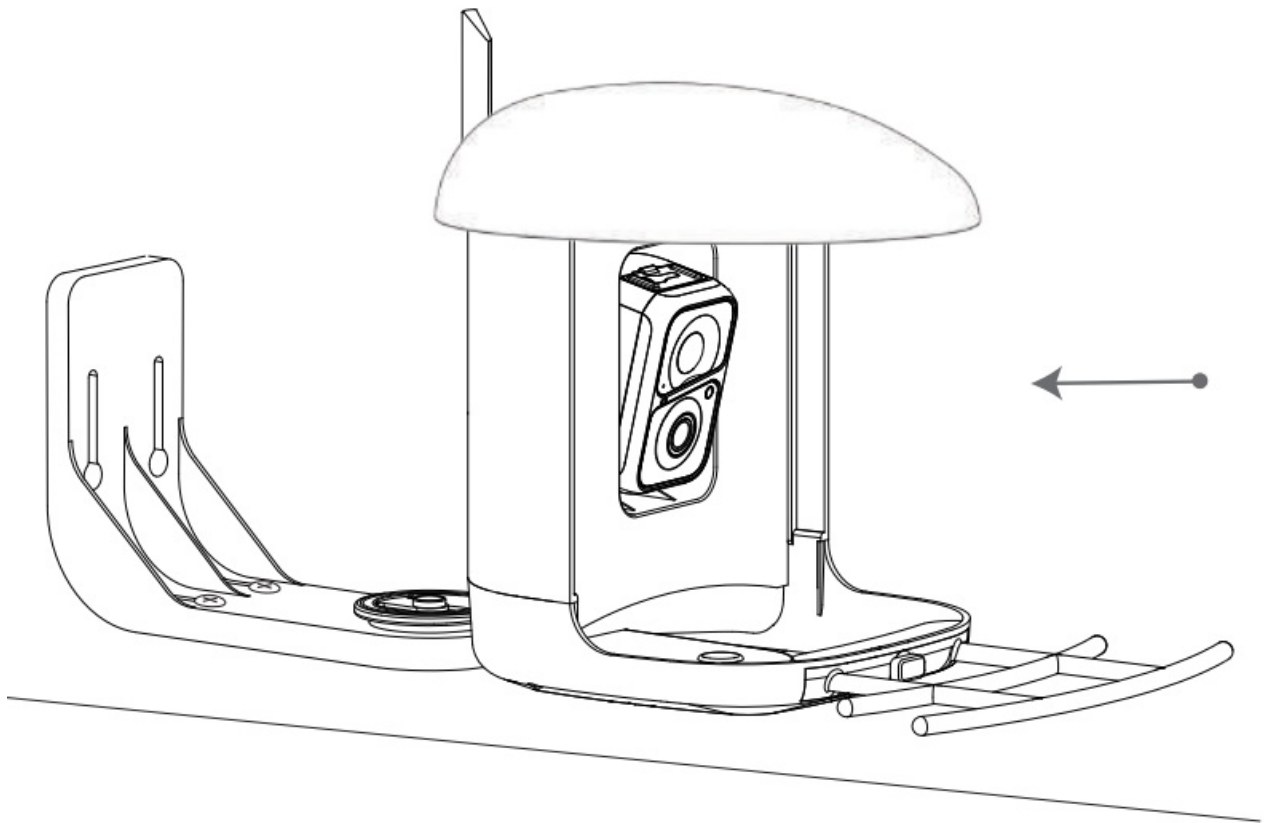

Cleaning Bird Feeder

1. **Step 1:** Unplug the charging cable and put on the silicone cover.

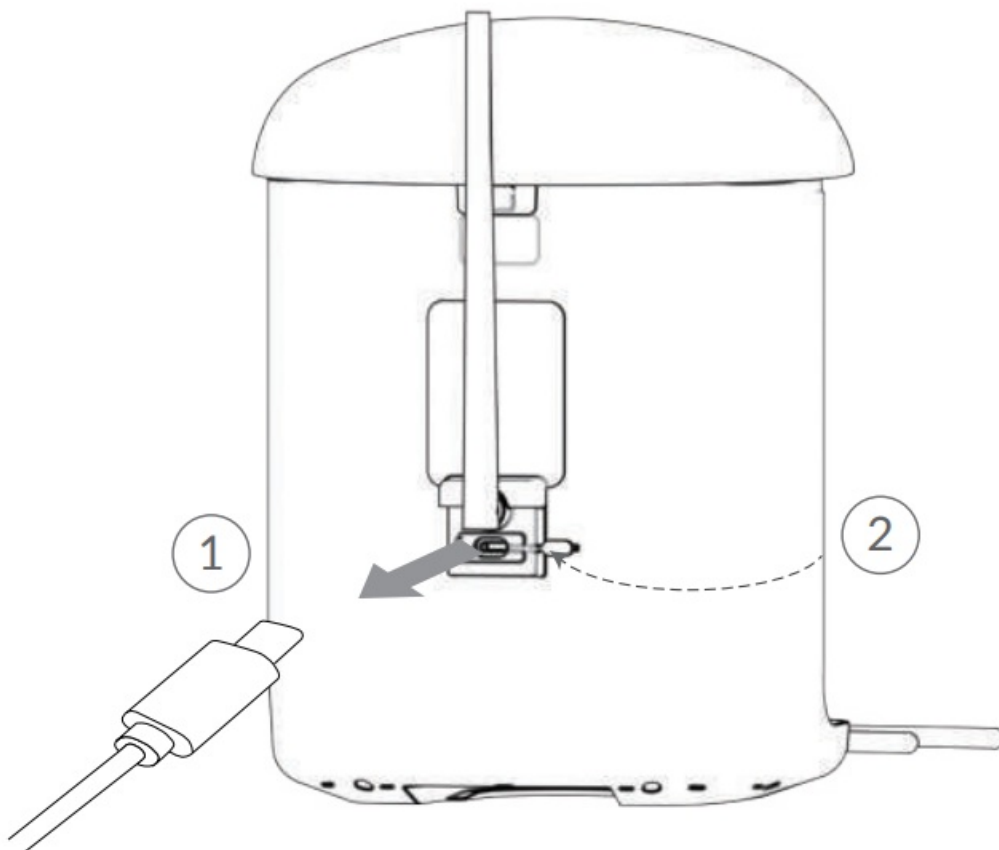

2. **Step2:** Using the Pull Tab on the base of the feeder, remove the Bird Feeder from the bracket.

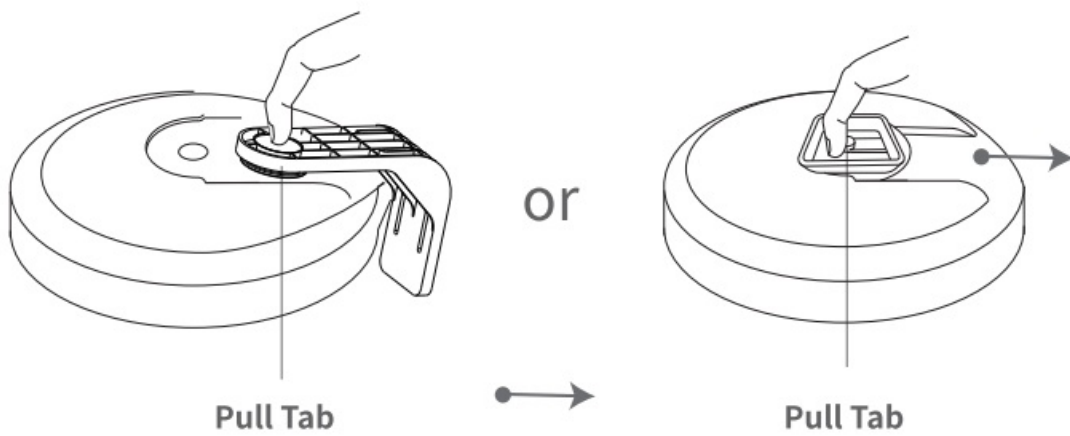

3. **Step 3:** Open up the buckle on the back of the Bird Feeder, and pull up on the roof to open.

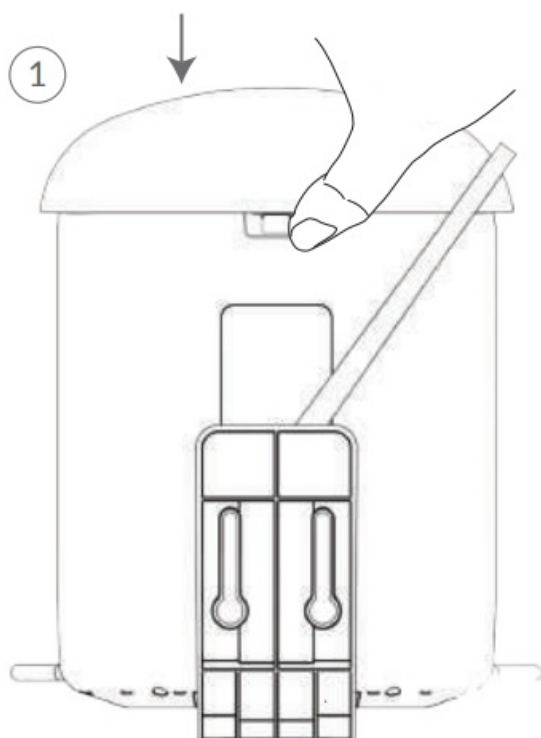

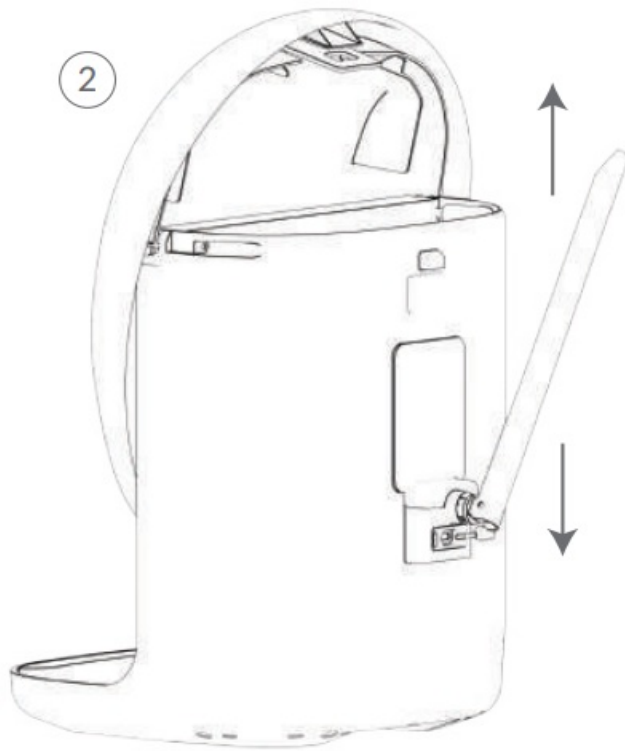

4. **Step 4:** Pour water into the top of the seed reservoir. Do not wash the camera or any of its components. They are water resistant, not water-proof. Dry the feeder, including the seed reservoir.

①

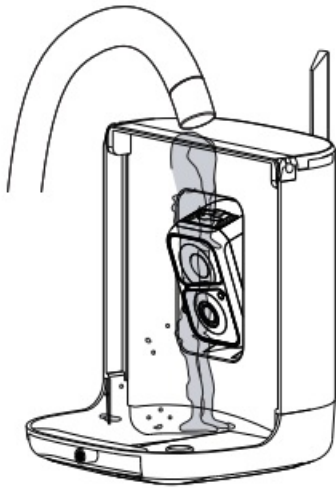

2

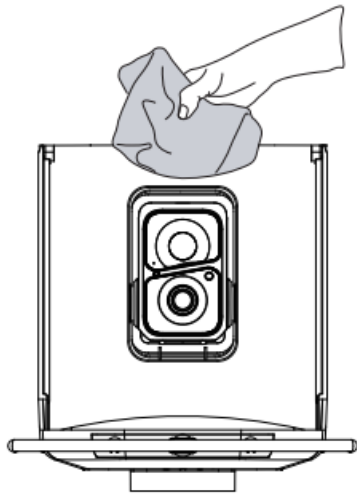

5. **Step 5:** Re-attach the Roof: Push the roof down and engage the snaps on the back of the Bird Feeder.

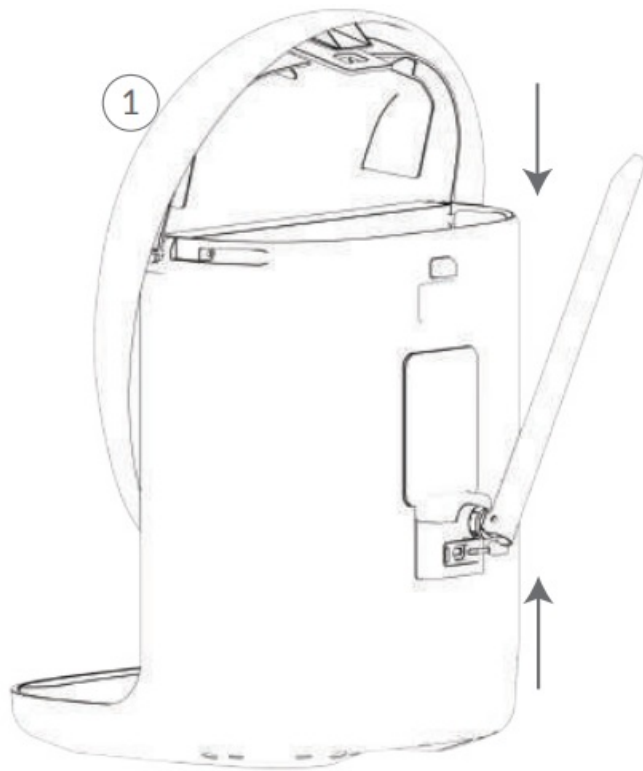

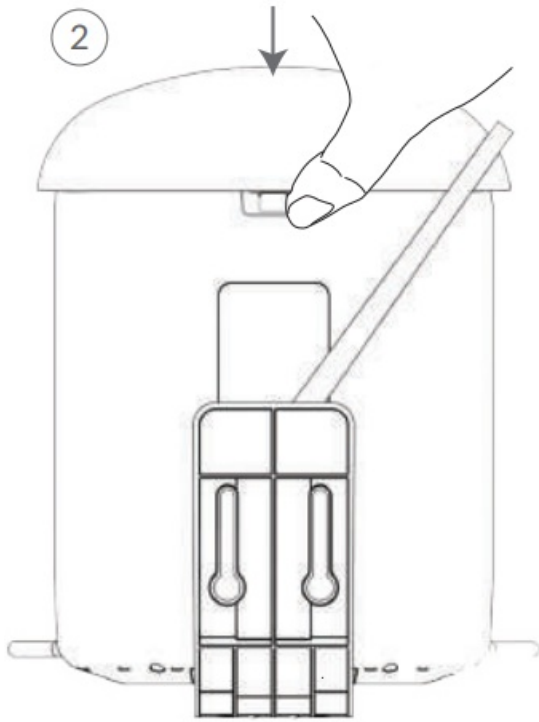

6. **Step 6:** Re-attach the bracket to the Bird Feeder base. Adjust the angle for both the Bird Feeder and camera.



or

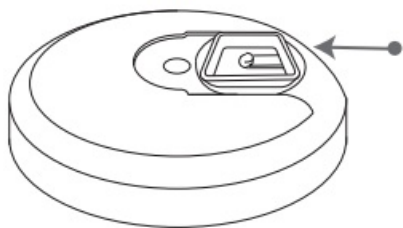

2

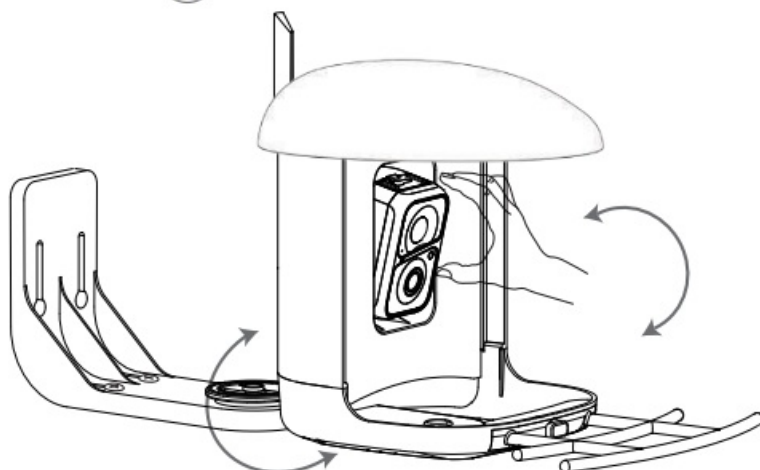

7. **Step 7:** Open the silicone plug, re-plug in the Solar Lite.

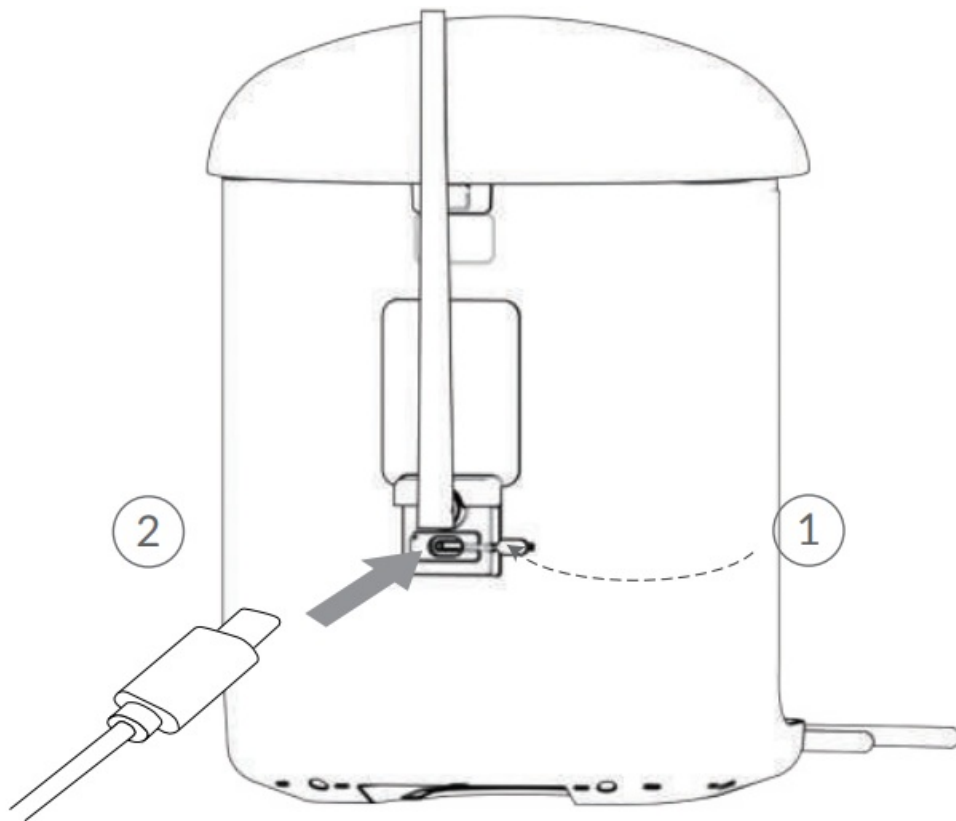

How to install the solar panel

- Base

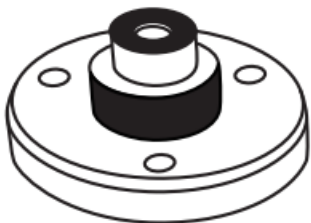

- Universal Joint



- Socket nut



- Locking Screw Cap



- Screws



- Wall Anchors

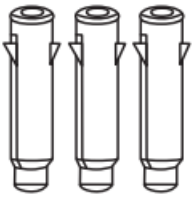

- Solar Panel

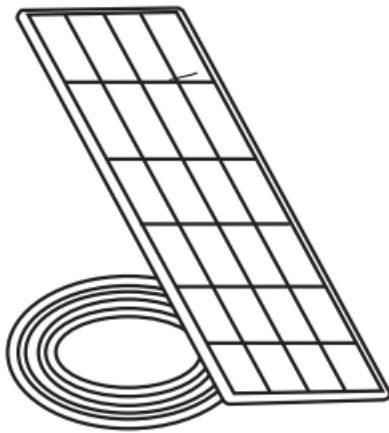

1. Find a good installation point and install the Solar Lite in a sunny location.

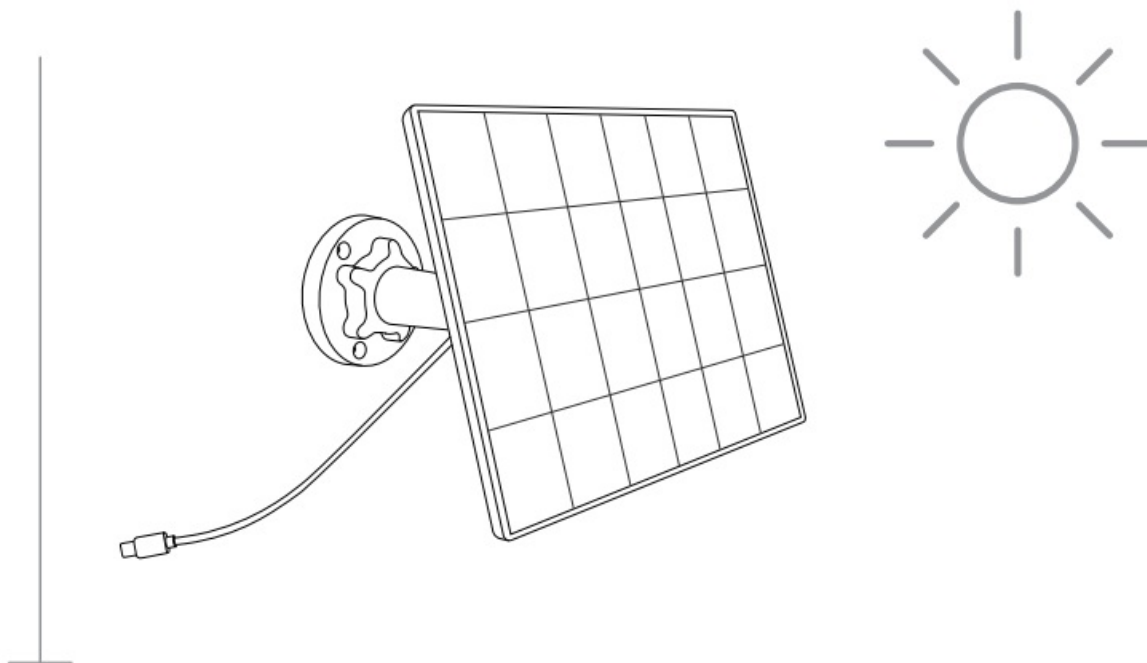

2. Use the provided base to mark the positions of the holes on the wall with a pencil.

Drill three $\varnothing 6.0(\text{mm})$ drill holes with an electric drill.

3. Drive the provided plastic anchors into the holes. Align the base with the anchors, and then drive in the screws to fix the base on the wall.
4. Take out locking screw cap on the base.

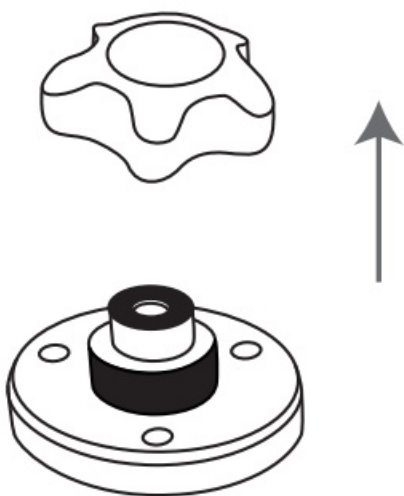

5. Slide the Locking Screw Cap into the Universal Joint until it reaches the end.

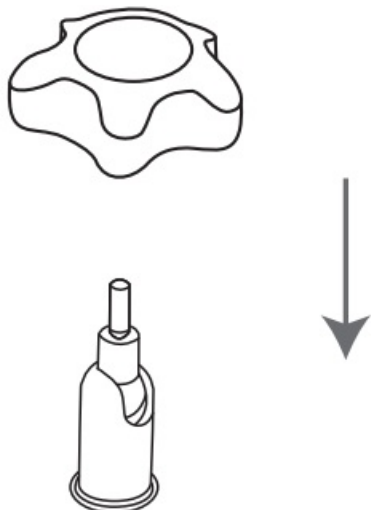

6. Clockwise spin the Locking Screw Cap.

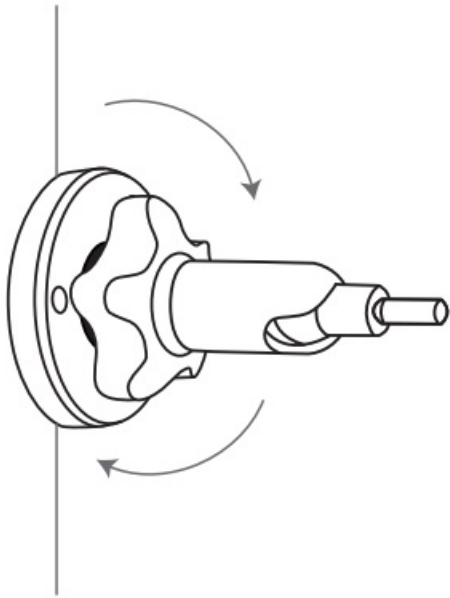

7. Then attach the joint to the back of the solar panel by screwing it in.

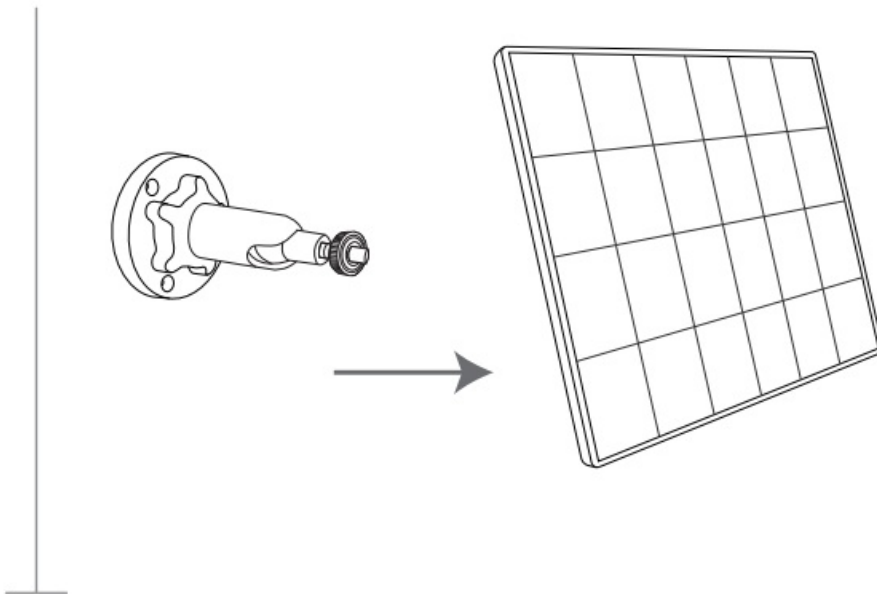

8. Align the universal joint with the Solar Panel, and lock it in place by turning the Universal Joint clockwise.

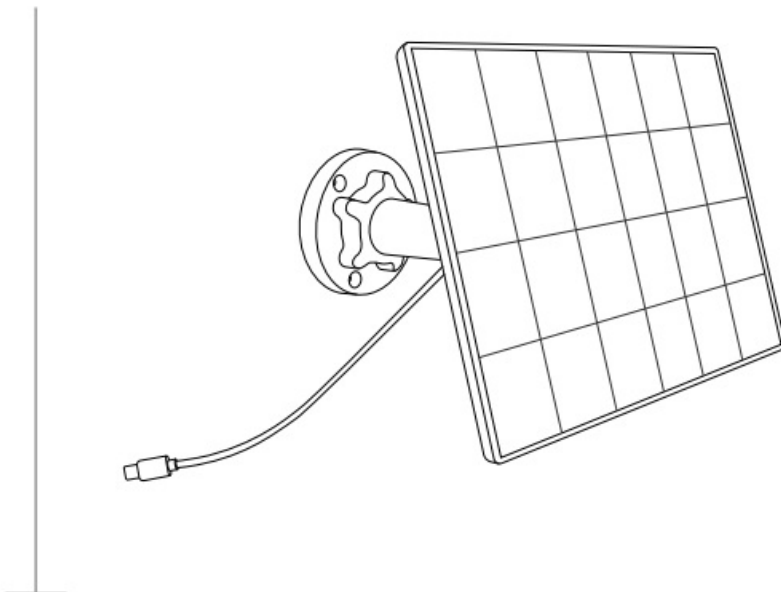

9. Adjust the solar Panel to your desired angle.

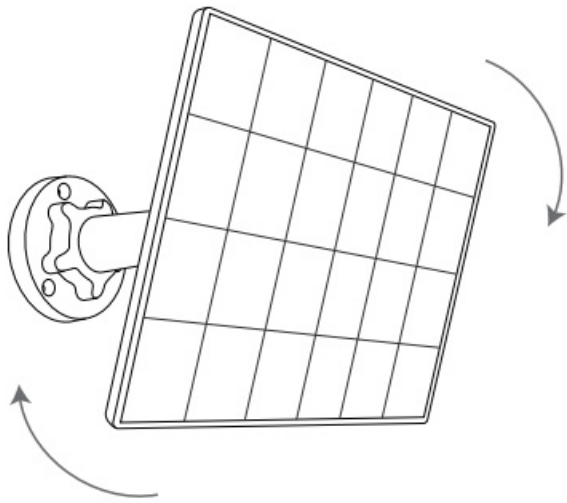

How to Add Bird Seed

1. **Step1:** Open up the buckle on the back of the Bird Feeder, and pull up on the roof to open.

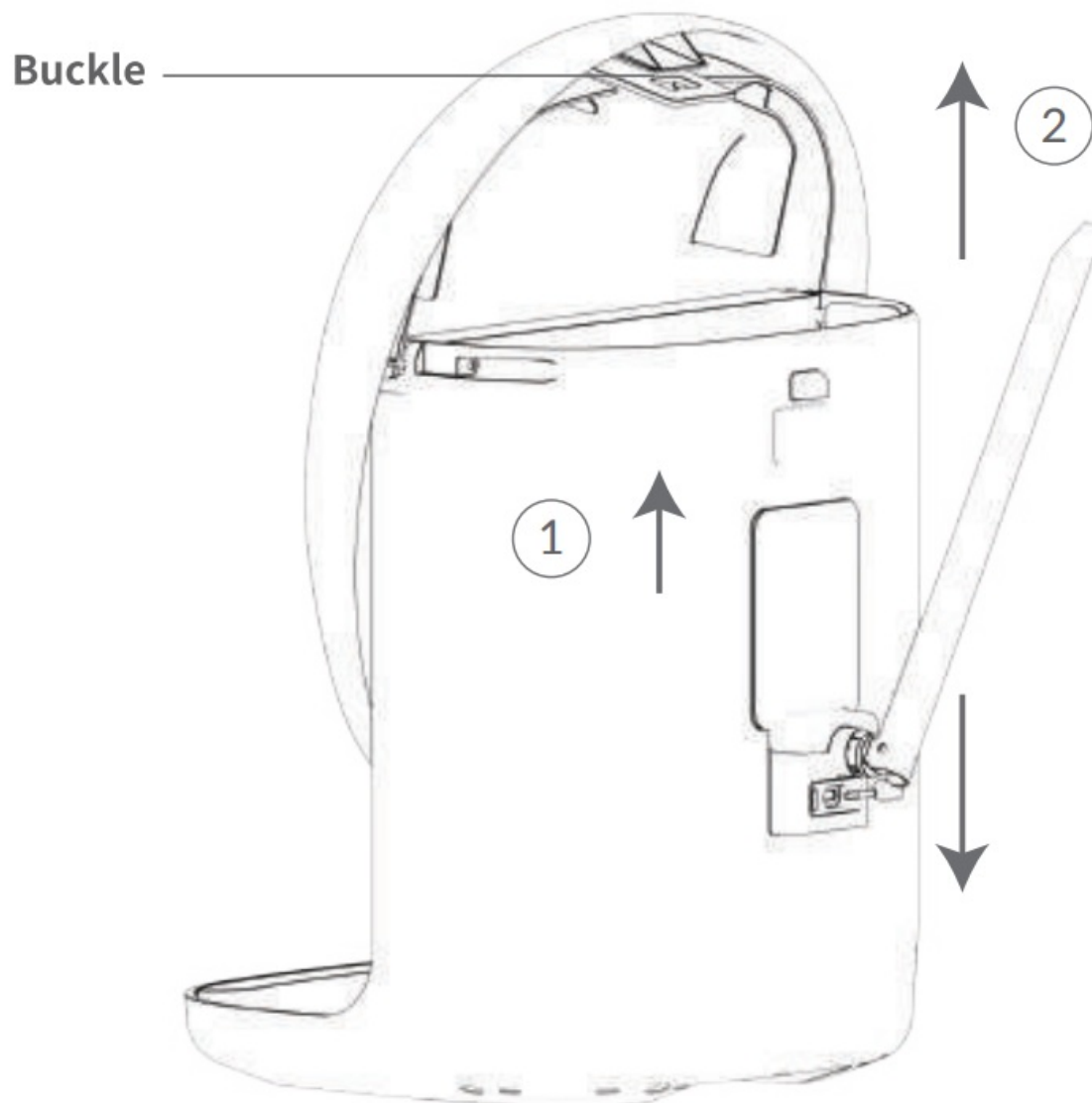

2. **Step 2:** You can add bird seed. Finally, close the roof back.

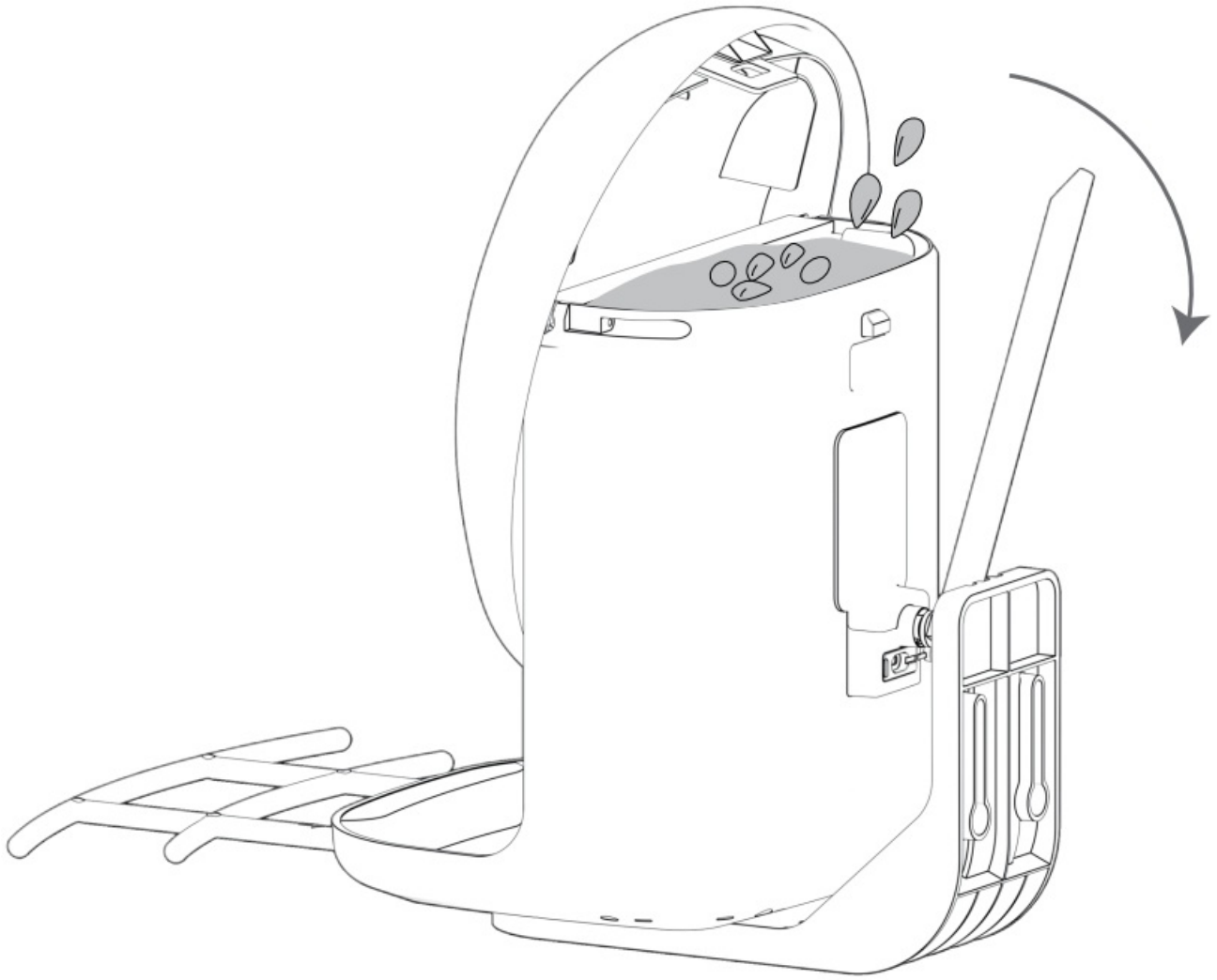

Status Light

This camera uses status light to communicate.

LED Indicator	Description
Solid Blue	Working
None	Sleep/Power Off
Solid Yellow	Charging
Solid Green	Charging Finished

AI Bird Recognition

*** This service requires a subscription.**

AI Bird Recognition has undergone massive machine learning and uses AI intelligent recognition algorithms to inform you in real time “what species of bird are coming”, automatically save the bird images/videos data for you, and also provide bird knowledge learning and so on.

Within 30 days from the date of purchase, you can register for an extended warranty on our website www.wuipet.com

Contact us for more help



support@wuiPET.com



@wuiPETofficial

Join our group

Join our group



Discuss and share bird videos or interesting facts with bird lovers | over the world

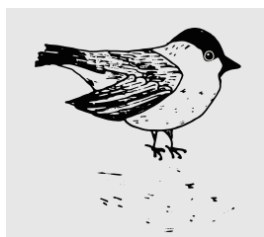

WUIPET

Documents / Resources



[wuiPET WP10 AI Bird Feeder](#) [pdf] User Guide
WP10 AI Bird Feeder, WP10, AI Bird Feeder, Bird Feeder, Feeder

References

- [🌐 WuiPET - Fostering Connections! Smart Bird Feeder With Camera – wuiPET](#)
- [User Manual](#)

[Manuals+](#), [Privacy Policy](#)

This website is an independent publication and is neither affiliated with nor endorsed by any of the trademark owners. The "Bluetooth®" word mark and logos are registered trademarks owned by Bluetooth SIG, Inc. The "Wi-Fi®" word mark and logos are registered trademarks owned by the Wi-Fi Alliance. Any use of these marks on this website does not imply any affiliation with or endorsement.