



WUBEN G2 EDC Keychain Light User Manual

[Home](#) » [WUBEN](#) » WUBEN G2 EDC Keychain Light User Manual 

Contents

- [1 WUBEN G2 EDC Keychain Light](#)
- [2 Product information](#)
- [3 Product Usage Instructions](#)
- [4 Contact](#)
- [5 Packaging](#)
- [6 About The Flashlight](#)
- [7 Accessories Installation](#)
- [8 Charging and Discharging](#)
- [9 Operation Of The Flashlight](#)
- [10 Specifications](#)
- [11 Common Issues and Solutions](#)
- [12 Maintenance](#)
- [13 Warranty](#)
- [14 EU Declaration of Conformity](#)
- [15 Documents / Resources](#)
 - [15.1 References](#)
- [16 Related Posts](#)



WUBEN G2 EDC Keychain Light



Product information

Specifications

- **Mode:** Turbo, High, Medium, Low, Moon
- **Brightness:** Turbo – 500-200 lm, High – 200 lm, Medium – 65 lm, Low – 15 lm, Moon – 1 lm
- **Run Time:** Turbo – N/A, High – 1.5 h, Medium – 6 h, Low – N/A, Moon – 70 h
- **Distance of Beam Projection:** Turbo – 30 m, High – 35 m, Medium – 46 m, Low – N/A, Moon – N/A
- **Intensity of Light Source:** Turbo – N/A, High – N/A, Medium –
- **Light Source:** Osram P9 LED
- **Drop resistance:** 1.5 m

FAQ

- **Q:** What should I do if there is an abnormal noise coming from the flashlight?
 - **A:** There may be damage to certain parts of the flashlight or foreign matter in the tube. If any parts are damaged, please reach out to your local distributor for assistance. Ensure to remove any foreign matter from the flashlight's tube.

- **Q:** What are the warranty conditions for this product?
 - **A:** Please refer to the maintenance section of the user manual for warranty conditions.

Product Usage Instructions

Packaging

- Before using the product, please check whether the contents of the package are complete.

Accessories Installation

- Follow the instructions provided to install the back clip and keychain.

Charging and Discharging

- To charge the flashlight, connect it to a power source using the USB port.
- The battery capacity indicator will show the charging progress. To discharge the flashlight, simply turn it on and select the desired mode.

Operation Of The Flashlight

To turn on the flashlight, press and hold the switch. The flashlight has multiple brightness modes:

- **Moon:** Press and hold the switch to activate the lowest brightness mode.
- **Low:** Press the switch once to switch to the low brightness mode.
- **Medium:** Press the switch twice to switch to the medium brightness mode.
- **High:** Press the switch three times to switch to the high brightness mode.
- **Turbo:** Press the switch four times to switch to the turbo brightness mode.

Contact

Dear customer,

Thank you for purchasing our product. Please read the following instructions carefully before first use and keep this user manual for future reference. Pay particular attention to the safety instructions. If you have any questions or comments about the device, please contact the customer line.

- www.alza.co.uk/kontakt
- ☎ +44 (0)203 514 4411
- **Importer:** Alza.cz a.s., Jankovcova 1522/53, Holešovice, 170 00 Praha 7, www.alza.cz

Caution

- Kindly read the user manual carefully before using the product.
- Please exercise caution as the product may generate heat during operation. Avoid direct exposure to prevent any potential harm.

- Avoid shining the light directly into the eyes to prevent eye damage.
- Keep the product out of reach of children.
- Utilize WUBEN or WUBEN recommended batteries for optimal performance.
- Do not disassemble the product as it will void the WUBEN warranty policy.
- Refrain from throwing the product into fire.
- Note that this product is not suitable for diving. Avoid prolonged underwater use.
- The LED may generate heat while in operation. Keep the main product away from other objects to prevent damage or any other potential risks.

Packaging

Before using this product, please check whether the contents of the package are complete.

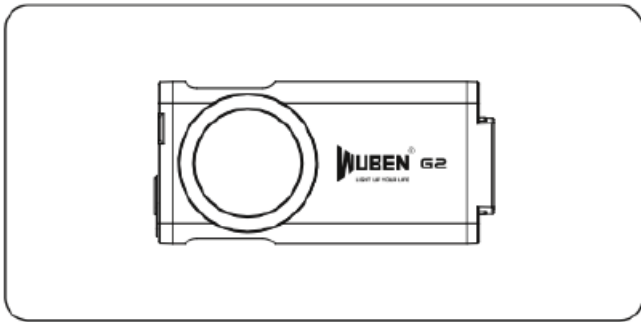

❶ 1× G2 Flashlight

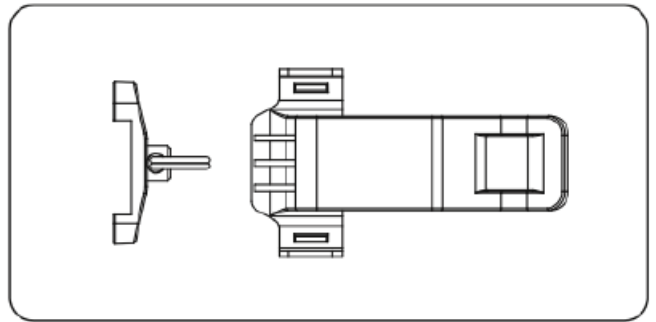

❷ 1× Keychain, Back Clip

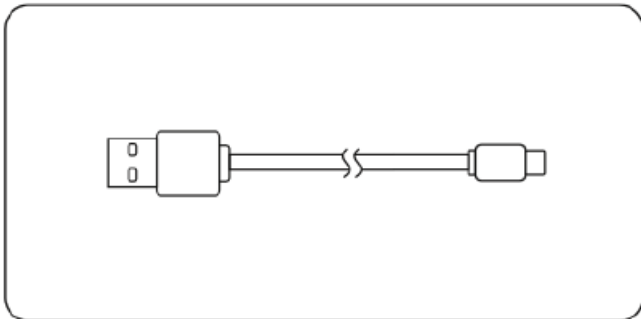

❸ 1× USB Type-C Charging Cable



❹ 1× Manual, Warranty Card

About The Flashlight

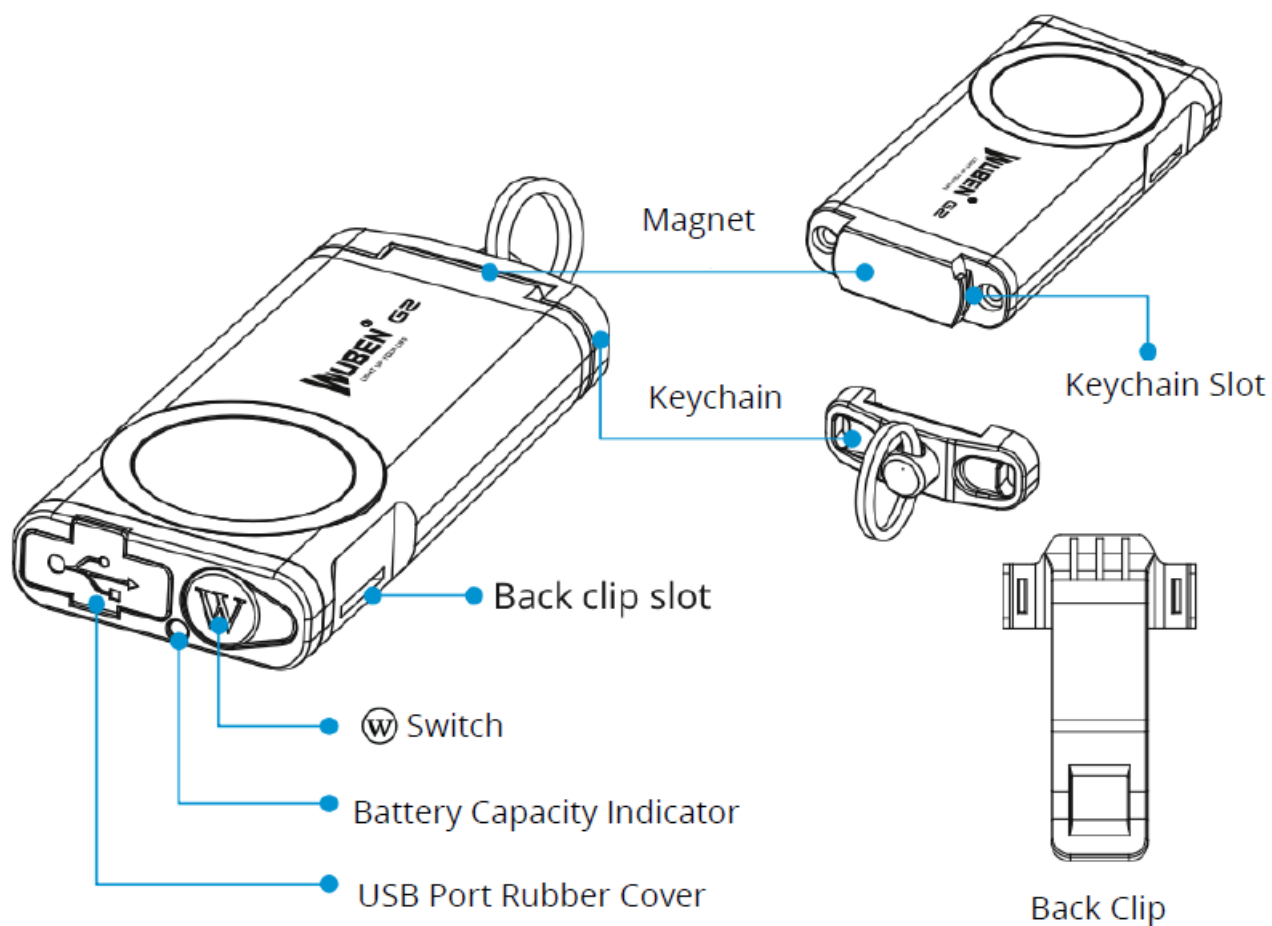

Accessories Installation

Back Clip Installation

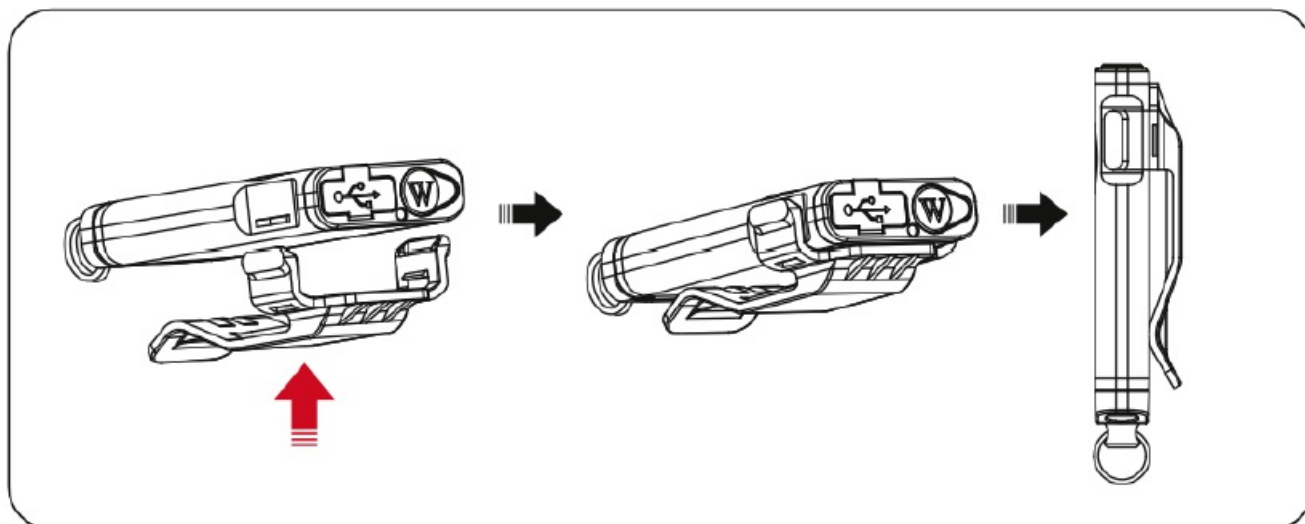

Keychain Installation

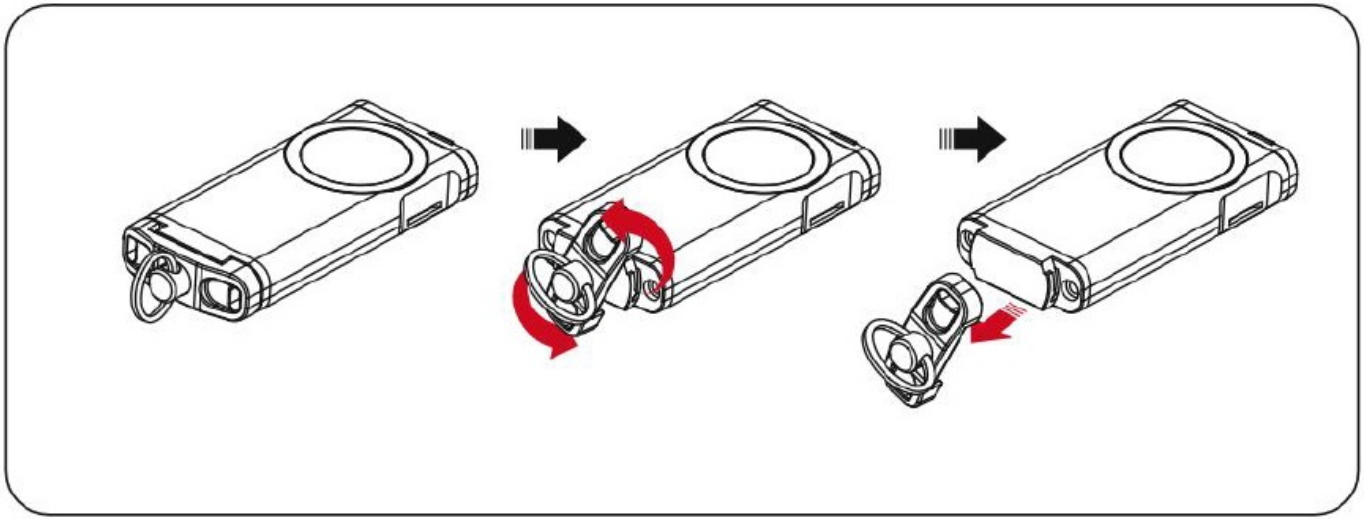

Charging and Discharging

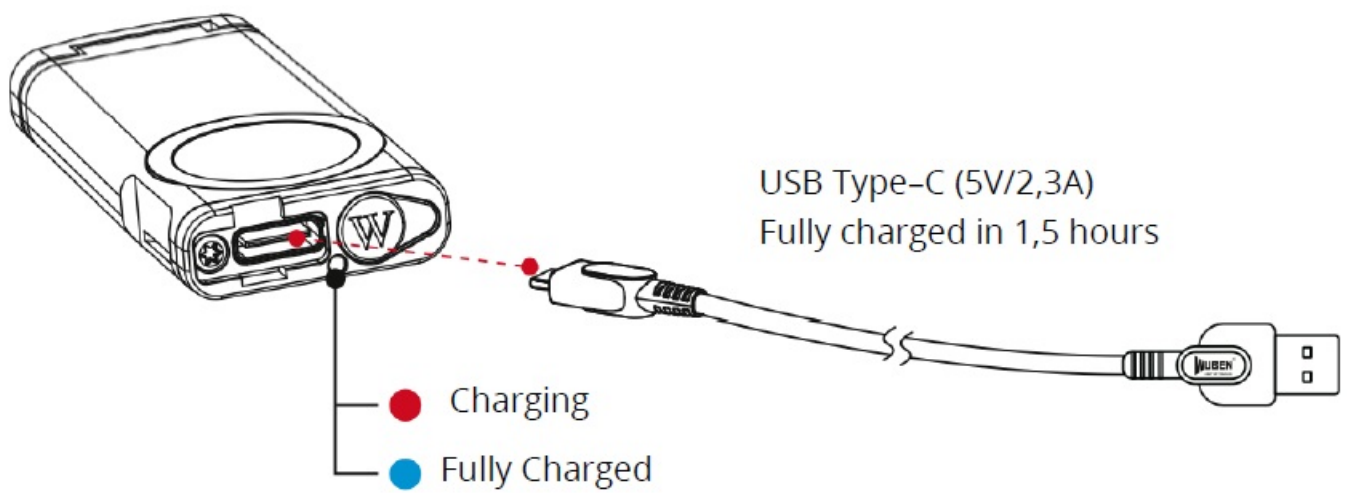

Battery Capacity Indication

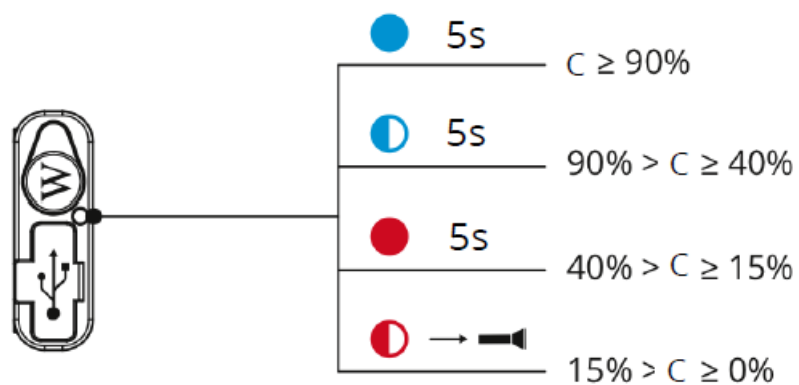

Operation Of The Flashlight

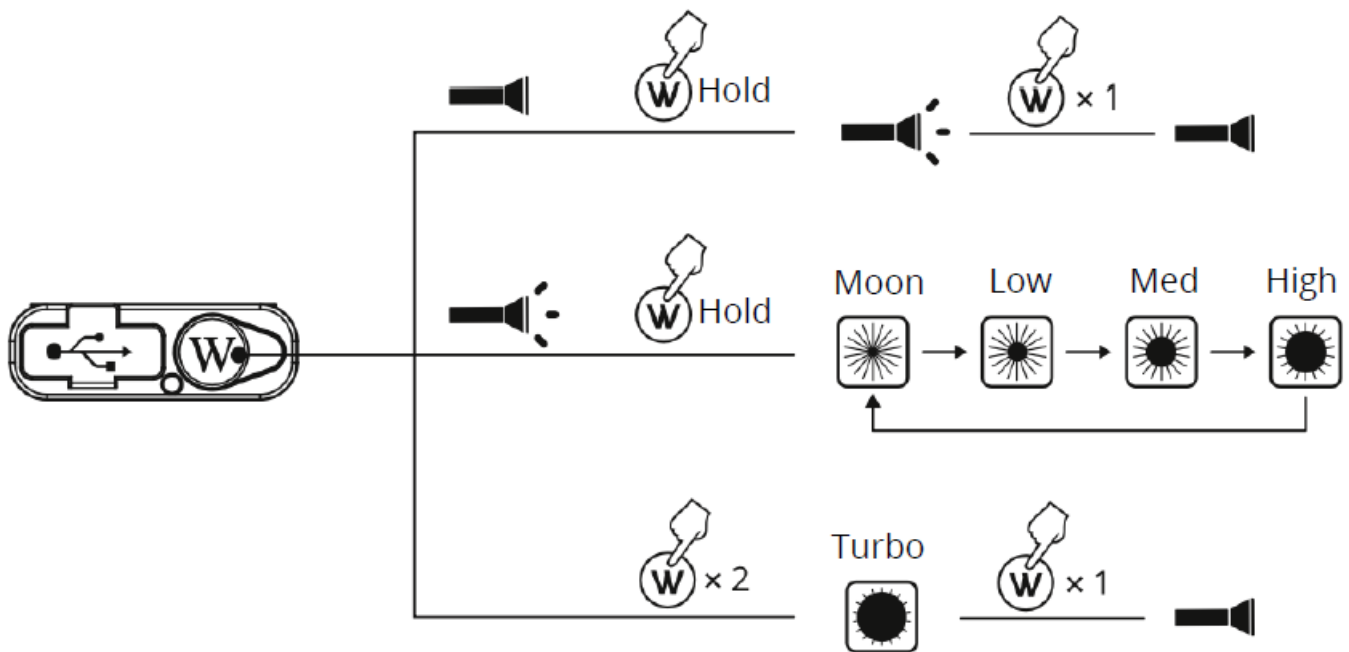

- **Power On/Off:** Press and hold the switch to turn on the light. A single click will turn it off. Please note that the light has a memory function and will remember the default output selections, except for flash modes.
- **Default Output Selections:** While the light is on, press and hold the switch to cycle through the brightness levels: Moon-Low-Med-High-Moon. Releasing the switch at any mode will lock the brightness at that level.
- **Instant Turbo:** Regardless of the current status, quickly double-click the switch to activate Turbo mode. A single click will turn off the Turbo mode, while pressing and holding the switch will switch between different brightness levels.

Specifications

Mode	Turbo	High	Medium	Low	Moon
Brightness	500 – 200 lm	200 lm	65 lm	15 lm	1 lm
Run Time	30 m	35 m	1,5 h	6 h	70 h
Distance of Beam Projection			46 m		
Intensity of Light Source			540 cd		
Light Source			Osram P9 LED		
Drop Resistance			1,5 m		
Weight		28 g With Built-in Battery			
Dimensions		58,5×27×9,2 mm			

All data presented in this information is obtained through experiments conducted by WUBEN lab in accordance with the ANSI/NEMA FL1 standard. It is important to note that the data may vary due to differences in experimental equipment, environmental conditions, or other relevant factors. The experiments were conducted using a built-in 280mAh Li-polymer battery.

Common Issues and Solutions

Issue: Abnormal Flashing or Failure to Turn On

Possible Causes

1. The switch might not be turned on correctly.
2. The assembly parts could be loose.
3. The battery might be low on power or improperly installed.
4. There could be dirt or foreign matter obstructing the conductive position.
5. The battery could be in the flashlight backwards.

Solutions

1. Double-check if the switch is correctly turned on.
2. Ensure that all assembly parts are tightened securely.
3. Try charging the battery or reinstalling it correctly.
4. Clean the conductive position thoroughly using alcohol and a cloth.

5. Remove the battery and put it in correctly.

Issue: Abnormal Noise

Possible Cause

1. There may be damage to certain parts of the flashlight.
2. There may be presence of foreign matter in the tube.

Solution

1. If any parts of the flashlight are damaged, please reach out to your local distributor for assistance.
2. Ensure to remove any foreign matter from the flashlight's tube.

Maintenance

- When the product displays a low power indication, it is advised to promptly charge or replace the battery to maintain battery longevity.
- After recharging or discharging, ensure that the rubber piece covering the USB ports is securely in place to prevent any foreign matter from entering.
- If the product will not be used for an extended period, it is recommended to charge the device once a month to prevent battery leakage or other potential issues that could impact normal product usage.
- Store the product in a dry and well-ventilated location to maintain its optimal condition.

Warranty

Warranty Conditions

A new product purchased in the Alza.cz sales network is guaranteed for 2 years. If you need repair or other services during the warranty period, contact the product seller directly, you must provide the original proof of purchase with the date of purchase. The following are considered to be a conflict with the warranty conditions, for which the claimed claim may not be recognized:

- Using the product for any purpose other than that for which the product is intended or failing to follow the instructions for maintenance, operation, and service of the product.
- Damage to the product by a natural disaster, the intervention of an unauthorized person or mechanically through the fault of the buyer (e.g., during transport, cleaning by inappropriate means, etc.).
- Natural wear and aging of consumables or components during use (such as batteries, etc.).
- Exposure to adverse external influences, such as sunlight and other radiation or electromagnetic fields, fluid intrusion, object intrusion, mains overvoltage, electrostatic discharge voltage (including lightning), faulty supply or input voltage and inappropriate polarity of this voltage, chemical processes such as used power supplies, etc.
- If anyone has made modifications, modifications, alterations to the design or adaptation to change or extend the functions of the product compared to the purchased design or use of non-original components.

EU Declaration of Conformity

This equipment is in compliance with the essential requirements and other relevant provisions of EU directives.





WEEE

This product must not be disposed of as normal household waste in accordance with the EU Directive on Waste Electrical and Electronic Equipment (WEEE – 2012/19 / EU). Instead, it shall be returned to the place of purchase or handed over to a public collection point for the recyclable waste. By ensuring this product is disposed of correctly, you will help prevent potential negative consequences for the environment and human health, which could otherwise be caused by inappropriate waste handling of this product. Contact your local authority or the nearest collection point for further details. Improper disposal of this type of waste may result in fines in accordance with national regulations.

Documents / Resources

	<p>WUBEN G2 EDC Keychain Light [pdf] User Manual G2, G2 EDC Keychain Light, EDC Keychain Light, Keychain Light, Light</p>
--	---

References

-  alza.at
-  [Alza | Alza.co.uk](https://Alza.co.uk)
-  alza.de
-  alza.hu
-  alza.sk
- [User Manual](#)