



WRIGHT VDN333BL Pull Lever Handle Set Instructions

[Home](#) » [WRIGHT](#) » WRIGHT VDN333BL Pull Lever Handle Set Instructions 

Contents

- [1 WRIGHT VDN333BL Pull Lever Handle Set](#)
- [2 Product Information](#)
- [3 Product Usage Instructions](#)
- [4 NEW INSTALLATION INSTRUCTIONS FOR PULL LATCHES](#)
- [5 REPLACEMENT INSTALLATION INSTRUCTIONS FOR PULL LATCHES](#)
- [6 Documents / Resources](#)
 - [6.1 References](#)
- [7 Related Posts](#)



WRIGHT VDN333BL Pull Lever Handle Set



Product Information

The product is a door latch mechanism that is used to secure doors. It comes with various sizes of spindles and screws to accommodate different door thicknesses. The product also includes a drill template and a strike plate for proper installation.

Product Usage Instructions

1. Determine Door Thickness

- Measure the thickness of your door using the sizing chart provided. Select the appropriate door thickness from the chart.

3. Spindle & Screw Chart

Place the spindle on the sizing chart and mark the appropriate door thickness. Cut the spindle using a wire cutter.

4. Drill Installation Holes:

- Place the drill template along the edge of the Z-bar with the door closed. Tape the template to the door and mark the holes.
- Drill the holes according to the marked positions on the template.

5. Assemble Door Latch

Follow the illustrations provided to assemble the door latch according to your specific model.

6. Install Latch Spindle / Housing

Attach the latch spindle and housing to the door using the specified screws.

7. Verify Strike

- Ensure that the strike plate is properly aligned with the latch when the door is closed. Use shims if necessary to adjust the strike plate position.

Note: If the hole pattern on your door does not match, refer to the New Installation instruction in Step 3 for further guidance. For warranty details or to make a warranty claim, please visit www.hampton.care or contact Hampton Care at 1-800-562-5625. Keep the defective product and the receipt for warranty claims.

NEW INSTALLATION INSTRUCTIONS FOR PULL LATCHES

TOOLS REQUIRED

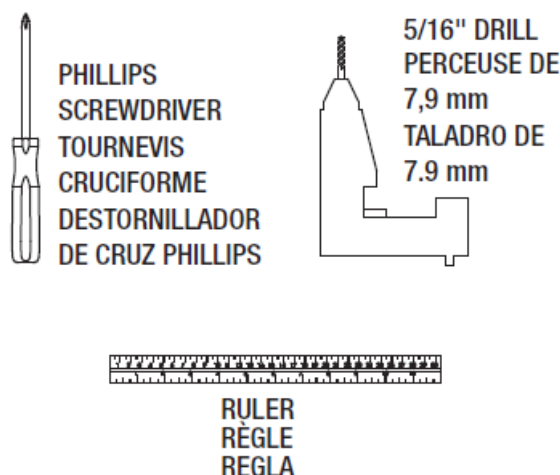

DETERMINE DOOR THICKNESS

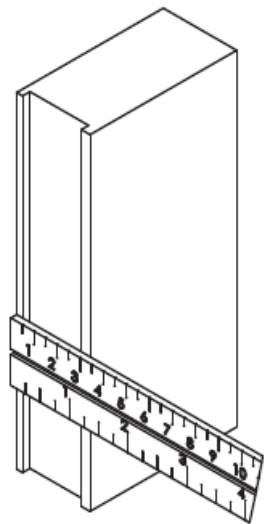

SPINDLE & SCREW CHART FOR DOOR THICKNESS

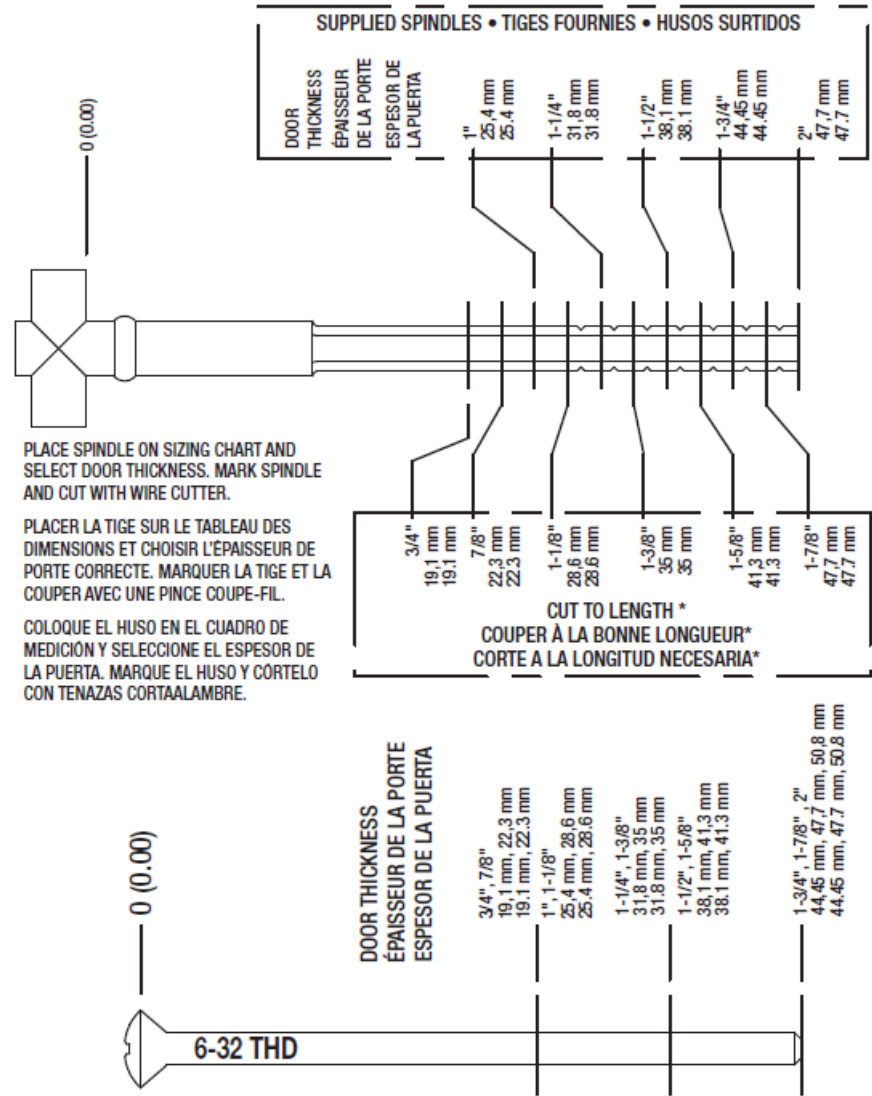

DRILL INSTALLATION HOLES

CAUTION LOCATE INSTALLATION SO THAT LATCH WILL NOT INTERFERE WITH ENTRANCE HARDWARE
ENSURE THERE IS A MINIMUM OF 3/4" BETWEEN CENTER OF HOLES AND EDGE OF DOOR

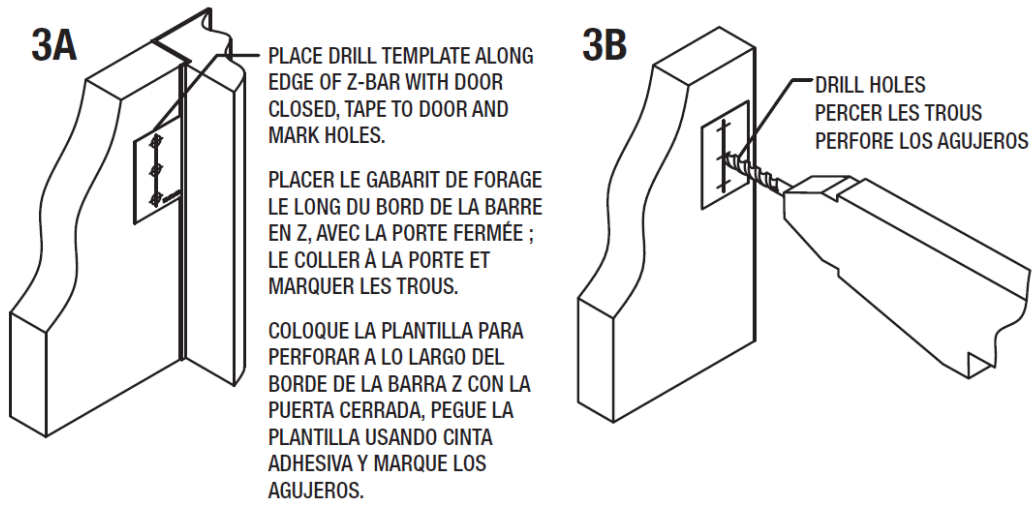

INSTALL LATCH SPINDLE / HOUSIN

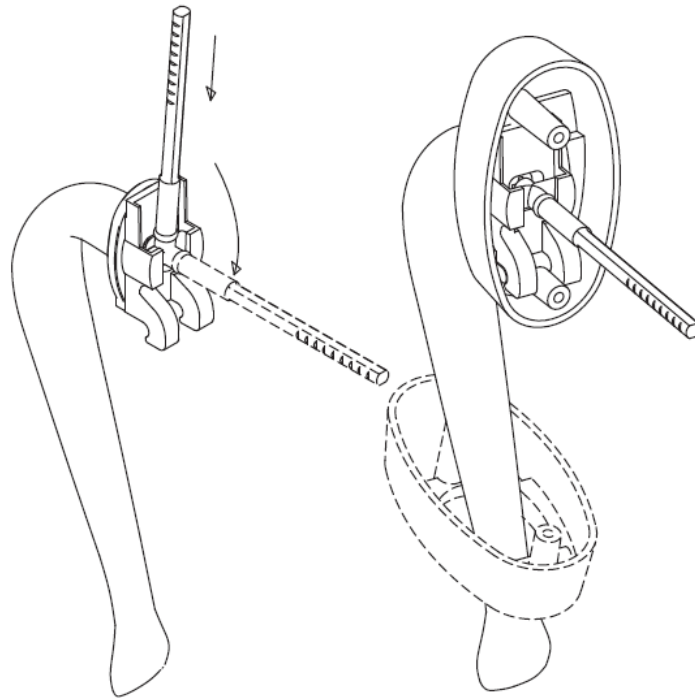

ASSEMBLE DOOR LATCH

NOTE The handle styles illustrated may vary by model.

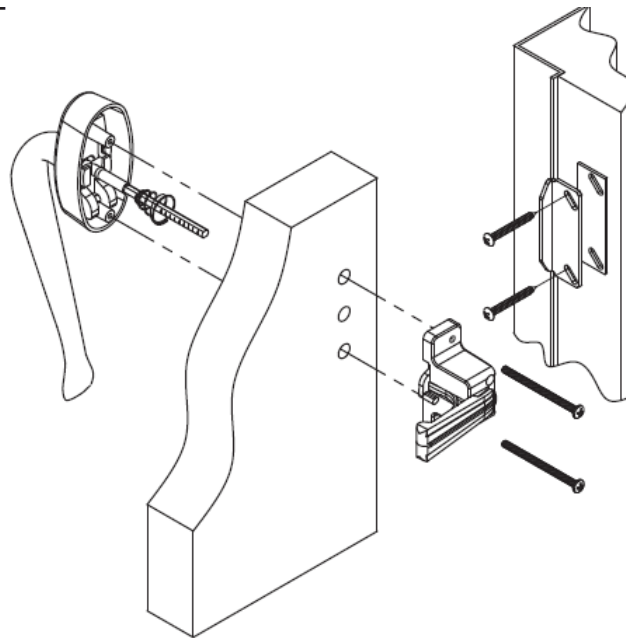

VERIFY STRIKE

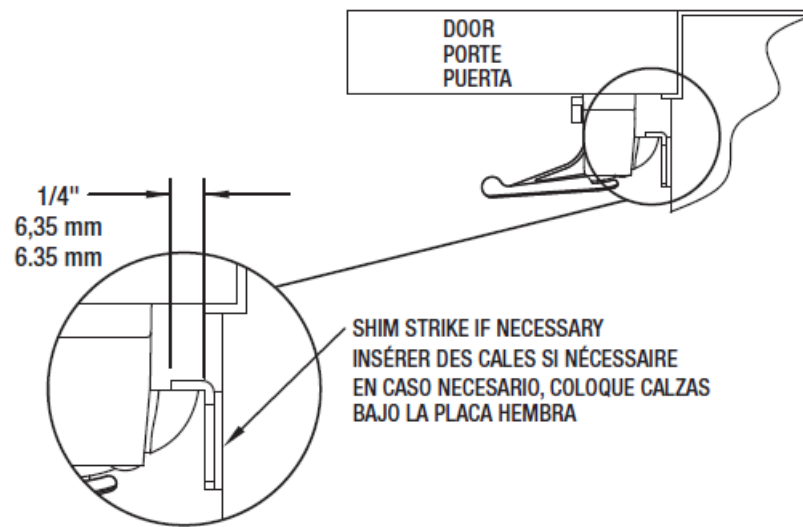

TEMPLATE **GABARIT** **PLANTILLA**

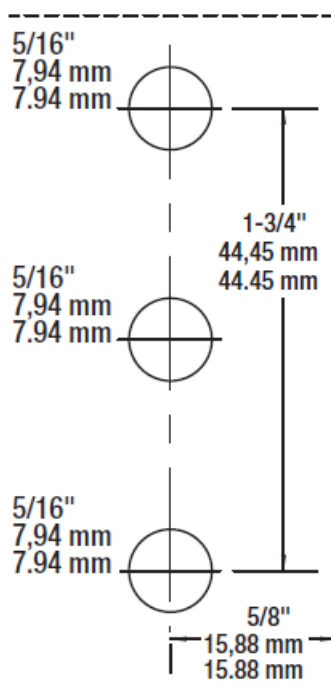

REPLACEMENT INSTALLATION INSTRUCTIONS FOR PULL LATCHES

TOOLS REQUIRED

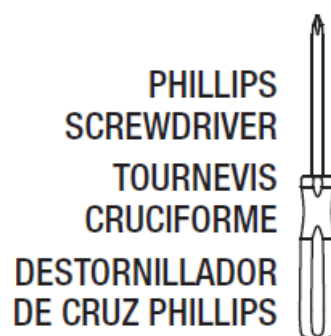

RULER
RÈGLE
REGLA

EXISTING MOUNTING HOLES IN DOOR

Note: If hole pattern does not match see “New Installation” instruction Step 3.

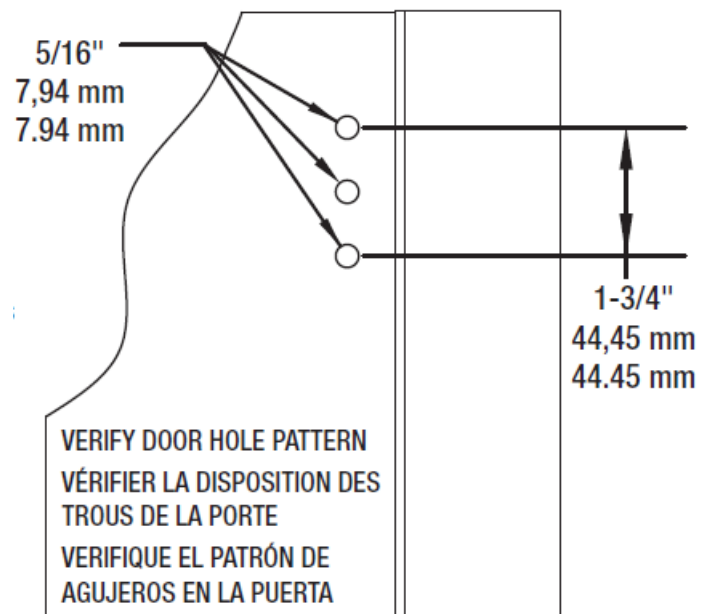

DETERMINE DOOR THICKNESS

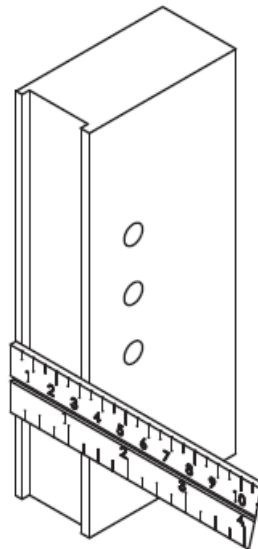

SPINDLE AND SCREW CHART FOR DOOR THICKNESS

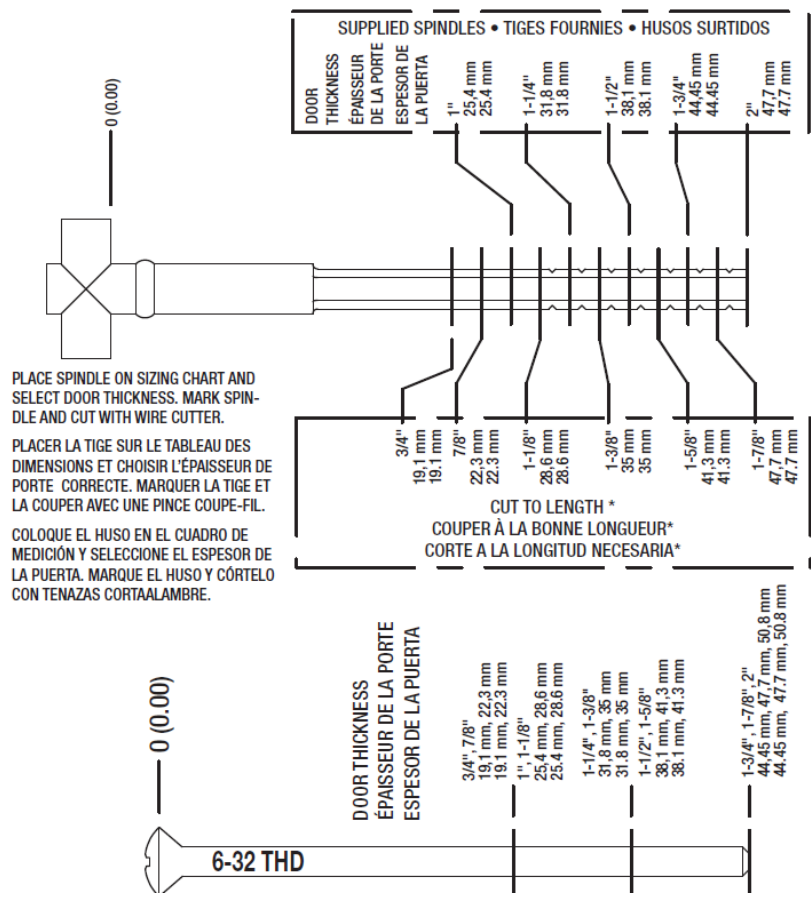

INSTALL LATCH SPINDLE / HOUSING

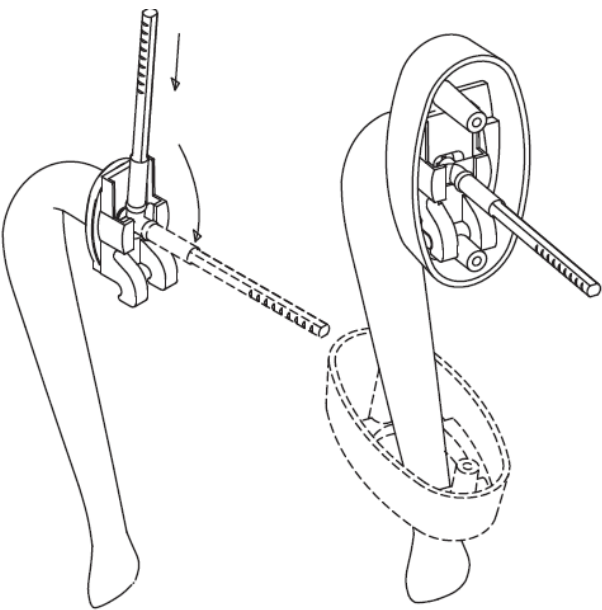

ASSEMBLE DOOR LATCH

NOTE The handle styles illustrated may vary by model

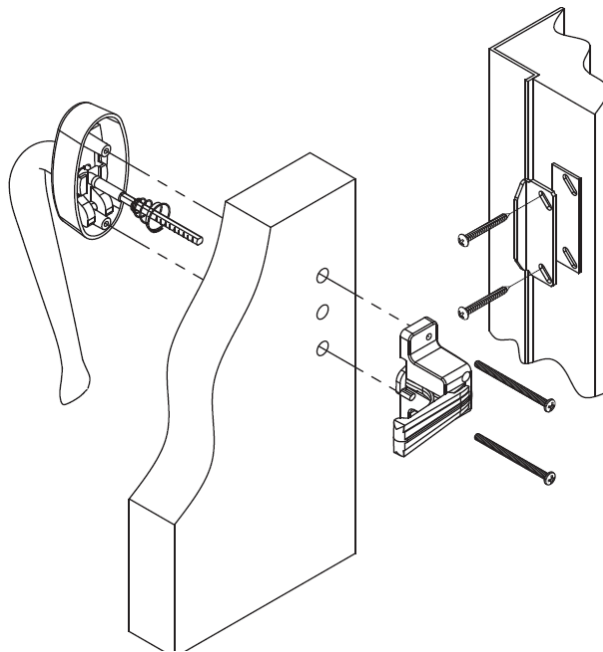

VERIFY STRIKE

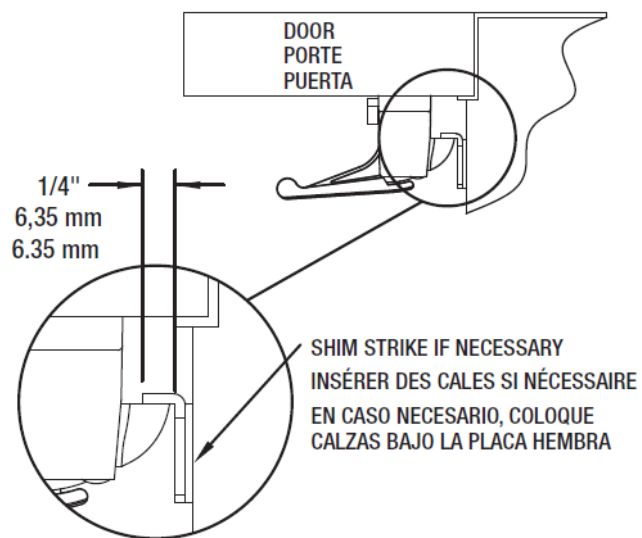

Documents / Resources



[WRIGHT VDN333BL Pull Lever Handle Set](#) [pdf] Instructions
VDN333BL Pull Lever Handle Set, VDN333BL, Pull Lever Handle Set, Lever Handle Set, Handl
e Set

References

- [Hampton Products | Home](#)