



WRIGHT V398 Push Button Latch Handle Set Instructions

[Home](#) » [WRIGHT](#) » WRIGHT V398 Push Button Latch Handle Set Instructions 

Contents

- [1 WRIGHT V398 Push Button Latch Handle Set](#)
- [2 Product Information](#)
- [3 Product Usage Instructions](#)
- [4 NEW INSTALLATION INSTRUCTIONS](#)
- [5 DETERMINE DOOR THICKNESS](#)
- [6 SCREW SELECTION CHART](#)
- [7 DRILL INSTALLATION HOLES](#)
- [8 DETERMINE SPINDLE LENGTH](#)
- [9 ASSEMBLE DOOR LATCH](#)
- [10 REPLACEMENT INSTALLATION INSTRUCTIONS](#)
- [11 Documents / Resources](#)
 - [11.1 References](#)
- [12 Related Posts](#)



WRIGHT V398 Push Button Latch Handle Set



Product Information

The product is a latch system designed for doors. It is available in different models such as V398, V398BL, V398WH, and VK398X3. The latch system includes a door latch, screws, and a spindle. The handle styles may vary depending on the model. The product comes with a full one-year warranty. For warranty details, repair, or replacement claims, customers can visit the website www.hampton.care or contact Hampton Care at 1-800-562-5625. Warranty claims may require the return of the defective product and proof of purchase.

Product Usage Instructions

1. For New Installation:
 1. Gather the required tools: Phillips screwdriver, pliers (quantity: 2), and a 5/16 drill.
 2. Align the arrow on the latch with the door face.
 3. Use the template provided to mark the hole centers on the door.
 4. Drill the installation holes, ensuring that the latch will not interfere with entrance hardware.
 5. Break off the spindle at the marked point.
 6. Assemble the door latch according to the handle style illustrated.
 7. Verify the strike on the door.
2. For Replacement Installation:
 1. Gather the required tools: Phillips screwdriver and pliers (quantity: 2).
 2. Determine the spindle length and align the arrow on the latch with the door face.
 3. Use the existing mounting holes in the door.
 4. If the hole pattern does not match, refer to the New Installation instructions in Step 4.
 5. Break off the spindle at the marked point.
 6. Assemble the door latch according to the handle style illustrated.
 7. Verify the strike on the door.

Note The product is suitable for doors with thicknesses of 3/4 inch, 1 inch, 1-1/4 inches, and 1-3/4 inches.

NEW INSTALLATION INSTRUCTIONS

FOR LATCHES – V398, V398BL, V398WH, VK398X3

TOOLS REQUIRED



RULER
RÈGLE
REGLA



PHILLIPS SCREWDRIVER
TOURNEVIS CRUCIFORME
DESATORNILLADOR DE CRUZ PHILLIPS

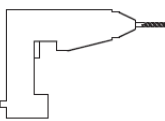

5/16" DRILL
PERCEUSE
DE 7,9 mm
TALADRO
DE 7.9 mm



PLIERS - QTY 2
2 PINCES
PINZAS – CANTIDAD 2

DETERMINE DOOR THICKNESS

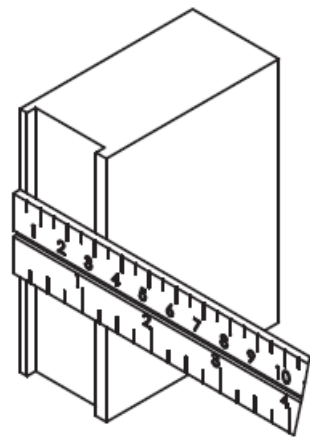

SCREW SELECTION CHART

DOOR THICKNESS	ÉPAISSEUR DE PORTE	ESPESOR DE LA PUERTA
3/4"	19,1 mm	19.1 mm
1"	25,4 mm	25.4 mm
1-1/4"	31,75 mm	31.75 mm

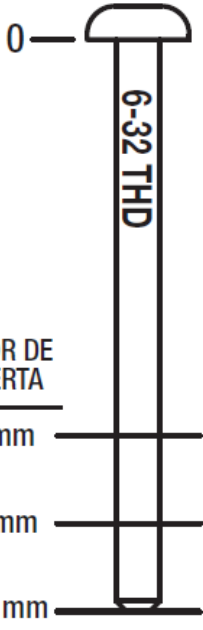

0 — 6-32 THD

DRILL INSTALLATION HOLES

CAUTION LOCATE INSTALLATION SO THAT LATCH WILL NOT INTERFERE WITH ENTRANCE HARDWARE

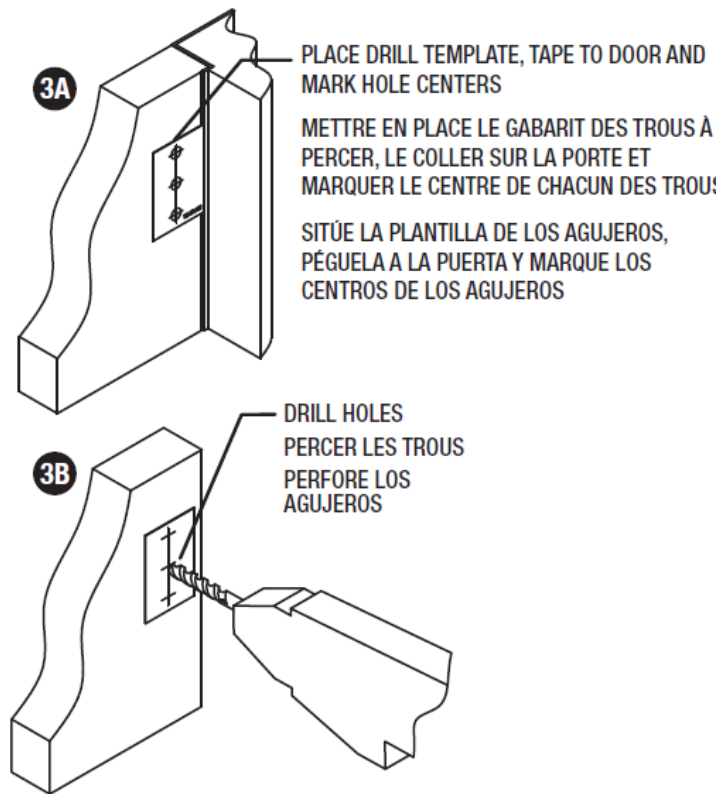

DETERMINE SPINDLE LENGTH

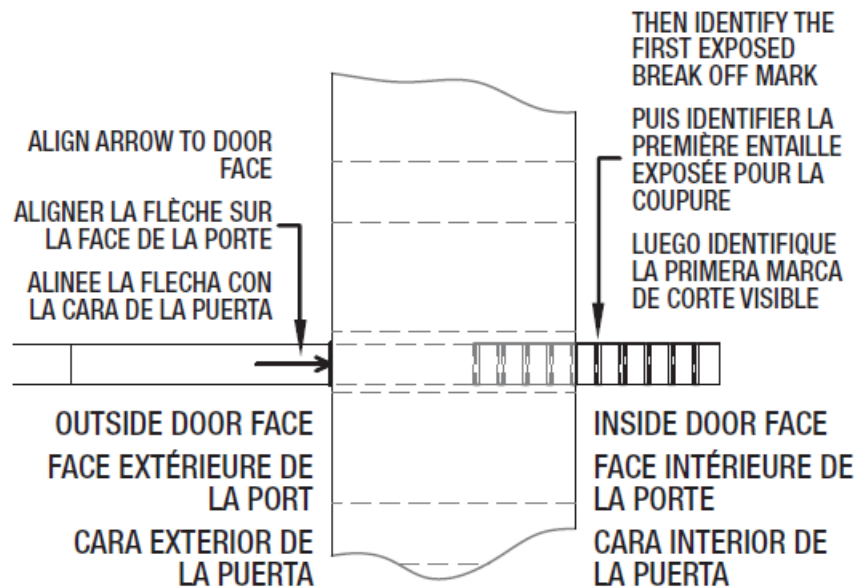

BREAK OFF SPINDLE AT MARK

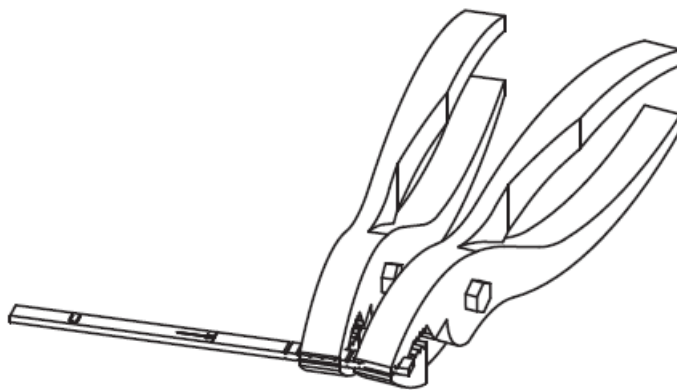

ASSEMBLE LOCK BUTTON (FOR KEYED VERSIONS ONLY)

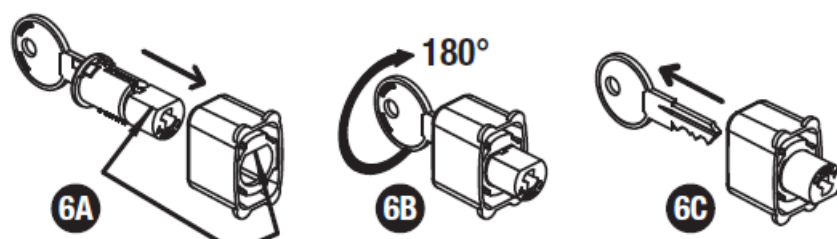

ASSEMBLE DOOR LATCH

NOTE: The handle styles illustrated may vary by model

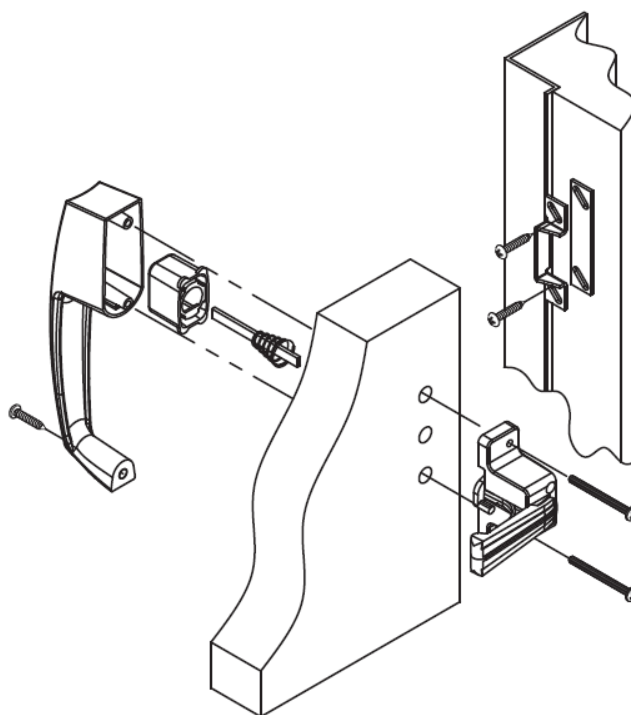

VERIFY STRIKE

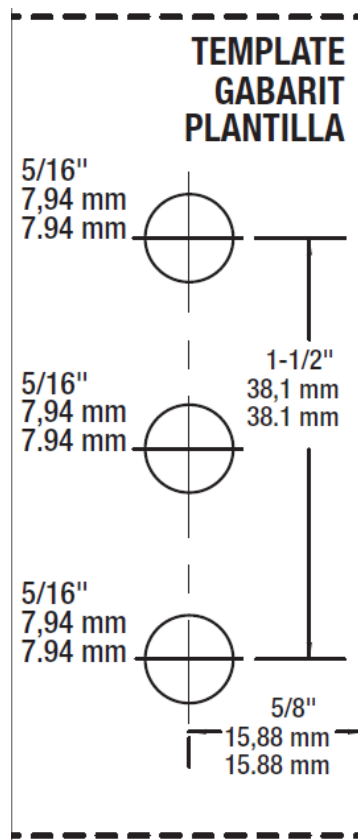
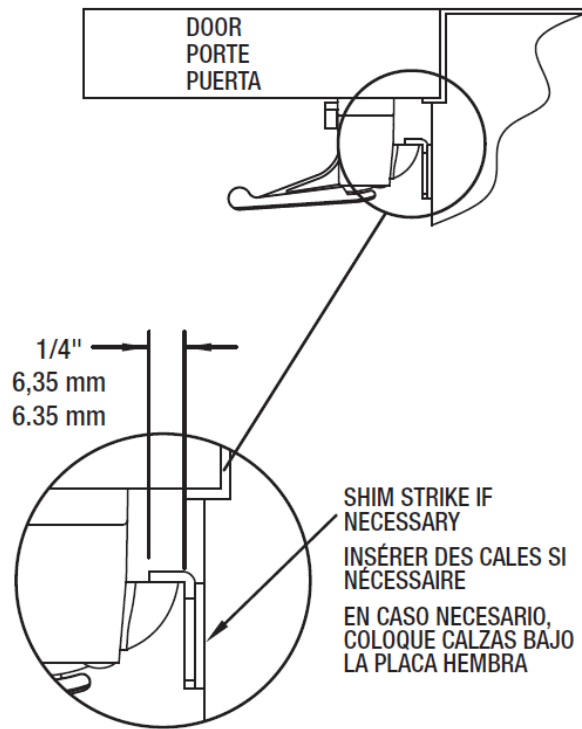

REPLACEMENT INSTALLATION INSTRUCTIONS

FOR LATCHES – V398, V398BL, V398WH, VK398X3

TOOLS REQUIRED



RULER
RÈGLE
REGLA



PHILLIPS SCREWDRIVER
TOURNEVIS CRUCIFORME
DESATORNILLADOR DE CRUZ PHILLIPS



PLIERS - QTY 2
2 PINCES
PINZAS - CANTIDAD 2

EXISTING MOUNTING HOLES IN DOOR

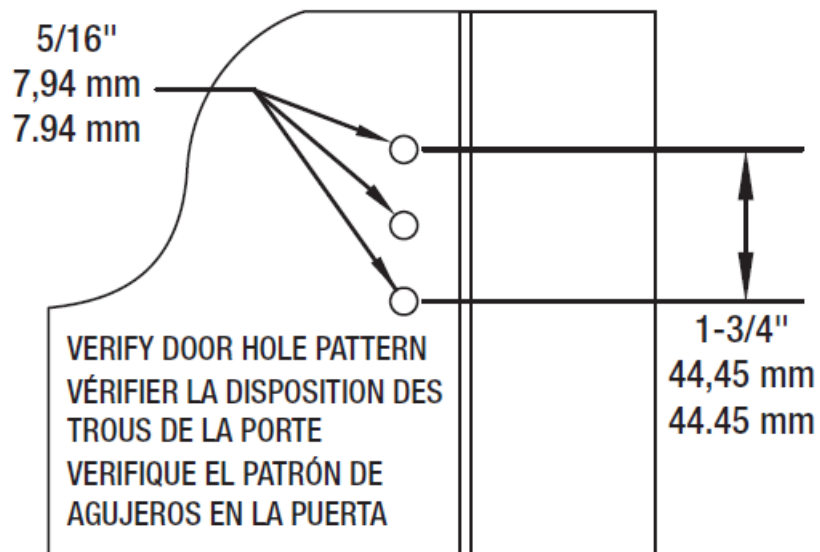

Note If hole pattern does not match see "New Installation" instruction Step 4.

DETERMINE DOOR THICKNESS

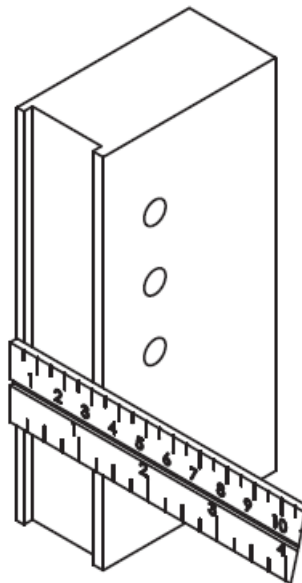

SCREW SELECTION CHAR

DOOR THICKNESS	ÉPAISSEUR DE PORTE	ESPEJOR DE LA PUERTA	
3/4"	19,1 mm	19.1 mm	
1"	25,4 mm	25.4 mm	
1-1/4"	31,75 mm	31.75 mm	

DETERMINE SPINDLE LENGTH

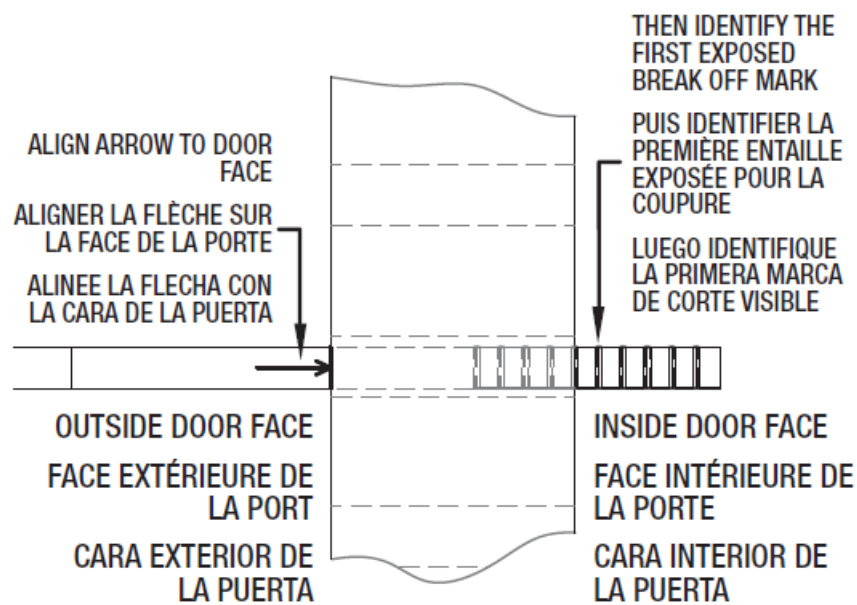

BREAK OFF SPINDLE AT MARK

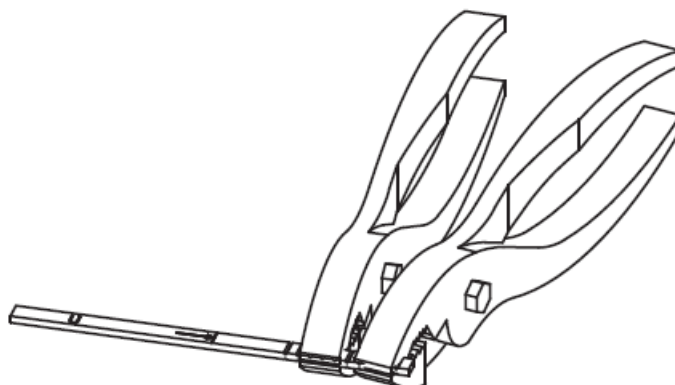

ASSEMBLE LOCK BUTTON (FOR KEYED VERSIONS ONLY)

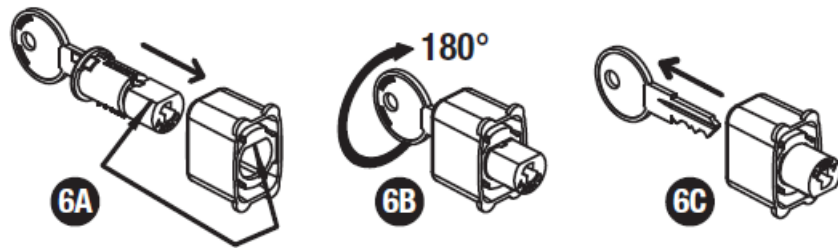

ASSEMBLE DOOR LATCH

NOTE The handle styles illustrated may vary by model

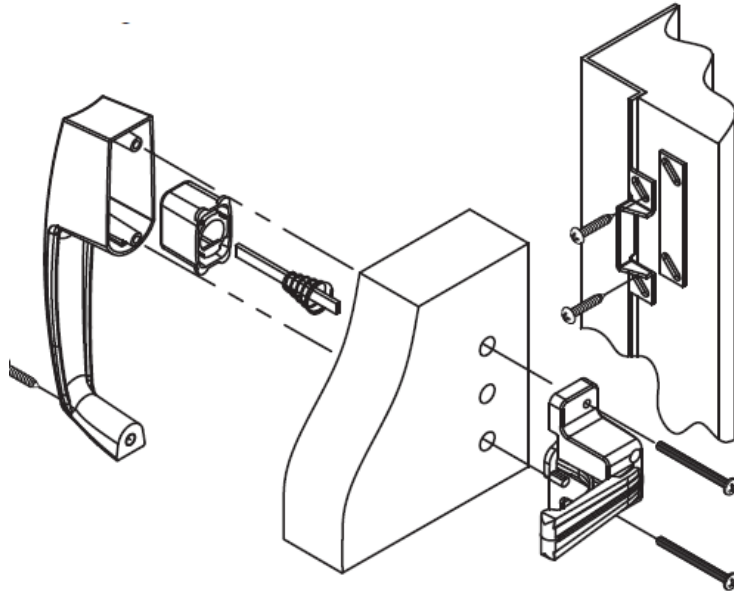

VERIFY STRIKE

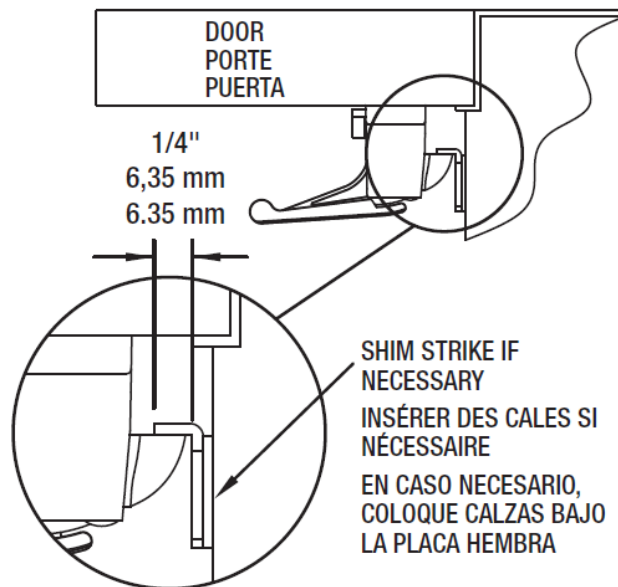

FULL ONE YEAR WARRANTY – For warranty details or to make a warranty claim for repair or replacement, please visit www.hampton.care or contact Hampton Care at 1-800-562-5625. Return of defective product and receipt may be required for warranty claims.

Documents / Resources

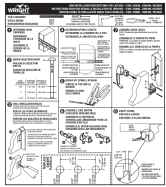

[WRIGHT V398 Push Button Latch Handle Set](#) [pdf] Instructions

V398 Push Button Latch Handle Set, V398, Push Button Latch Handle Set, Latch Handle Set, Handle Set

References

- [Hampton Products | Home](#)