

WIRELESS MULTIMODE
KEYBOARD
User Manual

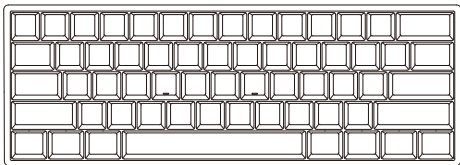

PACKING LIST

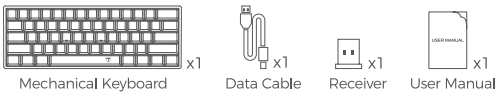

PRODUCT INSTRUCTIONS

1. CONNECTION MODES:

2.4G Wireless Mode

Toggle power switch to ON and mode switch to **2.4G**. The mode indicator light **will turn blue**. Then plug receiver into PC port, and now you can use the product as a wireless keyboard.

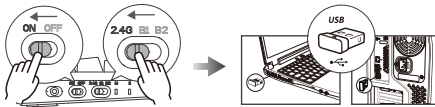

BT1 Wireless Mode

Toggle power switch to ON and mode switch to **BT1**. The mode indicator light **will turn red**.then the keyboard is in BT1 mode.

Long press **FN2+ESC** switch button for 3s and it's indicator will flash quickly showing that the keyboard enters pairing state. Turn on the Bluetooth of your laptop, if your computer system is **Win 7 or earlier**, please select to connect "**BT3.0 Keyboard**". If your computer system is **Win 8 or later**, please select to connect "**BT5.0 KB**".



- 01 -

BT2 Wireless Mode

Toggle power switch to ON and mode switch to **BT2**. The mode indicator light **will turn green**. then the keyboard is in BT2 mode. BT2 Mode can Refer to BT1 connection instructions.



Wired Mode

Connect the keyboard to your PC with the attached data cable and it will work once they're connected.

Note: Under this mode, whether your switch is toggled to ON or OFF, the keyboard will switch into wired connection.

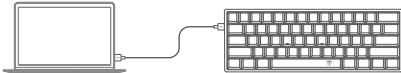

2. BACKLIGHT EFFECT

Backlight Effect Adjustment

Press FN2+"9" to switch multiple backlight modes.

Backlight Color Adjustment

Press FN2+"8" to switch backlight colors.

Light Colors in Sequence: Red, Orange, Yellow, Green, Blue, Cyan, Pink, Colorful.

Backlight Brightness Adjustment

Press FN2+"-" to decrease backlight brightness

Press FN2+"+" to increase backlight brightness (6 Brightness levels in total)

Turn Off Backlight

Press FN2+"0" to turn off backlight

- 02 -

Backlight Sleep Mode

Backlight will turn off automatically and enter into standby state if the keyboard is not operation in 1 min. Clicking any key on keyboard can wake up the keyboard and restore its backlight.

Light Customizing Function

Press FN2+BACKSPACE to enter into light customizing mode. Press FN2+BACKSPACE again to enter into the customizing state. Press a key continuously until you get the color you want. Then continue to set the light color of other keys. Press FN2+BACKSPACE to save it after you finish all settings.

3. F1 COMBINED FUNCTION

FN1+<ESC>=>'	FN1+<1>=>+>=F1-F12	FN1+ SHIFT +<ESC>=>~	FN1+<A>=>←	FN1+<[>=>HOME
FN1+<S>=>↓	FN1+<D>=>→	FN1+<W>=>↑	FN1+<P>=>PRTSC	FN1+</>=>DELETE
FN1+<J>=>END	FN1+<C>=>PCUP	FN1+<N>=>PGDN	FN1+<= >=>INSERT	

4. SOLUTION TO KEYBOARD'S 2.4G MODE CONNECTION ISSUE

1. Turn on the power switch and switch the keyboard to 2.4G mode.
2. Press FN2+ESC button for 3-5 seconds and release until the indicator of 2.4G mode flashes.
3. Plug the receiver into the computer. It is successfully connected when the indicator of 2.4G mode stops flashing. It can work then.

5. SOLUTION TO KEYBOARD'S BT1 MODE CONNECTION ISSUE

1. Clear the Bluetooth connection list of computer.
2. Turn on the power switch and switch it to BT1 mode.
3. Long press the button of FN2+ESC for over 3s and release until its indicator light flashes.

- 03 -

4. Turn on the Bluetooth of computer. If your computer system is Win 7 or earlier, please select to connect "BT3.0 Keyboard". If your computer system is Win 8 or later, please select to connect "BT5.0 KB". The keyboard's BT1 mode can work after successful connection.

6. BT2 MODE

Refer to BT1 mode solutions.

Note

"BT" is the abbreviation of Bluetooth. For example, "BT1" means "Bluetooth1" mode.

FCC STATEMENT

Any Changes or modifications not expressly approved by the party responsible for compliance could void the user's authority to operate the equipment.

This device complies with part 15 of the FCC Rules. Operation is subject to the following two conditions:

- (1) This device may not cause harmful interference, and (2) this device must accept any interference received, including interference that may cause undesired operation.

FCC Radiation Exposure Statement:

This equipment complies with FCC radiation exposure limits set forth for an uncontrolled environment.

- 04 -

CORRECT DISPOSAL OF THIS PRODUCT

(Waste Electrical & Electronic Equipment)

This Marking shown on the product or its literature, indicate that it should not be disposed with other household wastes at the end of its working life.

To prevent possible harm to the environment or human health from uncontrolled waste disposal, please separate this from other types of wastes and recycle it responsibly to promote the sustainable reuse of material resources. Household user should contact either the retailer where they purchased this product, or their local government office, for details of where and how they can take this item for environmentally safe recycling.

Business users should contact their supplier and check the terms and conditions of the purchase contact. This product should not be mixed with other commercial wastes for disposal.

- 05 -