

NEU MASTER

NTC0060-EU

CN 电动钉枪

EN Electric tacker

DE Elektrotacker

FR Agrafeuse électrique

IT Pistola sparachiodi elettrica

ES Grapadora eléctrica

PT Pistola de pregos elétrica

RU Степлер электрический

JP 電気タッカー

ID Stapler listrik

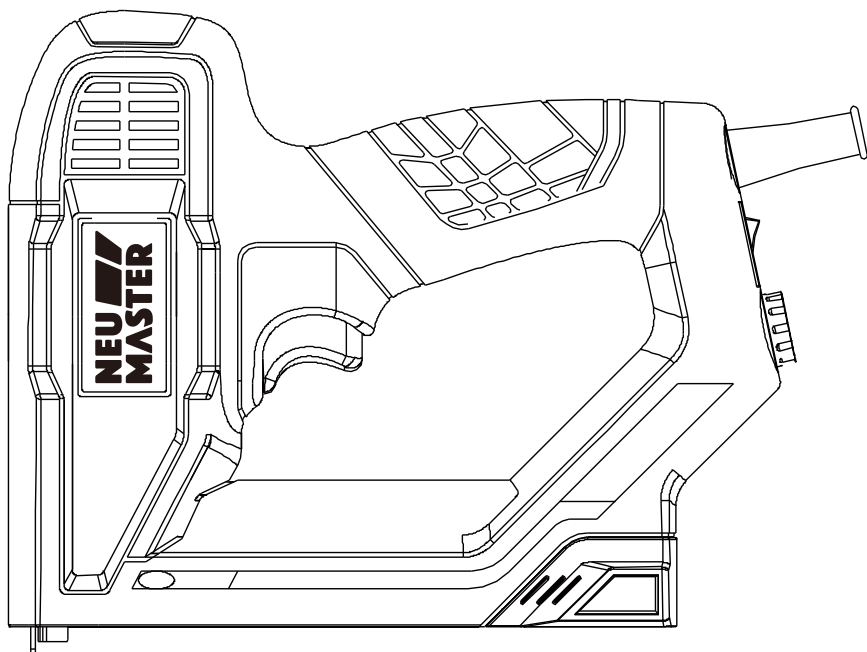

SAVE THIS INSTRUCTION MANUAL FOR FUTURE REFERENCE.

1 NTC0060-EU

220-240V~50Hz 5A

20pcs/min

staple:TYPE 53

Nail:TYPE F

1.1 kg

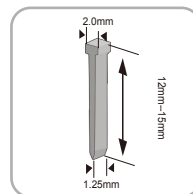
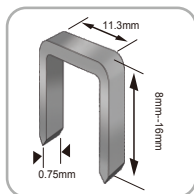

2

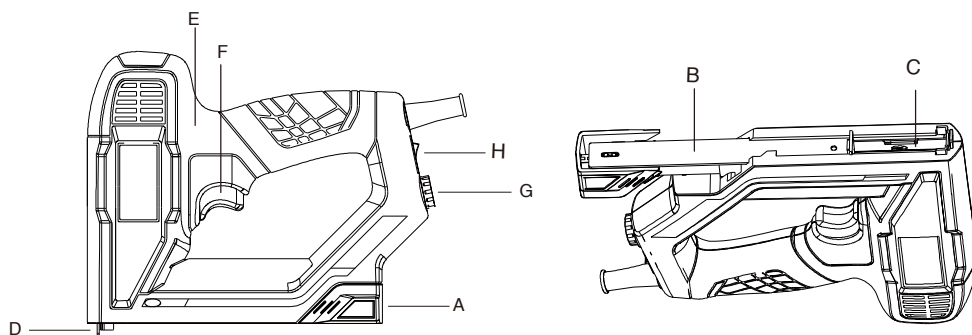

3



4

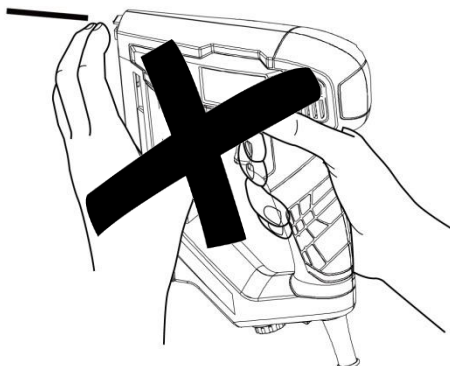

5



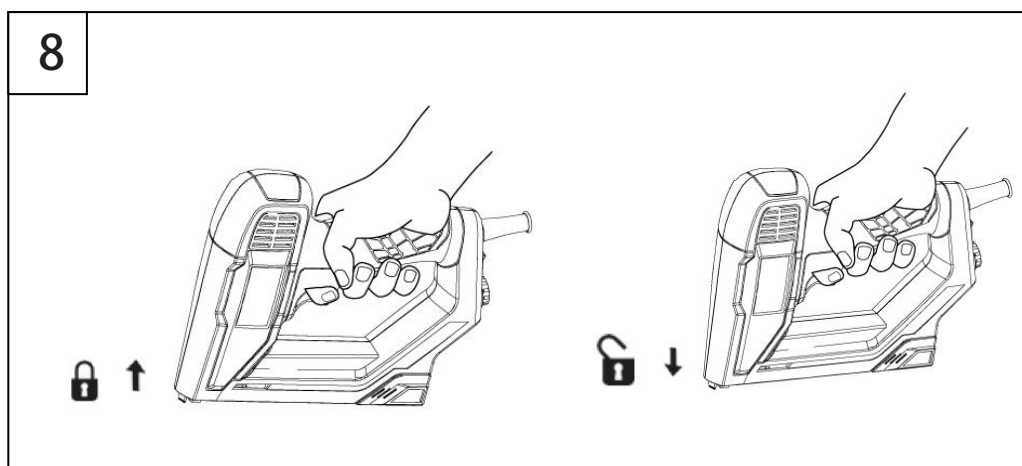
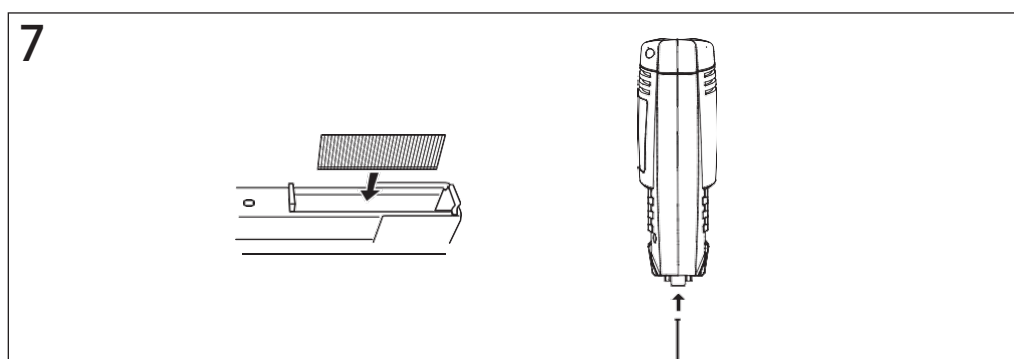
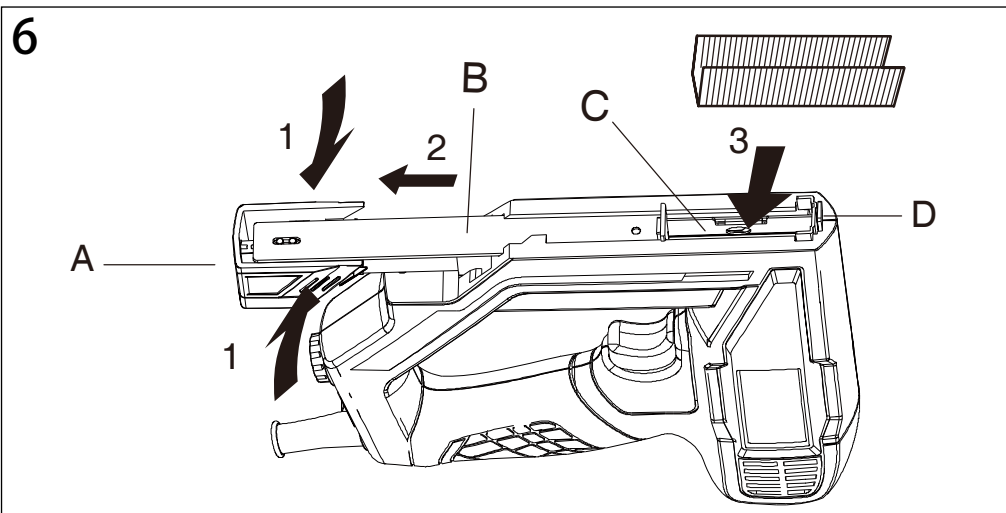

9

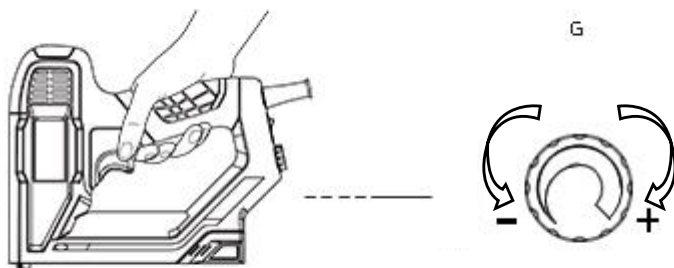

10

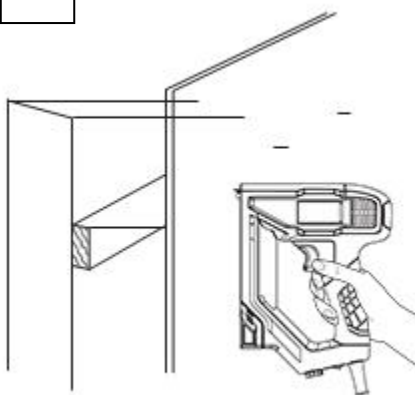

11

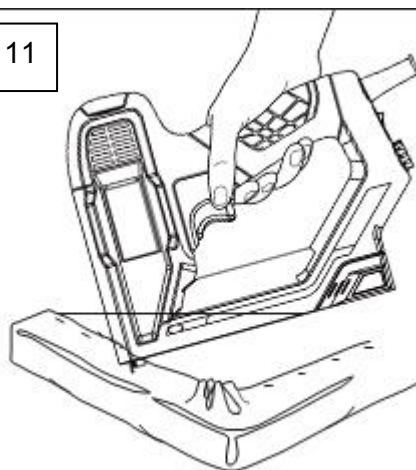

12



INTRODUCTION

- This tool is intended for stapling and nailing of cardboard, insulating material, fabrics, foils, leather and similar materials on surfaces of wood or materials similar to wood
- Read and save this instruction manual

TECHNICAL SPECIFICATIONS 1

TOOL ELEMENTS 2

- A Locker of slider
- B Slider
- C Magazine
- D Contact safety switch
- E Soft grip handle
- F Trigger
- G Impact control selection wheel
- H On/off switch

SAFETY

GENERAL SAFETY INSTRUCTIONS

WARNING! Read all instructions. Failure to follow all instructions listed below may result in electric shock, fire and/or serious injury. The term “power tool” in all of the warnings listed below refers to your mains operated (corded) power tool or battery operated (cordless) power tool.

1) WORKAREA

- a) **Keep work area clean and well lit.** Cluttered and dark areas invite accidents.
- b) **Do not operate power tools in explosive atmospheres, such as in the presence of flammable liquids, gases or dust.** Power tools create sparks which may ignite the dust or fumes.
- c) **Keep children and bystanders away while operating a power tool.** Distractions can cause you to lose control.

2) ELECTRICALSAFETY

- a) **Power tool plugs must match the outlet. Never modify the plug in any way. Do not use any adapter plugs with earthed (grounded) power tools.** Unmodified plugs and matching outlets will reduce risk of electric shock.
- b) **Avoid body contact with earthed or grounded surfaces such as pipes, radiators, ranges and refrigerators.** There is an increased risk of electric shock if your body is earthed or grounded.
- c) **Do not expose power tools to rain or wet conditions.** Water entering a power tool will increase the risk of electric shock.

- d) **Do not abuse the cord. Never use the cord for carrying, pulling or unplugging the power tool. Keep cord away from heat, oil, sharp edges or moving parts.** Damaged or entangled cords increase the risk of electric shock.

3) PERSONALSAFETY

- a) **Stay alert, watch what you are doing and use common sense when operating a power tool. Do not use a power tool while you are tired or under the influence of drugs, alcohol or medication.** A moment of inattention while operating power tools may result in serious personal injury.
- b) **Use safety equipment. Always wear eye protection.** Safety equipment such as dust mask, non-skid safety shoes, hard hat, or hearing protection used for appropriate conditions will reduce personal injuries.
- c) **Remove any adjusting key or wrench before turning the power tool on.** A wrench or a key left attached to a rotating part of the power tool may result in personal injury.
- d) **Do not overreach. Keep proper footing and balance at all times.** This enables better control of the power tool in unexpected situations.
- e) **Dress properly. Do not wear loose clothing or jewellery. Keep your hair, clothing and gloves away from moving parts.** Loose clothes, jewellery or long hair can be caught in moving parts.
- f) **If devices are provided for the connection of dust extraction and collection facilities, ensure these are connected and properly used.** Use of these devices can reduce dust related hazards.

4) POWER TOOL USE ANDCARE

- a) **Do not force the power tool. Use the correct power tool for your application.** The correct power tool will do the job better and safer at the rate for which it was designed.
- b) **Do not use the power tool if the switch does not turn it on and off.** Any power tool that cannot be controlled with the switch is dangerous and must be repaired.
- c) **Ensure the switch is in the off position before making any adjustments, changing accessories, or storing power tools.** Such preventive safety measures reduce the risk of starting the power tool accidentally.
- d) **Store idle power tools out of the reach of children and do not allow persons unfamiliar with the power tool or these instructions to operate the power tool.** Power tools are dangerous in the hands of untrained users.
- e) **Maintain power tools. Check for misalignment or binding of moving parts, breakage of parts and any other condition that may affect the power tools operation. If damaged, have the power tool repaired before use.** Many accidents are caused by poorly maintained power tools.
- f) **Keep cutting tools sharp and clean.** Properly maintained cutting tools with sharp cutting edges are less likely to bind and are easier to control.

- g) **Use the power tool, accessories and tool bits etc., in accordance with these instructions and in the manner intended for the particular type of power tool, taking into account the working conditions and the work to be performed.** Use of the power tool for operations different from those intended could result in a hazardous situation.

5) SERVICE

- a) **Have your power tool serviced by a qualified repair person using only identical replacement parts.** This will ensure that the safety of the power tool is maintained.

SAFETY INSTRUCTIONS FOR TACKERS

- **Secure the work piece**(a work piece clamped with clamping devices or in a vice is held more securely than by hand)
- **Never press contact safety switch with your hand 4.**(there is danger of injury when at the same time the trigger is activated unintentionally)
- **Never use the tool for fastening electrical wiring** (contact with electrical wires can lead to fire and electric shock)
- Avoid damage that can be caused by screws, nails and other elements in your work piece; remove them before you start working
- Always check that the supply voltage is the same as the voltage indicated on the nameplate of the tacker (tackers with a rating of 230V or 240V can also be connected to a 220Vsupply)
- In case of electrical or mechanical malfunction, immediately switch off the tool.
- PRULDE can assure flawless functioning of the tool only when original accessories are used
- This tool should not be used by people under the age of 16 years
- Do not expose tool to rain.⁵

USE

- Loading staples/nails⁶
 - turn tool up side down
 - press the both side of locker A and pull the slider backwards
 - insert the staple/nail strip into magazine C with legs facing upward (maximal capacity 84 staples/nails)
 - push slider B against tacker head until it snap- locks
 - when inserting a nail strip tilt the tool in such a way, that the nail strip rests against the magazine sidewhich corresponds with the nail symbol on tacker head⁷
- Operating the tool⁸
 - firmly press Contact safety switch D against the workpiece until it is pushed in a few millimeters
 - pull the trigger F to fire the staple, then release the trigger
 - The tool will lock as long as you do not press the contact safety switch against the workpiece surface, thus prevent accidental firing
 - At 20 shots/min, tacker should be allowed to cool down after 30 minutes continuous firing as it is only rated for short-time duty.

! remove all staples/nails from the magazine after each use

- Impact control⁹

With wheel G the required impact level can be selected in steps

 - indicator G shows the selected impact level
 - “-” for thin and light materials such as foils and fabrics
 - “+” for thick and tough materials such as hard woods and walls
 - before starting a job, find the optimal impact level by testing out on spare material

APPLICATION ADVICE

- Fastening panels¹⁰
- Do not use the tool for fastening ceiling panelling on profiled wood or grooves
- Fixing textiles¹¹
- Avoid dry fire in order to reduce the wear of the impact strike

GUARANTEE / ENVIRONMENT

- Keep tool clean
- **! unplug power cord from power source before cleaning**
- This product is guaranteed in accordance with statutory/country-specific regulations; damage due to normal wear and tear, overload or improper handling will be excluded from the guarantee
- **Do not dispose of electric tools, accessories and packaging together with household waste material** (only for EU countries)
 - in observance of European Directive 2002/96/EC on waste of electric and electronic equipment and its implementation in

accordance with national law, electric tools that have reached the end of their life must be collected separately and returned to an environmentally compatible recycling facility

- symbol¹² will remind you of this when the need for disposing occur

