



Juicing Steps



1.cut fruits into pieces less than 1 inch



2.put fruits & liquid less than $\frac{2}{3}$ bottle



3.Double-click the button to start, shake bottle for smoothie juice



4.Cover the bottle with Bottom Lid, and the juice will be ready to carry.

Flash Red

Please tighten the top cover and the main body, make sure ① and ② are aligned, otherwise the switch will **flash red**, the portable blender **won't work**.

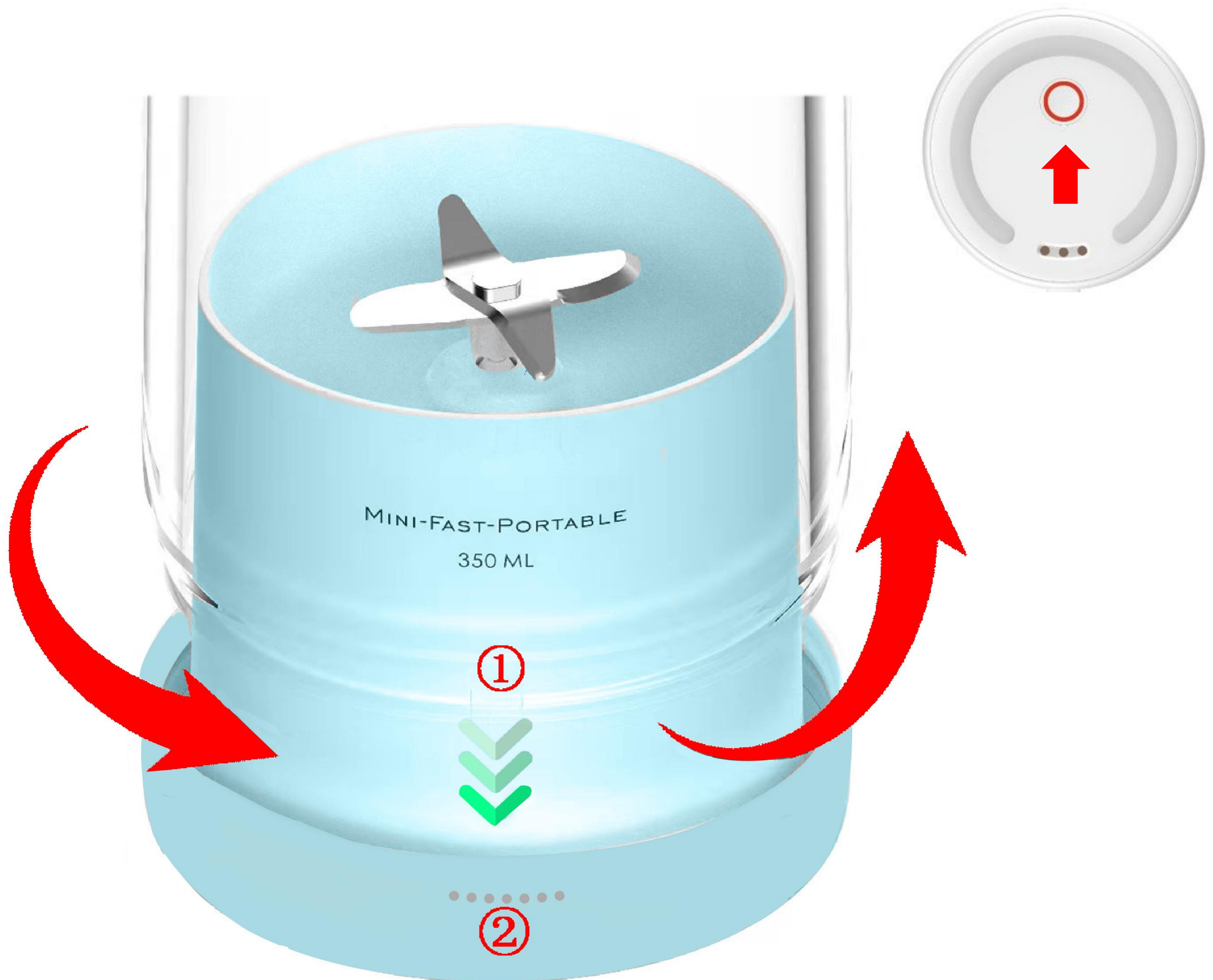

About Charging

- After receiving the machine, charge it for **3-5** hours first. Note that when charging normally, the light on the charger will light up like breathing. When fully charged, the indicator light is **always on**.



- If the light doesn't come on, the charger may be making **poor contact** with the bottle. Please see the vido of QA.

About the Battery

The built-in lithium-ion battery of the juicer has a capacity of 1400 mAh, and it can work **10** times (30 seconds each time) after being fully charged.



1400mAh \approx **10** cups



USB charging connector



Laptop



Powerbank



car charging

About Ice Cubes

Please use ice cubes that are 1cm x 1cm in size, too large to churn.



Multifunctional Blender



Fresh Juice



Baby Food



Vegetable Juice



Ice Cream



Smoothies & Milk Shake



Soy Milk



Mask Mud



Package Included



Our box contains:
1 portable blender
1 bottom cap
1 charger
1 instruction manual