

Shark

AI ULTRA™ 2-in-1 ROBOT

QUICK START GUIDE

2600WA Series

Robot Setup:

1 Set Up Base + Landing Mat

- Remove protective film from the robot and base.
- Snap together the pieces of the landing mat.
- Place the base on top of the landing mat, in a location with a strong Wi-Fi signal.

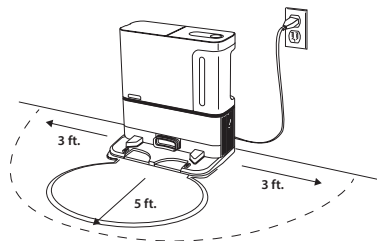

2 Attach Side Brush

- Note: Side brush design may vary.

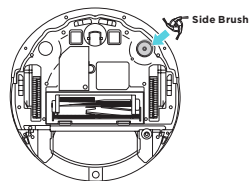

3 Place Robot on Base

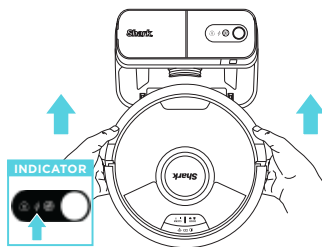

4 Scan the QR code to download the SharkClean® app.

- Complete your robot setup process in the app and learn about mopping mode.
- To get the best cleaning performance from your robot, we recommend downloading the latest version of the SharkClean® app.



App Features

- ✓ UltraClean
- ✓ Mapping
- ✓ Scheduling
- ✓ No-Go Zones
- ✓ Carpet Zones
- ✓ Spot Cleaning



Turn Page 

What's Included:

Self-Empty Base

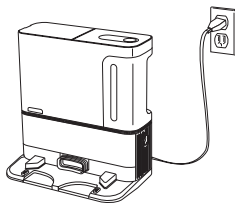

Holds 60 days' worth of debris.

Landing Mat

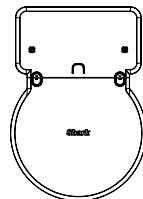

Sits under the Self-Empty Base and robot.

Self-Empty Dust Bin

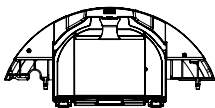

Enables Self-Empty feature for dry vacuuming.

Note: the Self-Empty Dust Bin comes pre-inserted in the robot.

VAC & MOP 2-in-1 Dust Bin

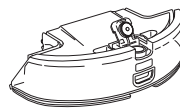

Enables mopping mode while holding dry debris from vacuuming.

Note: The VAC & MOP 2-in-1 Dust Bin will not self-empty. It will require manual cleaning after use.

Mopping Pad

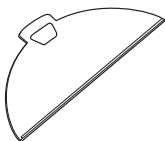

Reusable mopping pad for vacuuming and mopping mode.

VACMOP™ Bottle



2-liter refill bottles available for purchase on sharkclean.com

Two Easy Steps If You're Stuck:

1. Visit: sharkclean.com/support

- Owner's Guide
- Troubleshooting
- How-To Videos
- FAQs
- Tips & Tricks

2. For additional help, call **1-888-228-5531** for robot support.

Maximize Your Robot Experience:

Tips and tricks for getting the most out of your robot.

- To manually turn ON /OFF your robot, hold down the **DOCK** button for 6-8 seconds.
- Clear the area of cords and wires before each clean.
- Use mopping mode for daily maintenance and stuck-on messes.
- Only use Shark® VACMOP™ cleaning solution or water when mopping.
- Always place your robot on a level surface when performing maintenance.
- Clean brushroll and filter regularly.