

# COP CAM™

By The Makers Of **AtomicBeam®**

**IMPORTANT SAFETY INSTRUCTIONS, READ AND FOLLOW ALL WARNINGS AND INSTRUCTIONS BEFORE USING THIS PRODUCT. INJURY CAN RESULT FROM IMPROPER USE. SAVE THESE INSTRUCTIONS.**

## WARNING

**STORE OUT OF REACH OF CHILDREN. THIS PRODUCT IS NOT A TOY.**

## NOTICE

- Please review the state and local laws of your jurisdiction regarding using video recording devices.
- To protect the Cop Cam™ and recordings from damage:
  - Keep away from strong magnets and high voltage.
  - Clean the camera lens only with a soft cloth.
- Cop Cam™ is not waterproof, do not expose to wet or damp environments. Do not place outdoors unless protected. Do not immerse in water or other liquids.
- Do not expose to temperatures below 32°F or above 104°F.

PRODUCT MAY VARY FROM IMAGES SHOWN

## TABLE OF CONTENTS

Warnings .....	Cover
Product Components .....	1
How To Charge .....	1,2
How To Record .....	3
Night Mode .....	3
How To Retrieve Footage .....	4
Camera Swivel Clip Installation .....	5
Using Camera Wall Mount / Table Stand & Swivel Clip .....	5
Camera Wall Mount Installation .....	6
FCC Compliance .....	Back

## PRODUCT COMPONENTS

- A. Power/Record Button
- B. Indicator Light
- C. Camera Lens
- D. Night Mode Bulbs
- E. Microphone
- F. 8GB Memory Card
- G. Memory Card Port
- H. Charging Port
- I. Wall Mount/Table Stand (can be used interchangeably)
- J. Adhesive Tape
- K. Camera Clip
- L. USB Charging Cord

## HOW TO CHARGE

### BATTERY LIFE INDICATION

1. To check the battery, turn Cop Cam™ **ON** by pressing and holding the **POWER/RECORD** button for 4 seconds. (Figure A). Indicator light is solid red when fully charged. When the indicator light begins to flash red every 1 second, the battery is low.

**NOTE:** When the indicator light starts to flash red every 1 second, the battery has 10% charge remaining until plugged into a power source.

FIGURE A

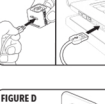

### HOW TO CHARGE

#### HOW TO CHARGE USING COMPUTER/LAPTOP

1. To charge Cop Cam™ using your computer/laptop, plug the Micro-USB connector end of the supplied USB cable into the charging port of the camera. (Figure B) Once the Micro-USB cable is plugged into the Cop Cam™, plug the other end of the cable into the USB port of your computer/laptop. (Figure C)

**NOTE:** USB port may be located either on the left or right side of your computer/laptop.

2. While the camera is charging in your computer/laptop, the indicator light will be alternately flashing red and green.

**NOTE:** If Cop Cam™ is charging in your computer/laptop, it will **ONLY** charge **NOT** record.

3. When charging is complete, the indicator light will turn **OFF**.

#### HOW TO CHARGE USING WALL OUTLET

1. To charge Cop Cam™ using a wall outlet, start by assembling the table stand following instructions on the top of page 5.

2. Once the table stand is fully assembled, plug the Micro-USB connector end of the supplied USB cable into the charging port of the camera. (Figure B)

3. With the Micro-USB cable connected, gently attach the camera to the swivel clip following the "Using Swivel Clip" instructions on the bottom of page 5. (Figure E)

4. Once the camera is successfully attached to the swivel clip (Figure F), plug the other end of the cable into a wall adapter (not provided), then plug the adapter into the wall outlet. (Figure D)

5. While the camera is charging in a wall outlet, the indicator light will flash red every 3 seconds, indicating camera is charging properly.

**NOTE:** If Cop Cam™ is charging in a wall outlet, the camera will **CHARGE** and **RECORD** at the same time.

6. When charging is complete, the indicator light will be solid red.

FIGURE B



FIGURE C



FIGURE D

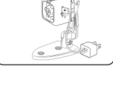

FIGURE E

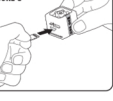
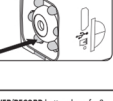

FIGURE F



## HOW TO RECORD VIDEO

1. To turn Cop Cam™ on, simply press and hold the **POWER/RECORD** button for 4 seconds. The camera will automatically start recording when on and motion is detected.

**NOTE:** LED light will illuminate solid red when on and recording. Cop Cam™ will automatically loop, always leaving space in your memory card. After 1 minute of no motion detected, Cop Cam™ will remain **ON** but will **STOP** recording.

2. Insert the memory card into the Cop Cam™ memory card port. (Figure G)

**NOTE:** Memory card is already installed in the unit. If the memory card is **NOT** installed in the unit while power is on, the indicator light will flash green 8 times and then the unit will shut off.

To turn Cop Cam™ **OFF**, simply press and hold the **POWER/RECORD** button for 4 seconds or until LED light turns off.

**Night Mode** – When Cop Cam™ is on and motion is detected, it will continue to record even in darkness. Infrared lights around the camera's lens (Figure H) will be activated but are not visibly lit.

FIGURE G

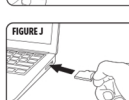
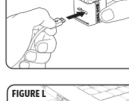

FIGURE H



## HOW TO TAKE PHOTOS

1. To switch from Video to Photo mode, simply press and hold the **POWER/RECORD** button down for 2 seconds. LED light will illuminate solid green, indicating Photo mode has been activated. To take a photo, quickly click the **POWER/RECORD** button once. The LED light will flash once after each click, indicating photo has been taken.

2. To switch back to Video mode, press and hold the **POWER/RECORD** button for 2 seconds. LED light will turn solid red, indicating Photo mode has been deactivated and camera is back in Video mode.

VIDEO FORMAT	AVI
VIDEO CODING	MJPEG
VIDEO RESOLUTION RATIO	720p
VIDEO FRAME RATE	720@30fps (default)
PLAYER	Pot Player/ Windows Player
SUPPORT SYSTEM	Microsoft Windows XP/7/8
PICTURE FORMAT	JPG

IMAGE PROPORTION	1.3M
BATTERY CAPACITY	160mAh
WORKING TIME	Up to 45 Minutes
CHARGING VOLTAGE	5v
INTERFACE TYPE	Micro USB
SAVE SUPPORT	Yes
BATTERY TYPE	Lithium Battery

## HOW TO RETRIEVE FOOTAGE

1. Start by removing the memory card from the Cop Cam™ by gently pulling the card out inward to release, then carefully pull the card out of the slot. Insert the memory card into a memory card adapter (not provided). (Figure I) Once the memory card is inserted into the adapter, plug the adapter into the memory card port of your computer/laptop. (Figure J)

**NOTE:** Memory card port may be located either on the left or right side of your computer/laptop.

2. If you do **NOT** have a memory card adapter or your computer/laptop does **NOT** have a memory card port, simply use the provided USB cable to connect Cop Cam™ to your computer/laptop. Plug the Micro-USB connector end of the USB cable into the camera. (Figure K) Once the Micro-USB cable is plugged into the camera, plug the other end of the USB cable into the USB port of your computer/laptop. (Figure L)

3. Access the footage by going to the drive associated with the Cop Cam™. Go to the DCIM folder to view the video files. You can view, save, or delete recorded videos & photos there.

FIGURE I

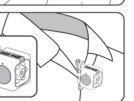

FIGURE J

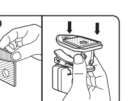

FIGURE K

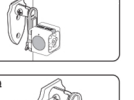
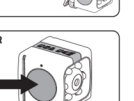

FIGURE L



5

## USING CAMERA WALL MOUNT / TABLE STAND & SWIVEL CLIP

### TABLE STAND ASSEMBLY

1. To assemble the table stand, start by holding the camera swivel clip in one hand and the table stand in the other.

2. Gently press the camera swivel clip clamp together to open. (Figure M1)

3. Insert the grooved base of the table stand into the camera clips opening and allow the grooves to align. (Figure M2)

4. Now the wall mount is fully assembled and is ready to be used as a table stand.

FIGURE M-1

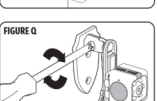
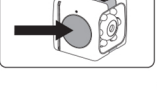

FIGURE M-2



### USING SWIVEL CLIP

1. With the unit in one hand and the camera swivel clip in the other, place the camera swivel clip on the back of the unit. (Figure N) Gently press the camera swivel clip down until the clips enter the Cop Cam™ mounting grooves, located on the left and right sides of the camera.

**NOTE:** Clips will make a slight click sound to indicate proper installation. Make sure **POWER/RECORD** button & charging port are oriented on the left and right side of the unit when in use. To remove the swivel clip, gently slide the clips either up or down out of the camera mounting grooves.

FIGURE N



### USING WALL MOUNT

1. To mount the Cop Cam™ using the mounting tape provided, first peel off a single side of the provided mounting tape and place on the back of the wall mounting. (Figure O)

2. Once the mounting tape is attached to the wall mount, simply peel the protective film off of the other side of the mounting pad and press the unit firmly onto the mounting surface. (Figure P)

**NOTE:** Wall mount can be installed either vertically or horizontally.

3. After the wall mount is installed, adjust the angle of the camera by loosening the wall mount base with a screwdriver (not provided). (Figure Q) When desired angle is achieved, make sure to tighten the wall mount base.

4. Ensure the Cop Cam™ logo is on the top of the unit with the **POWER/RECORD** button on the side. (Figure R)

5. To remove the wall mount, carefully peel off so as not to damage the wall surface.

**NOTE:** Screws and anchors are also included to install into structure. Use common building practices during installation.

FIGURE O



FIGURE P



FIGURE Q



FIGURE R



6

**Need more memory?**  
Purchase a 32GB memory card here:  
**www.CopCamMicroCard.com**

This device complies with Part 15 of the FCC Rules. Operation is subject to the following two conditions:

- (1) this device may not cause harmful interference, and
- (2) this device must accept any interference received, including interference that may cause undesired operation.

**Warning:** Changes or modifications to this unit not expressly approved by the party responsible for compliance could void the user's authority to operate the equipment.

**NOTE:** This equipment has been tested and found to comply with the limits for a Class B digital device, pursuant to Part 15 of the FCC Rules.

These limits are designed to provide reasonable protection against harmful interference in a residential installation. This equipment generates, uses and can radiate radio frequency energy and, if not installed and used in accordance with the instructions, may cause harmful interference to radio communications.

However, there is no guarantee that interference will not occur in a particular installation. If this equipment does cause harmful interference to radio or television reception, which can be determined by turning the equipment off and on, the user is encouraged to try to correct the interference by one or more of the following measures:

- Reorient or relocate the receiving antenna.
- Increase the separation between the equipment and receiver.
- Connect the equipment into an outlet on a circuit different from that to which the receiver is connected.
- Consult the dealer or an experienced radio/TV technician for help.

Manufactured for



Fairfield, NJ 07004  
©2018 BulbHead  
www.bulbhead.com

Made in China

## LIMITATION OF LIABILITY

Liability limited to the purchase price of this product. Telebrands Corp. shall not be liable for any incidental or consequential damages or any implied warranty on this product.

Some states do not allow the exclusion or limitation of incidental or consequential damages so the above limitation or exclusion may not apply to you.