



# WOZART WSCP01 Switch Controller Pro Installation Guide

[Home](#) » [WOZART](#) » Wozart WSCP01 Switch Controller Pro Installation Guide 



Installation guide  
Mozart Switch Controller Pro  
Installation Guide Version 3.0

## Contents

- [1 WSCP01 Switch Controller Pro](#)
- [2 What's in the box](#)
- [3 Description](#)
- [4 Technical Specifications](#)
- [5 Product Dimensions](#)
- [6 Precautions](#)
- [7 Setup Guide](#)
- [8 Troubleshooting](#)
- [9 Warranty and Service](#)
- [10 Documents / Resources](#)
  - [10.1 References](#)
- [11 Related Posts](#)

## WSCP01 Switch Controller Pro

### Welcome

This Guide will walk you through the installation of the Wozart Switch Controller Pro.

We hope you enjoy your purchase. We at Mozart have carefully crafted a reliable, durable, and secure Smart Home product. We promise to toil harder to build awesome devices that make life simpler and the planet more livable.

We hope our association continues and grows stronger with each passing day. You are awesome for supporting

the change we wish to bring in the way people live.

For the configuration video, scan the QR code below

 <p>For iOS devices</p>	 <p>For Andorid devices</p>
<a href="https://www.youtube.com/watch?v=Apmm6l0uc2I">https://www.youtube.com/watch?v=Apmm6l0uc2I</a>	<a href="https://www.youtube.com/watch?v=4FzByU5cs8I">https://www.youtube.com/watch?v=4FzByU5cs8I</a>

As the Mozart app is frequently updated, there may be changes to this manual.  
Please refer to [www.wozart.com/support](http://www.wozart.com/support) for the latest version of the manual.  
Download the Mozart app from the Google play store or App store.

**What’s in the box**



Wozart Switch Controller Pro

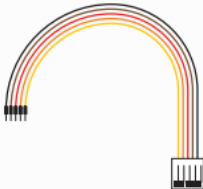

Switch connector



Warranty Card



Setup Code Sticker

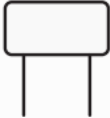

Snubber

**Description**

Mozart Switch Controller Pro is a smart device that turns electrical appliances or circuits on and off. The device can switch on or off a fan and also control speed in 4-steps without humming noise (only on L3). The device fits behind your standard wall switchboard and can be controlled either using voice commands or app interfaces on smart controller devices or through physical switches.

**Technical Specifications**

Power Supply	100-240 V ~ 50/60 Hz
Number of Loads	4
Compatible load types	Resistive, Capacitive & Inductive
Operating Temperature	0-40°C
Ambient Humidity	0- 95 % RH without condensation
Communication Protocol	Wi-Fi 2.4 GHz 802.11
Dimensions (Height*Width*Depth)	85 mm * 58 mm * 20.5 mm
Weight	116 Gms
Model	WSCP01

**Load Types**

Load Connection	Supported load types	220-240 V AC
L1	Resistive & inductive	Maximum 4.2A
L2	Resistive & inductive	Maximum 4.2A
L3	Capacitive	Maximum of 150 W
L4	Resistive & inductive	Maximum 4.2A

**Product Dimensions**

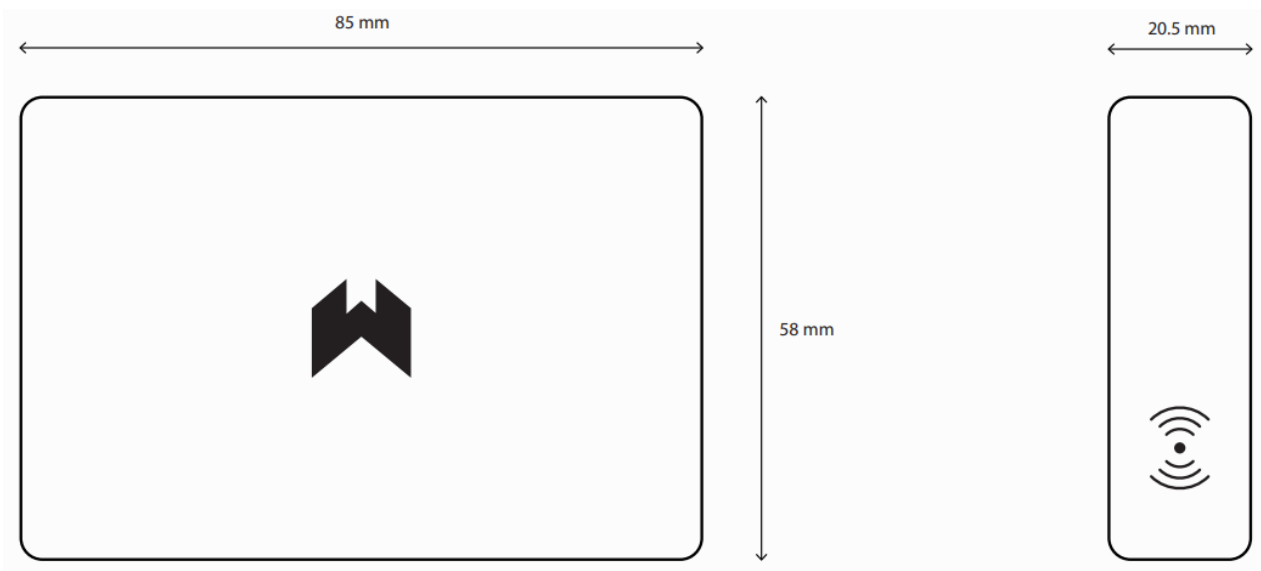

## Precautions

- Make sure that only switch connector wires (thin wires) coming out of the Mozart Switch Controller Pro are connected to manual switches.  
\*\*No electrical wires are to be connected to physical switches
- The device is designed to control electrical devices operating on AC voltage, faulty connection or use may result in fire or electric shock.
- Do not power the device before full installation and assembling it in the switchboard.
- Do not handle the device with wet or moist hands.
- Do not modify or alter the device in any way not included in this manual.
- Do not use in damp or wet locations, near the shower, swimming pool, sink, or anywhere else where water or moisture is present.
- Always use the same power source for devices and loads.
- Do not connect appliances that are not to the specification mentioned in this document.
- If you do not have basic electrical wiring knowledge, please get the help of an electrician or contact us.

## Setup Guide

N Terminal for Neutral Wire  
 P Terminal for Live Wire  
 Switch Connector slot  
 Terminal for 1  
 L1 Terminal for 2st appliance  
 L2 Terminal for 2nd appliance  
 L3 Terminal for Fan  
 L4 Terminal for 4th appliance

### Load connections

#### Switch off the main power supply

- Connect the neutral wire behind the switchboard to terminal N of the Mozart Switch Controller Pro.
- Connect live wire behind the switchboard to terminal P of the Mozart Switch Controller Pro.
- Connect appliances or lights as loads to terminals L1, L2, and L4.

- Connect Fan to terminal L3.

## Switch connections

- Plug the switch connector provided in the box to the switch socket of the Mozart Switch Controller Pro.

## Switch connections

- Following are the colors of the wires that have to be connected to the physical switches and the respective loads they control.

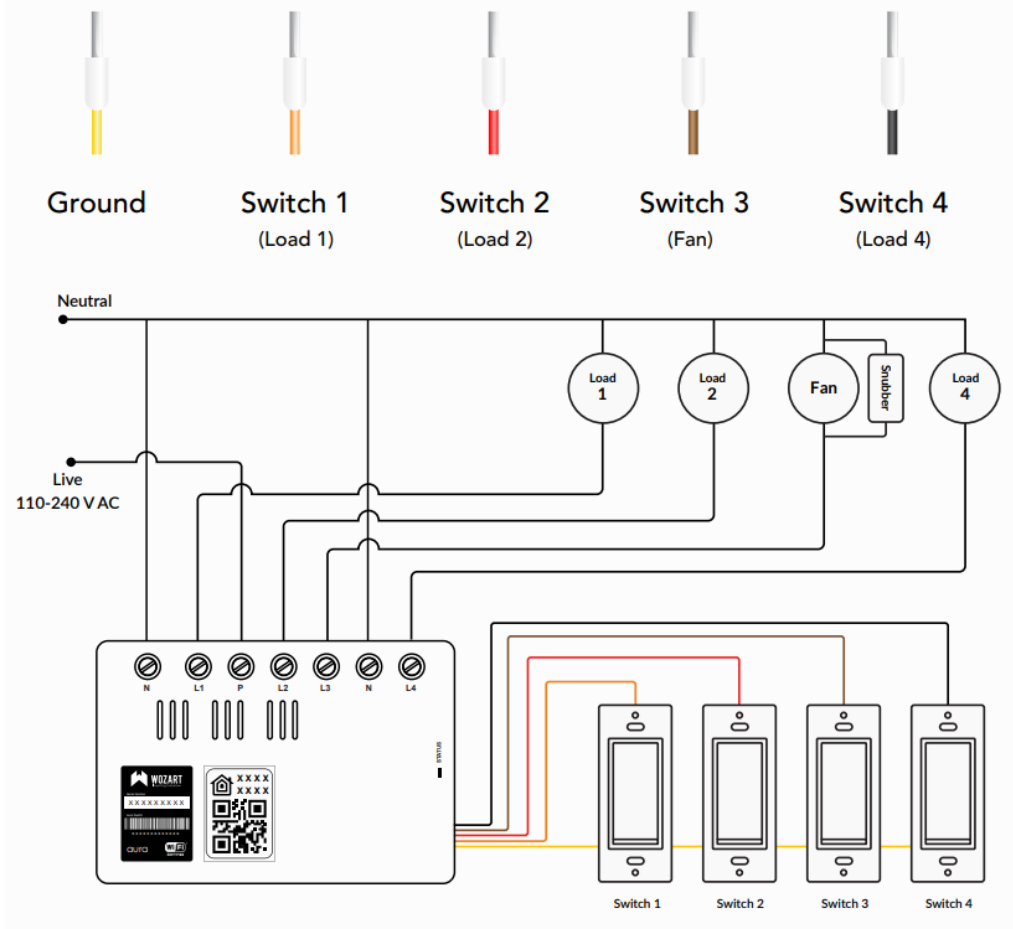

- Connect snubber to Fan as shown in the fig.
- Verify the connections and assemble the device inside the switchboard.
- Turn on the main power supply to the device and proceed with configuration on the app.

## Troubleshooting

### The device isn't responding

- Check if the Wi-Fi router is functioning properly.
- Reconnect your smart controller device eg: Phone to the Wi-Fi network to which Mozart device is connected.
- Switch off the main power supply of the room that has the device for 5 seconds and then switch it back ON.
- Do a factory reset as explained below and reconnect the device.

### Normal Reset

Switch off the main power supply of the room that has the Wozart device to be reset or toggle switch connected to slot L1 eight times.

## Factory Reset

Toggle the switch connected to slot L2 of the switch connector eight times continuously then you hear a buzzing sound.

Note: If a factory reset is done all your customization is lost. Do it only if required.

## Not able to scan the QR sticker as it is damaged.

Use the Spare QR Sticker provided in the Wozart Switch Controller Pro box or enter the code manually.

## Warranty and Service

This Mozart Product can be replaced in full for three years from the date of purchase in case of damage or malfunction due to manufacturing defects. This Warranty does not cover cosmetic damage or damage from accident, neglect, misuse, alteration or abnormal conditions of operation or handling. Mozart Technologies or any of its licensors are not liable for any special, incidental, consequential or indirect damages or losses arising from any cause. Resellers are not authorized to extend any other warranty on Wozart's behalf.

Service for all Wozart products will be provided for the device's lifetime. To obtain service, contact the nearest authorized Wozart reseller or Wozart Technologies Private Limited.

**Thank You**  
**Mozart Technologies Private Limited**

## Documents / Resources

	<a href="#">WOZART WSCP01 Switch Controller Pro</a> [pdf] Installation Guide WSCP01, Switch Controller Pro, WSCP01 Switch Controller Pro, Controller Pro
--	---

## References

-  [Support](#) | [Smart Home Gadgets India](#) | [Wozart Technologies](#)