



WOUD 120423 Array Low Sideboard Instruction Manual

[Home](#) » [WOUD](#) » WOUD 120423 Array Low Sideboard Instruction Manual 

Contents

- [1 WOUD 120423 Array Low Sideboard](#)
- [2 ASSEMBLY INSTRUCTION](#)
- [3 TOOLS NEEDED](#)
- [4 SAFETY INSTRUCTIONS](#)
- [5 ADJUSTMENT INSTRUCTIONS](#)
- [6 Documents / Resources](#)
- [7 Related Posts](#)

ARRAY

WOUD 120423 Array Low Sideboard



ARRAY IS INSPIRED BY THE WOODEN SLATE
CLADDING FOUND IN MODERN ARCHITECTURE.
WITH ITS GEOMETRIC SHAPE AND HORIZONTAL
SLATES, ARRAY CREATES A STRONG VISUAL
DEPTH EFFECT FROM CATCHING BOTH LIGHT AND
SHADOW. THE ILLUSION OF TRANSPARENCY IS
INTENDED TO CREATE A FEELING OF GROWING
CURIOSITY AS YOU GET A GLIMPSE OF WHAT IS
HIDDEN BEHIND THE CLOSED DOORS. THE SLEEK
LEGS LIFT THE SIDEBOARD FROM THE GROUND
CREATING AN ELEGANT CONTRAST BETWEEN
THE SOLID WOODEN CABINET ON TOP AND THE
THIN METAL CONSTRUCTION UNDERNEATH. THE
ARRAY SERIES IS GRAPHICAL AND MODERN IN
ITS EXPRESSION WITH A MYSTERIOUS SHELL TO
CONTAIN YOUR PERSONAL ITEMS.

Kasper & Nikolaj
SAYS WHO

WE HAVE NOW HANDED OVER ONE OF OUR DARLINGS TO YOU .

NOW IT IS YOURS. TAKE GOOD CARE OF IT. YOU CAN READ THE CARE INSTRUCTIONS FOR ALL OUR
MATERIALS AT OUR WEBSITE.

WOUD.DK/TAKECARE

ASSEMBLY INSTRUCTION

PLEASE GO THROUGH THE FOLLOWING STEPS CAREFULLY. RETAIN THIS MANUAL FOR FUTURE
REFERENCE TO ENSURE THAT YOUR NEW ITEM IS CORRECTLY ASSEMBLED IN CASE IT SHOULD BE
DISASSEMBLED OR MOVED. WE ARE NOT RESPONSIBLE FOR ANY FAULTS OR DAMAGES CAUSED BY
NOT FOLLOWING THESE INSTRUCTIONS CORRECTLY.

FRAME

A X 1

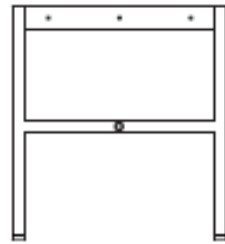

B X 2



C X 1



D X 6



E X 2



F X 1

G X 1



H X 2



I X 2

WALL

A X 1

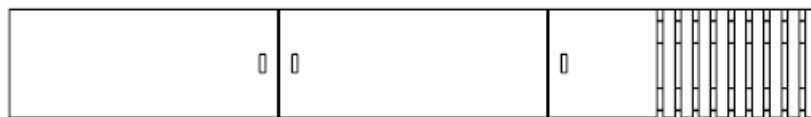

J X 2



K X 4



L X 4

TOOLS NEEDED

IMPORTANT (NOT INCLUDED)!

USE WALL PLUGS AND DRILLS SUITABLE FOR YOUR WALL. BE CAREFUL WITH THIN/PLASTER/DRY WALLS AND SOLID CONCRETE WALLS. IN CASE OF DOUBT, WE RECOMMEND THAT YOU ASK A PROFESSIONAL.

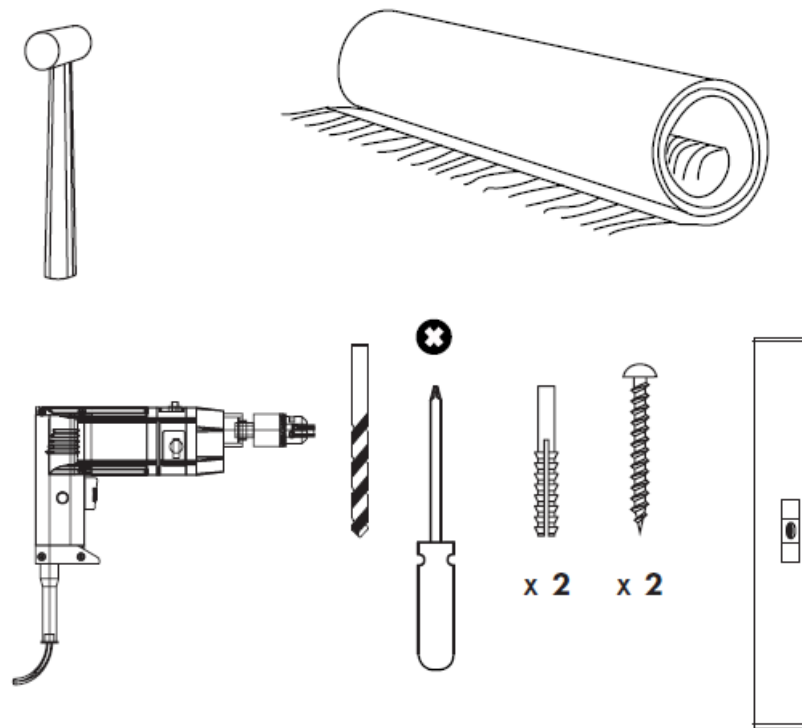

FRAME

STEP 1

MOUNT THE LEGS ON THE METAL FRAME UNDER THE WOODEN CABINET

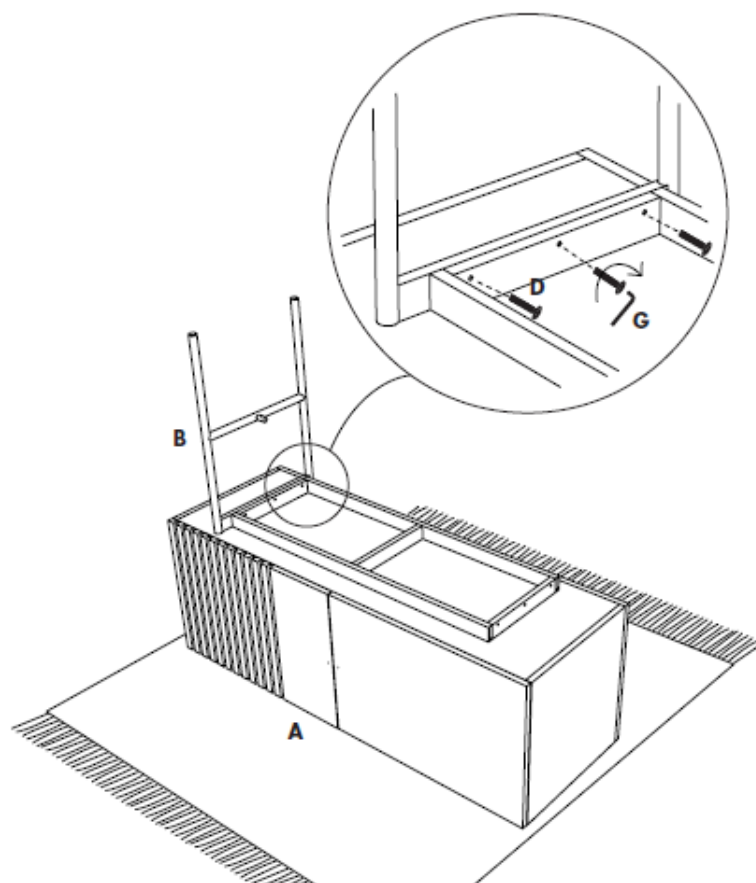

STEP 2

MOUNT THE METAL CROSSBAR ONTO THE LEG

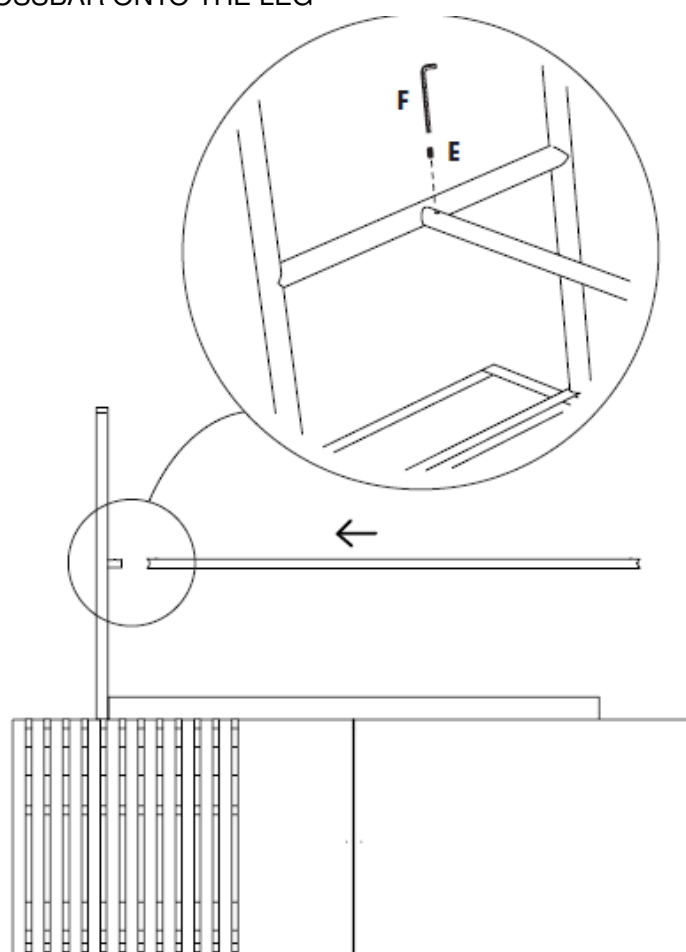

STEP 3

MOUNT THE SECOND LEG ON THE METAL FRAME AND CROSSBAR

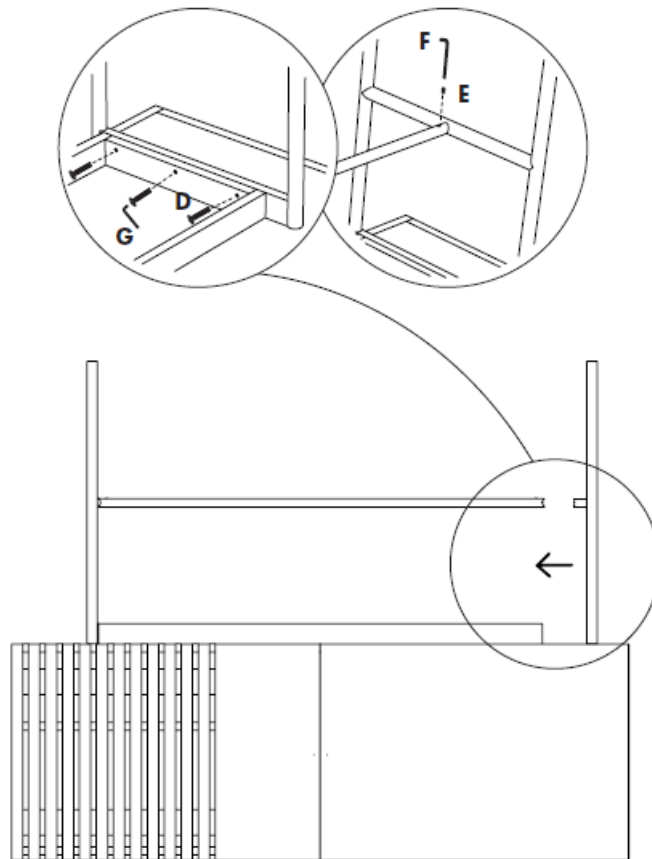

STEP 4

ADJUST THE FEET TO LEVEL THE CABINET.

SEE THE LAST PAGES FOR MOUNTING THE HANDLES AND ADJUSTING THE DOORS

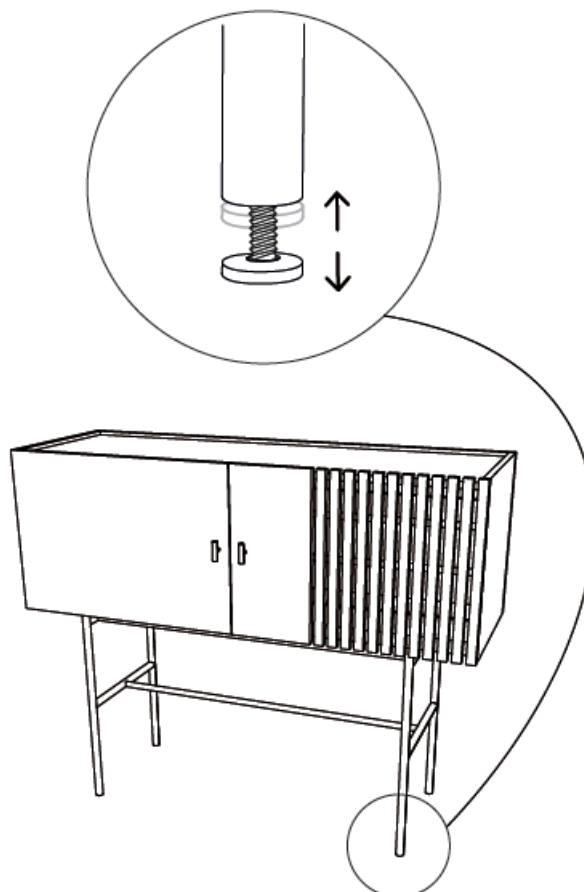

SAFETY INSTRUCTIONS

TO PREVENT THIS FURNITURE FROM TIPPING OVER RESULTING IN SERIOUS OR FATAL INJURIES, IT MUST BE PERMANENTLY FIXED TO THE WALL

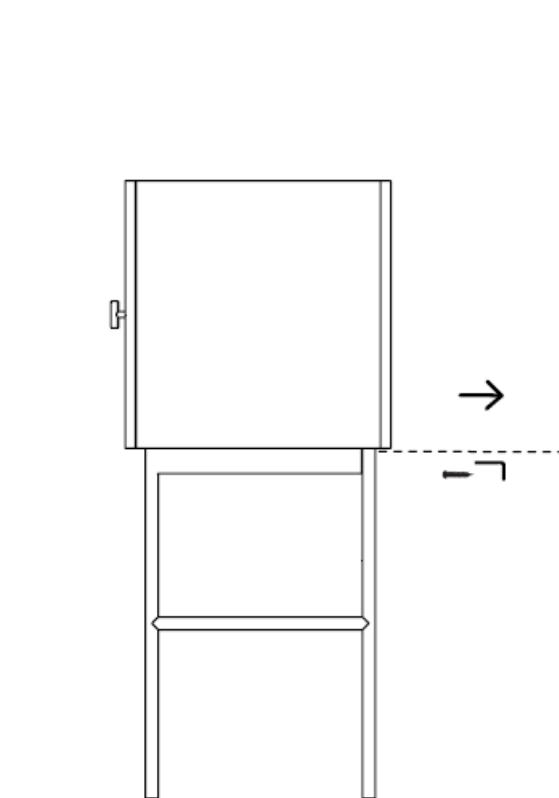

MEASURE THE HEIGHT AND DRILL HOLES IN THE WALL. APPLY SUITABLE WALL PLUGS. MOUNT THE METAL BRACKET TO THE WALL WITH SCREWS AND THEN MOUNT THE BRACKET TO THE CABINET.

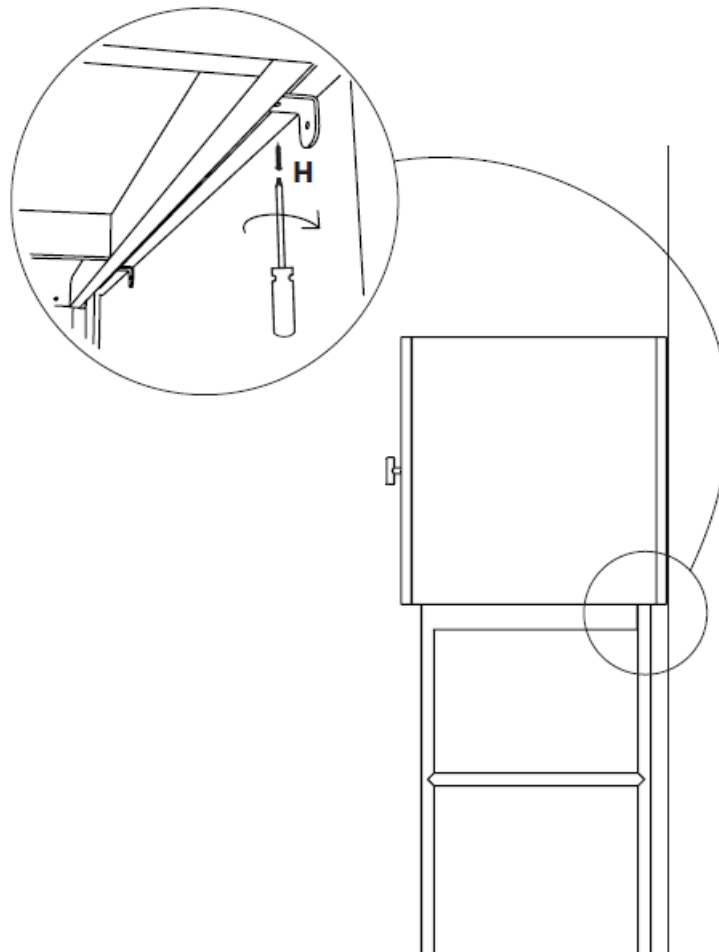

WALL

STEP 1

LEVEL, MARK (DISTAINCE 94 CM), DRILL AND USE SUITABLE WALL PLUGS AND THE SCREWS.

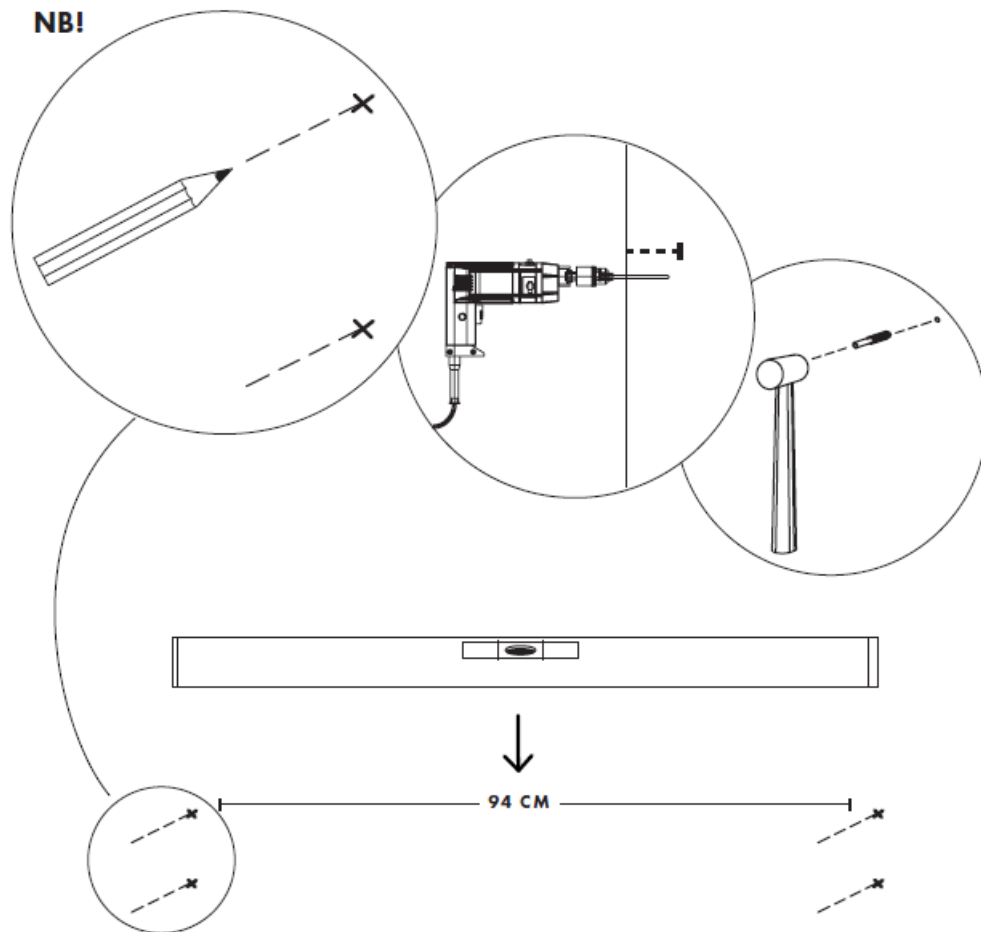

STEP 2

PLACE THE METAL WALL BRACKETS AND SCREW THEM ON TO THE WALL.

TWO PEOPLE IS NEED TO PLACE THE CABINET ON THE BRACKETS.

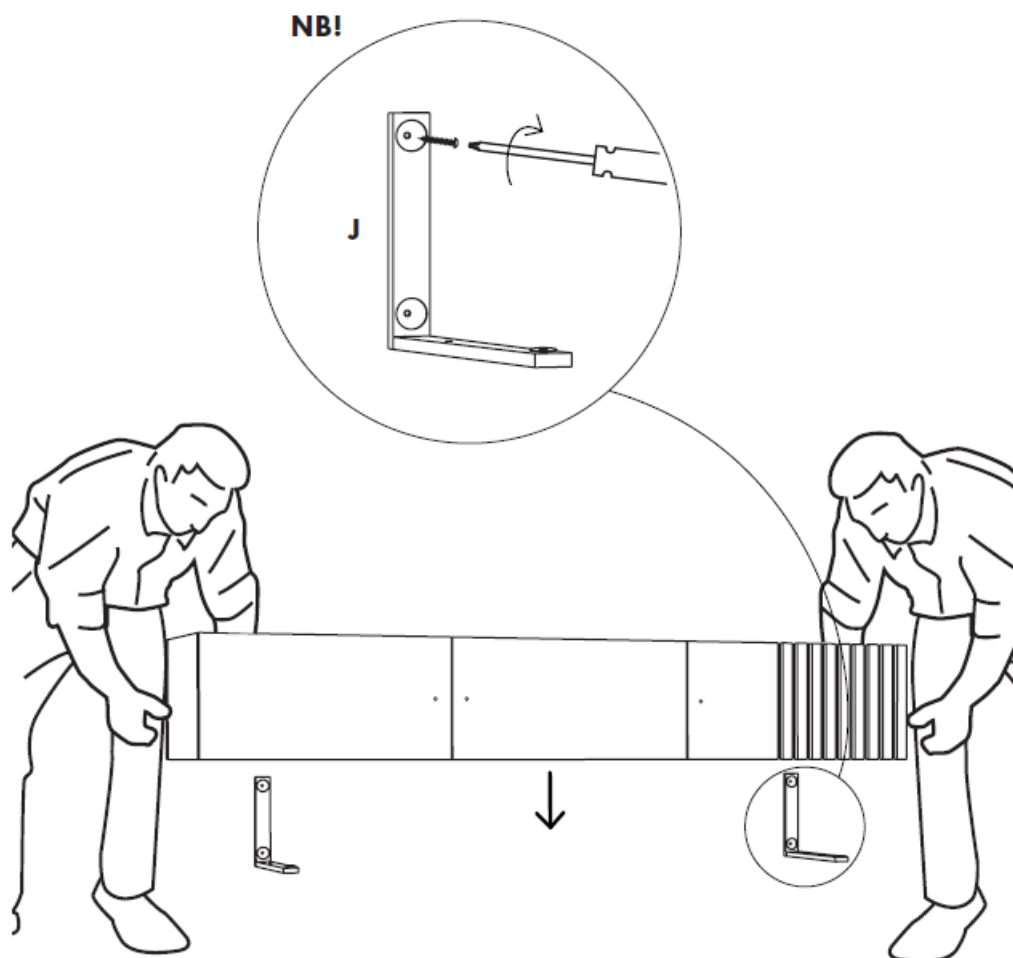

STEP 3
MOUNT THE CABINET TO THE METAL WALL BRACKETS

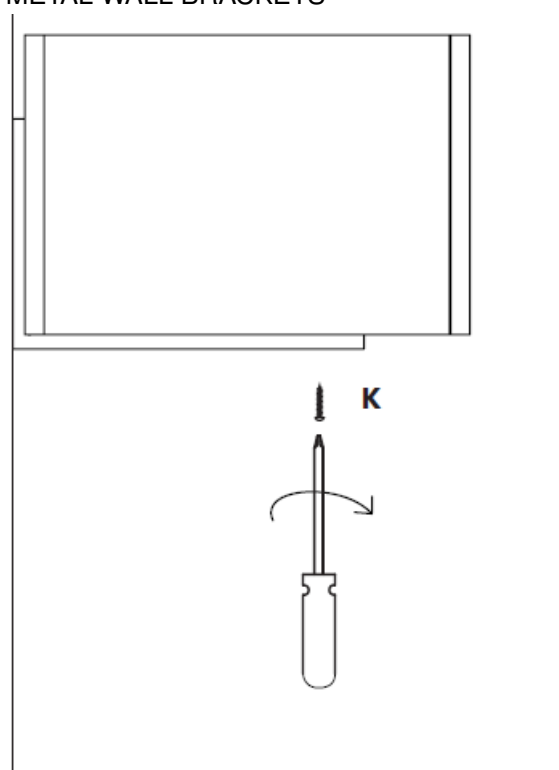

STEP 4
SEE THE FOLLOWING PAGES FOR MOUNTING
THE HANDLES AND ADJUSTING THE DOORS

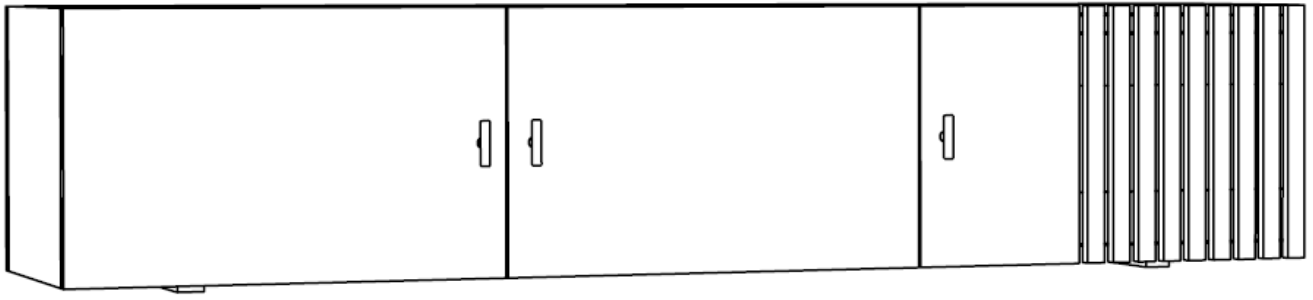

DETACH THE HANDLES FROM THE INSIDE OF THE CABINET AND ATTACH THEM ON THE OUTSIDE OF THE WOODEN DOORS

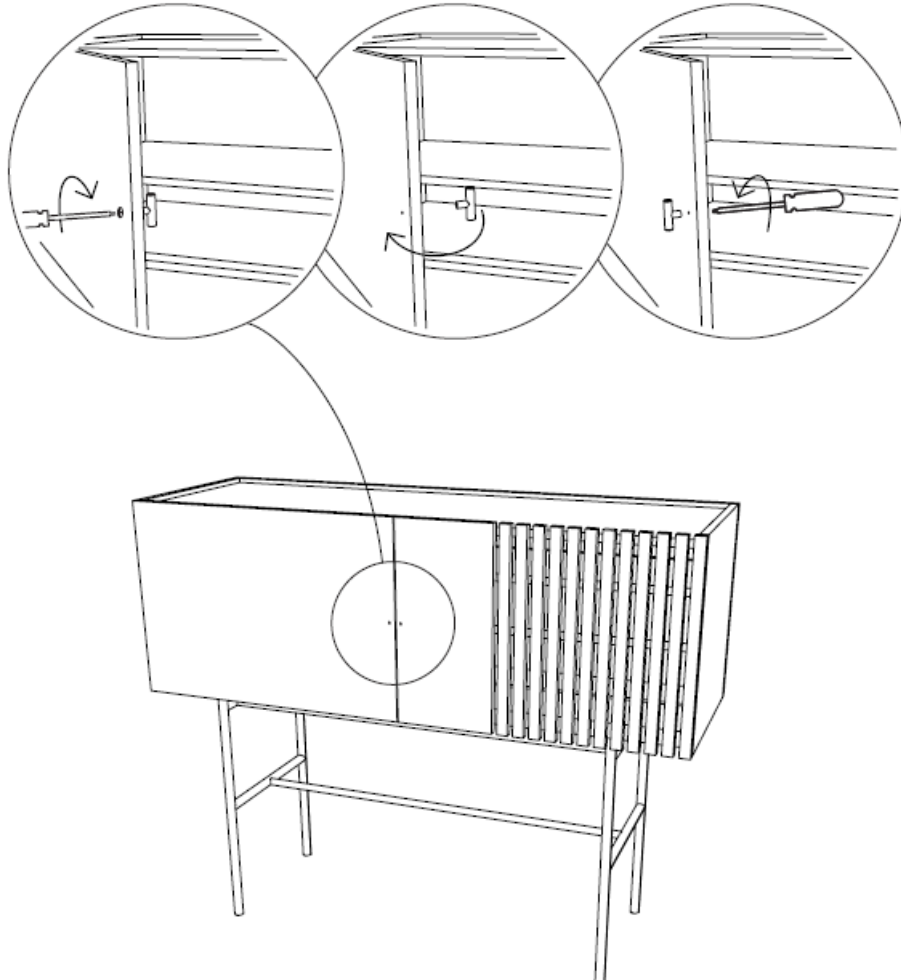

ADJUSTMENT INSTRUCTIONS

SHOULD YOU NEED TO LEVEL THE DOORS, PLEASE FOLLOW THESE INSTRUCTIONS.

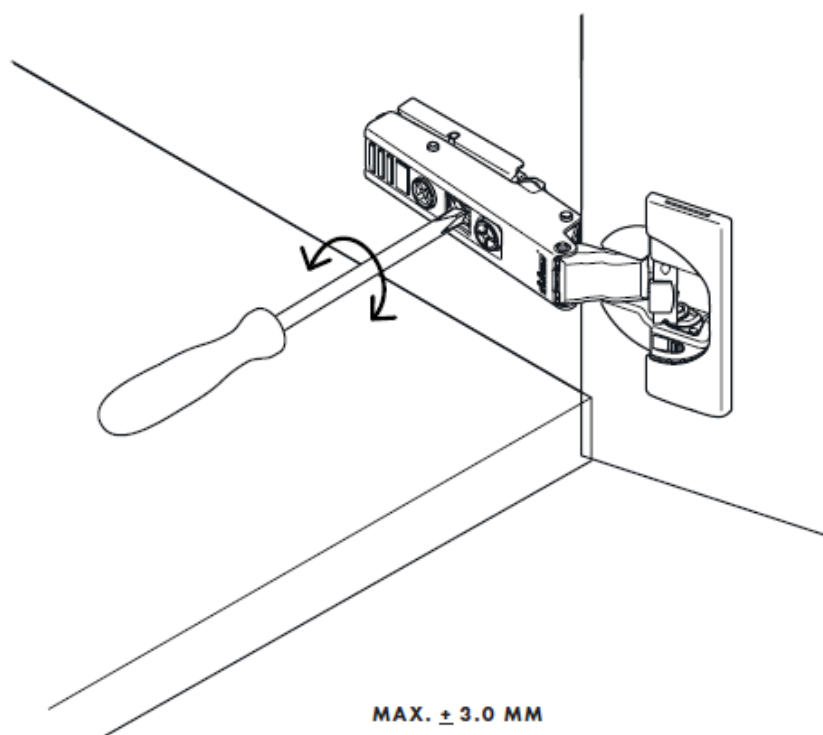
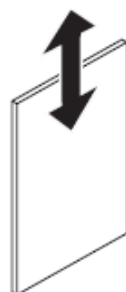

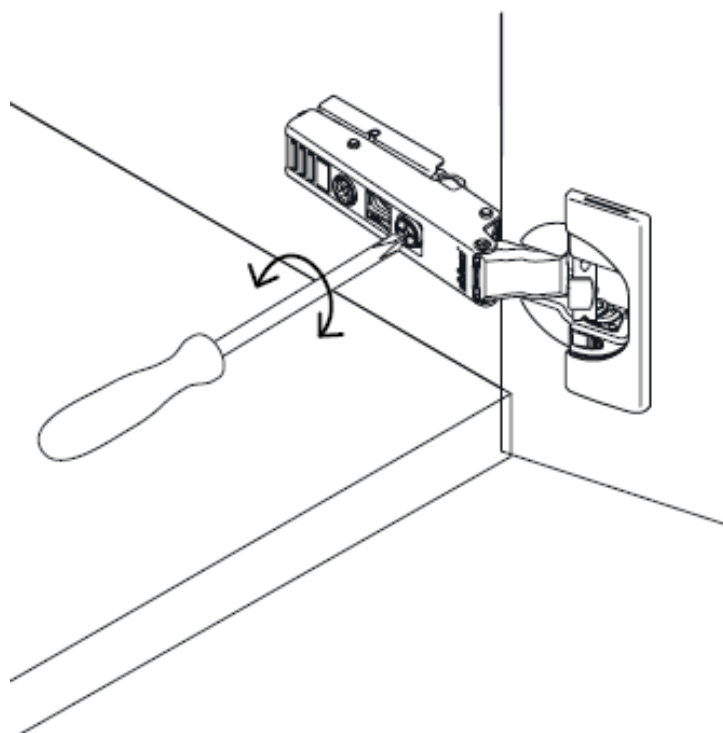
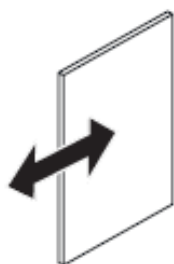

$\pm 2.0 \text{ mm}$

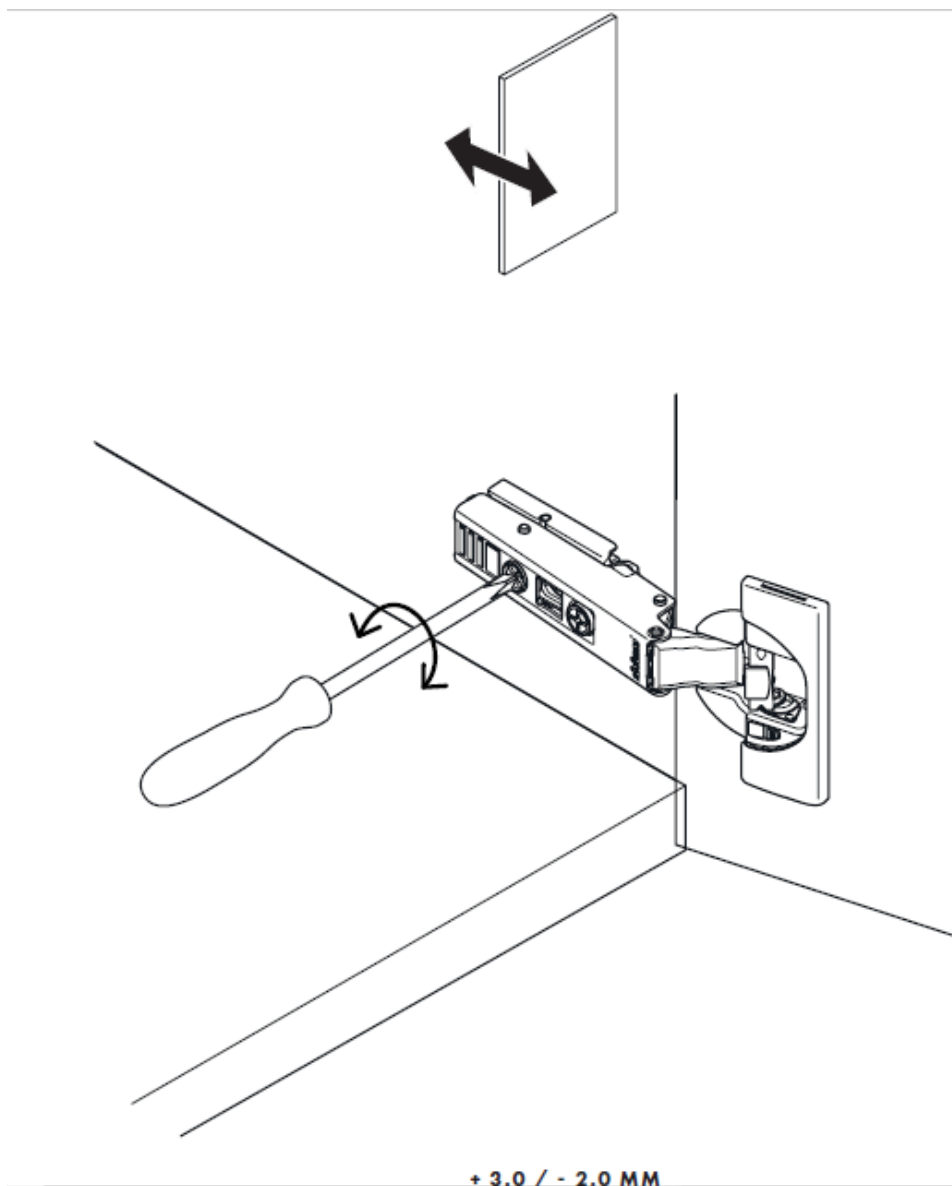

DESIGNED BY
SAYS WHO

+ 3.0 / - 2.0 MM

Documents / Resources

	<p>WOUD 120423 Array Low Sideboard [pdf] Instruction Manual 120423, Array Low Sideboard, 120423 Array Low Sideboard, Low Sideboard, Sideboard</p>
---	---