



workplace Camera Ceiling Mount Bracket Owner's Manual

[Home](#) » [workplace](#) » workplace Camera Ceiling Mount Bracket Owner's Manual 

workplace Camera Ceiling Mount Bracket Owner's Manual



Contents

- [1 Dimension](#)
- [2 Key Features:](#)
- [3 Specifications:](#)
- [4 Documents / Resources](#)
- [4.1 References](#)

Dimension

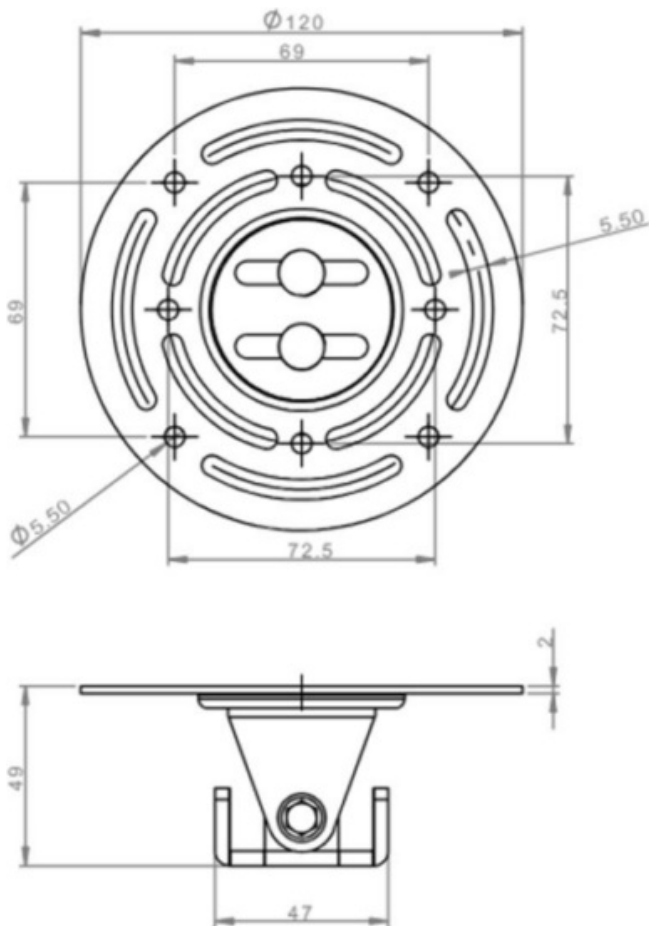

Key Features:

- **Wide Compatibility:** Supports 1/4" – 20 center mount cameras, making it a versatile choice for different camera models and brands.
- **Ceiling Mounting:** Ideal for ceiling installations, this bracket allows for effective placement of cameras in conference rooms, classrooms, auditoriums, and other environments.
- **Sturdy Load Capacity:** With a maximum load capacity of 5 kg, the AV-CMB-PTZCAM ensures secure and stable mounting for your camera, allowing for reliable performance during use.

Specifications:

- **Compatibility:** Designed for use with center mount cameras from various manufacturers
- **Mounting Type:** Ceiling
- **Load Capacity:** Max. 5 kg



Documents / Resources

	<p>workplace Camera Ceiling Mount Bracket [pdf] Owner's Manual</p> <p>Camera Ceiling Mount Bracket, Ceiling Mount Bracket, Mount Bracket, Bracket</p>
---	---

References

- [User Manual](#)

[Manuals+](#), [Privacy Policy](#)

This website is an independent publication and is neither affiliated with nor endorsed by any of the trademark owners. The "Bluetooth®" word mark and logos are registered trademarks owned by Bluetooth SIG, Inc. The "Wi-Fi®" word mark and logos are registered trademarks owned by the Wi-Fi Alliance. Any use of these marks on this website does not imply any affiliation with or endorsement.