



WORKDONE B07DHB86VM 3.5 Hard Drive Caddy with 2.5 HDD Adapter User Guide

[Home](#) » [WORKDONE](#) » WORKDONE B07DHB86VM 3.5 Hard Drive Caddy with 2.5 HDD Adapter User Guide 

Contents

- [1 WORKDONE B07DHB86VM 3.5 Hard Drive Caddy with 2.5 HDD Adapter](#)
- [2 Product Information](#)
- [3 Final checklist before installation](#)
- [4 Dell PowerEdge Front Drive Bay sizes](#)
- [5 Product Usage Instructions](#)
- [6 Installation Steps for a 2.5-inch Hard Drive into a 2.5-inch Hard Drive Adapter](#)
- [7 Hard-Drive Indicator Codes](#)
- [8 FAQ](#)
- [9 Documents / Resources](#)
 - [9.1 References](#)
- [10 Related Posts](#)



WORKDONE B07DHB86VM 3.5 Hard Drive Caddy with 2.5 HDD Adapter



Product Information

This product is a hard drive adapter designed for DELL PowerEdge servers. It allows users to install either a 3.5-inch or a 2.5-inch hard drive into the server's drive bay. The adapter is compatible with specific DELL PowerEdge models and comes with screws for securing the hard drive.

Final checklist before installation

• STEP 01

My DELL PowerEdge server has a 3.5-inch Drive Bay

Drive Bay



• STEP 02

I have checked the DELL PowerEdge model compatibility sheet

Dell PowerEdge Generation	14G	13G	12G	11G
Modular Models	PC640 M640 M640 (for VRTX)	PC630 PC630 PC630 PD332 PM130 NA30 NA30 (for VRTX) NA30 NA30 (for VRTX) NA30 NA30 (for VRTX)	NA20 M520 M520 (for VRTX) NA20 NA20 (for VRTX) M620 M620 (for VRTX)	M610 M610x M710 M710HD M910 M915
Modular Models	PC640 M640 M640 (for VRTX)	PC630 PC630 PD332 PM130 NA30 NA30 (for VRTX) NA30 NA30 (for VRTX) NA30 NA30 (for VRTX)	NA20 M520 M520 (for VRTX) NA20 NA20 (for VRTX) M620 M620 (for VRTX)	M610 M610x M710 M710HD M910 M915

- **STEP 03**

My DELL PowerEdge server has a Hot-Plug backplane



- **STEP 04**

I want to add a big 3.5-inch OR small 2.5-inch Hard Drive to my DELL PowerEdge server



Drive Bay

The same server model is delivered with two different drive bay sizes. Verify whether your server model has a bigger 4.2-inch / 10.6 cm drive bay size for 3.5-inch hard drives and with converter 2.5-inch hard drives.

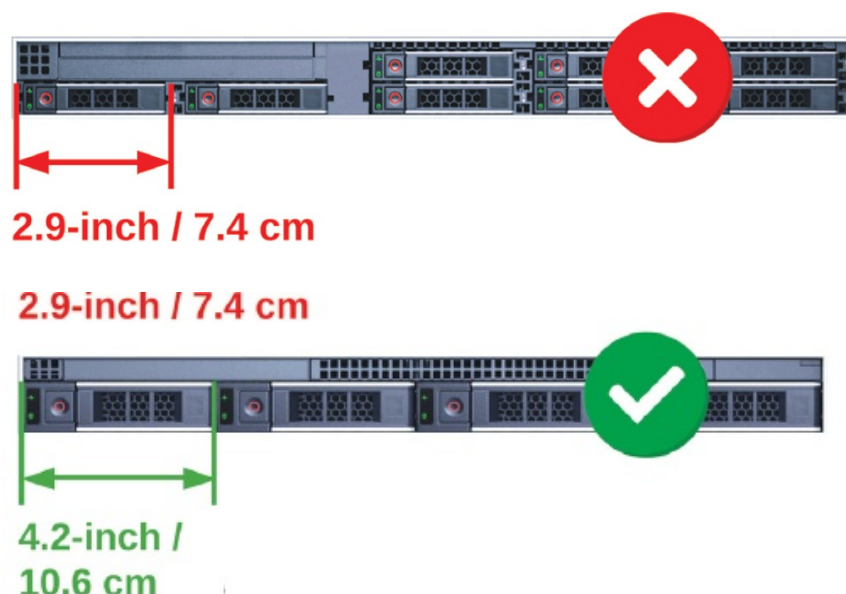

Dell PowerEdge Front Drive Bay sizes

	Server Generation	Measurement of Hard Drive, wide	Measurement of DriveBay, wide
2.5"	16th–14th	2.8-inch / 7 cm	2.9-inch / 7.4 cm
	13th–11th	2.8-inch / 7 cm	3-inch / 7.7 cm
3.5"	16th–14th	4-inch / 10.2 cm	4.2-inch / 10.6 cm
	13th–11th	4-inch / 10.2 cm	4.2-inch / 10.7 cm

Specifications

- **Compatible Drive Sizes:** 3.5-inch, 2.5-inch
- **Compatible Server Models:** DELL PowerEdge (refer to compatibility sheet)

Product Usage Instructions

Installing a 3.5-inch Hard Drive Into a 3.5-inch Hard Drive Carrier

1. Insert the hard drive into the carrier with the SATA/SAS connector end facing the back.
2. Align the screw holes on the hard drive with the back set of holes on the carrier. Ensure the back of the hard drive is flush with the carrier.
3. Secure the hard drive to the carrier using the provided screws (4pcs).

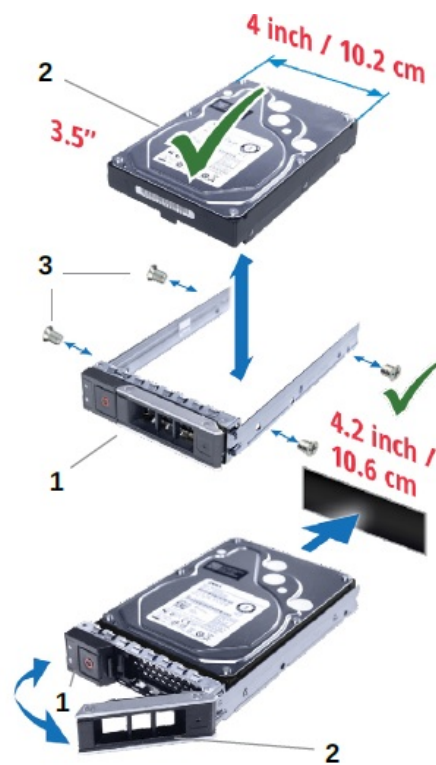

1. Hard-drive carrier
2. Hard-drive
3. Screws (4pcs)

Installing a Hot-Swap Hard Drive

1. Remove any installed hard-drive blank from the slot.
2. Press the release button (1) and open the carrier handle (2).
3. Slide the carrier into the slot until it connects with the backplane. Close the handle (2) to lock the hard drive in place.

Installation Steps for a 2.5-inch Hard Drive into a 2.5-inch Hard Drive Adapter

1. Align the screw holes on the 2.5-inch hard drive with those on the hard drive adapter.
2. Use two smaller screws to securely fasten the hard drive to the adapter.

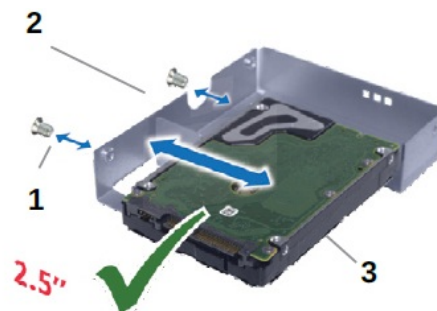

1. Screws (2pcs smaller)
2. Hard-drive adapter
3. 2.5" hard drive

4. Hard-drive carrier
5. Screws (5pcs smaller)
6. Hard-drive adapter
7. 2.5" hard-drive

Installing a Hard Drive with a Hard Drive Adapter into a Hard Drive Carrier

1. Insert the adapter into the carrier, aligning the hard drive connector towards the back. Double-check that the end of the hard drive aligns with the end of the hard drive carrier.
2. Align the screw holes on the hard drive with the back set of holes on the hard-drive carrier. When aligned correctly, the back of the hard drive is flush with the back of the hard-drive carrier.
3. Use five smaller screws to secure the hard drive to the carrier.



Hard-Drive Indicator Codes

Each hard drive carrier has an activity LED indicator and a status LED indicator. The indicators provide information about the current status of the hard drive.

Drive-status indicator pattern (RAID only)	Condition
Flashes green twice per second	Identifying drive or preparing for removal
Off	Drive ready for insertion or removal
Flashes green , amber , and turns off	Predicted drive failure
Flashes amber four times per second	Drive failed
Flashes green slowly	Drive rebuilding
Flashes green for three seconds, amber for three seconds, and turns off after six seconds	Rebuild stopped

Product materials

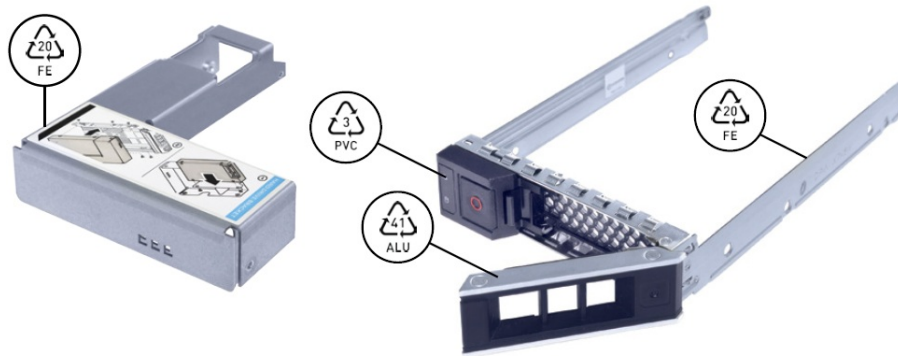

The product operates without electricity or a magnetic field, and it does not include electronic components, batteries, LED lights, wires, or microcircuits.

EU Representative – Assembled in China – All rights reserved

WORKDONE® / IT-S Consulting Oy Vartiokyläntie 58 00950 Helsinki Finland

- Email: support@workdone.biz
- Tel: +358505378049.

Copyright © 2018-2024 by WORKDONE

FAQ

1. Q: What server models are compatible with this hard drive adapter?

A: This hard drive adapter is compatible with DELL PowerEdge servers. Please refer to the compatibility sheet for specific models.

2. Q: Can I install both 3.5-inch and 2.5-inch hard drives with this adapter?

A: Yes, you can install either a 3.5-inch or a 2.5-inch hard drive into the DELL PowerEdge server using this adapter.

3. Q: How many screws are provided for securing the hard drive to the carrier?

A: Four screws are provided for securing a 3.5-inch hard drive, and two smaller screws are provided for securing a 2.5-inch hard drive.

4. Q: What are the indicator codes for the hard drive carrier?

A: The hard drive carrier has an activity LED indicator and a status LED indicator. The activity LED flashes green twice per second when identifying the drive or preparing for removal. The status LED is off when the drive is ready for insertion.

Documents / Resources

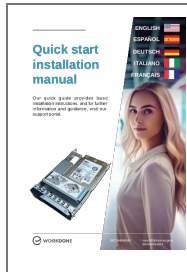

[WORKDONE B07DHB86VM 3.5 Hard Drive Caddy with 2.5 HDD Adapter](#) [pdf] User Guide
B07DHB86VM 3.5 Hard Drive Caddy with 2.5 HDD Adapter, B07DHB86VM, 3.5 Hard Drive Ca
ddy with 2.5 HDD Adapter, Drive Caddy with 2.5 HDD Adapter, Caddy with 2.5 HDD Adapter, 2.
5 HDD Adapter, HDD Adapter, Adapter

References

- [User Manual](#)