



WORK SHARP Mod Tools Fixed Blade with Sharpener Instruction Manual

[Home](#) » [WORK SHARP](#) » WORK SHARP Mod Tools Fixed Blade with Sharpener Instruction Manual 

WORK SHARP Mod Tools Fixed Blade with Sharpener Instruction Manual



Contents

- [1 GETTING TO KNOW](#)
- [2 PRODUCT OVERVIEW](#)
- [3 HOW TO USE:](#)
- [4 WARRANTY](#)
- [5 3 YEAR WARRANTY](#)
- [6 QUESTIONS?](#)
- [7 Documents / Resources](#)
 - [7.1 References](#)

GETTING TO KNOW

YOUR WORK SHARP® HUNTING FIXED BLADE MOD-TOOL

PRODUCT OVERVIEW

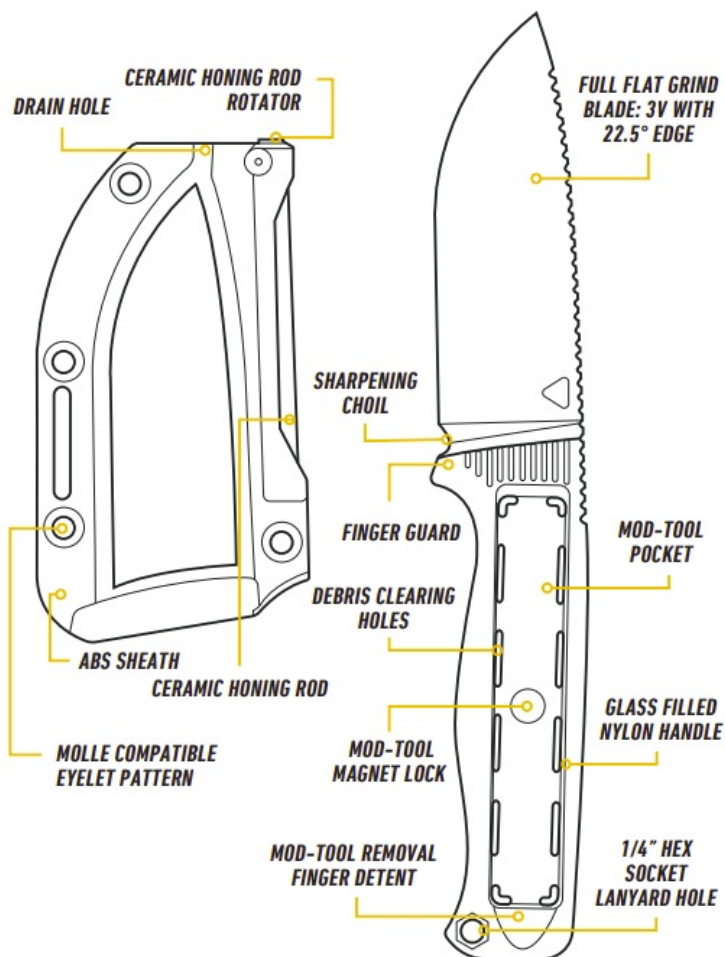

SHARPENER MOD-TOOL

(comes installed in mod-tool pocket)

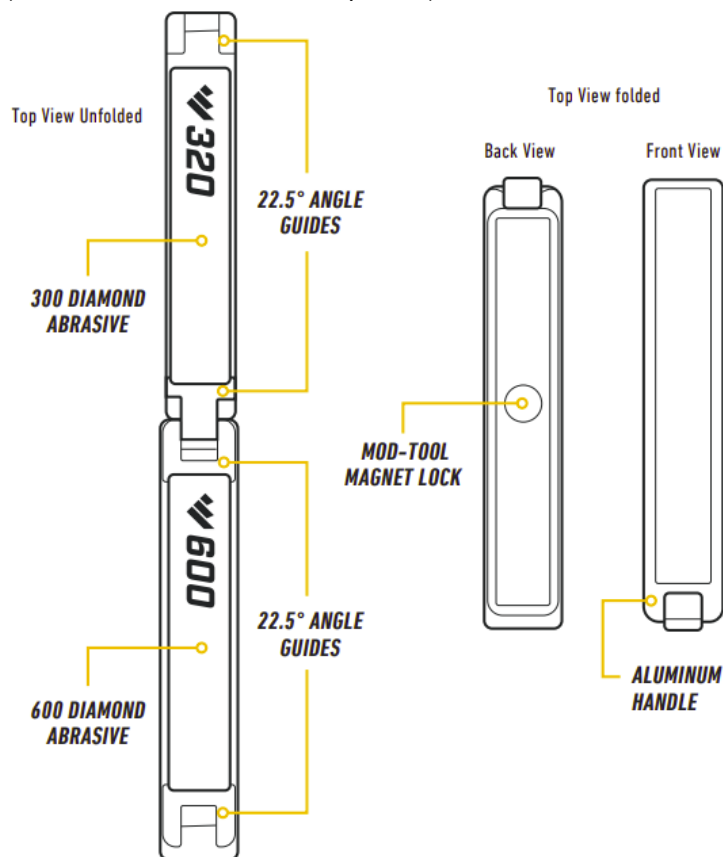

HOW TO REMOVE YOUR MOD-TOOL

1. With sheath on, insert index finger into Mod-tool removal finger detent and push Mod-tool, so it slides towards

the front of the knife. This will disengage the magnet.

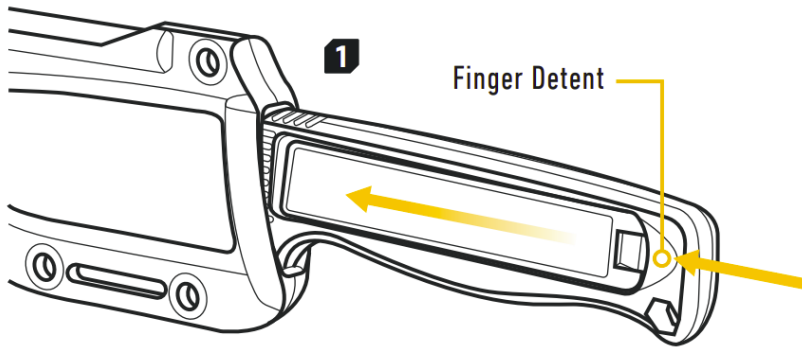

2. Pull Mod-tool away from the handle to remove

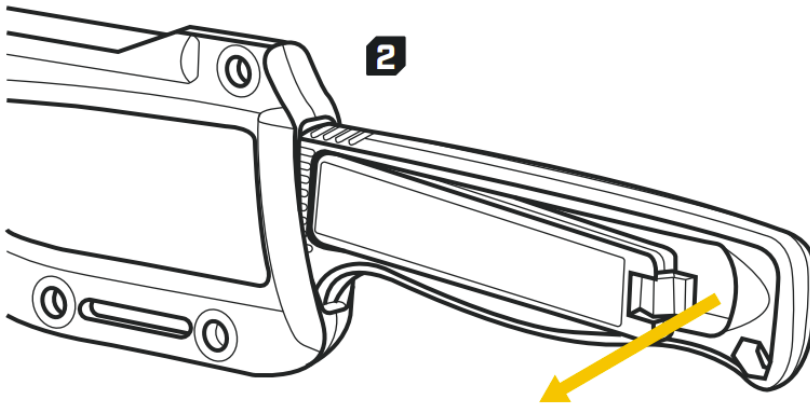

- **TIP:** Slide your finger nail under the Mod-tool when putting using the finger detent to give you more leverage while removing from the handle.



WARNING! Work Sharp™ Knives are incredibly sharp, always use with safety in mind. Read and follow these instructions for proper use and maintenance, Always have the sheath on the blade when removing or stowing the Mod-tool.

HOW TO STOW YOUR MOD-TOOL

1. Ensure the Mod-tool pocket is clear of debris.

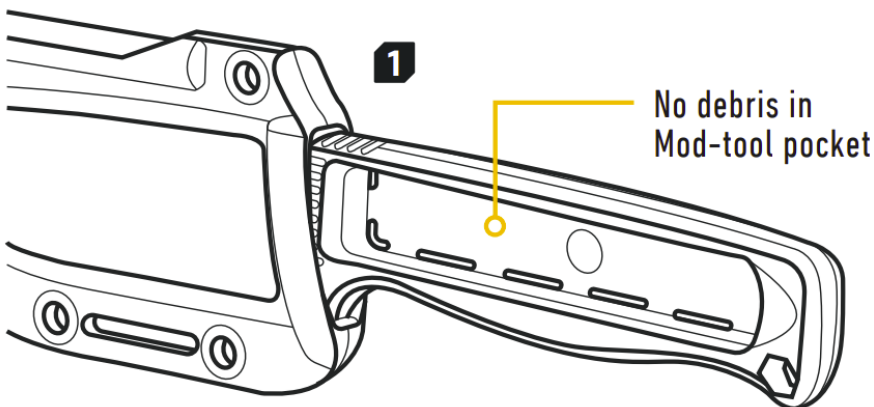

Insert the Podtool at an angle with the pod tool retention lip on the

2. bottom, facing the finger detent of the fixed blade handle.

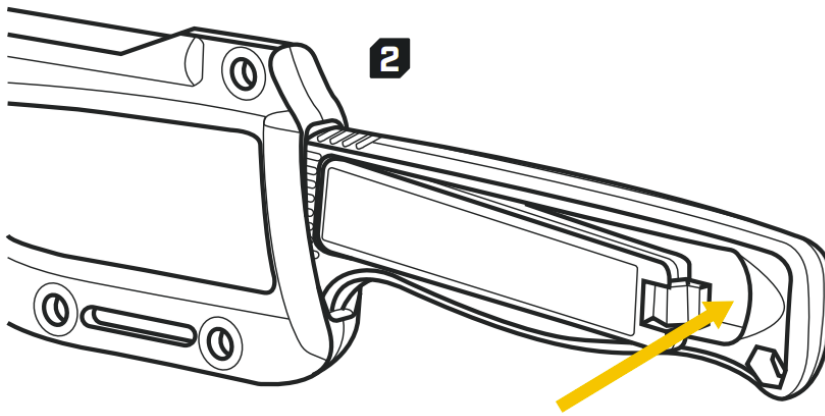

CAUTION! This knife is very sharp (that's probably why you bought it!) Accordingly, this knife is potentially dangerous and should be treated with great care and respect. So, exercise caution when unwrapping, using, storing, and/or maintaining this knife. Work Sharp® assumes no responsibility for cuts, scratches, or other injuries/damage to you or your property resulting from the use of this knife.

HOW TO USE:

SHARPENER MOD-TOOL

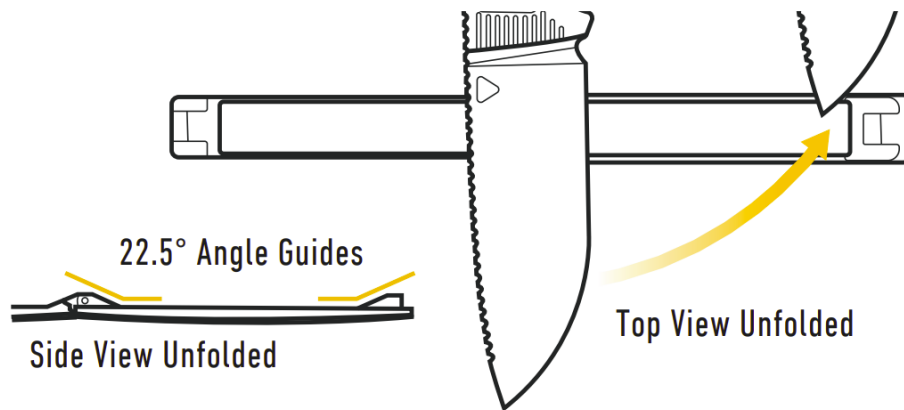

1. Place the side of the knife flat on the Guide closest to the handle so the cutting edge is on the abrasive and PUSH the knife edge away and along the abrasive surface.
2. Repeat this step using the opposing Guide and PULL the knife edge toward and along the abrasive surface.
3. Alternate for 5-10 strokes.
4. Use steps 1-3 to work through the abrasive progression in relation to your knife's level of dullness.
 - **SHAPE** (Very Dull): 320 Diamond abrasive.
 - **SHARPEN** (Dull): 600 Diamond abrasive.
 - **HONE** (Somewhat Dull): ceramic honing rod on sheath

HONING SHEATH

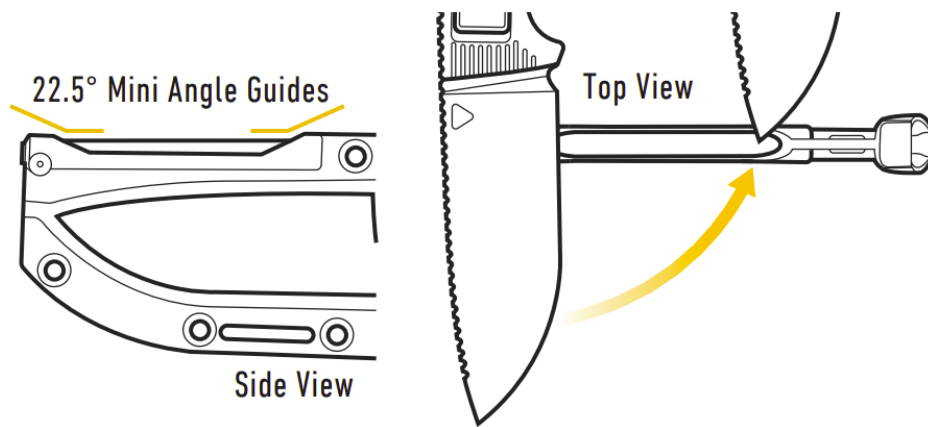

- **TIP:** Most knives can be sharpened with the 600 diamond plate and fine ceramic rod. Regular hone's on the sheath will reduce the number of times you need to go through the entire abrasive progression and increase the longevity of your knife.

WARRANTY

3 YEAR WARRANTY

This knife is covered by Work Sharp's 3-year warranty. We stand behind and support our products – contact us if you need assistance, parts, or service.



Warranty for consumer not industrial or commercial use.
Register your warranty online at [WorkSharpTools.com](https://www.WorkSharpTools.com).

HOW TO VIDEO



210 E. Hersey St.
Ashland, OR 97520 USA

QUESTIONS?

WorkSharpTools.com / 1.800.418.1439

PLEASE LEAVE A REVIEW WHERE YOU PURCHASED YOUR PRODUCT



WSFBK PP0005718 REV 0 01/24

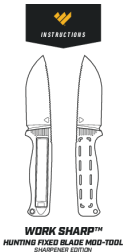

Documents / Resources

	<p>WORK SHARP Mod Tools Fixed Blade with Sharpener [pdf] Instruction Manual Mod Tools Fixed Blade with Sharpener</p>
---	--

References

-  [Work Sharp – Work Sharp](#)
- [User Manual](#)

[Manuals+](#), [Privacy Policy](#)

This website is an independent publication and is neither affiliated with nor endorsed by any of the trademark owners. The "Bluetooth®" word mark and logos are registered trademarks owned by Bluetooth SIG, Inc. The "Wi-Fi®" word mark and logos are registered trademarks owned by the Wi-Fi Alliance. Any use of these marks on this website does not imply any affiliation with or endorsement.