



WOOLLEY BSD29 Wi-Fi Smart Plug Socket User Manual

[Home](#) » [Woolley](#) » WOOLLEY BSD29 Wi-Fi Smart Plug Socket User Manual 

Contents

- [1 WOOLLEY BSD29 Wi-Fi Smart Plug Socket](#)
- [2 Specifications](#)
- [3 Add Device to eWeLink APP](#)
- [4 Pair with Amazon Echo](#)
- [5 More APP application platforms and gateway recommendations](#)
- [6 Gateway adding instruction](#)
- [7 Documents / Resources](#)
 - [7.1 References](#)
- [8 Related Posts](#)

WOOLLEY

WOOLLEY BSD29 Wi-Fi Smart Plug Socket



Specifications

Model	BSD29
Input	100-250V: 50/60Hz
Output	100-250V: 50/60Hz
Wireless Connection	Zigbee 3.0
APP Operating Systems	Androids & iOS
Working Temperature	-20°C-60°C
Product size	58x58x32.5mm

Add Device to eWeLink APP

1. Download eWeLink APP.



2. Connect your phone to 2.4GHz WiFi and turn on Bluetooth.

3. Please add the Zigbee gateway in the “link” APP first, the gateway is not included in this product and needs to be purchased separately.

4. Power on



- After powering on, the device will enter the pairing mode defaulted during the first use and the Zigbee LED signal indicator will “flash slowly”
- **Note:**
- The device will exit the pairing mode if you do not pair it within 3 minutes.
- If you want to enter the pairing mode again, long press the button on the device for 5 seconds until the Zigbee LED indicator “flashes slowly” and is released.

5. Add the device to the Zigbee gateway

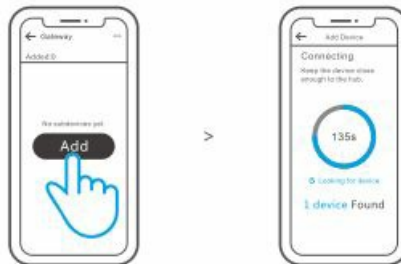

- Open the “eWeLink” App, tap the “Add” icon on the Zigbee gateway interface, then wait to look for and add the sub-devices.
- **Note:**
- If adding fails, please move the device closer to the gateway and add it again.

Pair with Amazon Echo

1. Download the latest Amazon Alexa App and pair it with Amazon Echo with a built-in Zigbee gateway.

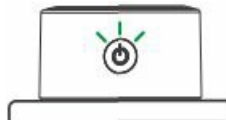

2. Power on the Plug, then it defaulted to enter the pairing mode, and the Zigbee LED signal indicator “flashes slowly”.
3. Ask the Alexa Echo to discover the devices automatically by saying “Alexa, discover my devices”

Note:

If it fails to pair within 3 minutes, the Plug will exit the pairing mode. Long press the button on Plug for 5s to make it enter the pairing mode if you need to pair again.

More APP application platforms and gateway recommendations



SmartThings



Amazon Alexa

This device supports the following gateways besides the eWeLink gateway:

Echo Studio
Echo(4thGen)
Echo Plus (Model: ZE39KL)
2nd Gen Echo Show (Model: DW84JL)
2nd Gen Echo Plus (Model: L9D29R)
Samsung SmartThings hub

Gateway adding instruction

1. Refer to the gateway user manual to download the matched APP and get it paired.
2. Set the Plug to the pairing mode.
3. Add Plug following the prompt on the APP and select eWeLink when adding.

Note:

- If you failed to add the sub-device, please take it closer to the gateway and try again.

SAR Warning

- Under normal use conditions, this equipment should keep a separation distance of at least 20 cm between the antenna and the body of the user.

WEEE Disposal and Recycling Information

- All products bearing this symbol are waste electrical and electronic equipment (WEEE as in directive 2012/19/EU) which should not be mixed with unsorted household waste.
- Instead, you should protect human health and the environment by handing over your waste equipment to a designated collection point for the recycling of waste electrical and electronic equipment, appointed by the government or local authorities. Correct disposal and recycling will help prevent potential negative consequences to the environment and human health. Please contact the installer or local authorities for more information about the location as well as the terms and conditions of such collection points.



Documents / Resources

	WOOLLEY BSD29 Wi-Fi Smart Plug Socket [pdf] User Manual BSD29 Wi-Fi Smart Plug Socket, BSD29, Wi-Fi Smart Plug Socket, Smart Plug Socket, Plug Socket, Socket
---	--

References

- [User Manual](#)