

Woodpeckers®

**Woodpeckers
StabilMAX RT
Router Table**



Woodpeckers StabilMAX RT Router Table Owner's Manual

[Home](#) » [Woodpeckers](#) » Woodpeckers StabilMAX RT Router Table Owner's Manual 

Contents

- 1 Woodpeckers StabilMAX RT Router Table
- 2 Product Usage Instructions
- 3 TRIM ROUTER BASE ASSEMBLY
- 4 TABLE TOP ASSEMBLY
- 5 TABLE & LEG STAND ASSEMBLY
- 6 FENCE MICRO-ADJUST
- 7 FENCE ASSEMBLY
- 8 ASSEMBLING & CALIBRATING
- 9 SETTING UP & USING YOUR STABILMAX RT ROUTER TABLE SYSTEM
- 10 STABILMAX RT ROUTER TABLE TIPS & TRICKS
- 11 ADDITIONAL ACCESSORIES
- 12 Documents / Resources
 - 12.1 References
- 13 Related Posts

Woodpeckers®

Woodpeckers StabilMAX RT Router Table



Specifications

- Product Name: Stabilmax R.T. Router Table
- Components: Five components that can be purchased individually
- Contact: Email: mailroom@woodpeck.com, Phone: [800-752-0725](tel:800-752-0725) (9:00 a.m. to 4:00 p.m. EST, Monday – Friday)

Product Usage Instructions

Router Base Assembly

1. Install the (4) Leveling Screws into the Router Base.
2. Attach the Router Base Handle using the provided screws.
3. Mount your router securely onto the base.

Table Setup

1. Install the Bumpers and adjust tension between Router Base and Table Top.
2. Insert the Leveling Screw Pads into pre-drilled holes.

Leg Stand Assembly

1. Align Leg Stand Pivot Flanges with pre-drilled holes on the Table Top.
2. Attach Leg Stands using Pan Head Screws, being cautious not to over-tighten.
3. Adjust pivot tightness using nylon lock nuts.

Fence and Micro-Adjust Installation

1. Attach the Micro-Adjust to the Fence.
2. Place the Fence onto the Micro-Adjust base and secure with hardware.
3. Adjust the Micro-Adjust position using the Positioning Knob.

FAQ

- **Q: What should I do if I'm missing components?**

A: Contact customer service via email at mailroom@woodpeck.com or call [800-752-0725](tel:800-752-0725) for assistance.

- **Q: How do I adjust the tension between the Router Base and Table Top?**

A: Tighten or loosen the screw assembly connecting the Bumpers to adjust the tension.

STABILMAX™ RT ROUTER TABLE OWNER'S MANUAL

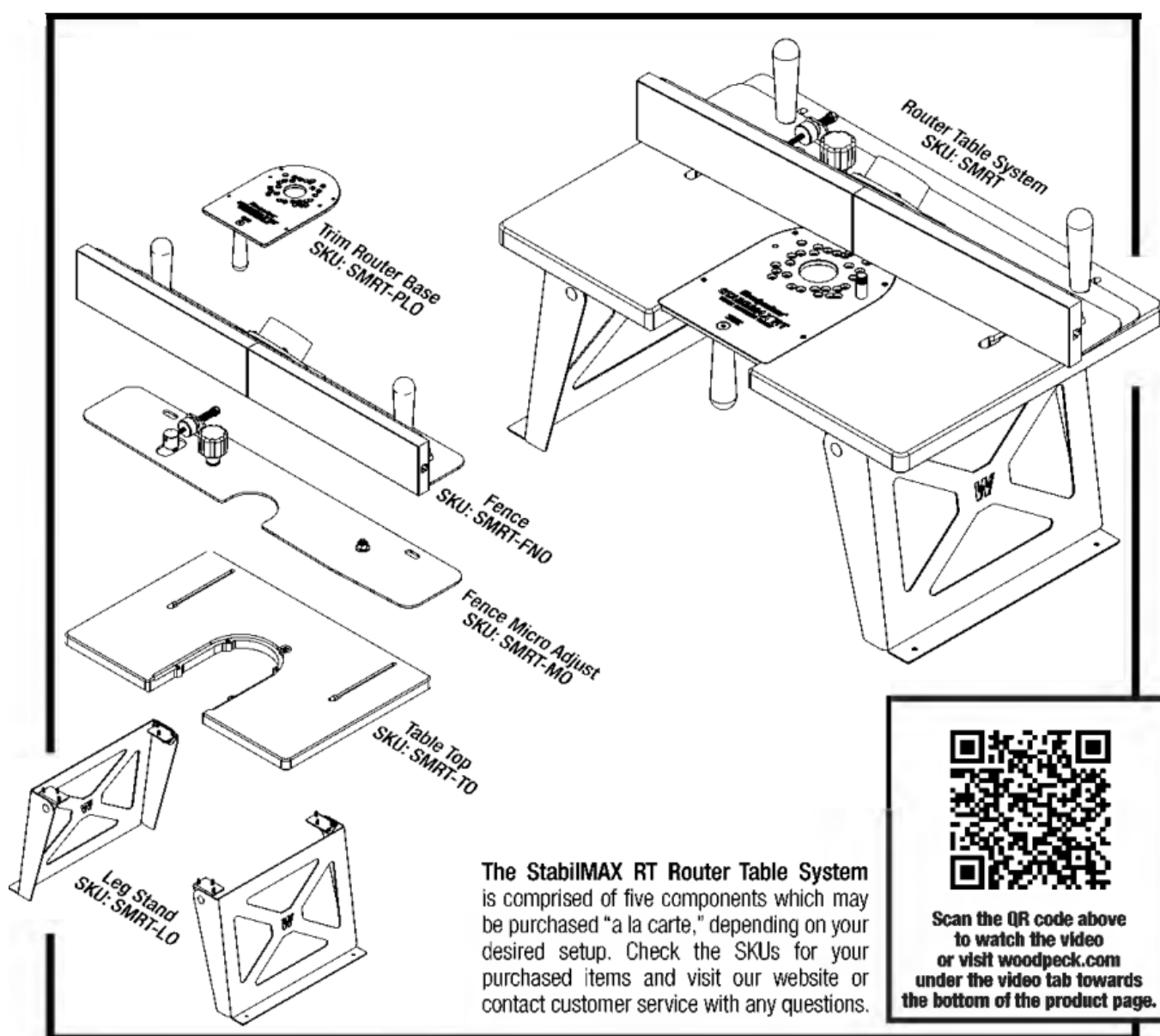

If you think you're missing anything, email us at mailroom@woodpeck.com.

You can also call us at [800-752-0725](tel:800-752-0725) from 9:00 a.m. to 4:00 p.m. EST Monday – Friday.

TRIM ROUTER BASE ASSEMBLY

- AT THIS POINT YOU WILL NEED:

- Trim Router Base SKU: SMRT-PLO – Base – Handle
- HARDWARE BAG
- (4) Leveling Screw (1) Flat Head Screw – 1/4-20 x 5/8"
- Hex Key 3/32"

1. Install the (4) ® Leveling Screws into the Router Base from the engraved face and set just below the surface.

FIGURE A

2. Install the Router Base Handle with the ® Flat Head Screw and tighten.
3. Mount your router with the included M4 Screws. Locate your router's bolt patter using the diagram in Figure B and ensure the collet is centered in the opening before tightening screws.

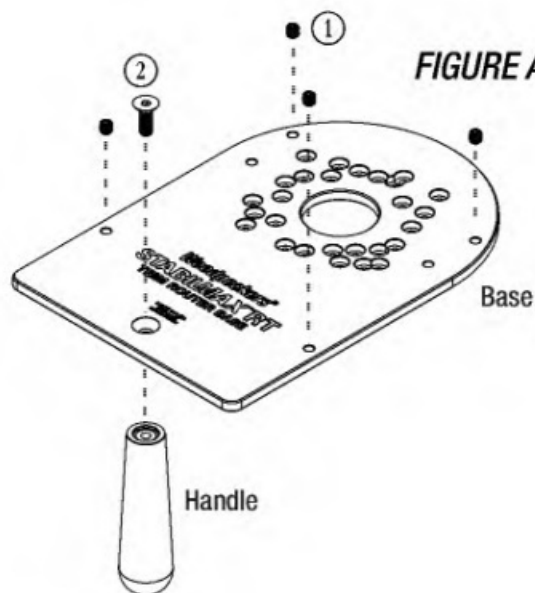
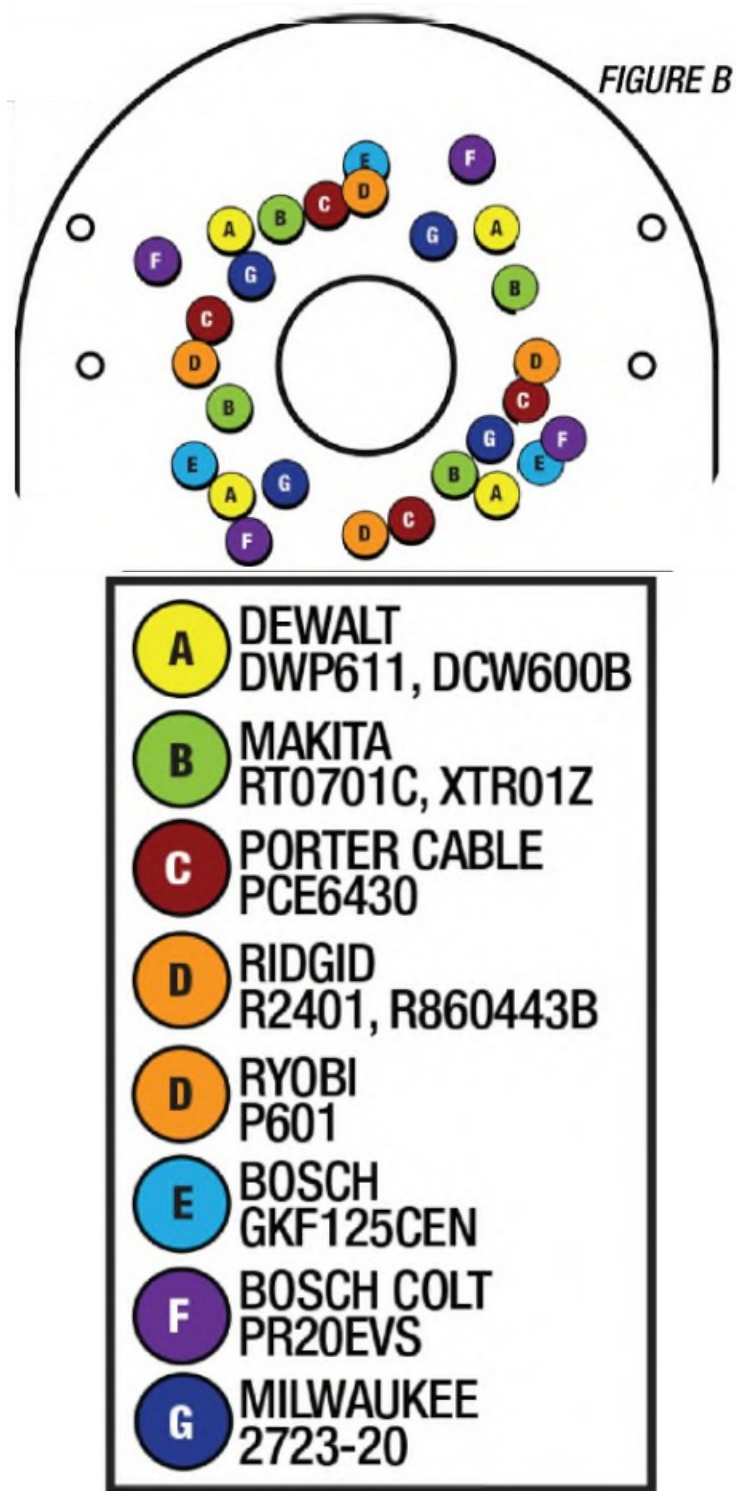

TABLE TOP ASSEMBLY

- AT THIS POINT YOU WILL NEED:

- Table Top SKU: SMRT-TO
- HARDWARE BAG
 1. (1) Phillips Flat Head Screw – 1/4-20 x 1-1/2" *
 2. (1) Bumper
 3. (1) Bumper Nut
 4. (4) Leveling Screw Pad – #6



If Purchased as a complete kit, you may skip this step.

1. Install the € Bumper with the included © Flat Head Screw and © Bumper Nut so the screw sits below the table top surface. The tension between the Router Base and the Table Top can be adjusted by tightening or loosening the screw assembly. FIGURE C & C-1 2.
2. Install the (4) Leveling Screw Pads in the pre-rilled holes. This creates a pad for the plate leveling screws to rest on.

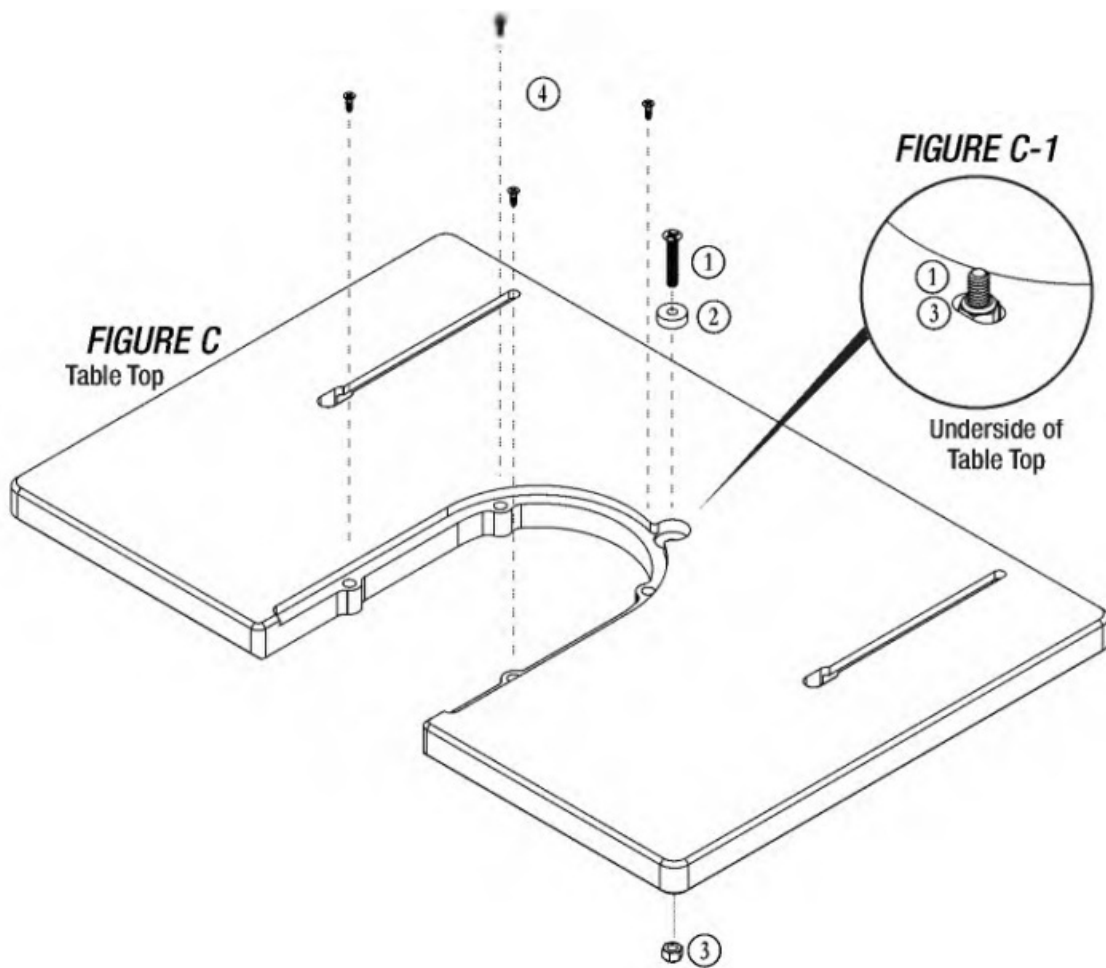
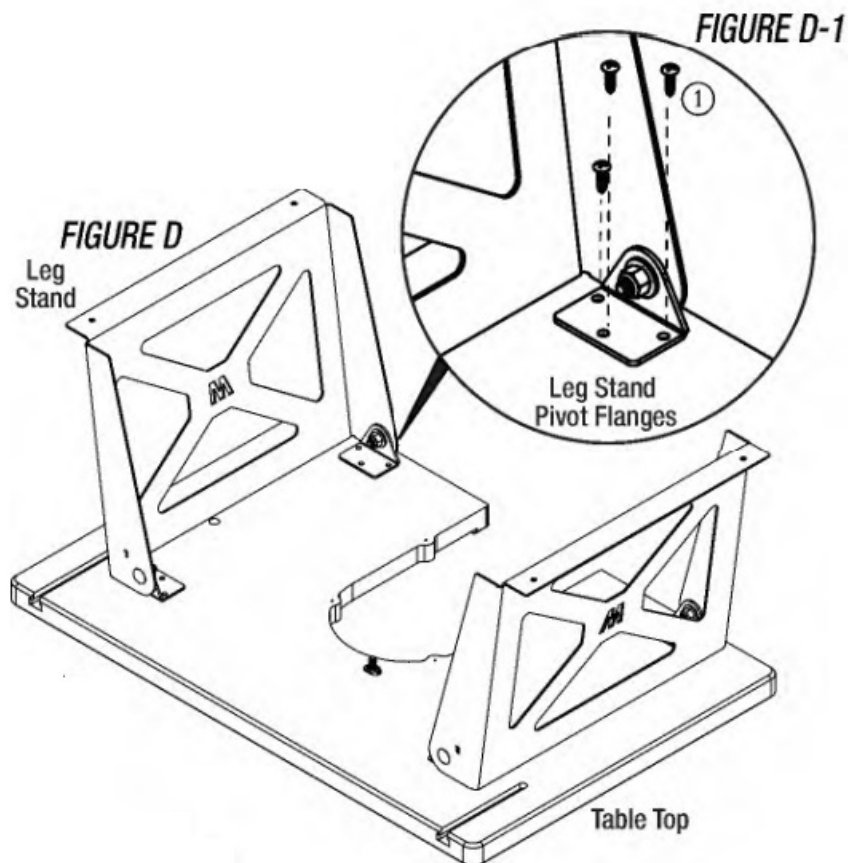

TABLE & LEG STAND ASSEMBLY

- AT THIS POINT YOU WILL NEED:
- Leg Stand SKU: SMRT-LO
- HARDWARE BAG
 1. (12) Pan Head Screw – #6 x 1/2"



1. Set your Table Top upside down on a worksurface and locate the (4) sets of (3) pre-drilled holes.
2. Align the holes in the Leg Stand Pivot Flanges to the pre-drilled holes. The Left and Right Legs are marked (L) and (R). FIGURE D
3. Attach the Leg Stands by driving the (12) © Pan Head Screws. DO NOT over-tighten the screws which may strip the pre-drilled holes. Tighten the screws by hand or with a low-torque drill setting. Impact drill is not recommended. FIGURE D-1
4. The Legs are held to the pivot flange with anti-wobble nylon washers. The pivot should be tight enough not to move under the weight of the legs while still moveable by hand. You can change the tension by tightening or loosening the nylon lock nuts to your desired setting.

FENCE MICRO-ADJUST

- AT THIS POINT YOU WILL NEED:
- Fence SKU: SMRT-FNO
- Micro-Adjust Base SKU: SMRT-MO
- HARDWARE BAG ©
 1. (1) Micro-Adjust Mount
 2. (1) Positioning Knob
 3. (1) Cupped Washer
 4. (4) Washer
 5. (1) Spring.
 6. (2) Nylon Locking Nut
 7. (2) Hex Bolt – 3/32
 8. (2) Micro-Adjust Lock Knob

- 3/32" Hex Key 3/32"

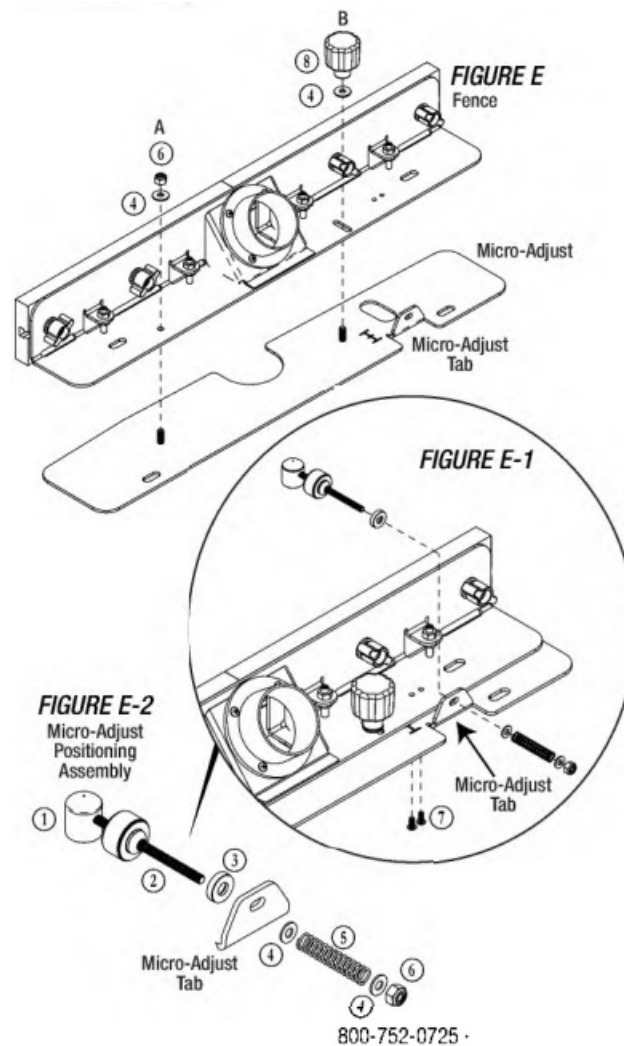

1. The Micro-Adjust attaches to the Fence.
2. Place the Fence onto the Micro-Adjust base by aligning the two studs on the Micro-Adjust to the hole and slot on the Fence. FIGURE E
3. A. Install the © Washer and © Nylon Locking Nut onto the first stud. (Left of the aust port, looking from the rear.)
4. B. Install the ® Washer and ® Positioning Knob onto the second stud and leave loose for now.
5. Insert the Micro-Adjust Hardware through the Tab. FIGURES E-1 & 2. Install the cup of the Cupped Washer towards the Positioning Knob.
6. Using a 3/32" hex key, install the (2) © Hex Bolts to mount the Micro-Adjust to underside of the Fence.
7. Drive the Fence all the way forward with the Positioning Knob.
8. Tighten the Lock Nut until the Spring is fully compressed.
9. Use the Positioning Knob to position the Micro-Adjust to the center of travel indicator and lock in place.

FENCE ASSEMBLY

- AT THIS POINT YOU WILL NEED:
- Fence SKU: SMRT-FNO – Fence – Dust Port
- HARDWARE BAG
 1. (2) Handle

2. (2) T-Bolt
3. (2) Washer
4. (4) Dust Port Screw

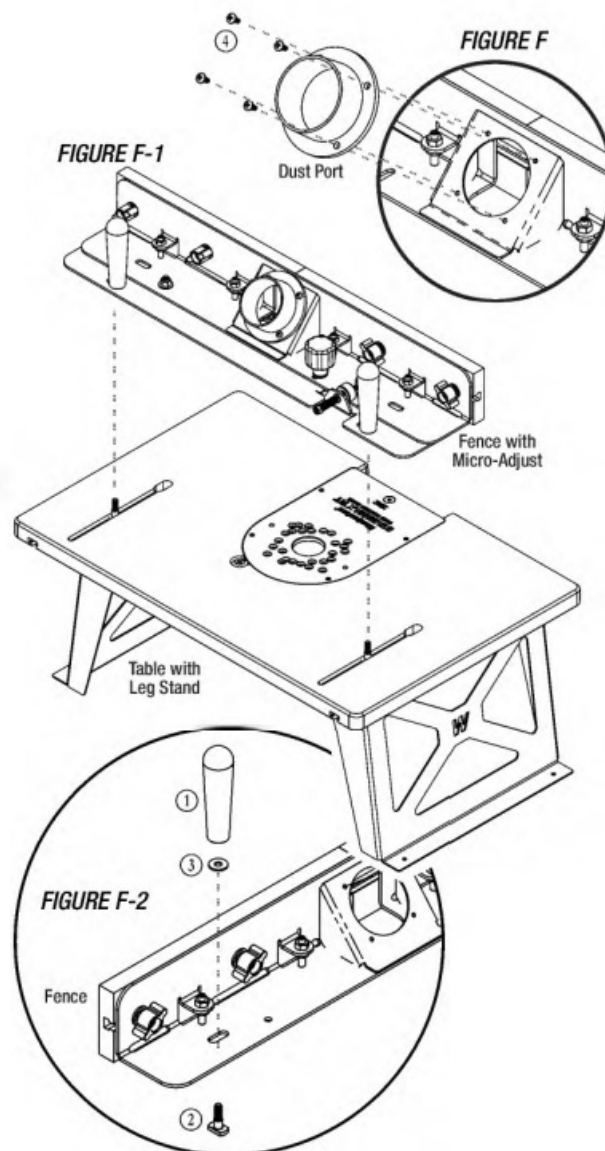

1. Install the Dust Port onto the dust port opening on the Fence using the (4) ® Dust Port Screws.
2. Install the O Handles through the ® Washer and through the oval holes on the Micro-Adjust (or the Fence) to the T-Bolts. Leave loose for now, as these T-Bolts slide into the fence tracks on the Router Table Top. FIGURES F-1 & 2

ASSEMBLING & CALIBRATING

1. Install the Fence to the Router Table Top by aligning the Handle and T-Bolts to the slotted tracks. Tighten the handles to lock the Fence in place.
2. Calibrating the Fence Roll Angle The Fence is calibrated at the factory. If you ever need to adjust, follow the steps in this section.
 - To square the roll angle, first place a known square reference, such as a Woodpeckers DelVe Square Not included against the front of the Fence. FIGURE G.
 - Use a 7/16" open-ended wrench (Not included) to crack loose the upper Hex Nuts on the Jack Screw

assemblies. Loosen a few turns to give room for adjustment.

- Place the 7/16" wrench onto the lower Hex Nuts and a 1/8" hex key (Not included) into the socket of the Jack Screw.
- Prevent the screw from turning with the hex key and use the wrench to tighten or loosen the lower Hex Nut to adjust the roll angle. Do so until the reference square touches at both top and bottom of the fence.
- Repeat for the other three Jack Screws.
- Once satisfied with the setting, ensure the lower Hex Nuts are snug against the flanges and tighten the upper Hex Nuts to lock the setting in place. Again, use the 1/8" hex key to prevent the Jack Screws from spinning.

3.

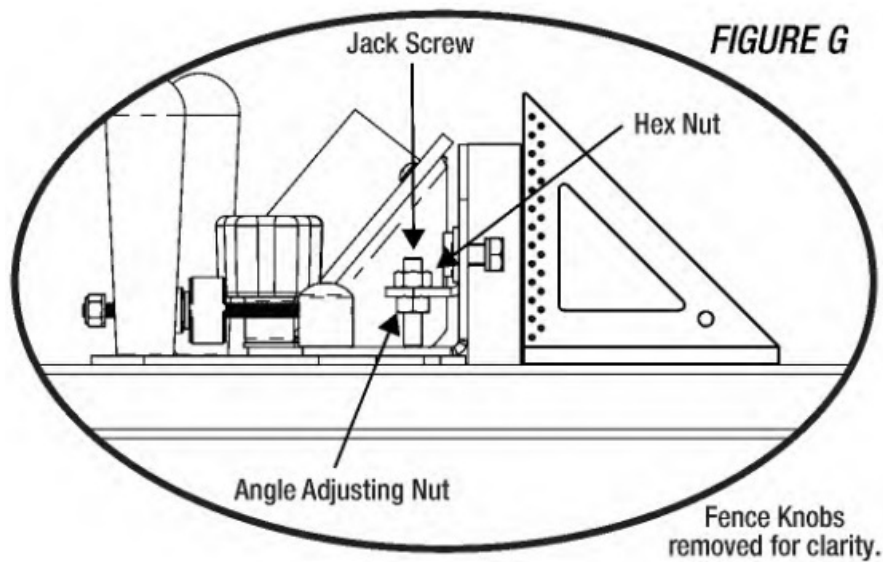

Leveling the Router Base to the Table.

- With the Router Base mounted in the Router Table Top opening, use a straight edge to check that the top and the base are coplanar.
- Use the Hex Key to tighten or loosen the Leveling Screws while checking for level. Adjust as necessary.

FIGURE H.

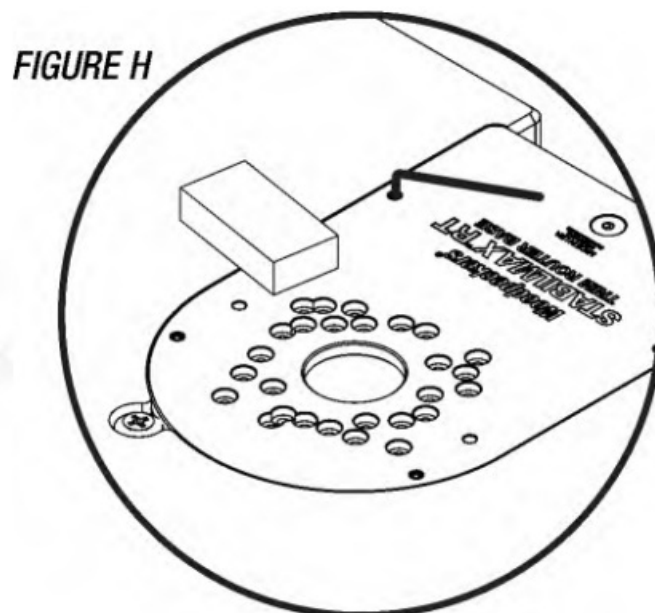

SETTING UP & USING YOUR STABILMAX RT ROUTER TABLE SYSTEM

1. With your router installed to the StabilMAX RT Router Base, place the base in the opening and pull down on the handle. Ensure that the Router Base is level to the Router Table Top. See Section Vi.3. for leveling procedure.
2. Positioning your Router Table a. You can secure to a work surface by clamping the bottom flange of the legs to the work surface. b. You can use track clamps in the T-Slots milled into the underside of the Table Top to clamp directly to your workbench.
3. Rough positioning of the Fence is done by loosening the Fence Handles, sliding into position, and re-tightening them.
4. To use the Micro-Adjust module, first loosen the Micro-Adjust Locking Knob. Turn the Micro-Adjust Positioning Knob to adjust the Fence. Counter-clockwise brings the fence closer to the router bit and clockwise moves the fence away from the router bit. Once you've located the desired setting, lock the Micro-Adjust Locking Knob.
5. Set the Fence face opening (if desired) by loosening the red Knobs on the back of the Fence. Slide the Sacrificial Fence Faces to the desired position and re-tighten the red Knobs.
6. The Starting Pin provides a pivot for safer cuts when freehand routing (routing without the fence) using a bit with a guide bearing. You can install a Starting Pin into one of the two threaded holes in the Router Base.

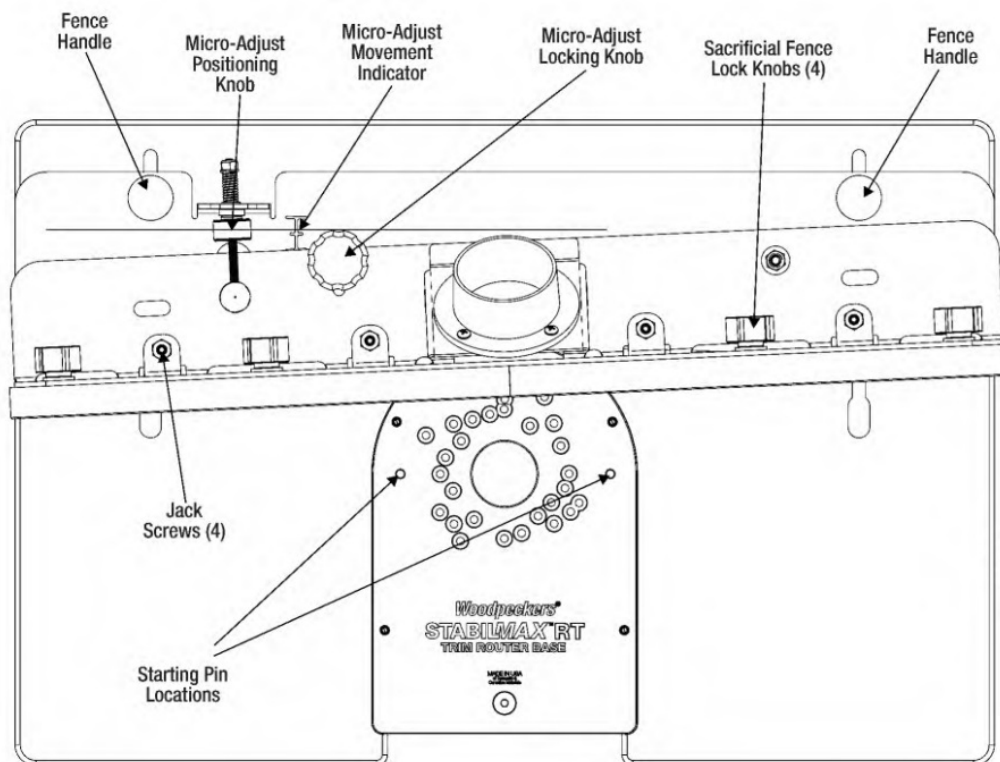

NOTE: The Micro-Adjust positions the Fence by pivoting. Your Fence does not need to be parallel to the front of Table. The round cutter will always cut at a tangent parallel to the Fence.

MOUNTING YOUR STABILMAX RT RACK-IT™

1. Find a suitable location on your wall and locate a wall stud.
2. Drill (1) 3/16" pilot hole the stud at the desired height.
3. Install (1) lag bolt into the wall. Do not tighten.
4. Place one half of the Rack-it onto the lag bolt and hold plumb and mark the second hole.
5. Remove the Rack-it, drill the second pilot hole and install the second lag bolt. Do not tighten.
6. Place the Right bracket (marked with an "R") and then the Left bracket onto the lag bolts and tighten.

NOTE: The rectangular holes in the Rack-It are to store a pair of track clamps (sold separately).

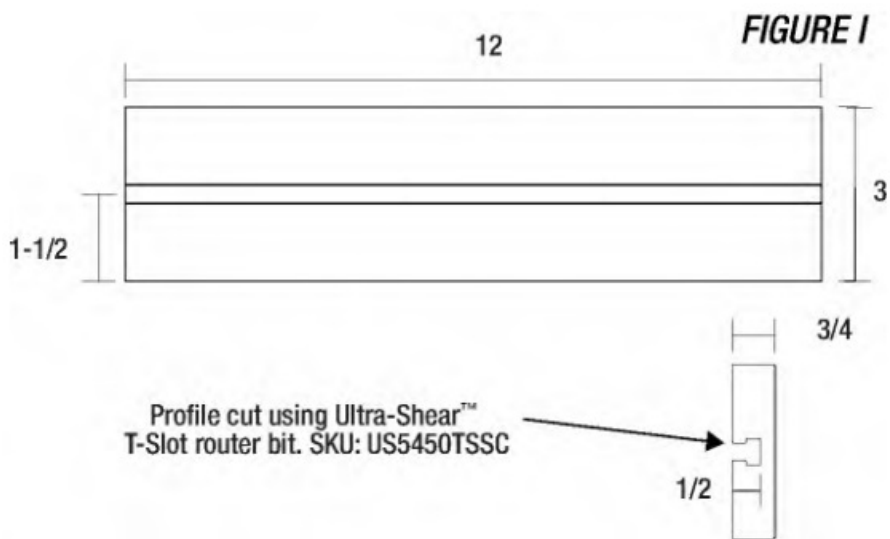

STABILMAX RT ROUTER TABLE TIPS & TRICKS

- 1. If the Legs are not long enough to accommodate the full length of your router (especially if using a cordless router with a large battery), the Legs' length can be extended by mounting scrap wood to the bottom flange of each Leg.
- 2. The marks adjacent the Micro-Adjust Knob are to indicate the Micro-Adjust travel. The intent is to keep the Micro-Adjust module centered on these marks, giving you ample travel either way when micro-adjusting. A good practice would be to re-center the Micro-Adjust after completing an operation.
- 3. The (2) Sacrificial Fences are symmetrical about their two axes. If the Fence is cut to create a zero-clearance setup, the Fence may be rotated and swapped side-for-side, allowing you to cut into all four corners before needing a replacement. The dimensions for the Fence are included as Figure I.



ADDITIONAL ACCESSORIES

DESCRIPTION	SKU
Additional Sacrificial Fences	SMRT-SFO
Rack-It	SMRT-RI
Starting Pin	STRTPIN5
Semble Screw-Type Track Clamps (2 pack)	G20KP-2
Semble Screw-Type Track Clamps (4 pack)	G20KP-4
Semble Ratcheting Track Clamps (4 pack)	G20KL-4P

WARNING! To reduce the risk of injury keep hands away from moving parts. Refer to your power tool manual for proper setup and use.

WARNING! To reduce the risk of injury, wear safety goggles or glasses with side shields, ear protection & a dust mask.

Woodpeckers, LLC Strongsville, Ohio woodpeck.com © 2024 Woodpeckers, LLC

**woodpeck.com**

At Woodpeckers we are constantly reviewing & improving our tools. The most current version of our instruction manuals are always available to download at woodpeck.com.
(Located in the bottom section of the tool's page under the "Additional Information" or "Instructions" tabs.)

**eCLUB**

Be the first to know all the new products, *OneTIME* Tools & sales by subscribing to our eClub. *(Located at the top center of our webpage woodpeck.com.)*

**YouTube**

Subscribe to our YouTube channel to stay up-to-date on all the latest tool tips & tricks.

**INTERACT WITH US!**

Follow us on Facebook, Instagram & TikTok!

**KNO THOLE**

Enjoy shop tips, project ideas, tool techniques & more in our Woodworking Resource Center/Blog. *(Located at the bottom center of our webpage woodpeck.com.)*

woodpeck.com



WARNING! This product can expose you to chemicals, including chromium, which is known to the State of California to cause cancer and birth defects or other reproductive harm. For more information go to www.P65Warnings.ca.gov

Documents / Resources

	<p>Woodpeckers StabilMAX RT Router Table [pdf] Owner's Manual StabilMAX RT Router Table, RT Router Table, Router Table, Table</p>
---	---

References

- [W Woodworking Tools Designed and Made in USA | Woodpeckers](#)
- [P65Warnings.ca.gov](#)
- [User Manual](#)

[Manuals+](#), [Privacy Policy](#)

This website is an independent publication and is neither affiliated with nor endorsed by any of the trademark owners. The "Bluetooth®" word mark and logos are registered trademarks owned by Bluetooth SIG, Inc. The "Wi-Fi®" word mark and logos are registered trademarks owned by the Wi-Fi Alliance. Any use of these marks on this website does not imply any affiliation with or endorsement.