

Woan Technology TH S1 SwitchBot Thermometer and Hygrometer User Guide

[Home](#) » [Woan Technology](#) » Woan Technology TH S1 SwitchBot Thermometer and Hygrometer User Guide 

Contents

- 1 [Woan Technology TH S1 SwitchBot Thermometer and Hygrometer](#)
- 2 [SWICHTHBOT Thermometer and Hygrometer](#)
- 3 [Woan Technology TH S1 SwitchBot Thermometer and Hygrometer](#)
- 4 [SWICHTHBOT Thermometer and Hygrometer](#)
- 5 [Woan Technology TH S1 SwitchBot Thermometer and Hygrometer](#)
- 6 [SWICHTHBOT Thermometer and Hygrometer](#)
- 7 [Woan Technology TH S1 SwitchBot Thermometer and Hygrometer](#)
- 8 [SWICHTHBOT Thermometer and Hygrometer](#)
- 9 [In The Box](#)
- 10 [Device Instructions](#)
- 11 [How To Install](#)
- 12 [Change the Temperature Unit](#)
- 13 [Reset the Device](#)
- 14 [Setting Alert](#)
- 15 [Remote Access](#)
- 16 [Scene](#)
- 17 [Voice Control](#)
- 18 [How to connect to Google Home](#)
- 19 [How to connect to HomePod/Siri](#)
- 20 [Work with IFTTT](#)
- 21 [History Data](#)
- 22 [Export the Data](#)
- 23 [Specification](#)
- 24 [FAQ](#)
- 25 [CE Warning](#)
- 26 [Documents / Resources](#)
 - 26.1 [References](#)
- 27 [Related Posts](#)

WOAN

Woan Technology TH S1 SwitchBot Thermometer and Hygrometer



SWICTHBOT Thermometer and Hygrometer

User Manual

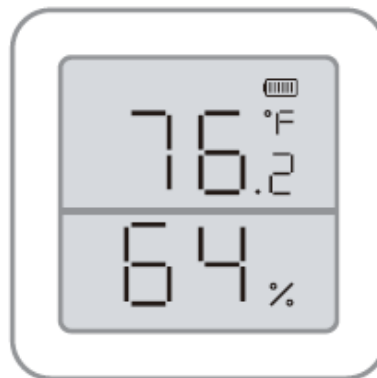

WOAN

Woan Technology TH S1 SwitchBot Thermometer and Hygrometer



SWICTHBOT Thermometer and Hygrometer

User Manual

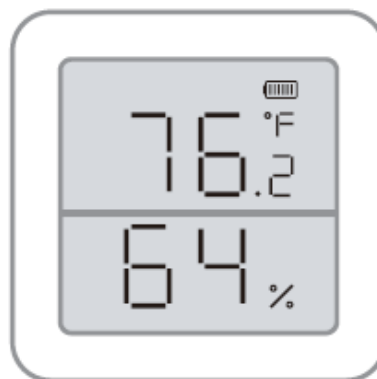

WOAN

Woan Technology TH S1 SwitchBot Thermometer and Hygrometer



SWICTHBOT Thermometer and Hygrometer

User Manual

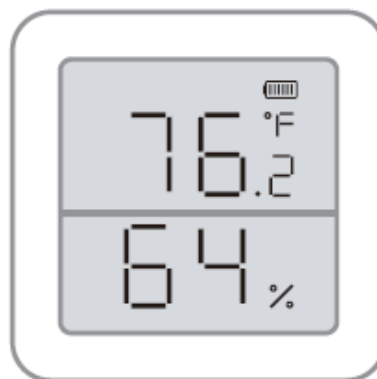

WOAN

Woan Technology TH S1 SwitchBot Thermometer and Hygrometer



SWICTHBOT Thermometer and Hygrometer

User Manual

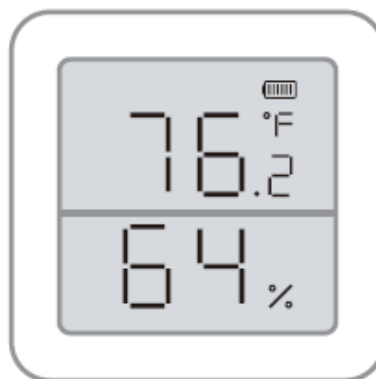

In The Box

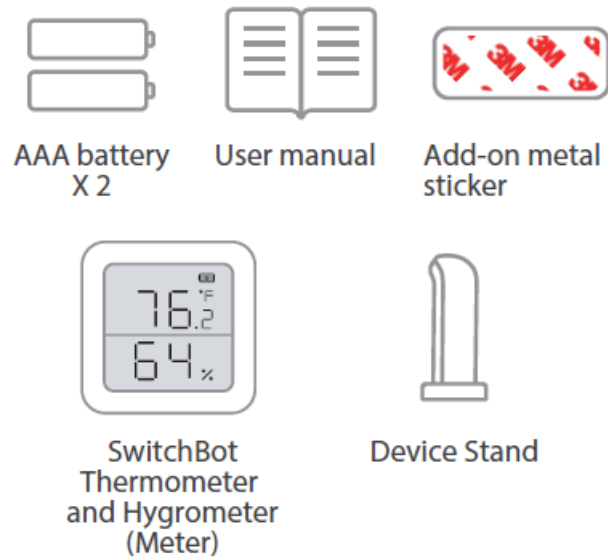

Device Instructions

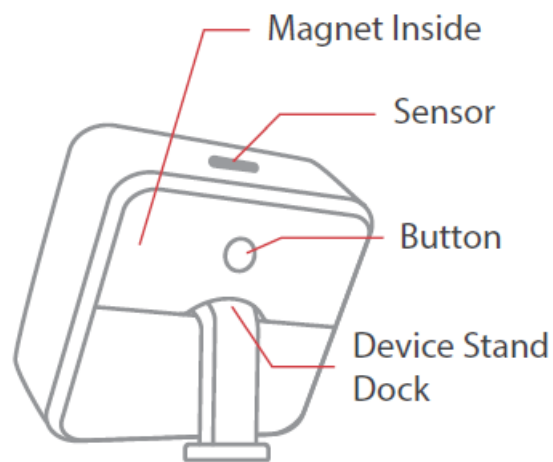

How To Install

1. Install two AAA batteries into the battery box.
- 2.

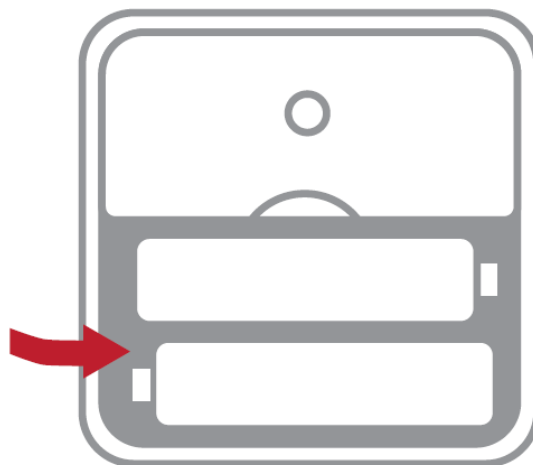

For non-iron surfaces, stick the add-on metal sticker to the surface. Then place Meter on the metal sticker.

- 3.



Get the SwitchBot app.

4. Create a SwitchBot account and sign in from the app's Profile page. Then add Meter to your account. Learn more at support.switch-bot.com/hc/en-us/articles/360038241053

Change the Temperature Unit

Press the button on the back of Meter once to change the temperature unit on the physical display. Learn more at support.switch-bot.com/hc/en-us/articles/360038241073

Reset the Device

Long press the button on the back of Meter for 15 seconds. Learn more at support.switch-bot.com/hc/en-us/articles/360037754854

Setting Alert

Setting Alert You could set up temperature/humidity alert with Meter and it will send notifications to your phone via Bluetooth. * If you are using an Android phone, a SwitchBot Hub Plus/Mini is required to use this feature. Learn more at support.switch-bot.com/hc/en-us/articles/360038241413

Remote Access

If you have a SwitchBot Hub Plus/Mini (sold separately), you could monitor Meter remotely and history data will be synced to SwitchBot server via the Hub device. * Enable Cloud Service first while using with a Hub Plus/Mini. Learn more at support.switch-bot.com/hc/en-us/articles/360038241053

Scene

If you have a SwitchBot Hub Plus/Mini (sold separately), you could create automation or scenes with Meter. You could turn on/off SwitchBot devices and home appliances triggered by temperature/humidity thresholds. Learn more at support.switch-bot.com/hc/en-us/articles/360037755654

Voice Control

If you have a SwitchBot Hub Plus/Mini (sold separately), you could get current temperature or humidity using voice commands with Alexa, Google Assistant, Siri, or more. * Enable Cloud Service first before using voice control services. support.switch-bot.com/hc/en-us/articles/360038241993

How to connect to Google Home

support.switch-bot.com/hc/en-us/articles/360037755234

How to connect to HomePod/Siri

support.switch-bot.com/hc/en-us/articles/360038242593

Work with IFTTT

support.switch-bot.com/hc/en-us/articles/360039457314

History Data

On Meter's History page, you could review temperature and humidity data in interactive graphs. Tap a point on the graph to see data at a specific moment. Learn more at support.switch-bot.com/hc/en-us/articles/360060298693

Export the Data

Export the DataOn Meter's History page, tap Export Databelow the graphs to save data as a .csv file.* Turn off Cloud Service on Meter's Settingspage first for more up-to-date data support.switch-bot.com/hc/en-us/articles/

Specification

SwitchBot Meter has one year warranty (start from the purchasing day). The situation below do not fit the Return and Refund Policy

- Intended damage or abuse.
- Inappropriate storage (drop down or soaking in water).
- User modify or repair.
- Using loss.
- Force majeure damage (Natural disasters).

FAQ

The Meter shows nothing.

Please change the batteries.

The alert doesn't work.

Please place the Meter in the Bluetooth range from your phone.

The history data doesn't show up.

Please place the Meter in the Bluetooth range from your phone.

If you have any concern or problem when using our products, please kindly send feedback from the Profile > Feedback page in the SwitchBot app.

CE Warning

Documents / Resources

	<p>Woan Technology TH S1 SwitchBot Thermometer and Hygrometer [pdf] User Guide METERTH, 2AKXB-METERTH, 2AKXBMETERTH, TH S1 SwitchBot Thermometer and Hygro meter, TH S1, SwitchBot Thermometer and Hygrometer</p>
---	---

References

-  [SwitchBot Official Website - Your Simple Switch to a Smart Home – SwitchBot International](#)