



Programming Wireless Keyless Entry Pad WKCC User Guide

[Home](#) » [WKCC](#) » Programming Wireless Keyless Entry Pad WKCC User Guide 

Programming Wireless Keyless Entry Pad WKCC User Guide



Contents

- [1 Instructions](#)
- [2 To Add Personal Codes](#)
- [3 Operation](#)
- [4 Removing ALL Personal Code\(s\)](#)
- [5 Mounting the Keyless Entry](#)
- [6 Replacing Keyless Entry Batteries](#)
- [7 Documents / Resources](#)
- [8 Related Posts](#)

Instructions

NOTE: DO NOT OBSTRUCT THE PHOTO-EYE BEAM DURING LEARN MODE. BREAKING THE BEAM AFTER PRESSING THE LEARN BUTTON CAN CAUSE A FAULT IN THE LEARN PROCESS.

To Add Personal Codes

1. Press/Release the “LEARN” button on the rear control panel, courtesy light will glow# or “OK” LED will glow and beep*. The unit is now ready to accept a transmitter in the next 30 seconds as shown in **Fig.1**.

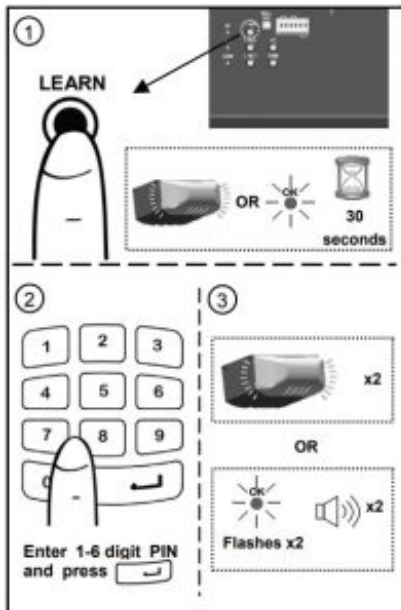

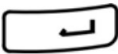

2. Enter 1 – 6 digit(s) personal code on the Keyless Entry within 30 seconds and press/release  button.
3. Courtesy light will flash twice# or “OK” LED will flash and beep twice* indicating personal code is stored in memory.

Up to 20 personal codes (including 1-button transmitters) can be added to the unit by repeating the above procedures.

If more than 20 personal codes are stored, the previously stored one from the very beginning will be replaced, i.e. the 21st transmitter replaces the 1st stored one.

Operation

To access the door, enter a pre-stored personal code and press  to transmit code, and within 20s, the  button can be used to stop or reverse the door.

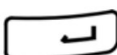
If the code is entered incorrectly, correction can be made by pressing  to reset and re-enter code.

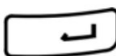
When dark,  may be pressed in advance to turn on back light.

Removing ALL Personal Code(s)

To remove ALL personal code(s) and/or transmitters from memory, press and hold the “LEARN” button for 5 seconds. Courtesy light will flash or “OK” LED will flash and beep, indicating ALL codes/transmitters have been removed from memory.

For units with AC motor
For units with DC motor

Mounting the Keyless Entry

Keyless Entry may be secured on door jamb face outside your garage. Refer to Fig.2, locate the Keyless Entry within sight of door at minimum height of 5 feet (1.5m), ensure it is away from reach of children and moving parts of door and hardware. Test the reception of the Keyless Entry before mounting. Change location for better reception if necessary.

Use the mounting holes on the Keyless Entry as template to mark position on the mounting surface. On wooden use the screws provided. In case of drywall surface, drill holes and use drywall anchors provided.

Replacing Keyless Entry Batteries

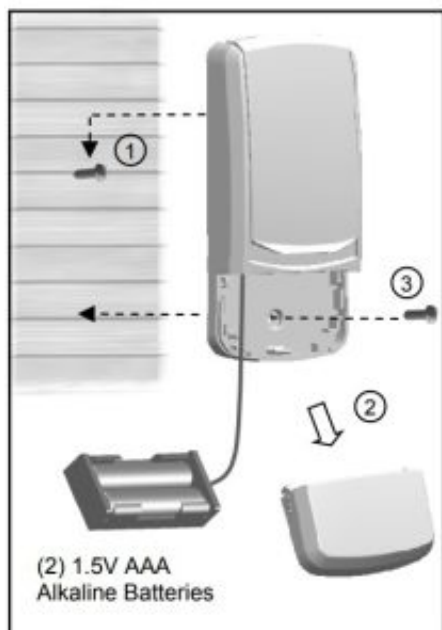

When the battery of Keyless Entry is low, dimmed illumination is observed. To replace batteries, remove the battery cover, replace the batteries with (2) 1.5V AAA alkaline batteries.

Documents / Resources

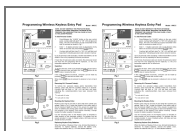

[WKCC Programming Wireless Keyless Entry Pad WKCC](#) [pdf] User Guide
WKCC, Programming, Wireless, Keyless Entry Pad, WKCC