



## WIZMAX WM3 Mouse User Manual

[Home](#) » [WIZMAX](#) » WIZMAX WM3 Mouse User Manual 

### Contents

- [1 WIZMAX WM3 Mouse](#)
- [2 Product Structure](#)
- [3 Features](#)
- [4 Product Warranty](#)
- [5 Federal Communication Commission Interference Statement](#)
  - [5.1 FOR PORTABLE DEVICE USAGE](#)
- [6 Documents / Resources](#)
- [7 Related Posts](#)



**WIZMAX**  
*DESIGN YOURSELF*

**WIZMAX WM3 Mouse**



## Product Structure

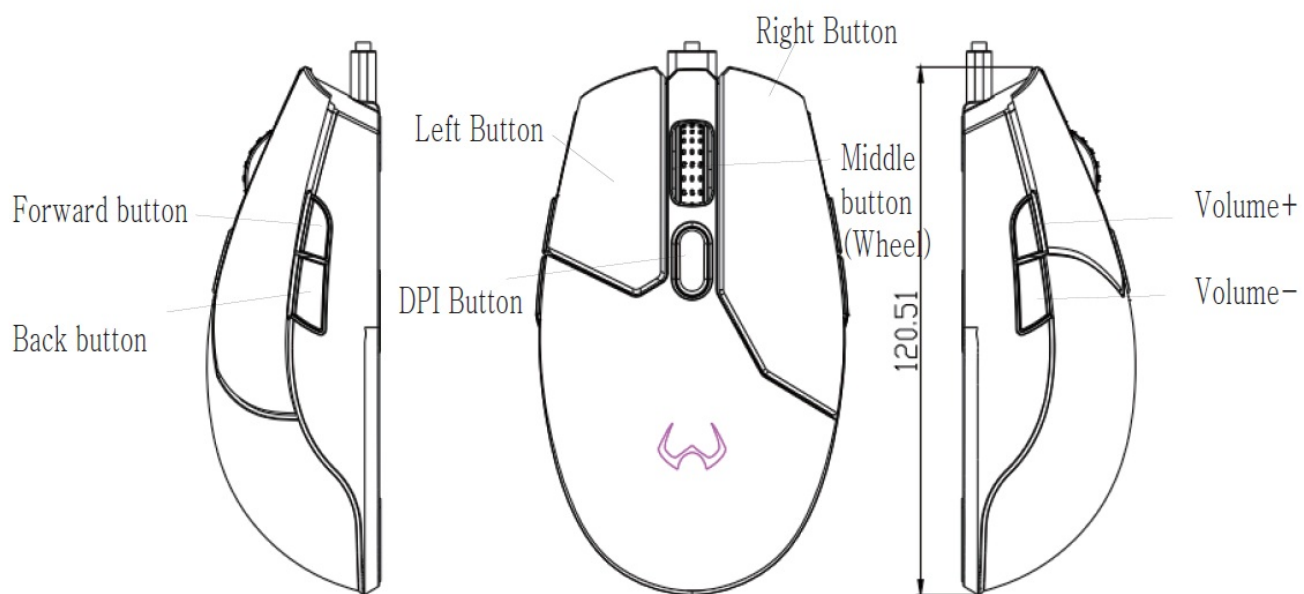

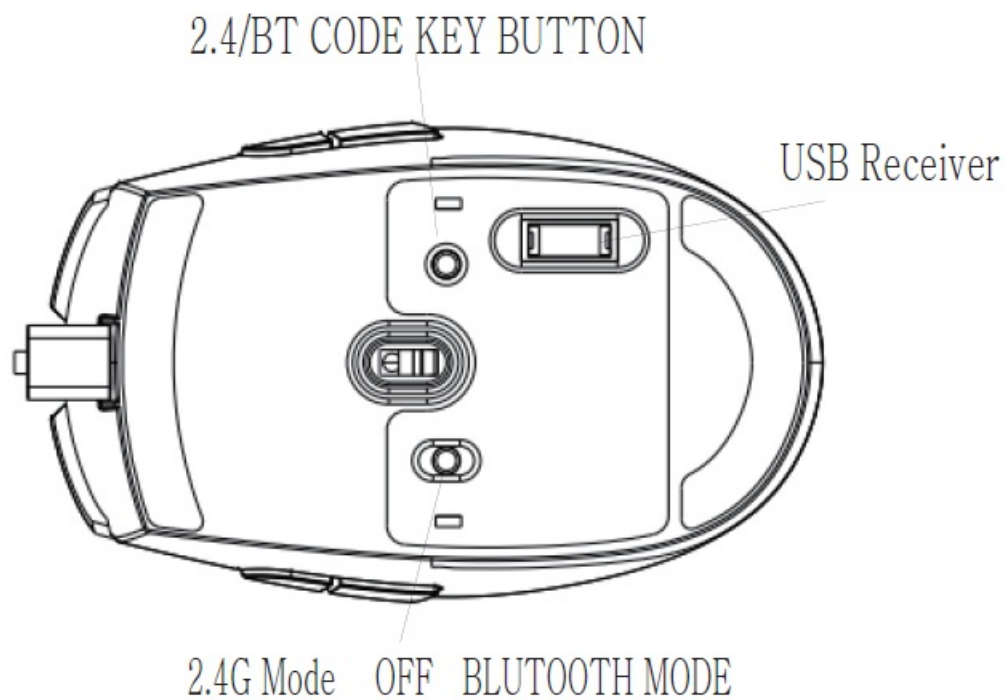

## Features

### Product Features

- Sensor:PAW3335
- Switch: HUANO
- Dimension:120.5×74.5×41.6mm
- Lifespan of switch:20 million times Polling rate 1000HZ
- DPI :800~16,000 (7step)
- Acceleration: 40G
- Operating current:< 120mA
- Operating voltage DC 5V
- LED RGB patterns
- Interface USB+2.4G +bluetooth
- Cable length 1.8M
- Cable material: Black fabric cable

### System Compatibility

Windows XP/7 /8/10

### DPI setting

Click the DPI button to change the DPI and lighting color in 7 steps, and you can adjust the DPI more precisely from 800 to DPI through dedicated software.

### Product Warranty

The compensation standards for product repair, replace, and refund are guaranteed as follows in accordance with our A/S terms and conditions. You can check our A/S terms and conditions and service-related details on our website.

- Model Mouse
- Date of purchase Year Month Day
- Dealer
- Name
- Mobile

### **Service Standard Notes**

For the determination of the warranty period, be sure to keep the purchase receipt or purchase statement based on the purchase date. If the product purchase date cannot be confirmed, the service period will be set based on the product production date.

### **Free service standard**

In the case of a problem due to defective product quality during the warranty period after product supply, A/Sis supported.

1. Within 15 days of purchasing the product: We will pay the full cost of the round-trip courier.
2. Within 1 year of product purchase: 50%: 50% paid by the customer and our company.
3. More than 1 year after purchasing the product: the full cost of the round trip delivery fee will be charged to customers.

### **Paid service standard**

1. In case of consumer negligence (random disassembly, careless handling, modification, fall, etc.) or accident (fire, flood, natural disaster, etc.).
2. When the free warranty period has expired.
  - If you disassemble or modify the product arbitrarily, you may be damaged by electric shock, and you cannot receive the benefits of free service.
  - Do not use liquid to clean the product.
  - Do not use the product in dangerous places.

### **Federal Communication Commission Interference Statement**

This device complies with Part 15 of the FCC Rules. Operation is subject to the following two conditions:

1. This device may not cause harmful interference, and
2. This device must accept any interference received, including interference that may cause undesired operation.

This equipment has been tested and found to comply with the limits for a Class B digital device, pursuant to Part 15 of the FCC Rules. These limits are designed to provide reasonable protection against harmful interference in a residential installation. This equipment generates, uses and can radiate radio frequency energy and, if not installed and used in accordance with the instructions, may cause harmful interference to radio communications. However, there is no guarantee that interference will not occur in a particular installation. If this equipment does cause harmful interference to radio or television reception, which can be determined by turning the equipment off and on, the user is encouraged to try to correct the interference by one of the following measures:

- Reorient or relocate the receiving antenna.
- Increase the separation between the equipment and receiver.

- Connect the equipment into an outlet on a circuit different from that to which the receiver is connected.
- Consult the dealer or an experienced radio/TV technician for help.

**FCC Caution:** Any changes or modifications not expressly approved by the party responsible for compliance could void the user’s authority to operate this equipment.  
This transmitter must not be co-located or operating in conjunction with any other antenna or transmitter.

**FOR PORTABLE DEVICE USAGE**

**Radiation Exposure Statement:**

The product comply with the FCC portable RF exposure limit set forth for an uncontrolled environment and are safe for intended operation as described in this manual. The further RF exposure reduction can be achieved if the product can be kept as far as possible from the user body or set the device to lower output power if such function is available.

**Documents / Resources**

	<p><a href="#">WIZMAX WM3 Mouse</a> [pdf] User Manual WM3, 2A3QW-WM3, 2A3QWWM3, WM3 Mouse, Mouse</p>
---	--