



WITSHOCK C1YWWCGrx5L Computer Speaker Soundbar User Manual

[Home](#) » [WITSHOCK](#) » WITSHOCK C1YWWCGrx5L Computer Speaker Soundbar User Manual 

Contents

- 1 WITSHOCK C1YWWCGrx5L Computer Speaker Soundbar
- 2 SAFETY INSTRUCTIONS
- 3 SPECIFICATION
- 4 PACKING LIST
- 5 BUTTON OVERVIEW
- 6 PORT INSTRUCTION/ BT CONNECTION
- 7 USB-COMPATIBLE AUDIO FORMAT
- 8 BUTTON INSTRUCTION
- 9 FCC Requirement
- 10 Documents / Resources

WITSHOCK®

WITSHOCK C1YWWCGrx5L Computer Speaker Soundbar



Dear

It is with great pleasure that you chose our MX Gaming 2. We made this excellent computer speaker after touring many scenic spots, visiting many art galleries, and testing on dozens of games on Steam. Prominent lines, luxury spraying paint and dark metal mesh, add much hi-tech atmosphere, which must be the first choice for game enthusiasts. 7 dynamic lighting modes and 16 different lighting colors, you can set it by yourself to make the lighting change with music, create dreamlike lighting effects. Two 2.5" speakers and patented bass invert tube are built inside to bring you clear sound quality. Even though powered by USB, the computer speaker can provide wide frequency response up to 50 Hz.

Besides, we would like to introduce Lucia and Bestan to you, dear customers. Lucia, who is born in Leo Galaxies Group, is the first heroine in WITSHOCK Universe; Bestan is her guardian. They are virtual characters we create for MX Gaming 2, and if you like them, we may publish a series of new characters from WITS HOCK Universe and produce short animations about their stories in the future. Hope that all your game life will be accompanied by WITS HOCK.

SAFETY INSTRUCTIONS

1. Please set up your MX Gaming 2 on a stable surface that allows for adequate air circulation
2. Do not use or install the apparatus near water, moisture, or other wet surfaces.
3. Install the apparatus in a cool and dry place. Do not block any ventilated vents or openings
4. Do not use or install near any heat or flame sources. Do not use around radiators, stoves, candles or other hot surfaces
5. Do not insert or push any objects into openings on the apparatus.
6. Do not place any object containing liquid on the apparatus, such as vase.
7. Unplug the apparatus during thunderstorms or when you do not use it for a long time
8. Only use original accessories produced by authorized manufacturer.
9. Store well the attached adapter and audio cable, especially the plug and ports
10. Clean only with a dry or damp cloth. Unplug the apparatus before cleaning and do not use aerosol or liquid cleaning agents
11. Refer all maintenance to qualified service personnel. Do not attempt to repair or dismantle this apparatus yourself. Removing the shell will expose you to dangerous electric currents.

CAUTIONS

1. Only use 5V output power adapter, do not use adapter over 5V output.
2. Make sure the exchangeable adapter plug is fully inserted into the power adapter before plugging the adapter into a power outlet
3. Unplug this apparatus during thunderstorms or when unused for a long time to further protect the apparatus
4. Protect the power cord from being walked on or pinched, particularly at plugs, socket, or the point where they exit from the apparatus
5. Do not overload wall electricity outlets, extension cords and plugs, or it may result in fire or electrical shock.
6. Disconnect the power adapter or any other cables if any of the following conditions exists:
 1. You want to clean the apparatus;
 2. The power cord or plug becomes frayed or even damaged;
 3. The apparatus is exposed to rain, excessive moisture, or liquid spilled into the case;
 4. The apparatus has been dropped and damaged, or you suspect that service or repair is required.

Power Cable for MX Gaming 2

WARNING The power port is only compatible with OC5V output adapter, too high voltage may cause injury or damage.

SPECIFICATION

Model	MX Gaming 2
Adapter output	DC5V 2A
Adapter input	AC 110-220V
Speaker	2.5"/4Ω, 16W (8W x 2)
Sensitivity	Audio IN (sinusoidal signal), 1KHz, 800mV±100mV, 0dB
Rated output	5W (RMS), THD 10%
SNR	≥65 dB
Frequency response	50Hz-20kHz (±6 dB)
Audio input	BT, AUX, USB
BT version	V5.0 (EDR, 2.4GHz)
BT sensitivity	-85dBm, 0-12m
AUX	analog audio signal, 800mV (input sensitivity)
USB	support MP3, WMA, FLAC decoding, 128M-32G (capacity)
Headphone	3.5mm stereo output
Material	plastic, iron
Size	418 x 88 x 85 mm (L*W*H)

PACKING LIST

1. Computer speaker x 1
2. 5V 2A Adapter x 1
3. 3.5mm AUX cable x 1
4. User manual x 1
5. Virtual character sticker x 1



①

Computer speaker x 1

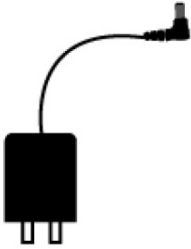

②

5V 2A Adapter



③

3.5mm AUX cable x 1



④

User manual x 1



⑤

Virtual character sticker x 1

If you have any questions about our products, please add WhatsApp groups.



WITSHOCK SOUNDBAR

Right here to help you! If you have any issues, questions, advices or concerns about our products, please contact us!

BUTTON OVERVIEW

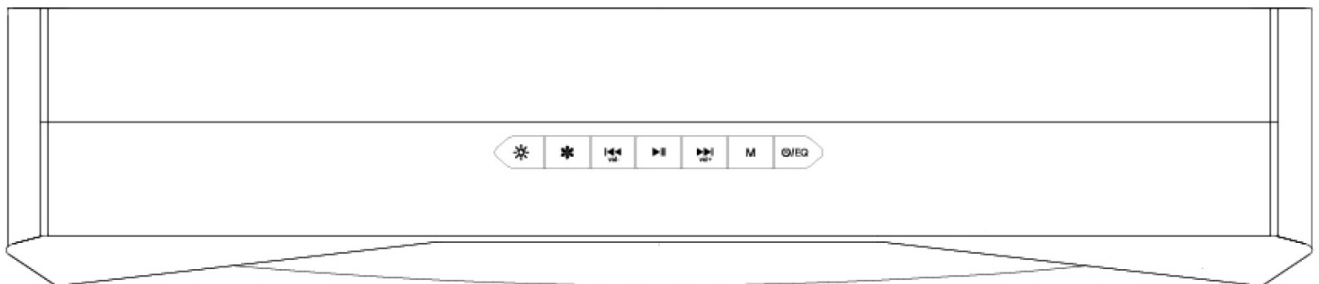

Short press to change 7 lighting modes
Long press for 5s to restore the factory settings



Short press to change 16 lighting colors
Long press for 1.5s to adjust brightness (4 levels)



Short press to increase or decrease volume
Long press for 1.5s to the last or next song



Short press to play or pause
Long press for 3s to disconnect with BT



Short press to change audio output mode:
AUX - BT - USB



Long press for 3s to turn it on/off
Short press to change sound effect

PORT INSTRUCTION/ DC IN

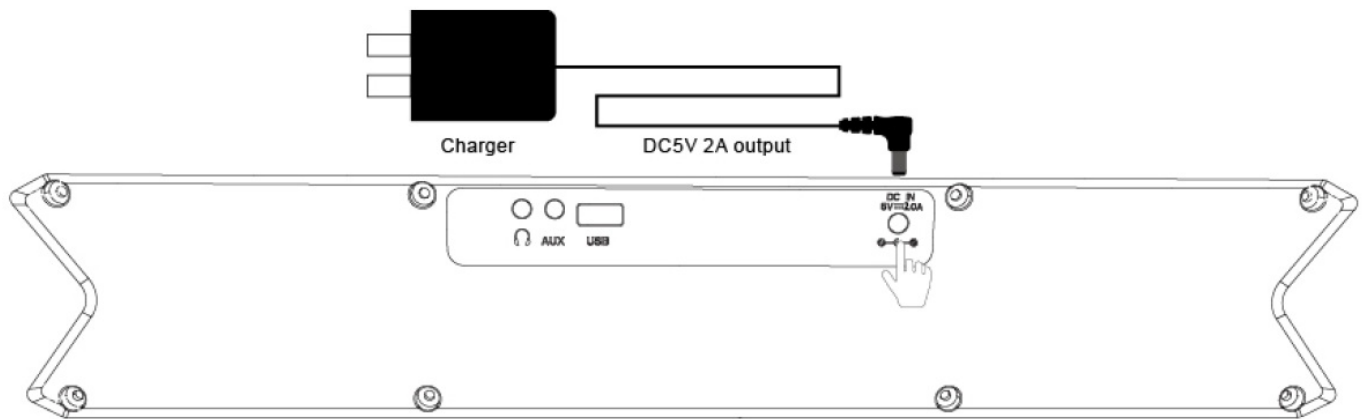

DC IN: Charge with DC5V adapter. Only use power adapter we provided to connect MX Gaming 2 ,or it may cause burning hazard

PORT INSTRUCTION/ BT CONNECTION

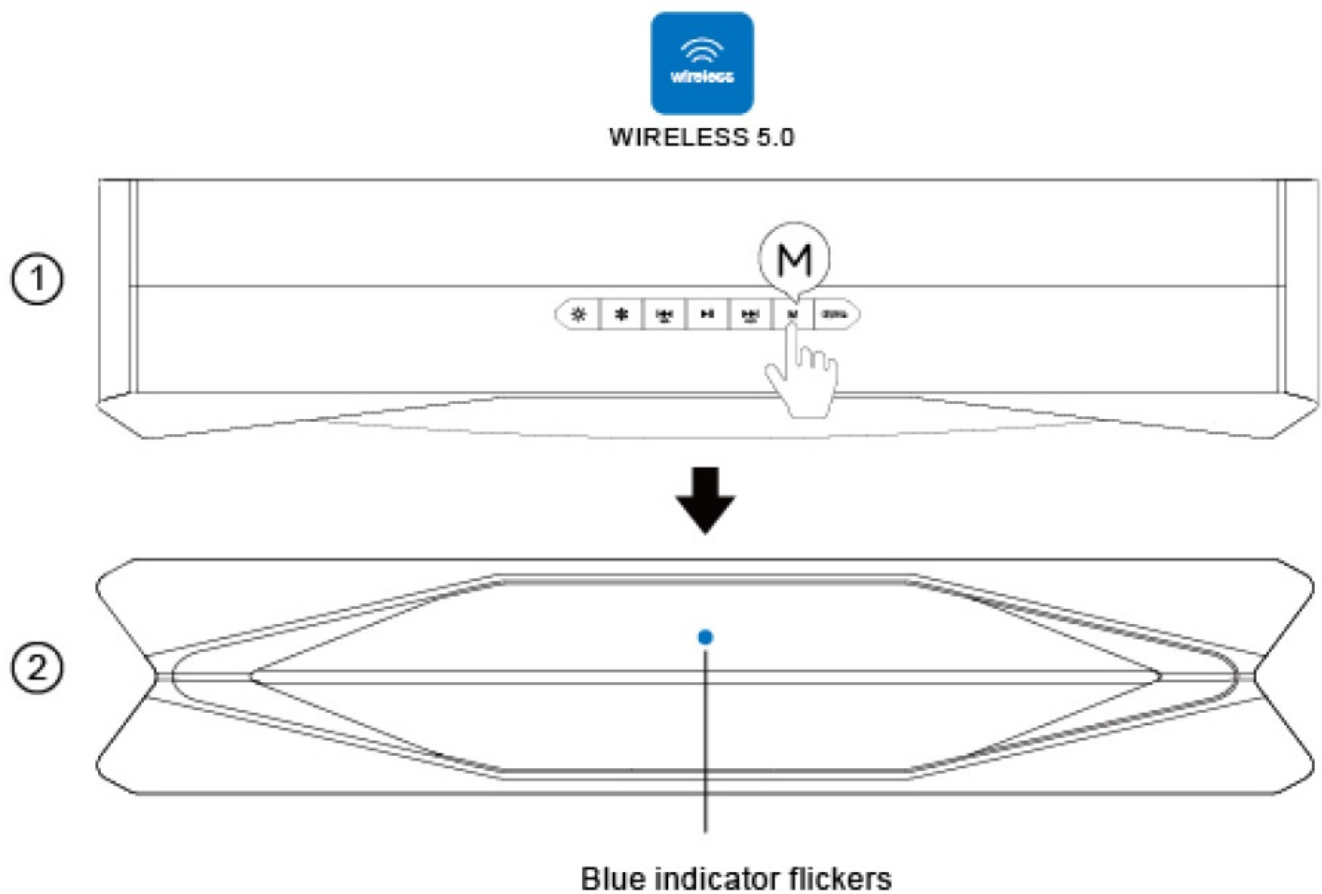

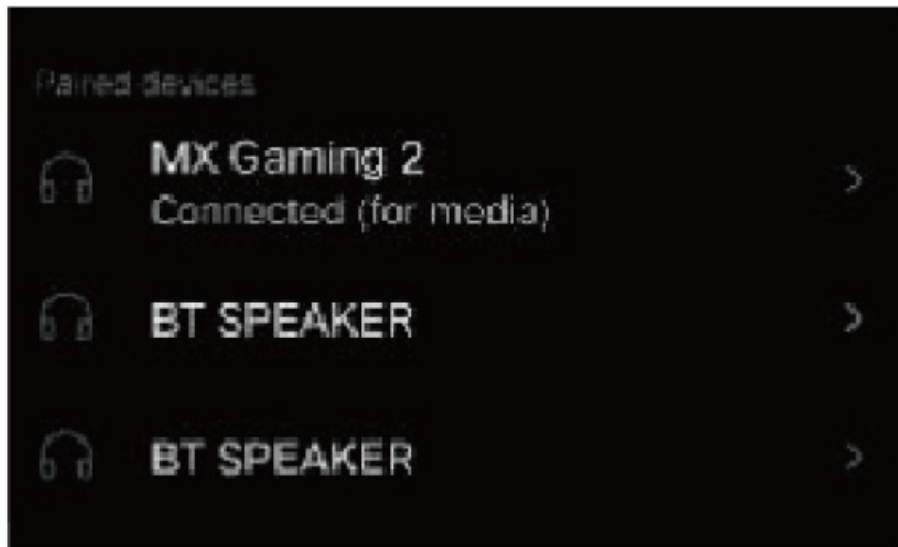

BT Connection: Connect to power supply and long-press the power button for 3s to turn it on. Short press the M button to enter BT mode, then blue indicator flickers. Turn on BT on your phone and search MX Gaming 2, click to connect with our computer speaker. After pairing, blue indicator flickers for 5s, and then light off.

PORT INSTRUCTION/ AUX IN

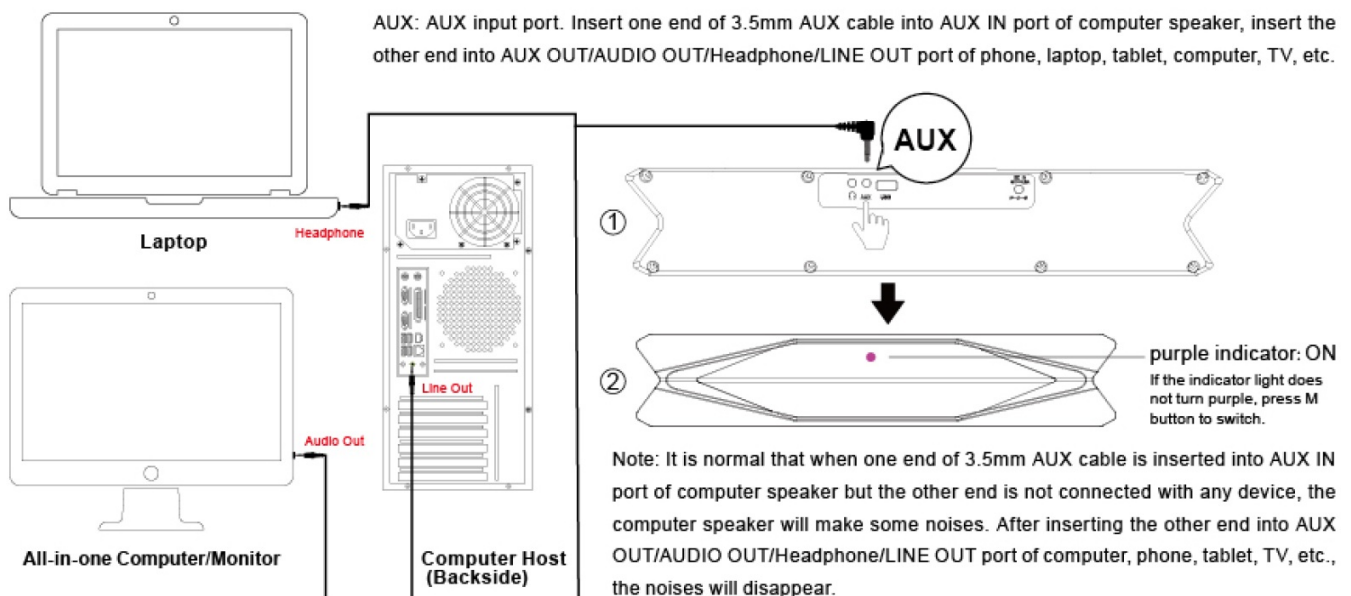

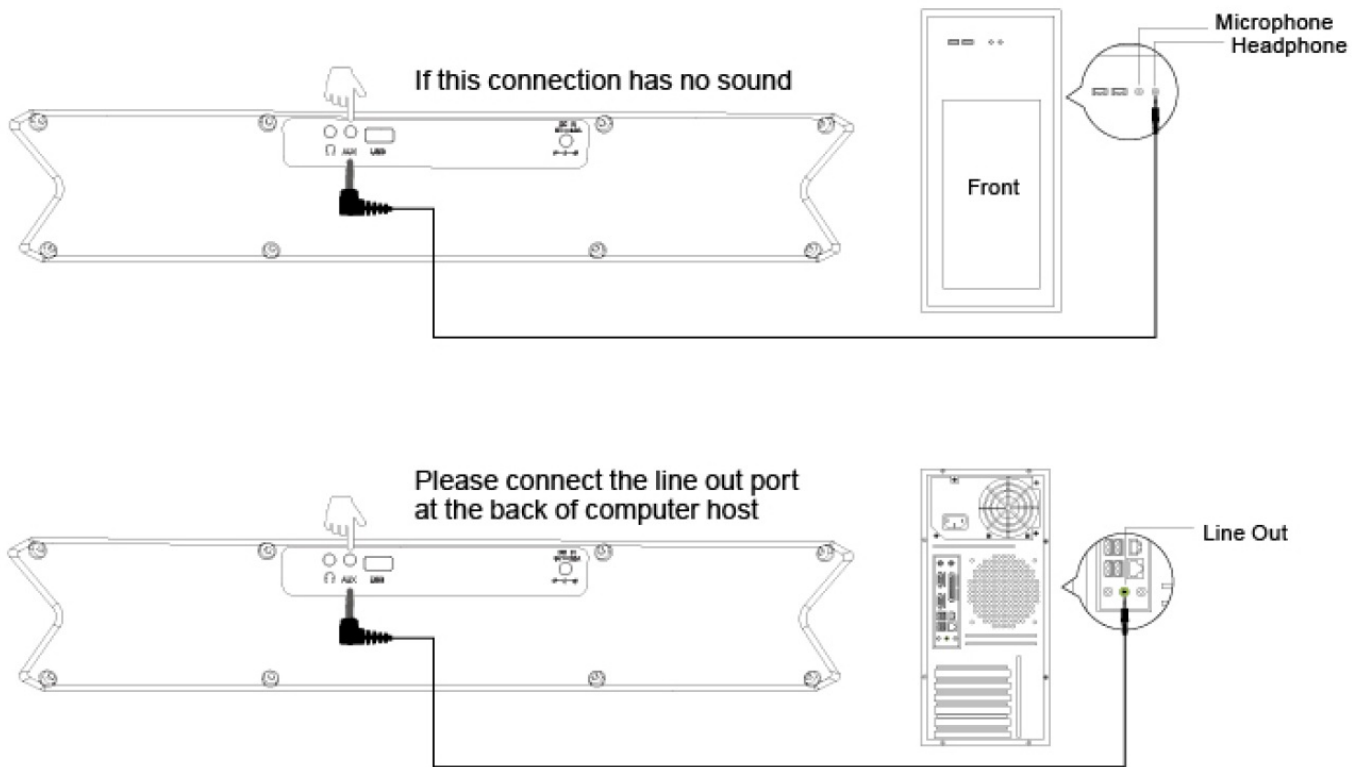

If there still is no sound, try to insert 3.5mm connector of AUX cable into LINE OUT port at the back of computer host. The computer will prompt you that speaker is added, you just need to click YES

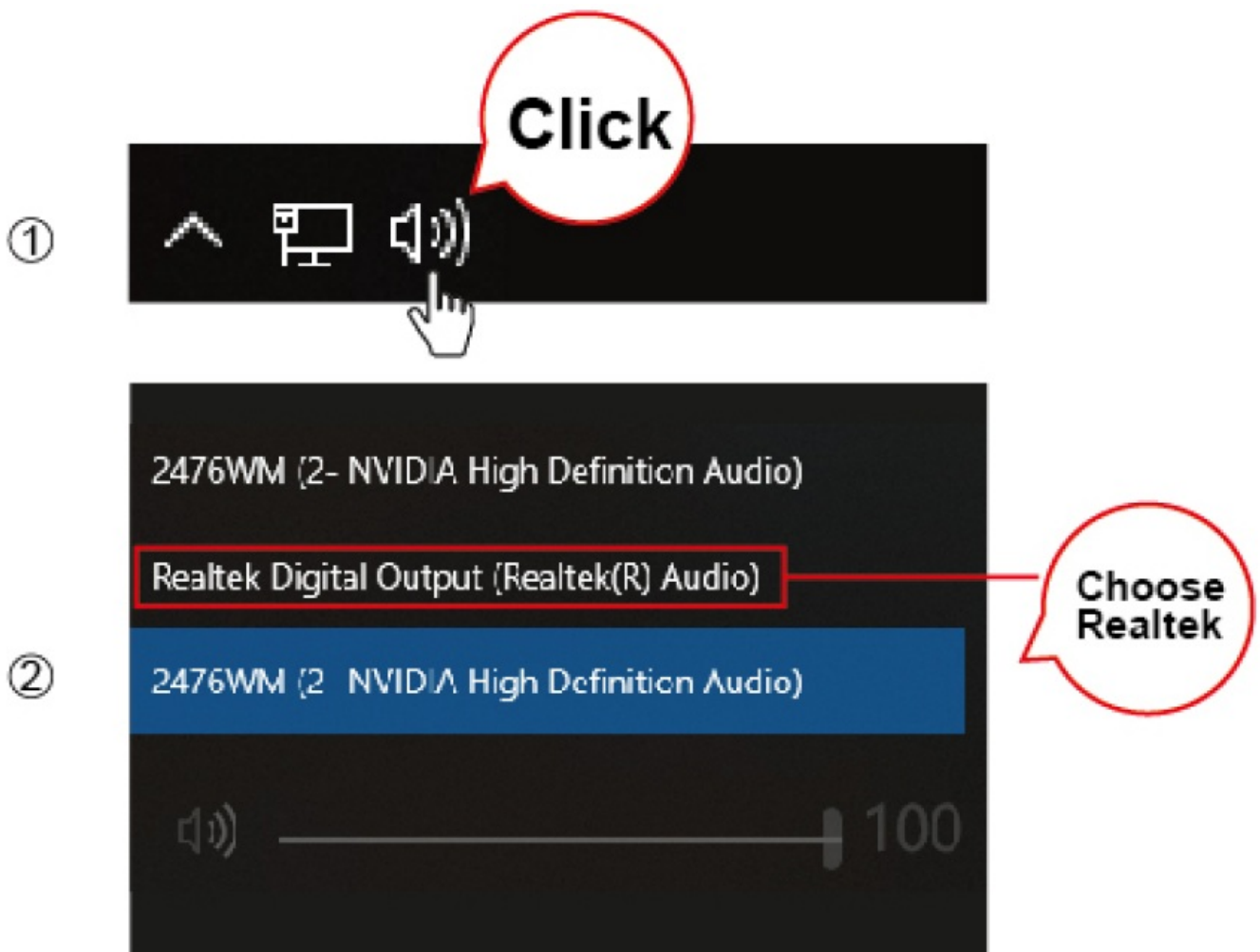

Note: Under AUX mode, if there is no sound after connecting to computer, please connect the AUX cable to 3.5mm headphone port at the back of computer host. If there still is no sound, you can try to click the sound icon in the lower right of Windows interface to change sound card settings

PORT INSTRUCTION/ HEADPHONE

Headphone: For connecting to headphone. Insert the headphone cable(not included) into the headphone port, you can hear audio transmitted from headphone.



After connecting to headphone,
you can hear from the headphone

PORT INSTRUCTION / USB



Insert U-disk into and the
computer speaker will automatically play audio files in the U-disk.

USB: LISS input port. Insert U-disk into the apparatus, the computer speaker will automatically enter USB mode and play audio files in the U-disk

Note: The computer speaker is only compatible with U-disk no more than 32GB. If you connect with USB hub or docking station, the computer speaker may not find USB device

USB-COMPATIBLE AUDIO FORMAT

Audio format	Bit rate	Sampling Rate	Bit	Coded format
MP3	8-320Kbps	8-48KHz	/	CBR/VBR
WMA	5-384Kbps	8-48KHz	16bit	WMA VER8/9/10 (not include WMA Lossless/Pro/Voice)
FLAC	/	8-48KHz	8/16/24bit	/
APE	/	8-48KHz	8/16/24bit	Compressed setting: High (less than 3000)
WAV	/	8-48KHz	8/16bit	PCM/ADPCM

BUTTON INSTRUCTION

Button



Function	Indicator (Prompt)
Long press for 3s to turn on/off; Under working mode, short press to change sound effect (music, game, female voice, HIFI, news).	Under standby mode: Red indicator flickers, RGB LED light is off; Red indicator will light off automatically if there is no operation in 15s. Press any button to enter standby mode again, red indicator flickers; Under working mode: Red indicator is off, RGB LED light is on
Short press to change audio output mode; ALIX – BT – USB, in a circle	BT mode: After pairing, blue indicator flickers for 5s, and then lights off; AUX mode: purple indicator keep steady on for 5s, and then lights off; LISS mode: automatically recognize and no indicator.
Short press to increase volume; Long press for 1.5s to the next song	Volume range from 0 to 20. There will be a beep when the volume is full.



Short press to pause/play; Long press for 3s to disconnect with BT.	USB and BT mode: short press to pause or play; AUX mode: short press to mute on, play.
Short press to decrease volume; Long press for 1.5s to the last song	Volume range from 20 to 0
Short press to change color; Long press for 1.5s to adjust brightness	All lighting modes can change color except mode 7; Under mode 7, lighting color only change with in color 0-7; Under mode 1-5, lighting color only change with color 0-15; Color 0 is changing color automatically, color 1-15 is 15 different single colors; 4-level brightness for adjustment in a cycle

FCC Requirement

changes or modifications not expressly approved by the party responsible for compliance could void the user's authority to operate the equipment. This device complies with Part 15 of the FCC Rules. Operation is subject to the following two conditions:

- (1) This device may not cause harmful interference, and
- (2) This device must accept any interference received, including interference that may cause undesired operation.

Note: This equipment has been tested and found to comply with the limits for a Class B digital device, pursuant to Part 15 of the FCC Rules. These limits are designed to provide reasonable protection against harmful interference in a residential installation. This equipment generates, uses, and can radiate radio frequency energy, and if not installed and used in accordance with the instructions, may cause harmful interference to radio communications. However, there is no guarantee that interference will not occur in a particular installation. If this equipment does cause harmful interference to radio or television reception, which can be determined by turning the equipment off and on, the user is encouraged to try to correct the interference by one or more of the following measures:

- Reorient or relocate the receiving antenna.
- Increase the separation between the equipment and receiver.
- Connect the equipment into an outlet on a circuit different from that to which the receiver is connected.
- Consult the dealer or an experienced radio/TV technician for help.

Documents / Resources

	<p>WITSHOCK C1YWWCGrx5L Computer Speaker Soundbar [pdf] User Manual C1YWWCGrx5L Computer Speaker Soundbar, C1YWWCGrx5L, Computer Speaker Soundbar, Speaker Soundbar, Soundbar</p>
---	---