



Wisenet TID-600R Network Intercom User Guide

[Home](#) » [WiSeNeT](#) » Wisenet TID-600R Network Intercom User Guide 

WiSeNeT

NETWORK INTERCOM
Quick Guide
TID-600R

Contents

- [1 TID-600R Network Intercom](#)
- [2 SAFETY INFORMATION](#)
- [3 COMPONENT](#)
- [4 INSTALLATION](#)
- [5 PASSWORD SETTING](#)
- [6 LOGIN](#)
- [7 Documents / Resources](#)
 - [7.1 References](#)
- [8 Related Posts](#)

TID-600R Network Intercom

Important

Please check 'Manuals' from our website, before connecting to the Supply,

<https://www.hanwha-security.com/en/data-center/download-data/>

We recommend using the officially compatible VMS version or the latest Hanwha NVR version when integrating with VMS or Hanwha NVR.



Hanwha Techwin cares for the environment at all product manufacturing stages and is taking measures to provide customers with more environmentally friendly products. The Eco mark represents Hanwha Techwin's devotion to creating environmentally friendly products and indicates that the product satisfies the EU RoHS

Directive.



Correct Disposal of This Product (Waste Electrical & Electronic Equipment)

(Applicable in the European Union and other European countries with separate collection systems) This marking on the product, accessories or literature indicates that the product and its electronic accessories (e.g. charger, headset, USB cable) should not be disposed of with other household waste at the end of their working life. To prevent possible harm to the environment or human health from uncontrolled waste disposal, please separate these items from other types of waste and recycle them responsibly to promote the sustainable reuse of material resources.

Household users should contact either the retailer where they purchased this product, or their local government office, for details of where and how they can take these items for environmentally safe recycling.

Business users should contact their suppliers and check the terms and conditions of the purchase contract. This product and its electronic accessories should not be mixed with other commercial wastes for disposal.



Correct disposal of batteries in this product

(Applicable in the European Union and other European countries with separate battery return systems.)

This marking on the battery, manual or packaging indicates that the batteries in this product should not be disposed of with other household waste at the end of their working life. Where marked, the chemical symbols Hg, Cd, or Pb indicate that the battery contains mercury, cadmium, or lead above the reference levels in EC Directive 2006/66. If batteries are not properly disposed of, these substances can cause harm to human health or the environment. To protect natural resources and to promote material reuse, please separate batteries from other types of waste and recycle them through your local, free battery return system.

SAFETY INFORMATION



COMPONENT

As for each sales country, accessories are not the same.

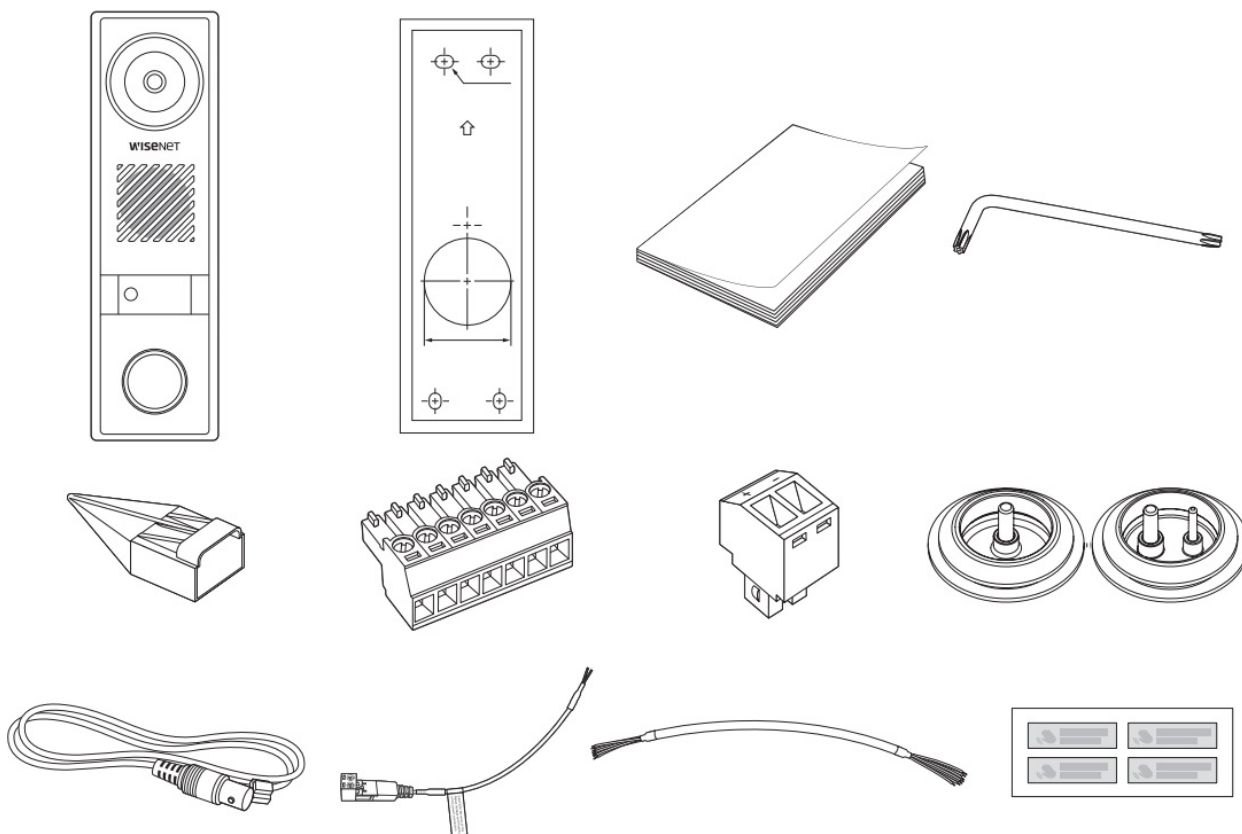

! Options (not included)

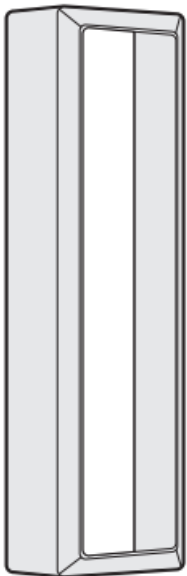
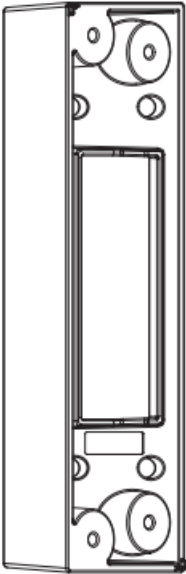
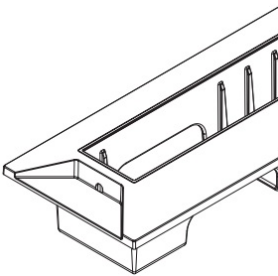
		
<p>Skin Cover : White SBC-165W</p>	<p>Tilt mount SBS-165TM</p>	<p>Flush mount SHS-165F</p>

INSTALLATION

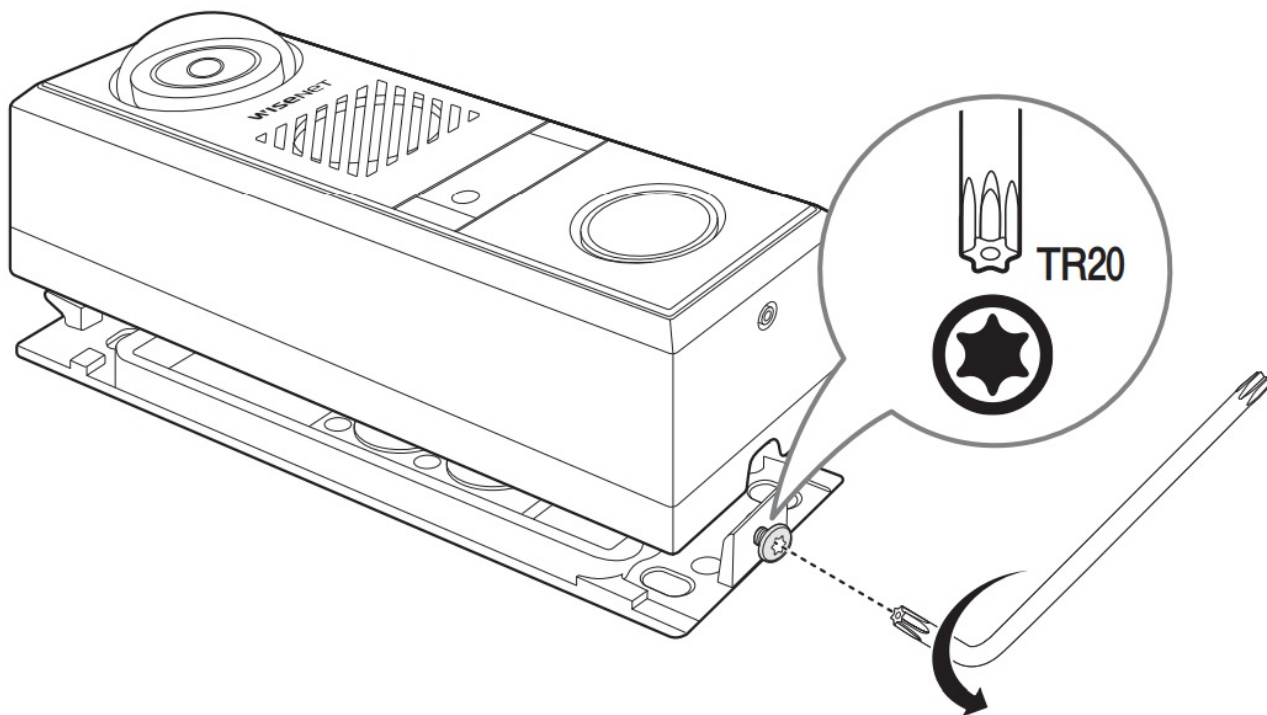

2 • Not Included : Micro SD Card

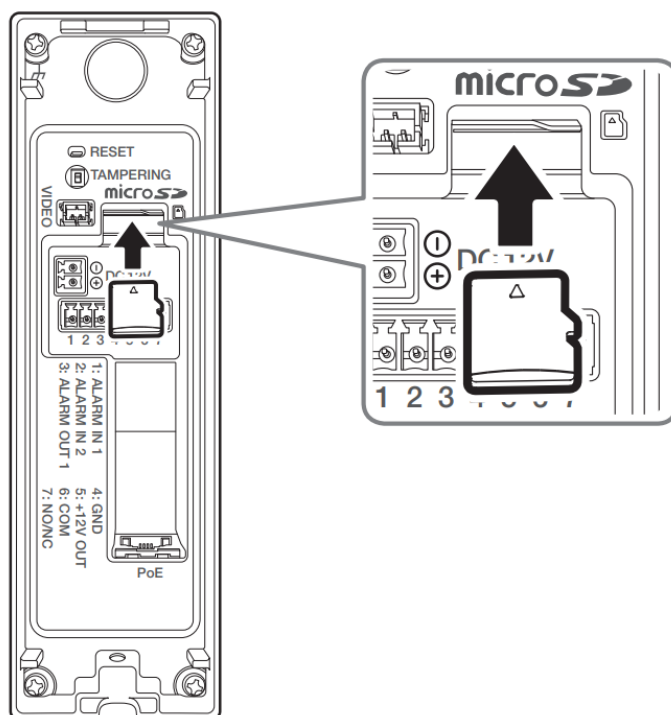

3

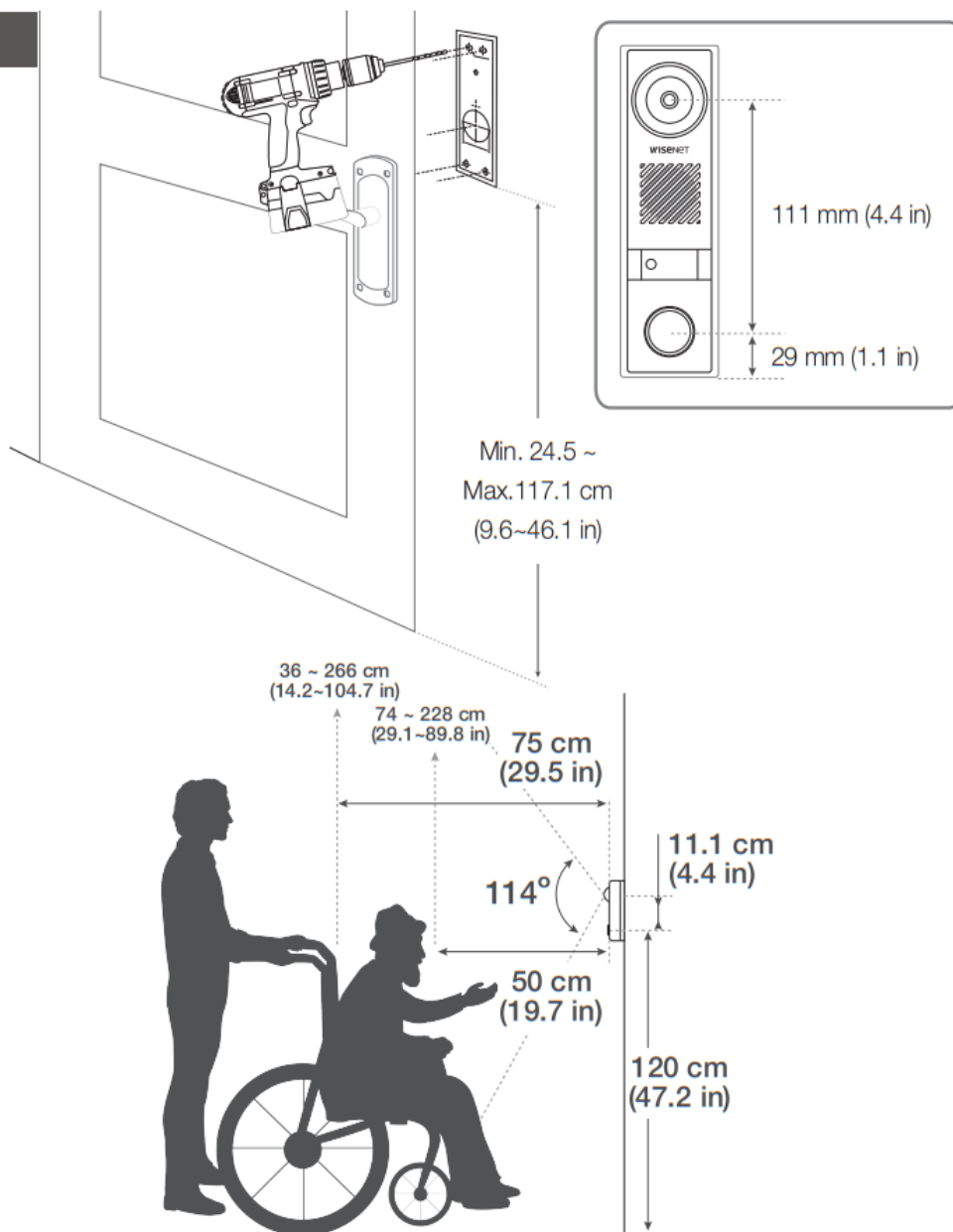

4

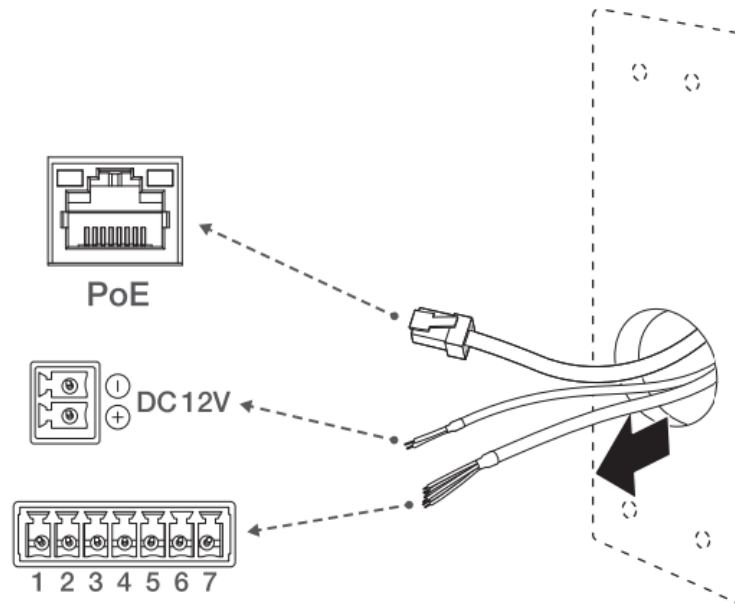

5

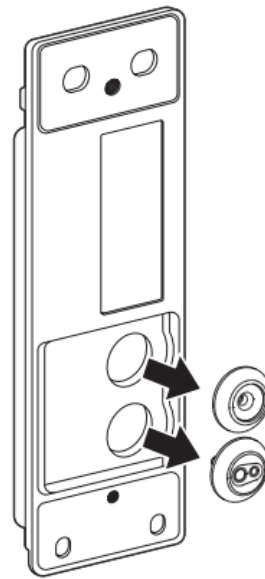

6 • Network cable installation

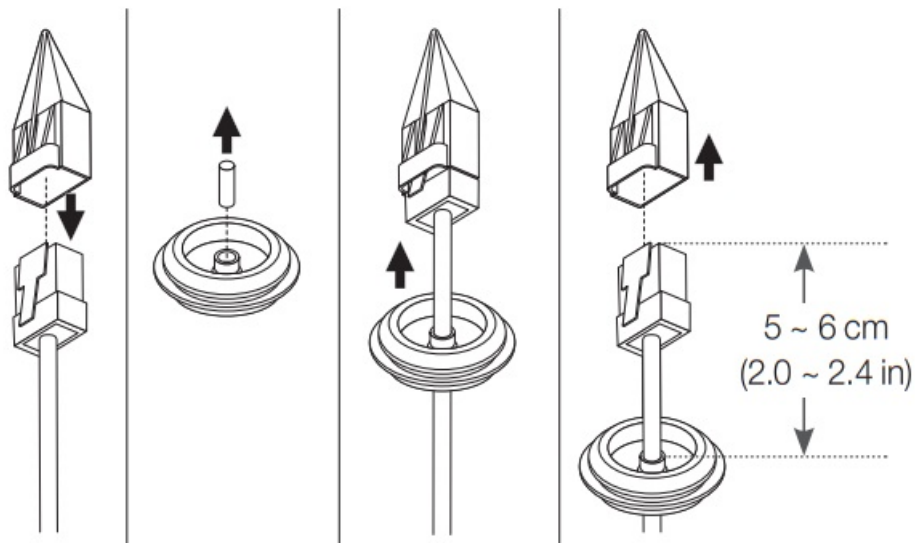

7 • Alarm cable and power cable installation

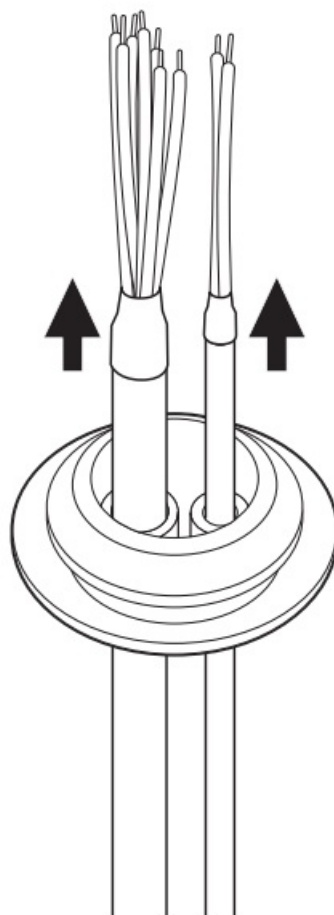
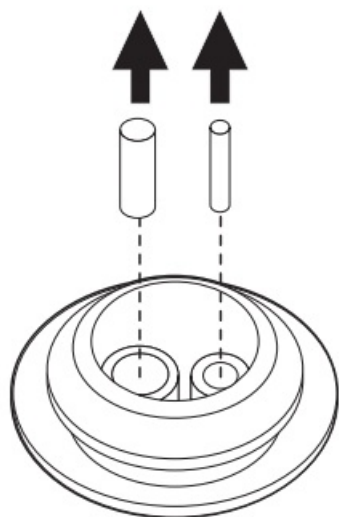

8

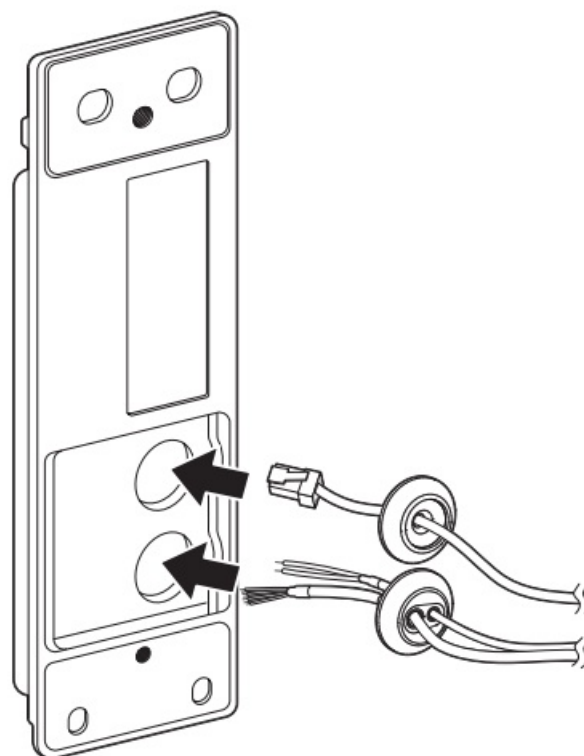

9

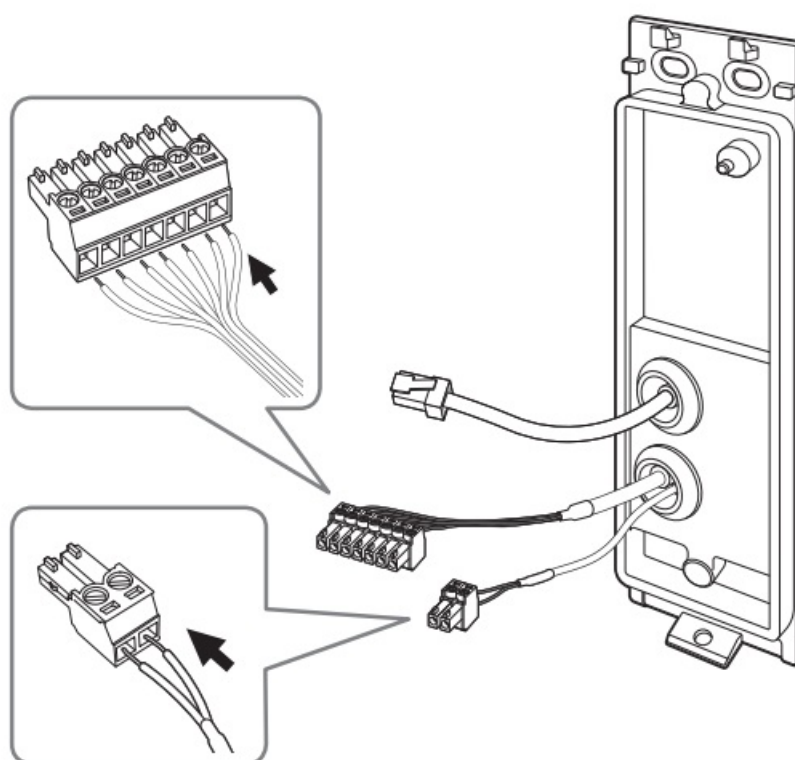

10

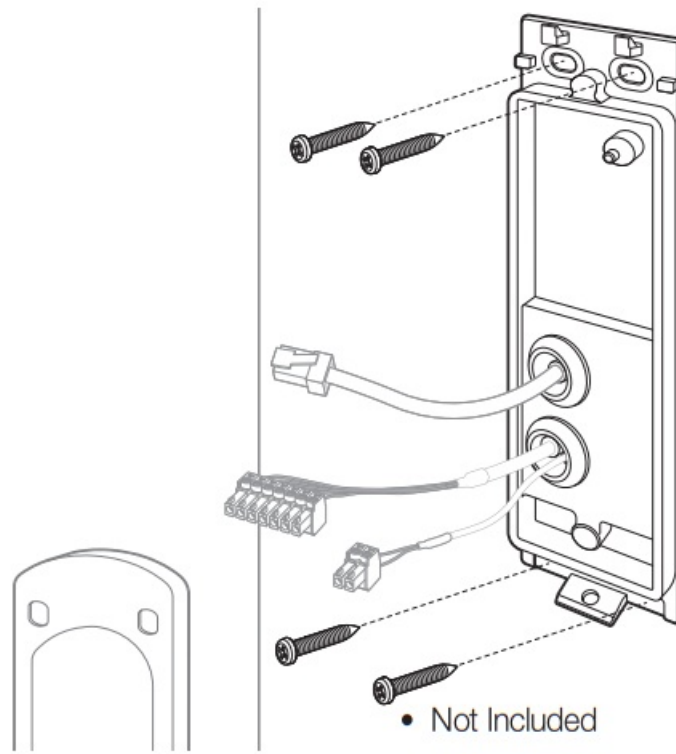

11

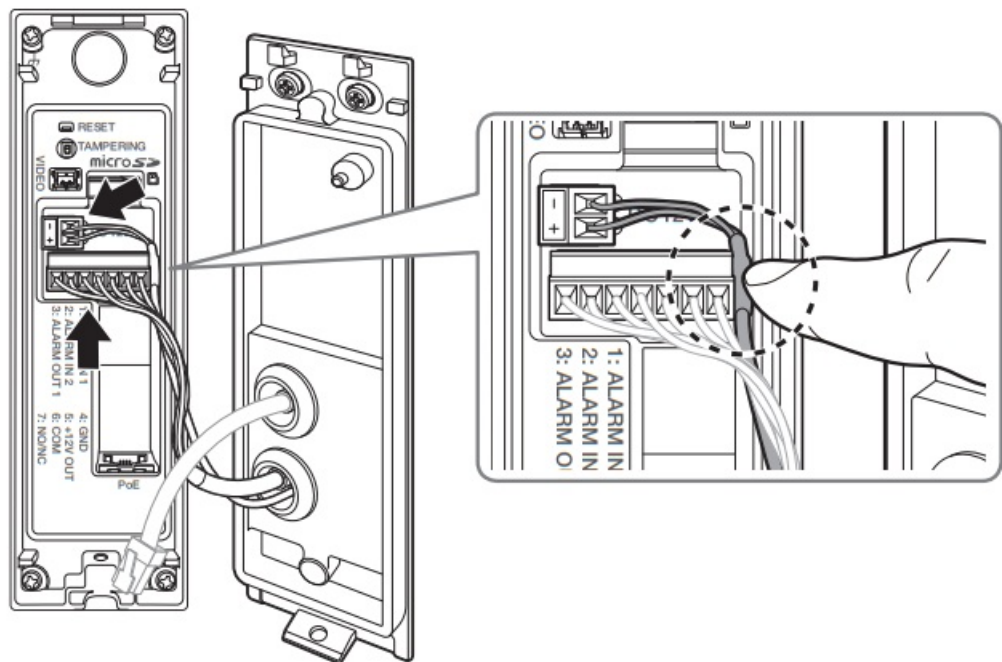

12

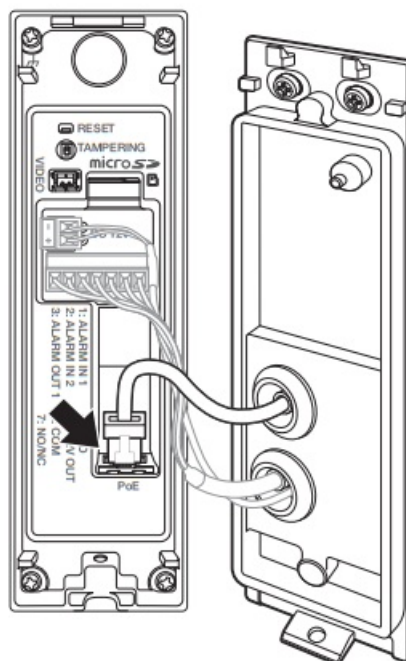

13

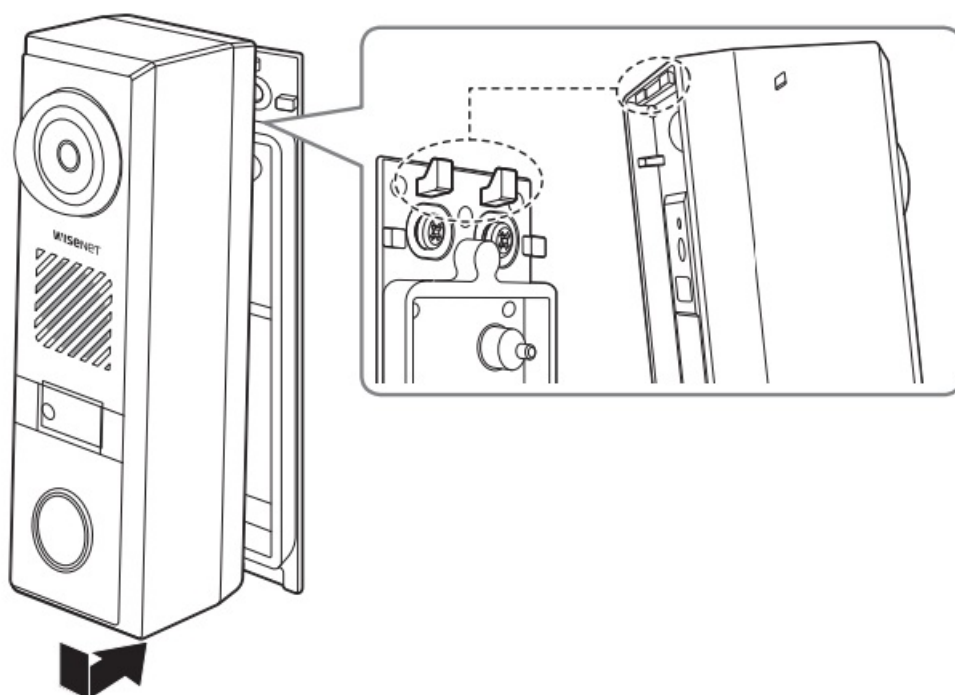

14

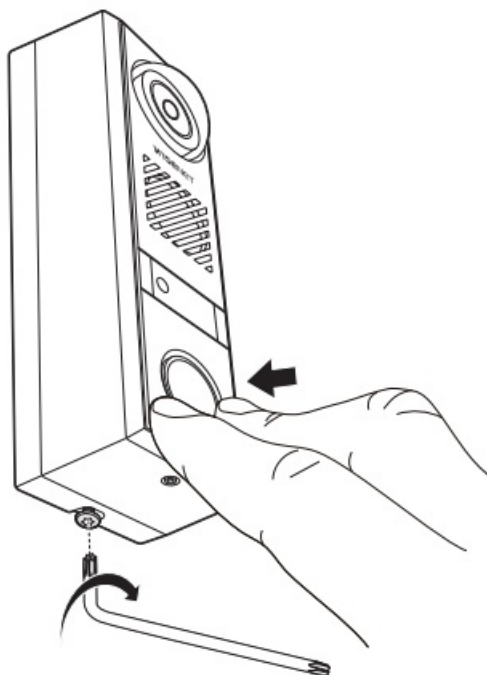

15

- <Setup ()> → <Intercom> → <Call Setup> → <Touchless call> → <Enable>

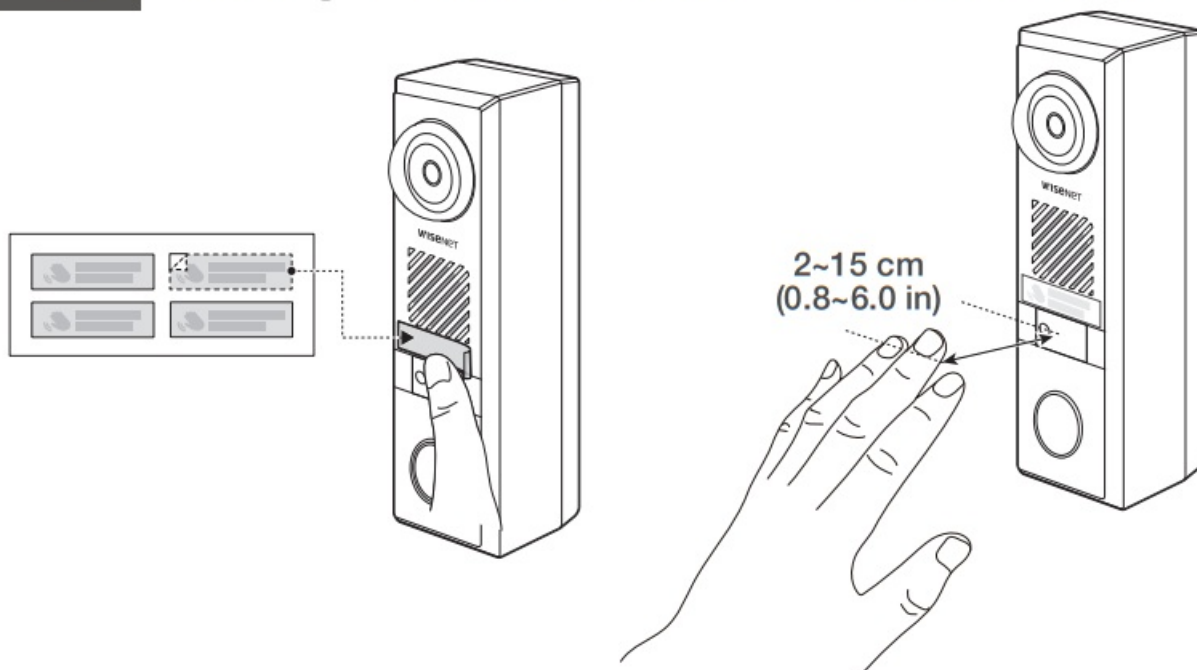

16 • Setting up when using the Fail-Safe type door strike (Opens upon power outage)

Alarm output	Alarm output 2 (NO/NC port) Type ● N.C. (Normal Close)
--------------	-----------------------------------------------------------

17 • Setting up when using the Fail-Secure type door strike (Closes upon power outage)

Alarm output	Alarm output 2 (NO/NC port) Type ● N.O. (Normal Open)
--------------	----------------------------------------------------------

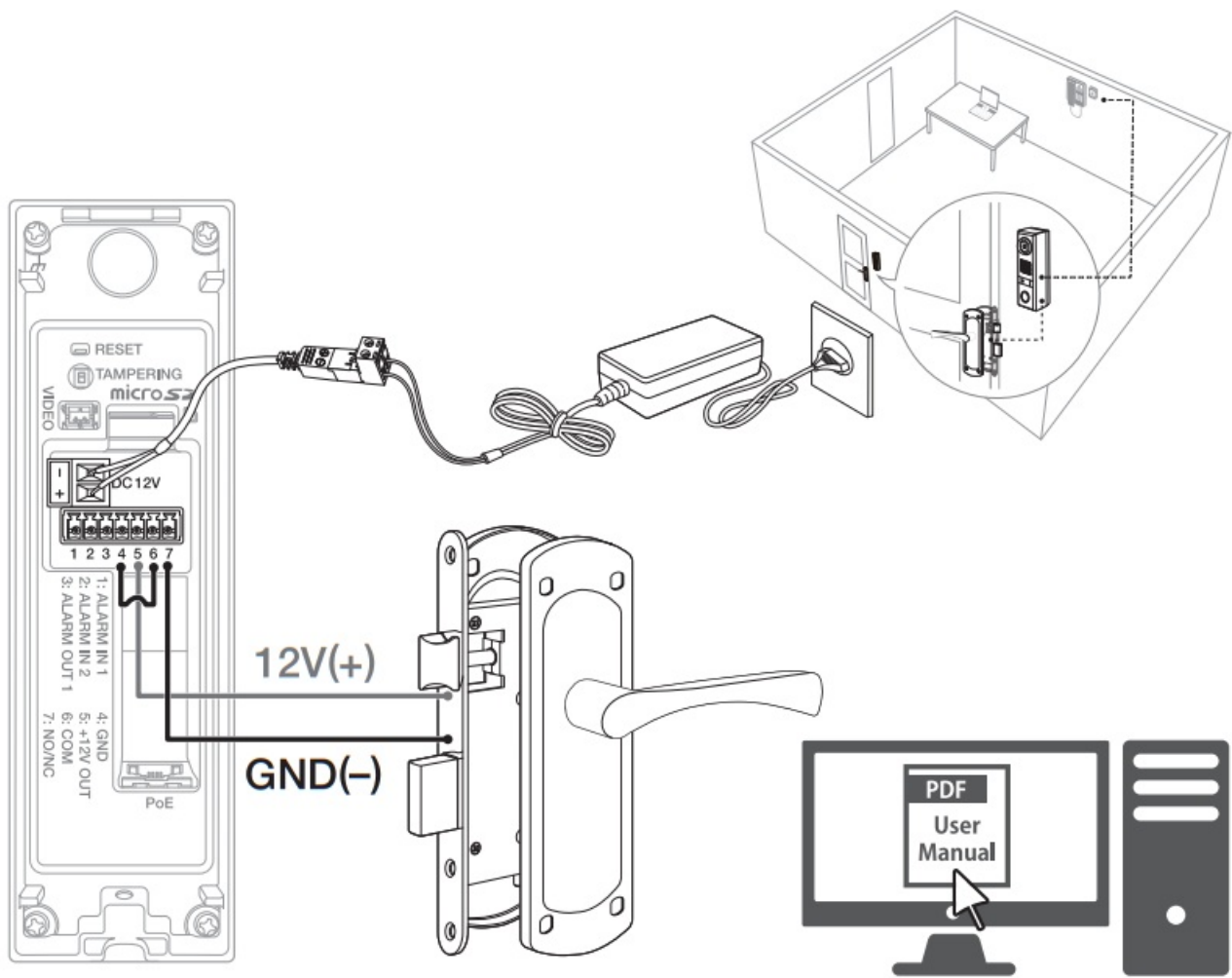

18

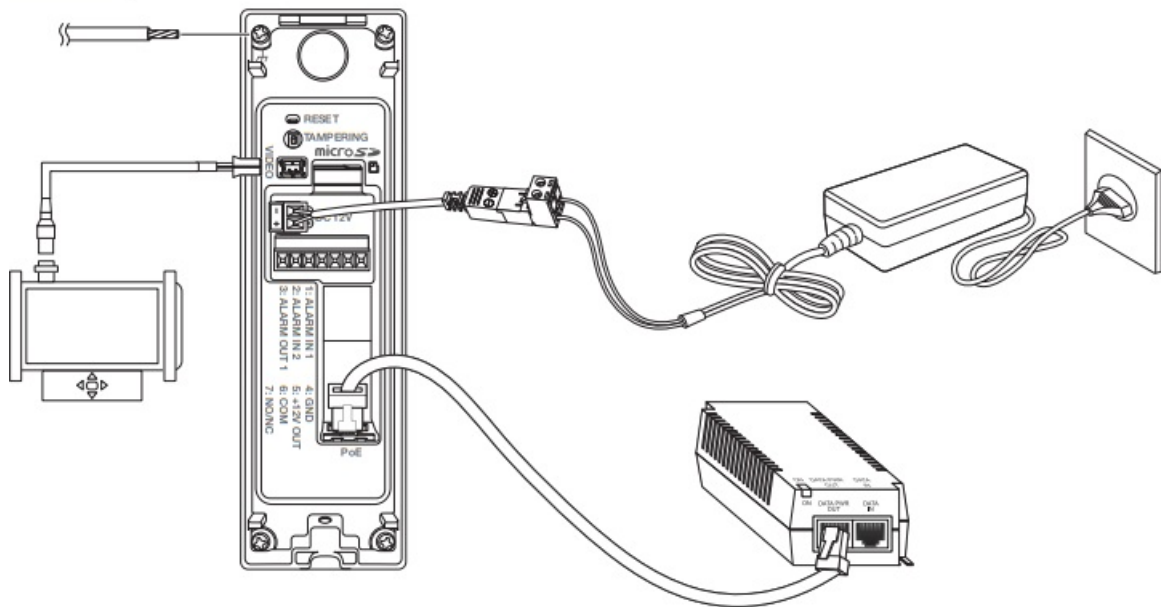

19

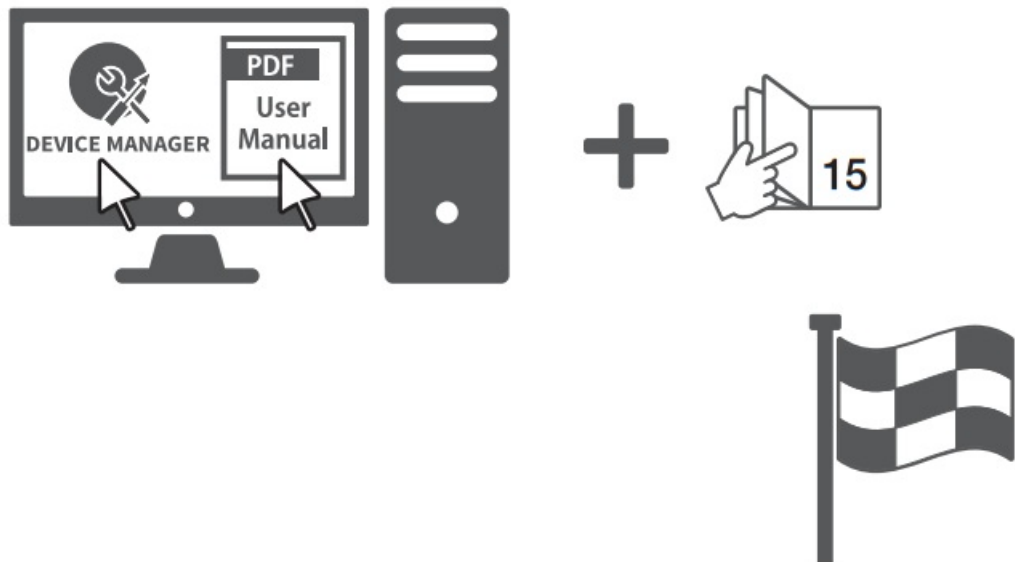

PASSWORD SETTING

When you access the intercom for the first time, you must register the login password.

Administrator password change

New password

Confirm new password

- If the password is 8 to 9 characters long, then it must include a combination of at least 3 of the following character types: alphabet letters with uppercase or lowercase, numbers, and special characters.
- If the password is longer than 10 characters, then it must include a combination of at least 2 of the following character types: alphabet letters with uppercase or lowercase, numbers, and special characters.
- User name may not be used as password.
- The following special characters can be used: ~!@#\$%^&*()_-=+|{}[].?/
- You may not use more than 4 consecutive characters. (example: 1234, abcd, etc.)
- You may not use the same character 4 or more times consecutively. (example: !!!!!, 1111, aaaa, etc.)

-  For a new password with 8 to 9 digits, you must use at least 3 of the following: uppercase/lowercase letters, numbers, and special characters. For a password with 10 to 15 digits, you must use at least 2 types of those mentioned. – Special characters that are allowed. : ~!@#\$%^&*()_-=+|{}[].?/
- For higher security, you are not recommended to repeat the same characters or consecutive keyboard inputs for your passwords.
- If you lost your password, you can press the [RESET] button to initialize the product. So, don't lose your password by using a memo pad or memorizing it.

LOGIN

Whenever you access the intercom, the login window appears.
Enter the User ID and password to access the intercom.

1. Enter “admin” in the <User Name> input box.
2. Enter the password in the <Password> input field.
3. Click [Sign in].

Head Office

6, Pangyo-ro 319 beon-gil, Bundang-gu, Seongnam-si,
Gyeonggi-do, 463-400 Rep. of KOREA
Tel : +82.70.7147.8753 Fax : +82.31.8018.3740

www.hanwha-security.com

Hanwha Techwin Europe

Heriot House, Heriot Road, Chertsey, Surrey, KT16 9DT, United Kingdom
Tel : +44.1372.235663 Fax : +44.1932.57.8101

www.hanwha-security.eu

Hanwha Techwin Vietnam Hanoi Office

28th Floor, Handico Building, Pham Hung Street, Me Tri ward, Nam Tu Liem District, Hanoi City, Vietnam
Tel : +84.91.982.40.88

www.hanwha-security.com





<https://www.hanwha-security.com/en/data-center/download-data/camera/>





PT01-005768A_(v1.1)

Documents / Resources

	<p>Wisenet TID-600R Network Intercom [pdf] User Guide TID-600R Network Intercom, TID-600R, Network Intercom, Intercom</p>
-----------------------------------------------------------------------------------	-----------------------------------------------------------------------------------------------------------------------------------------------

References

-  [Hanwha Vision - Global Vision Solution Provider](#)
-  [Hanwha Vision Europe Limited - Total technology security solutions provider](#)
-  [Hanwha Vision - Innovative Video Surveillance Systems](#)
-  [■■■■■ - ■■■■■ CCTV No.1](#)