



Wisenet PNO-A6081R Network Camera User Guide

[Home](#) » [WISeNeT](#) » Wisenet PNO-A6081R Network Camera User Guide 

Contents

- 1 Wisenet PNO-A6081R Network Camera
- 2 Product Information
- 3 SAFETY INFORMATION
- 4 COMPONENT
- 5 INSTALLATION
 - 5.1 COMPONENT
- 6 Product Usage Instructions
 - 6.1 Password Setting
- 7 LOGIN
- 8 Connecting to WiFi
- 9 Documents / Resources
 - 9.1 References
- 10 Related Posts

WISeNeT

Wisenet PNO-A6081R Network Camera



Product Information

Network Camera

The PNO-A6081R and PNB-A6001 are outdoor bullet and box network cameras respectively, manufactured by Hanwha Techwin. The cameras are designed to provide high-quality video surveillance for both indoor and outdoor environments. Both cameras are compatible with Hanwha's VMS version or the latest Hanwha NVR version when integrating with VMS or Hanwha NVR. The Eco mark signifies that the product complies with the EU RoHS Directive, indicating Hanwha Techwin's commitment to environmentally friendly products.

The cameras come with a variety of installation options such as directly installing on walls/ceilings, using pipes or installing network/power cables. Some accessories such as WiFi dongles, OTG adapters, and CS mount lenses are not included in the package and must be purchased separately depending on the sales country of the product.

Important

Please check 'Manuals' from our website, before connecting to the Supply,

<https://www.hanwha-security.com/en/data-center/download-data/>

We recommend using the officially compatible VMS version or the latest Hanwha NVR version when integrating with VMS or Hanwha NVR.

Hanwha Techwin cares for the environment at all product manufacturing stages and is taking measures to provide customers with more environmentally friendly products.

The Eco mark represents Hanwha Techwin's devotion to creating environmentally friendly products and indicates that the product satisfies the EU RoHS Directive.

Correct Disposal of This Product (Waste Electrical & Electronic Equipment)

(Applicable in the European Union and other European countries with separate collection systems)

This marking on the product, accessories or literature indicates that the product and its electronic accessories (e.g. charger, headset, USB cable) should not be disposed of with other household waste at the end of their working life. To prevent possible harm to the environment or human health from uncontrolled waste disposal, please separate these items from other types of waste and recycle them responsibly to promote the sustainable reuse of material resources. Household users should contact either the retailer where they purchased this product, or their local government office, for details of where and how they can take these items for environmentally safe recycling.

Business users should contact their suppliers and check the terms and conditions of the purchase contract. This

product and its electronic accessories should not be mixed with other commercial wastes for disposal.

Correct disposal of batteries in this product

(Applicable in the European Union and other European countries with separate battery return systems.)

This marking on the battery, manual, or packaging indicates that the batteries in this product should not be disposed of with other household waste at the end of their working life. Where marked, the chemical symbols Hg, Cd, or Pb indicate that the battery contains mercury, cadmium, or lead above the reference levels in EC Directive 2006/66. If batteries are not properly disposed of, these substances can cause harm to human health or the environment. To protect natural resources and to promote material reuse, please separate batteries from other types of waste and recycle them through your local, free battery return system.

SAFETY INFORMATION



Outdoor Bullet Camera
PNO-A6081R

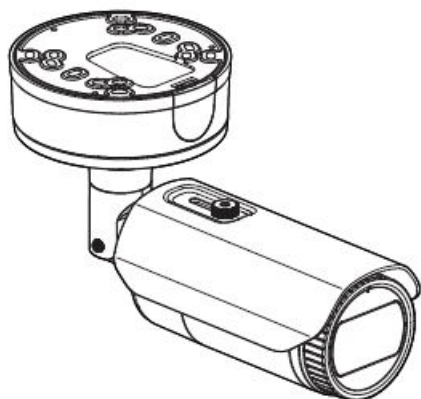

Box Camera
PNB-A6001

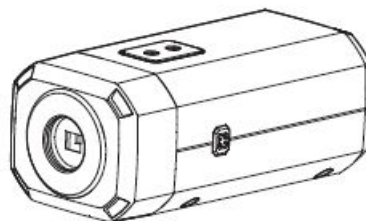

COMPONENT

As for each sales country, accessories are not the same.

- PNO-A6081R

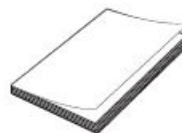
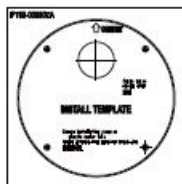
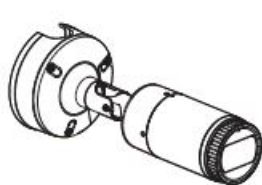

INSTALLATION

1

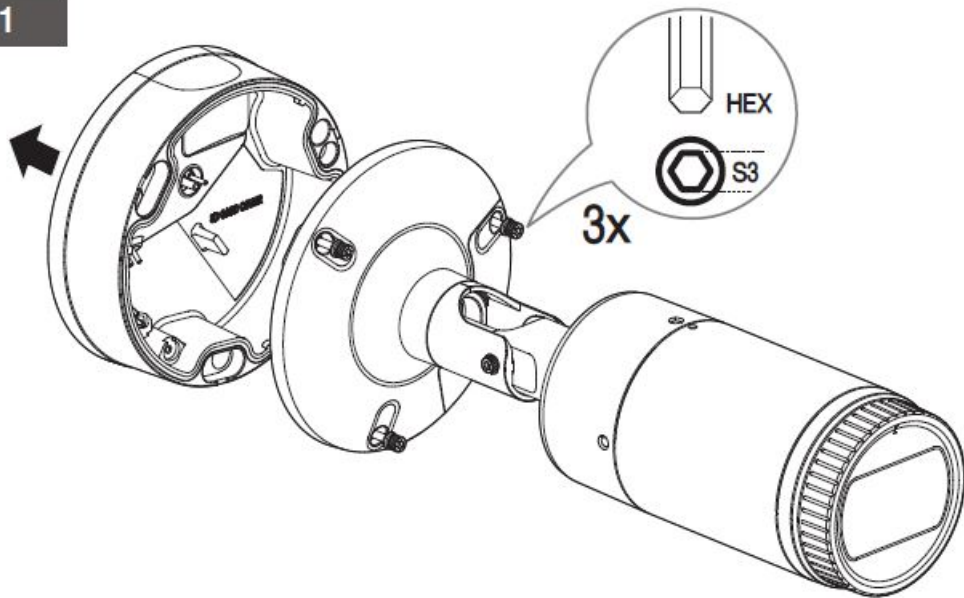

- **Not Included:** Micro SD Card

2

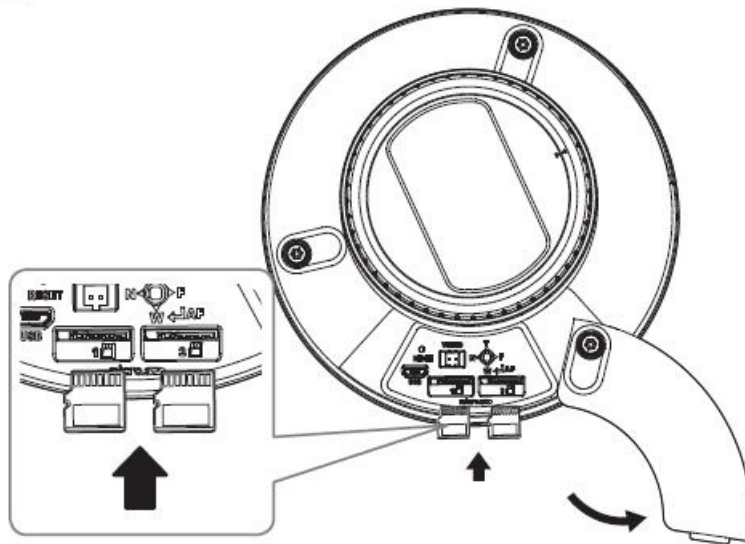

3

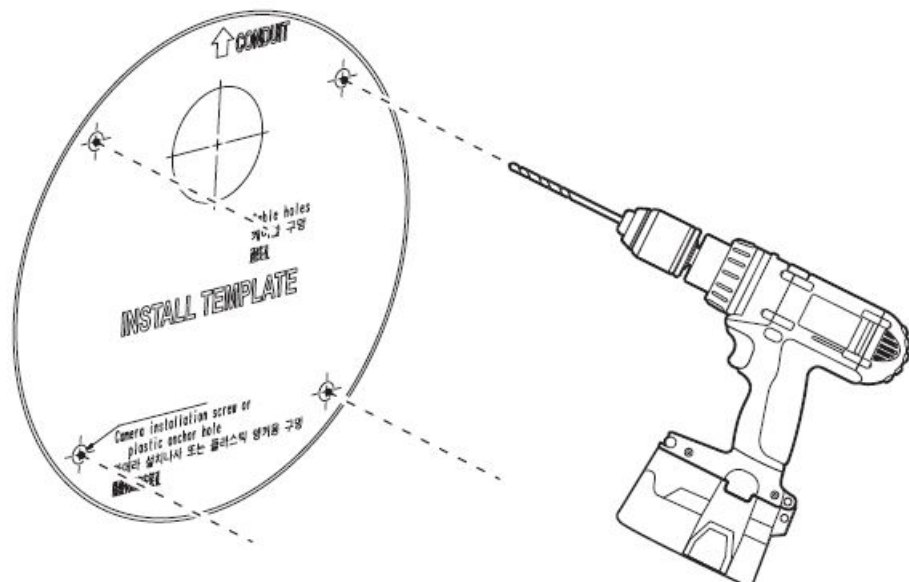

Directly installing on wall/ceiling

4

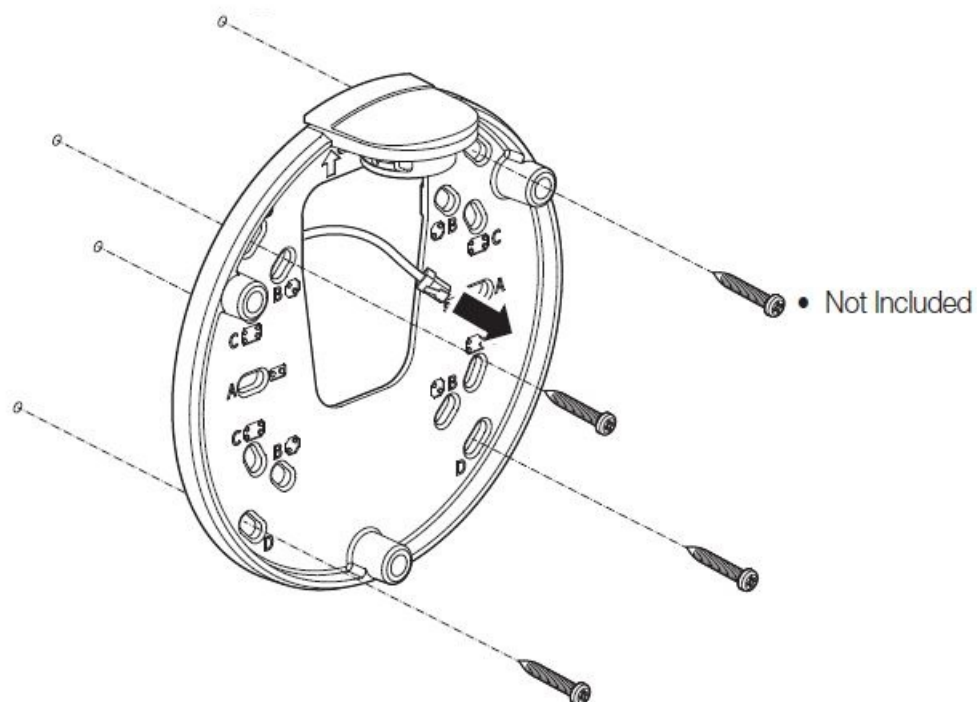

Installing using pipe

5-1

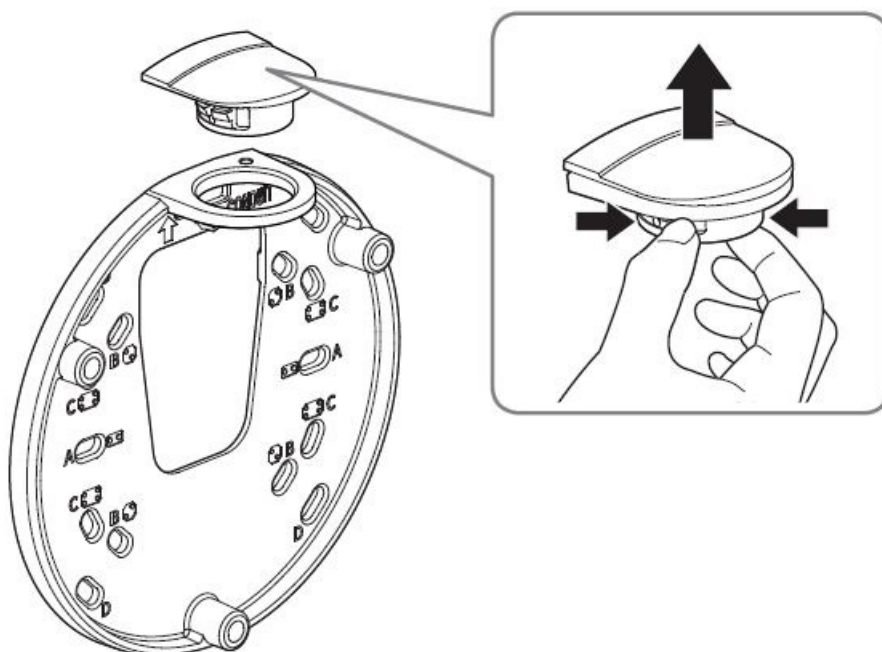

5-2

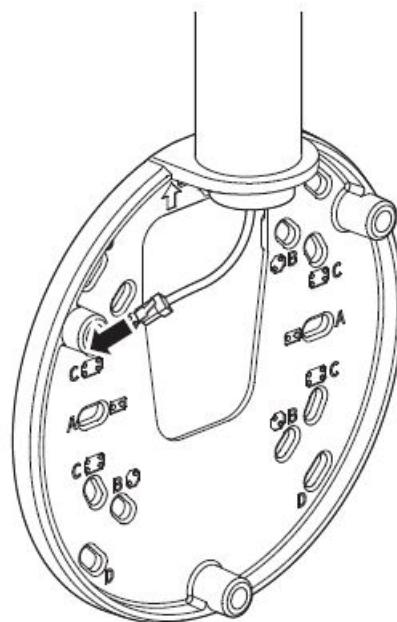

Installing network/power cables

6-1

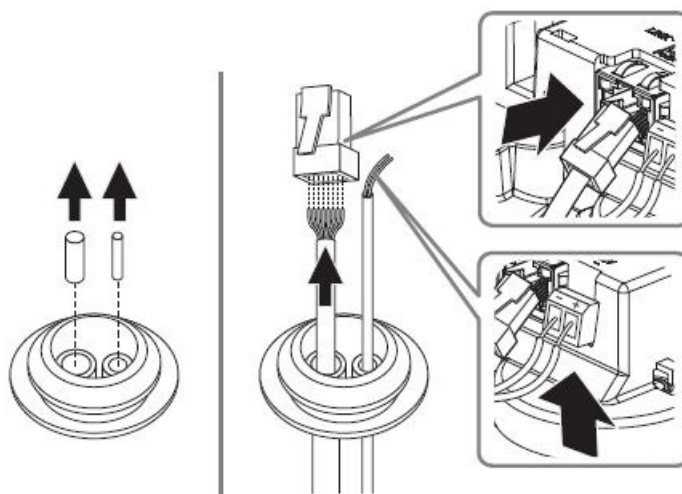

6-2

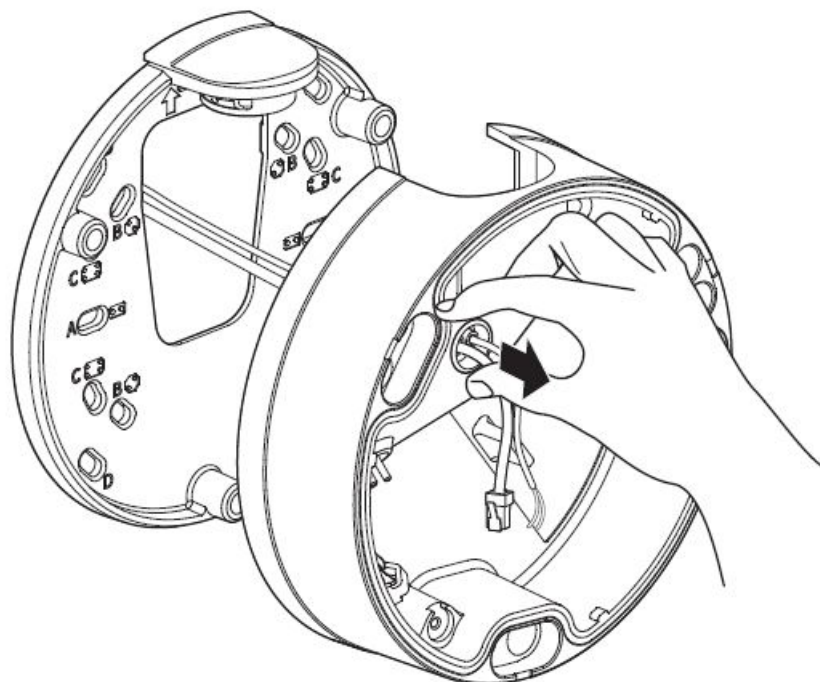

7-1

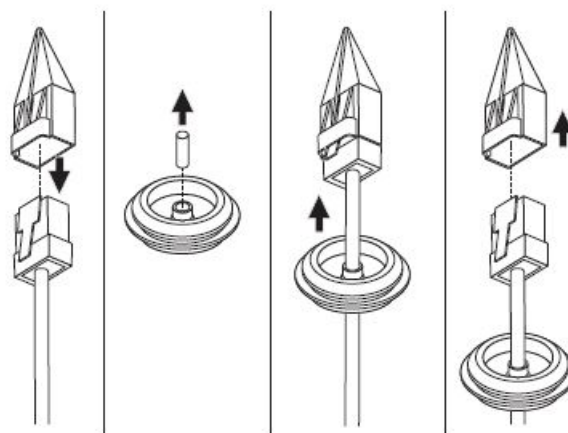

7-2

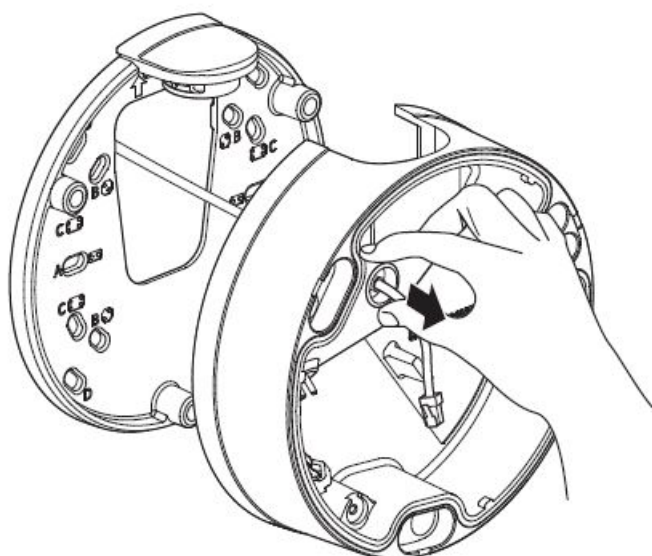

8

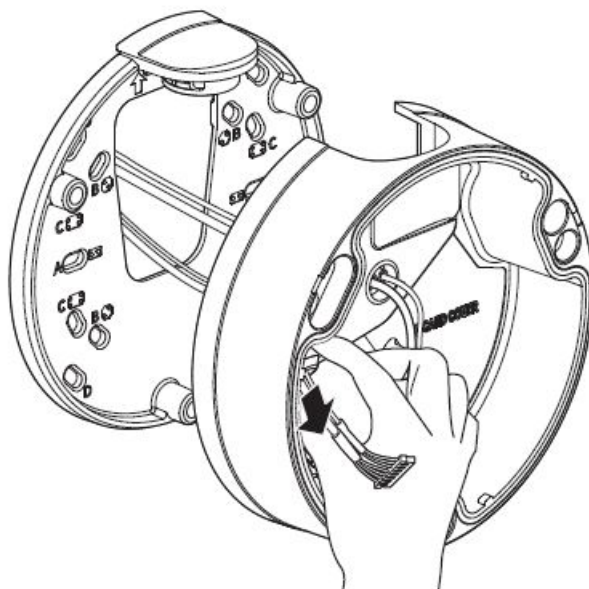

9

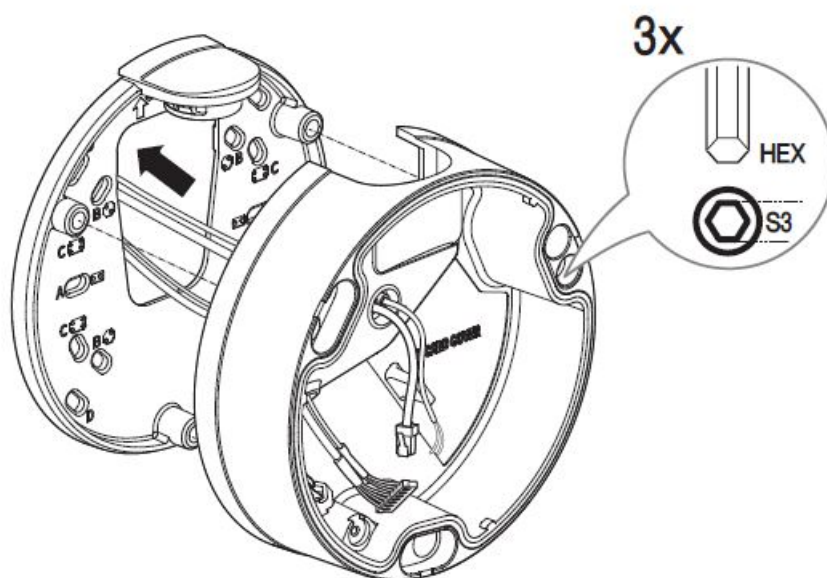

10

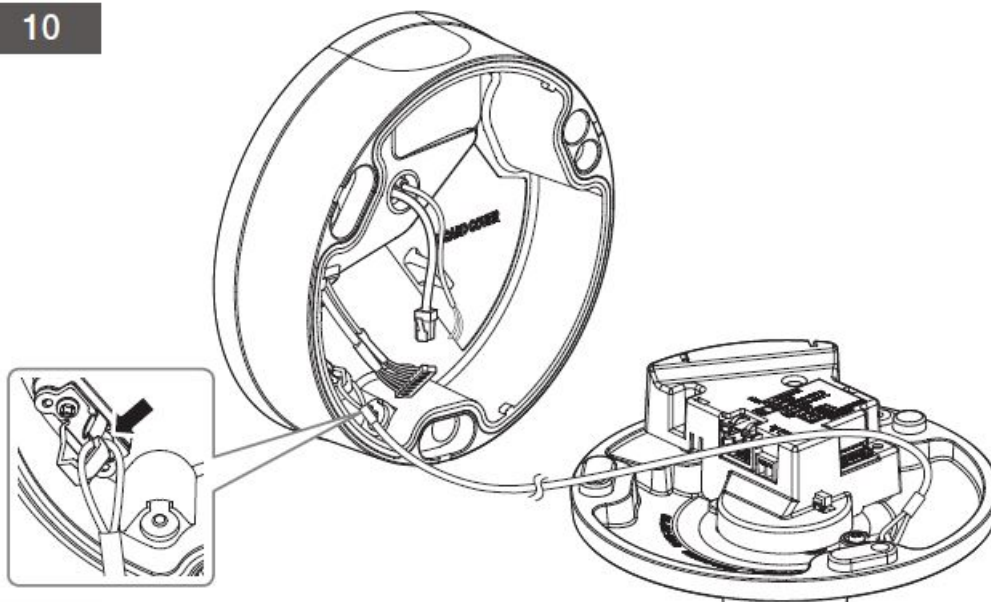

11

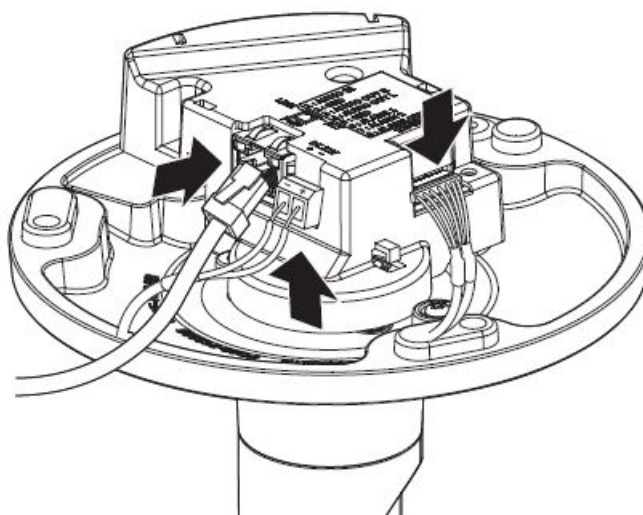

12

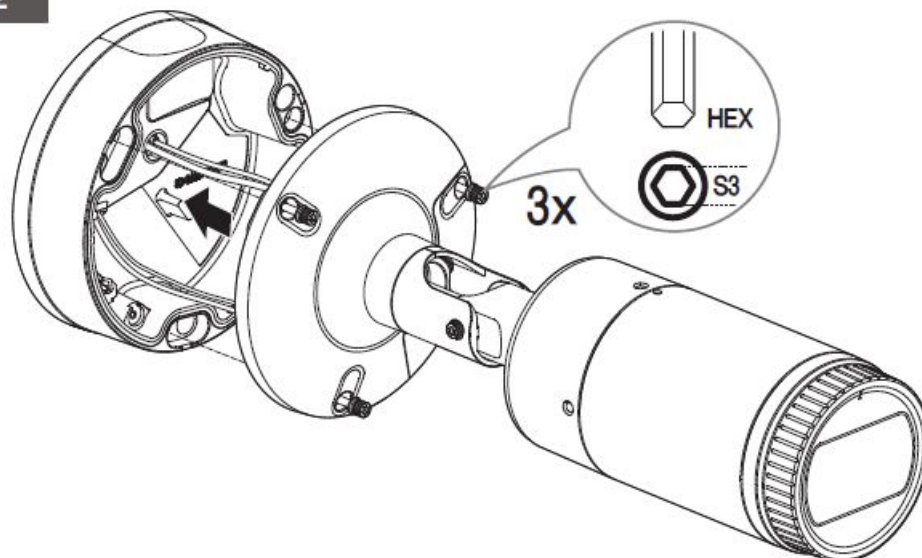

Not Included: WiFi dongle, OTG adapter

13

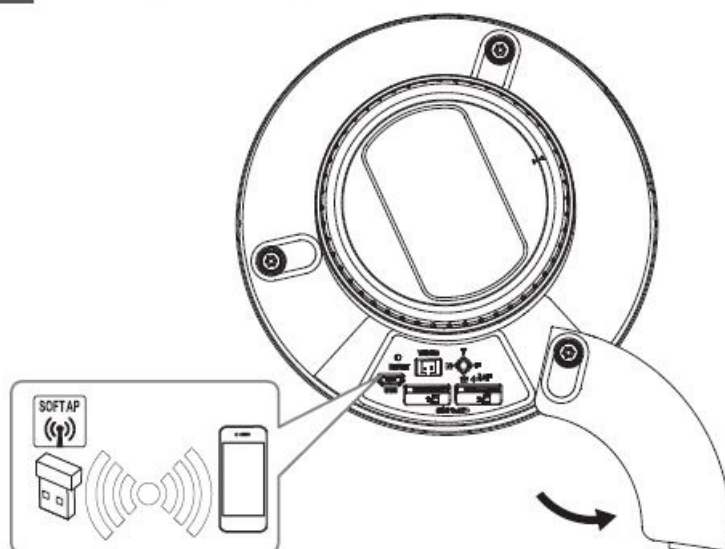

14



15

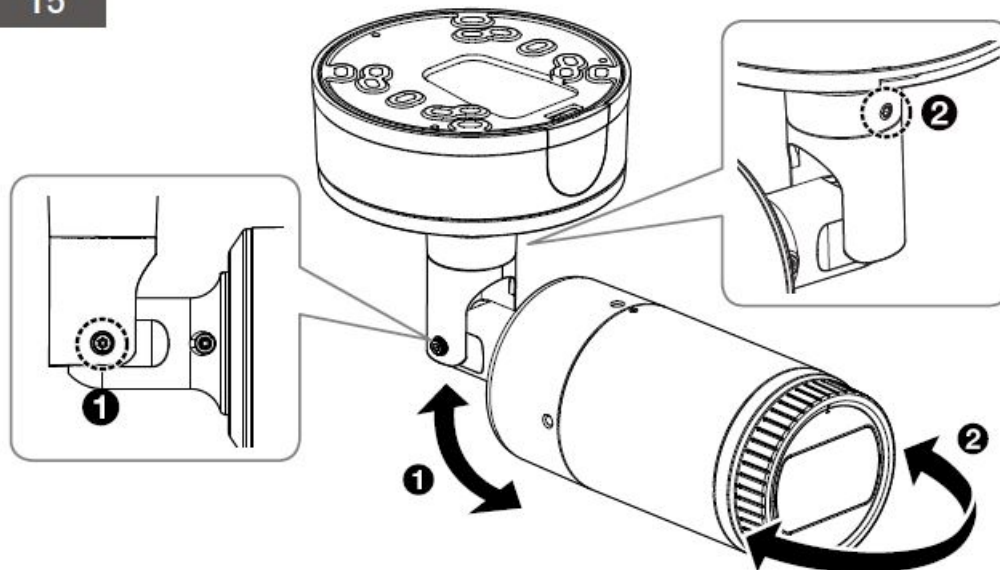

16

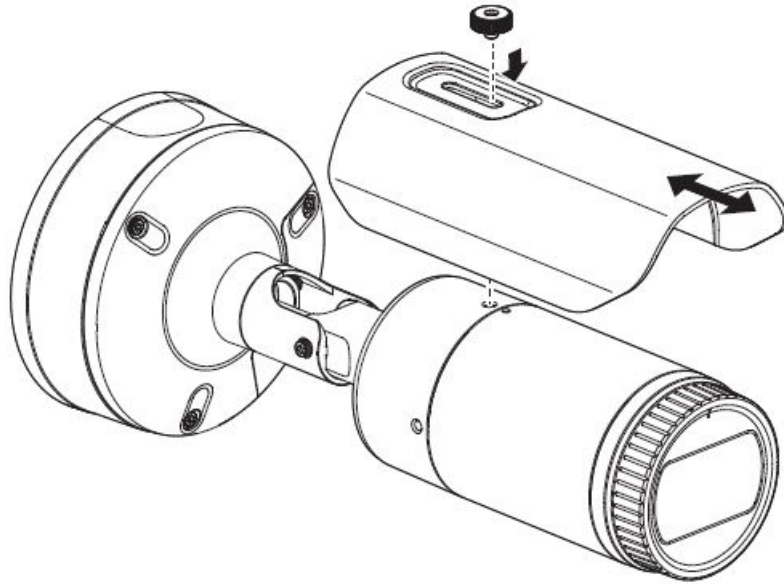

17

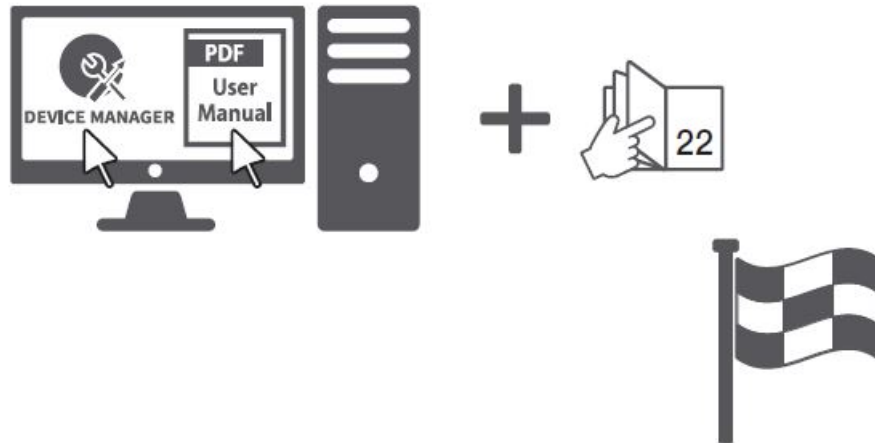

COMPONENT

As for each sales country, accessories are not the same.

- PNB-A6001

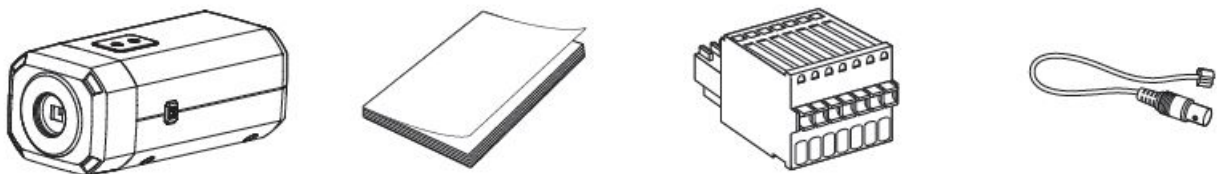

Options (not included)

- CS-Mount Lens

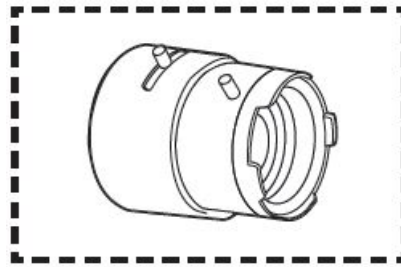

CS Mount Lens

1

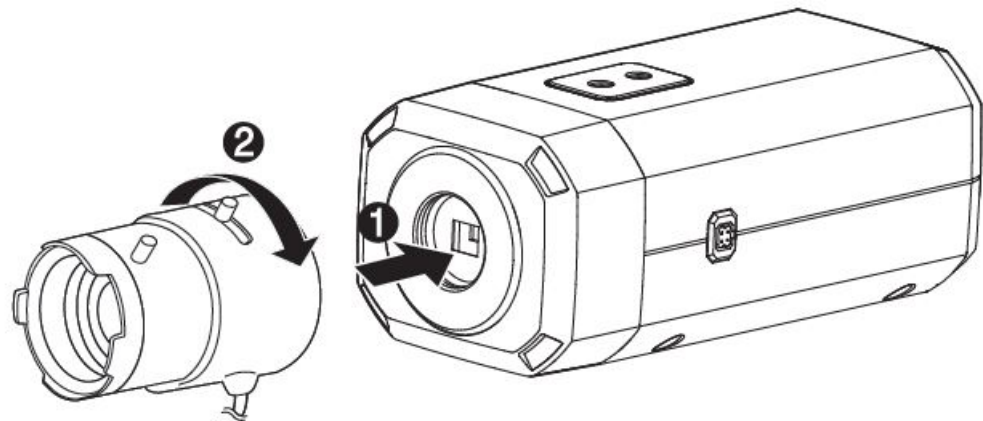

2

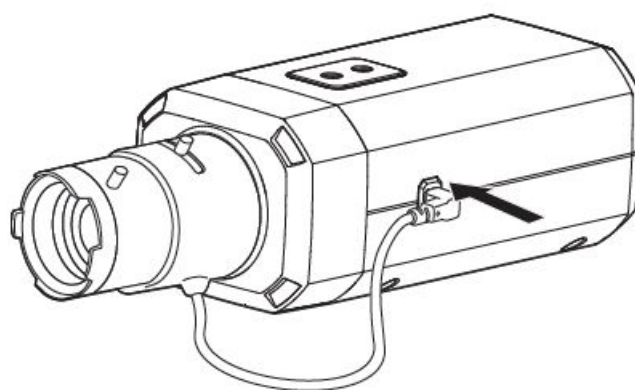

3

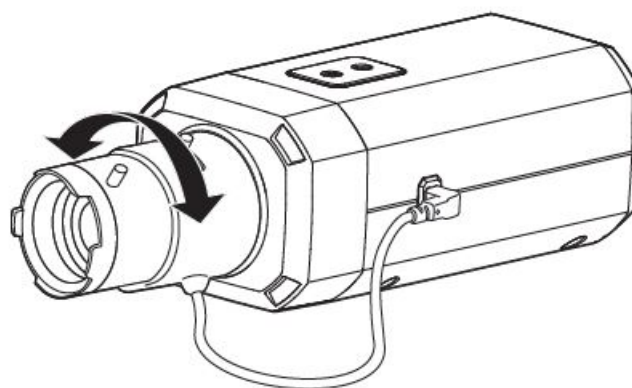

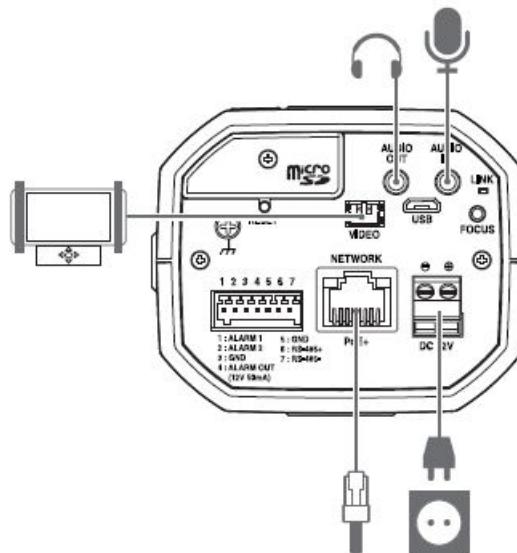
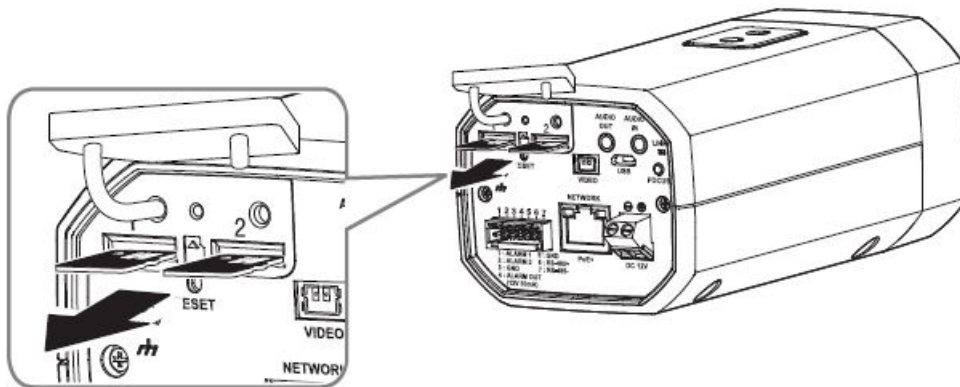
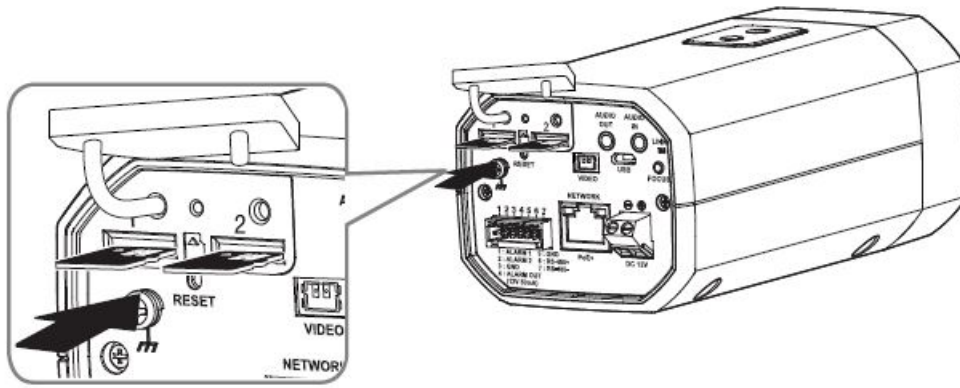

Not included: WiFi dongle, OTG adapter

6

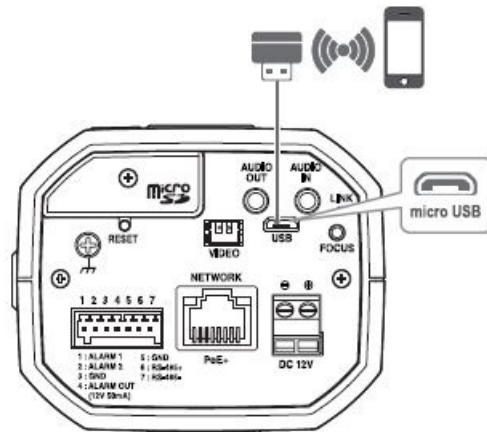

7



8

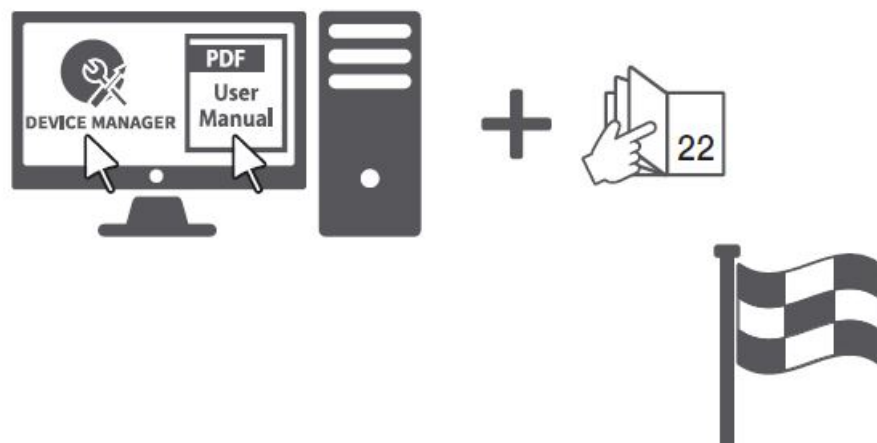

Product Usage Instructions

Password Setting

When accessing the camera for the first time, users must register a login password. The login window appears

every time you access the camera. Enter your User ID and password to access the camera. The User ID is 'admin', and you must enter your password in the input field. The password should be between 8 to 9 digits long with at least three of the following: uppercase/lowercase letters, numbers, and special characters. For passwords between 10 to 15 digits long, you must use at least two types of the mentioned characters. It is recommended not to repeat the same characters or consecutive keyboard inputs for your passwords. If you lose your password, you can press the RESET button to initialize the product.

Administrator password change

New password

Confirm new password

- If the password is 8 to 9 characters long, then it must include a combination of at least 3 of the following character types: alphabet letters with uppercase or lowercase, numbers, and special characters.
- If the password is longer than 10 characters, then it must include a combination of at least 2 of the following character types: alphabet letters with uppercase or lowercase, numbers, and special characters.
- User name may not be used as password.
- The following special characters can be used: ~!@#\$%^&*()_-=+[]{}|.\:/
- You may not use more than 4 consecutive characters. (example: 1234, abcd, etc.)
- You may not use the same character 4 or more times consecutively. (example: !!!!!, 1111, aaaa, etc.)

Apply

- For a new password with 8 to 9 digits, you must use at least 3 of the following: uppercase/lowercase letters, numbers and special characters. For a password with 10 to 15 digits, you must use at least 2 types of those mentioned.
 - Special characters are allowed.:
 - `!@#\$%^&*()_-=+[]{}|.\:/
- For higher security, you are not recommended to repeat the same characters or consecutive keyboard inputs for your passwords.
- If you lost your password, you can press the [RESET] button to initialize the product. So, don't lose your password by using a memo pad or memorizing it.

LOGIN

Whenever you access the camera, the login window appears. Enter the User ID and password to access the camera.

1. Enter "admin" in the <User Name> input box.
2. Enter the password in the <Password> input field.
3. Click [Sign in].

Connecting to WiFi

To connect the camera to WiFi, follow these steps:

1. Connect the OTG adapter (5-pin) and WiFi dongle to the micro USB terminal.

Smartphone setting

2. Install the Wisenet Installation application on your smartphone.

- 3. Select the camera SSID after turning on the WiFi.
- 4. Run the Wisenet Installation application.
- 5. When you log in to the camera, the video will be connected.
 - The video will be played without being logged in during the initial connection.
- 6. You can adjust the angle of view while watching the video through your smartphone.

Note that the WiFi dongle and OTG adapter are not included in the package and must be purchased separately.

www.hanwha-security.com.

Documents / Resources

	<p>Wisenet PNO-A6081R Network Camera [pdf] User Guide</p> <p>PNO-A6081R Network Camera, PNO-A6081R, Network Camera, Camera</p>
---	--

References

-  [CCTV No.1](#)