



## WISE ALLY AP82 Rapid Response Button User Guide

[Home](#) » [WISE ALLY](#) » WISE ALLY AP82 Rapid Response Button User Guide 



### Rapid Response Button User Guide

The Rapid Response Button is designed to improve employee safety by providing indoor location information of employees upon emergency leveraging PwC's Indoor Geolocation Platform (IGP).

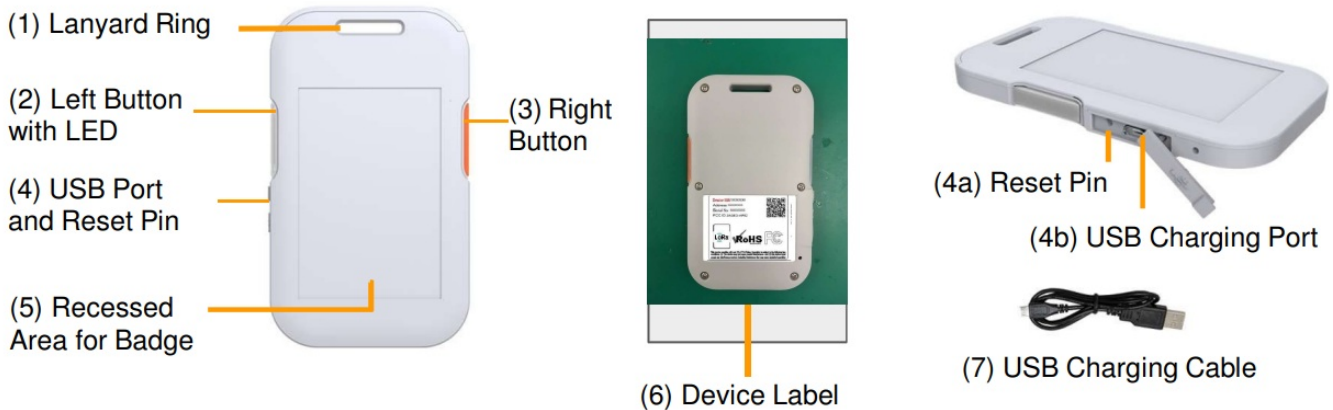

#### 1. Lanyard Ring

Attach lanyard with the ring to wear the device

#### 2. Left Button with LED

The left button is smooth and translucent with LEDs inside it

#### 3. Right Button

The right button is blue and textured

## Contents

[1 Trigger / Stop Alerts](#)

[2 Silent / Audible Alert Mode](#)

[3 Check Silent / Audible Alert Mode](#)

[4 Switch Between Silent / Audible Alert Modes](#)

[5 Documents / Resources](#)

[6 Related Posts](#)

## Trigger / Stop Alerts

Press and hold both the left button and the right button to trigger alerts and location reports. The LED will flash when an alert is triggered.

Press and hold both buttons again to stop alerts.

## Silent / Audible Alert Mode

When the silent alert mode is triggered, the device will vibrate once and the LED will flash green. Once a location report is sent, the device will vibrate.

When the audible alert mode is triggered, the device will beep and the LED will flash red. Once a location report is sent, the device will vibrate.

If an alert is triggered and not stopped, the device will send a location report every one minute

## Check Silent / Audible Alert Mode

Press and release the right button. If the LED flashes green, the device is in silent alert mode. If the LED flashes red, the device is in the audible alert mode

## Switch Between Silent / Audible Alert Modes

Press and hold the right button for 3 seconds to switch between silent / audible alert modes

The device will beep and flash the green LED when it is switched to the silent alert mode

The device will beep and flash the red LED when it is switched to the audible alert mode

## (4) USB Port and Reset Pin

(4a) Micro USB Port for charging and device update (by device managers) (4b) Reset pin. The device can be power cycled by pressing the reset pin with a paperclip

## (5) Recessed Area for Badge

Optionally stick an employee badge photo in the recessed area

## (6) Device Label

- **DevEUI:** LoRa Device Extended Unique Identifier
- **Address:** Device MAC address
- **Serial No.** Device serial number
- **FCC ID:** Device FCC ID
- **QR Code:** Scanning of the QR code renders a concatenated DevEUI, Address, and Serial No.

## (7) USB Charging

Cable Charging Micro USB cable for the device

**Caution:** The user is cautioned that changes or modifications not expressly approved by the party responsible for compliance could void the user's authority to operate the equipment.

**Note:** This equipment has been tested and found to comply with the limits for a Class B digital device, pursuant to part 15 of the FCC Rules. These limits are designed to provide reasonable protection against harmful interference in a residential installation. This equipment generates, uses and can radiate radio frequency energy and, if not installed and used in accordance with the instructions, may cause harmful interference to radio communications. However, there is no guarantee that interference will not occur in a particular installation. If this equipment does cause harmful interference to radio or television reception, which can be determined by turning the equipment off and on, the user is encouraged to try to correct the interference by one or more of the following measures:

- Reorient or relocate the receiving antenna.
- Increase the separation between the equipment and receiver.
- Connect the equipment into an outlet on a circuit different from that to which the receiver is connected.
- Consult the dealer or an experienced radio/TV technician for help.

This equipment complies with FCC's RF radiation exposure limits set forth for an uncontrolled environment. End-user must follow the specific operating instructions for satisfying RF exposure compliance. This transmitter must not be co-located or operating in conjunction with any other antenna or transmitter.

**Device Specs:**

**Model:** AP82

**Radio Frequency Band:** 900MHz

**Band WiFi-Band:** 2.4GHz

**Bluetooth Version:** 4.2

**Dimensions:** 2.6 x 4.5 x 0.4 inch

**Weight** 62g

**Battery:** 500mAh

**Operating Temperature:** 0-45C

**Relative Humidity:** 0-95%

## Documents / Resources

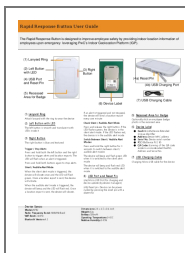

[WISE ALLY AP82 Rapid Response Button](#) [pdf] User Guide

AP82, 2AGEG-AP82, 2AGEGAP82, AP82 Rapid Response Button, Rapid Response Button