



Contents [[hide](#)]

- [1 WIOONI YXP01-06001 WiFi PIR Motion Sensor](#)
- [2 Product Presentation](#)
- [3 Specification](#)
- [4 How to use](#)
- [5 How to set up](#)
- [6 Functions](#)
- [7 FCC](#)
- [8 FAQs](#)
- [9 Documents / Resources](#)
 - [9.1 References](#)



WIOONI YXP01-06001 WiFi PIR Motion Sensor



Product Presentation

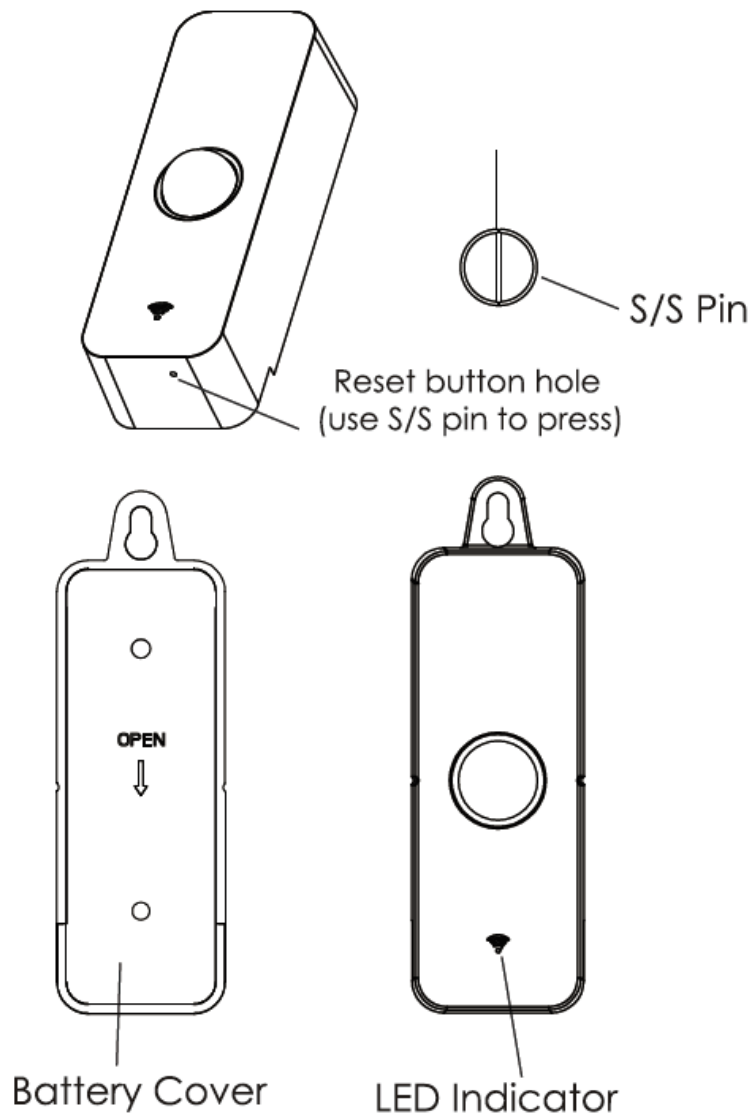

Specification

- **Size:** 71*25*20mm
- **Battery:** LRO3-1.5V/AAA*2 (Alkaline battery)
- **Wi-Fi Standard:** 2.4GHz
- **Wi-Fi Frequency:** IEEE 802.11b/g/n
- **Standby Current:** 22UA
- **Alarm Current:** $\leq 45\text{mA}$
- **Detect Angle:** 128°
- **Detect distance:** ≤ 6 Meters

How to use

Slide downwards to open back cover of battery compartment, install 2pcs AAA Alkaline batteries in the right direction of electrode, the indicator will blink, then push to close the cover.

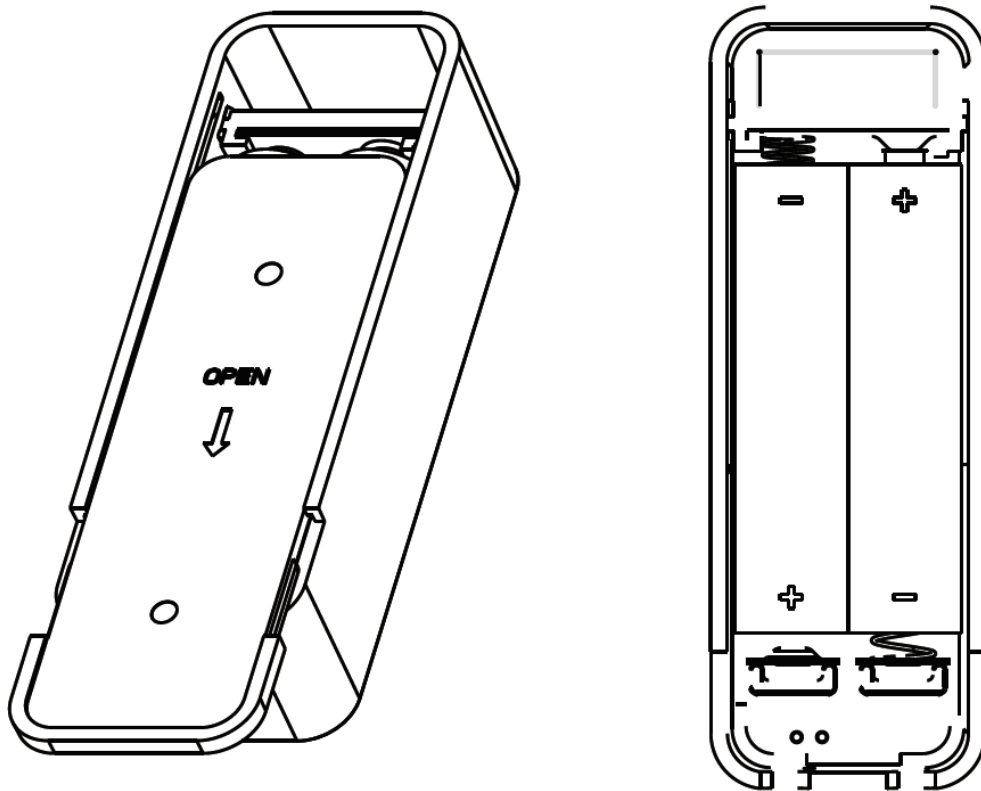

(Notes: when batteries are run out, please choose Alkaline battery instead of Carbon-zinc battery.)

How to set up

1. Use your smartphone to scan QR code, or search “Smart Life” app in Google Play Store or APP Store to download and install.



Smart Life



QR Code



2. Create an account with your mobile number and authentication code.

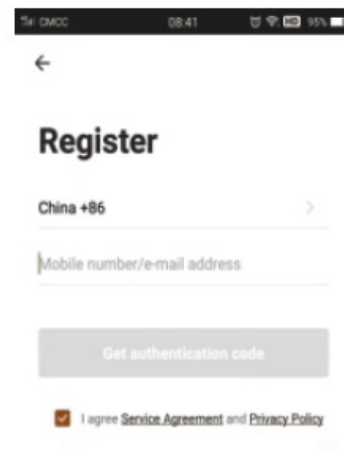
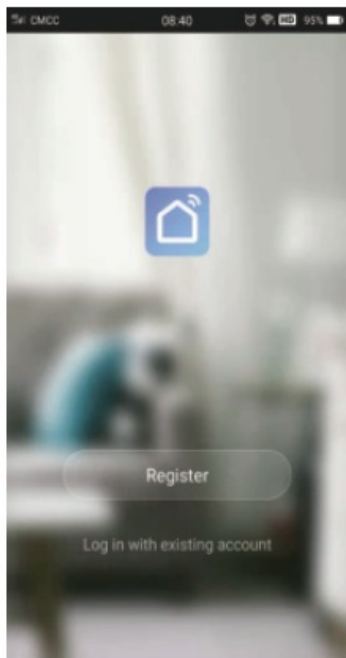

3. Connect your mobile to the Wi-Fi router, click “Add Device”. Make your zigbee gateway ready and supply power to the gateway.

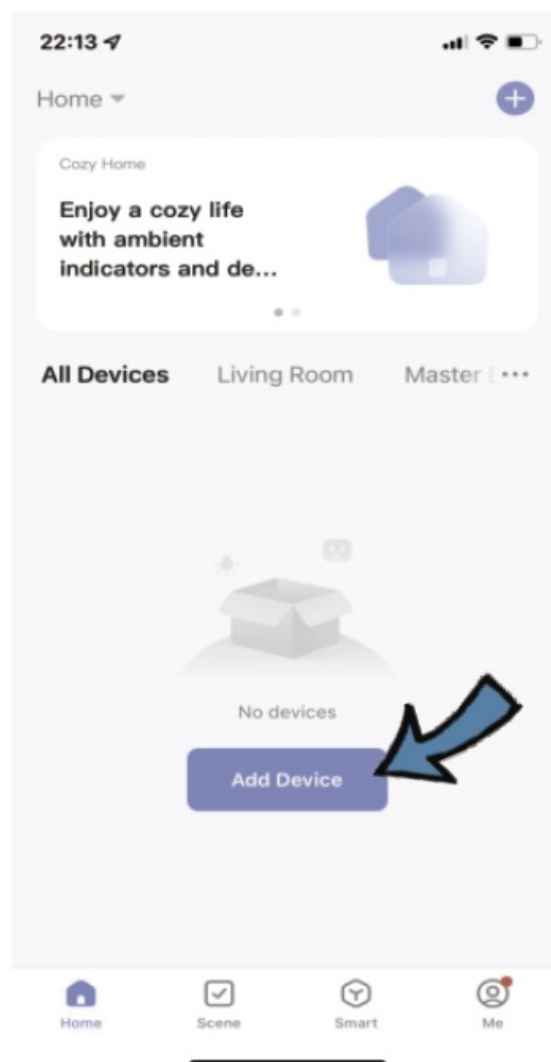

Bluetooth Mode:

The app advises you to turn on the bluetooth in your mobile, enter wifi name and password, it will search for nearby device, and connect the motion sensor automatically.

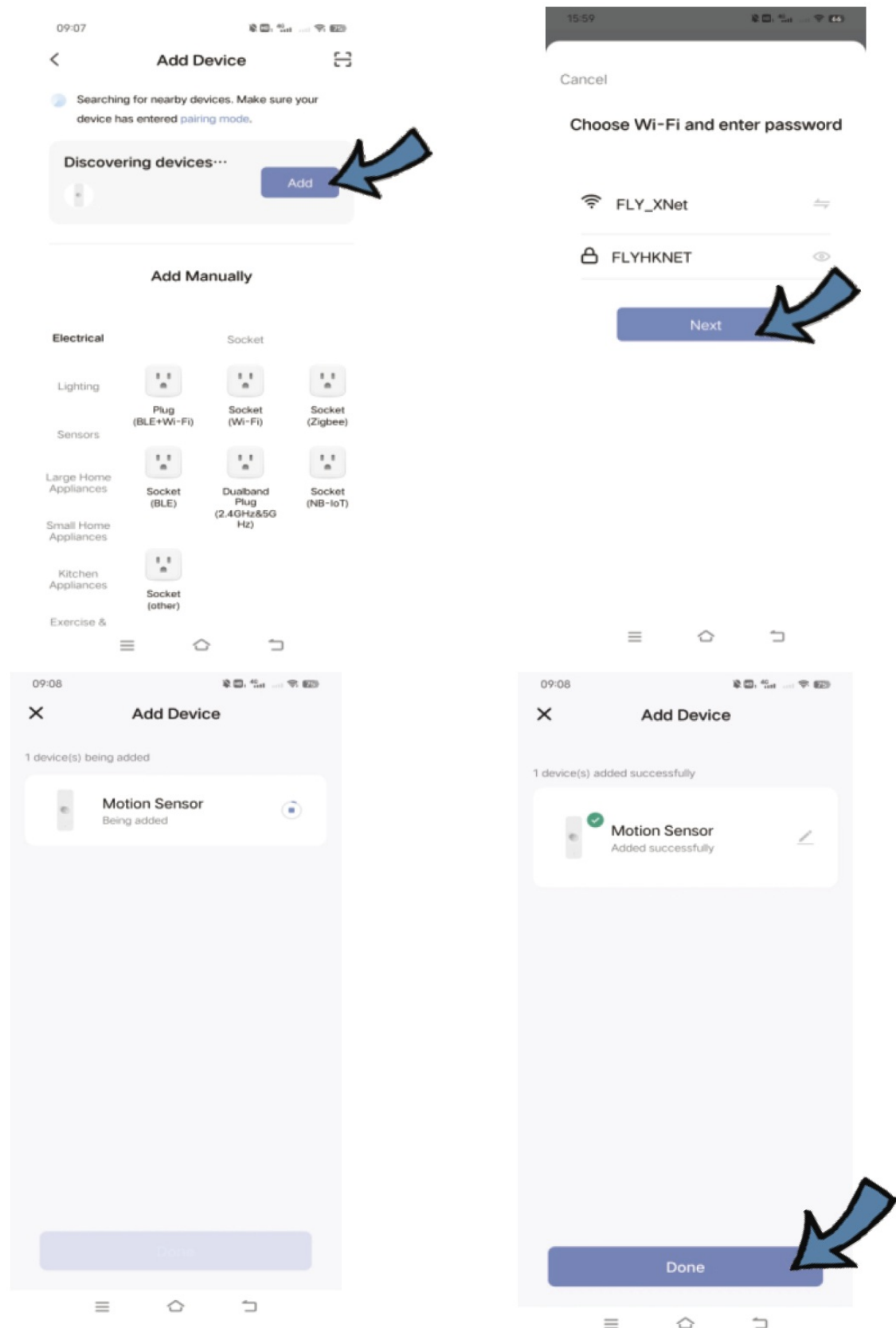

Blink Quickly:

Select "Motion Detector (Wi-Fi)" from "Sensors", enter wifi name and password, Select "Blink Quickly", make sure the LED indicator is blinking quickly, if not, use the supplied

S/S Pin to press the reset button till indicator is blinking quickly.

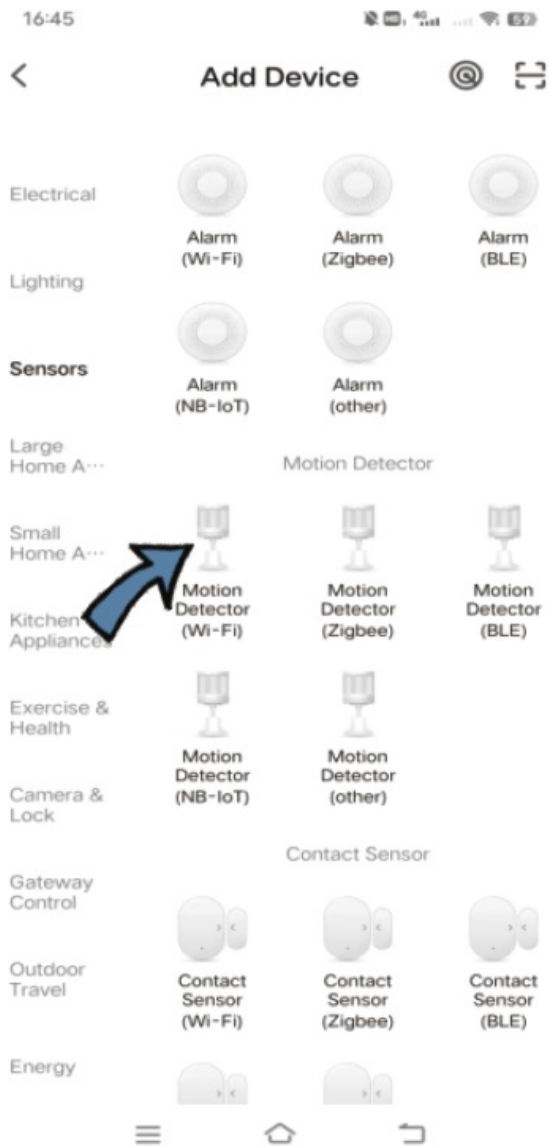

Reset the device



Press and hold the RESET button for 5 seconds until the indicator blinks (subject to the user manual).

Confirm the indicator is blinkin...

[Reset Device Step by Step](#)

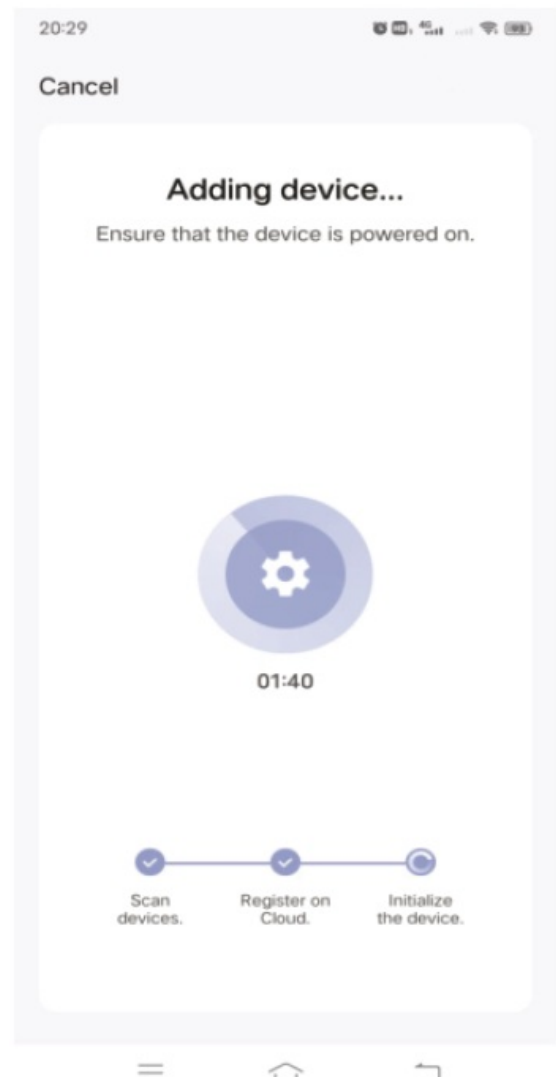
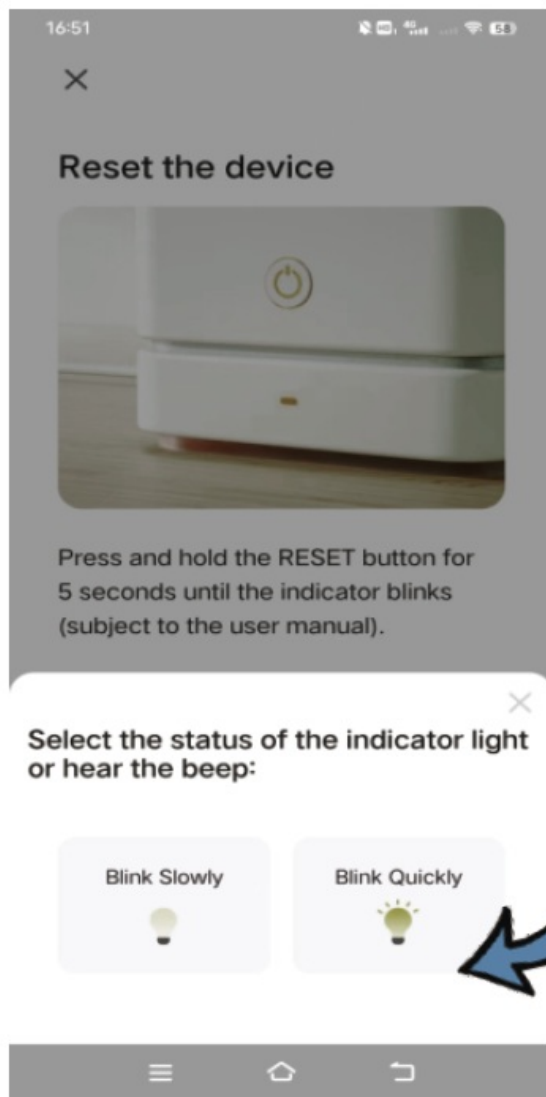

Blink Slowly:

You can also select “Blink Slowly”, make sure the LED indicator is blinking slowly. if not, use the S/S pin to press reset button till the indicator is blinking slowly. Connect your mobile to the device’s hotspot: “SmartLife-XXXX”, then click to return to App interface, it will connect automatically, configuration completed.

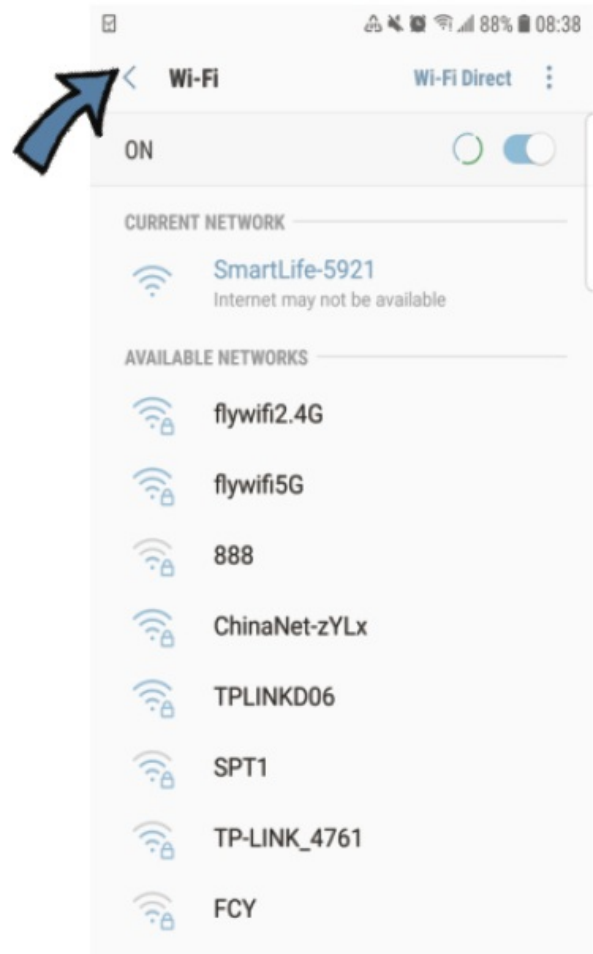
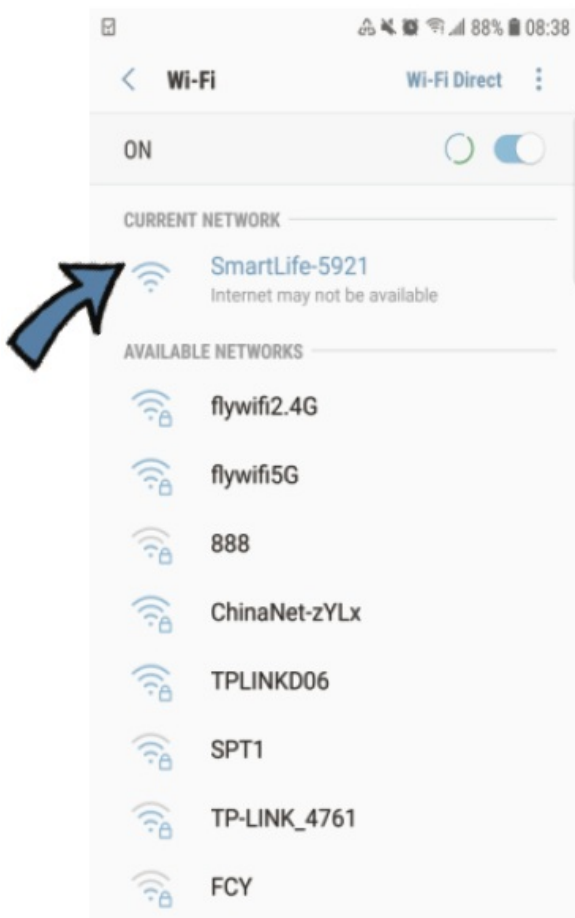
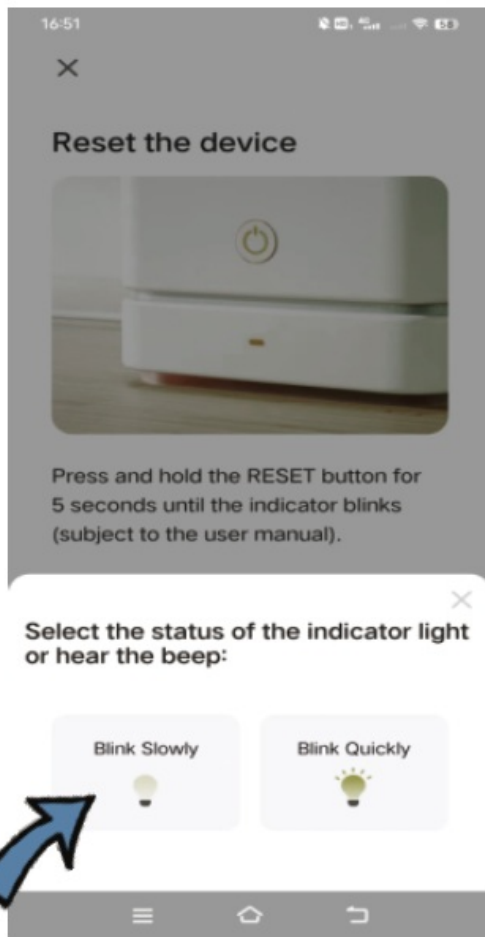

Functions

1. **Alarm alert**

- When the sensor detects someone is passing by, you will receive alarm message on your mobile.

2. **Alarm records**

- You can check all alarm records in the app, so you will not miss any important moments.

3. **Low power alarm**

- When the battery power is low, the app will aler you to replace with new batteries.

4. **Device sharing**

- Share your added sensors with family members, so they can also monitor the status on their App.

5. **Scene linkage**

- You can set scene linkage with other Tuya smart devices such as liaht. When it detects someone is passing by,

FCC

FCC WARNING

This device complies with part 15 of the FCC Rules.

Operation is subject to the following two conditions:

1. This device may not cause harmful interference, and
2. This device must accept any interference received, including interference that may cause undesired operation.

Any changes or modifications not expressly approved by the party responsible for compliance could void the user's authority to operate the equipment.

NOTE: This equipment has been tested and found to comply with the limits for a Class B digital device, pursuant to Part 15 of the FCC Rules. These limits are designed to provide reasonable protection against harmful interference in a residential installation. This equipment generates, uses, and can radiate radio frequency energy and, if not installed and used in accordance with the instructions, may cause harmful interference

to radio communications. However, there is no guarantee that interference will not occur in a particular installation. If this claim is made by fish, which can be determined by turning the equipment off and on, the user is encouraged to try to correct the interference by one or more of the following measures:

- Reorient or relocate the receiving antenna.
- Increase the separation between the equipment and receiver.
- Connect the equipment into an outlet on a circuit different from that to which the receiver is connected
- Consult the dealer or an experienced radio/TV technician for help.

To maintain compliance with FCC's RF Exposure guidelines, this equipment should be installed and operated with a minimum 20cm distance between the radiator and your body. Use only the supplied antenna.

FAQs

1. If you use the motion sensor for the first time, it will alarm when the sensor detects body movement. And there will be about 30s time interval to alarm after you leave the detect angle or detect range then pass by again.
2. The motion sensor is vulnerable to interrupt by heat or light sources, the infrared radiation of human body is easily shielded due to poor penetration, so the detector is hard receiving the infrared.
3. The motion sensor is vulnerable to interruption by RF radiation. When the environment temperature is close to human body temperature, the detect sensitivity will obviously decrease, causing sensor short-term failure sometimes.

Please contact us if you have any questions: Wiooni@outlook.com

Documents / Resources

	WIOONI YXP01-06001 WiFi PIR Motion Sensor [pdf] User Manual 2BKMO-YXP01, 2BKMOYXP01, YXP01-06001 WiFi PIR Motion Sensor, YXP01-06001, WiFi PIR Motion Sensor, PIR Motion Sensor, Motion Sens or
---	--

References

- [User Manual](#)

WIOONI
2BKMO-YXP01, 2BKMOYXP01, Motion Sensor, PIR Motion Sensor, WiFi PIR Motion Sensor, WIOONI, YXP01-06001, YXP01-06001 WiFi PIR Motion Sensor

Leave a comment

Your email address will not be published. Required fields are marked *

Comment *

Name

Email

Website

☐ Save my name, email, and website in this browser for the next time I comment.

Post Comment

Search:

e.g. whirlpool wrf535swhz

Search

[Manuals+](#) | [Upload](#) | [Deep Search](#) | [Privacy Policy](#) | [@manuals.plus](#) | [YouTube](#)

This website is an independent publication and is neither affiliated with nor endorsed by any of the trademark owners. The "Bluetooth®" word mark and logos are registered trademarks owned by Bluetooth SIG, Inc. The "Wi-Fi®" word mark and logos are registered trademarks owned by the Wi-Fi Alliance. Any use of these marks on this website does not imply any affiliation with or endorsement.