



WILO TOP-Z Protect Modul C Instruction Manual

[Home](#) » [wilo](#) » WILO TOP-Z Protect Modul C Instruction Manual 



Installation and operating instructions

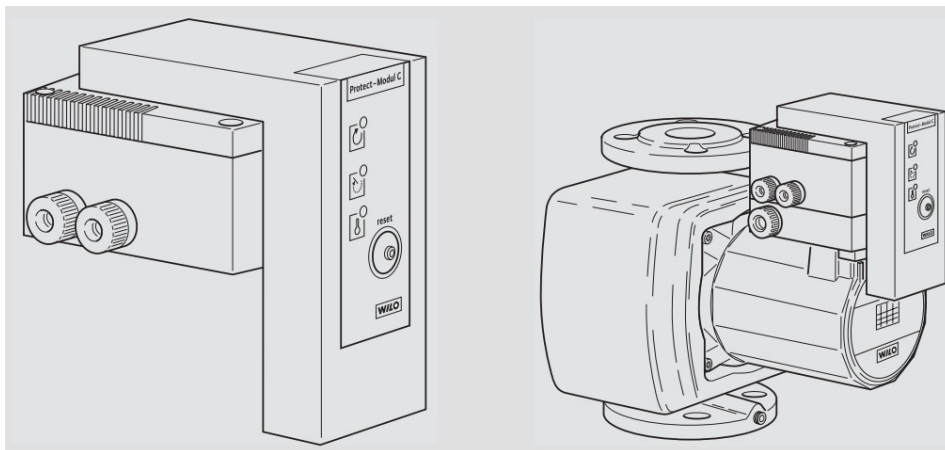

Wilo-Protect-Modul C

Fig.1

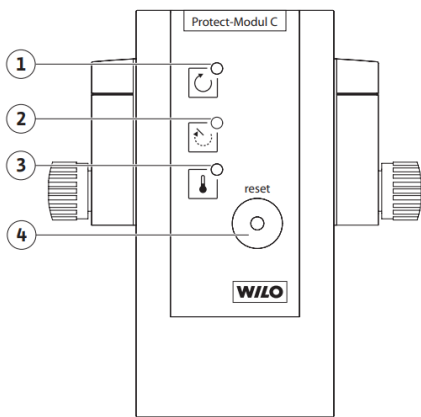

Fig.2a

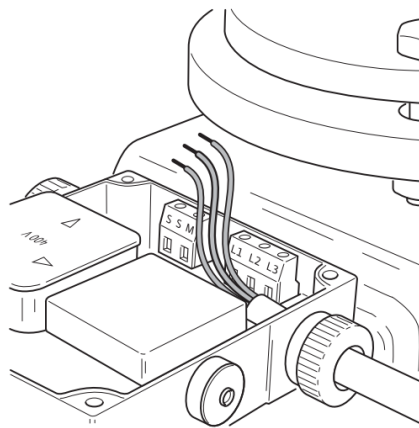

Fig.2b

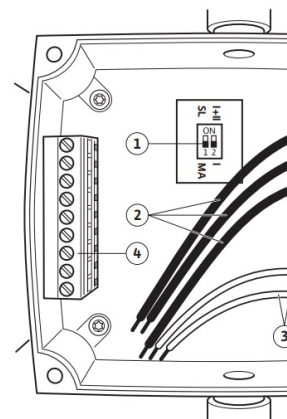

Fig.2d

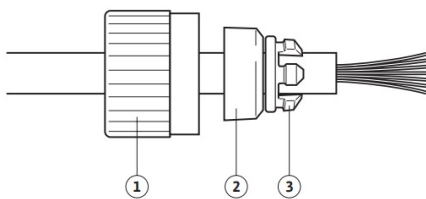

Fig.2e

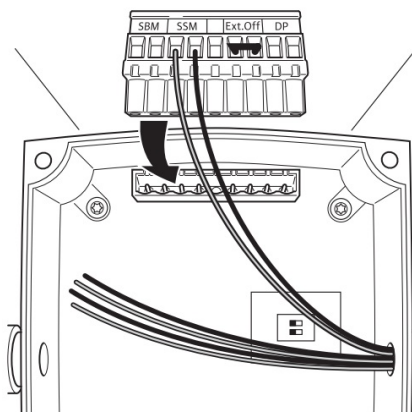

Fig.2f

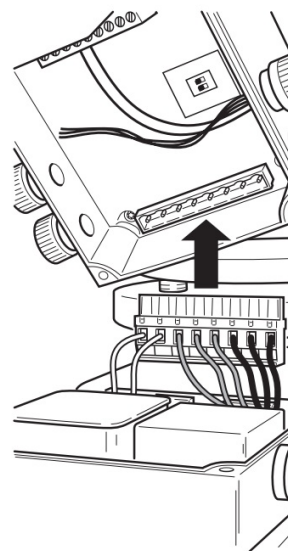

Fig.2g

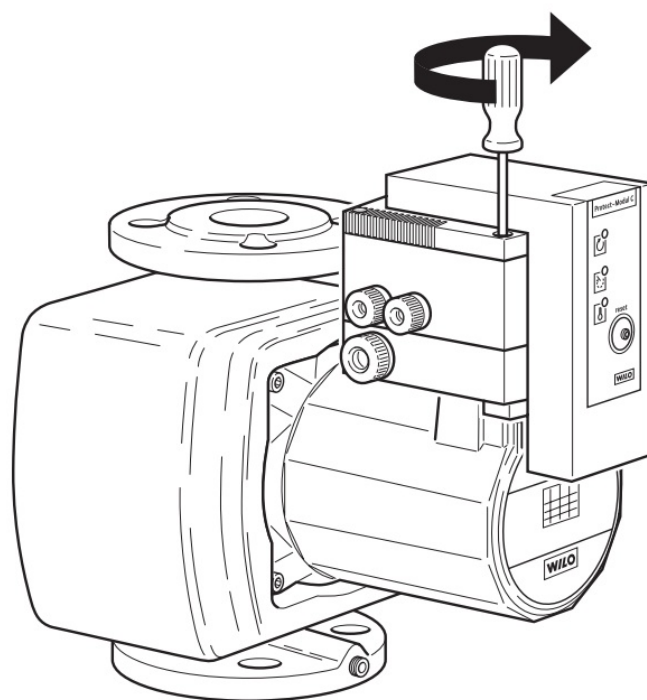

Fig.3a

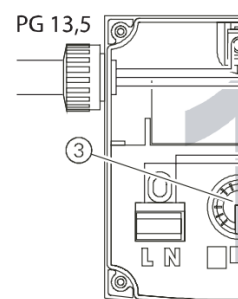

Fig.3b

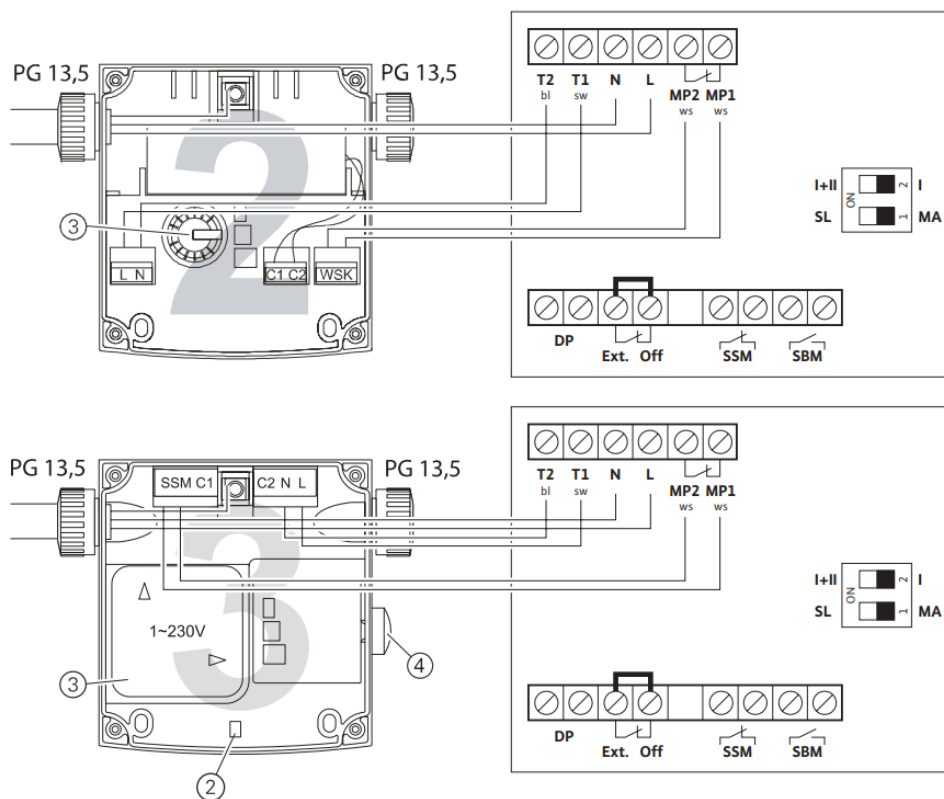

Fig.3c

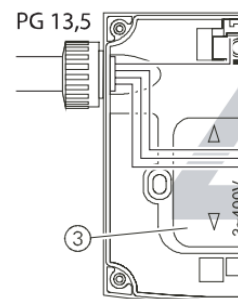

Fig.3d

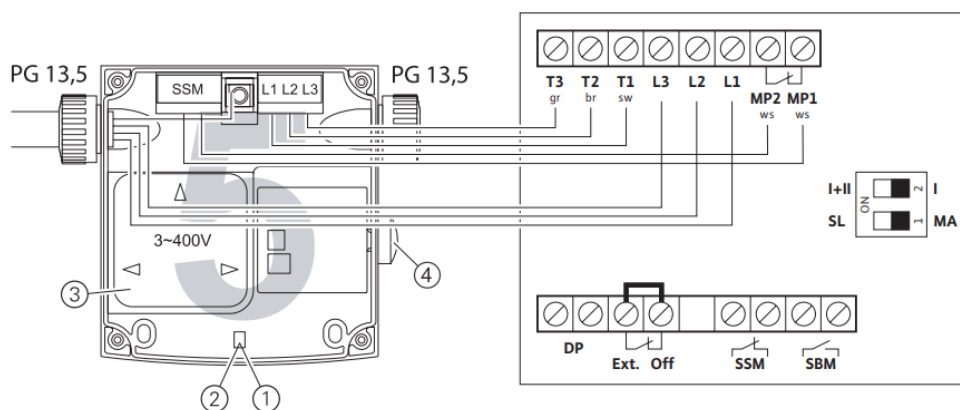
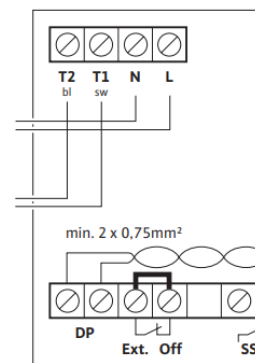

Fig.3e



Contents

- 1 General
- 2 Safety
- 3 Transport and interim storage
- 4 Application
- 5 Product data
- 6 Description and function
- 7 Installation and electrical connection
- 8 Commissioning
- 9 Maintenance
- 10 Faults, causes, and remedies
- 11 Spare parts
- 12 Documents / Resources
 - 12.1 References
- 13 Related Posts

General

1.1 About this document

These Installation and Operating Instructions are an integral part of the product. They must be kept readily available at the place where the product is installed. Strict adherence to these instructions is a precondition for the proper use and correct operation of the product. This Installation and Operating Instructions correspond to the relevant version

of the product and the underlying safety standards valid at the time of going to print.

These Installation and operating instructions are an addition to the Installation and operating instructions for glandless circulation pump type TOP-S/ TOP-SD/TOP-Z.

Safety

These operating instructions contain basic information which must be adhered to during installation and operation. For this reason, these operating instructions must, without fail, be read by the service technician and the responsible operator before installation and commissioning. It is not only the general safety instructions listed under the main point "safety" that must be adhered to but also the special safety instructions with danger symbols included under the following main points.

2.1 Designation of information in the operating instructions

Symbols:



General danger symbol



Danger due to electrical voltage



NOTE: ...

Signal words:

DANGER!

An acutely dangerous situation.

Non-observance results in death or the most serious of injuries.

WARNING!

The user can suffer (serious) injuries. 'Warning' implies that (serious) injury to persons is probable if this information is disregarded.

CAUTION!

There is a risk of damaging the pump/unit. 'Caution' implies that damage to the product is likely if the information is disregarded.

NOTE:

Useful information on using the product. It draws attention to possible problems.

2.2 Personnel qualifications

The installation personnel must have the appropriate qualification for this work.

2.3 Danger in event of non-observance of the safety instructions

Non-observance of the safety instructions can result in a risk of injury to persons and damage to the pump/unit.

Non-observance of the safety instructions can result in the loss of any claims to damages.

In detail, non-observance can, for example, result in the following risks:

- Failure of important pump/unit functions,
- Failure of required maintenance and repair procedures
- Danger to persons from electrical, mechanical, and bacteriological influences,
- Property damage

2.4 Safety instructions for the operator

The existing directives for accident prevention must be adhered to. Danger from electrical current must be eliminated. Local directives or general directives [e.g. IEC, VDE, etc.] and local power supply companies must be adhered to.

2.5 Safety instructions for inspection and installation work

The operator must ensure that all inspection and installation work is carried out by authorized and qualified personnel, who are sufficiently informed from their own detailed study of the operating instructions. Work to the pump/unit must only be carried out when at a standstill.

2.6 Unauthorised alteration and spare part production

Alterations to the pump/unit are only permissible after consultation with the manufacturer. Original spare parts and accessories authorized by the manufacturer ensure safety.

The use of other parts can nullify the liability from the results of their usage.

2.7 Unacceptable operating modes

The operating safety of the supplied pump/unit is only guaranteed for conventional use in accordance with Section 4 of the operating instructions. The limit values must on no account fall under or exceed those specified in the catalog/ datasheet.

Transport and interim storage

On receipt of the product, check it for any damage incurred in transit. In the event of damage in transit, the necessary steps must be taken with the carrier before the relevant deadlines.



CAUTION! The danger of damage to the module!

The danger of damage due to improper handling during transport and storage.

- The Protect-Module C must be protected during transport and storage from moisture, frost and mechanical damage.
- It must not be exposed to any temperature outside the range – 10 °C to +70°C.

Application

The TOP series circulating pumps come equipped with a standard terminal box.

A retrofit plug-in module is available for the pump with the Protect-Module C (see title illustration). In addition to the pump functions, the Protect-Module C also enables further signals as well as the performance of control tasks. When the Protect-Module C is deployed, external contractors and supplementary switchgear are no longer

required,
with a corresponding effect on the complexity of the installation.

Product data

5.1 Type Key

Example: Wilo-Protect-Modul C Type 22 EM	
Protect-Modul	Series designation
C	comfort
Type 22	Type designation: 22 or 32-52
EM	For mains connection: EM = 1~230 V, 50 Hz (single-phase motor) DM = 3~400 V, 50 Hz (three-phase current motor)

5.2 Technical data

Technical data	
Connection current Type 22 EM Type 32-52 EM Type 22 DM Type 32-52 DM	1~230 V, ±10 %, 50 Hz 1~230 V, ±10 %, 50 Hz 3~400 V, ±10 %, 50 Hz 3~400 V, ±10 %, 50 Hz
Frequency	50 Hz
Terminal cross-section, all terminals	max. 2.5 mm ²
Temperature range of flow medium	-20 °C to +110 °C
Max. ambient temperature	+40 °C
Pump protection class	IP 44
Cable connections	4xPG9
Electromagnetic compatibility: Emitted interference Immunity to interference	EN 61000-6-3 EN 61000-6-2

5.3 Scope of supply

- Protect-Module C

- Plug strip control and signal terminals
- Plug strip mains connection terminals and connection terminals WSK/SSM with connection cables
- Fixing screws (4)
- Installation and operating instructions

Description and function

6.1 Description of the Protect-Module C

The functions of the pump housing in the terminal box (mains connection, thermal winding contact WSK or potential-free collective fault signal) are transferred to the terminal box when the Protect-Module C is installed. The fault acknowledgment button and the direction of the rotation control lamp, if fitted, as well as the manual speed stage switching of the standard terminal box continue to function when the Protect-Module C is installed. The Protect-Module C is fitted to the standard terminal box of the pump in place of the terminal box cover.

6.2 Functions and operation of the Protect-Module C

6.2.1 Light signals

There are three possible light signals on the display field:

- Operation light signal (figure 1, position 1)



WARNING! The danger of electric shock Even when the operation light signal is off, the voltage may be present on the Protect-Module.

- Fault signal light "Stoppage" (figure 1, position 2)
- Fault signal light "Winding Overheat" (figure 1, position 3)

6.2.2 Fault acknowledgement buttons

- Fault acknowledgment button on the pump (figures 3b, 3d, position 4) If fitted, this button is used to reset the response of the integrated full motor protection. This fault reset is done before the fault reset on the Protect-Module C.
- Fault acknowledgement button on Protect-Module C (figure 1, position 4)
- A fault displayed on the Protect-Module C is reset by briefly pressing this button (< 1s).
- Pressing and holding down the button (≥ 1s) triggers pump cycling in dual pump operation with integrated dual pump management.

6.2.3 Faults, light signals, signal contacts

- Single pump

The following table shows the links between possible faults and the reactions of light signals and signal contacts:

Operating element	Status	Possible causes
Operation light signal green	off	<ul style="list-style-type: none"> •No supply voltage. •Control input “Ext. Off” opened. •Fault is present and has not yet been acknowledged.
	flashing	<ul style="list-style-type: none"> •DP communication fault (only with a double pump).
Fault signal light “Stoppage” red	off	<ul style="list-style-type: none"> •No motor stoppage.
	on	<ul style="list-style-type: none"> •Motor stoppage recognized. •Mechanical blockage of pump •Winding fault
	flashing	<ul style="list-style-type: none"> •Motor stoppage acknowledged, the pump is in control loop 1).
Fault signal light “Winding Overheat” red	off	<ul style="list-style-type: none"> •No overheating.
	on	<ul style="list-style-type: none"> •Overheat recognized. •Pump overload •Winding fault •Unacceptable combination of medium temperature — ambient temperature
	flashing	<ul style="list-style-type: none"> •Overheat acknowledged, the pump is in control loop 1).
Operating signal contact	open	<ul style="list-style-type: none"> •No supply voltage. •Control input “Ext. Off” opened. •Fault is present and has not yet been acknowledged.
	closed	<ul style="list-style-type: none"> •Pump functioning, no-fault recognized.
Fault signal contact	open	<ul style="list-style-type: none"> •Fault is present. •Pump is still in control loop 1).
	closed	<ul style="list-style-type: none"> •Fault-free operation.
Fault signal light “Stoppage” red	off	<ul style="list-style-type: none"> •No motor stoppage.
	on	<ul style="list-style-type: none"> •Motor stoppage recognized. •Mechanical blockage of the pump. •Winding fault.

1. After acknowledging a fault, the Protect-Module C will be in a special control loop for up to 10 sec, depending on pump type and fault. If the fault is recognized again during this process, the pump returns to fault status.

Table 1

- Double pump:

The relationships between possible faults and the reactions of light signals and signal contacts depend on the following factors:

- Parametrization of signal contacts in individual operation/individual fault signal or joint operation/collective fault signal (function see Table 2)
- Allocation of “Ext. Off” control inputs to master and slave

6.2.4 Double pump operation

A Protect-Module C must be installed for each of the two pumps.

The double pump functions on the Protect-Module C are:

- Main/Reserve operation with automatic switching to the standby reserve pump after 24 hours of real running time, the external control command “Ext. Off” interrupts the running time counter.
- Switching takes place through an overlap, i.e. at the time of switching, both pumps run simultaneously (for approx. 10 sec.). This avoids pressure surges and undersupplies in cooling and air-conditioning systems for example.
- The DIP switch 1 (figure 2b, position 1) determines which pump is the master (MA) and which pump is the slave (SL) (function see Table 2).
- The DIP switch 2 (figure 2b, position 1) determines whether the signal contacts “SSM” and “SBM” are individual or collective signals (function see Table 2).
- In the case of a fault in the working pump, the system switches to the standby pump after approx. 3 sec.

Single pump	Double pump	
	Master (MA)	Slave (SL)
DIP Switch1: MA DIP Switch2: I Allocate terminals to Ext. Off	DIP Switch1: MA DIP Switch2: Allocate terminals to Ext. Off	DIP Switch1: SL DIP Switch2: Bridge terminals to Ext. Off
DIP Switch1: MA DIP Switch2: I SSM: Collective fault signal for pump	DIP Switch1: MA DIP Switch2: I SSM: Individual fault signal for MA DIP Switch2: I + II SSM: Collective fault signal for MA + SL	DIP Switch1: SL DIP Switch2: SSM: Individual fault signal for SL DIP Switch2: SSM: Individual fault signal for SL
DIP Switch1: MA DIP Switch2: I SBM: Individual operating signal for pump	DIP Switch1: MA DIP Switch2: I SBM: Individual operating signal for MA DIP Switch2: I + II SBM: Collective operating signal for MA + SL	DIP Switch1: SL DIP Switch2: SBM: Individual operating signal for SL DIP Switch2: SBM: Individual operating signal for SL

– : Setting of DIP switch not relevant

Table 2

Installation and electrical connection

Installation and the electrical connection must be carried out in accordance with local regulations and only by qualified personnel.



WARNING! The danger of personal injury The applicable regulations on the prevention of accidents must be observed.



WARNING! The danger of electric shock Potential dangers from electrical currents must be eliminated. Local directives or general regulations [e.g. IEC, VDE, etc.] and those issued by the local power supply company must be adhered to.

7.1 Installation and electrical connection of mains cable

1. Switch off the power supply to pump,



CAUTION! The danger of damage to Protect-Module C The module may only be plugged in and unplugged when the pump has been completely disconnected.

2. Loosen the terminal box lid screws on the pump,
3. Remove terminal box lid,
4. Pinch off the power supply cable except for the protective lead PE: EM version (1~230V): L, N DM version (3~400V) L1, L2, L3 (figure 2a)
5. Remove plug strip with power supply terminals and connection terminals MP1/MP2 (figure 2b, position 5) with connection cables (figure 2b, position. 2.3) from the Protect-Module C. When removing, do not pull straight out, but begin at one corner of the plug strip,
6. Apply the plug strip cables to the corresponding terminals on the pump terminal box (figure 2c, figure 3),
7. Fit the power supply cable to the plug strip, Table 3 shows the allocation of module types to the terminal diagrams.

Protect-Module C	Terminal diagram
Type 22 EM	3a
Type 32-52 EM	3b
Type 22 DM	3c
Type 32-52 DM	3d

Table 3

8. Remove the plug strip with control and signal terminals (figure 2b, position 4) from the Protect-Module C. When removing, do not pull straight out, but begin at one corner of the plug strip,
 - 8.1 Dismantle cable connection (PG 9) of the Protect-Module C,
 - 8.2 Cut diaphragm seal,
 - 8.3 Thread individual parts of the cable connection onto the control cable (figure 2d),
Pos. 1: Union connection
Pos. 2: Seal
Pos. 3: Strain relief
 - 8.4 Insert control cable through cable connection into Protect-Module C,
 - 8.5 Assemble cable connection, fastening union nuts tightly enough so that the cable can no longer be pulled out of the cable connection by hand.



CAUTION! The danger of damage to Protect-Module C An incorrectly assembled cable connection may lead to a short-circuit in the module due to water penetration. This is a particular danger in cold water installations in which condensation constantly forms.

9. Fix the control cable to the plug strip (figure 2 e),
10. Plug the plug strip with the control cable to the corresponding place in the Protect-Module C,
11. Set DIP switch (figure 2b, position 1) in accordance with Table 2,
12. Plug the Protect-Module C onto the plug strip with the power connections (figure 2f),



Note: Arrange power cables and leads so that they cannot be crushed when finally tightening the module

installation.

In DM versions, it is essential before final tightening of the module installation to check the direction of rotation with the direction of the rotation control lamp in the pump terminal box (figures 3c, 3d, position 1).

13. Arrange the Protect-Module C over the terminal box structure and screw to the domes of the terminal box using the screws provided, tighten screws evenly diagonally (figure 2g).
- Stages 1 to 4 are not required for a new installation. Power connection is made directly on the corresponding plug strip with power connection terminals and connection terminals MP1/MP2.
 - For a double pump, as previously described, two Protect-Modules C must be fitted. For integrated dual pump management, the DP terminals of the two Protect-Modules C must be connected to each other, see also figure 3e.

7.2 Electrical connection of control and signal clamps

For connection to a remote control center or building automation, the following connections are provided:

- Ext. Off: Control input with “drive priority off” for potential-free normally closed contacts, contact charge 24V, 10 mA.

In dual pump operation, Ext. Off on the master must be assigned to a potential-free normally closed contact, and Ext. Off on the slave must remain bridged. The Ext. Off of the master works on the entire double pump, i.e. master and slave.

- SBM: Programmable run signal, potential-free normally opened contact, maximum contact capacity 250 VAC, 1 A.
- SSM: Programmable fault signal, potential-free normally closed contact, maximum contact capacity 250 VAC, 1 A.

A serial interface is provided for integrated dual pump management:

- DP: Interface for integrated dual pump management, the connection terminals cannot be twisted. The connection cable (2 x 0.75 mm²) must be provided on site. Wiring for all Protect-Modules is shown in the example in figure 3e.

Commissioning



CAUTION! The danger of damage to Protect-Module C. When commissioning, the Installation and operating instructions of the glandless circulation pump, types TOP-S/TOP-SD/TOP-Z must be observed.



NOTE: Rotation control (only for three-phase motors) In pumps with a three-phase connection, before the final tightening of the module installation, it is essential to check the direction of rotation with the direction of the rotation control lamp in the pump terminal box (figures 3c, 3d, position 1).

- When the Protect-Module C is fully installed, switch on the power supply.

Maintenance

Maintenance and repair work must only be carried out by professionally qualified personnel.



WARNING! The danger of electric shock. Potential dangers from electrical currents must be eliminated. During all maintenance and repair work, the pump must be disconnected from the power supply and secured.

against possible unauthorized reconnection.

Faults, causes, and remedies

see paragraph 6.2

If an operating fault of the pump / the Protect-Module C / system cannot be corrected, please consult a professional technician or contact your nearest Wilo Customer Service point or representative.

Spare parts

Spare parts may be ordered through local professional technicians and/or Wilo Customer Service. To avoid queries and order errors, all data on the rating plate must be given along with every order.

Wilo – International (Subsidiaries)

USA
WILO USA LLC
Calgary, Alberta T2A5L4
T +1 403 2769456
F +1 403 2779456
blowe@wilo-na.com

Wilo – International (Representation offices)

Bosnia and Herzegovina
71000 Sarajevo
T +387 33 714511
F +387 33 714510
anton.mrak@wilo.si





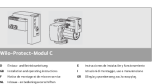

WILO AG
Nortkirchenstraße 100
44263 Dortmund
Germany
T 0231 4102-0
F 0231 4102-7363
wilo@wilo.de
www.wilo.de

Documents / Resources

 <p>WILO TOP-Z Protect Modul C</p> <ul style="list-style-type: none">• 100% stainless steel construction• 100% stainless steel construction• 100% stainless steel construction• 100% stainless steel construction• 100% stainless steel construction• 100% stainless steel construction	<p>WILO TOP-Z Protect Modul C [pdf] Instruction Manual TOP-Z Protect Modul C, TOP-Z, Protect Modul C</p>
---	--

References

-  [Commercial Distributor & Supply Company | North American](#)
-  [100% WIR | Crisol Holding GmbH](#)
-  [Wilo Corporate - Pioneering for You | WILO](#)
-  [Wilo - Pumpenhersteller in Ihrer Nähe seit 1872 | Wilo](#)

Manuals+.