



# WHALETEQ DFS200 APP AED Testing APP User Manual

[Home](#) » [WHALETEQ](#) » WHALETEQ DFS200 APP AED Testing APP User Manual 



DFS200 APP AED Testing APP  
User Manual



## Contents

- 1 DFS200 APP User and Scenario
- 2 Maintenance Order Overview
- 3 Documents / Resources
  - 3.1 References
- 4 Related Posts

## DFS200 APP User and Scenario



### AED Field Technician

Create and process orders on-site Process orders assigned through the AIMS

1. Create a Maintenance Order
2. Process a Maintenance Order Process a Maintenance Order

### User Scenario Instruction



### AED Owner

Create and process orders on-site

1. Create a Maintenance Order
2. Process a Maintenance Order

## DFS200 APP Overview (standalone mode, not logging in to the AIMS)

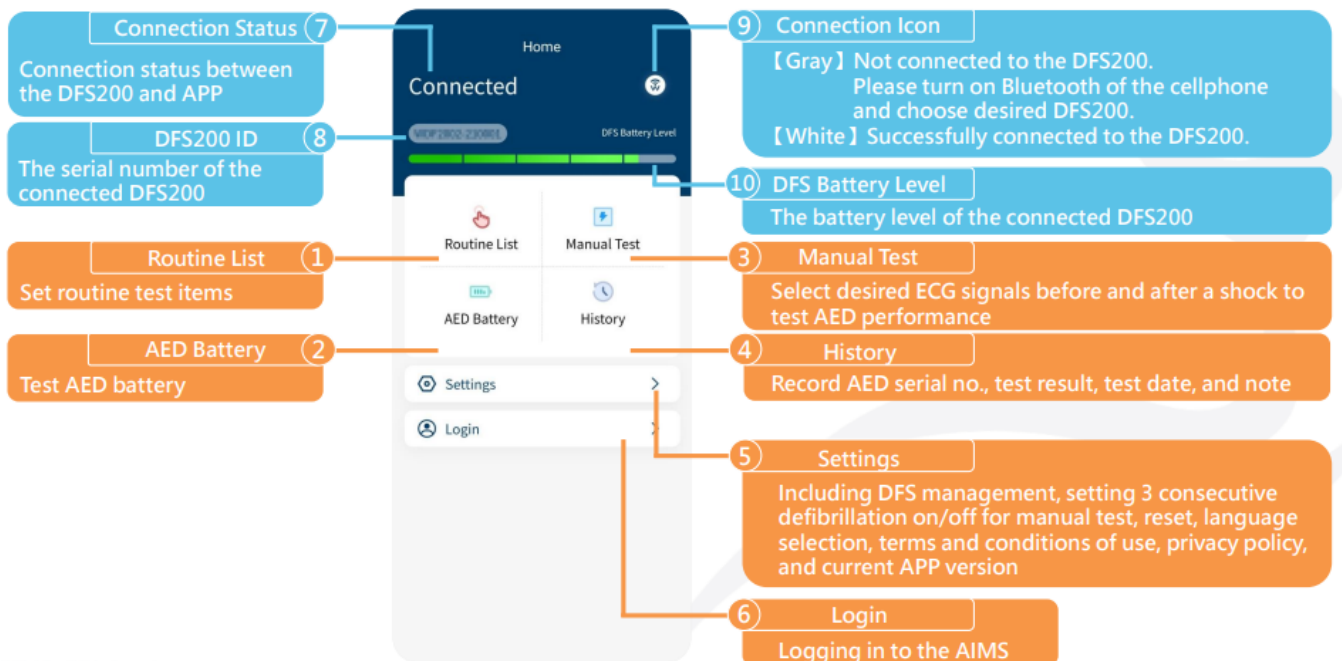

## DFS200 APP Overview (logging in to the AIMS)

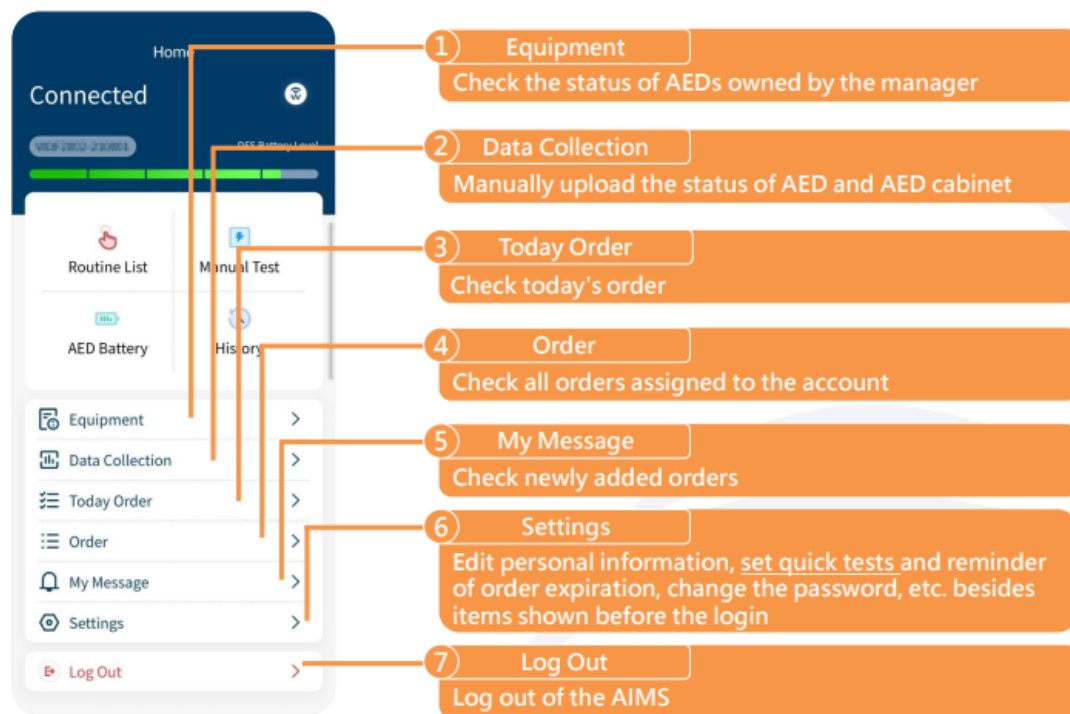

## Maintenance Order Overview

The maintenance order includes 8 items:

1. Basic Information
2. Outer Case
3. AED Main Unit
4. Battery
5. Accessories
6. Functionality
7. Replace Consumables
8. Photos and Signatures

The screenshot shows the 'Processing maintenance order' form. It is divided into three main sections, each with a numbered callout:

- 1 Basic Information**: Including the processor, process result, maintenance time, AED Battery Test, Manual Test, etc.
  - Processor: Parai
  - Process result: Not processed >
  - Maintenance time: 2023-03-06
  - Next maintenance time: Please choose the next time
  - Remark: Please enter a note desc
  - AED Battery: AED Battery
  - Manual Test: Manual Test
- 2 Outer Case**: The status of the AED cabinet, cabinet alarm, and wall signboard.
  - AED Storage Cabinet/ Bracket: ☒ Normal ☐ Abnormal ☐ N/A
  - Cabinet alarm/ alert: ☒ Normal ☐ Abnormal ☐ N/A
  - Wall Sign: ☒ Normal ☐ Abnormal ☐ N/A
- 3 AED Main Unit**: The status of AED's appearance, status indicator, voice prompt, etc.
  - AED Unit Clean/ undamaged/ free of excessive wear (outer appearance): ☐ Normal ☒ Abnormal ☐ N/A
  - Status indicator: ☐ Normal ☒ Abnormal ☐ N/A
  - Voice prompt: ☐ Normal ☒ Abnormal ☐ N/A
  - Self-check: ☐ Normal ☒ Abnormal ☐ N/A
  - Shock indicator: ☐ Normal ☒ Abnormal ☐ N/A
  - AED LCD Screen: ☐ Normal ☒ Abnormal

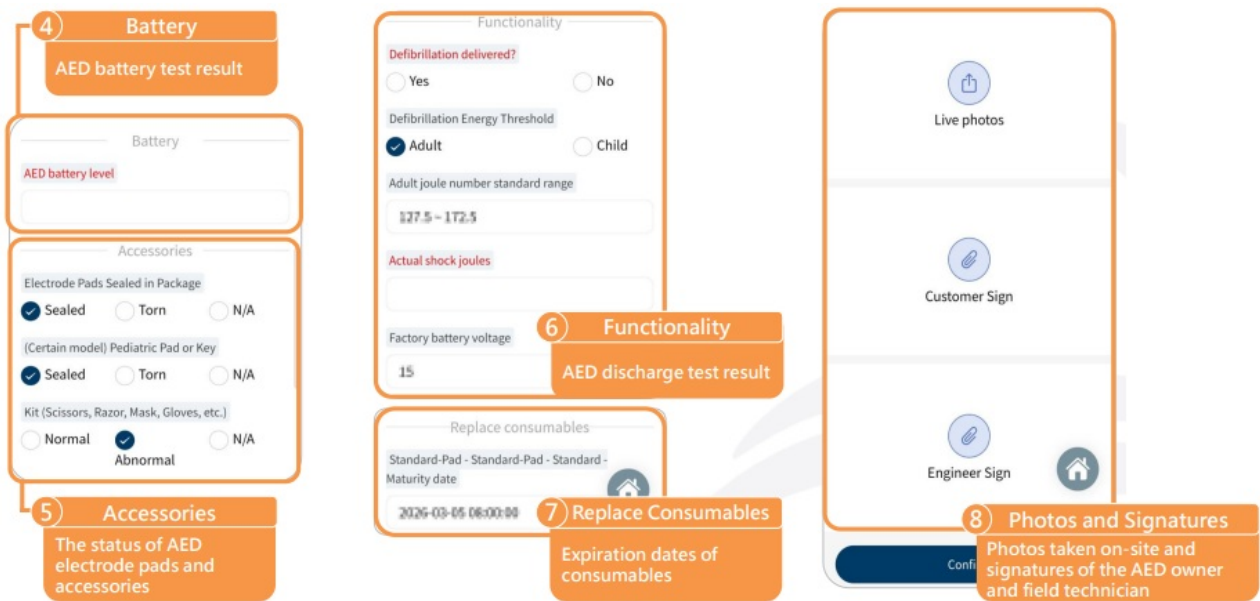

## Create a Maintenance Order

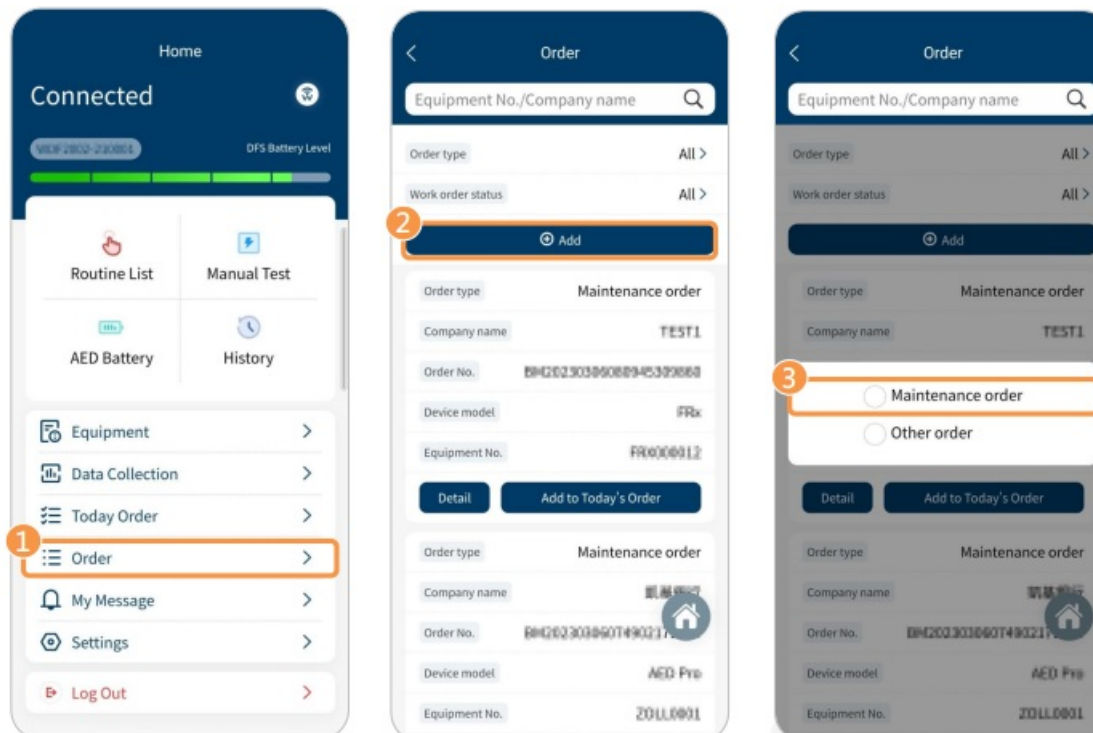

1. Select Order on the Home page.
2. Click Add button on the Order page.
3. Select Maintenance Order.

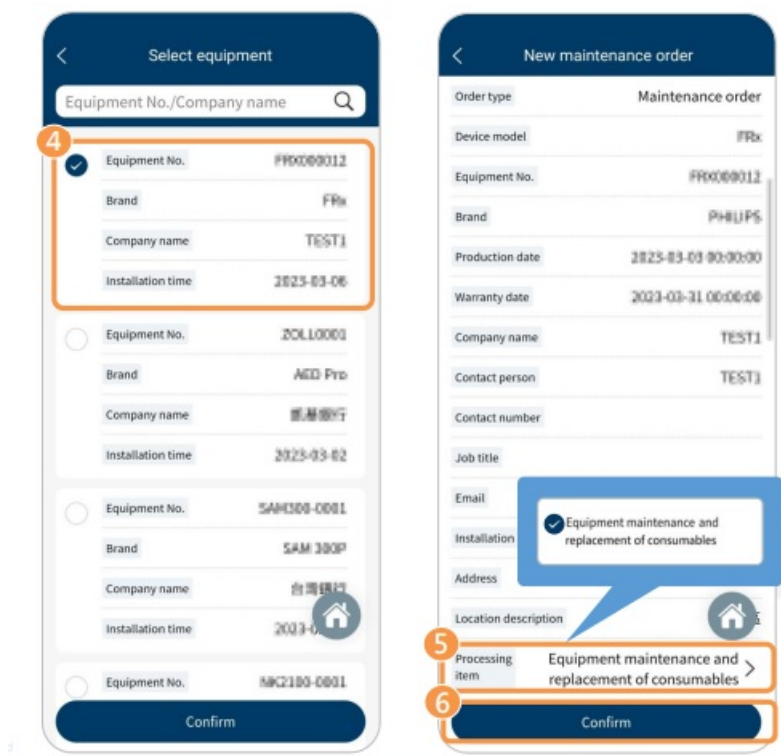

4. Select a desired AED and click Confirm button to go to the New maintenance order page.
5. Click Processing item and make sure Equipment maintenance and replacement of consumables is checked.
6. Click Confirm button to complete the procedure, and it will automatically return to the Order page.

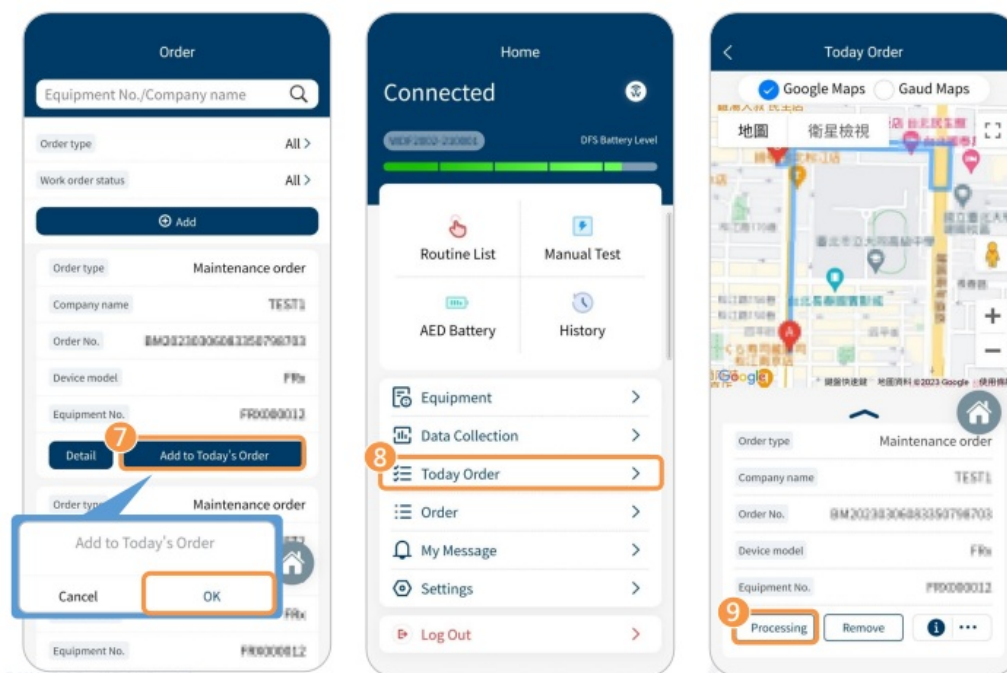

7. Click Add to Today's Order button and OK to confirm.
8. Back to the Home page and click Today Order.
9. Click Processing button of the new maintenance order to start the test (see next page).

## Process a Maintenance Order

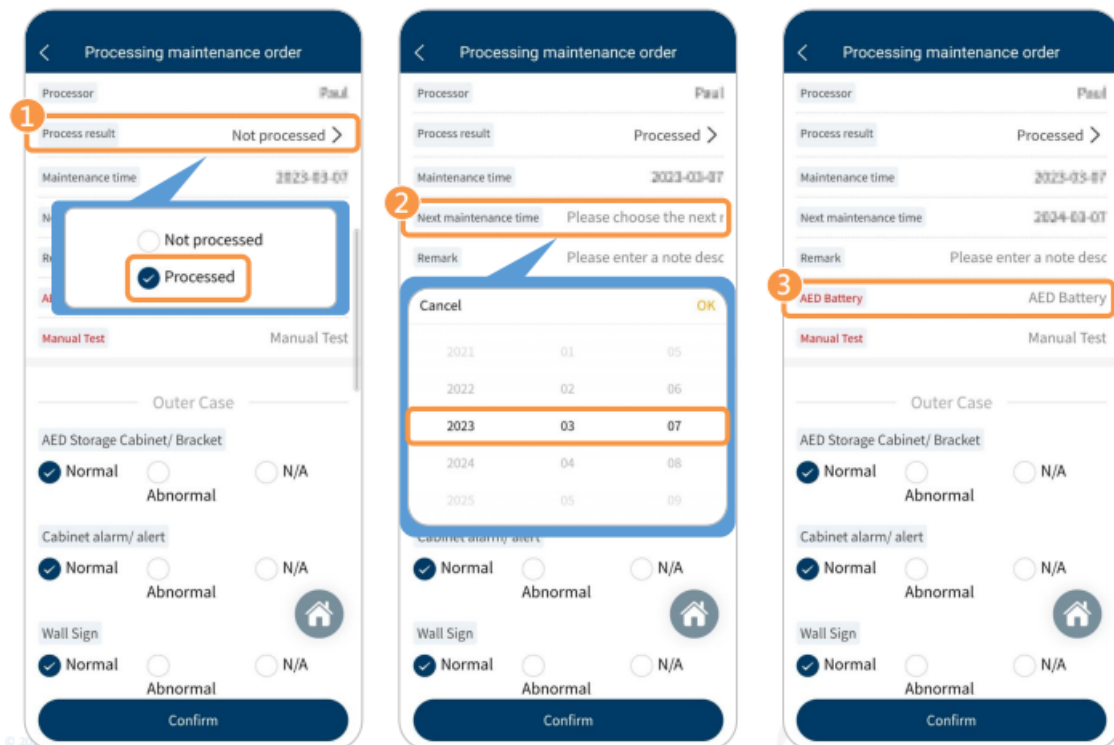

Click Today Order on the Home page and Processing button of the desired maintenance order to start the test.

1. Click Process result on the Processing maintenance order page to select Processed.
2. Click Next maintenance time and scroll to select the correct date, then click OK.
3. Click AED Battery to start the battery test.

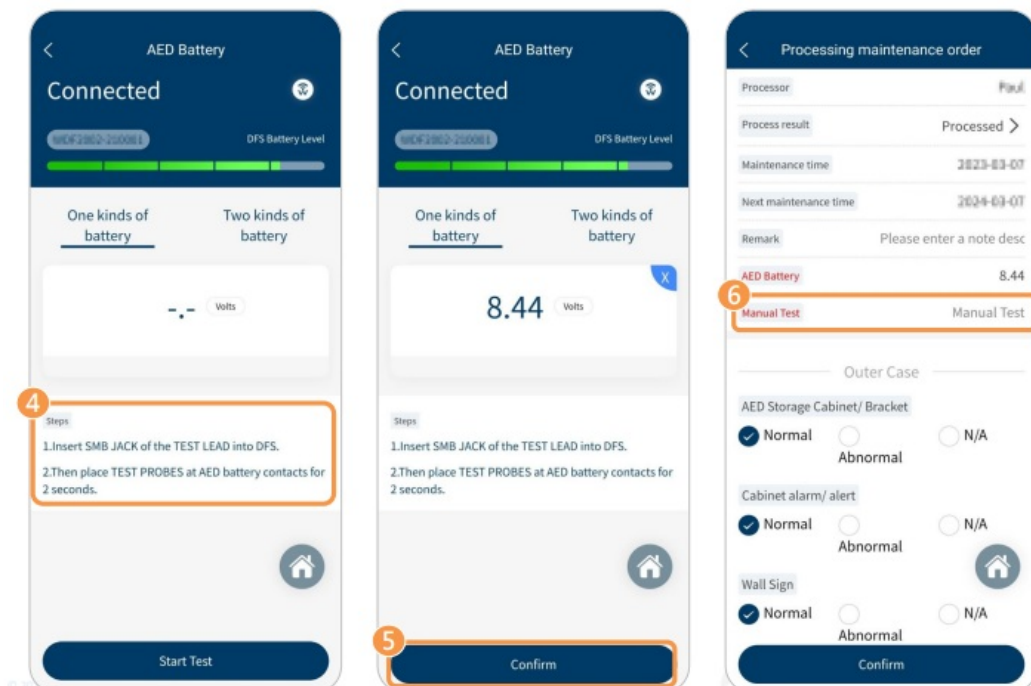

4. Follow the steps on the AED Battery page for testing, then click Start Test button.
5. The test result will show on the page. Click Confirm button to return to the Processing maintenance order page.
6. Click Manual Test to start the discharge test.



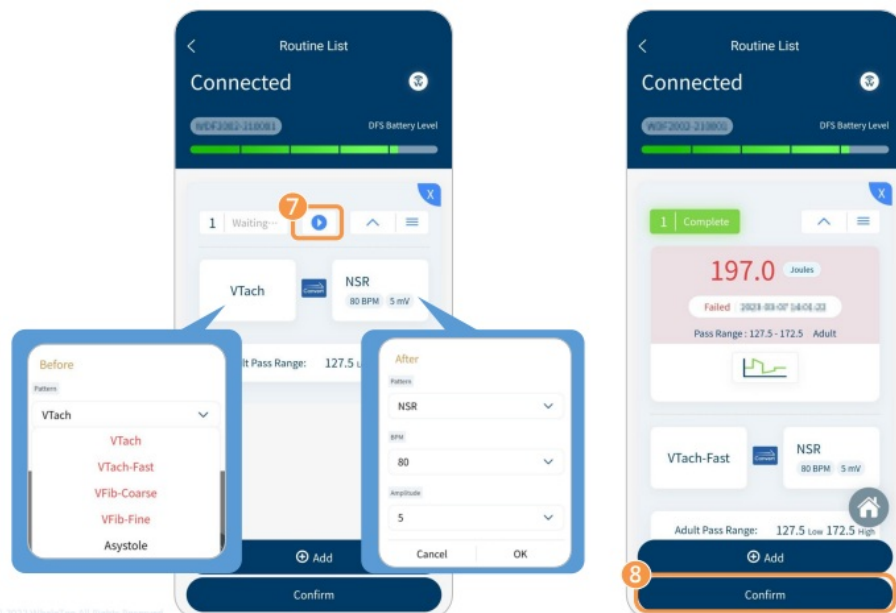

7. On the Routine List page, users can select desired ECG signals before and after a shock, and click Add button to add up to 6 sets of different test settings. After setting desired ECG signals and testing sets, check the connection between the DFS200 and AED is secure, then click the play icon (  ) to start the test.
8. After the AED gives a shock to the DFS200, the test result will show on the page. Click Confirm button to return to the Processing maintenance order page.

**Note:** Users can set a quick test in advance and use it to conduct the discharge test. Please refer to Use a Quick Test for the Discharge Test.

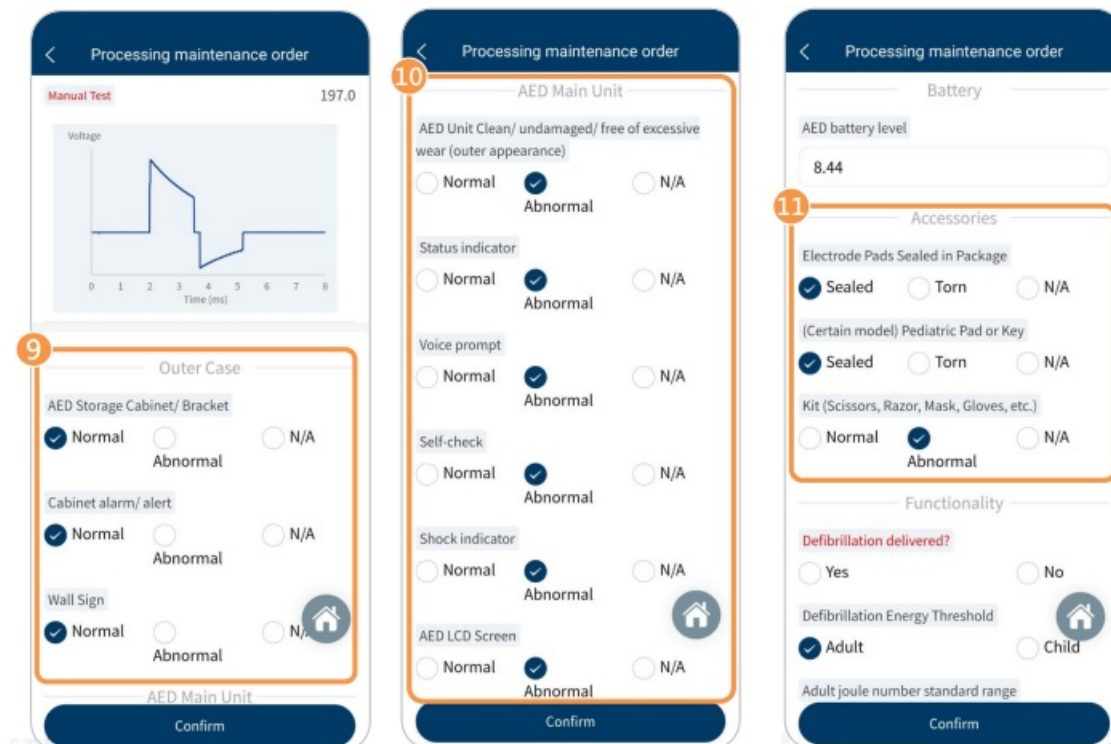

9. Check the AED cabinet, cabinet alarm, and wall signboard, then select the correct status.
10. Check the AED's appearance, status indicator, voice prompt, etc., then select the correct status.
11. Check the AED electrode pads and accessories, then select the correct status.

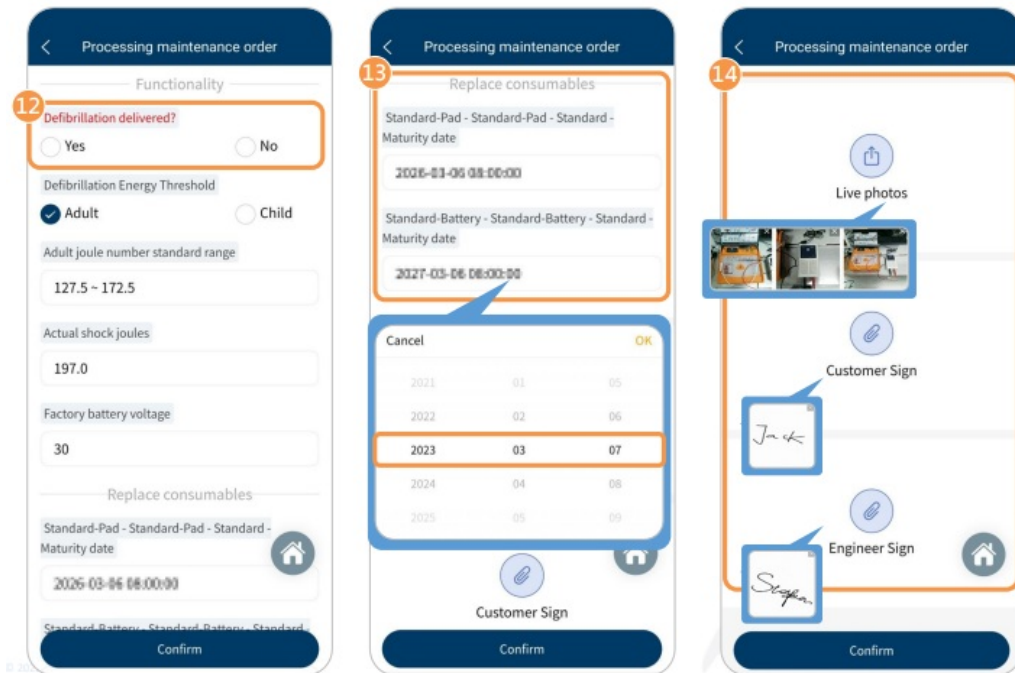

12. Select the correct AED defibrillation performance.
13. (Optional) If consumables are replaced, scroll to select the correct expiration date, then click OK.
14. Take 6 photos at most on-site and upload them, then the AED owner and field technician should sign on the page. Finally, click Confirm button to complete this maintenance order.

## Download a Test Report

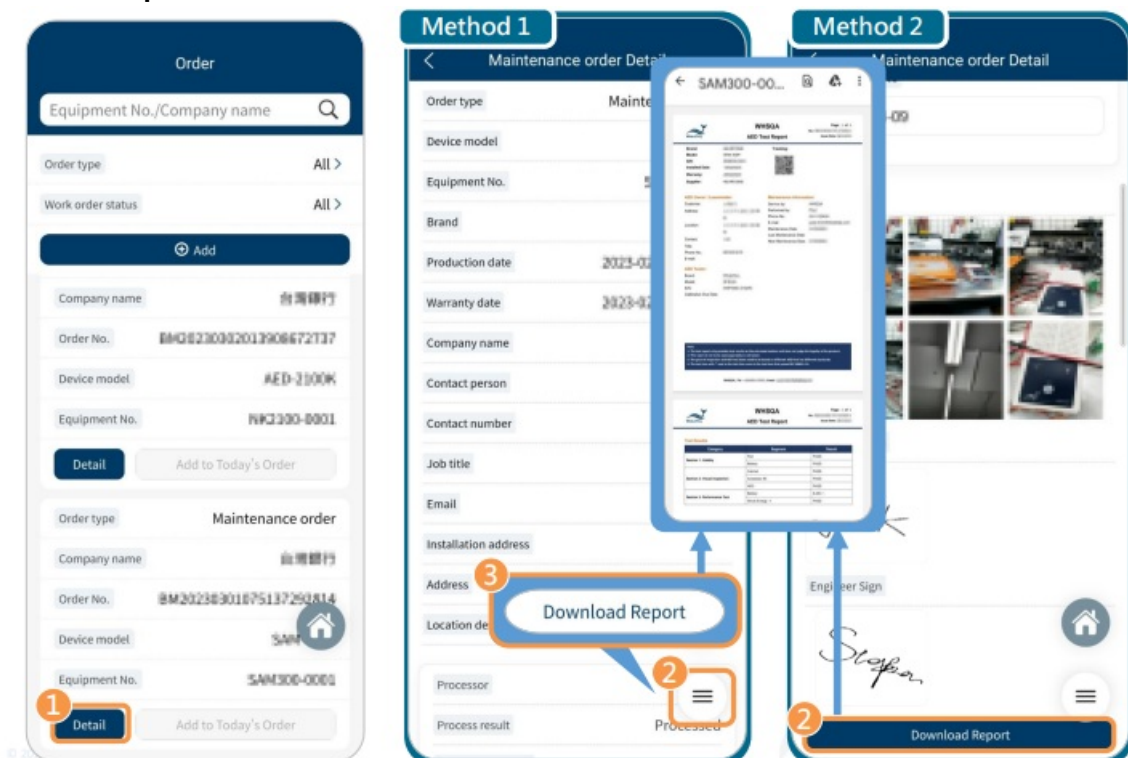

After the manager approves and successfully sends a test report on the AIMS, users can download it through the APP.

1. Click Order on the Home page and Detail button of the desired maintenance order. Method 1:
2. Click the menu icon (☰) on the Maintenance order detail page to bring up Download Report button.
3. Click Download Report button to download the test report. Method 2:
4. Scroll to the bottom of the Maintenance order detail page and click Download Report button.



## Set a Quick Test

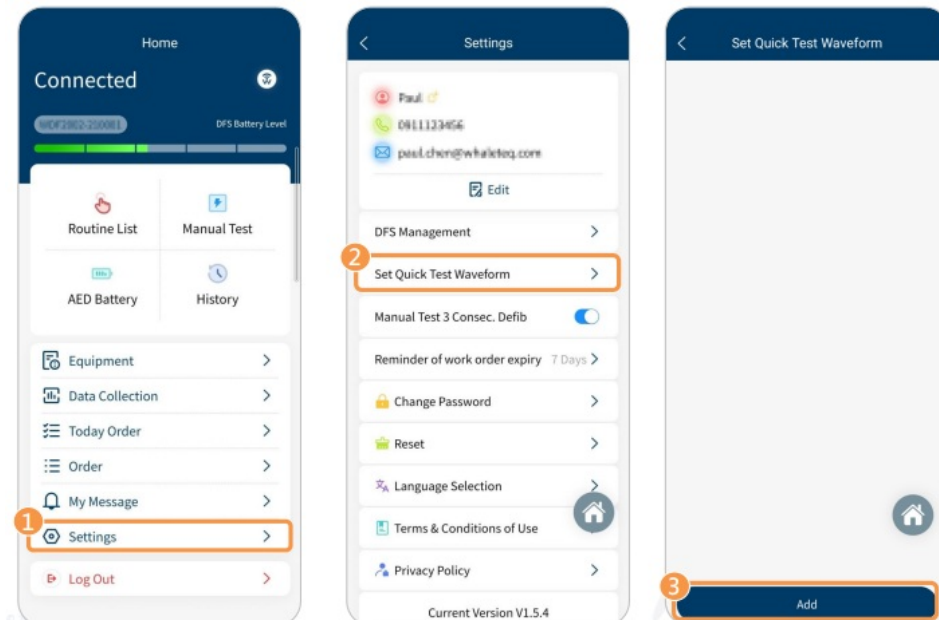

1. Select Settings on the Home page.
2. Select Set Quick Test Waveform on the Settings page.
3. Click Add button on the Set Quick Test Waveform page.

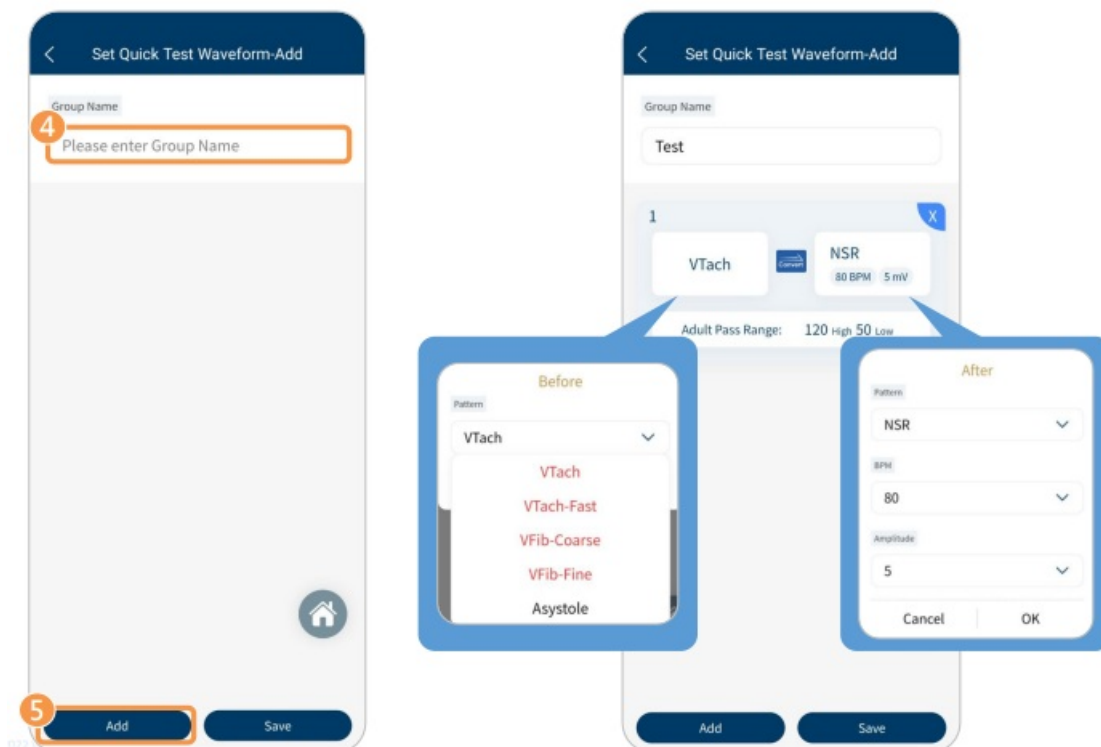

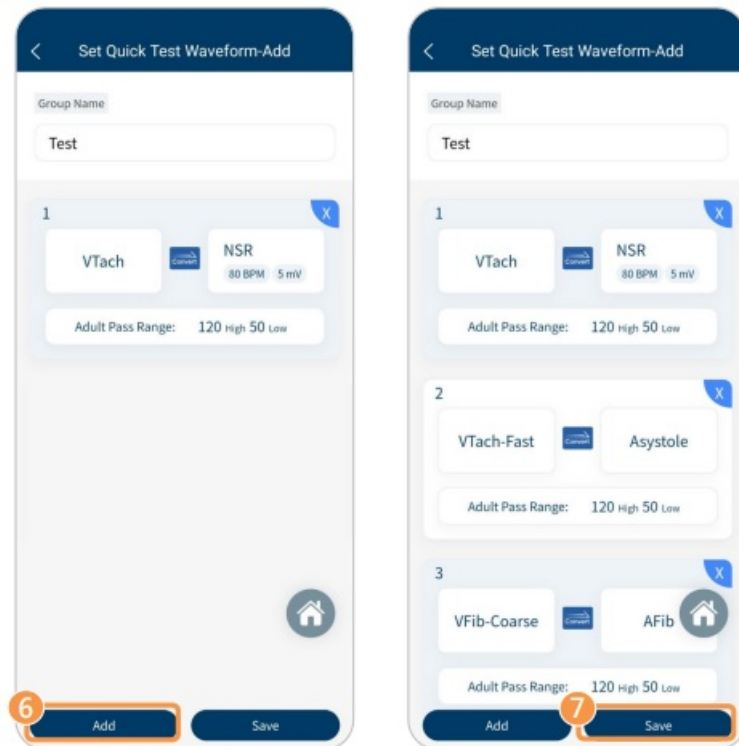

4. Name the new quick test.
5. Click Add button to add a set of ECG signals to the new quick test. Users can select desired ECG signals before and after a shock.



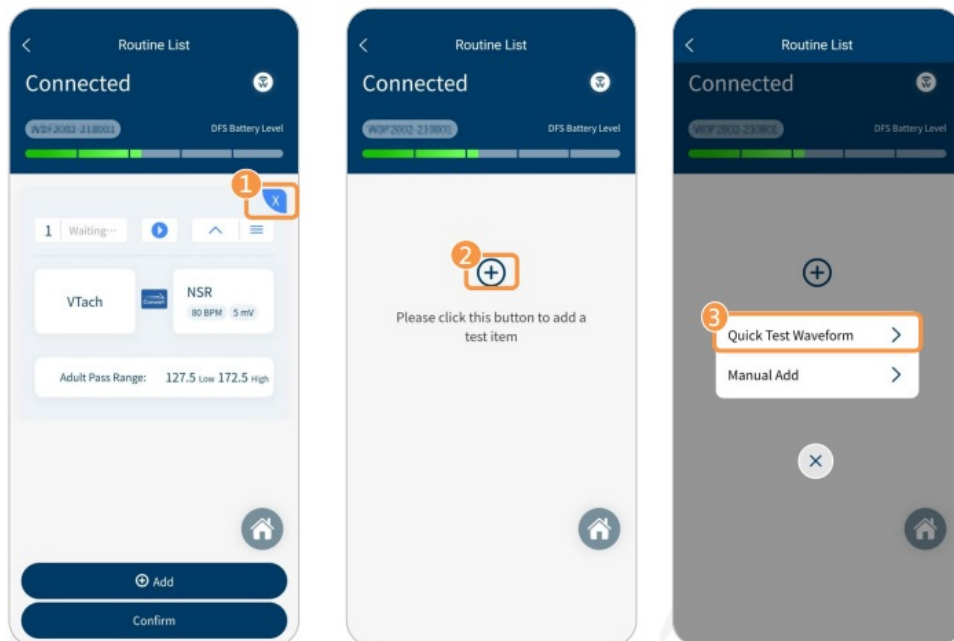

6. (Optional) After completing the first set's settings, click Add button to add more sets of different test settings (up to 6 sets in total).
7. Click Save button to save the new quick test's settings.

### Use a Quick Test for the Discharge Test

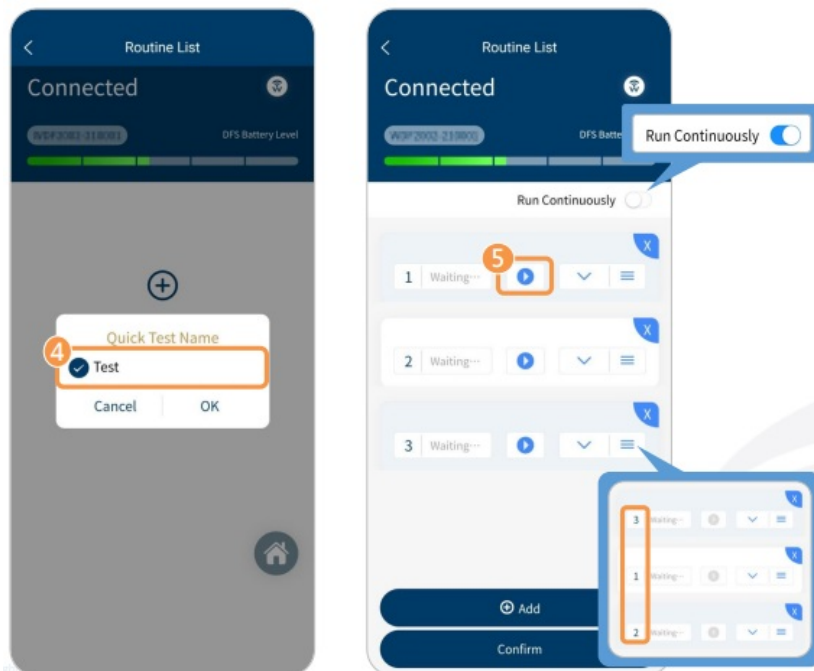

1. Click the delete icon (  ) of the default testing set on the Routine List page.
2. Click the add icon (  ).
3. Select Quick Test Waveform.



4. Select a desired quick test and click OK.
5. Click the play icon (  ) to start the test. If users turn on Run Continuously switch, all testing sets will be automatically played according to the user-defined order.

If users need to change the order, press and hold the move icon (  ) of the desired testing set, then move it up or down. This change won't be saved to the original settings.

#### Test Solutions Medical Device Manufacturers

All information, documentation, firmware, software utilities, and specifications are subject to change without prior notification by the manufacturers.



[www.whaleteq.com](http://www.whaleteq.com)

[service@whaleteq.com](mailto:service@whaleteq.com)

🏠 8F., No. 125 Songjiang Rd., Zhongzheng Dist., Taipei City 104474, Taiwan

☎ +886-2-2517-6255

📞 +886-2-2596-0702

Copyright © 2013-2023, All Rights Reserved.

Whale Teq Co. LTD

is a registered trademark of Whale Teq Co. LTD.

All other trademarks or trade names are the property of their respective holders.

Documents / Resources

	<a href="#">WHALETEQ DFS200 APP AED Testing APP</a> [pdf] User Manual DFS200 APP AED Testing APP, DFS200, APP AED Testing APP, Testing APP
---	---

References

-  [WhaleTeq](#)