



WESTMAN CommandIQ Apps User Guide

[Home](#) » [WESTMAN](#) » WESTMAN CommandIQ Apps User Guide 

Contents

- [1 WESTMAN CommandIQ Apps](#)
- [2 Setting up your Wi-Fi and App](#)
- [3 Need More Assistance?](#)
- [4 Documents / Resources](#)
 - [4.1 References](#)
- [5 Related Posts](#)

WESTMAN

WESTMAN CommandIQ Apps



Setting up your Wi-Fi and App

1. Power on GigaSpire u6 device, connect an ethernet cable from WAN port in back to uplink device (DOCSIS modem/Calix ONT/etc).
2. Connect to the Wi-Fi. The SSID and password will be the same as what is on the sticker on the bottom of the device. Once it connects to Calix cloud through the internet it will replace the SSID with WCG-*Last 8 characters of SSID*. Eg: Default SSID goes from CXNK0094898B to WCG-0094898B.
3. Once connected to Wi-Fi, download the CommandIQ™ App from Apple Store or Google Play Store.



4. Once installed, start the app and tap "Let's Get Started". It will ask you to login or sign up. Users who have never used the app before will need to sign up. Once your account is created, login and set the location to Canada.

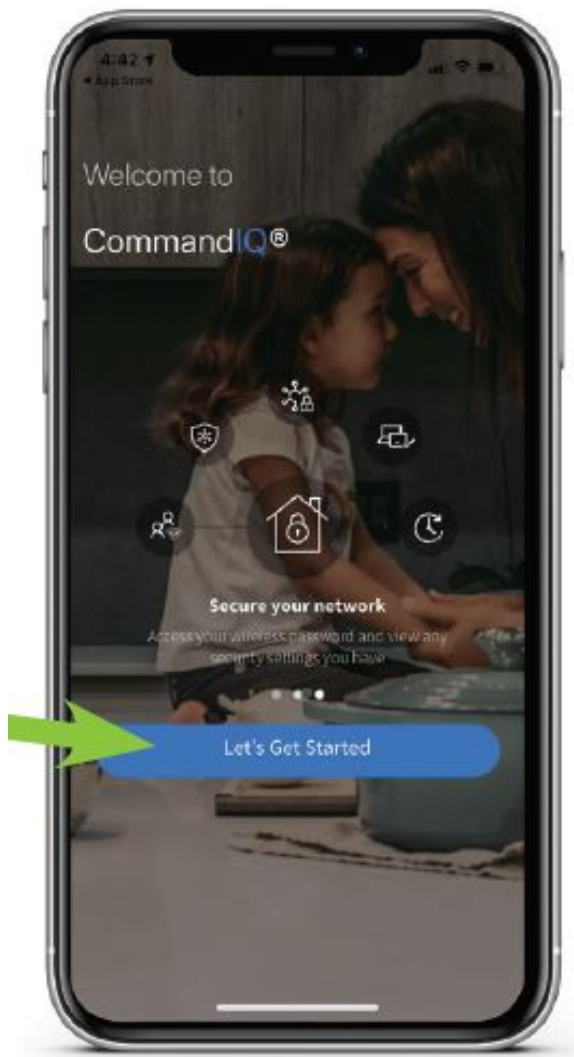

5. Once logged in, it will ask to onboard your router. Tap OK, allow it to use your camera, and then scan the QR code on the bottom sticker.

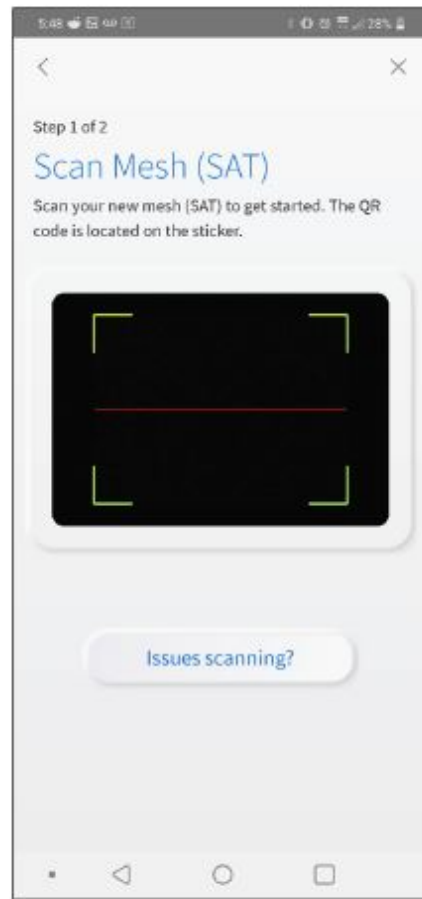
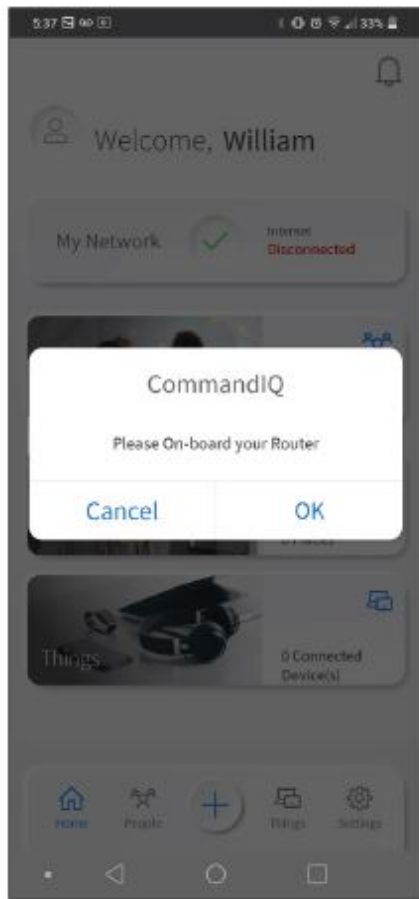

6. When it scans, it will transition to the next page asking you to setup the Wi-Fi. If you do not want to change anything, tap "Skip this step". Otherwise, fill in the information below such as Network Name (SSID), Password, etc.

5:46 28%

< X

Step 3 of 3

Setup Wi-Fi

 Wi-Fi already set up?

[Skip this step](#)

 if you are replacing a router, make sure to use the same Network Name and Password.

Network Name (SSID)

Security Type

WPA2-Personal

Password

Place(Optional)
In what place is this equipment located in your home.

Office, Living Room, etc.

7. Once complete, it will ask to setup your mesh device, if you do not have one, press "I don't have a mesh (SAT). Otherwise, click Next. It will ask you to scan the mesh device the same way we set up the main router.

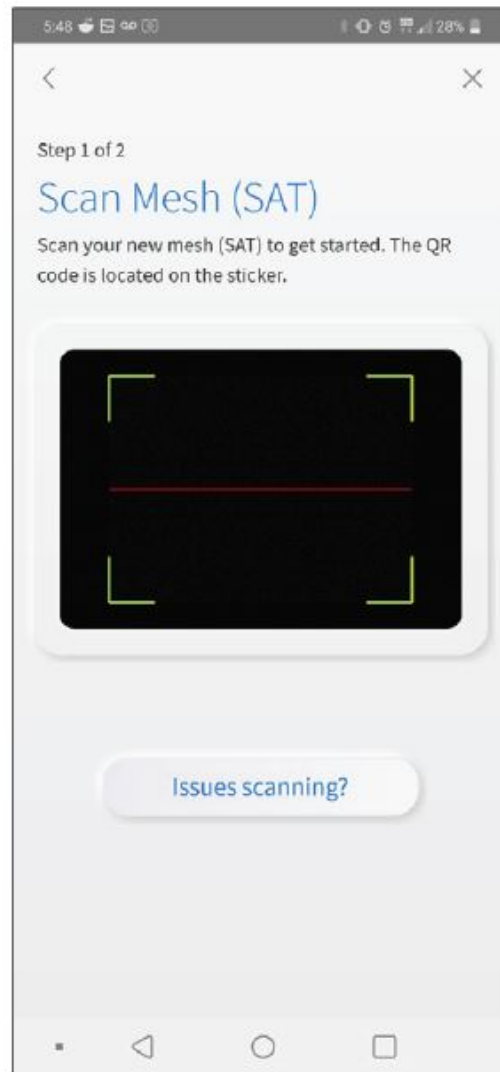

8. Once everything is completed you will be greeted with the main page of the app and you are good to go!

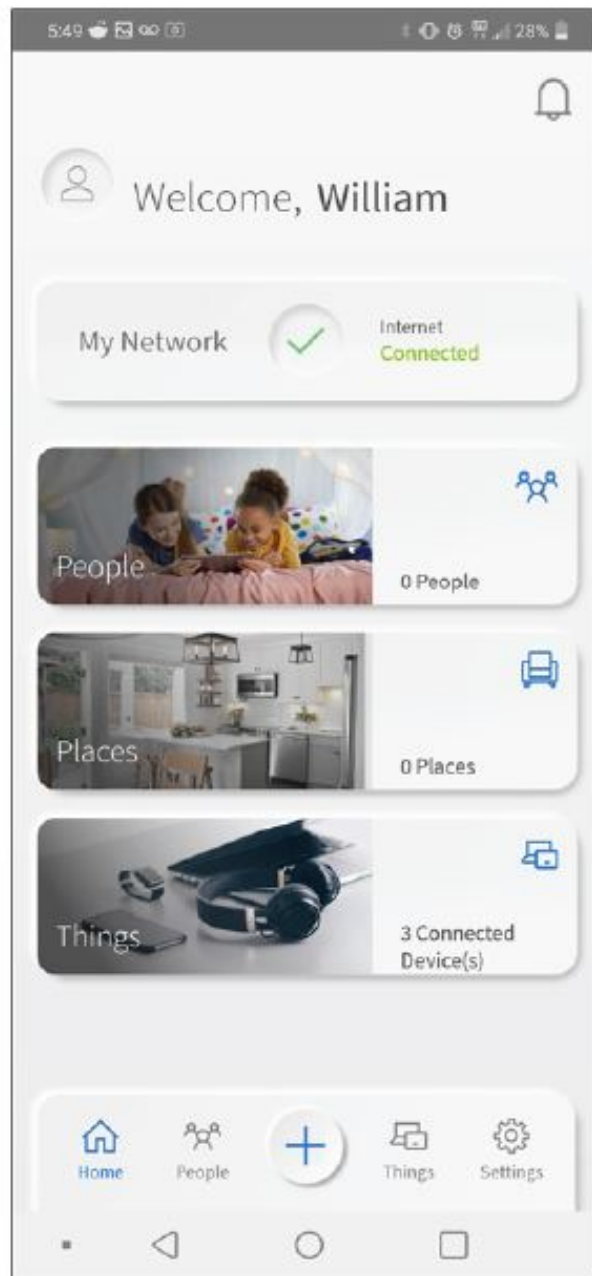

Need More Assistance?

We're here to help.



support.westmancom.com Search for "CommandIQ". FOR TECHNICAL ASSISTANCE, PLEASE CALL 204.717.2802 or toll-free at 1.800.665.3337 204.725.4300 1.800.665.3337 westmancom.com

Documents / Resources



[WESTMAN CommandIQ Apps \[pdf\] User Guide](#)
CommandIQ Apps, CommandIQ, Apps

References

-  [Westman Communications Group - Customer Support Portal - Home](#)
-  [Westman Communications Group: Your local telecommunications provider](#)

Manuals+.