

Westinghouse iGen5000c Inverter Generator with CO Sensor



Westinghouse iGen5000c Inverter Generator with CO Sensor User Guide

[Home](#) » [Westinghouse](#) » Westinghouse iGen5000c Inverter Generator with CO Sensor User Guide 

Contents

- [1 Westinghouse iGen5000c Inverter Generator with CO Sensor](#)
- [2 Specifications](#)
- [3 Quick Start](#)
- [4 TOOLS YOU WILL NEED](#)
- [5 BEFORE STARTING](#)
- [6 STARTING PROCEDURE](#)
- [7 SHUTDOWN PROCEDURE](#)
- [8 Maintenance](#)
- [9 SPARK PLUG REPLACEMENT](#)
- [10 QR SCAN](#)
- [11 FAQ](#)
- [12 Documents / Resources](#)
 - [12.1 References](#)
- [13 Related Posts](#)



Westinghouse iGen5000c Inverter Generator with CO Sensor



Specifications

- **Model Number:** iGen5000/ iGen5000c
- **Running Watts:** 3900
- **Peak Watts:** 5000
- **Fuel Tank Size (L/G):** 12.8/3.4
- **Rated Speed (RPM):** 3600
- **Ignition Type:** TCI
- **Engine Disp (cc):** 224
- **Oil Capacity (L):** 3%
- **Oil Type:** 10W30
- **THD:** 0.6

Quick Start

WARNING: This Quick Start Guide is not a substitute for reading the operator's manual. To reduce the risk of injury or death, the user must read and understand the operator's manual before using this product.

TOOLS YOU WILL NEED



Fresh clean unleaded
gasoline (not included)



Funnel (included)



4-stroke engine oil
(included)

BEFORE STARTING

1. Add engine oil.

- **a.** Remove the engine service cover to access the oil dipstick.

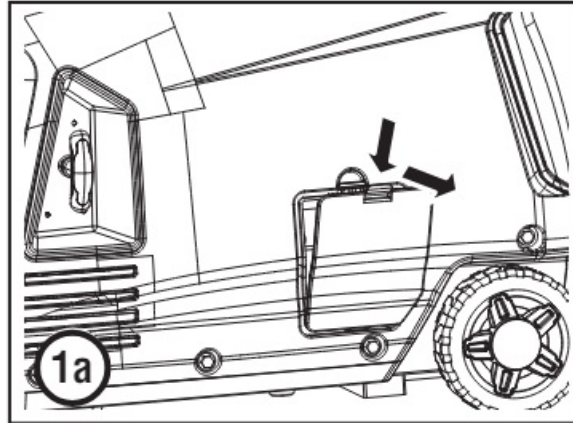

- **b.** Remove the oil dipstick.
- **c.** Using the supplied 4-cycle engine oil and funnel, slowly add engine oil to the engine until full.

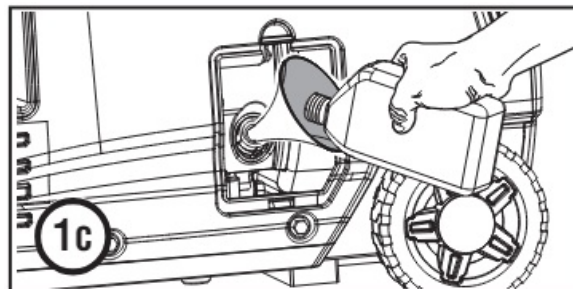

- **d.** Do not overfill. If the oil level is too high, oil will drain out through the fill plug.

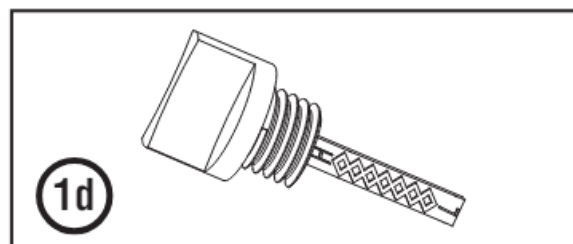

2. Add unleaded gasoline to the gas tank.

- **a.** Unscrew the gas cap on top of tank
- **b.** Slowly add gasoline to the fuel tank. The gasoline level should NOT be higher than the red maximum fill ring.

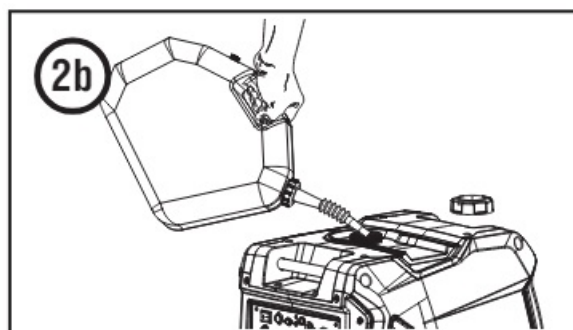

- **c.** Secure gas cap

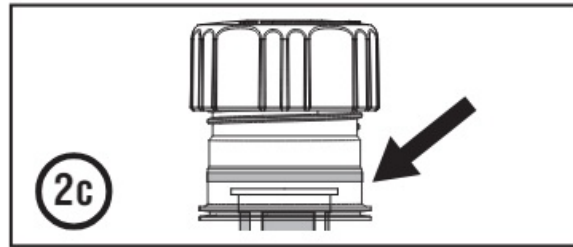

STARTING PROCEDURE

1. Make sure all loads are disconnected from the generator and the ECO mode switch is in the OFF position.
2. Connect the battery and turn the engine/fuel control switch to the on (I) position

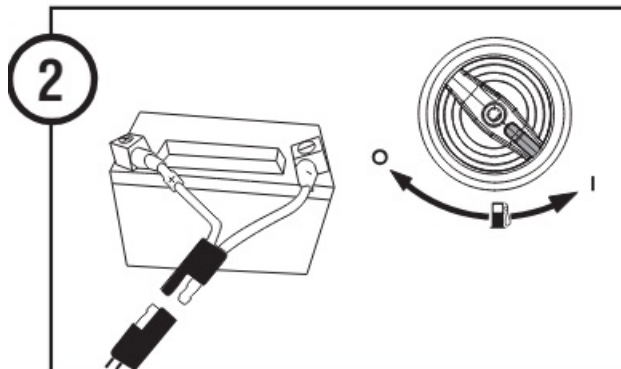

3. **3a.** For manual start, place the battery switch in the on position (I). Firmly grasp and pull the recoil handle slowly until you feel increased resistance. At this point, apply a rapid pull while pulling out from the inverter

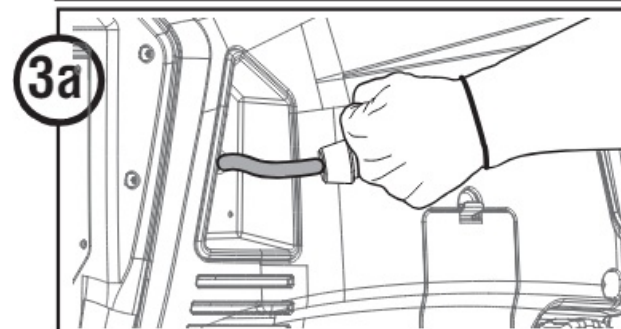
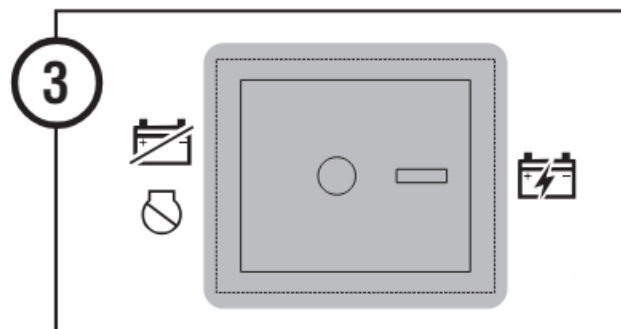

4. **3b.** For electric start, place the battery switch in the on position (I). Press the start button until the engine starts

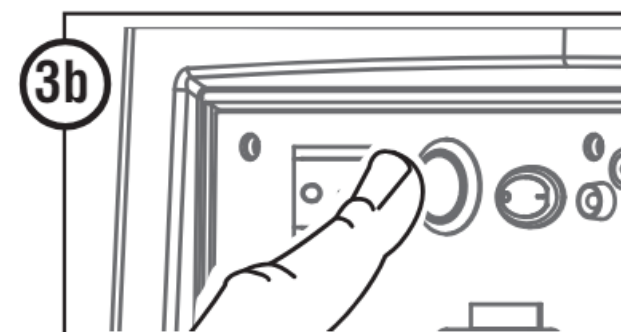

5. **3c.** For a remote start, place the battery switch in the on position (I). Press the ON button on the remote until the engine starts

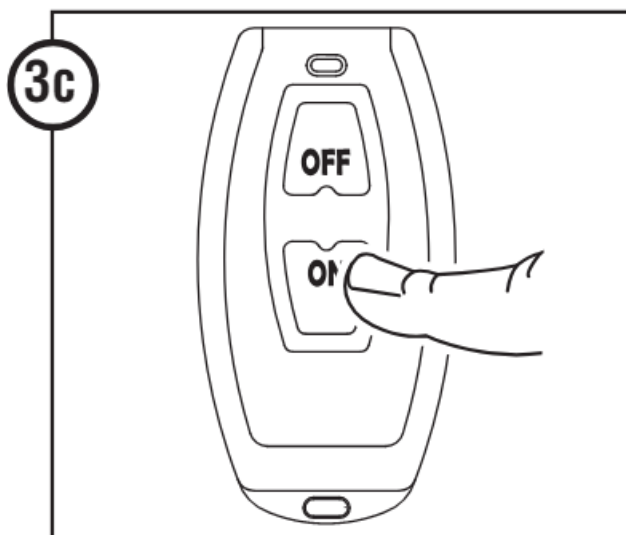

6. Connect loads to the control panel receptacles

SHUTDOWN PROCEDURE

1. Make sure all loads are disconnected from the generator
2. Put the engine run/stop switch in the stop position (O)

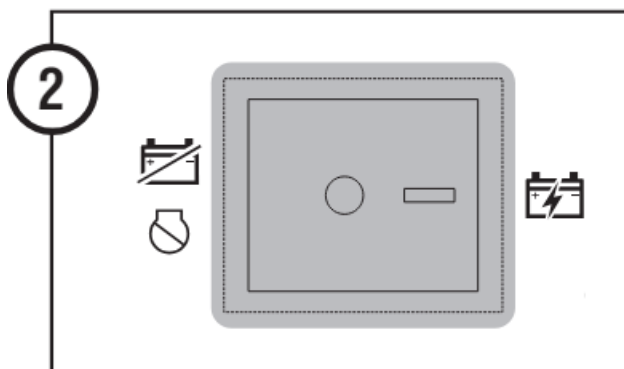

DANGER

- Using a generator indoors
- CAN KILL YOU IN MINUTES.
- Generator exhaust contains carbon monoxide.
- This is a poison you cannot see or smell.

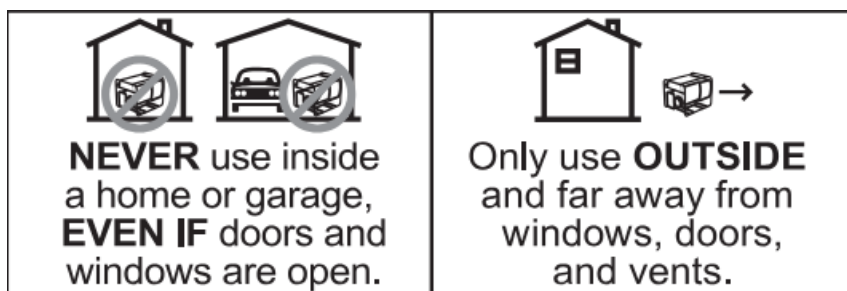

Avoid other generator hazards.
READ THE MANUAL BEFORE USE.

NOTE: This unit has a GASOLINE OFF (PROPANE) setting that can be used before storing the unit for long periods. Refer to the user manual for details.

Maintenance

INVERTER MECHANICAL SPECIFICATIONS

Model Number	Running Watts	Peak Watts	Fuel Tank Size (L/G)	Rated Speed (RPM)	Ignition Type	Engine Displacement (cc)	Oil Capacity (L)	Oil Type	THD
iGen5000/iGen5000c	3900	5000	12.8/3.4	3600	TCI	224	0.6	10W30	£ 3 %

MAINTENANCE SCHEDULE

Following the maintenance schedule is important to keep the inverter in good operating condition. The following is a summary of maintenance items by periodic maintenance intervals. Refer to the Maintenance section in the Owners Manual to find out how to properly perform maintenance.

TABLE 1: MAINTENANCE SCHEDULE

Maintenance Item	Before Every Use	After First 25 Hours or First Month of Use	After 50 Hours of Use or Every 6 Months	After 100 Hours of Use or Every 6 Months	After 300 Hours of Use or Every Year
Engine Oil	Check Level	Change ¹	Change	—	—
Air Filter	—	—	Clean ²	—	Replace
Spark Plug	—	—	—	Check/Clean	Replace
Spark Arrestor	—	—	—	Check/Clean	—
Fuel Filter	—	—	—	Replace ³	—
Valve Clearance	—	—	—	Inspect/Adjust ³	—

1. Change oil every month when operating under heavy load or in high temperatures.
2. Clean more often under dirty or dusty conditions.
3. Recommended service by authorized Westinghouse dealer.

ENGINE OIL

- Only use 4-stroke/cycle engine oil. NEVER USE 2-STROKE/CYCLE
- OIL. Synthetic oil is an acceptable substitute for conventional oil.

SPARK PLUG REPLACEMENT

Westinghouse Model	Torch	Bosch	NGK	Autolite
iGen5000/ iGen5000c	F7RTC	WR7BC	BPR6HS	284

Recommended Engine Oil Type

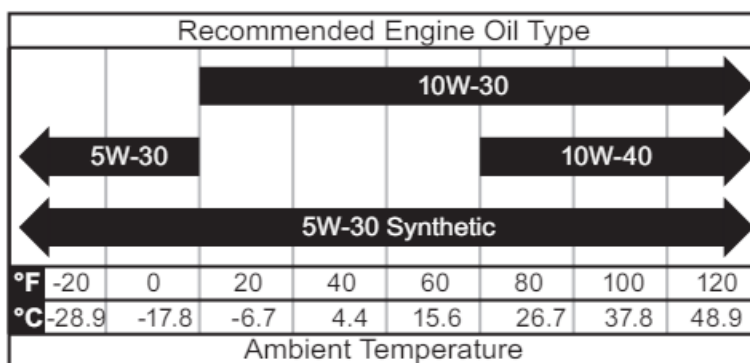

QR SCAN



For customer support, scan the QR code.

Questions? Call 855.944.3571 or visit wpowereq.com/pages/support

Tiene preguntas? Llame al 855.944.3571 o visite wpowereq.com/pages/support Des questions? Téléphoner au 855 944-3571 ou visitez wpowereq.com/pages/support

FAQ

- **Q: What is the maintenance schedule for the inverter?**
- **A:** Following the maintenance schedule is important to keep the inverter in good operating condition. Refer to the Maintenance section in the Owners Manual for detailed instructions on how to perform maintenance properly.
If you have any further questions, please call 855.944.3571 or visit wpowereq.com/pages/support.

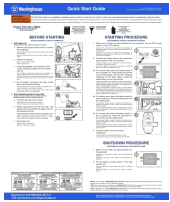

[Westinghouse iGen5000c Inverter Generator with CO Sensor](#) [pdf] User Guide
iGen5000c, iGen5000c Inverter Generator with CO Sensor, Inverter Generator with CO Sensor,
Generator with CO Sensor, CO Sensor

References

- [User Manual](#)

[Manuals+](#), [Privacy Policy](#)

This website is an independent publication and is neither affiliated with nor endorsed by any of the trademark owners. The "Bluetooth®" word mark and logos are registered trademarks owned by Bluetooth SIG, Inc. The "Wi-Fi®" word mark and logos are registered trademarks owned by the Wi-Fi Alliance. Any use of these marks on this website does not imply any affiliation with or endorsement.