

westfalia 928643 Convector Heater with Timer Instruction Manual



Contents

- 1 Convector Heater with Timer**
 - 1.1 Art. 92 86 43
 - 1.2 Original Instructions
 - 1.3 SAFETY NOTES
- 2 Operation**
 - 2.1 EU DECLARATION OF CONFORMITY
 - 2.2 CUSTOMER SERVICES
 - 2.3 DISPOSAL
- 3 Documents / Resources**
 - 3.1 References
- 4 Related Posts**

Convector Heater with Timer

Art. 92 86 43

Original Instructions



This Product is suitable only for use in well insulated rooms or for occasional use.

Dear Customers,

Instruction manuals provide valuable hints for using your new device. They enable you to use all functions, and they help you avoid misunderstandings and prevent damage. Please take the time to read this manual carefully and keep it for future reference.

If you pass the device on to third parties, enclose these instructions.

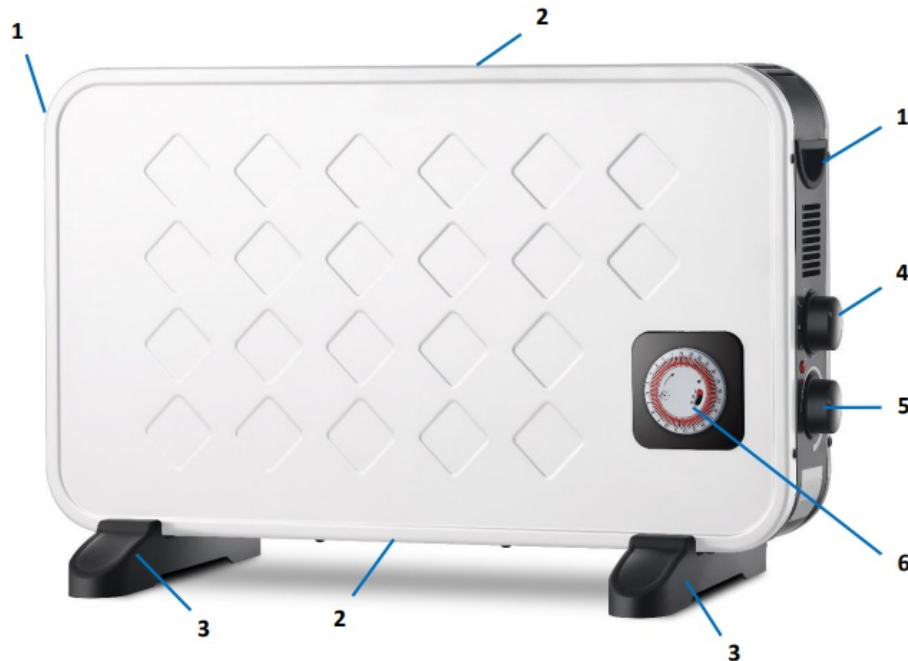

1. Handles
2. Air Vents
3. Stand Support
4. Dial for the Heating Stages
5. Thermostat
6. Timer

SAFETY NOTES

Please note the following safety notes to avoid malfunctions, damage or physical injury:

- Please read this manual carefully and use the device only according to this manual.
- Dispose of used packaging material carefully or store it out of the reach of children. There is a danger of suffocation!
- Persons with limited physical, sensorial or mental abilities are not allowed to use the device, unless they are supervised and briefed for their safety by a qualified person.
- Make sure the voltage corresponds to the type label on the unit.
- Do not leave the unit for long time unsupervised during operation.
- Always use a socket earthed according to the regulations.
- The convector heater is hot when in use. To avoid burns, do not let bare skin touch hot surface. Always use the handgrip when moving the heater. Keep combustible materials, such as furniture, pillows, bedding, papers, clothes, and curtains at least 50 cm away from the heater.



- Always unplug the heater while it is not in use or when you clean it.
- Always turn the heater off before unplugging it. Always pull on the plug, not on the cord.
- Do not install the power cord underneath the carpet. It has to lie free. Make sure it does not become a tripping hazard.
- Do not conduct the line cord over sharp edges and corners or hot surfaces.
- Do not operate the convector heater with a damaged plug or power cord or after the heater malfunctions, has been dropped or damaged in any manner.
- Do not use the heater outdoors.
- The heater is not intended for use in wet or damp conditions.
- The heater must not be used in bathrooms, showers, pool facilities, laundry rooms or in other similar indoor rooms. Never place the unit near bathtubs or other water tanks.
- Make sure that water cannot enter the interior of the heater.
- Always place the heater on a firm, even surface.
- Never use the heater without the stand supports.
- Do not operate the convector heater in areas with fire hazard, such as garages, stables or wooden shed. Do not use the unit in rooms in which highly inflammable gases or dust can be formed. Fire hazard!
- When operating the convector heater, make sure the room does not contain inflammable materials, e. g. petrol, solvents, spray cans, paints etc. Also make sure that the unit is not operated in the vicinity of wood, paper, plastics etc. Keep such materials away from the heater.
- The air vents of the heater must be clean and free from foreign objects. Do not cover the unit to prevent overheating.
- The unit is designed for operation in altitudes of up to 2000 m above sea level.
- Should the unit become damaged do not use it any further and have it repaired by a professional or contact our customer service. Do not disassemble the unit or try repairing it yourself.



Do not Cover!

Operation

Before the first Use

Unpack the convector heater and check the unit for any damage in transit. Dispose of packaging materials or store it out of reach of children. Plastic bags etc. may become a deadly toy for children. Before first use, clean the housing as described in chapter "Cleaning".

Assembling

For transport protection, the stand supports (3) of the convector heater are not attached. Fasten the stand supports on the base plate. Use the small screws included in the package. The unit has to be placed on a firm, level ground.

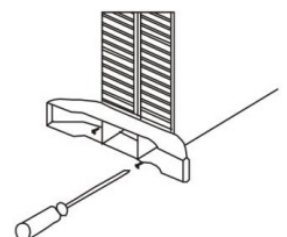

Operation

The heater is equipped with a turn knob (4) with which you can set the heater to two power settings either with or without the ventilator.

To activate the heater with the ventilator select the temperature settings with a ventilator symbol next to it.

Temperature Control/Thermostat

- Turn the thermostat switch (5) clockwise to the highest setting. As soon as the desired room temperature has been reached, turn the thermostat switch counter clockwise until you notice a click sound. This way the heater will be switched on and off automatically. The desired room temperature is maintained.
- Turn the thermostat switch clockwise in order to reach a higher room temperature. Turn the thermostat switch counter clockwise, in order to decrease heating power. The heater will switch on and off at a lower room temperature.

Overheat Protection

To prevent overheating, the built-in thermal overheating protection switches off the heater. Overheating may occur if the unit is covered while operation, if the convector heater is placed wrongly, the grille inside is dirty or if any objects are obstructing the air flow.

1. Turn off the heater and pull the power plug. Remove the causes and clean the convector heater.
2. First, allow the heater to cool down for at least 20 minutes. Then insert the power plug again into a grounded wall socket. The convector heater is ready for use again.

Timer



1. 3-Position Slider
2. Override Position I
3. Clock Symbol
4. OFF Position 0
5. Seconds Hand
6. Direction Arrow
7. Index
8. Outer Ring with 96 Segments

1. Familiarize yourself with the control elements of the timer.
2. Set the time switch to the current time. For this, turn the outer dial ring clockwise (see rotating arrow) until the clock time on the 24 h plan matches the arrow pointer. The outer dial ring allows for time settings in 15 minute intervals.

Example: At 8 p.m. turn the outer dial ring until it is in line with the number 20.

3. Move the red 3-Position-slide switch to the clock symbol. The timer is now activated.
4. Switch on the convector heater by using the turn knob (4). Set the switch-on and switch off times by moving the segments outwards. Each segment corresponds to a time setting of 15 minutes.

Hint: When all segments are pushed out, the heater will be switched on for 24 hours.

5. Make sure the unit is plugged in and switched on and the thermostat is set to the desired setting. In this case, the unit will switch on and off every day to the adjusted time.
6. If the 3-Position-slide switch is pushed to the override position I the convector heater will be in the continuous heating operation mode, so that manual operation is possible, by using the turn knob (4) and the thermostat (5).

Hint: The timer keeps running, but without influence to the manually adjusted settings.

If the 3-Position-slide switch is in the position **0**, all heating functions are switched off.

Cleaning and Storing

- Before cleaning, first unplug the unit. Do not pull the cord to unplug from the wall socket but grasp the plug itself to unplug.
- Do not wipe the convector heater with sharp detergents or aggressive chemicals in order not to damage the surfaces.
- Wipe the heater with a lightly moistened cloth. Use detergent as needed. Do not immerse it in water or any other liquid. Dry all parts well before storing.
- Clean the air vents with a brush.
- Never try to clean the interior of the heater. Do not open the unit.
- Allow the convector heater to fully cool down before storing.
- Make sure that liquids cannot enter the air vents.
- Store the convector heater in a dry place that is protected from dust, dirt and extreme temperatures.
- Store the unit out of reach of children.

Technical Data

Nominal voltage:	230 V~
Frequency:	50 Hz
Protection class:	I
Nominal power stage 1:	1300 W
Nominal power level 2:	2000 W
Nominal heat output P_{nom} :	2.0 kW
Minimum heat output P_{min} :	1.3 kW
Maximum continuous heat output $P_{max,C}$:	2 kW
Power consumption in standby mode:	0.00091 kW
Dimensions with stand:	600 x 260 x 385 mm
Approx. weight:	3550 g

EU DECLARATION OF CONFORMITY

We, the Westfalia Werkzeugcompany, Werkzeugstraße 1, D-58093 Hagen,

declare by our own responsibility that the product

Convector Heater with Timer
Article No. 92 86 43

is according to the basic requirements, which are defined in the European Directives and their amendments.

2011/65/EU Restriction of the Use of certain hazardous Substances in electrical and electronic Equipment (RoHS)

2014/30/EU Electromagnetic Compatibility (EMC) EN IEC 55014-1:2021, EN IEC 55014-2:2021, EN IEC 61000-3-2:2019+A1, EN 61000-3-3:2013+A1

2014/35/EU Low Voltage Directive (LVD) EN 60335-1:2012+A11+AC+A13+A1+A14+A2+A15, EN 60335-2-30:2009+A11+AC+A1+A12, EN 62233:2008+AC

2009/125/EG Energy-related Products (ErP) Regulations (EU) 2015/1188

The technical documentations are on file at the QA department of the Westfalia Werkzeug company.

Hagen, 28th of June 2023

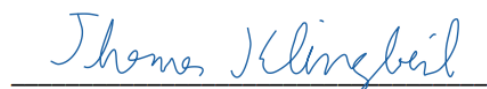

Thomas Klingbeil,
QA Representative

CUSTOMER SERVICES

DEUTSCHLAND

Westfalia
Werkzeugstraße 1
D-58093 Hagen

Telefon: (0180) 5 30 31 32
Telefax: (0180) 5 30 31 30
Internet: www.westfalia.de

SCHWEIZ

Westfalia
Wydenhof 3a
CH-3422 Kirchberg (BE)

Telefon: (034) 4 13 80 00
Telefax: (034) 4 13 80 01
Internet: www.westfalia-versand.ch

ÖSTERREICH

Westfalia
Moosham 31
A-4943 Geinberg OÖ
Telefon: (07723) 4 27 59 54
Telefax: (07723) 4 27 59 23
Internet: www.westfalia-versand.at

DISPOSAL



Dear Customer,

Please help avoid waste materials.

If you at some point intend to dispose of this article, then please keep in mind that many of its components consist of valuable materials, which can be recycled. Please do not discharge it in the rubbish bin, but check with your local council for recycling facilities in your area.

Gestaltung urheberrechtlich geschützt

©Westfalia 06/23

Westfalia®



Documents / Resources

	<p>westfalia 928643 Convector Heater with Timer [pdf] Instruction Manual 928643 Convector Heater with Timer, 928643, Convector Heater with Timer, Heater with Timer</p>
---	---

References

- [W Westfalia Versand Österreich | Werkzeug ✓ Garten ✓ Technik ✓ & mehr](#)
- [W Westfalia Versand Schweiz mobil bei Westfalia Versand Schweiz](#)
- [W Westfalia Versand Deutschland mobil bei Westfalia Versand Deutschland](#)