



Westcom Atlas Max Digital Wireless Intercom User Manual

[Home](#) » [Westcom](#) » Westcom Atlas Max Digital Wireless Intercom User Manual 



Atlas Max
DIGITAL
WIRELESS INTERCOM

Contents

- [1 Atlas Max Digital Wireless Intercom](#)
- [2 Introduction](#)
- [3 Function](#)
- [4 Accessories](#)
- [5 FAQ](#)
- [6 Specification & Caution](#)
- [7 Warning](#)
- [8 Documents / Resources](#)
- [9 Related Posts](#)

Atlas Max Digital Wireless Intercom

Caution

Atlas Max operates in the license-free 900MHz ISM band.

Atlas Max subject to the Rules and Regulations of the FCC.

This device complies with part 15 of the FCC rules. Operation is subject to the following two conditions: (1) This device may not cause harmful interference, and (2) this device must accept any interference received, including interference that may cause undesired operation.

NOTE: THE GRANTEE IS NOT RESPONSIBLE FOR ANY CHANGES OR MODIFICATIONS NOT EXPRESSLY APPROVED BY THE PARTY RESPONSIBLE FOR COMPLIANCE. SUCH MODIFICATIONS COULD VOID THE USER'S AUTHORITY TO OPERATE THE EQUIPMENT.

NOTE: This equipment has been tested and found to comply with the limits for a Class B digital device, pursuant to part 15 of the FCC Rules. These limits are designed to provide reasonable protection against harmful interference in a residential installation. This equipment generates uses and can radiate radio frequency energy and, if not installed and used in accordance with the instructions, may cause harmful interference to radio communications. However, there is no guarantee that interference will not occur in a particular installation.

If this equipment does cause harmful interference to radio or television reception, which can be determined by turning the equipment off and on, the user is encouraged to try to correct the interference by one or more of the following measures:

- Reorient or relocate the receiving antenna.
 - Increase the separation between the equipment and receiver.
 - Connect the equipment into an outlet on a circuit different from that to which the receiver is connected.
 - Consult the dealer or an experienced radio/TV technician for help.
-
- Do not put sharp, hard materials into the connector hole when using this product.
 - Do not put apart or repair "Atlas Max" yourself.
 - Do not leave Atlas Max in a vehicle in hot or cold weather.
 - Leaving "Atlas Max" in a closed area for a long period of time may result in deformation or malfunction of this product.
 - For charging use only the provided charger & cable. Using a third party charger may cause explosion, fire or malfunction.
 - Stop using "Atlas Max" immediately if you smell something like smoke from this.
 - Stop using "Atlas Max" immediately when exposed to risk of fire and call the customer center and consult if you can use "Atlas Max" at the environment.
 - Please do not use third party's components.
 - If you use a third party component, it could cause breakdown or malfunction.
 - Be careful not to apply strong pressure on this product, which may cause breakdown or damage to the product.
 - If dirt slips in, the quality could decline, so make sure to clean the product with soft cloth often.
 - If "Atlas Max" submerges under water, don't put apart or repair it yourself. Please turn the power off and call our

customer service center.

Certification :

Identification Code : Shown below

Company Name: Manufacturer/Country:

Date of manufacturing: Marked Separately

Model Name: Shown Below

Input Rating: Shown Below

Date of Manufacture: Separately Shown

Model Name	Input Rating	Identification Code

Introduction

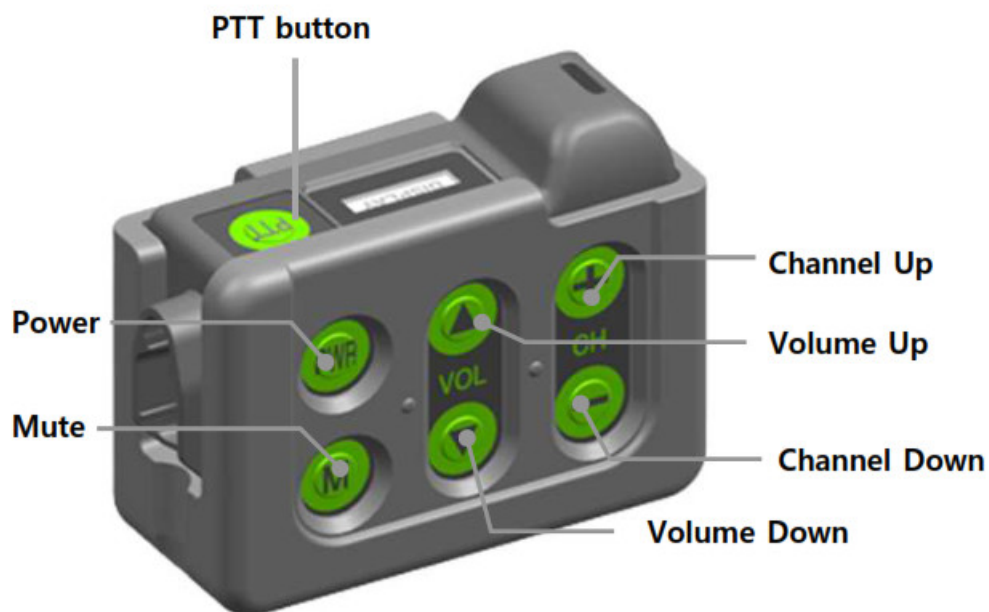

**Product Image
FRONT**

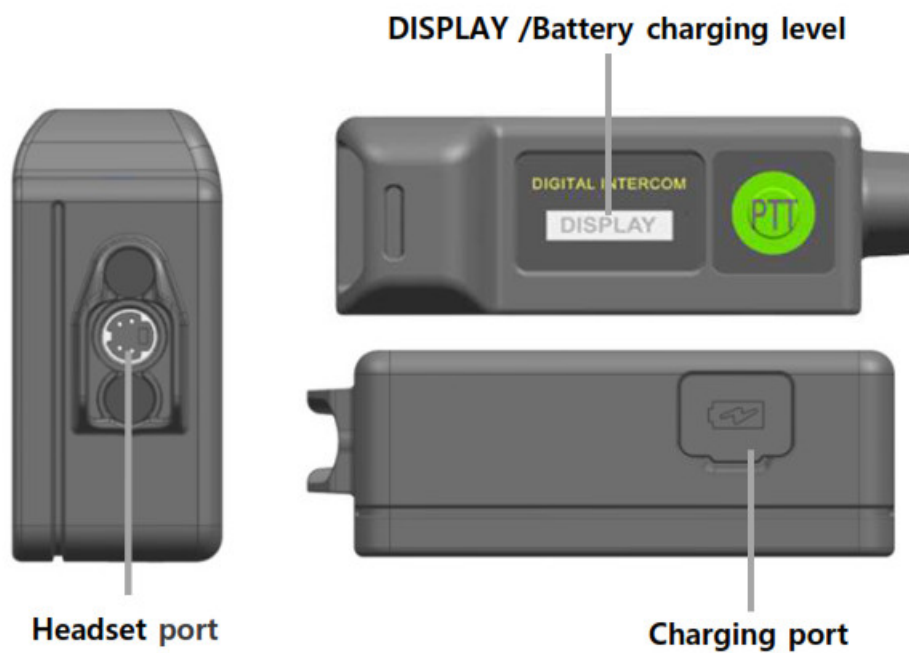

TOP & SODE & BOTTOM

Function

1. Power

Power on, off with PWR button



2. Current Setting Display

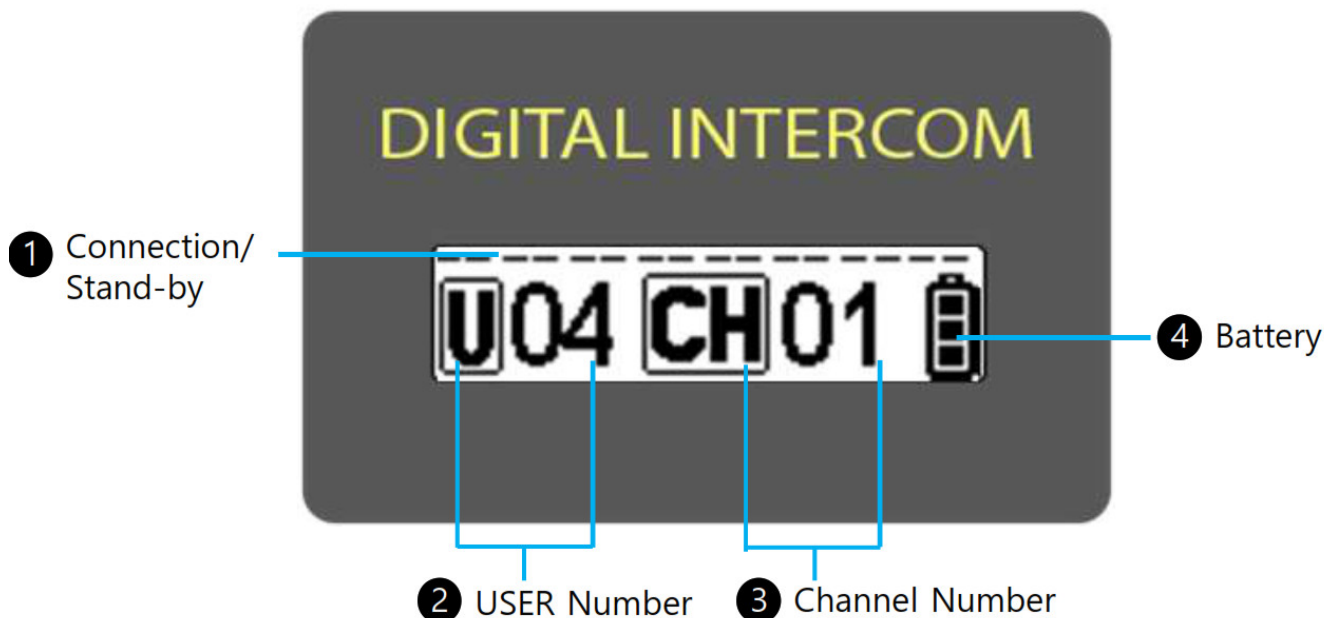

1. Connection/Stand-By : Twelve bars on the upper display shows connection  or stand-by .

2. User Number : it shows the user number that your device is set to.

3. Channel :  means the current channel number that your device is set to.

If you are a master device,  is displayed.

4. Battery : It indicates current battery level.

When battery is running low, the battery ICON is blinking.



More than 80%



Below 50%



Below 20%

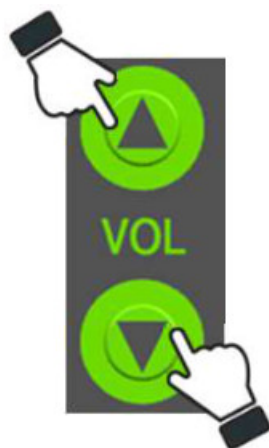

Note

Volume 0 means no audio volume



Note

If device is left in standby mode for half hour, it is automatically turned off for power-saving.

Standby status means the device is ready for pairing (No connection)

Function

3. Volume Setting

Volume level ranges from 0 to 8.

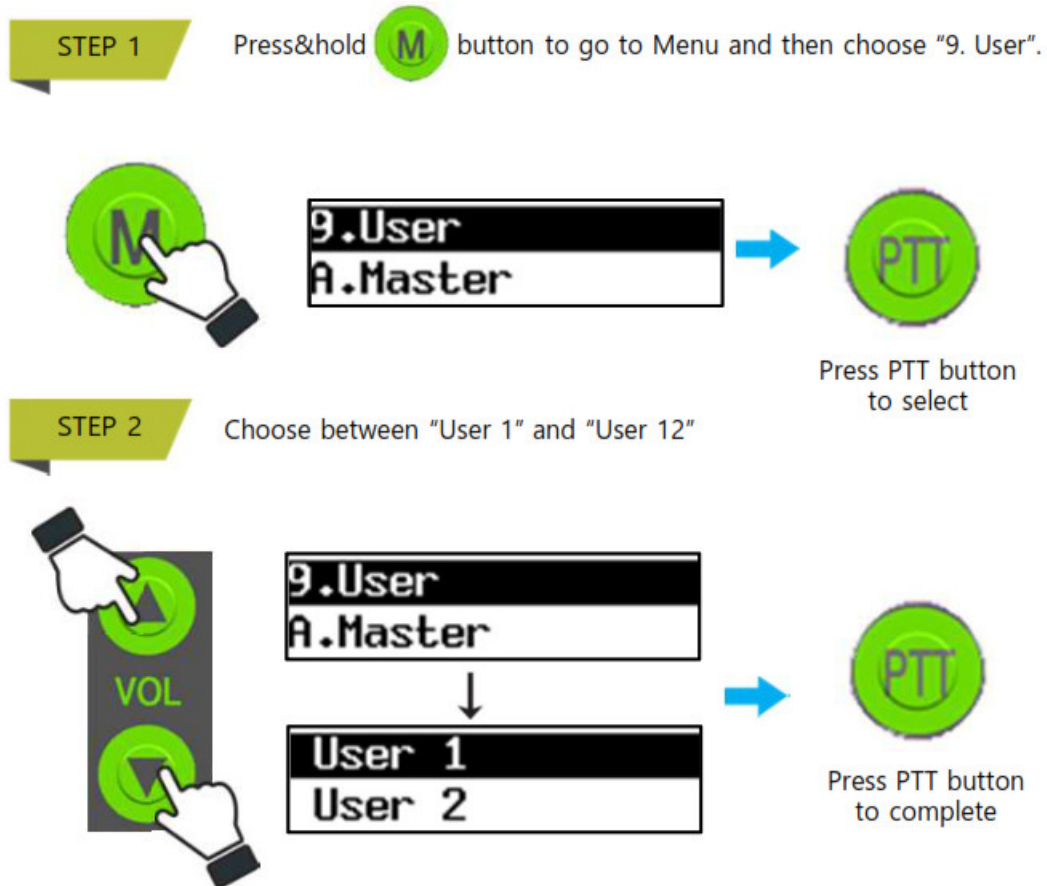

4. User Number Setting

User Number ranges from User 1 to User 16.

Each device takes one user number, and user number for devices should be different from one another.



Note

- There should be one Master Device for group communication.
- Press&hold PTT button for transmission in "PA mode".

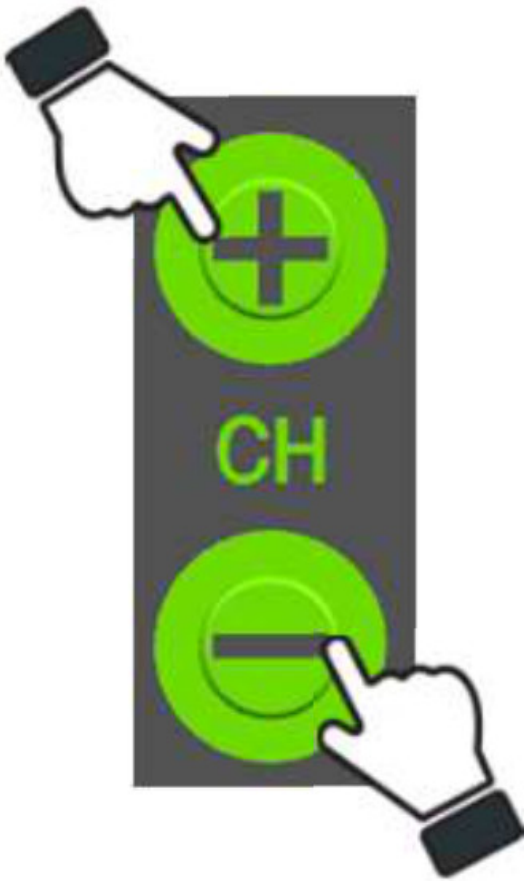

Select a channel number
by pressing Channel Up or
Down button

Function

5. Channel Setting

Devices should be set to same channel number for communication.

If there are multiple communication groups in the same channel nearby, set channel number different from other groups to avoid potential interference.

STEP 1 Choose between "Channel 1" and "Channel 6"

STEP 1

Press&hold  button to go to Menu and then choose "1.Radio Mode".



1.Radio Mode
2.Reverse LCD



Press PTT button to select

STEP 2

Choose Between Normal, Long, Repeat



1.Radio Mode
2.Reverse LCD



0 Normal Mode
Long Mode



Press PTT button to complete

6. Radio Mode Setting

It can be used by selecting from Normal Mode, Long Mode and Repeat mode.

-Normal Mode : Max. 16 User – Default mode

-Long Mode : Max. 12 User – Maximum distance mode

-Repeat Mode : Max. 16 User – Repeater mode

Function

7. Pairing (Grouping)

Below pairing procedure should be done to establish communication group.

STEP 1 Pairing is made between a master device and rest devices.

Each device needs to be set to a different user number than others



STEP 2 Press&hold 'M' button to go to Menu and then select "6. Pairing".



8.Pairing
9.User



Push PTT button to select

Pairing...
59

STEP 3 Once pairing is done, paired devices go to stand-by display.

If you press 'M' button while pairing is being processed, the pairing is canceled and these devices go to stand-by display.



Note

Pairing is cancelled if not done within 60 seconds.

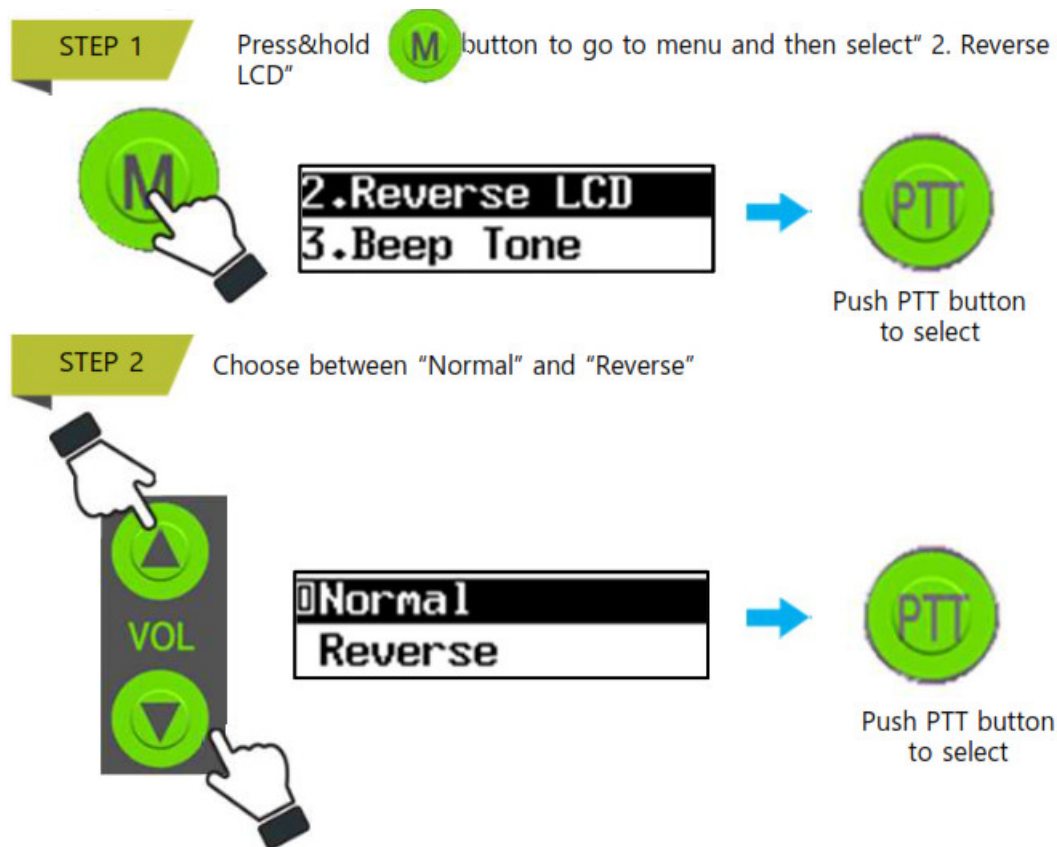

Function

8. Reverse LCD
Display Image .

STEP 1

Press&hold  button to go to menu and select " 3. Beep Tone".



3.Beep Tone
4.Brightness



Push PTT button
to select

STEP 2

Choose between "Enable" and "Disable"



Enable
Disable



Push PTT button
to select

9. Beep Tone

You can turn on or off warning sound and button sound depending on user's preference.

STEP 1

Press&hold  button to go to menu and then select " 4. Brightness .



4.Brightness
5.Mic Level



Push PTT button
to select

STEP 2

Choose between "0" and "8".

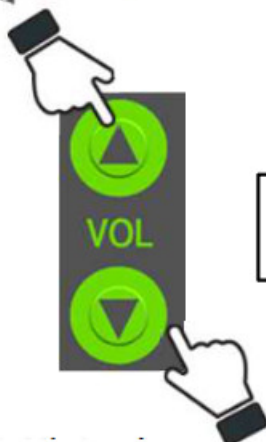

Brightness
8



Push PTT button
to select

STEP 1

Press&hold  button to go to menu and then select " 5. Mic Level "



5.Mic Level
6.Side Tone



Push PTT button to select

STEP 2

Choose between "0" and "8" (The higher number you choose, the higher microphone volume it transmits)
"Mic Level" 0 means microphone is mute

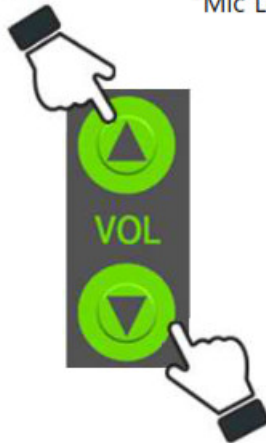

Mic Level
6



Push PTT button to select

Function

10. Display Brightness Setting

You can adjust display brightness level. **11. Mic Level**

You can adjust the Microphone Volume level. With this function your voice transmission is clearer if you set it right, depending on your voice level.



B.Information
Exit



Push PTT button to select



Push PTT button to select

Function

12. Information

You can check the device's version **13. PA Mode (PTT Button)**

User 1-12 can use PA mode by using below PTT button.



Push 'M' button to
activate/deactivate mute.

13. Mic Mute

User 1~12 can mute microphone by pressing 'M' button shortly. Users only listen if they mute microphone.

14. Side Tone

You can turn on or off Side Tone function.

If you turn on the Side Tone, you can hear what you are saying at real time.

14. How to reset in case of malfunction



Press these buttons together at the same time. Then the device goes off.



Note

Be careful not to press these buttons together during normal operation.

15. How to charge

While on charge, green light on the lower display lights up and the green light becomes dimmer once the device is fully charged.



Note

- Please use only the provided charging adapter or use 5V / 2A adapter or higher than that.
- The battery level indication while on charge could be different from the actual battery level.
- We don't recommend charging a device with power on.

If you leave a device charged with power on for one day, it could self-discharge.

(When this happens, please make sure to re-charge it)

Please make sure to turn off the device before charging it to get it fully charged.

Accessories

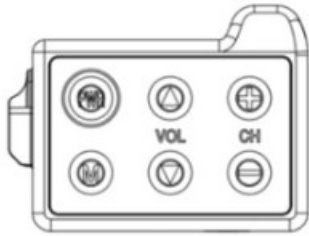

1 Atlas Max



2 Rubber Belt Holder

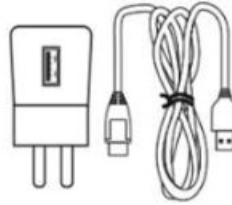

3 Charger



4 Manual



5 H9 (Headset)

FAQ

Following is the list of frequent questions and answer.

- 1 I can't communicate with other devices.
- Check if your device is paired with Master Device.
- In your group, check if Master Device exists.
- 2 I cannot join a group communication.
- Check if other users are connected on the display.
- Check if there is a Master Device in the group.
- You might be too far from Master Device to get the signal from it. .
- 3 I cannot turn on the device.
- Put your device to the charger for charging and then turn it on.
- 4 I lost connections sometimes.
- Check if other users are connected on the display.
- Check if someone is using the same user number as mind
- 5 Other users' voice sounds broken.
- Check if the distance between the users is too far.
- 6 Other users can barely hear my voice.
- Check if you set MIC level low.
- Check if the headset' microphone is a little far from your mouth

Specification & Caution

Frequency	902MHz~928MHz
Transmission Distance	1Km (Line of Sight)
Battery Lifetime	10Hour
Battery	Rechargeable Li-ion 3.7V Battery
Transmission Output	250mW / 1W
Weight	190g
Size	Width(w) : 92mm Height(h) : 75.5mm Thickness(t) : 35mm
Working Temperature	-10/+50°C
Modulation System	FSK
Transmission Method	TDMA

※ The function may change without notice for product improvement purpose.

※ Transmission distance may vary depending on the surroundings' obstacles and humidity.

I Caution I

Please make sure to read through the below safety requirements before using this product.

If these are not followed well, incidents like fire or explosion may happen.

– DO NOT separate / modify the antenna or DO NOT use the modified antenna.

It degrades performance of the device, which results in serious breakdown as the intercom generates strong radio wave through the antenna.

– Only the provided charging adapter and headset are acceptable to use with this device, so DO NOT use a third-party adapter and headset. Otherwise, the battery will be damaged and there will be a malfunction of the device.

– Use this device only for communication (NOT for other purposes).

– Do not take apart or modify this device yourself. Otherwise, this could result in a malfunction which our warranty doesn't cover. Also, you might be subject to a penalty according to a relevant communication law.

– Do not change the frequency or use other frequency than the allowed frequency.

Otherwise, you might be subject to a penalty according to a relevant communication law.

* Try not to put strong physical shocking to this device.

* Keep it out of direct sunlight and high humidity.

* DO NOT leave the device in a car in the summer.

Warning

I Warning I

-FCC Information to User-

This equipment has been tested and found to comply with the limits for a Class B digital device, pursuant to Part 15 of the FCC Rules. These limits are designed to provide

reasonable protection against harmful interference in a residential installation. This equipment generates, uses and can radiate radio frequency energy and, if not installed and

used in accordance with the instructions, may cause harmful interference to radio communications. However, there is no guarantee that interference will not occur in a

particular installation. If this equipment does cause harmful interference to radio or television reception, which can be determined by turning the equipment off and on, the

user is encouraged to try to correct the interference by one of the following measures:

- Reorient or relocate the receiving antenna.
- Increase the separation between the equipment and receiver.
- Connect the equipment into an outlet on a circuit different from that to which the receiver is connected.

- Consult the dealer or an experienced radio/TV technician for help.

-Caution-

Modifications not expressly approved by the party responsible for compliance could void the user's authority to operate the equipment.

-FCC Compliance Information-

This device complies with Part 15 of the FCC Rules. Operation is subject to the following two conditions: (1) This device may not cause harmful interference, and (2) this device must accept any interference received, including interference that may cause undesired operation.

This device was tested in compliance with FCC RF Exposure limit. (0 mm distance from human body (limit 1.6 W/kg @ 1g SAR))

Documents / Resources

	<p>Westcom Atlas Max Digital Wireless Intercom [pdf] User Manual</p> <p>Atlas Max Digital Wireless Intercom, Atlas Max, Digital Wireless Intercom, Wireless Intercom, I ntercom</p>
---	---