



WERMA WEA3 WeASSIST Gateway User Manual

[Home](#) » [WERMA](#) » WERMA WEA3 WeASSIST Gateway User Manual 

WERMA WEA3 WeASSIST Gateway User Manual



Electrical connection is to be made by trained electrical specialists only. Operation only with power adapter included in assembly

Receiver category according to EN 300220: category 1.5. This product fulfills the requirements of the norm 2014/53/EU. The Declaration of Conformity is available on request.

Contents

- [1 Safety instructions](#)
- [2 Specifications](#)
- [3 LED status](#)
- [4 Mounting + Installation](#)
- [5 FCC](#)
- [6 Documents / Resources](#)
 - [6.1 References](#)
- [7 Related Posts](#)

Safety instructions

CAUTION

- Observe the instructions for the connectable devices and network participants.
- The system is not suitable for safety relevant applications.
- Please note that this version is only approved for use in all EU (862 000 01) member countries, the USA and

Canada (862 000 02). Further countries upon request.



- The device must not be used in connection with devices that may directly or indirectly serve health- or life-saving purposes or cause hazards by operation to human beings, animals or asset values.
- The described products have been developed in order to assume safety functions as part of an entire plant or machine. The responsibility taken by the manufacturer of a plant or machine implies a safeguarding of correct general function. Moreover WERMA does not assume any liability for recommendations made or implied by this description. From this description new claims for guarantee, warranty or liability cannot be derived beyond the general terms and conditions of delivery.
- Use only the antenna included.

Specifications

Note: For the use of the enclosed product with the WERMA WeASSIST system solution, please refer to the WERMA WeASSIST manual.

Power adapter	Input: 100-240 V~, 50-60 Hz, max. 1,0 A	
Connections	DC Power Input	
	LAN	RJ45
		USB 2.0
	Antenna	SMA-RP
862 000 01		
SRD-frequency	868,0 ... 868,6 MHz	
Transmission range	500 m (unobstructed line of sight)	
862 000 02		
ISM-frequency	921,0 ... 922,0 MHz	
Transmission range	500 m (unobstructed line of sight)	

LED status

LED	Meaning
lights up white 	Connection to the WERMA Cloud established
lights up white 	Radio service ready or data received by radio
light up red 	Connection fault

Note on Fig. 2b:

Use M5 / M6 cylinder head screws with a low head (DIN 6912 / DIN 7984) or flat head screws (DIN EN ISO 7380)!

Mounting + Installation

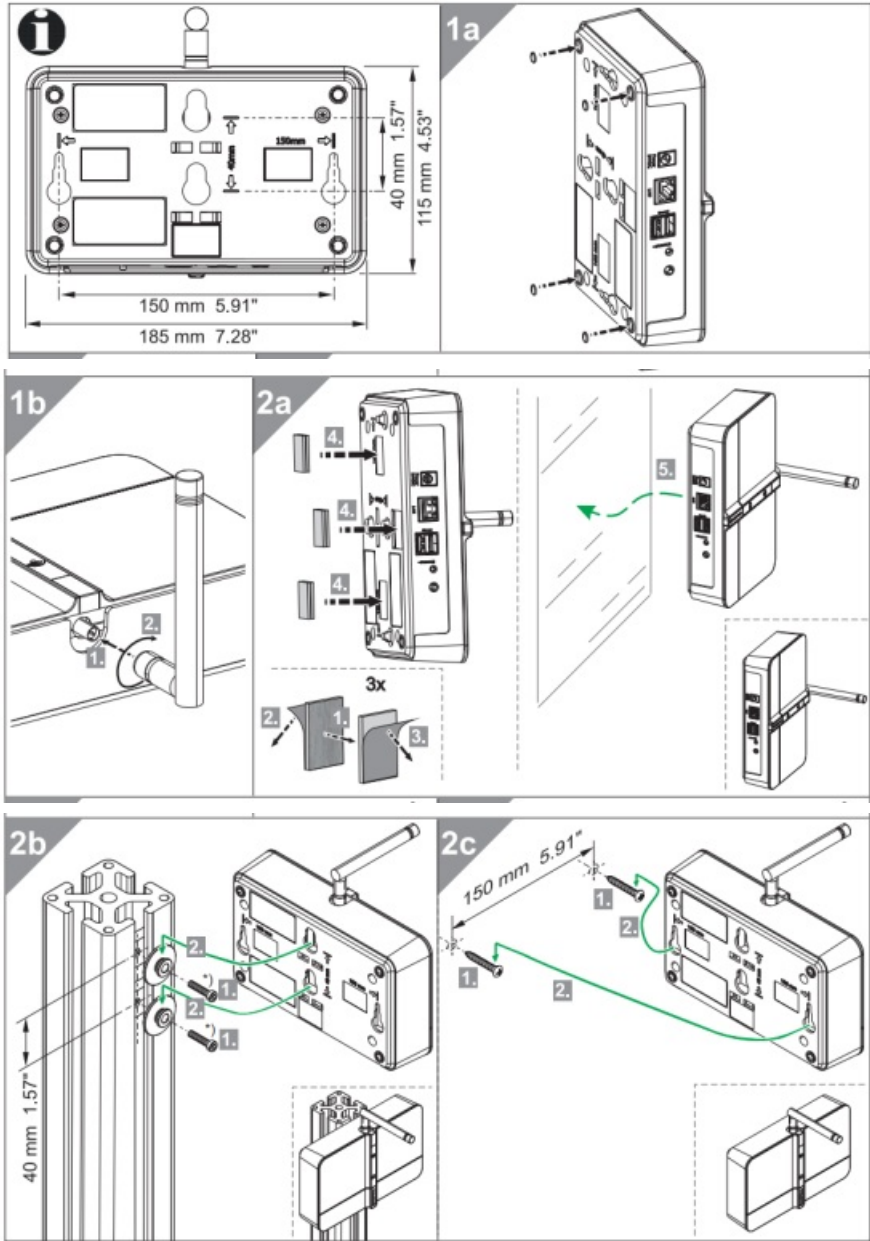

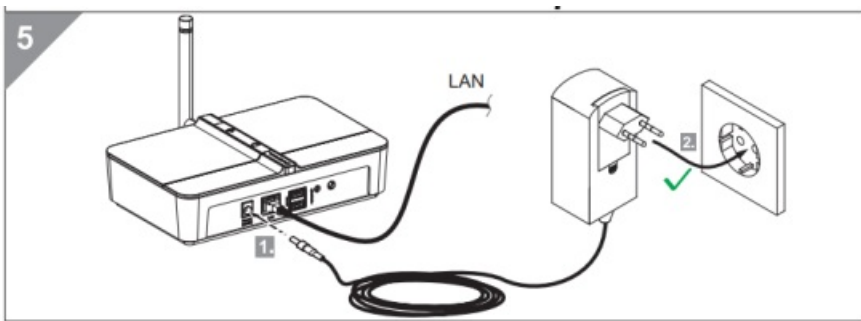
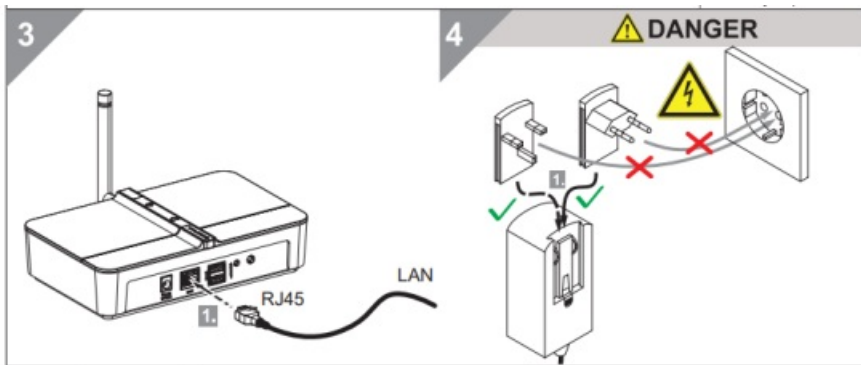
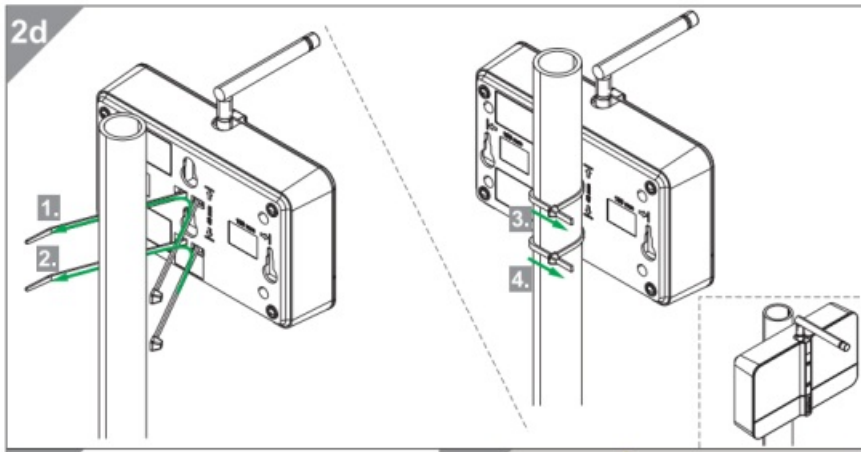

FCC

FCC: This device complies with Part 15 of the FCC Rules. Operation is subject to the following two conditions:

1. This device may not cause harmful interference, and
2. this device must accept any interference received, including interference that may cause undesired operation.

Any changes or modifications not expressly approved by the party responsible for compliance could void the user's authority to operate this equipment. ISED: This device complies with the licence-free RSS standard(s) from Industry Canada. Operation is subject to the following two conditions:

1. this device may not cause interference, and
2. this device must accept any interference, including interference that may cause undesired operation of the device

Documents / Resources

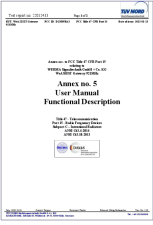

[WERMA WE3 WeASSIST Gateway](#) [pdf] User Manual
WEA3, ZGHWEA3, WEA3 WeASSIST Gateway, WeASSIST Gateway

References

- [🌐 Produkte - kreateam & wolf Informationsdesign](#)

Manuals+.